



BEYOND

DISCOVER THE

Galapagos Islands



A pristine ecological phenomenon



Scattered along the Pacific Ocean off the west coast of Ecuador, the magnificent archipelago of volcanic islands known as the Galapagos is world-renowned for its unique wildlife and natural wonders, many of which are found nowhere else.

Why visit the Galapagos Islands?

The Galapagos archipelago is a UNESCO World Heritage Site comprising 18 main islands, three smaller islands and 107 rocks and islets.



1

UP CLOSE AND PERSONAL

Renowned for hosting a wide variety of wildlife that has evolved with no major predators for hundreds of years allows for exceptional viewing opportunities from a surprisingly close range in their natural habitat. Amble along with giant tortoises, meet birds-of-a-feather perched in nearby trees, and swim with marine iguana.



2

AN ABUNDANCE OF WILDLIFE

More than 80% of the Galapagos' animals and 30% of plant species are endemic — meaning they can be found nowhere else on earth. The giant Galapagos tortoise, land and marine iguana, sea lion, green sea turtle, stingray, three kinds of boobies, the Galapagos penguin, waved albatross, frigatebirds and flightless cormorant, are just a few of the incredible marine, wildlife and birdlife to be seen.



3

UNSPOILED ECOSYSTEMS

The majority of the islands remain uninhabited today and there are strict tourism laws in place designed to protect the biodiversity of these pristine ecosystems. Naturally one of the most biodiverse places on earth with 97% of its islands forming a protected national park, travellers can enjoy dense forests, volcanic lava tubes and picturesque beaches.



4

SWIM, SNORKEL AND SCUBA

The islands are well known for their spectacular scuba diving and snorkelling spots. While some may offer better viewing opportunities than others, no matter which island you're exploring, you'll likely be swimming alongside sea lion and green sea turtle, with the opportunity to see hammerhead sharks, whale sharks, eagle rays, plus large schools of jackfish.

DISCOVER THE GALAPAGOS ISLANDS

Why travel with &Beyond?

1 TRAVEL WITH HEART

Our core ethos of "Care of Land, Wildlife & People" drives all that we do. When you travel with us you make a meaningful contribution to the preservation of our world's cultures and wildlife, and leave with an opportunity to gain first-hand experience in some of our conservation and community initiatives.

2 IN OUR HANDS

We are on call 24/7 to assist you throughout your journey. With over 2 000 &Beyonders, including guides and ground logistics teams on three continents, you will be in our hands from the moment you arrive to the moment you leave. Additionally, we offer a personal concierge service that is only a phone call away should you require any assistance at any point during your trip.

3 FINEST GUIDES

We operate three ranger training schools and are renowned for having the most highly trained, professional and knowledgeable guides, rangers, naturalists and trackers, who offer intriguing cultural insights as well as interpretive wildlife experiences.

4 TRAVEL EXPERTS

Big or small, we are all about tailoring trips around your specific interests and expectations. Our expert travel specialists are able to personalise a range of experiences for individual travellers, groups, families, wedding parties and special interest groups.

5 PERFECT MOMENTS

With journeys lovingly crafted from perfect moments, you will return from an &Beyond adventure feeling that nothing will take your breath away quite like this ever again. Our collection of signature experiences is often exclusive to &Beyond, ensuring a unique adventure.

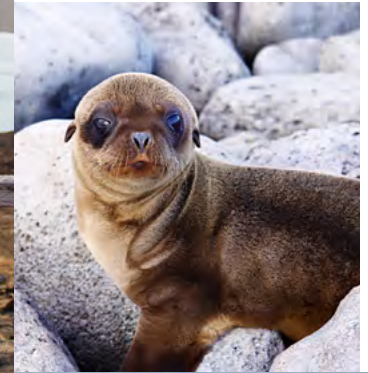

DISCOVER THE GALAPAGOS ISLANDS

Travel to the Galapagos and beyond

Travelling to the Galapagos Islands requires careful consideration and attention to detail. Contact your preferred Travel Specialist to assist with your travel plans.



GETTING TO THE GALAPAGOS ISLANDS

The traditional gateway to the Galapagos Islands is through Ecuador, specifically the cities of Quito and Guayaquil. International flights typically arrive at Mariscal Sucre International Airport in Quito or José Joaquín de Olmedo International Airport in Guayaquil.

There are two main airports in the Galapagos Islands: Seymour Airport on Baltra Island and San Cristóbal Airport on San Cristóbal Island. Most international flights from the mainland arrive at Baltra Island.

After arriving in Ecuador, you'll need to book a domestic flight from either Quito or Guayaquil to the Galapagos. Several airlines operate flights to the islands, and it's advisable to book through &Beyond or your preferred Travel Specialist.

Once you land in the Galapagos, you'll immediately sense the unique environment and conservation efforts that are in place. From the airport, transportation and accommodation to your chosen island will be arranged with your Travel Specialist.

ACCESS TO THE &BEYOND GALAPAGOS EXPLORER

Scheduled flights to Seymour Airport on Baltra Island, followed by land transportation to Baltra Harbour.

Panga boat ride to the &Beyond Galapagos Explorer yacht.

TRAVEL TIMES

QUITO

✈️	7hrs 50mins (439 km)	GUAYAQUIL
	0hrs 53mins	
✈️	Not possible	GALAPAGOS
	2hrs 30mins	
	Not possible	
	1hr 59mins	

Disclaimer: All flights may include multiple stops, and scheduling is a guideline. Times will vary. Above times are based on best-practice logistics.

DISCOVER THE GALAPAGOS ISLANDS

Regional information

Altitude	Sea level
Geography	The Galapagos Islands are a volcanic archipelago in the Pacific Ocean, consisting of approximately 18 main islands, three smaller islands, and 107 rocks and islets. The islands are of volcanic origin, with diverse landscapes ranging from lava fields and volcanic craters to lush highlands and pristine beaches
Airport	There are two major airports: Seymour Airport on Baltra Island and San Cristóbal Airport on San Cristóbal Island
Best time to travel	Year-round
Seasons	Warm season (Wet season): December to June Cool season (Dry season): July to November
Weather	The Galapagos has a subtropical climate, and the weather is influenced by ocean currents. It's important to note that the Galapagos weather is influenced by El Niño and La Niña, which shift sea temperatures and seasonal patterns. Furthermore, each island boasts its own unique microclimate, shaped by its specific elevation and topography
Rainfall	Warm season (Wet season): Occasional, light rainfall with warmer seas, making it the ideal time for snorkelling and swimming Cool season (Dry season): Characterised by a cool, dry mist known as "garúa". The sea is cooler, and there might be stronger currents, but this is also a good time for wildlife observation
Average temperatures	Warm season (Wet season): From 25°C to 31°C (77°F to 88°F) Cool season (Dry season): From 21°C to 27°C (70°F to 80°F)





BEYOND

DISCOVER THE GALAPAGOS ISLANDS

Adventures of a lifetime

Snorkel alongside playful sea lion in turquoise waters, hike through otherworldly lava fields, and witness the balletic dance of blue-footed boobies. This is not just a journey; it's a rendezvous with the extraordinary.

Water experiences

Discover the Galapagos' untamed waters, from above and below. Paddle over the exquisite indigo ocean or dip beneath the surface, swimming among colourful fish.

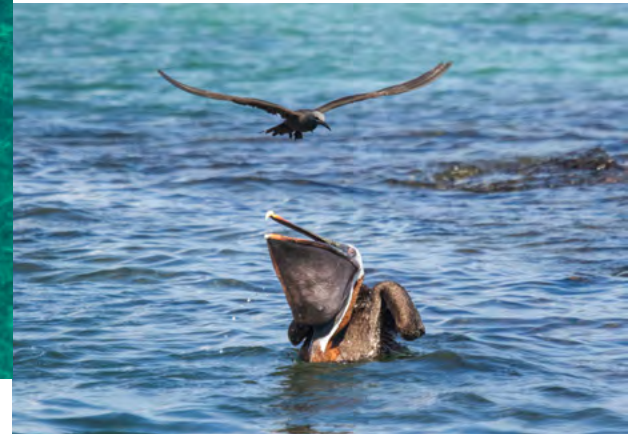
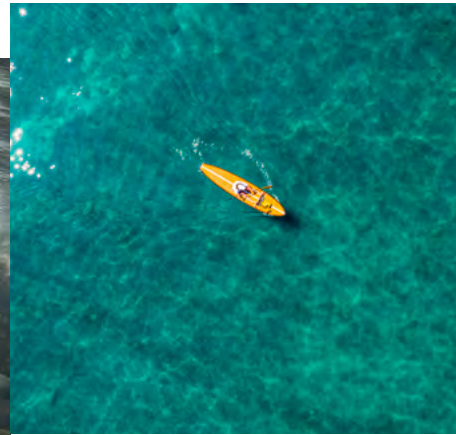

1

SNORKELLING

Imagine drifting over a volcanic sea floor, only to discover the colourful aquatic life illuminated in the crystal-clear water below. At once you are transported to the underwater world where penguins frolic, turtles glide, iguanas forage, and myriad vibrant tropical fish dart about the aqua expanse.

2

SEA KAYAKING

Teeming with land and marine wildlife, the Galapagos is a sea kayaker's utopia. Set to your pace, you decide how you wish to explore these pristine waters, with the islands' remarkable scenery offering the ideal backdrop. As you paddle through the exquisite azure ocean, relax into your magnificent personal aquatic, wildlife show. The opening act dramatically presents Galapagos penguin, sea lion, blue-footed and Nazca boobies, pelican, and marine iguana, to name only a few.

DISCOVER THE GALAPAGOS ISLANDS

Adventures of a Lifetime

Land experiences

Summit active volcanoes, traverse magnificent landscapes and photograph iconic land animals. Visit the Charles Darwin Research Centre and learn about the islands' unique ecology.



1

HIKING

With an abundance of flora and fauna to explore and diverse terrains to traverse, the Galapagos Islands offer hikers, of all levels, countless outdoor adventures good for the heart and soul. Breathe deeply, taking in the fresh, salty sea air, as you navigate the rugged landscape, climbing over rocky shorelines, trekking through unique landscapes and meandering across pristine beaches.



2

WILDLIFE WATCHING

The volcanic archipelago is known for its unusual wildlife, much of which is endemic, owing to its isolated terrain. Observe some of the Galapagos' most incredible species such as the giant tortoise, land iguana, blue-footed boobies, and frigatebirds in their natural habitat.



3

ISLAND TOURS

Island tours in the Galapagos Islands, also known as land-based tours, offer intrepid travellers a unique way of unveiling the magic of each enchanted island. Explore the various islands to witness their distinct ecosystems, landscapes, and wildlife.



4

BIRDWATCHING

Avid birders will delight in their search for the region's approximately 45 unique bird species. Found nowhere else in the world, spot species like the Galapagos penguin and Darwin's finch, not to forget other interesting birds, including the flightless cormorant, Galapagos waved albatross and blue and red-footed boobies.



5

PHOTOGRAPHY

The Galapagos is a visual feast. Everywhere you look a captivating blend of awe-inspiring landscapes and iconic wildlife awaits. Unlike traditional wildlife photography, you'll often have close encounters, allowing for unique captures without needing extensive telephoto lenses.



6

EDUCATIONAL TOURS

Visit research and conservation centres to learn more about ongoing efforts to preserve the islands' unique ecosystems. Sharing the history and settlement of the Galapagos, enjoy exhibitions on natural and human history, conservation as well as old photographs of the region. Learn about the islands' volcanic origin, its ocean's currents, the special climate, and the arrival of its unusual species.

DISCOVER THE GALAPAGOS ISLANDS
Adventures of a Lifetime

Year-round activities

The Galapagos is an exceptional year-round destination, with a wide range of unforgettable experiences available.

- ✓ Snorkelling*
- ✓ Sea kayaking*
- ✓ Hiking*
- ✓ Wildlife watching
- ✓ Island tours
- ✓ Birdwatching
- ✓ Photography
- ✓ Educational tours
- ✓ Beach relaxing*

**These activities are weather dependent*





&BEYOND

DISCOVER THE GALAPAGOS ISLANDS

&Beyond Galapagos Explorer

An intimate 38 m (124 ft) expedition yacht designed to exclusively navigate the Galapagos Islands in ultimate luxury.



DISCOVER THE GALAPAGOS ISLANDS
Beyond Galapagos Explorer

Why stay?

1 OTHERWORLDLY LOCATION
Celebrated for its unique wildlife and natural wonders, many found nowhere else on earth, the Galapagos is recognised as one of the world's most biodiverse places and was declared a UNESCO World Heritage Site in 1978.

2 UNRIVALLED EXPERIENCES
Snorkel alongside playful sea lion and penguin, witness the timeless dance of giant tortoises, and explore pristine volcanic landscapes. Each island presents a unique experience, from the vibrant marine life of Española to the dramatic vistas of Bartolomé.

3 COMPLETE EXCLUSIVITY
Revel in personalised luxury, where intimate spaces and attentive service redefine superyacht sailing standards. With only 12 guests on board the Galapagos Explorer, with an elevated crew-to-guest ratio, expect an ocean voyage tailored to your interests, marked by genuine care.

4 BEYOND LUXURIOUS CUISINE
Our food philosophy is simple: delicious, well-balanced meals that surprise and delight. Our skilled chefs are able to create an array of dishes, ensuring your culinary experience is tailored to your preferences.

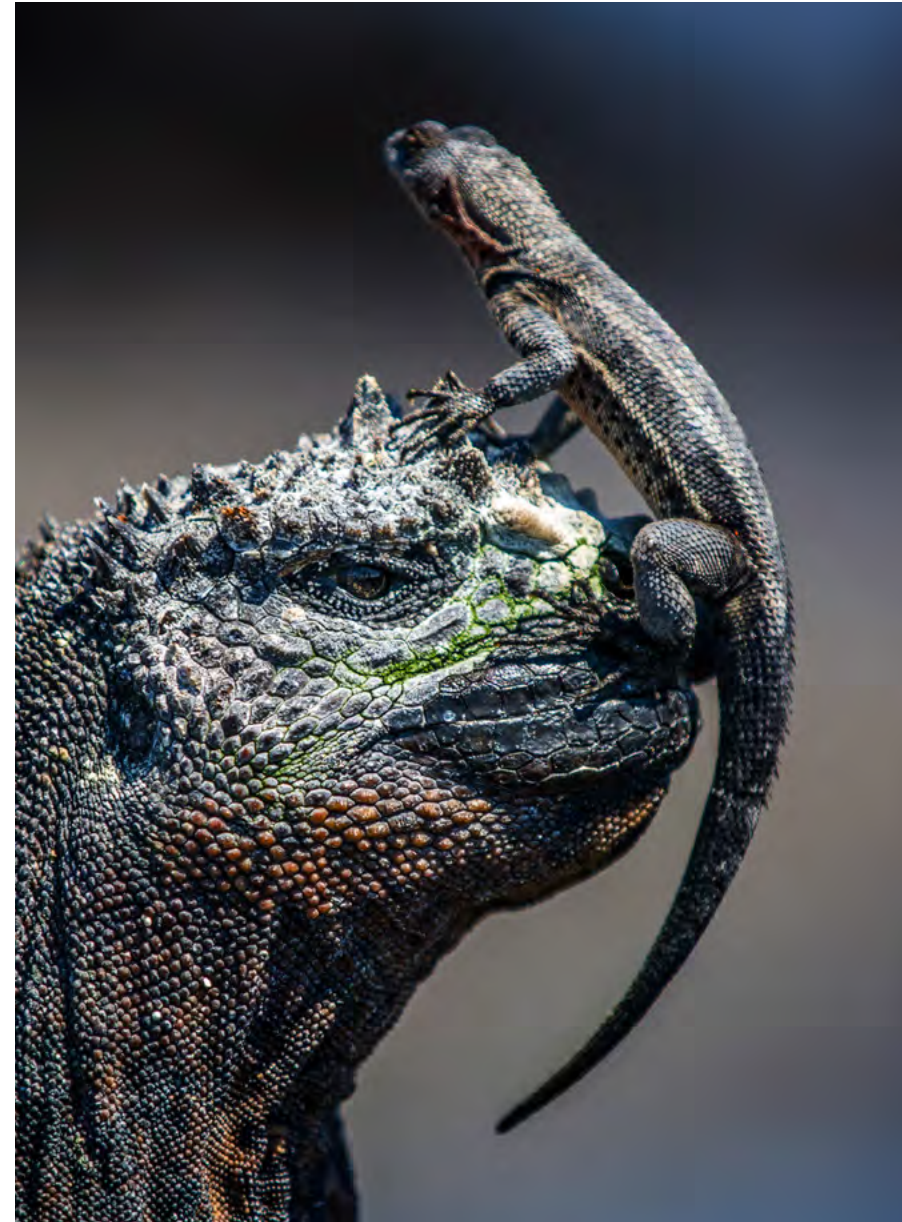

DISCOVER THE GALAPAGOS ISLANDS
 Beyond Galapagos Explorer

Preserving the spirit of adventure

Centuries of maritime history have woven a tapestry of tales around the Galapagos Islands' remote waters. Sailors stumbled upon its secluded shores, pirates hid in its secret coves, and scientists studied its unusual plants and animals. Our luxury expedition yacht, the Galapagos Explorer, also has a story to tell.

Back in 1987, she was built for a private individual by Picchiotti Yachts, an Italian family business with a rich shipbuilding history spanning over four centuries since its founding in 1575. The Galapagos Explorer spent 25 years cruising the Mediterranean and Caribbean before she was brought to Fort Lauderdale in 2013 and sold to the former owners. In 2014, she was deployed to sail in the Galapagos as the islands' very first charter yacht, named *Stella Maris*. In 2024, she became part of the Beyond family.

Over her years of service, she has undergone several refurbishments, the most recent under the care of Beyond. Working with a local Ecuadorian designer, we created a contemporary space mixing local aesthetics with her European heritage. Drawing inspiration from the Galapagos, the interiors feature natural materials and marine tones. Intricately carved wooden miniatures of traditional local canoes, indigenous textiles, and historic oars are just some of the many distinctive pieces found on board.

The Galapagos Explorer also stands out for her technical advancements, which are scarce in these waters. Stabilisers make for a smoother voyage, bow thrusters for agile navigation, and a swim deck for easier embarking and disembarking. Every feature has been considered to provide guests with even more comfort and convenience. Securing the Galapagos Explorer as our first flagship vessel is a milestone achievement for Beyond.

Since we began operating in the Galapagos in 2016, we have been searching for the perfect vessel. Finally, we have found it in this exclusive 38 m (124 ft) yacht.

Being one of the select few boats permitted to operate in this region is a true privilege. Our presence here is not just about exploration, but also supporting conservation efforts and community initiatives. As you step on board this yacht, we invite you to unveil the region's natural beauty, diverse wildlife and fascinating history firsthand.

THE HMS BEAGLE

was a Cherokee-class 10-gun naval brig-sloop. For Darwin's voyage, she was adapted to a 3-masted barque sail plan which was cheaper and easier for a smaller crew to operate.

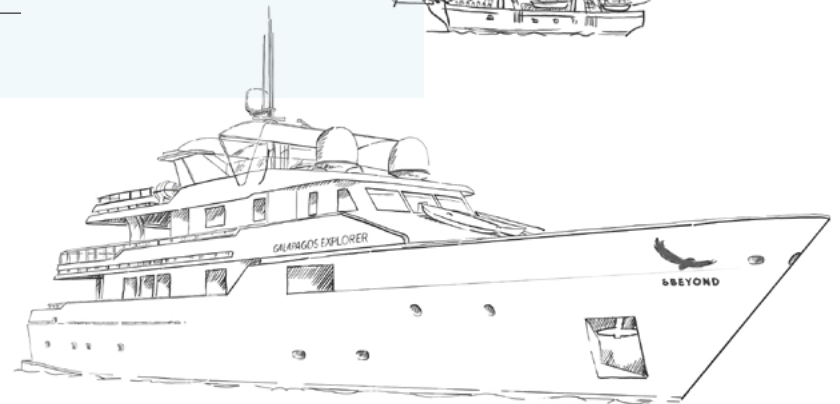
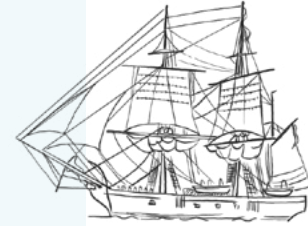

HMS BEAGLE

GALAPAGOS EXPLORER

BUILT	by Woolwich Dockyard in 1820	by Picchiotti in 1987
LENGTH	27.5 m 90 ft	37.8 m 124 ft
BEAM (WIDTH)	7 m 23 ft	7.6 m 25 ft
TONNAGE	235 tonnes	317 tonnes
POWER	3 Masted barque sail plan Square-rigged main mast Fore-and-aft rigged mizzen mast	2 Caterpillar 3412 turbo diesel engines 625 HP with 27 litre displacement
SPEED	6 knots	13 knots
CREW	65	13
GUESTS	9 (including Charles Darwin)	12 (including you)

DISCOVER THE GALAPAGOS ISLANDS
Beyond Galapagos Explorer

Yacht amenities

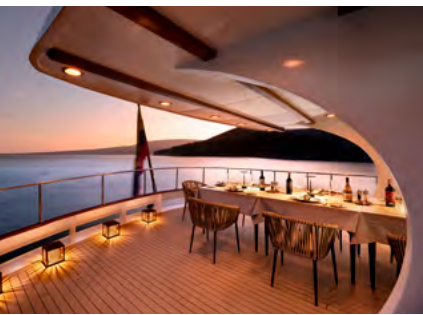

1

OUTDOOR DINING

Savour your meals in a variety of settings, like the yacht's open-air dining deck. Each dish is thoughtfully prepared and best enjoyed beneath the stars.

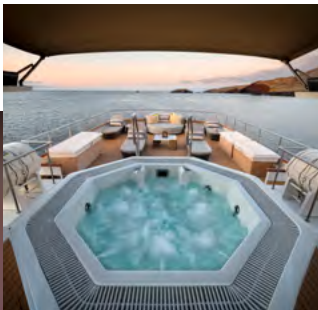

2

HOT TUB AND SUNDECK

The yacht features its own luxurious sundeck, boasting panoramic views. Relax in the soothing hot tub or bask in the warmth of your sun-drenched surroundings on comfortable loungers.

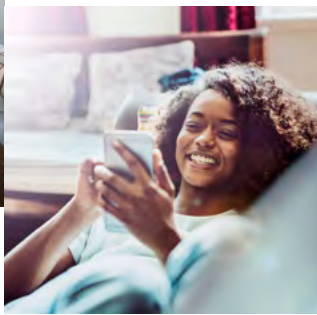

3

HIGH-SPEED WI-FI

While on board, stay fully connected with the outside world with high-speed Wi-Fi coverage throughout the yacht.



4

OCEAN BAR

The yacht's central bar area provides the perfect setting to savour your favourite sundowner while relishing magnificent Galapagos views. Ask our barman to craft our exclusive cocktail of the day for you!



5

EXPERT GUIDES

Revel in a personalised experience with only the best guides and crew members in the Galapagos. With only 12 guests on board, and an elevated crew-to-guest ratio, expect an intimate guest experience throughout your journey.



6

GASTRONOMIC DELIGHT

Our expert chefs combine creativity with wholesome ingredients, transforming every meal into a culinary adventure. Every meal is prepared and presented with passion, unveiling unique flavour profiles and unexpected pairings, bringing joy to the table.

DISCOVER THE GALAPAGOS ISLANDS

Beyond Galapagos Explorer

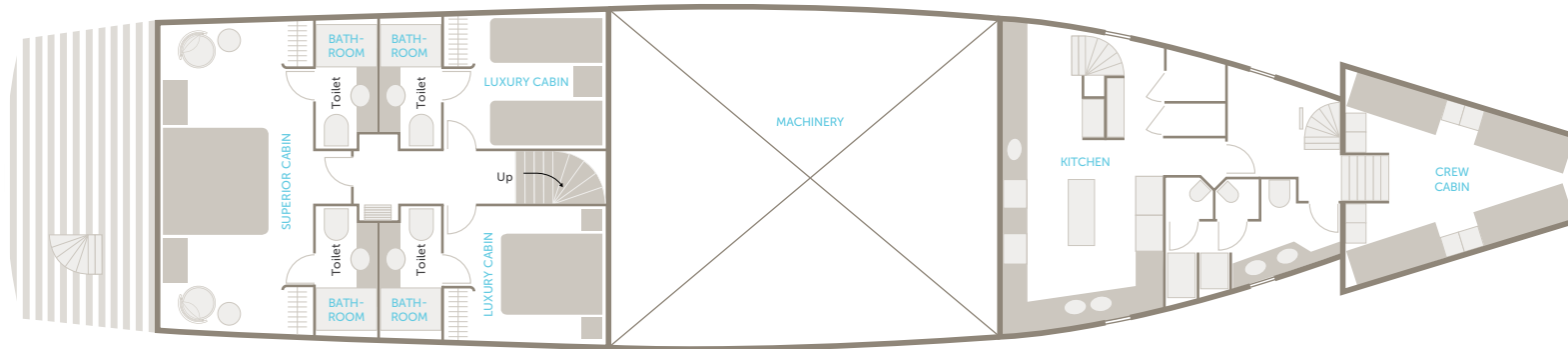

LOWER DECK

The yacht's lower deck (Deck 1) features two Luxury Cabins and one Superior Cabin, along with the crew members' quarters.

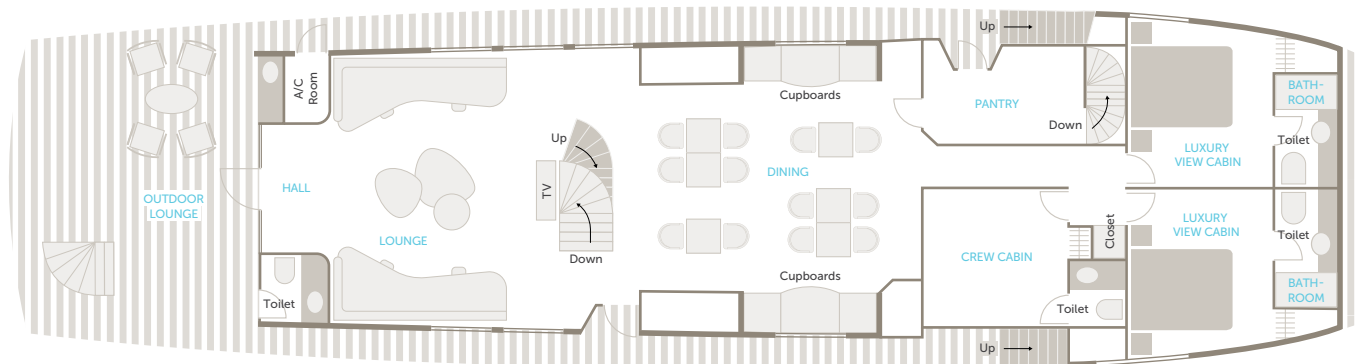

MIDDLE DECK

The yacht's middle deck (Deck 2) includes two Luxury View Cabins plus an indoor guest dining and lounge area inviting you to unwind in style. An outdoor, shaded lounge area also offers the perfect spot for whiling away the afternoon before enjoying an evening sundowner.

DISCOVER THE GALAPAGOS ISLANDS
&Beyond Galapagos Explorer

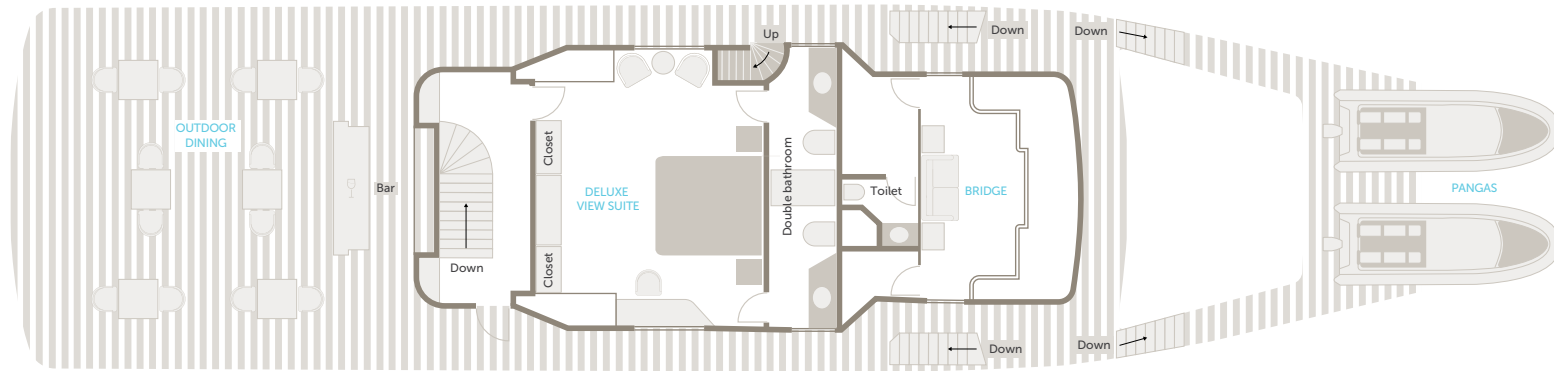

UPPER DECK AND SUNDECK

The upper deck (Deck 3) boasts the yacht's magnificent Deluxe View Suite along with the yacht's bridge plus a spacious al fresco deck, bar, and guest dining area. To round off the experience, the sundeck, located on the yacht's uppermost level, provides an exclusive haven with comfortable sun loungers, a hot tub, and panoramic vistas.

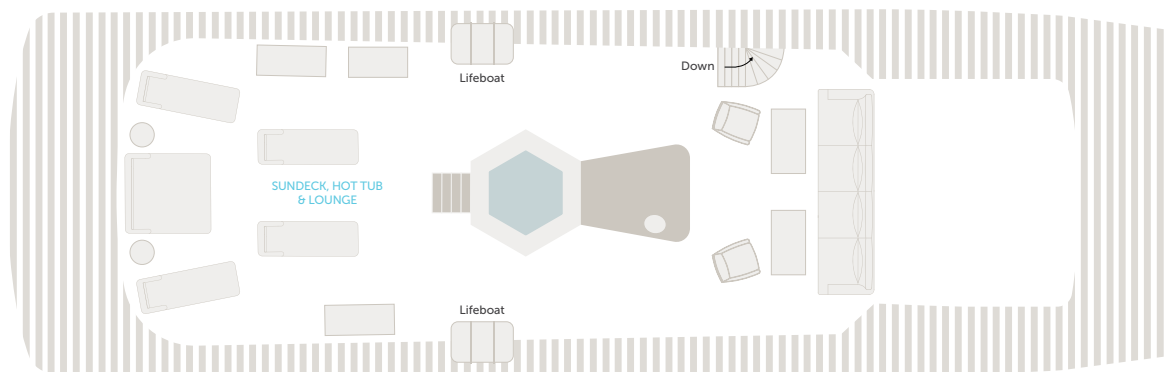

DISCOVER THE GALAPAGOS ISLANDS
 Beyond Galapagos Explorer

Yacht overview

YACHT

Maximum number of guests	13
Number of rooms	6
Room types	Cabins and Suites
Family accommodation	Children 12 years and older 1 Triple option per cruise
WILDchild programme	No
Child policy	Children aged 12 years and older are welcome (7 years and older welcome on charters) Children aged 12 – 16 years sharing with one or two adults receive a 20% discount off the adult rate Children aged 12 – 16 years sharing a cabin – first child pays adult rate, second child receives a 20% discount An additional bed (for a child aged 12 – 16 years) may be added to the Superior Cabin (max. 1 triple per cruise)
Pilot / Guide accommodation	No
Check-in and check-out times	14h00 / 11h00, with early check-in and late check-out on request
Private charters	Available on request
Chartering (for exclusive use)	Available on request
Yacht closure	Closed during September – alternating between 2 or 4 weeks, starting with 2 weeks in September 2025

FACILITIES

Internet access	Yes (via Starlink)
Outdoor dining	Yes
Bar	Yes
Hot tub	Yes
Sundeck	Yes
Wheelchair accessibility	No
Laundry	No
Beyond Signature Shop	Yes

DINING

Food / Dietary options	Halal and kosher food not available
Plated service	Yes

PAYMENT TYPES ACCEPTED

Credit cards	Yes
Currency	All major currencies accepted

DISCOVER THE GALAPAGOS ISLANDS
8Beyond Galapagos Explorer

Inclusions

RATE INCLUDES

Accommodation	✓
Three meals daily	✓
Soft drinks, house wines, local brand spirits and beers, teas and coffees, and refreshments on excursions	✓
All excursions including panga boat rides, hikes, island visits, beach walks, visit to the Charles Darwin Research Station, sea kayaking and snorkelling (included snorkelling gear: short wetsuit, mask, snorkel and fins)	✓
Guides' Journal with illustrations of fauna and flora to record your sightings	✓
Area map with illustrated Star Birds checklist	✓
Emergency medical evacuation insurance	✓
VAT	✓
VIP Lounge at the Galapagos' airports, road transfers to and from Seymour Airport on Baltra Island	✓
Internet (via Starlink)	✓

RATE EXCLUDES

Administration fee	✗
Telephone calls	✗
All items of a personal nature	✗
Flights to and from the Galapagos Islands	✗
Gratuities	✗
Champagne, cognacs, fine wines, premium brand spirits and cigars	✗
Landing fees	✗
Travel insurance	✗
Park fees	✗
Migratory card	✗
Signature Shop purchases	✗

NOTE: The use of Unmanned Aerial Vehicles (drones) and Manned or Unmanned Submersibles (underwater vehicles) is not permitted on board the 8Beyond Galapagos Explorer or in the Galapagos Islands.





8BEYOND



8BEYOND GALAPAGOS EXPLORER

Accommodation

DISCOVER THE GALAPAGOS ISLANDS
Beyond Galapagos Explorer Accommodation

LUXURY CABIN

2 Luxury Cabins / Max. 2 guests per Cabin



OCEAN ELEGANCE
Situated on the yacht's lower deck (Deck 1), two private Luxury Cabins are available on either the Port or Starboard side. Each air conditioned cabin is equipped with an intimate ensuite bathroom, featuring a luxurious shower and single vanity. Thoughtfully placed portholes provide captivating views of the Pacific Ocean and the Galapagos Islands beyond.

ROOM FACILITIES

Cabin size	Approx. 12.5 m ² (134 ft ²)
Starboard and Port side options	Yes
Portholes	Yes
Air conditioning / heating	Yes
Bath	No
Indoor shower	Yes
Separate WC	Yes, separate flushing WC
Telephone	Yes
Hairdryer	Yes
Internet access	Yes (via Starlink)
In-room safe	Yes
Triple bed option	No
Twin bed option	Yes, only in the port-side cabin
Double bed option	Yes
Wheelchair accessibility	No

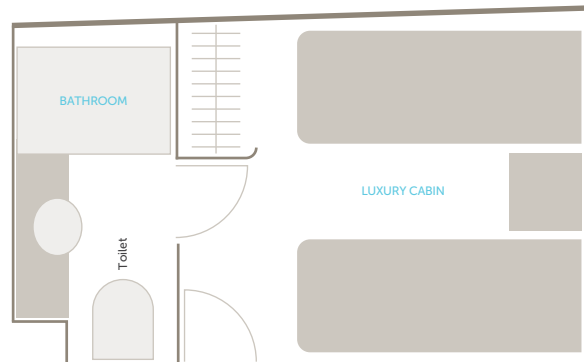
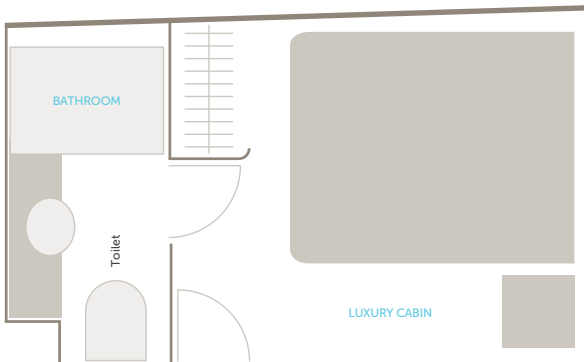

Ideal for families sharing

DISCOVER THE GALAPAGOS ISLANDS
 Beyond Galapagos Explorer Accommodation

LUXURY VIEW CABIN

2 Luxury View Cabins / Max. 2 guests per Cabin



STYLISH SAILING

On the yacht's middle deck (Deck 2) there are two private Luxury View Cabins, one on the Port side and the other on the Starboard. Windows offer sweeping views of the Pacific Ocean, providing an unparalleled vantage point to appreciate the beauty of the islands. Each air conditioned cabin also features an intimate ensuite bathroom, complete with a decadent shower and single vanity.

ROOM FACILITIES

Cabin size	Approx. 14 m ² (151 ft ²)
Starboard and Port side options	Yes
Windows	Yes
Air conditioning / heating	Yes
Bath	No
Indoor shower	Yes
Separate WC	Yes, separate flushing WC
Telephone	Yes
Hairdryer	Yes
Internet access	Yes (via Starlink)
In-room safe	Yes
Triple bed option	No
Twin bed option	No
Double bed option	Yes
Wheelchair accessibility	No

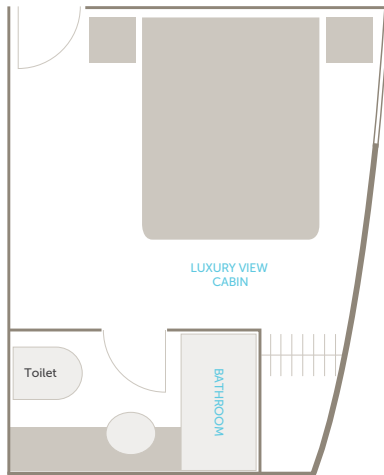

DISCOVER THE GALAPAGOS ISLANDS
Beyond Galapagos Explorer Accommodation

SUPERIOR CABIN

1 Superior Cabin / Max. 3 guests per Cabin



SPACIOUS SEASIDE SUPERIORITY

Located on the lower deck (Deck 1), our Superior Cabin radiates sophistication. This expansive, air conditioned suite features two private ensuite bathrooms, thoughtfully designed with lavish showers and single vanities. Carefully positioned portholes provide striking glimpses of the Pacific Ocean and Galapagos Islands. Wooden accents, neutral colours, and elegant surfaces harmonise to create an inviting and refined atmosphere.

ROOM FACILITIES

Cabin size	Approx. 27 m ² (291 ft ²)
Portholes	Yes
Air conditioning / heating	Yes
Bath	No
Indoor shower	Yes
Separate WC	Yes, separate flushing WC
Telephone	Yes
Hairdryer	Yes
Internet access	Yes (via Starlink)
In-room safe	Yes
Triple bed option	Yes
Twin bed option	Yes
Double bed option	Yes
Wheelchair accessibility	No

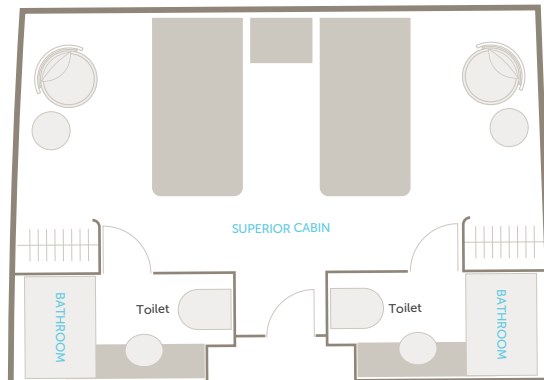
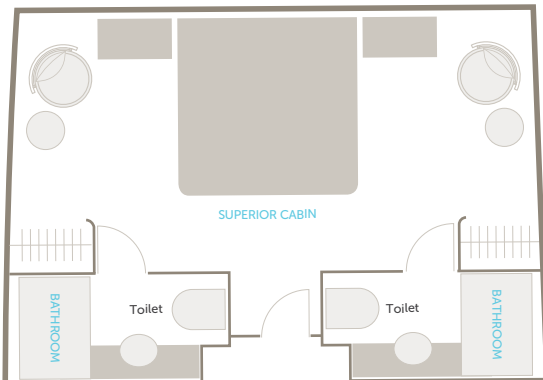

Ideal for families sharing

DISCOVER THE GALAPAGOS ISLANDS
 Beyond Galapagos Explorer Accommodation

DELUXE VIEW SUITE

1 Deluxe View Suite / Max. 2 guests per Suite



EXCLUSIVE EXTRAVAGANT RETREAT

Positioned on the upper deck (Deck 3), our Deluxe View Suite offers a unique and intimate experience. Expansive, unobstructed windows showcase breathtaking views of the Galapagos Islands, where the vibrant hues of the surrounding Pacific Ocean come to life. This roomy, air conditioned suite boasts a double ensuite bathroom, equipped with a luxurious shower and single vanities.

ROOM FACILITIES

Suite size	Approx. 32 m ² (344 ft ²)
Windows	Yes
Air conditioning / heating	Yes
Bath	No
Indoor shower	Yes
Separate WC	Yes, separate flushing WC
Telephone	Yes
Hairdryer	Yes
Internet access	Yes (via Starlink)
In-room safe	Yes
Twin bed option	No
Double bed option	Yes
Wheelchair accessibility	No

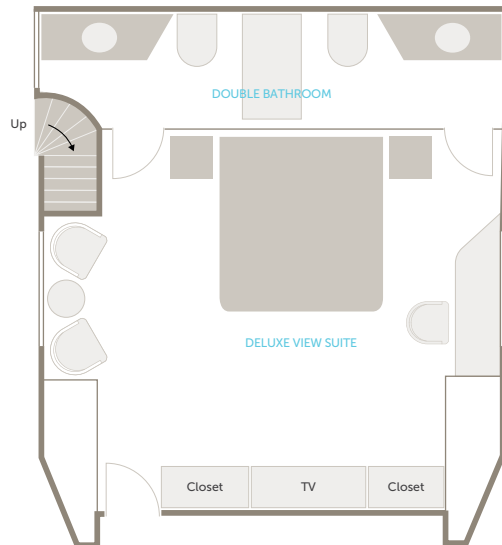

DISCOVER THE GALAPAGOS ISLANDS

Beyond Galapagos Explorer Accommodation

Accommodation comparison

	LUXURY CABIN	LUXURY VIEW CABIN	SUPERIOR CABIN	DELUXE VIEW SUITE
Number of rooms	2	2	1	1
Room size (square metres)	Approx. 12.5 m ² (134 ft ²)	Approx. 14 m ² (151 ft ²)	Approx. 27 m ² (291 ft ²)	Approx. 32 m ² (344 ft ²)
Port or Starboard options	Yes	Yes	Portholes facing both sides	Windows facing both sides
Deck level	Deck 1	Deck 2	Deck 1	Deck 3
Windows	No	Yes	No	Yes
Portholes	Yes	No	Yes	No
Air conditioning / heating	Yes	Yes	Yes	Yes
Ensuite bathroom	Yes	Yes	Yes, two	Yes, two
Bath	No	No	No	No
Indoor shower	Yes	Yes	Yes	Yes
Separate WC	Yes, separate flushing WC	Yes, separate flushing WC	Yes, separate flushing WC	Yes, separate flushing WC
Telephone	Yes	Yes	Yes	Yes
Hairdryer	Yes	Yes	Yes	Yes
Internet access	Yes	Yes	Yes	Yes
In-room safe	Yes	Yes	Yes	Yes
Triple bed option	No	No	Yes	No
Twin bed option	Yes, only in the port-side cabin	No	Yes	No
Double bed option	Yes	Yes	Yes	Yes
Wheelchair accessibility	No	No	No	No



GBEYOND

DISCOVER THE GALAPAGOS ISLANDS

Set departure journeys

There are two set-departure 7-night itineraries to choose from, providing you with the opportunity to explore either the eastern or western islands of the Galapagos.

DISCOVER THE GALAPAGOS ISLANDS

Set Departure Journeys

DAY 03

Iconic birdlife

ESPAÑOLA

MORNING: Gardner Bay: Bask in the sunshine on pristine sandy white beaches observing large bird colonies, sea lion and Española lava lizards or discover the vibrant underwater world swimming with sea turtles, pufferfish, and Galapagos grunts. Weather permitting, Gardner Bay also boasts exceptional kayaking.

AFTERNOON: Suarez Point: This rocky land offers one of the most beautiful walks in the Galapagos, with plenty of close-up wildlife opportunities with marine iguanas, sea lions and swallow-tailed gulls. It's also the only known breeding site for the critically endangered waved albatross. Keep an eye out for the large blowhole which can spray ocean water up to 15 – 23 m (50 – 75 ft) in the air.

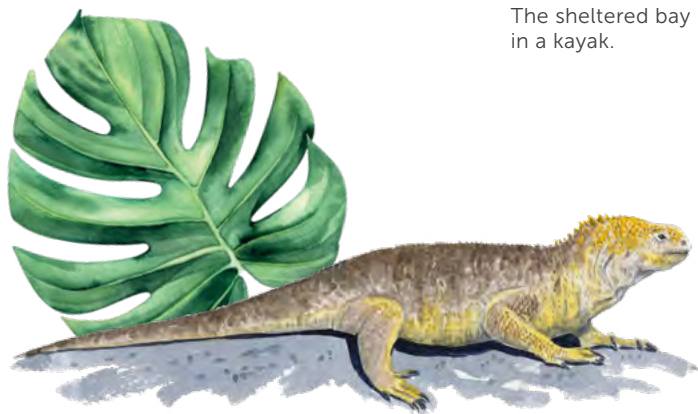

DAY 04

Beautiful beaches

FLOREANA

MORNING: Cormorant Point: With only 350 known pairs left in the Galapagos, this is one of the best places to see these vibrant creatures, also known as the pinkest flamingo on earth. Other inhabitants to look for are Floreana lava lizards, finches and flycatchers.

Champion Islet: Underwater, explore one of the best snorkelling sites. Above the surface, ride in a panga boat for your best chance of seeing the endangered Floreana mockingbird.

AFTERNOON: Post Office Bay: In the 18th century, sailors passing through the islands placed a wooden barrel on this island to use as an unofficial mailbox. Known as Post Office Bay today, the tradition continues as travellers leave addressed postcards in the barrel and sort through mail to deliver at home. The sheltered bay is also a fantastic area to explore in a kayak.



DAY 05

Tortoises and twins

SANTA CRUZ

MORNING: The Highlands: Begin your day at El Chato Ranch Private Reserve, where you'll be able to see the Galapagos giant tortoise. Next, stroll through the Highland's lush forests, where numerous finch varieties can be spotted. If there's enough time, you'll also explore 'Los Gemelos' (Twin Craters), two collapsed calderas surrounded by a distinctive Scalesia forest.

AFTERNOON: Charles Darwin Research Station: See conservation in action at the research station, an active breeding site for giant tortoises. After this, use your free time to explore the town, experiencing the local culture first-hand. This is also the perfect opportunity to relax on board the Galapagos Explorer.

DISCOVER THE GALAPAGOS ISLANDS

Set Departure Journeys

DAY 06

Rocky summits

SANTA CRUZ | BARTOLOMÉ

MORNING: **Dragon Hill:** This rocky, low-lying hill is home to an impressive population of Galapagos land iguana. These miniature dragons roam around the sun-scorched, boulder-strewn island, enjoying the fruits and flowers of their favourite food, the prickly pear. The trail also guides you through other endemic vegetation, like the palo santo tree, letter leaf tree and Galapagos cotton. Along the way, keep an eye out for finches, yellow warblers and flycatchers.

AFTERNOON: **Pinnacle Rock:** Exactly 375 steps lead you to the summit of an extinct volcano, boasting some of the best views in the Galapagos. Later, enjoy a panga boat ride along the coast in search of the Galapagos penguin and snorkel with parrotfish, sergeant majors, starfish and stingrays.



DAY 07

Birdwatchers' paradise

GENOVESA

MORNING: **Darwin Bay:** Here you'll find 70 000 pairs of nesting red-footed boobies – the largest colony on earth. Along the walking trail, also look out for swallow-tailed gulls, the only nocturnal gull species in the world. Other notable fauna and flora include sea lions, the yellow-crowned night heron, and the lava morning glory plant. Darwin Bay is also the only place to see the sharp-beaked ground finch. Ocean swims, kayaking and panga boat rides are also available.

AFTERNOON: **Prince Philip's Steps:** A steep but short climb leads you onto a flat, dried lava field where you can spot colonies of red-footed boobies, Nazca boobies, great frigatebirds and wedge-rumped storm petrels that nest under the rocks. This is also your best chance to glimpse the shy, short-eared owl.

DAY 08

Departure

DAPHNE MAJOR

MORNING: Your final sail takes you around Daphne Major, an extinct volcanic tuff cone. Nazca boobies, red-billed tropicbirds, and blue-footed boobies can be found nesting here. Daphne Major is also the primary site of Peter and Rosemary Grant's iconic 40-year study of evolution in Darwin's finches that demonstrates evolution occurring over short periods of time. Nearly all of the finches on the island are banded for observation.

Thereafter, it is time to wave a fond farewell to the Galapagos Explorer as you head to Seymour Airport on Baltra Island for your onward flight.

DISCOVER THE GALAPAGOS ISLANDS
Set Departure Journeys

Wildlife highlights in the east

The Galapagos is a year-round wildlife destination, with the endangered waved albatross just one of the highlights.

	BLUE-FOOTED BOOBY	RED-FOOTED BOOBY	NAZCA BOOBY	FRIGATEBIRD	WAVED ALBATROSS	GALAPAGOS PENGUIN	DARWIN'S FINCH	LAND IGUANA	MARINE IGUANA	GIANT TORTOISE	SEA LION	GALAPAGOS HAWK	ESPAÑOLA MOCKINGBIRD	SEA TURTLE	AMERICAN FLAMINGO
Baltra			✓	✓			✓				✓			✓	
North Seymour	✓		✓	✓			✓	✓	✓		✓			✓	
San Cristóbal	✓	✓	✓	✓			✓			✓	✓			✓	
Kicker Rock	✓			✓			✓				✓			✓	
Española	✓		✓	✓	Apr to Dec only (breeding season)		✓		✓		✓	✓	✓	✓	
Floreana	✓			✓		✓	✓				✓			✓	✓
Santa Cruz	✓			✓			✓	✓		✓	✓			✓	✓
Bartolomé	✓			✓		✓	✓		✓		✓	✓		✓	
Genovesa		✓	✓	✓			✓		✓		✓			✓	
Daphne Major	✓		✓	✓			✓				✓	✓		✓	

DISCOVER THE GALAPAGOS ISLANDS
Set Departure Journeys

East itinerary 2026 departure dates

Our east-bound 7-night itinerary sets course every two weeks, departing from Baltra Island.

EMBARK (IN)	DISEMBARK (OUT)
12 January	19 January
26 January	02 February
09 February	16 February
23 February	02 March
09 March	16 March
23 March	30 March
06 April	13 April
20 April	27 April
04 May	11 May
18 May	25 May
01 June	08 June
15 June	22 June
29 June	06 June
13 July	20 July
27 July	03 August
10 August	17 August
24 August	31 August
07 September	14 September
02 November	09 November
16 November	23 November
30 November	07 December
14 December	21 December
28 December	04 January 2027



East itinerary 2027 departure dates

EMBARK (IN)	DISEMBARK (OUT)
11 January	18 January
25 January	1 February
8 February	15 February
22 February	1 March
8 March	15 March
22 March	29 March
5 April	12 April
19 April	26 April
3 May	10 May
17 May	24 May
31 May	7 June
14 June	21 June
28 June	5 July
12 July	19 July
26 July	2 August
9 August	16 August
23 August	30 August
6 September	13 September
18 October	25 October
1 November	8 November
15 November	22 November
29 November	6 December
13 December	20 December
27 December	3 January 2028

Our east-bound 7-night itinerary sets course every two weeks, departing from Baltra Island.



DISCOVER THE GALAPAGOS ISLANDS
Set Departure Journeys

BEST OF THE GALAPAGOS

West itinerary



DAY
02

Chinese Hat

SANTIAGO | RABIDA

MORNING: Chinese Hat: This island features a gently sloping volcanic cone that emerges from the ocean, resembling the distinctive shape of an old-fashioned Chinese hat. In the west you can see lava formations topped with coral heads, which are an indicator that the flows were once formed under the sea. Look out for bright red Sally Lightfoot crabs, marine iguanas, lava lizards and sea lions. This is also an excellent snorkeling site.

AFTERNOON: Rabida Island: Celebrated as one of the most colourful and volcanically varied islands in the archipelago, Rabida's famous red sandy beach (the only one in the Galapagos) and stunning lookouts provide unmatched photographic opportunities. The island is also a birdwatcher's delight where some of the region's rarest species are in abundance.

DAY
01

Arrival

SANTA CRUZ

AFTERNOON: Upon arrival at Seymour Airport on Baltra Island, you will be welcomed and transferred to the Galapagos Explorer.

Black Turtle Cove: Only accessible by panga boat, Black Turtle Cove is a mangrove estuary featuring black, red and brown mangroves. Pristine and naturally secluded, the cove is a haven for rare fauna and flora and has been declared a turtle sanctuary. Pangas are required to turn off their motors while visiting, allowing you to truly become immersed in the sights and sounds of your natural surrounds.

DISCOVER THE GALAPAGOS ISLANDS

Set Departure Journeys



DAY
03

Iconic fauna and flora

SANTIAGO

MORNING: James Bay: Walk along the coastline in search of American oystercatchers, lava herons, great blue herons, as well as bright red Sally Lightfoot crabs. Towards the end of the walk, you'll find a beautiful, eroded lava tunnel offering one of the only chances to see the Galapagos fur seal.

AFTERNOON: Espumilla Beach: Enjoy a secluded cove with pristine white sandy beaches, ideal for leisurely walks, swimming, and kayaking.

Buccaneer Cove: Named after the first navigators who used the island as an anchorage place to beach their boats while searching for food or water. Today, the cove is home to a variety of marine birds, sea lions and fur seals. Only accessible by panga boat, look out for pelicans, herons, swallow-tailed gulls, and boobies.

DAY
04

Pristine ecosystems

FERNANDINA

MORNING: Espinosa Point: This is one of the most untouched islands in the Galapagos. No foreign species have ever invaded Fernandina and the unique landscape was created by lava fields of the volcano La Cumbre. Marine iguanas congregate in larger groups than on any other island and this is one of the best chances to see them dive underwater.

AFTERNOON: Tagus Cove: Hike to the top of the cliff to see Darwin Lake, an uplifted ultra-saline lake saltier than the sea. Created from the remains of a tuff cone, Tagus Cove is a secluded bay with calm waters ideal for panga boat rides, kayaking and snorkelling. It also provides close encounters with the Galapagos penguin and other iconic sea birds like the flightless cormorant, Galapagos martin, brown noddy, brown pelican and blue-footed booby.



DAY
05

Myriad marine life

ISABELA

MORNING: Elizabeth Bay: Few have the privilege of exploring this secluded bay, teeming with abundant marine life. Cruise by panga boat into the sheltered mangrove lagoon, where the tallest red mangroves in the Galapagos tower overhead and graceful sea turtles swim to the water's surface.

AFTERNOON: Moreno Point: The main attractions are the coastal lagoons in the middle of black lava flows where several unique bird species can be found. Walk in the lava flows and between the island's three cacti species (lava, candelabra, and prickly pear).

DISCOVER THE GALAPAGOS ISLANDS

Set Departure Journeys

DAY 06

Tortoises and twins

SANTA CRUZ

MORNING: The Highlands: Begin your day at El Chato Ranch Private Reserve, where you'll be able to see the Galapagos giant tortoise. Next, stroll through the Highland's lush forests, where numerous finch varieties can be spotted. If there's enough time, you'll also explore 'Los Gemelos', two collapsed calderas surrounded by a distinctive Scalesia forest.

AFTERNOON: Charles Darwin Research Station: See conservation in action at the research station, an active breeding site for giant tortoises. After this, use your free time to explore the town, experiencing the local culture first-hand. This is also the perfect opportunity to relax on board the Galapagos Explorer.

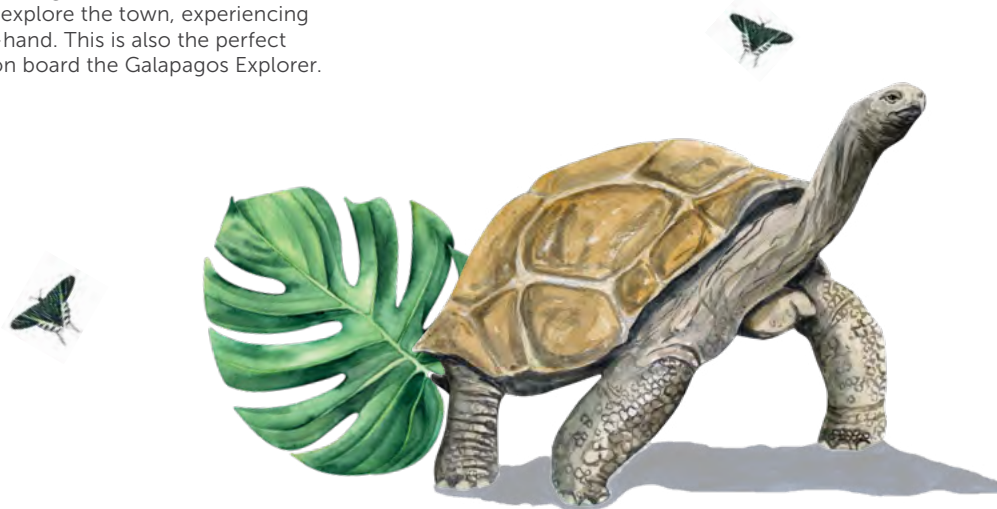

DAY 07

Island hopping

SANTA FE | SOUTH PLAZA

MORNING: Santa Fe: A short walking trail leads you to a large colony of sea lion, afterwards taking you inland to spot the island's endemic land iguana and large prickly pear cactus forest. With some luck, you may even see the rice rat unique to the islands.

AFTERNOON: South Plaza: A distinctive landscape of steep cliffs filled with red Sesuvium plants and Opuntia cacti makes for some of the most interesting wildlife observations available in Galapagos. Land iguanas are easily seen from the walking trail under the shade of cacti waiting for a prickly pear to fall.



DAY 08

Departure

MOSQUERA

MORNING: A small island with white sandy beaches, black lava rocks and turquoise waters, Mosquera Island is the last stop of your Galapagos adventure. Highlights include the island's vibrant colony of Galapagos sea lion, one of the archipelago's largest, and the nesting grounds of the lava gull, the rarest gull species on the planet. Other creatures to look out for include Sally Lightfoot crabs, marine iguanas and pelicans.

Thereafter, it is time to wave a fond farewell to the Galapagos Explorer as you head to Seymour Airport on Baltra Island for your onward flight.

DISCOVER THE GALAPAGOS ISLANDS
Set Departure Journeys

Wildlife highlights in the west

The Galapagos is a year-round wildlife destination, with the rare lava gull just one of the highlights.

	BLUE-FOOTED BOOBY	NAZCA BOOBY	FRIGATEBIRD	GALAPAGOS HAWK	LAVA GULL	GALAPAGOS PENGUIN	DARWIN'S FINCH	FLIGHTLESS CORMORANT	SANTA FE LAND IGUANA	LAND IGUANA	MARINE IGUANA	GIANT TORTOISE	SEA LION	SEA TURTLE	AMERICAN FLAMINGO
Baltra			✓		✓						✓		✓	✓	
Santa Cruz	✓		✓		✓		✓			✓	✓	✓	✓	✓	✓
Sombrero Chino	✓		✓	✓	✓	✓	✓				✓		✓	✓	
Rabida	✓		✓	✓	✓						✓		✓	✓	✓
Santiago	✓	✓	✓	✓	✓		✓			✓	✓	✓	✓	✓	✓
Fernandina	✓		✓	✓	✓	✓	✓	✓		✓	✓		✓	✓	
Isabela	✓	✓	✓	✓	✓	✓	✓	✓		✓	✓	✓	✓	✓	✓
Santa Fe	✓		✓	✓	✓				✓	✓	✓		✓	✓	
South Plaza	✓	✓	✓		✓					✓	✓		✓		
Mosquera	✓		✓		✓						✓		✓	✓	

DISCOVER THE GALAPAGOS ISLANDS
Set Departure Journeys

West itinerary 2026 departure dates

Our west-bound 7-night itinerary sets course every two weeks, departing from Baltra Island.

EMBARK (IN)	DISEMBARK (OUT)
05 January	12 January
19 January	26 January
02 February	09 February
16 February	23 February
02 March	09 March
16 March	23 March
30 March	06 April
27 April	04 May
11 May	18 May
25 May	01 June
08 June	15 June
22 June	29 June
06 July	13 July
20 July	27 July
03 August	10 August
17 August	24 August
31 August	07 September
09 November	16 November
23 November	30 November
07 December	14 December
21 December	28 December

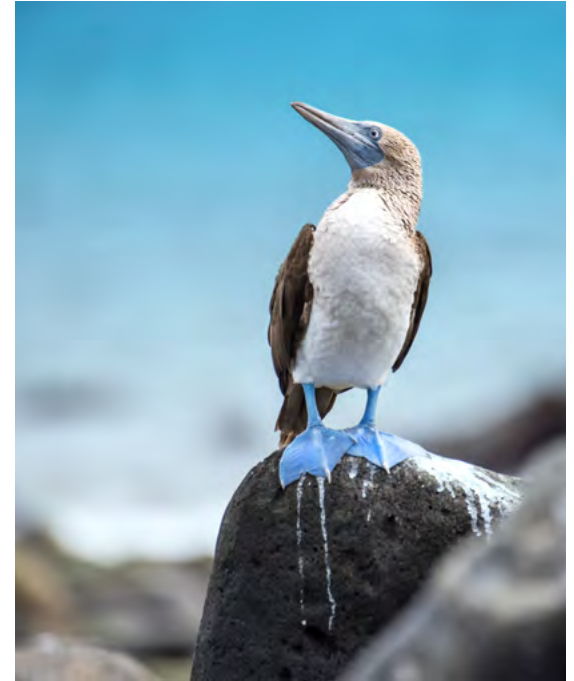

West itinerary 2027 departure dates

EMBARK (IN)	DISEMBARK (OUT)
4 January	11 January
18 January	25 January
1 February	8 February
15 February	22 February
1 March	8 March
15 March	22 March
29 March	5 April
12 April	19 April
26 April	3 May
10 May	17 May
24 May	31 May
7 June	14 June
21 June	28 June
5 July	12 July
19 July	26 July
2 August	9 August
16 August	23 August
30 August	6 September
11 October	18 October
25 October	1 November
8 November	15 November
22 November	29 November
6 December	13 December
20 December	27 December

Our west-bound 7-night itinerary sets course every two weeks, departing from Baltra Island.



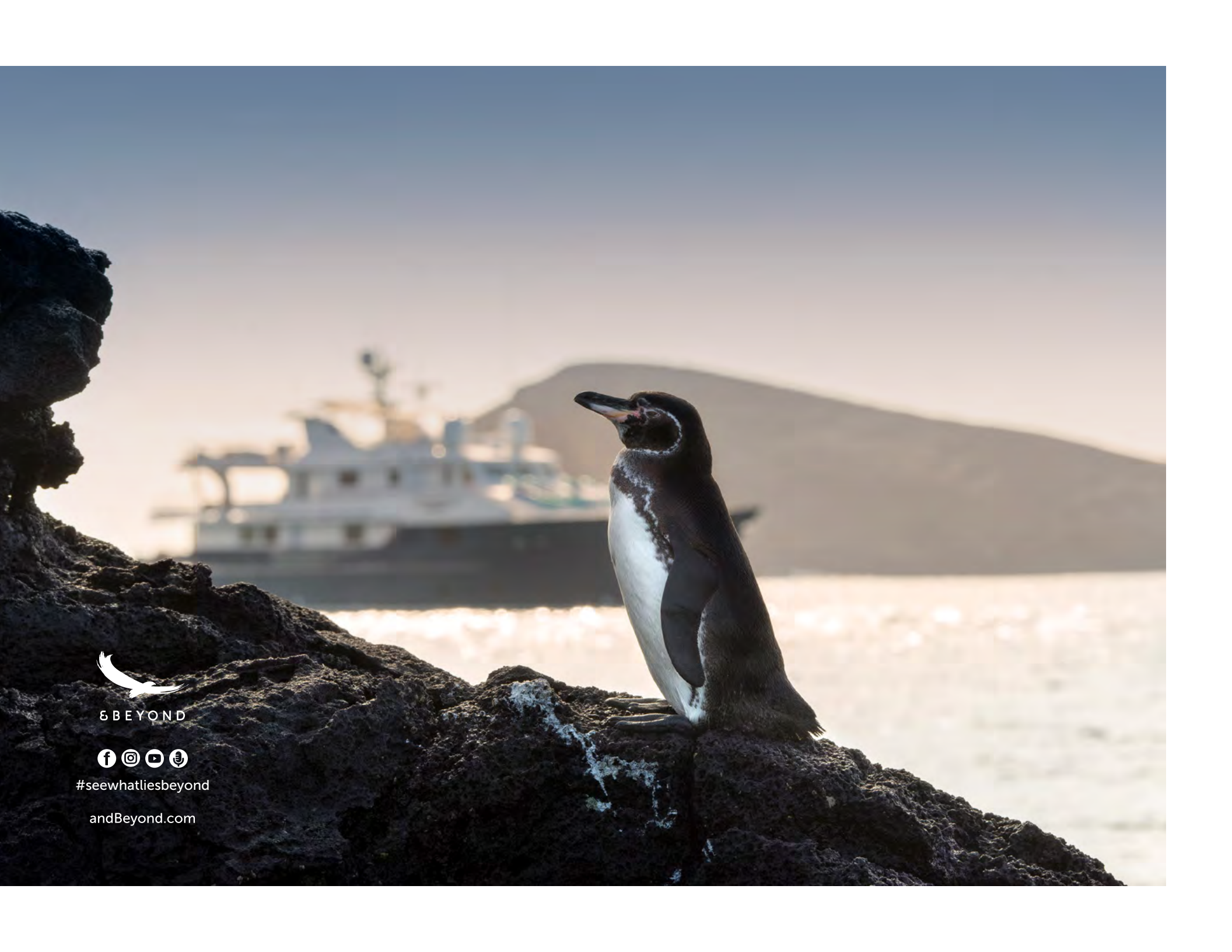

andBEYOND



#seewhatliesbeyond

andBeyond.com