



**NDS**®

We put water in its place

# 2018 Product Catalog

Residential Stormwater Management

Commercial Stormwater Management

Professional Irrigation

Flow Management



**[ndspro.com](http://ndspro.com)**

Your knowledgeable and trusted partner  
for the best in water management solutions

MADE IN  
**USA**



# PROFESSIONAL IRRIGATION

PROFESSIONAL IRRIGATION



Introducing NDS® Professional Irrigation, a line of efficient drip and micro-irrigation products that offers complete, system-oriented watering solutions for the green industry. Product offering includes drip emitters, multi-outlet bubblers, micro-sprays, misters, tubing, fittings, stakes, regulators, valves, and filters.

## POINT OF CONNECTION

### Hose Bib Timer



Part No.	Description	Color	Bag Qty./Box Qty.	Wt. per 100 (lbs.)	Product Class
A 675CT	Battery Hose Bib Timer	Blue	1/10	1.25	21DI

### Universal Conversion Kit & Cap Off

Patented



Part No.	Description	Color	Bag Qty./Box Qty.	Wt. per 100 (lbs.)	Product Class
FR2 17-710	Spray-to-Drip Conversion Kit	Black	1	–	21DI
CAP POP/5	Universal Cap-Off	Black	5	–	21DI
CAP POP/25	Universal Cap-Off	Black	25	–	21DI

### Pressure-Regulating Wye Filter



Part No.	Description	Color	Bag Qty./Box Qty.	Wt. per 100 (lbs.)	Product Class
PRYF 30	Pressure Regulating Filters	Black	1/5	0.25	21DI
PRYF 40	Pressure Regulating Filters	Black	1/5	0.30	21DI

### Control Zone Kits

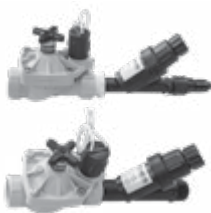

Part No.	Description	Bag Qty./Box Qty.	Wt. Each (lbs.)	Product Class
CZK 100-30	1" Control Zone Kit with 30 PSI Pressure Regulating Filter	1/10	1.26	21DI
CZK 100-30F	1" Control Zone Kit with 30 PSI Pressure Regulating Filter and Flow Control	1/10	1.30	21DI
CZK 100-40	1" Control Zone Kit with 40 PSI Pressure Regulating Filter	1/10	1.26	21DI
CZK 100-40F	1" Control Zone Kit with 40 PSI Pressure Regulating Filter and Flow Control	1/10	1.30	21DI
CZK 100-40VB1	1" Control Zone Kit with 40 PSI Pressure Regulating Filter in 10"x15" Green Valve Box	1/25	5.35	21DI

### Drip Zone Kit

Part No.	Description	Bag Qty./Box Qty.	Wt. per 100 (lbs.)	Product Class
DZK 700/710	Drip Zone Kit: 150 Mesh Filter, 30 PSI Regulator, 1-8 gpm Flow (Fits .680" – .710" OD Tubing Outlet 1" and 3/4" MIPT Inlet)	1/10	0.76	21DI



Features	Benefits
All parts in one kit	No need to purchase or source additional parts
Easy installation	Saves time
Fits .680" – .710" OD PE Tubing	One kit used for a wide range of PE tubing, saving the need to have additional products
3/4" or 1" Inlet	Easily installed on 3/4" or 1" discharges
150 Mesh Filter	Prevents debris entering drip system
30 PSI Regulator	Will operate a wide range of micro products

PROFESSIONAL IRRIGATION

## POINT OF CONNECTION

### Y Strainers

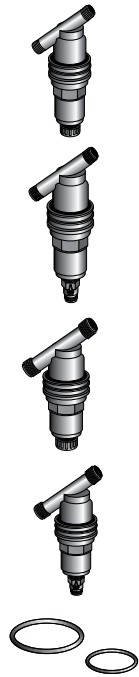

YS 75	"Y" Filter, 3/4" MIPT, with 150 Mesh Polyester Screen Element (10 gpm Capacity, 150 PSI Max. Pressure)	Black	1/50	33.1	21DI
YSS 75	"Y" Filter, 3/4" MIPT, with 150 Mesh Polyester Screen Element (10 gpm Capacity, 150 PSI Max. Pressure)	Black	1/50	34.1	21DI
YSV 75	"Y" Filter, 3/4" MIPT, with 150 Mesh Polyester Screen Element, Includes Flush Valve (10 gpm Capacity, 150 PSI Max. Pressure)	Black	1/50	35.6	21DI
YSVS 75	"Y" Filter, 3/4" MIPT, with 150 Mesh Stainless Steel Screen Element, Includes Flush Valve (10 gpm Capacity, 150 PSI Max. Pressure)	Black	1/50	36.5	21DI
YS 100	"Y" Filter, 1" MIPT, with 150 Mesh Polyester Screen Element, (10 gpm Capacity, 150 PSI Max. Pressure)	Black	1/50	36.6	21DI
YSS 100	"Y" Filter, 1" MIPT, with 150 Mesh Stainless Steel Screen Element, (10 gpm Capacity, 150 PSI Max. Pressure)	Black	1/50	36.8	21DI
YSV 100	"Y" Filter, 1" MIPT, with 150 Mesh Polyester Screen Element, Includes Flush Valve (10 gpm Capacity, 150 PSI Max. Pressure)	Black	1/50	39.0	21DI
YSVS 100	"Y" Filter, 1" MIPT, with 150 Mesh Stainless Steel Screen Element, Includes Flush Valve (10 gpm Capacity, 150 PSI Max. Pressure)	Black	1/50	39.7	21DI
OR 136	Replacement O-Ring for YS Filter Housing	Black	10/100	.03	21DI
OR 027	Replacement O-Ring for YS Filter Element	Black	10/100	.01	21DI

### Pressure Regulators

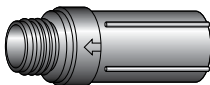
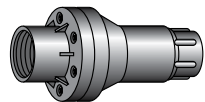

PR 20	20 PSI, 3/4" FIPT Pressure Regulator (0.1 – 8 gpm Flow Range)	Black	10/50	31.0	21DI
PR 30	30 PSI, 3/4" FIPT Pressure Regulator (0.1 – 8 gpm Flow Range)	Black	10/50	31.0	21DI
PRM 30	30 PSI, 3/4" FIPT Pressure Regulator (2 – 20 gpm Flow Range)	Black	10/50	31.0	21DI
PRP 10	10 PSI, Pipe Thread, Pressure Regulator (3/4" FPT in x 3/4" MPT out, .2 to 10 gpm)	Red	10/50	15.3	21DI
PRP 15	15 PSI, Pipe Thread, Pressure Regulator (3/4" FPT in x 3/4" MPT out, .2 to 10 gpm)	Brown	10/50	15.3	21DI
PRP 20	20 PSI, Pipe Thread, Pressure Regulator (3/4" FPT in x 3/4" MPT out, .2 to 10 gpm)	Black	10/50	15.3	21DI
PRP 25	25 PSI, Pipe Thread, Pressure Regulator (3/4" FPT in x 3/4" MPT out, .2 to 10 gpm)	Green	10/50	15.3	21DI
PRP 30	30 PSI, Pipe Thread, Pressure Regulator (3/4" FPT in x 3/4" MPT out, .2 to 10 gpm)	Grey	10/50	15.3	21DI



## POINT OF CONNECTION

### Pressure Regulators (continued)

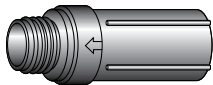

Part No.	Description	Color	Bag Qty./ Box Qty.	Wt. per 100 (lbs.)	Product Class
PRP 40	40 PSI, Pipe Thread, Pressure Regulator (3/4" FHT in x 3/4" MHT out, .2 to 10 gpm)	Blue	10/50	15.3	21DI
PRH 10	10 PSI, Hose Thread, Pressure Regulator (3/4" FHT in x 3/4" MHT out, .2 to 10 gpm)	Red	10/50	15.3	21DI
PRH 15	15 PSI, Hose Thread, Pressure Regulator (3/4" FHT in x 3/4" MHT out, .2 to 10 gpm)	Brown	10/50	15.3	21DI
PRH 20	20 PSI, Hose Thread, Pressure Regulator (3/4" FHT in x 3/4" MHT out, .2 to 10 gpm)	Black	10/50	15.3	21DI
PRH 25	25 PSI, Hose Thread, Pressure Regulator (3/4" FHT in x 3/4" MHT out, .2 to 10 gpm)	Green	10/50	15.3	21DI
PRH 30	30 PSI, Hose Thread, Pressure Regulator (3/4" FHT in x 3/4" MHT out, .2 to 10 gpm)	Grey	10/50	15.3	21DI
PRH 40	40 PSI, Hose Thread, Pressure Regulator (3/4" FHT in x 3/4" MHT out, .2 to 10 gpm)	Blue	10/50	15.3	21DI

### Filters and Replacement Screens

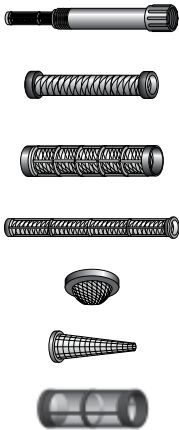

Part No.	Description	Color	Bag Qty./ Box Qty.	Wt. per 100 (lbs.)	Product Class
FIL 75	3/4" MHT x 3/4" FHT Inline Plastic Filter with 120 Mesh Screen (Maximum Flow of 7gpm)	Black	10/50	12.4	21DI
SSTF 150	Stainless Steel Screen – 150 Mesh (Replacement for FTEE 150 Filter)	Black	10/50	1.8	21DI
SP 150	Polyester Screen – 150 Mesh (Replacement for YS 75, YSV 75, YS 100, YSV 100 Filter)	Black	5/20	3.7	21DI
SSS 150	Stainless Steel Screen (Replacement for YSS 75, YSVS 75, YSS 100 and YSVS 100 Filter)	Black	5/20	4.3	21DI
SP 120	Polyester 120 Mesh Screen (Replacement for FIL 75)	Black	10/50	1.6	21DI
SW 75	3/4" Filter Washer (30 Mesh, Stainless Steel)	Green	100/1,000	0.5	21DI
SW 50	1/2" Filter Washer (100 Mesh, Stainless Steel)	Black	100/1,000	0.4	21DI
SSPRAY 200	Stainless Steel Filter Screen for PRYF 30 & 40	Black	1/20	3.5	21DI

### Swing Pipe Fittings



Part No.	Description	Color	Bag Qty./ Box Qty.	Wt. per 100 (lbs.)	Product Class
FPA-0500	1/2" Male NPT x Spiral Barbed Adapter	Black	50/500	1.6	42LS
FPA-0750	3/4" Male NPT x Spiral Barbed Adapter	Black	50/500	2.0	42LS
FPE-0500	1/2" Male NPT x Spiral Barbed Elbow	Black	50/500	2.2	42LS
FPE-0750	3/4" Male NPT x Spiral Barbed Elbow	Black	50/500	2.6	42LS
FPC-0490	1/2" Spiral Barbed Coupler	Black	50/500	1.4	42LS

Use with Flexee or Super Flexee pipe. (See page 123)  
Swing Riser Assemblies available. (See page 148)

## DRIPLINE



- Reduces water use by 30% or more compared to overhead irrigation
- Complies with new water conservation legislation
- Highly efficient solution for landscape plantings & turfgrass
- Chemical-free root intrusion protection
- Longest run lengths in the industry
- Comprehensive offering from NDS  
Pressure Compensating, Non Pressure Compensating, Check Valve,  
Multiple Tubing size and color options

### Dura Flo™ CV – One Dripline Tubing for All Applications

The new Dura Flo CV Check Valve Dripline combines the best of Dura Flo PC with a check valve. The combination brings the next level of water conservation to your irrigation project. The dripper features a check valve in combination with anti-siphon capabilities. The check valve prevents low emitter drainage on shut down and the anti-siphon feature eliminates back-siphonage at each emitter. This combination maximizes water efficiency by minimizing water loss and protecting each emitter from clogging and root intrusion. NDS Dura Flo CV is the only product offering this level of efficiency and protection in an all-in-one solution for drip line applications.

#### Features

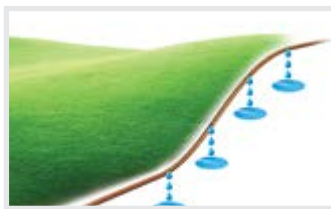

##### Check Valve

- Each emitter opens a 7.5 PSI – Longer run lengths lead to reduced material and labor costs
- Each emitter has a 2 PSI check valve that holds back up to 4.5 ft. of elevation – Prevents low head drainage & keeps the line full of water between irrigation intervals to provide instant watering when the system turns on for each cycle
- Reduces water waste – saves up to 1.39 gallons of water per 100 ft. of tubing



##### Anti-Siphon

- Each dripper is designed with an anti-siphon feature that prevents the suction of debris into the emitter
- Built-in anti-siphon feature eliminates the need for an air/vacuum relief valve



##### Emitter Specifications

- With its unique built-in filtration slits and self-cleaning design, clogging is minimized
- Flat, economical, check valve, pressure compensating, anti-siphon emitter maintains uniform flow rates at a wide range of working pressures and various topographies
- Operating range: 7.5 - 60 PSI • Flow rates: 0.4 gph, 0.6 gph, and 0.9 gph • Dripper spacing: 12", 18" or 24"



##### Pressure Compensation

- Conserves up to 70% of the water used by a conventional sprinkler irrigation system
- Distributes water evenly regardless of pressure fluctuations
- Self-flushing emitter eliminates debris from clogging the system during operation

##### Made in USA

## DRIPLINE

### 17MM Dura Flo™ CV

Shrink Wrapped Packaging

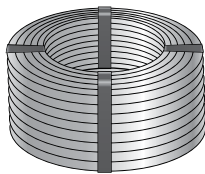

0.660" OD  
Inline Check Valve

Part No.	Description	Color	Coil Size/Type	Wt. per 100' (lbs.)	Product Class
SFCV-BR-6112-01S	0.4 gph, 17mm Dura Flo™ Inline Check Valve Dripline (0.560" ID x 0.660" OD), 12" spacing	Brown	100'/ Wrapped Coil	3.3	21DF
SFCV-BR-6112-025S	0.4 gph, 17mm Dura Flo™ Inline Check Valve Dripline (0.560" ID x 0.660" OD), 12" spacing	Brown	250'/ Wrapped Coil	3.3	21DF
SFCV-BR-6112-05S	0.4 gph, 17mm Dura Flo™ Inline Check Valve Dripline (0.560" ID x 0.660" OD), 12" spacing	Brown	500'/ Wrapped Coil	3.3	21DF
SFCV-BR-6212-01S	0.6 gph, 17mm Dura Flo™ Inline Check Valve Dripline (0.560" ID x 0.660" OD), 12" spacing	Brown	100'/ Wrapped Coil	3.3	21DF
SFCV-BR-6212-025S	0.6 gph, 17mm Dura Flo™ Inline Check Valve Dripline (0.560" ID x 0.660" OD), 12" spacing	Brown	250'/ Wrapped Coil	3.3	21DF
SFCV-BR-6212-05S	0.6 gph, 17mm Dura Flo™ Inline Check Valve Dripline (0.560" ID x 0.660" OD), 12" spacing	Brown	500'/ Wrapped Coil	3.3	21DF
SFCV-BR-6218-01S	0.6 gph, 17mm Dura Flo™ Inline Check Valve Dripline (0.560" ID x 0.660" OD), 18" spacing	Brown	100'/ Wrapped Coil	3.3	21DF
SFCV-BR-6218-025S	0.6 gph, 17mm Dura Flo™ Inline Check Valve Dripline (0.560" ID x 0.660" OD), 18" spacing	Brown	250'/ Wrapped Coil	3.3	21DF
SFCV-BR-6218-05S	0.6 gph, 17mm Dura Flo™ Inline Check Valve Dripline (0.560" ID x 0.660" OD), 18" spacing	Brown	500'/ Wrapped Coil	3.3	21DF
SFCV-BR-6224-05S	0.6 gph, 17mm Dura Flo™ Inline Check Valve Dripline (0.560" ID x 0.660" OD), 24" spacing	Brown	500'/ Wrapped Coil	3.3	21DF
SFCV-BR-6412-01S	0.9 gph, 17mm Dura Flo™ Inline Check Valve Dripline (0.560" ID x 0.660" OD), 12" spacing	Brown	100'/ Wrapped Coil	3.3	21DF
SFCV-BR-6412-025S	0.9 gph, 17mm Dura Flo™ Inline Check Valve Dripline (0.560" ID x 0.660" OD), 12" spacing	Brown	250'/ Wrapped Coil	3.3	21DF
SFCV-BR-6412-05S	0.9 gph, 17mm Dura Flo™ Inline Check Valve Dripline (0.560" ID x 0.660" OD), 12" spacing	Brown	500'/ Wrapped Coil	3.3	21DF
SFCV-PS-6412-05S	0.9 gph, 17mm Dura Flo™ Inline Check Valve Dripline (0.560" ID x 0.660" OD), 12" spacing	Purple Stripe	500'/ Wrapped Coil	3.3	21DF
SFCV-BR-6418-01S	0.9 gph, 17mm Dura Flo™ Inline Check Valve Dripline (0.560" ID x 0.660" OD), 18" spacing	Brown	100'/ Wrapped Coil	3.3	21DF
SFCV-BR-6418-025S	0.9 gph, 17mm Dura Flo™ Inline Check Valve Dripline (0.560" ID x 0.660" OD), 18" spacing	Brown	250'/ Wrapped Coil	3.3	21DF
SFCV-BR-6418-05S	0.9 gph, 17mm Dura Flo™ Inline Check Valve Dripline (0.560" ID x 0.660" OD), 18" spacing	Brown	500'/ Wrapped Coil	3.3	21DF
SFCV-PS-6418-05S	0.9 gph, 17mm Dura Flo™ Inline Check Valve Dripline (0.560" ID x 0.660" OD), 18" spacing	Purple Stripe	500'/ Wrapped Coil	3.3	21DF
SFCV-BR-6424-05S	0.9 gph, 17mm Dura Flo™ Inline Check Valve Dripline (0.560" ID x 0.660" OD), 24" spacing	Brown	500'/ Wrapped Coil	3.3	21DF

Notes: 1,000' Coils are Available Made to Order.

Brown 17mm Tubing with no emitters can be found on page 122 – See A660BR SKUs.

PROFESSIONAL IRRIGATION

## DRIPLINE

### 17MM Dura Flo™ PC

Shrink Wrapped  
Packaging



PROFESSIONAL IRRIGATION



0.660" OD  
Pressure Compensative

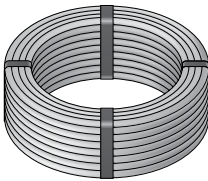

0.660" OD  
Pressure Compensative

Part No.	Description	Color	Coil Size/Type	Wt. per 100' (lbs.)	Product Class
SFPC-BR-17212-01S	1/2 gph, 17mm Dura Flo™ Pressure Compensating Dripline (0.560" ID x 0.660" OD), 12" spacing	Brown	100'/ Wrapped Coil	4.1	21DF
SFPC-BR-17212-025S	1/2 gph, 17mm Dura Flo™ Pressure Compensating Dripline (0.560" ID x 0.660" OD), 12" spacing	Brown	250'/ Wrapped Coil	4.1	21DF
SFPC-BR-17212-05S	1/2 gph, 17mm Dura Flo™ Pressure Compensating Dripline (0.560" ID x 0.660" OD), 12" spacing	Brown	500'/ Wrapped Coil	4.1	21DF
SFPC-BR-17218-01S	1/2 gph, 17mm Dura Flo™ Pressure Compensating Dripline (0.560" ID x 0.660" OD), 18" spacing	Brown	100'/ Wrapped Coil	3.9	21DF
SFPC-BR-17218-025S	1/2 gph, 17mm Dura Flo™ Pressure Compensating Dripline (0.560" ID x 0.660" OD), 18" spacing	Brown	250'/ Wrapped Coil	3.9	21DF
SFPC-BR-17218-05S	1/2 gph, 17mm Dura Flo™ Pressure Compensating Dripline (0.560" ID x 0.660" OD), 18" spacing	Brown	500'/ Wrapped Coil	3.9	21DF
SFPC-BR-17224-05S	1/2 gph, 17mm Dura Flo™ Pressure Compensating Dripline (0.560" ID x 0.660" OD), 24" spacing	Brown	500'/ Wrapped Coil	3.8	21DF
SFPC-BR-17412-01S	1 gph, 17mm Dura Flo™ Pressure Compensating Dripline (0.560" ID x 0.660" OD), 12" spacing	Brown	100'/ Wrapped Coil	4.1	21DF
SFPC-BR-17412-025S	1 gph, 17mm Dura Flo™ Pressure Compensating Dripline (0.560" ID x 0.660" OD), 12" spacing	Brown	250'/ Wrapped Coil	4.1	21DF
SFPC-BR-17412-05S	1 gph, 17mm Dura Flo™ Pressure Compensating Dripline (0.560" ID x 0.660" OD), 12" spacing	Brown	500'/ Wrapped Coil	4.1	21DF
SFPC-PS-17412-05S	1 gph, 17mm Dura Flo™ Pressure Compensating Dripline (0.560" ID x 0.660" OD), 12" spacing	Brown/ Purple Stripe	500'/ Wrapped Coil	4.1	21DF
SFPC-RC-17412-05S	1 gph, 17mm Dura Flo™ Pressure Compensating Dripline (0.560" ID x 0.660" OD), 12" spacing	Purple	500'/ Wrapped Coil	4.1	21DF
SFPC-BR-17412-10	1 gph, 17mm Dura Flo™ Pressure Compensating Dripline (0.560" ID x 0.660" OD), 12" spacing	Brown	1,000'/ Wrapped Coil	3.8	21DF
SFPC-BR-17418-01S	1 gph, 17mm Dura Flo™ Pressure Compensating Dripline (0.560" ID x 0.660" OD), 18" spacing	Brown	100'/ Wrapped Coil	3.9	21DF
SFPC-BR-17418-025S	1 gph, 17mm Dura Flo™ Pressure Compensating Dripline (0.560" ID x 0.660" OD), 18" spacing	Brown	250'/ Wrapped Coil	3.9	21DF
SFPC-BR-17418-05S	1 gph, 17mm Dura Flo™ Pressure Compensating Dripline (0.560" ID x 0.660" OD), 18" spacing	Brown	500'/ Wrapped Coil	3.9	21DF

Note: 1,000' Coils are Available Made to Order.



## DRIPLINE

### 16MM Dura Flo™ PC



0.640" OD  
Pressure Compensative

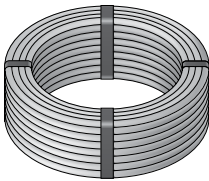

0.640" OD  
Pressure Compensative

Part No.	Description	Color	Coil Size/Type	Wt. per 100' (lbs.)	Product Class
SFPC-BR-6212-025	1/2 gph, 16mm Dura Flo™ Pressure Compensating Dripline (0.550" ID x 0.640" OD), 12" spacing	Brown	250'/Coil	4.0	21DF
SFPC-BR-6212-05	1/2 gph, 16mm Dura Flo™ Pressure Compensating Dripline (0.550" ID x 0.640" OD), 12" spacing	Brown	500'/Coil	4.0	21DF
SFPC-BR-6218-01	1/2 gph, 16mm Dura Flo™ Pressure Compensating Dripline (0.550" ID x 0.640" OD), 18" spacing	Brown	100'/Coil	3.8	21DF
SFPC-BR-6218-025	1/2 gph, 16mm Dura Flo™ Pressure Compensating Dripline (0.550" ID x 0.640" OD), 18" spacing	Brown	250'/Coil	3.8	21DF
SFPC-BR-6218-05	1/2 gph, 16mm Dura Flo™ Pressure Compensating Dripline (0.550" ID x 0.640" OD), 18" spacing	Brown	500'/Coil	3.8	21DF
SFPC-BL-6412-01	1 gph, 16mm Dura Flo™ Pressure Compensating Dripline (0.550" ID x 0.640" OD), 12" spacing	Black	100'/Coil	4.0	21DF
SFPC-BR-6412-01	1 gph, 16mm Dura Flo™ Pressure Compensating Dripline (0.550" ID x 0.640" OD), 12" spacing	Brown	100'/Coil	4.0	21DF
SFPC-BR-6412-025	1 gph, 16mm Dura Flo™ Pressure Compensating Dripline (0.550" ID x 0.640" OD), 12" spacing	Brown	250'/Coil	4.0	21DF
SFPC-BL-6412-05	1 gph, 16mm Dura Flo™ Pressure Compensating Dripline (0.550" ID x 0.640" OD), 12" spacing	Black	500'/Coil	4.0	21DF
SFPC-BR-6412-05	1 gph, 16mm Dura Flo™ Pressure Compensating Dripline (0.550" ID x 0.640" OD), 12" spacing	Brown	500'/Coil	4.0	21DF
SFPC-BL-6418-01	1 gph, 16mm Dura Flo™ Pressure Compensating Dripline (0.550" ID x 0.640" OD), 18" spacing	Black	100'/Coil	3.8	21DF
SFPC-BR-6418-01	1 gph, 16mm Dura Flo™ Pressure Compensating Dripline (0.550" ID x 0.640" OD), 18" spacing	Brown	100'/Coil	3.8	21DF
SFPC-BR-6418-025	1 gph, 16mm Dura Flo™ Pressure Compensating Dripline (0.550" ID x 0.640" OD), 18" spacing	Brown	250'/Coil	3.8	21DF
SFPC-BL-6418-05	1 gph, 16mm Dura Flo™ Pressure Compensating Dripline (0.550" ID x 0.640" OD), 18" spacing	Black	500'/Coil	3.8	21DF
SFPC-BR-6418-05	1 gph, 16mm Dura Flo™ Pressure Compensating Dripline (0.550" ID x 0.640" OD), 18" spacing	Brown	500'/Coil	3.8	21DF

PROFESSIONAL IRRIGATION

## DRIPLINE

### 18MM Dura Flo™ PC



0.700" OD  
Pressure Compensative

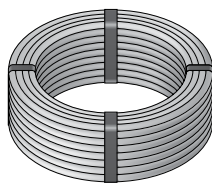

0.700" OD  
Pressure Compensative

Part No.	Description	Color	Coil Size/Type	Wt. per 100' (lbs.)	Product Class
SFPC-BL-7212-01	1/2 gph, 18mm Dura Flo™ Pressure Compensating Dripline (0.600" ID x 0.700" OD), 12" spacing	Black	100'/Coil	4.7	21DF
SFPC-BR-7212-01	1/2 gph, 18mm Dura Flo™ Pressure Compensating Dripline (0.600" ID x 0.700" OD), 12" spacing	Brown	100'/Coil	4.7	21DF
SFPC-BL-7212-05	1/2 gph, 18mm Dura Flo™ Pressure Compensating Dripline (0.600" ID x 0.700" OD), 12" spacing	Black	500'/Coil	4.7	21DF
SFPC-BR-7212-05	1/2 gph, 18mm Dura Flo™ Pressure Compensating Dripline (0.600" ID x 0.700" OD), 12" spacing	Brown	500'/Coil	4.7	21DF
SFPC-BR-7218-05	1/2 gph, 18mm Dura Flo™ Pressure Compensating Dripline (0.600" ID x 0.700" OD), 18" spacing	Brown	500'/Coil	4.5	21DF
SFPC-BL-7412-01	1 gph, 18mm Dura Flo™ Pressure Compensating Dripline (0.600" ID x 0.700" OD), 12" spacing	Black	100'/Coil	4.7	21DF
SFPC-BR-7412-01	1 gph, 18mm Dura Flo™ Pressure Compensating Dripline (0.600" ID x 0.700" OD), 12" spacing	Brown	100'/Coil	4.7	21DF
SFPC-BL-7412-05	1 gph, 18mm Dura Flo™ Pressure Compensating Dripline (0.600" ID x 0.700" OD), 12" spacing	Black	500'/Coil	4.7	21DF
SFPC-BR-7412-05	1 gph, 18mm Dura Flo™ Pressure Compensating Dripline (0.600" ID x 0.700" OD), 12" spacing	Brown	500'/Coil	4.7	21DF
SFPC-BL-7418-01	1 gph, 18mm Dura Flo™ Pressure Compensating Dripline (0.600" ID x 0.700" OD), 18" spacing	Black	100'/Coil	4.5	21DF
SFPC-BR-7418-01	1 gph, 18mm Dura Flo™ Pressure Compensating Dripline (0.600" ID x 0.700" OD), 18" spacing	Brown	100'/Coil	4.5	21DF
SFPC-BL-7418-05	1 gph, 18mm Dura Flo™ Pressure Compensating Dripline (0.600" ID x 0.700" OD), 18" spacing	Black	500'/Coil	4.5	21DF
SFPC-BR-7418-05	1 gph, 18mm Dura Flo™ Pressure Compensating Dripline (0.600" ID x 0.700" OD), 18" spacing	Brown	500'/Coil	4.5	21DF

PROFESSIONAL IRRIGATION

### 18MM Dura Flo™ CV

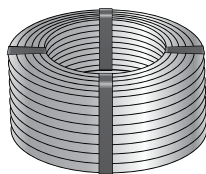

0.700" OD  
Inline Check Valve

Part No.	Description	Color	Coil Size/Type	Wt. per 100' (lbs.)	Product Class
SFCV-BR-7212-01	0.6 gph, 18mm Dura Flo™ Inline Check Valve Dripline (0.600" ID x 0.700" OD), 12" spacing	Brown	100'/Coil	3.3	21DF
SFCV-BR-7212-025	0.6 gph, 18mm Dura Flo™ Inline Check Valve Dripline (0.600" ID x 0.700" OD), 12" spacing	Brown	250'/Coil	3.3	21DF
SFCV-BR-7212-10	0.6 gph, 18mm Dura Flo™ Inline Check Valve Dripline (0.600" ID x 0.700" OD), 12" spacing	Brown	1,000'/Coil	3.3	21DF
SFCV-BR-7412-01	0.9 gph, 18mm Dura Flo™ Inline Check Valve Dripline (0.600" ID x 0.700" OD), 12" spacing	Brown	100'/Coil	3.3	21DF
SFCV-BR-7412-025	0.9 gph, 18mm Dura Flo™ Inline Check Valve Dripline (0.600" ID x 0.700" OD), 12" spacing	Brown	250'/Coil	3.3	21DF
SFCV-BR-7412-10	0.9 gph, 18mm Dura Flo™ Inline Check Valve Dripline (0.600" ID x 0.700" OD), 12" spacing	Brown	1,000'/Coil	3.3	21DF
SFCV-BR-7218-01	0.9 gph, 18mm Dura Flo™ Inline Check Valve Dripline (0.600" ID x 0.700" OD), 18" spacing	Brown	100'/Coil	3.3	21DF
SFCV-BR-7218-025	0.9 gph, 18mm Dura Flo™ Inline Check Valve Dripline (0.600" ID x 0.700" OD), 18" spacing	Brown	250'/Coil	3.3	21DF

## DRIPLINE

### 1/4" Dura Flo™ JR

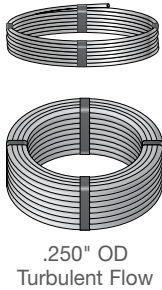

Part No.	Description	Color	Coil Size/Type	Wt. per 100' (lbs.)	Product Class
SFJR-BL-06-01	1/2 gph, 1/4" Dura Flo™ JR Dripline (0.170" ID x 0.250" OD) 6" spacing	Black	100'/Coil	1.2	21DF
SFJR-BL-06-05	1/2 gph, 1/4" Dura Flo™ JR Dripline (0.170" ID x 0.250" OD) 6" spacing	Black	500'/Spool	1.2	21DF
SFJR-BL-06-10	1/2 gph, 1/4" Dura Flo™ JR Dripline (0.170" ID x 0.250" OD) 6" spacing	Black	1,000'/Spool	1.2	21DF
SFJR-BL-12-01	1/2 gph, 1/4" Dura Flo™ JR Dripline (0.170" ID x 0.250" OD) 12" spacing	Black	100'/Coil	1.1	21DF
SFJR-BL-12-05	1/2 gph, 1/4" Dura Flo™ JR Dripline (0.170" ID x 0.250" OD) 12" spacing	Black	500'/Coil	1.1	21DF
SFJR-BL-12-10	1/2 gph, 1/4" Dura Flo™ JR Dripline (0.170" ID x 0.250" OD) 12" spacing	Black	1,000'/Spool	1.1	21DF
SFJR-BR-06-01	1/2 gph, 1/4" Dura Flo™ JR Dripline (0.170" ID x 0.250" OD) 6" spacing	Brown	100'/Coil	1.2	21DF
SFJR-BR-12-01	1/2 gph, 1/4" Dura Flo™ JR Dripline (0.170" ID x 0.250" OD) 12" spacing	Brown	100'/Coil	1.1	21DF

Note: Non-PC Emitter.

### Turbulent Flo™

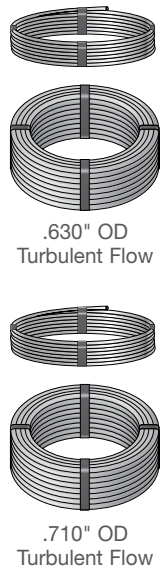

Part No.	Description	Color	Coil Size/Type	Wt. per 100' (lbs.)	Product Class
SF-BL-6212-05	1/2 gph, Dura Flo™ Dripline (0.550" ID x 0.630" OD) 12" spacing	Black	500'/Coil	3.4	21DF
SF-BL-6812-01	1/2 gph, Dura Flo™ Dripline (0.550" ID x 0.630" OD) 12" spacing	Black	100'/Coil	3.4	21DF
Part No.	Description	Color	Coil Size/Type	Wt. per 100' (lbs.)	Product Class
SF-BL-7212-01	1/2 gph, Dura Flo™ Dripline (0.620" ID x 0.710" OD) 12" spacing	Black	100'/Coil	4.2	21DF
SF-BL-7212-05	1/2 gph, Dura Flo™ Dripline (0.620" ID x 0.710" OD) 12" spacing	Black	500'/Coil	4.2	21DF
SF-BL-7412-01	1 gph, Dura Flo™ Dripline (0.620" ID x 0.710" OD) 12" spacing	Black	100'/Coil	4.2	21DF
SF-BL-7412-05	1 gph, Dura Flo™ Dripline (0.620" ID x 0.710" OD) 12" spacing	Black	500'/Coil	4.2	21DF
SF-BL-7412-10	1 gph, Dura Flo™ Dripline (0.620" ID x 0.710" OD) 12" spacing	Black	1,000'/Coil	4.2	21DF
SF-BL-7812-01	2 gph, Dura Flo™ Dripline (0.620" ID x 0.710" OD) 12" spacing	Black	100'/Coil	4.2	21DF

Note: Non-PC Emitter.



## DRIPLINE – TECHNICAL INFORMATION

### 17MM Dura Flo™ CV Maximum Recommended Length of Run (Feet)

Initial Pressure	12" SPACING			18" SPACING			24" SPACING		
	0.4 GPH	0.6 GPH	0.9 GPH	0.4 GPH	0.6 GPH	0.9 GPH	0.4 GPH	0.6 GPH	0.9 GPH
15 PSI	261'	221'	161'	347'	292'	214'	420'	354'	260'
20 PSI	357'	300'	221'	477'	399'	294'	576'	488'	358'
25 PSI	422'	354'	259'	563'	471'	346'	684'	575'	421'
30 PSI	471'	395'	289'	629'	526'	385'	765'	642'	471'
35 PSI	514'	429'	314'	687'	571'	418'	835'	699'	512'
40 PSI	550'	460'	336'	735'	618'	449'	893'	748'	549'
45 PSI	582'	486'	355'	779'	650'	473'	947'	791'	581'
50 PSI	610'	508'	372'	818'	677'	493'	995'	830'	610'

### Discharge Rates (GPH)

Model	Part No.	10 PSI	15 PSI	20 PSI	25 PSI	30 PSI	40 PSI	60 PSI	80 PSI
Dura Flo™ JR Mini Dripperline	DS 20			1.7 gph	1.9 gph	2.0 gph	2.2 gph	2.5 gph	2.1 gph
	DS 30			3.0 gph	3.3 gph	3.6 gph	3.6 gph	3.6 gph	3.0 gph
Dura Flo™ PC Dripperline	SFJR-XX-XX-XX	0.39 gph	0.47 gph	0.56 gph	0.63 gph	0.69 gph			
	SFPC-XX-62XX-XX	0.45 gph	0.50 gph	0.50 gph	0.50 gph	0.50 gph	0.50 gph	0.45 gph	
	SFPC-XX-64XX-XX	0.75 gph	0.90 gph	0.90 gph	0.90 gph	0.90 gph	0.85 gph	0.80 gph	
	SFPC-XX-68XX-XX	1.40 gph	1.60 gph	1.65 gph	1.65 gph	1.65 gph	1.65 gph	1.65 gph	
	SFPC-XX-72XX-XX	0.50 gph	0.55 gph	0.55 gph	0.55 gph	0.55 gph	0.55 gph	0.50 gph	
	SFPC-XX-74XX-XX	0.80 gph	0.95 gph	0.95 gph	0.95 gph	0.95 gph	0.95 gph	0.85 gph	
	SFPC-XX-78XX-XX	1.50 gph	1.75 gph	1.80 gph	1.80 gph	1.80 gph	1.80 gph	1.80 gph	
Dura Flo™ Dripperline	SFPC-XX-202XX-XX	0.43 gph	0.45 gph	0.48 gph	0.48 gph	0.49 gph	0.49 gph	0.45 gph	
	SFPC-XX-204XX-XX	0.80 gph	0.83 gph	0.83 gph	0.86 gph	0.88 gph	0.93 gph	0.94 gph	
	SFPC-XX-208XX-XX	1.55 gph	1.62 gph	1.62 gph	1.65 gph	1.65 gph	1.62 gph	1.77 gph	
	SF-XX-62XX-XX	0.36 gph	0.40 gph	0.51 gph	0.60 gph	0.68 gph	0.78 gph		
	SF-XX-64XX-XX	0.63 gph	0.78 gph	0.92 gph	1.08 gph	1.21 gph	1.41 gph		
	SF-XX-68XX-XX	1.26 gph	1.58 gph	1.79 gph	2.00 gph	2.20 gph	2.54 gph		
Mini Flo™ Emitter	SF-XX-72XX-XX	0.40 gph	0.48 gph	0.56 gph	0.66 gph	0.75 gph	0.86 gph		
	SF-XX-74XX-XX	0.71 gph	0.86 gph	1.01 gph	1.19 gph	1.35 gph	1.56 gph		
Laser Drilled Soaker Hose	SF-XX-78XX-XX	1.40 gph	1.75 gph	1.98 gph	2.22 gph	2.44 gph	2.82 gph		
	MIL 5	0.51 gph	0.63 gph	0.73 gph	0.81 gph				
	MIL 10	0.86 gph	1.06 gph	1.22 gph	1.36 gph				
	ALT 6/12	1.0 gph	1.30 gph	1.6 gph					

### Maximum Recommended Length of Run (Feet)

Model	Nominal Flow Rate	Initial Pressure	I.D. of Tubing (inches)									
			.520"	.600"	.520"	.600"	.520"	.600"	.520"	.600"	.520"	.600"
			Spacing Between Emitters (inches)									
			18"		24"		36"		48"		60"	
PC Plus™ Emitter	0.5 gph	20 PSI	350'	440'	415'	535'	530'	68'	640'	820'	740'	970'
		30 PSI	460'	590'	550'	710'	700'	900'	850'	1,090'	1,000'	1,290'
		40 PSI	540'	695'	640'	825'	840'	1,080'	1,020'	1,310'	1,160'	1,500'
	1.0 gph	20 PSI	220'	280'	265'	340'	340'	440'	410'	530'	480'	620'
		30 PSI	290'	375'	350'	450'	450'	580'	540'	690'	630'	820'
		40 PSI	340'	440'	410'	530'	540'	690'	650'	840'	750'	965'
	2.0 gph	20 PSI	160'	200'	190'	240'	240'	305'	300'	370'	350'	435'
		30 PSI	210'	265'	255'	320'	325'	405'	390'	490'	460'	575'
		40 PSI	250'	310'	300'	370'	380'	475'	460'	575'	540'	675'

## DRIPLINE – TECHNICAL INFORMATION

### Maximum Recommended Length of Run (Feet)

Model	Nominal Flow Rate	Initial Pressure	Spacing Between Emitters (inches)																	
			12"			18"			24"			36"			48"			60"		
			Tubing Size																	
.630" OD	.710" OD	.830" OD	.630" OD	.710" OD	.830" OD	.630" OD	.710" OD	.830" OD	.630" OD	.710" OD	.830" OD	.630" OD	.710" OD	.830" OD	.630" OD	.710" OD	.830" OD	.630" OD	.710" OD	.830" OD
Dura Flo™ Emitter-line	0.5 gph	20 PSI	180'	240'	N/A	250'	340'	N/A	300'	420'	N/A	400'	550'	N/A	490'	680'	N/A	570'	790'	N/A
	1.0 gph	20 PSI	130'	180'	N/A	170'	240'	N/A	210'	300'	N/A	270'	390'	N/A	340'	480'	N/A	390'	550'	N/A
	2.0 gph	20 PSI	95'	120'	N/A	125'	150'	N/A	150'	190'	N/A	200'	250'	N/A	250'	310'	N/A	285'	360'	N/A
Dura Flow PC™ Emitter-line	0.5 gph	15 PSI	180'	210'	315'	255'	300'	495'	325'	380'	560'	455'	525'	780'	560'	650'	950'	655'	760'	1,090'
		25 PSI	265'	315'	460'	380'	450'	660'	485'	570'	825'	675'	780'	1,160'	850'	975'	1,420'	990'	1,140'	1,630'
		35 PSI	325'	380'	565'	460'	540'	790'	580'	685'	990'	810'	940'	1,400'	1,020'	1,175'	1,700'	1,190'	1,375'	1,950'
		45 PSI	365'	430'	625'	520'	610'	890'	660'	775'	1,120'	920'	1,065'	1,580'	1,150'	1,330'	1,930'	1,345'	1,555'	2,200'
	1.0 gph	15 PSI	130'	155'	215'	185'	220'	315'	240'	280'	380'	330'	380'	540'	410'	475'	660'	480'	555'	755'
		25 PSI	195'	230'	330'	280'	330'	460'	355'	420'	575'	485'	570'	840'	615'	715'	970'	720'	835'	1,080'
		35 PSI	240'	280'	395'	335'	395'	560'	430'	505'	690'	585'	690'	970'	740'	860'	1,190'	865'	1,005'	1,360'
		45 PSI	265'	315'	445'	380'	450'	625'	485'	570'	775'	660'	780'	1,100'	835'	975'	1,335'	975'	1,140'	1,530'
	2.0 gph	15 PSI	85'	100'	150'	125'	145'	200'	155'	180'	250'	215'	245'	350'	260'	305'	430'	300'	355'	495'
		25 PSI	125'	150'	215'	180'	215'	300'	230'	270'	380'	315'	365'	520'	400'	455'	640'	470'	530'	730'
		35 PSI	150'	180'	265'	215'	255'	330'	270'	320'	460'	380'	440'	635'	480'	550'	775'	560'	645'	890'
		45 PSI	170'	200'	295'	250'	290'	410'	305'	360'	510'	430'	500'	715'	540'	625'	875'	630'	730'	1,000'

PROFESSIONAL IRRIGATION

Model	Nominal Flow Rate	Initial Pressure	Spacing Between Emitters (inches)				
			12"	18"	24"	30"	36"
Mini Flo™ Emitter	0.5 gph	20 PSI	20'	25'	30'	35'	40'
	1.0 gph	20 PSI	12'	15'	18'	21'	24'

Model	Nominal Flow Rate	Spacing	Maximum Run	Model	Nominal Flow Rate	Spacing	Maximum Run
Dura Flo™ JR Mini Dripperline	0.5 gph	6"	19 ft.	Laser Drilled Soaker Hose (1/4")	1.0 gph	6"	12 ft.
	0.5 gph	12"	33 ft.		1.0 gph	12"	20 ft.

Calculations are based on: 1. No elevation changes over length of run. 2. Maximum allowable variation in discharge rate of ±7.5%.

Refer to Technical Specifications Document for Flowcharts and Run Length Information at [ndspro.com/specifications](https://ndspro.com/specifications)

## DRIPLINE – TECHNICAL INFORMATION

The Following Formula Should be Used to Calculate Application Rates

$$\text{Application Rate (inches per hour)} = \frac{231 \times \text{Emitter Flow Rates (gph)}}{\text{Spacing between Poly Laterals (inches)} \times \text{Spacing between Emission Device (inches)}}$$

(A)
(B)

### Example

Emitter Flow Rate = 1 gph

Spacing between Emission Device = 18"

Spacing between Poly Laterals = 16"

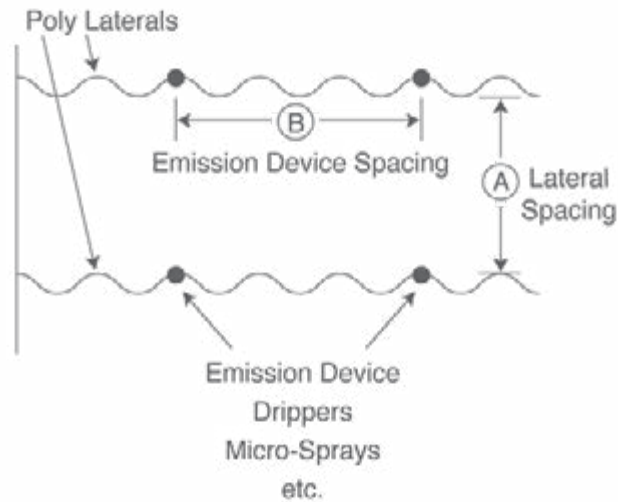

### Question

What is the application rate?

### Solution

$$\text{Application Rate} = \frac{231 \times 1}{16 \times 18} = 0.80"/\text{hr}$$

## Drip Application Rates (Inches/Hour) – Based on Nominal Flow Rates

Emitter Spacing	1/2 gph										
	Spacing between Poly Laterals										
	12"	13"	14"	15"	16"	17"	18"	19"	20"	22"	24"
12"	.80	.74	.69	.64	.60	.57	.53	.51	.48	.44	.40
18"	.53	.49	.46	.43	.40	.38	.36	.34	.32	.29	.27
24"	.40	.37	.34	.32	.30	.28	.26	.25	.24	.22	.20

Emitter Spacing	1 gph										
	Spacing between Poly Laterals										
	12"	13"	14"	15"	16"	17"	18"	19"	20"	22"	24"
12"	1.60	1.48	1.38	1.28	1.20	1.14	1.06	1.02	.96	.88	.80
18"	1.07	.99	.92	.86	.80	.75	.71	.68	.64	.58	.53
24"	.80	.74	.69	.64	.60	.57	.53	.51	.48	.44	.40

Emitter Spacing	2 gph										
	Spacing between Poly Laterals										
	12"	13"	14"	15"	16"	17"	18"	19"	20"	22"	24"
12"	3.20	2.96	2.75	2.56	2.40	2.28	2.12	2.04	1.92	1.76	1.60
18"	2.14	1.98	1.84	1.72	1.60	1.50	1.42	1.36	1.28	1.16	1.06
24"	1.60	1.48	1.38	1.28	1.20	1.14	1.06	1.02	.96	.88	.80



## SINGLE-OUTLET DEVICES

### Pressure Compensating

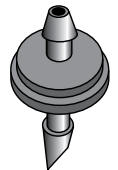

ACCUFLOW™

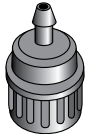

UNI-FLO™

Part No.	Description	Color	Bag Qty./ Box Qty.	Wt. per 100 (lbs.)	Product Class
<b>AccuFlow™</b>					
AFPC 5	1/2 gph Pressure Compensating AccuFlow™ Emitter	Blue	100/N/A	N/A	21DI
AFPC 5/25	1/2 gph Pressure Compensating AccuFlow™ Emitter	Blue	25/N/A	N/A	21DI
AFPC 5/1000	1/2 gph Pressure Compensating AccuFlow™ Emitter	Blue	1,000/N/A	N/A	21DI
AFPC 10	1 gph Pressure Compensating AccuFlow™ Emitter	Black	100/N/A	N/A	21DI
AFPC 10/25	1 gph Pressure Compensating AccuFlow™ Emitter	Black	25/N/A	N/A	21DI
AFPC 10/1000	1 gph Pressure Compensating AccuFlow™ Emitter	Black	1,000/N/A	N/A	21DI
AFPC 20	2 gph Pressure Compensating AccuFlow™ Emitter	Red	100/N/A	N/A	21DI
AFPC 20/25	2 gph Pressure Compensating AccuFlow™ Emitter	Red	25/N/A	N/A	21DI
AFPC 20/1000	2 gph Pressure Compensating AccuFlow™ Emitter	Red	1,000/N/A	N/A	21DI
AFPC 50	5 gph Pressure Compensating AccuFlow™ Emitter	Tan	100/N/A	N/A	21DI
AFPC 50/25	5 gph Pressure Compensating AccuFlow™ Emitter	Tan	25/N/A	N/A	21DI
AFPC 50/1000	5 gph Pressure Compensating AccuFlow™ Emitter	Tan	1,000/N/A	N/A	21DI
<b>Uni-Flo™</b>					
UF 5	1/2 gph, Pressure Compensating Emitter, 1/4" Barbed Outlet Nipple (1/2" FIPT Base)	Brown	100/500	1.6	21DI
UF 10	1 gph, Pressure Compensating Emitter, 1/4" Barbed Outlet Nipple (1/2" FIPT Base)	Black	100/500	1.6	21DI
UF 20	2 gph, Pressure Compensating Emitter, 1/4" Barbed Outlet Nipple (1/2" FIPT Base)	Green	100/500	1.6	21DI
UFC 10	1 gph Pressure Compensating, Self-Flushing Emitter with 1/2" FIPT Base	Black	100/500	1.6	21DI
UFC 20	2 gph Pressure Compensating, Self-Flushing Emitter with 1/2" FIPT Base	Green	100/500	1.6	21DI

### Non-Pressure Compensating

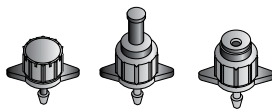

360  
180

BUB

FAN

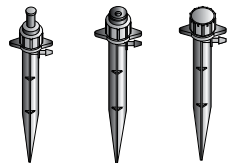

BUB

FAN

360  
180  
135

DIAL-A-FLO™

Part No.	Description	Color	Bag Qty./ Box Qty.	Wt. per 100 (lbs.)	Product Class
<b>Dial-a-Flo™</b>					
DAFB 360	360°, 8 Stream, 0-10 gph, 1/4" Barbed, Adjustable Dial-a-Flo™ Emitter	Black	100/2,500	0.5	21DI
DAFB 180	180°, 5 Stream, 0-10 gph, 1/4" Barbed, Adjustable Dial-a-Flo™ Emitter	Black	100/2,500	0.5	21DI
DAFB FAN	360°, Fan Spray, 0-20 gph, 1/4" Barbed, Adjustable Dial-a-Flo™ Emitter	Black	100/2,500	0.6	21DI
DAFB BUB	Umbrella Bubbler, 0-25 gph, 1/4" Barbed, Adjustable Dial-a-Flo™ Emitter	Black	100/2,500	0.7	21DI
DAFT 360	360°, 8 Stream, 0-10 gph, 10/32 NDS Threads, Adjustable Dial-a-Flo™ Emitter	Black	100/2,500	0.6	21DI
DAFT 180	180°, 5 Stream, 0-10 gph, 10/32 NDS Threads, Adjustable Dial-a-Flo™ Emitter	Black	100/2,500	0.6	21DI
DAFT FAN	360°, Fan Spray, 0-20 gph, 10/32 NDS Threads, Adjustable Dial-a-Flo™ Emitter	Black	100/2,500	0.7	21DI
DAFT BUB	Umbrella Bubbler, 0-25 gph, 10/32 NDS Threads, Adjustable Dial-a-Flo™ Emitter	Black	100/2,500	0.8	21DI
DAFS 360	360°, 8 Stream, 0-10 gph, Adjustable Dial-a-Flo™ Emitter with 6" Stake	Black	100/1,000	1.4	21DI
DAFS 180	180°, 5 Stream, 0-10 gph, Adjustable Dial-a-Flo™ Emitter with 6" Stake	Black	100/1,000	1.4	21DI
DAFS 135	135°, 4 Stream, 0-10 gph, Adjustable Dial-a-Flo™ Emitter with 6" Stake	Black	100/1,000	1.4	21DI
DAFS FAN	360°, Fan Spray, 0-20 gph, Adjustable Dial-a-Flo™ Emitter with 6" Stake	Black	100/1,000	1.4	21DI
DAFS BUB	Umbrella Bubbler, 0-25 gph, Adjustable Dial-a-Flo™ Emitter with 6" Stake	Black	100/1,000	1.5	21DI
VFR 90	90° Circle Adjustable Stream Sprayer	N/A	100/N/A	0.4	21DI
VFR 180	180° Circle Adjustable Stream Sprayer	N/A	100/N/A	0.4	21DI
VFR 360	360° Circle Adjustable Stream Sprayer	N/A	100/N/A	0.4	21DI

## SINGLE-OUTLET DEVICES

### Non-Pressure Compensating (continued)

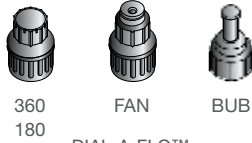

DIAL-A-FLO™



SUPER-FLO™

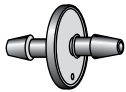

MINI-FLO™

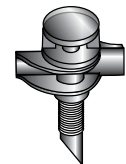
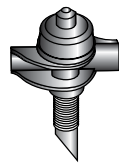
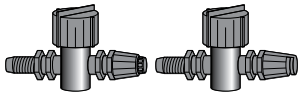

HYDRO-FLO™

Part No.	Description	Color	Bag Qty./ Box Qty.	Wt. per 100 (lbs.)	Product Class
Dial-a-Flo™ (cont.)					
DAFU 360	360°, 8 Stream, 0-10 gph, 1/2" FIPT, Adjustable Dial-a-Flo™ Emitter	Black	50/500	1.8	21DI
DAFU 180	180°, 5 Stream, 0-10 gph, 1/2" FIPT, Adjustable Dial-a-Flo™ Emitter	Black	50/500	1.7	21DI
DAFU FAN	360°, Fan Spray, 0-20 gph, 1/2" FIPT, Adjustable Dial-a-Flo™ Emitter	Black	50/500	1.8	21DI
DAFU BUB	Umbrella Bubbler, 0-25 gph, 1/2" FIPT, Adjustable Dial-a-Flo™ Emitter	Black	50/500	1.9	21DI
Super-Flo™					
TAE 10	1 gph, Laminar Flow, Take-Apart Super-Flo™ Emitter	Black	100/2,000	0.4	21DI
TAE 20	2 gph, Laminar Flow, Take-Apart Super-Flo™ Emitter	Green	100/2,000	0.4	21DI
TAE 40	4 gph, Laminar Flow, Take-Apart Super-Flo™ Emitter	Yellow	100/2,000	0.4	21DI
Mini-Flo™					
MIL 5	1/2 gph, Mini-Flo™ Mini-Inline Emitter	Red	100/2,000	0.5	21DI
MIL 10	1 gph, Mini-Flo™ Mini-Inline Emitter	Black	100/2,000	0.5	21DI
Use 1/4" tubing A 250 (page 121)					
Hydro-Flo™					
VF	0-25 gph, Hydro-Flo™ Adjustable Jet Body Only	Black	100/500	0.4	21DI
VF 360	0-25 gph, Hydro-Flo™ Adjustable Jet (360° Pattern – Stream Spray, 10-32 NPT Inlet)*	Black	100/500	0.5	21DI
VF 180	0-25 gph, Hydro-Flo™ Adjustable Jet (180° Pattern – Fan Spray, 10-32 NPT Inlet)*	Black	100/500	0.5	21DI
VF 90	0-25 gph, Hydro-Flo™ Adjustable Jet (90° Pattern – Fan Spray, 10-32 NPT Inlet)*	Black	100/500	0.5	21DI
*Uses SAJ Adapter (page 117)					
TFC 360	Cap-360°, 12 Finger Spray Hydro-Flo™ Jet	Black	100/2,500	0.1	21DI
TFC 180	Cap-180°, Fan Spray Hydro-Flo™ Jet	Black	100/2,500	0.1	21DI
TFC 90	Cap-90°, Fan Spray Hydro-Flo™ Jet	Black	100/2,500	0.1	21DI
TFC 33	Cap-Strip Fan Spray Hydro-Flo™ Jet	Black	100/2,500	0.1	21DI
TFB 30	Base-0.030" Nozzle Hydro-Flo™ Jet	Black	100/2,500	0.1	21DI
TFB 40	Base-0.040" Nozzle Hydro-Flo™ Jet	Blue	100/2,500	0.1	21DI
TFB 50	Base-0.050" Nozzle Hydro-Flo™ Jet	Green	100/2,500	0.1	21DI
TFB 60	Base-0.060" Nozzle Hydro-Flo™ Jet	Red	100/2,500	0.1	21DI
TFB 70	Base-0.070" Nozzle Hydro-Flo™ Jet	White	100/2,500	0.1	21DI
TF 436	0.040" Nozzle, 360° Fan Spray Single-Piece Hydro-Flo™ Jet	Blue	100/2,500	0.1	21DI
TF 536	0.050" Nozzle, 360° Fan Spray Single-Piece Hydro-Flo™ Jet	Green	100/2,500	0.1	21DI
TF 636	0.060" Nozzle, 360° Fan Spray Single-Piece Hydro-Flo™ Jet	Red	100/2,500	0.1	21DI
TF 318	0.030" Nozzle, 180° Fan Spray Single-Piece Hydro-Flo™ Jet	Black	100/2,500	0.1	21DI
TF 418	0.040" Nozzle, 180° Fan Spray Single-Piece Hydro-Flo™ Jet	Blue	100/2,500	0.1	21DI
TF 518	0.050" Nozzle, 180° Fan Spray Single-Piece Hydro-Flo™ Jet	Green	100/2,500	0.1	21DI
TF 618	0.060" Nozzle, 180° Fan Spray Single-Piece Hydro-Flo™ Jet	Red	100/2,500	0.1	21DI
TF 39	0.030" Nozzle, 90° Fan Spray Single-Piece Hydro-Flo™ Jet	Black	100/2,500	0.1	21DI
TF 49	0.040" Nozzle, 90° Fan Spray Single-Piece Hydro-Flo™ Jet	Blue	100/2,500	0.1	21DI
TF 59	0.050" Nozzle, 90° Fan Spray Single-Piece Hydro-Flo™ Jet	Green	100/2,500	0.1	21DI
TF 69	0.060" Nozzle, 90° Fan Spray Single-Piece Hydro-Flo™ Jet	Red	100/2,500	0.1	21DI

## SINGLE-OUTLET DEVICES

### Non-Pressure Compensating (continued)



MICRO-FLO™

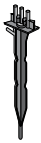

TRI-FLO™

Part No.	Description	Color	Bag Qty./ Box Qty.	Wt. per 100 (lbs.)	Product Class
<b>Micro-Flo™</b>					
MFA	0-25 gph, Micro-Flo™ Adjustable Micro-Sprinkler with Shutoff (10-32 NPT Inlet)*	Red	50/300	1.2	21DI
*Uses SAJ Adapter (page 117)					
<b>Tri-Flo™</b>					
TFS 9	3 Flow Tri-Flo™ Spraystick, 90° Pattern	Blue	100/2,000	0.6	21DI
TFS 16	3 Flow Tri-Flo™ Spraystick, 160° Pattern	Green	100/2,000	0.7	21DI
Use with 1/8" tubing A 185 (page 121). Not recommended for vinyl tubing.					

### Risers & Accessories

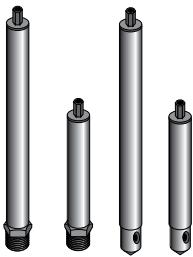

HYDRO-POP™

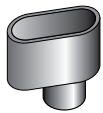

Part No.	Description	Color	Bag Qty./ Box Qty.	Wt. per 100 (lbs.)	Product Class
<b>Hydro-Pop™</b>					
HYP 250	Hydro-Pop™ Pop-up Riser with 1/4" Compression Fit Inlet Maximum 9" Extension (Minimum Pressure Required = 15 PSI)	Black	25/100	12.9	21DI
HYP 500	Hydro-Pop™ Pop-up Riser with 1/2" MPT Inlet Maximum 9" Extension (Minimum Pressure Required = 15 PSI)	Black	25/100	13.1	21DI
HYPJ 250	Hydro-Pop™ Pop-up Riser with 1/4" Compression Fit Inlet Maximum 5" Extension (Minimum Pressure Required = 15 PSI)	Black	25/150	9.7	21DI
HYPJ 500	Hydro-Pop™ Pop-up Riser with 1/2" MPT Inlet Maximum 5" Extension (Minimum Pressure Required = 15 PSI)	Black	25/150	10.0	21DI
PUPS	Hydro-Pop™ Protector Sleeve (Use with TF, DAFT, MF, VF, AF)	Black	25/100	4.3	21DI



## SINGLE-OUTLET DEVICES

### Risers & Accessories (continued)

PROFESSIONAL IRRIGATION



Part No.	Description	Color	Bag Qty./ Box Qty.	Wt. per 100 (lbs.)	Product Class
R 6	6" Riser Extension (0.160" ID x 0.300" OD)	Black	100/2,000	1.0	21DI
R 8	8" Riser Extension (0.160" ID x 0.300" OD)	Black	100/1,500	1.4	21DI
R 12	12" Riser Extension (0.160" ID x 0.300" OD)	Black	100/1,000	2.1	21DI
R 18	18" Riser Extension (0.160" ID x 0.300" OD)	Black	100/600	3.1	21DI
RATT 6	6" Riser (0.160" ID) with Threaded Adapter	Black	100/1,500	1.2	21DI
RATT 8	8" Riser (0.160" ID) with Threaded Adapter	Black	100/1,500	1.5	21DI
RATT 12	12" Riser (0.160" ID) with Threaded Adapter	Black	100/1,000	2.2	21DI
RATT 18	18" Riser (0.160" ID) with Threaded Adapter	Black	N/A/600	3.2	21DI
RABB 8	8" Riser (.160" ID) with Barbed Adapter	Black	100/N/A	1.5	21DI
RABB 12	12" Riser (.160" ID) with Barbed Adapter	Black	100/N/A	2.2	21DI
RABB 18	18" Riser (.160" ID) with Barbed Adapter	Black	100/N/A	3.2	21DI
RABT 6	6" Riser (0.160" ID) with Barbed Adapter	Black	100/1,500	1.1	21DI
RABT 8	8" Riser (0.160" ID) with Barbed Adapter	Black	100/1,500	1.5	21DI
RABT 12	12" Riser (0.160" ID) with Barbed Adapter	Black	100/1,000	2.2	21DI
RABT 18	18" Riser (0.160" ID) with Barbed Adapter	Black	N/A/600	3.2	21DI
S5R6	6" Riser (R6) Pre-assembled onto Elbow Stake (S5)	Black	100/400	2.5	21DI
S5R8	8" Riser (R8) Pre-assembled onto Elbow Stake (S5)	Black	100/400	2.8	21DI
S5R12	12" Riser (R12) Pre-assembled onto Elbow Stake (S5)	Black	100/600	3.6	21DI
CMAP 6	6" Riser Assembly (1/2" MIPT x 0.160" ID/0.300" OD PE Tubing)	Black	100/200	2.8	21DI
CMAP 12	12" Riser Assembly (1/2" MIPT x 0.160" ID/0.300" OD PE Tubing)	Black	100/200	3.6	21DI

### Stake Assemblies

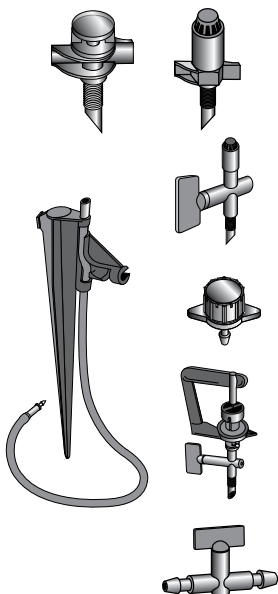

Part No.	Description	Color	Bag Qty./ Box Qty.	Wt. per 100 (lbs.)	Product Class
TA 24-1XY	Jet Assembly Comprising 2-Piece Hydro-Flo™ Jet, 24" Vinyl Tubing with Connector and S 12 Stake X=F (For 360°), H (For 180°), Q (For 90°) Y=3 (Black Base), 4 (Blue Base), 5 (Green Base) 6 (Red Base), 7 (White Base)	Specify	N/A/200	10.9	21DI
TA 24-2XY	Jet Assembly Comprising 1-Piece Hydro-Flo™ Jet, 24" Vinyl Tubing with Connector and S 12 Stake X=F (For 360°), H (For 180°), Q (For 90°) Y=3 (Black Orifice), 4 (Blue Orifice), 5 (Green Orifice) 6 (Green Orifice), 7 (Red Orifice)	Specify	N/A/200	10.8	21DI
TA 24-3X	Jet Assembly Comprising Adjustable Hydro-Flo™ Jet, 24" Vinyl Tubing with Connector and S 12 Stake X=F (For 360°), H (For 180°), Q (For 90°)	Black	N/A/200	11.2	21DI
TA 24-4	Assembly Comprising 24" Vinyl Tubing, Connector and S 12 Stake (No Jet)	Black	N/A/200	10.7	21DI
TA 24-5	Emitter Assembly Comprising Dial-a-Flo™ (DAFB 360), 24" Vinyl Tubing with Connector and S 12 Stake	Black	N/A/200	11.2	21DI
TA 24-6	Jet Assembly Comprising Adjustable Micro-Flo™ Sprinkler (MFA), 24" Vinyl Tubing with Connector and S 12 Stake	Black	N/A/200	11.9	21DI
TA 24-7	Assembly Comprising 24" Vinyl Tubing with Connector, Valve for Flow Adjustment and S 12 Stake	Black	N/A/200	11.1	21DI

## MULTI-OUTLET DEVICES

### Fixed Flow Rate Devices

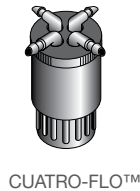

Part No.	Description	Color	Bag Qty./ Box Qty.	Wt. per 100 (lbs.)	Product Class
<b>Cuatro-Flo™</b>					
CFL 2	2 gph/Outlet Bubbler, 4 Swivel Barbed Outlets 1/2" FIPT, Pressure Compensating Cuatro-Flo™ Bubbler	Blue	25/100	5.5	21DI
CFL 6	6 gph/Outlet Bubbler, 4 Swivel Barbed Outlets 1/2" FIPT, Pressure Compensating Cuatro-Flo™ Bubbler	Black	25/100	5.5	21DI
CFL 10	10 gph/Outlet Bubbler, 4 Swivel Barbed Outlets 1/2" FIPT, Pressure Compensating Cuatro-Flo™ Bubbler	Red	25/100	5.5	21DI
CFL 20	20 gph/Outlet Bubbler, 4 Swivel Barbed Outlets 1/2" FIPT, Pressure Compensating Cuatro-Flo™ Bubbler	Green	25/100	5.5	21DI
<b>Maxi-Flo™</b>					
MFBL 2	2 gph/Outlet, 1/2" FIPT, 6 Swivel Barbed Outlets, Compensating Maxi-Flo™ Bubbler	Blue	25/100	10.2	21DI
MFBL 6	6 gph/Outlet, 1/2" FIPT, 6 Swivel Barbed Outlets, Compensating Maxi-Flo™ Bubbler	Black	25/100	10.2	21DI
MFBL 10	10 gph/Outlet, 1/2" FIPT, 6 Swivel Barbed Outlets, Compensating Maxi-Flo™ Bubbler	Red	25/100	10.2	21DI
MFBL 20	20 gph/Outlet, 1/2" FIPT, 6 Swivel Barbed Outlets, Compensating Maxi-Flo™ Bubbler	Green	25/100	10.2	21DI
Use MVI for the replacement swivel valves, and 1/4" tubing such as A 220 (page XX) or JR Dripperline (page XX)					
<b>Power-Flo™</b>					
PF 2	2 gph/Outlet, 1/2" FIPT, 8 Swivel Barbed Outlets, Compensating Power-Flo™ Bubbler	Blue	10/100	18.5	21DI
PF 6	6 gph/Outlet, 1/2" FIPT, 8 Swivel Barbed Outlets, Compensating Power-Flo™ Bubbler	Black	10/100	18.5	21DI
PF 10	10 gph/Outlet, 1/2" FIPT, 8 Swivel Barbed Outlets, Compensating Power-Flo™ Bubbler	Red	10/100	18.5	21DI
PF 20	20 gph/Outlet, 1/2" FIPT, 8 Swivel Barbed Outlets, Compensating Power-Flo™ Bubbler	Green	10/100	18.5	21DI

PROFESSIONAL IRRIGATION

### Adjustable Flow Rate Devices

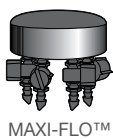

Part No.	Description	Color	Bag Qty./ Box Qty.	Wt. per 100 (lbs.)	Product Class
<b>Maxi-Flo™</b>					
MFBA	0-20 gph, Adjustable Flow, 1/2" FIPT, 6 Outlet, Compensating Maxi-Flo™ Adjustable Bubbler	Green	25/75	11.8	21DI
Use MVI (page 104) for the replacement swivel valves, and 1/4" tubing such as A 220 (page 117) or JR Dripperline (page 95)					
<b>Hydroport™</b>					
HPAM 4	0-20 gph, Adjustable Flow, 1/2" FIPT, 4 Port Outlet Hydroport™ Adjustable Manifold	Black	10/30	30.0	21DI
HPAM 8	0-20 gph, Adjustable Flow, 1/2" FIPT, 8 Port Outlet Hydroport™ Adjustable Manifold	Black	10/30	30.0	21DI

## MULTI-OUTLET DEVICES

### Bubbler Accessories



Part No.	Description	Color	Bag Qty./ Box Qty.	Wt. per 100 (lbs.)	Product Class
PC 250	Port Cap for Unused Outlets on Maxi-Flo™ (MFBL), Cuatro-Flo™ (CFL), and Power-Flo™ (PF) Bubbler	Black	100/2,500	0.1	21DI
OP 250	Outlet Plug for up to 2 Unused Outlets on Cuatro-Flo™ (CF) Drip Bubbler	Black	100/2,000	0.1	21DI
PFFC 6	6 gph Flow Controlling Insert for Power-Flo™ Bubbler	Black	100/1,000	0.1	21DI

### Spare Parts

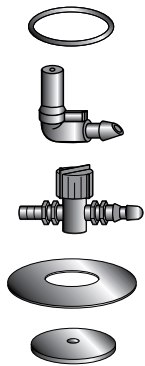

Part No.	Description	Color	Bag Qty./ Box Qty.	Wt. per 100 (lbs.)	Product Class
OR 141	Replacement O-Ring for Power-Flo™ Bubbler	Black	10/100	0.3	21DI
ELI	Replacement Swivel Elbow for MFBL, CFL and PF Bubblers	Black	10/100	0.2	21DI
MVI	Replacement Swivel Valve for MFBA Bubbler	Black	10/50	0.5	21DI
D 90	Replacement Diaphragm for Power-Flo™ Bubbler	Black	10/20	0.8	21DI
D 80 H	Replacement Diaphragm for Cuatro-Flo™ (CF) Bubbler	Black	10/20	0.1	21DI

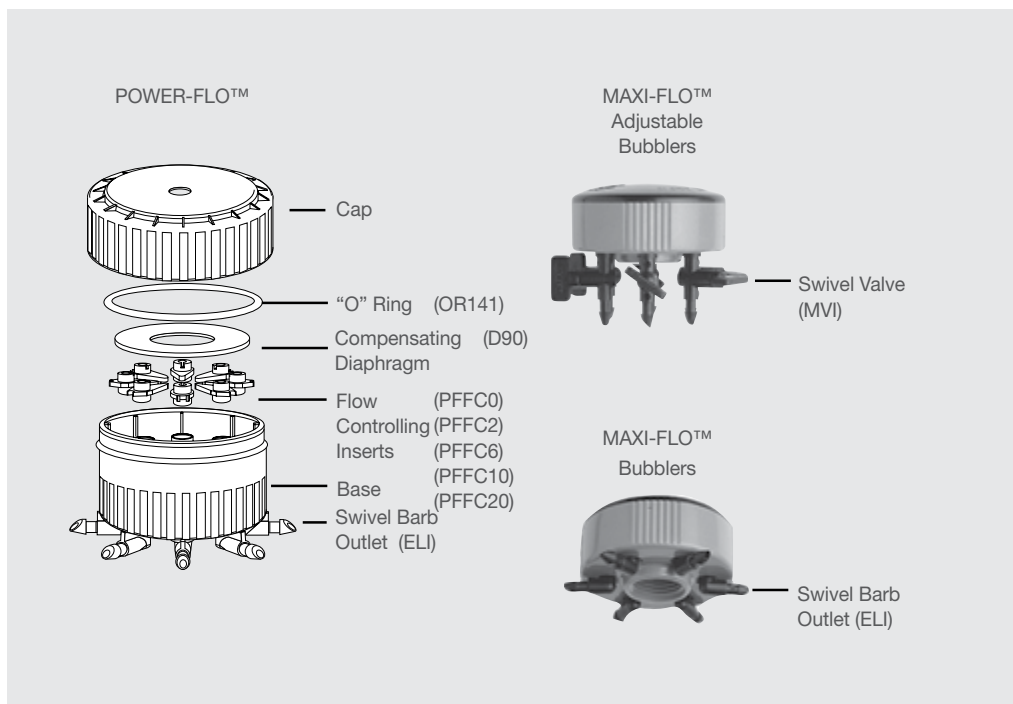



## ADJUSTABLE EMITTERS – TECHNICAL INFORMATION





Hydro-Flo™ Jet (Adjustable) Model VF90 / VF180 / VF360

Radius (Feet)	Discharge (gph)		
	VF90	VF180	VF360
1 FT.	—	—	4.0 gph
2 FT.	—	6.5 gph	5.7 gph
3 FT.	12.4 gph	8.3 gph	7.8 gph
4 FT.	14.5 gph	10.2 gph	10.5 gph
5 FT.	16.2 gph	12.1 gph	12.7 gph
6 FT.	18.6 gph	14.5 gph	14.8 gph
7 FT.	20.1 gph	17.1 gph	16.8 gph
8 FT.	23.0 gph	21.8 gph	18.0 gph
9 FT.	25.3 gph	26.4 gph	21.2 gph
10 FT.	27.6 gph	—	23.5 gph
11 FT.	29.3 gph	—	25.6 gph
12 FT.	—	—	27.6 gph

Micro-Flo™  
Micro-Sprinkler Model MFA

Radius (Feet)	Discharge (gph)
1 FT.	—
2 FT.	—
3 FT.	4.7 gph
4 FT.	6.6 gph
5 FT.	8.2 gph
6 FT.	9.8 gph
7 FT.	11.3 gph
8 FT.	13.2 gph
9 FT.	14.8 gph
10 FT.	16.4 gph

Dial-a-Flo™ Emitters

Part No.	Pattern
DAFB-360 / DAFT-360 DAFS-360 / DAFU-360	
DAFB-180 / DAFT-180 DAFS-180 / DAFU-180	
DAFB-FAN / DAFT-FAN DAFS-FAN / DAFU-FAN	
DAFS-135	
DAFB-BUB / DAFT-BUB DAFS-BUB / DAFU-BUB	

Model DAFB-360 / DAFT-360 / DAFS-360 / DAFU-360

Position	20 PSI		30 PSI		40 PSI	
	Discharge	Radius	Discharge	Radius	Discharge	Radius
0	0 gph	0"	0 gph	0"	0 gph	0"
1	1.8 gph	0"	2.3 gph	0"	2.7 gph	0"
2	2.4 gph	0"	3.1 gph	0"	3.5 gph	2"
3	3.0 gph	0"	3.9 gph	2"	4.6 gph	3"
4	3.7 gph	2"	4.8 gph	3"	5.6 gph	4"
5	4.4 gph	3"	5.7 gph	4"	6.7 gph	5"
6	5.0 gph	4"	6.5 gph	6"	7.6 gph	8"
7	5.6 gph	5"	7.2 gph	7"	8.4 gph	10"
8	6.2 gph	6"	8.1 gph	9"	9.1 gph	12"
1+	7.0 gph	7"	9.1 gph	11"	10.4 gph	14"
2+	7.9 gph	9"	10.3 gph	12"	11.7 gph	16"

Model DAFB-180 / DAFS-180 / DAFU-180 / DAFS-135

Position	20 PSI		30 PSI		40 PSI	
	Discharge	Radius	Discharge	Radius	Discharge	Radius
0	0 gph	0"	0 gph	0"	0 gph	0"
1	1.8 gph	4"	2.3 gph	6"	2.7 gph	9"
2	2.4 gph	7"	3.1 gph	10"	3.5 gph	13"
3	3.0 gph	9"	3.9 gph	13"	4.6 gph	18"
4	3.7 gph	11"	4.8 gph	16"	5.6 gph	24"
5	4.4 gph	13"	5.7 gph	19"	6.7 gph	30"
6	5.0 gph	15"	6.5 gph	24"	7.6 gph	35"
7	5.6 gph	18"	7.2 gph	27"	8.4 gph	40"
8	6.2 gph	21"	8.1 gph	30"	9.1 gph	44"
1+	7.0 gph	24"	9.1 gph	33"	10.4 gph	46"
2+	7.9 gph	26"	10.3 gph	36"	11.7 gph	48"

Model DAFB-FAN / DAFS-FAN / DAFU-FAN

Position	20 PSI		30 PSI		40 PSI	
	Discharge	Radius	Discharge	Radius	Discharge	Radius
0	0 gph	0"	0 gph	0"	0 gph	0"
1	3.8 gph	0"	5.0 gph	0"	5.8 gph	0"
2	6.3 gph	0"	8.2 gph	12"	9.5 gph	18"
3	9.5 gph	18"	12.4 gph	24"	14.3 gph	36"
4	10.6 gph	21"	13.6 gph	30"	16.0 gph	42"
5	11.4 gph	24"	14.8 gph	36"	17.1 gph	48"
6	12.1 gph	27"	15.6 gph	42"	18.1 gph	54"
7	13.0 gph	30"	16.5 gph	48"	19.0 gph	57"
8	13.5 gph	33"	17.1 gph	52"	20.0 gph	59"
1+	14.0 gph	35"	18.1 gph	54"	20.9 gph	61"
2+	14.3 gph	36"	18.7 gph	56"	21.6 gph	62"

Model DAFB-BUB / DAFS-BUB / DAFU-BUB / DAFT-BUB

Position	20 PSI		30 PSI		40 PSI	
	Discharge	Radius	Discharge	Radius	Discharge	Radius
0	0 gph	0"	0 gph	0"	0 gph	0"
1	3.8 gph	0"	5.0 gph	0"	5.8 gph	0"
2	6.3 gph	0"	8.2 gph	0"	9.5 gph	0"
3	9.5 gph	0"	12.4 gph	0"	14.3 gph	1"
4	10.6 gph	0"	13.6 gph	1"	16.0 gph	2"
5	11.4 gph	1"	14.8 gph	1"	17.1 gph	3"
6	12.1 gph	1"	15.6 gph	2"	18.1 gph	3"
7	13.0 gph	1"	16.5 gph	2"	19.0 gph	4"
8	13.5 gph	1"	17.1 gph	3"	20.0 gph	4"
1+	14.0 gph	2"	18.1 gph	3"	20.9 gph	5"
2+	14.3 gph	2"	18.7 gph	4"	21.6 gph	5"

## TECHNICAL INFORMATION – DRIP & MICRO-SPRAY EMITTERS

### Discharge Rates (GPH)

Model	Part No.	10 PSI	15 PSI	20 PSI	25 PSI	30 PSI	40 PSI	60 PSI	80 PSI
Maxi-Flo™ Bubbler	MFBL 2			2.2 gph	2.3 gph	2.4 gph	2.5 gph	2.6 gph	2.6 gph
	MFBL 6			5.7 gph	6.3 gph	6.9 gph	7.7 gph	9.1 gph	9.5 gph
	MFBL 10			9.0 gph	9.7 gph	10.4 gph	11.6 gph	14.1 gph	15.3 gph
	MBFL 20			16.4 gph	17.7 gph	19.0 gph	22.1 gph	26.7 gph	28.2 gph
	MFBA			16.4 gph (Max)	17.7 gph (Max)	19.0 gph (Max)	22.1 gph (Max)		
Hydroport™	HPAM 4	7.0 gph (Max)	10.0 gph (Max)	12.0 gph (Max)	13.0 gph (Max)	14.0 gph (Max)	16.0 gph (Max)	20.0 gph (Max)	
	HPAM 8	7.0 gph (Max)	10.0 gph (Max)	12.0 gph (Max)	13.0 gph (Max)	14.0 gph (Max)	16.0 gph (Max)	20.0 gph (Max)	
Power-Flo™ Bubbler	PF 2			2.2 gph	2.3 gph	2.4 gph	2.5 gph	2.6 gph	2.6 gph
	PF 6			5.7 gph	6.3 gph	6.9 gph	7.7 gph	9.1 gph	9.5 gph
	PF 10			9.0 gph	9.7 gph	10.4 gph	11.6 gph	14.1 gph	15.3 gph
	PF 20			16.4 gph	17.7 gph	19.0 gph	22.1 gph	26.7 gph	28.2 gph
Super-Flo™ Emitter	UFC 10	1.10 gph	1.15 gph	1.20 gph	1.22 gph	1.22 gph	1.23 gph		
	UFC 20	2.10 gph	2.15 gph	2.20 gph	2.22 gph	2.23 gph	2.25 gph		
	TAE 10	0.56 gph	0.70 gph	0.80 gph	0.89 gph	0.97 gph			

### Maximum Recommended Length of Run (Feet)

#### Hydro-Flo™ Jets, Micro-Flo™ Micro-Sprinkler

Orifice	Initial Pressure	I.D. of Tubing (inches)											
		.600"	.820"	1.040"	.600"	.820"	1.040"	.600"	.820"	1.040"	.600"	.820"	1.040"
		Average Spacing Between Jets (feet)											
		6'			9'			12'			15'		
0.030"	20 PSI	210'	400'	620'	275'	520'	810'	340'	645'	1,000'	385'	730'	1,130'
0.040"	20 PSI	140'	265'	415'	185'	350'	545'	225'	425'	600'	250'	475'	735'
0.050"	20 PSI	110'	210'	325'	145'	275'	425'	175'	330'	515'	195'	370'	575'
0.060"	20 PSI	85'	160'	250'	110'	210'	330'	135'	255'	400'	150'	290'	450'

#### Tri-Flo™ Spray Stick

Model	Flow Node	Initial Pressure	I.D. of Tubing (inches)									
			.600"	.820"	.600"	.820"	.600"	.820"	.600"	.820"	.600"	.820"
			Average Spacing Between Spray Sticks (inches)									
			12"		24"		36"		48"		60"	
TFS 9	Low	20 PSI	75'	140'	115'	220'	150'	285'	180'	340'	210'	400'
	Medium	20 PSI	55'	105'	85'	160'	110'	205'	135'	250'	155'	290'
	High	20 PSI	45'	85'	70'	130'	90'	170'	110'	205'	125'	235'
TFS 16	Low	20 PSI	55'	105'	85'	160'	110'	205'	135'	250'	155'	290'
	Medium	20 PSI	45'	85'	70'	130'	90'	170'	110'	205'	125'	235'
	High	20 PSI	35'	65'	55'	105'	75'	140'	90'	170'	105'	200'

## TECHNICAL INFORMATION – MICRO SPRAY EMITTERS

### Discharge Rates (GPH) / Radius (feet)

Model	Part No.	15 PSI		20 PSI		25 PSI		30 PSI		40 PSI		45 PSI	
		Discharge	Radius	Discharge	Radius	Discharge	Radius	Discharge	Radius	Discharge	Radius	Discharge	Radius
Hydro-Flo™ Jet	TFB 30 (Black)	4.8 gph	5.0'	5.5 gph	6.0'	6.2 gph	7.0'	6.8 gph	8.0'				
	TFB 40 (Blue)	8.8 gph	7.0'	10.4 gph	8.0'	11.7 gph	8.0'	12.9 gph	9.0'				
	TFB 50 (Green)	13.8 gph	8.0'	15.8 gph	9.0'	17.7 gph	9.0'	19.5 gph	10.0'				
	TFB 60 (Red)	20.0 gph	8.0'	23.3 gph	9.0'	26.3 gph	10.0'	28.9 gph	11.0'				
	TFB 70 (White)	32.9 gph	9.0'	37.6 gph	10.0'	42.5 gph	11.0'	46.6 gph	12.0'				
	TF 336 (Black)	4.8 gph	4.0'	5.5 gph	4.5'	6.2 gph	5.0'	6.8 gph	5.0'				
	TF 436 (Blue)	8.8 gph	4.5'	10.4 gph	5.0'	11.7 gph	5.5'	12.9 gph	5.5'				
	TF 536 (Green)	13.8 gph	5.0'	15.8 gph	5.5'	17.7 gph	6.0'	19.5 gph	6.0'				
	TF 636 (Red)	20.0 gph	5.0'	23.3 gph	5.5'	26.3 gph	6.0'	28.9 gph	6.5'				
	TF 318 (Black)	4.8 gph	3.0'	5.5 gph	3.5'	6.2 gph	4.0'	6.8 gph	4.5'				
	TF 418 (Blue)	8.8 gph	3.5'	10.4 gph	4.0'	11.7 gph	4.5'	12.9 gph	5.0'				
	TF 518 (Green)	13.8 gph	4.0'	15.8 gph	4.5'	17.7 gph	5.0'	19.5 gph	5.5'				
	TF 618 (Red)	20.0 gph	4.5'	23.3 gph	5.0'	26.3 gph	5.5'	28.9 gph	6.0'				
	TF 39 (Black)	4.8 gph	4.0'	5.5 gph	4.5'	6.2 gph	5.5'	6.8 gph	6.0'				
	TF 49 (Blue)	8.8 gph	4.5'	10.4 gph	5.0'	11.7 gph	5.5'	12.9 gph	6.0'				
	TF 59 (Green)	13.8 gph	4.5'	15.8 gph	5.5'	17.7 gph	6.0'	19.5 gph	6.5'				
	TF 69 (Red)	20.2 gph	5.0'	23.3 gph	5.5'	26.3 gph	6.0'	28.9 gph	6.5'				
	AF 3xx (Black)	5.7 gph	5.0'	6.5 gph	6.0'	7.3 gph	7.0'	8.0 gph	8.0'				
Micro-Flo™ Micro-Sprinkler	MF 35 (Orange)	6.6 gph	6.0'	7.7 gph	7.0'	8.6 gph	8.0'	9.4 gph	8.0'				
	MF 40 (Blue)	8.6 gph	7.0'	10.0 gph	8.0'	11.3 gph	9.0'	12.4 gph	9.0'				
	MF 50 (Green)	13.6 gph	8.0'	16.0 gph	9.0'	17.9 gph	10.0'	19.7 gph	10.0'				
Tri-Flo™ Spray Stick	TFS 9 - Low	4.8 gph	1.0'	5.3 gph	1.5'	6.0 gph	2.0'						
	TFS 9 - Medium	7.1 gph	1.5'	7.9 gph	2.0'	9.0 gph	2.5'						
	TFS 9 - High	9.5 gph	3.0'	10.6 gph	3.5'	12.0 gph	4.0'						
	TFS 16 - Low	7.1 gph	1.5'	7.9 gph	2.0'	9.0 gph	2.5'						
	TFS 16 - Medium	9.5 gph	2.5'	10.6 gph	3.0'	12.0 gph	3.5'						
TFS 16 - High	14.3 gph	3.5'	15.9 gph	4.0'	18.0 gph	4.5'							
Misti-Flo™ Mister	MFM 4	3.7 gph	4.5'	4.4 gph	5.0'	5.0 gph	5.5'	5.5 gph	6.0'	5.9 gph	6.5'	6.3 gph	7.0'

PROFESSIONAL IRRIGATION

Model	Part No.	Pattern
Hydro-Flo™ Jet	TFC 360	
	TFC 300	
	TFC 180, TF 318, TF 418, TF 518, TF 618	
	TFC 90, TF 39, TF 49, TF 59, TF 69	
	TF 336, TF 436, TF 536, TF 636	
	TFC 33	

Model	Part No.	Pattern
Tri-Flo™ Spray Stick	TFS 9	
	TFS 16	

### Flushing Characteristics of Compensating Emitters\*

Nominal Flow	Peak Flush Flow	Peak Flush Pressure
1	1.6 gph	3 PSI
2	3.0 gph	3 PSI

\*Includes Mono Flo™ and Uni Flo™ Classic emitters.

## FITTINGS & ACCESSORIES

### Smart-Loc™ Multi-Diameter Fittings

PROFESSIONAL IRRIGATION



Part No.	Description	Color	Bag Qty./ Box Qty.	Wt. per 100 (lbs.)	Product Class
CMAP 75-18	3/4" Male Pipe Thread Adaptor (Fits 16mm, 17mm & 18mm Tubing)	Black	25/250	0.375	21DI
SLC 18	Coupling (Fits 16mm, 17mm & 18mm Tubing)	Black	25/250	0.375	21DI
CEP 18	End Plug (Fits 16mm, 17mm & 18mm Tubing)	Black	25/250	0.375	21DI
CEL 18	Elbow (Fits 16mm, 17mm & 18mm Tubing)	Black	25/250	0.375	21DI
CMAH 18	Male Hose Thread Adaptor (Fits 16mm, 17mm & 18mm Tubing)	Black	25/250	0.375	21DI
CSA 18	Swivel Adaptor Female Hose Thread (Fits 16mm, 17mm & 18mm Tubing)	Black	25/250	0.375	21DI
CMAH 5-18	1/2" Male Pipe Thread Adaptor (Fits 16mm, 17mm & 18mm Tubing)	Black	25/250	0.375	21DI
CT 18	Tee (Fits 16mm, 17mm & 18mm Tubing)	Black	25/250	0.375	21DI

### Specifications

- Connect 16mm-18mm 1/2" polyethylene tubing
- Reduces Inventory
- Ideal for Tubing Repairs
- Durable Under the Most Demanding Conditions
- 8-80 PSI
- Accepts tubing OD of .620" to .710" (16mm-18mm)
- Made from UV-resistant, high-quality ABS material
- Reusable design – Tubing can be inserted & removed without damaging the fitting

### WORKS WITH

### DURA FLO™ DRIPLINE

and parts A620, A660, A700, A710 Supply Tubing





## FITTINGS & ACCESSORIES

### 17MM Insert Fittings



Part No.	Description	Color	Bag Qty./ Box Qty.	Wt. per 100 (lbs.)	Product Class
BTMA 1750	Agrifim 17mm Insert x 1/2" MPT Adapter	Brown	10/bag	1.71	21DI
BTMA 1775	Agrifim 17mm Insert x 3/4" MPT Adapter	Brown	10/bag	2.40	21DI
BV 17	Agrifim 17mm Insert Ball Valve	Black	–	4.10	21DI
C 17	Agrifim 17mm Insert Coupling	Brown	25/bag	2.25	21DI
CX 17	Agrifim 17mm Insert Cross	Brown	–	–	21DI
EL 17	Agrifim 17mm Insert Elbow	Brown	25/bag	1.32	21DI
T 17	Agrifim 17mm Insert Tee	Brown	25/bag	1.73	21DI
TMA 1750	Agrifim 17mm Insert Tee x 1/2" MPT Adapter	Brown	–	2.35	21DI
YMA 1775	Agrifim 17mm Insert Y x 3/4" MPT Adapter	Brown	–	4.15	21DI

PROFESSIONAL IRRIGATION

### 16MM Insert Fittings

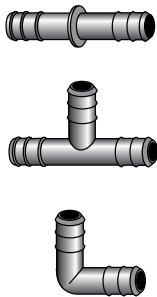

Part No.	Description	Color	Bag Qty./ Box Qty.	Wt. per 100 (lbs.)	Product Class
C 520	Insert Barbed Coupling (Fits A 620 Tubing)	Black	100/1,000	0.8	21DI
T 520	Insert Barbed Tee (Fits A 620 Tubing)	Black	100/600	1.0	21DI
EL 520	Insert Barbed Elbow (Fits A 620 Tubing)	Black	100/400	1.1	21DI

NOTE: Fittings are used inside tubing.

## FITTINGS & ACCESSORIES

### Compression Solvent Weld Adapters

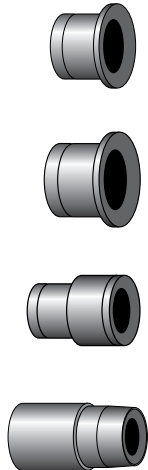

Part No.	Description	Color	Bag Qty./ Box Qty.	Wt. per 100 (lbs.)	Product Class
CA 250	Compression Adapter (1/2" Slip x .250" OD Tubing)	Orange	100/2,000	0.6	21DI
Use w/A 250 Tubing (1/4" Tubing)					
CA 300	Compression Adapter (1/2" Slip x .307" OD Tubing)	Grey	100/2,000	0.6	21DI
CA 500	Compression Adapter (1/2" Slip x .455" to .480" OD Tubing)	Red	100/2,000	0.6	21DI
Use w/A 455 Tubing (3/8" Tubing)					
CA 600	Compression Adapter (1/2" Slip x .610" to .640" OD Tubing)	Green	100/2,000	0.5	21DI
Use w/A 620 Tubing (1/2" Tubing)					
CA 700	Compression Adapter (1/2" Slip x .680" to .704" OD Tubing)	Black	100/2,000	0.4	21DI
Use w/A 700 Tubing (1/2" Tubing)					
CA 710	Compression Adapter (1/2" Slip x .704" to .710" OD Tubing)	Blue	100/2,000	0.4	21DI
Use w/A 710 Tubing (1/2" Tubing)					
CA 800	Compression Adapter (3/4" Slip x .830" OD Tubing)	Black	100/1,000	0.8	21DI
CA 900	Compression Adapter (3/4" Slip x .940" OD Tubing)	Grey	100/1,000	0.8	21DI
Use w/A 940 Tubing (3/4" Tubing)					
LCA 700	1/2" Compression Adapter (Long) (1/2" Slip x .680" to .704" OD Tubing)	Black	50/800	1.3	21DI
Use w/A 700 Tubing (1/2" Tubing)					
LCA 710	1/2" Compression Adapter (Long) (1/2" Slip x .704" to .710" OD Tubing)	Blue	50/800	1.3	21DI
Use w/A 710 Tubing (1/2" Tubing)					
SA 700	Socket Adapter - ID Bonds Over 1/2" PVC Pipe, OD Bonds into 3/4" PVC Socket	Black	100/600	1.5	21DI
Use w/A 700 Tubing (1/2" Tubing)					

### Compression Fittings

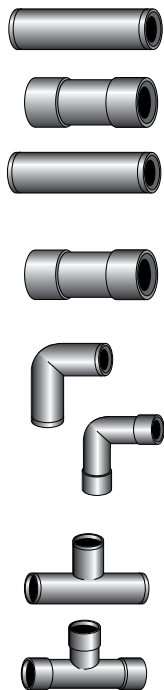

Part No.	Description	Color	Bag Qty./ Box Qty.	Wt. per 100 (lbs.)	Product Class
CC 600	Compression Coupling (Fits .610" to .640" OD Tubing i.e. A 620)	Green	25/1,000	2.8	21DI
CC 700	Compression Coupling (Fits .680" to .704" OD Tubing i.e. A 700)	Black	25/1,000	2.8	21DI
CC 710	Compression Coupling (Fits .704" to .710" OD Tubing i.e. A 710)	Blue	25/1,000	2.7	21DI
CC 800	Compression Coupling (Fits .830" OD Tubing)	Black	25/500	6.0	21DI
CC 900	Compression Coupling (Fits .940" OD Tubing i.e. A 940)	Grey	25/500	5.7	21DI
RCC 6070	Reducing Compression Coupling (600 Series to 700 Series)	Green	25/1,000	2.9	21DI
RCC 6071	Reducing Compression Coupling (600 Series to 710 Series)	Blue	25/1,000	2.8	21DI
RCC 7071	Reducing Compression Coupling (700 Series to 710 Series)	Blue	25/1,000	2.7	21DI
RCC 8090	Reducing Compression Coupling (800 Series to 900 Series)	Black/Grey	25/500	5.7	21DI
RCC 7090	Reducing Compression Coupling (700 Series to 900 Series)	Black/Grey	25/500	4.0	21DI
CEL 600	Compression Elbow (.610" to .640" OD Tubing i.e. A 620)	Green	25/800	3.9	21DI
CEL 700	Compression Elbow (.680" to .704" OD Tubing i.e. A 700)	Black	25/800	3.7	21DI
CEL 710	Compression Elbow (.704" to .710" OD Tubing i.e. A 710)	Blue	25/800	3.7	21DI
CEL 800	Compression Elbow (Fits .830" OD Tubing)	Black	25/500	6.1	21DI
CEL 900	Compression Elbow (Fits .940" OD Tubing i.e. A 940)	Grey	25/500	5.9	21DI
CT 600	Compression Tee (.610" to .640" OD Tubing i.e. A 620)	Green	15/480	5.5	21DI
CT 700	Compression Tee (.680" to .704" OD Tubing i.e. A 700)	Black	15/480	5.2	21DI
CT 710	Compression Tee (.704" to .710" OD Tubing i.e. A 710)	Blue	15/480	5.2	21DI
CT 800	Compression Tee (Fits .830" OD Tubing)	Black	25/300	8.7	21DI
CT 900	Compression Tee (Fits .940" OD Tubing i.e. A 940)	Grey	25/300	8.4	21DI

## FITTINGS & ACCESSORIES

### Compression End Caps

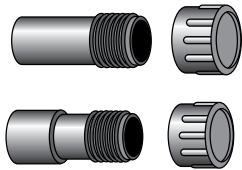

Part No.	Description	Color	Bag Qty./ Box Qty.	Wt. per 100 (lbs.)	Product Class
CEP 600	End Plug with Cap (Fits .610" to .640" OD Tubing i.e. A 620)	Green	25/800	4.0	21DI
CEP 700	End Plug with Cap (Fits .680" to .704" OD Tubing i.e. A 700)	Black	25/800	4.0	21DI
CEP 710	End Plug with Cap (Fits .704" to .710" OD Tubing i.e. A 710)	Blue	25/800	4.0	21DI
CEP 800	End Plug with Cap (Fits .830" OD Tubing)	Black	25/600	5.1	21DI
CEP 900	End Plug with Cap (Fits .940" OD Tubing i.e. A 940)	Grey	25/600	5.1	21DI

Note: All caps are unscrewing caps.

### Compression Male Adapters

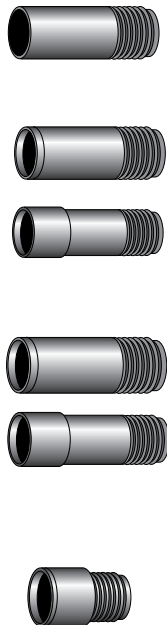

Part No.	Description	Color	Bag Qty./ Box Qty.	Wt. per 100 (lbs.)	Product Class
CMAH	3/4" MHT x 1/2" Slip Socket Adapter	Black	50/1,000	1.8	21DI
CMAH 600	3/4" MHT Adapter (Fits .610" to .640" OD Tubing i.e. A 620)	Green	50/1,000	2.3	21DI
CMAH 700	3/4" MHT Adapter (Fits .680" to .704" OD Tubing i.e. A 700)	Black	50/1,000	2.2	21DI
CMAH 710	3/4" MHT Adapter (Fits .704" to .710" OD Tubing i.e. A 710)	Blue	50/1,000	2.2	21DI
CMAH 800	3/4" MHT Adapter (Fits .830" OD Tubing)	Black	25/700	3.4	21DI
CMAH 900	3/4" MHT Adapter (Fits .940" OD Tubing i.e. A 940)	Grey	25/700	3.3	21DI
CMAP 600	3/4" MIPT Adapter (Fits .610" to .640" OD Tubing)	Green	50/1,000	2.2	21DI
CMAP 700	3/4" MIPT Adapter (Fits .680" to .704" OD Tubing)	Black	50/1,000	2.2	21DI
CMAP 710	3/4" MIPT Adapter (Fits .704" to .710" OD Tubing)	Blue	50/1,000	2.1	21DI
CMAP 800	3/4" MIPT Adapter (Fits .830" OD Tubing)	Black	25/800	3.5	21DI
CMAP 900	3/4" MIPT Adapter (Fits .940" OD Tubing)	Grey	25/800	3.3	21DI
CMAP5-600	1/2" MIPT Adapter (Fits .610" to .640" OD Tubing)	Green	50/1,000	1.6	21DI
CMAP5-700	1/2" MIPT Adapter (Fits .680" to .704" OD Tubing)	Black	50/1,000	1.5	21DI
CMAP5-710	1/2" MIPT Adapter (Fits .704" to .710" OD Tubing)	Blue	50/1,000	1.5	21DI

## FITTINGS & ACCESSORIES

### Compression 3/4" Swivel Fittings

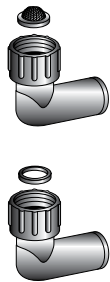
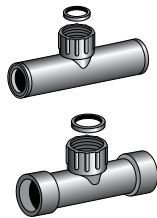
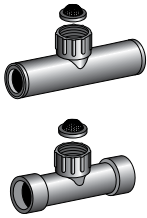
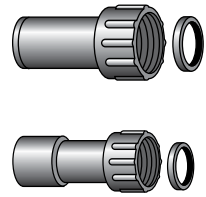
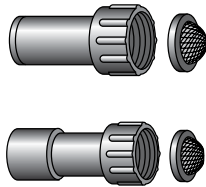

Part No.	Description	Color	Bag Qty./ Box Qty.	Wt. per 100 (lbs.)	Product Class
CSA 600	3/4" FHT Swivel Adapter (Fits .610" to .640" OD Tubing i.e. A 620)	Green	25/800	3.8	21DI
CSA 700	3/4" FHT Swivel Adapter (Fits .680" to .704" OD Tubing i.e. A 700)	Black	25/800	3.8	21DI
CSA 710	3/4" FHT Swivel Adapter (Fits .704" to .710" OD Tubing i.e. A 710)	Blue	25/800	3.6	21DI
CSA 800	3/4" FHT Swivel Adapter (Fits .830" OD Tubing)	Black	25/600	5.0	21DI
CSA 900	3/4" FHT Swivel Adapter (Fits .940" OD Tubing i.e. A 940)	Grey	25/600	4.8	21DI
Note: All adapters include screens as shown.					
CSAW 600	3/4" FHT Swivel Adapter w/Washer (Fits .610" to .640" OD Tubing)	Green	25/800	3.6	21DI
CSAW 700	3/4" FHT Swivel Adapter w/Washer (Fits .680" to .704" OD Tubing)	Black	25/800	3.5	21DI
CSAW 710	3/4" FHT Swivel Adapter w/Washer (Fits .704" to .710" OD Tubing)	Blue	25/800	3.5	21DI
CSAW 800	3/4" FHT Swivel Adapter w/Washer (Fits .830" OD Tubing)	Black	25/600	4.7	21DI
CSAW 900	3/4" FHT Swivel Adapter w/Washer (Fits .940" OD Tubing)	Grey	25/600	4.7	21DI
CST 600	3/4" FHT Swivel Tee w/Screen (Fits .610" to .640" OD Tubing)	Green	15/480	6.4	21DI
CST 700	3/4" FHT Swivel Tee w/Screen (Fits .680" to .704" OD Tubing)	Black	15/480	6.2	21DI
CST 710	3/4" FHT Swivel Tee w/Screen (Fits .704" to .710" OD Tubing)	Blue	15/480	6.3	21DI
CST 900	3/4" FHT Swivel Tee w/Screen (Fits .940" OD Tubing)	Grey	25/300	8.3	21DI
CSTW 600	3/4" FHT Swivel Tee w/Washer (Fits .610" to .640" OD Tubing)	Green	15/480	6.0	21DI
CSTW 700	3/4" FHT Swivel Tee w/Washer (Fits .680" to .704" OD Tubing)	Black	15/480	5.9	21DI
CSTW 710	3/4" FHT Swivel Tee w/Washer (Fits .704" to .710" OD Tubing)	Blue	15/480	6.0	21DI
CSTW 900	3/4" FHT Swivel Tee w/Washer (Fits .940" OD Tubing)	Grey	25/300	8.0	21DI
CSEL 700	3/4" FHT Swivel Elbow w/Screen (Fits .680" to .704" OD Tubing)	Black	25/500	4.7	21DI
CSEL 710	3/4" FHT Swivel Elbow w/Screen (Fits .704" to .710" OD Tubing)	Blue	25/500	4.7	21DI
CSELW 600	3/4" FHT Swivel Elbow w/Washer (Fits .610" to .640" OD Tubing)	Green	25/500	4.4	21DI
CSELW 700	3/4" FHT Swivel Elbow w/Washer (Fits .680" to .704" OD Tubing)	Black	25/500	4.4	21DI
CSELW 710	3/4" FHT Swivel Elbow w/Washer (Fits .704" to .710" OD Tubing)	Blue	25/500	4.4	21DI



## FITTINGS & ACCESSORIES

### Micro Fittings

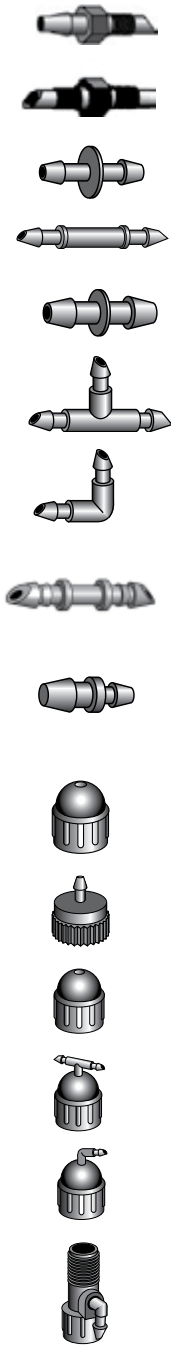

Part No.	Description	Color	Bag Qty./ Box Qty.	Wt. per 100 (lbs.)	Product Class
BT 250	Adapter - Barb x Thread (Fits 0.160" ID - 0.170" ID Tubing)	Black	100/2,000	0.1	21DI
Use with A 250 (1/4" tubing).					
TT 250	Adapter - Thread x Thread (Fits 0.160" ID - 0.170" ID Tubing)	Black	100/2,000	0.1	21DI
Use with A 250 (1/4" tubing).					
C 125	Connector (Barb x Barb) (Fits 0.125" ID Tubing)	Black	100/5,000	0.1	21DI
Use with A 185 (1/8" tubing).					
C 250	Connector (Barb x Barb) (Fits 0.160" ID - 0.170" ID Tubing)	Black	100/10,000	0.1	21DI
Use with A 250 (1/4" tubing).					
BB 250	Adapter (Barb x Barb) (Fits 0.160" ID - 0.170" ID Tubing)	Black	100/5,000	0.1	21DI
Use with A 250 (1/4" tubing).					
T 250	Tee (Barb x Barb x Barb) (Fits 0.160" ID - 0.170" ID Tubing)	Black	100/3,000	0.2	21DI
Use with A 250 (1/4" tubing).					
T 250	Tee (Barb x Barb x Barb) (Fits 0.160" ID - 0.170" ID Tubing)	Black	100/3,000	0.2	21DI
Use with A 250 (1/4" tubing).					
DBC 250	Double Barbed Connector (Barbed x Barbed) (Fits 0.160" ID - 0.170" ID Tubing)	Black	100/10,000	0.1	21DI
Use with A 250 (1/4" tubing).					
GP 2	Dual Goof Plug (20/Rack)	Black	100/10,000	0.1	21DI
GP 2B	Bulk Packaged 2-Sided Goof Plug	Black	N/A/10,000	0.1	21DI
Use with A 250 (1/4" tubing).					
SAJ	Adapter for Hydro-Flo™ (page 102), Dial-a-Flo™ (page 101), Micro-Flo™ Jets (page 103) (1/2" FIPT x 10-32 NPT)	Black	100/400	1.5	21DI
SAT	Adapter for A 220 and A 250 Tubing (page 119) (1/2" FIPT x Barb)	Black	100/400	1.1	21DI
REA	Adapter for 1/4" Barbed Drip Emitter (1/2" FIPT x Emitter Socket dapter)	Black	100/400	1.3	21DI
ST 250	Adapter for Dura-Flo™ JR (page 97) and 1/4" Tubing (page XX) (1/2" FIPT x 1/4" Barbed Swivel Tee)	Black	100/300	1.4	21DI
SEL 250	Adapter for Dura-Flo™ JR (page 97) and 1/4" Tubing (page XX) (1/2" FIPT x 1/4" Barbed Swivel Elbow)	Black	100/300	1.4	21DI
RA 250	Riser Extension Adapter (1/2" FIPT x 1/2" MIPT x 1/4" Barb)	Black	25/100	2.6	21DI

## FITTINGS & ACCESSORIES

### Compression 1/2" Riser Adapters

PROFESSIONAL IRRIGATION



Part No.	Description	Color	Bag Qty./ Box Qty.	Wt. per 100 (lbs.)	Product Class
RSF 100	1/2" Riser Swivel Filter with 100 Mesh Stainless Steel Screen – Maximum Flow 2 gpm (1/2" MIPT x 1/2" FIPT Swivel)	Black	25/100	3.2	21DI
RS	1/2" Riser Swivel (1/2" MIPT x 1/2" FIPT Swivel)	Black	25/100	3.0	21DI
RST 700	1/2" Riser Swivel Tee w/100 Mesh Filter (Fits .680" to .704" OD Tubing i.e. A 700)	Black	40/80	6.3	21DI
RST 710	1/2" Riser Swivel Tee w/100 Mesh Filter (Fits .704" to .710" OD Tubing i.e. A 710)	Blue	40/80	6.3	21DI
Products include filter.					
RSTW 600	1/2" Riser Swivel Tee (Fits .610" to .640" OD Tubing)	Green	40/80	5.9	21DI
RSTW 700	1/2" Riser Swivel Tee (Fits .680" to .704" OD Tubing)	Black	40/80	6.1	21DI
RSTW 710	1/2" Riser Swivel Tee (Fits .704" to .710" OD Tubing)	Blue	40/80	6.0	21DI
Products include washer.					
RSEL 600	1/2" Riser Swivel Elbow w/100 Mesh Filter (Fits .610" to .640" OD Tubing)	Green	50/100	5.2	21DI
RSEL 700	1/2" Riser Swivel Elbow w/100 Mesh Filter (Fits .680" to .704" OD Tubing)	Black	50/100	5.0	21DI
RSEL 710	1/2" Riser Swivel Elbow w/100 Mesh Filter (Fits .704" to .710" OD Tubing)	Blue	50/100	5.0	21DI
Products include filter.					
RSELW 500	1/2" Riser Swivel Elbow (Fits .455" to .480" OD Tubing)	Red	50/100	4.8	21DI
RSELW 600	1/2" Riser Swivel Elbow (Fits .610" to .640" OD Tubing)	Green	50/100	4.8	21DI
RSELW 700	1/2" Riser Swivel Elbow (Fits .680" to .704" OD Tubing)	Black	50/100	4.8	21DI
RSELW 710	1/2" Riser Swivel Elbow (Fits .704" to .710" OD Tubing)	Blue	50/100	4.8	21DI
Products include washer.					

### Automatic Flush Valves

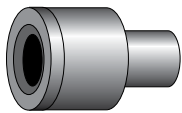

Part No.	Description	Color	Bag Qty./ Box Qty.	Wt. per 100 (lbs.)	Product Class
FVA 600	Automatic Flush Valve – Closes at 7 PSI (Fits .610" to .630" OD Tubing i.e. A 620)	Green	25/500	1.5	21DI
FVA 700	Automatic Flush Valve – Closes at 7 PSI (Fits .680" to .704" OD Tubing i.e. A 700)	Black	25/500	1.4	21DI
FVA 710	Automatic Flush Valve – Closes at 7 PSI (Fits .704" to .710" OD Tubing i.e. A 710)	Blue	25/500	1.4	21DI

### Figure 8 End Enclosures



Part No.	Description	Color	Bag Qty./ Box Qty.	Wt. per 100 (lbs.)	Product Class
F 870	Figure "8" End Plug (Fits .620" OD to .710" OD Tubing)	Black	100/3,000	0.7	21DI
Fits A 620, A 700, A 710 Tubing					
F 890	Figure "8" End Plug (Fits .830" OD to .940" OD Tubing)	Black	100/1,500	1.5	21DI
Fits A 940 Tubing					
TEC	Thin Walled Tape End Closure	Black	100/2,000	1.6	21DI

## FITTINGS & ACCESSORIES

### Sod Staples

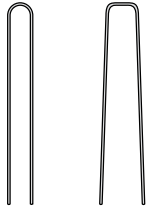

Part No.	Description	Color	Bag Qty./ Box Qty.	Wt. per 100 (lbs.)	Product Class
FW6	6" Sod Staple Flat Top	N/A	N/A/1,000	3.5	21DT
FW6/100	6" Sod Staple Flat Top	N/A	100/N/A	3.5	21DT
FW6/25	6" Sod Staple Flat Top	N/A	25/N/A	3.5	21DT
SW6	6" Sod Staple Round Top	N/A	N/A/1,000	3.4	21DT
SW6/100	6" Sod Staple Round Top	N/A	100/N/A	3.4	21DT
SW6/25	6" Sod Staple Round Top	N/A	25/N/A	3.4	21DT

### Stakes

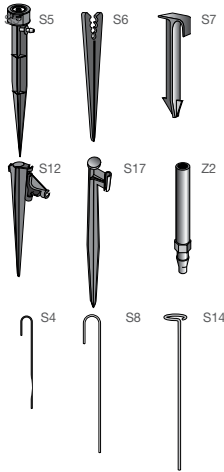

Part No.	Description	Color	Bag Qty./ Box Qty.	Wt. per 100 (lbs.)	Product Class
S 5	5" Plastic Elbow Stake with 1/4" Barbed Side Inlet and 10/32 NPT Outlet	Black	100/1,500	1.4	21DI
S 6	6" Plastic Stake (Fits A 185, A 220 and A 250 Tubing)	Black	100/3,000	1.0	21DI
S 7	6" Plastic Stake to Hold Down .620" to .710" OD Tubing	Black	50/700	2.9	21DI
S 12	12" Plastic Stake to Hold A 250/V 250 Tubing	Black	100/300	6.2	21DI
S 17	17" Plastic Stake to Support .160" ID x .300" OD Rigid Risers	Black	250/250	9.4	21DI
Z 2	Snap-in Adapter for S 17 Stake 10-32 Self Tap x 1/4" Barb	Black	100/1,000	0.5	21DI
S 4	5" 14-Gauge Galvanized Wire Stake	Silver	100/2,500	1.2	21DI
S 8	8" 12-Gaug Galvanized Wire Stake	Silver	100/2,000	0.5	21DI
S 14	14" 11-Gauge Galvanized Wire Stabilizer Stake for Rigid Riser Jet Assemblies	Silver	50/1,000	5.0	21DI

### Valves

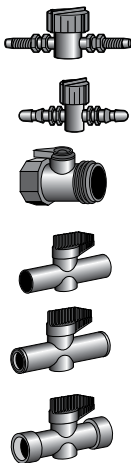

Part No.	Description	Color	Bag Qty./ Box Qty.	Wt. per 100 (lbs.)	Product Class
MV 25	1/4" Flow Controlling Valve (Barb x Barb) (Fits .160" to .170" ID Tubing i.e. A 250)	Black	100/500	0.4	21DI
MVT 25	1/4" Flow Controlling Valve (Thread x Thread) (Fits .160" ID to .300" OD Risers; Use with A 250 Tubing)	Black	100/500	0.4	21DI
BV 75	3/4" FHT x 3/4" MHT Ball Valve	Black	25/150	3.8	21DI
FC	1/2" Flow Controlling Valve (1/2" Slip Socket x 1/2" Slip Socket)	Black	25/200	4.6	21DI
FC 500	1/2" Flow Controlling Valve (Fits .455" to .480" OD Tubing i.e. A 455)	Red	25/200	5.8	21DI
FC 600	1/2" Flow Controlling Valve (Fits .610" to .630" OD Tubing i.e. A 620)	Green	25/200	5.6	21DI
FC 700	1/2" Flow Controlling Valve (Fits .680" to .704" OD Tubing i.e. A 700)	Black	25/200	5.4	21DI
FC 710	1/2" Flow Controlling Valve (Fits .704" to .710" OD Tubing i.e. A 710)	Blue	25/200	5.4	21DI
Note: Not to be used as a shutoff valve.					
FC 800	3/4" Flow Controlling Valve (Fits .830" OD Tubing)	Black	25/125	7.6	21DI
FC 900	3/4" Flow Controlling Valve (Fits .940" OD Tubing i.e. A 940)	Grey	25/125	7.5	21DI

## FITTINGS & ACCESSORIES

### Air/Vacuum Valves



Part No.	Description	Color	Bag Qty./ Box Qty.	Wt. per 100 (lbs.)	Product Class
AVRV 50	1/2" Air/Vacuum release valve (1/2" MIPT inlet)	Black	25/100	1.6	21DI

### Hole Punches

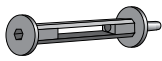

Part No.	Description	Color	Bag Qty./ Box Qty.	Wt. per 100 (lbs.)	Product Class
HP 100	Hole Punch for 1/8" Fittings. Insert Tool for BT 250, TT 250 Fittings	Blue	10/150	3.8	21DI
HP 125	Hole Punch for PC Plus™, Multi-Flo™, Aqua-Flo™, Dial-a-Flo™, Super-Flo™, Misti-Flo™ and 1/4" Fittings. Insert Tool for BT 250, TT 250 Fittings.	Green	10/150	3.8	21DI
HP 125PRO	Hole Punch for for 1/4" fittings, insert tool for PCP Drippers	Green	1/10	17.4	21DI
HP 240	Hole Punch for Mono-Flo™ Emitters	Blue	10/50	4.1	21DI
PPT	Punch Pal™ Tool (Plastic Hole Punch Including Socket for Inerting Jets)	Orange	50/500	0.7	21DI

### Emitter Access Boxes



Part No.	Description	Color	Bag Qty./ Box Qty.	Wt. per 100 (lbs.)	Product Class
EB 6	6" Emitter/Bubbler Access Box	Black	24/24	57.7	21DI
EBMD 6	6" Emitter/Bubbler Access Box with Metal Detection Capability	Black	24/24	61.6	21DI
EBDS 6	6" Emitter/Bubbler Access Box for Desert Landscaping	Tan	24/24	57.7	21DI
EBRC 6	6" Emitter/Bubbler Access Box for Reclaimed Water	Purple	N/A/24	57.7	21DI

### Tubing Accessories and Miscellaneous

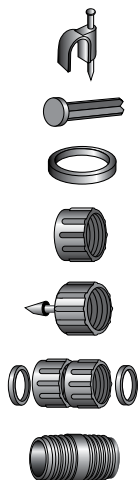

Part No.	Description	Color	Bag Qty./ Box Qty.	Wt. per 100 (lbs.)	Product Class
MC 250	1/4" Mounting Clamp (Fits A 220 and A 250 Tubing)	Black	100/4,000	0.2	21DI
MC 500	3/8" Mounting Clamp (Fits A 455 Tubing)	Black	100/1,500	0.4	21DI
MC 710	1/2" Mounting Clamp (Fits A 620 and A 700 Tubing)	Black	100/1,000	0.6	21DI
BP 250	Bug Plug for A 220 and A 250	Black	100/5,000	0.1	21DI
W 75	3/4" Vinyl Washer	Black	100/3,000	0.2	21DI
CAP 75	3/4" FHT Cap with Washer	Black	100/1,500	1.8	21DI
SAH	Adapter with Washer (3/4" FHT x 1/4" Barb)	Black	100/500	1.7	21DI
PHA 75	3/4" FHT Swivel x 3/4" FPT Swivel Adapter	Black	25/300	4.2	21DI
TNPH	3/4" Transition Nipple (3/4" MHT x 3/4" MPT)	Black	100/500	2.8	21DI



## DISTRIBUTION TUBING

### Distribution & Supply Tubing

50 ft. & 100 ft. Coils in Shrink Wrapped Packaging



Self Coil

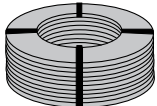

Plastic Hub (1") w/Chipboard Flanges

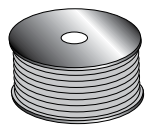

Sunburst Cardboard Spool



Self Coil

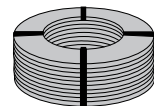

Sunburst cardboard spool

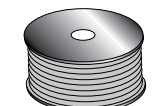

Plastic hub (1") with chipboard flanges



Bucket

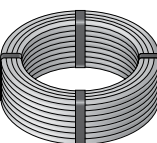

Supply Tubing

Part No.	Description	Color	Coil Size/Type	Wt. per 100' (lbs.)	Product Class
A 185	1/8" Polyethylene Tubing (0.125" ID x 0.185" OD)	Black	2,000'/Spool	0.6	21DT
A 185/100	1/8" Polyethylene Tubing (0.125" ID x 0.185" OD)	Black	100'/Coil	0.6	21DT
A 185/500	1/8" Polyethylene Tubing (0.125" ID x 0.185" OD)	Black	500'/Spool	0.6	21DT
A 185/1000	1/8" Polyethylene Tubing (0.125" ID x 0.185" OD)	Black	1,000'/Spool	0.6	21DT
A 185V	1/8" Vinyl Tubing (0.125" ID x 0.185" OD)	Black	2,000'/Spool	1.0	21DT
A 185V/100	1/8" Vinyl Tubing (0.125" ID x 0.185" OD)	Black	100'/Coil	1.0	21DT
A 185V/1000	1/8" Vinyl Tubing (0.125" ID x 0.185" OD)	Black	1,000'/Spool	1.0	21DT
A 220	1/4" Polyethylene Tubing (0.160" ID x 0.220" OD)	Black	1,500'/Spool	0.7	21DT
A 220/100	1/4" Polyethylene Tubing (0.160" ID x 0.220" OD)	Black	100'/Coil	0.7	21DT
A 220/500	1/4" Polyethylene Tubing (0.160" ID x 0.220" OD)	Black	500'/Spool	0.7	21DT
A 220/1000	1/4" Polyethylene Tubing (0.160" ID x 0.220" OD)	Black	1,000'/Spool	0.7	21DT
A 220/2500	1/4" Polyethylene Tubing (0.160" ID x 0.220" OD)	Black	2,500'/Spool	0.7	21DT
A 220V	1/4" Vinyl Tubing (0.160" ID x 0.220" OD)	Black	1,500'/Spool	1.2	21DT
A 220V/100	1/4" Vinyl Tubing (0.160" ID x 0.220" OD)	Black	100'/Coil	1.2	21DT
A 220V/500	1/4" Vinyl Tubing (0.160" ID x 0.220" OD)	Black	500'/Spool	1.2	21DT
A 220V/1000	1/4" Vinyl Tubing (0.160" ID x 0.220" OD)	Black	1,000'/Spool	1.2	21DT
A 220V/2500	1/4" Vinyl Tubing (0.160" ID x 0.220" OD)	Black	2,500'/Spool	1.2	21DT
A 250	1/4" Polyethylene Tubing (0.170" ID x 0.250" OD)	Black	1,250'/Spool	1.1	21DT
A 250/50	1/4" Polyethylene Tubing (0.170" ID x 0.250" OD)	Black	50'/Coil	1.1	21DT
A 250BR/50	1/4" Polyethylene Tubing (0.170" ID x 0.250" OD)	Brown	50'/Coil	1.1	21DT
A 250GR/50	1/4" Polyethylene Tubing (0.170" ID x 0.250" OD)	Green	50'/Coil	1.1	21DT
A 250RD/50	1/4" Polyethylene Tubing (0.170" ID x 0.250" OD)	Redwood	50'/Coil	1.1	21DT
A 250SD/50	1/4" Polyethylene Tubing (0.170" ID x 0.250" OD)	Sand	50'/Coil	1.1	21DT
A 250WT/50	1/4" Polyethylene Tubing (0.170" ID x 0.250" OD)	White	50'/Coil	1.1	21DT
A 250/100	1/4" Polyethylene Tubing (0.170" ID x 0.250" OD)	Black	100'/Coil	1.1	21DT
A 250BR/100	1/4" Polyethylene Tubing (0.170" ID x 0.250" OD)	Brown	100'/Coil	1.1	21DT
A 250/500	1/4" Polyethylene Tubing (0.170" ID x 0.250" OD)	Black	500'/Spool	1.1	21DT
A 250/1000	1/4" Polyethylene Tubing (0.170" ID x 0.250" OD)	Black	1,000'/Spool	1.1	21DT
A 250/1000B	1/4" Polyethylene Tubing (0.170" ID x 0.250" OD) in Bucket	Black	1,000'/Spool in Bucket	1.1	21DT
A 250/2500	1/4" Polyethylene Tubing (0.170" ID x 0.250" OD)	Black	2,500'/Spool	1.1	21DT
A 250V	1/4" Vinyl Tubing (0.170" ID x 0.250" OD)	Black	1,250'/Spool	1.6	21DT
A 250V/50	1/4" Vinyl Tubing (0.170" ID x 0.250" OD)	Black	50'/Coil	1.6	21DT
A 250V/100	1/4" Vinyl Tubing (0.170" ID x 0.250" OD)	Black	100'/Coil	1.6	21DT
A 250V/500	1/4" Vinyl Tubing (0.170" ID x 0.250" OD)	Black	500'/Spool	1.6	21DT
A 250V/1000	1/4" Vinyl Tubing (0.170" ID x 0.250" OD)	Black	1,000'/Spool	1.6	21DT
A 250V/1000B	1/4" Vinyl Tubing (0.170" ID x 0.250" OD) in Bucket	Black	1,000'/Spool in Bucket	1.6	21DT
A 455/100	3/8" Polyethylene Tubing (0.375" ID x 0.455" OD)	Black	100'/Coil	2.2	21DT
A 455/500	3/8" Polyethylene Tubing (0.375" ID x 0.455" OD)	Black	500'/Coil	2.2	21DT

PROFESSIONAL IRRIGATION

## DISTRIBUTION TUBING

### Distribution & Supply Tubing

All 17mm Coils in Shrink Wrapped Packaging



Self Coil

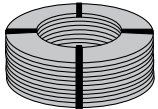

Plastic Hub (1")  
w/Chipboard Flanges

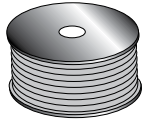

Sunburst  
Cardboard Spool



Self Coil

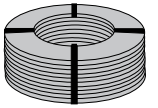

Sunburst Cardboard Spool

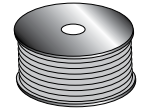

Plastic Hub (1")  
w/ Chipboard Flanges

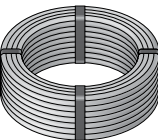

Supply Tubing

Part No.	Description	Color	Coil Size/Type	Wt. per 100' (lbs.)	Product Class
A 620	1/2" Polyethylene Tubing (0.520" ID x 0.620" OD)	Black	1,000'/Coil	3.6	21DT
A 620/50	1/2" Polyethylene Tubing (0.520" ID x 0.620" OD)	Black	50'/Coil	3.6	21DT
A 620/100	1/2" Polyethylene Tubing (0.520" ID x 0.620" OD)	Black	100'/Coil	3.6	21DT
A 620BR/100	1/2" Polyethylene Tubing (0.520" ID x 0.620" OD)	Brown	100'/Coil	3.6	21DT
A 620/500	1/2" Polyethylene Tubing (0.520" ID x 0.620" OD)	Black	500'/Coil	3.6	21DT
A 620BR/500	1/2" Polyethylene Tubing (0.520" ID x 0.620" OD)	Brown	500'/Coil	3.6	21DT
A 660BR/100S	17mm Polyethylene Tubing (0.560" ID x 0.660" OD)	Brown	100'/Wrapped Coil	3.8	21DT
A 660BR/250S	17mm Polyethylene Tubing (0.560" ID x 0.660" OD)	Brown	250'/Wrapped Coil	3.8	21DT
A 660BR/500S	17mm Polyethylene Tubing (0.560" ID x 0.660" OD)	Brown	500'/Wrapped Coil	3.8	21DT
A 700	1/2" Polyethylene Tubing (0.600" ID x 0.700" OD)	Black	500'/Coil	4.1	21DT
A 700SH	1/2" Polyethylene Tubing (0.600" ID x 0.700" OD)	Black	500'/Wrapped Coil	4.1	21DT
A 700BR	1/2" Polyethylene Tubing (0.600" ID x 0.700" OD)	Brown	500'/Coil	4.1	21DT
A 700/50	1/2" Polyethylene Tubing (0.600" ID x 0.700" OD)	Black	50'/Coil	4.1	21DT
A 700/100	1/2" Polyethylene Tubing (0.600" ID x 0.700" OD)	Black	100'/Coil	4.1	21DT
A 700/100SH	1/2" Polyethylene Tubing (0.600" ID x 0.700" OD)	Black	100'/Wrapped Coil	4.1	21DT
A 700BR/100	1/2" Polyethylene Tubing (0.600" ID x 0.700" OD)	Brown	100'/Coil	4.1	21DT
A 700/1000	1/2" Polyethylene Tubing (0.600" ID x 0.700" OD)	Black	1,000'/Coil	4.1	21DT
A 710	1/2" Polyethylene Tubing (0.620" ID x 0.710" OD)	Black	500'/Coil	3.8	21DT
A 710GRS	1/2" Polyethylene Tubing (0.620" ID x 0.710" OD)	Black/ Green Stripe	500'/Coil	3.8	21DT
A 710PS	1/2" Polyethylene Tubing (0.620" ID x 0.710" OD)	Black/ Purple Stripe	500'/Coil	3.8	21DT
A 710RDS	1/2" Polyethylene Tubing (0.620" ID x 0.710" OD)	Black/ Red Stripe	500'/Coil	3.8	21DT
A 710WHS	1/2" Polyethylene Tubing (0.620" ID x 0.710" OD)	Black/ White Stripe	500'/Coil	3.8	21DT
A 710YS	1/2" Polyethylene Tubing (0.620" ID x 0.710" OD)	Black/ Yellow Stripe	500'/Coil	3.8	21DT
A 710SH	1/2" Polyethylene Tubing (0.620" ID x 0.710" OD)	Black	500'/Wrapped Coil	3.8	21DT
A 710/50	1/2" Polyethylene Tubing (0.620" ID x 0.710" OD)	Black	50'/Coil	3.8	21DT
A 710/100	1/2" Polyethylene Tubing (0.620" ID x 0.710" OD)	Black	100'/Coil	3.8	21DT
A 710/100RDS	1/2" Polyethylene Tubing (0.620" ID x 0.710" OD)	Black/ Red Stripe	100'/Coil	3.8	21DT
A 710/100SH	1/2" Polyethylene Tubing (0.620" ID x 0.710" OD)	Black	100'/Wrapped Coil	3.8	21DT
A 710/1000	1/2" Polyethylene Tubing (0.620" ID x 0.710" OD)	Black	1,000'/Coil	3.8	21DT
A 940	3/4" Polyethylene Tubing (0.830" ID x 0.940" OD)	Black	500'/Coil	6.4	21DT
A 940RDS	3/4" Polyethylene Tubing (0.830" ID x 0.940" OD)	Black/ Red Stripe	500'/Coil	6.4	21DT
A 940WHS	3/4" Polyethylene Tubing (0.830" ID x 0.940" OD)	Black/ White Stripe	500'/Coil	6.4	21DT
A 940YS	3/4" Polyethylene Tubing (0.830" ID x 0.940" OD)	Black/ Yellow Stripe	500'/Coil	6.4	21DT
A 940PS	3/4" Polyethylene Tubing (0.830" ID x 0.940" OD)	Purple Stripe	N/A	N/A	21DT
A 940/100	3/4" Polyethylene Tubing (0.830" ID x 0.940" OD)	Black	100'/Coil	6.4	21DT
A 940/1000	3/4" Polyethylene Tubing (0.830" ID x 0.940" OD)	Black	1,000'/Coil	6.4	21DT
A 1200	1" Polyethylene Tubing (1.060" ID x 1.200" OD)	Black	500'/Coil	9.8	21DT

## DISTRIBUTION TUBING

### IPS Flex Pipe

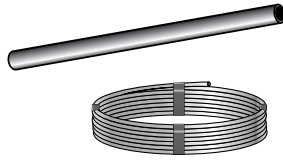

Part No.	Description	Color	Bag Qty./ Box Qty.	Wt. per 100' (lbs.)	Product Class
IPS 75/3	36" Cut, 3/4" IPS Flex Vinyl Pipe (0.742" ID x 1.050" OD, 0.154" Wall)	Black	25/Bundle	84.0	21DT
IPS 75/4	48" Cut, 3/4" IPS Flex Vinyl Pipe (0.742" ID x 1.050" OD, 0.154" Wall)	Black	25/Bundle	112.0	21DT
IPS 50/100	1/2" IPS Flex Vinyl Pipe (0.546" ID x 0.840" OD, 0.147" Wall)	Black	100'	20.5	21DT
IPS 75/100	3/4" IPS Flex Vinyl Pipe (0.742" ID x 1.050" OD, 0.154" Wall)	Black	100'	28.5	21DT

### Swing Pipe

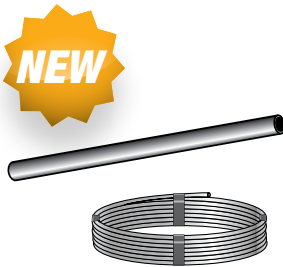

Part No.	Description	Color	Bag Qty./ Box Qty.	Wt. per 100' (lbs.)	Product Class
SRP/100SH	1/2" Flexee™ Swing Riser Pipe (0.490" ID x 0.690" OD), Shrinkwrapped	Black	100'/1,000'	7.7	21DT
SRP FLEX/100SH	1/2" Super Flexee™ Swing Riser Pipe (0.490" ID x 0.690" OD), Shrinkwrapped	Black	100'/1,000'	7.7	21DT

## TUBING FRACTIONAL LOSSES

### Polyethylene Supply Tubing – Friction Loss (PSI/100 Feet)

Flow	Part Number				
	A455	A620	A700	A710	A940
0.5 gpm	1.80	0.37	0.19	0.16	0.05
1.0 gpm	6.6	1.33	0.68	0.55	0.15
1.5 gpm	12.2	2.45	1.24	1.01	0.32
2.0 gpm		4.80	2.17	1.78	0.53
2.5 gpm		6.18	3.13	2.56	0.82
3.0 gpm		10.31	5.16	4.23	1.11
3.5 gpm			6.85	5.62	1.52
4.0 gpm			8.78	7.20	1.90
4.5 gpm			10.32	8.46	2.42
5.0 gpm				10.10	2.88
6.0 gpm					4.03
7.0 gpm					5.37
8.0 gpm					6.87
9.0 gpm					8.53
10.0 gpm					10.37

### IPS Flex PVC Hose – Friction Loss (PSI/100 Feet)

Flow	Part Number	
	IPS 50	IPS 75
0.5 gpm	0.31	0.07
1.0 gpm	1.10	0.23
1.5 gpm	2.09	0.45
2.0 gpm	3.85	0.75
2.5 gpm	5.10	1.15
3.0 gpm	8.52	1.55
3.5 gpm	11.34	2.14
4.0 gpm	13.86	2.66
5.0 gpm		3.92
6.0 gpm		5.65
7.0 gpm		7.51
8.0 gpm		9.62
9.0 gpm		11.95
10.0 gpm		14.52

### Polyethylene/Vinyl Micro-Tubing – Friction Loss (PSI/100 Feet)

Flow	Part Number		
	A 185/V	A 220/V	A 250/V
3 gph	5.9	1.7	1.3
6 gph	19.7	5.8	4.3
9 gph	41.5	12.2	9.1
12 gph		20.9	15.6
15 gph		31.7	23.9
18 gph		43.9	33.0
21 gph			44.3

### “Flexee” Swing Riser Pipe – Friction Loss (PSI/100 Feet)

Flow	Part Number
	SRP 100
0.5 gpm	0.40
1.0 gpm	1.47
1.5 gpm	2.70
2.0 gpm	5.28
2.5 gpm	6.80
3.0 gpm	11.35



## TECHNICAL INFORMATION – CONVERSION FACTORS

To Convert From	To	Multiply by
<b>AREA</b>		
Acres	Sq. Feet	43,560
Acres	Sq. Meters	4,046.8
Sq. Centimeters	Sq. Feet	0.00108
Sq. Centimeters	Sq. Inches	0.1550
Sq. Feet	Sq. Centimeters	929.03
Sq. Feet	Sq. Inches	144
Sq. Feet	Sq. Meters	0.0929
Sq. Feet	Sq. Yards	0.1111
Sq. Inches	Sq. Centimeters	6.4516
Sq. Inches	Sq. Feet	0.00694
Sq. Inches	Sq. Meters	0.000645
Sq. Meters	Sq. Feet	10.764
Sq. Meters	Sq. Yards	1.196
Sq. Yards	Sq. Feet	9
Sq. Yards	Sq. Meters	0.8361
<b>ENERGY AND POWER</b>		
Foot Pounds	BTU	0.001285
Foot Pounds	Joules	1.3558
Foot Pounds	Kilogram-Meters	0.13826
Foot Pound per Minute	Horsepower	0.0000303
Horsepower	BTU per Minute	42.41
Horsepower	Foot Pound per Minute	33,000
Horsepower	Foot Pound per Second	550
Horsepower	Kilowatts	0.7457
<b>FLOW</b>		
Cubic Feet per Minute	Cubic Meters per Second	0.0004719
Cubic Feet per Second	Cubic Meters per Second	0.02832
Cubic Yards/Minute	Cubic Meters per Second	0.01274
Gallons/Minute	Cubic Meters per Second	0.0000631
Gallons/Minute	Cubic Meters per Hour	0.22716
<b>LENGTH</b>		
Centimeters	Inches	0.3937
Centimeters	Yards	0.01094
Feet	Inches	12
Feet	Meters	0.30481
Feet	Yards	0.333
Inches	Centimeters	2.540
Inches	Feet	0.08333
Inches	Meters	0.02540
Inches	Microns	25.400
Inches	Millimeters	25.400
Inches	Yards	0.2778
Kilometers	Feet	3.281
Kilometers	Miles (Nautical)	0.5336
Kilometers	Miles (Statue)	0.6214
Kilometers	Yards	1.094
Meters	Feet	3.2809
Meters	Yards	1.0936
Miles (Statue)	Feet	5.280
Miles	Kilometers	1.6093
Miles (Statue)	Meters	1,609.34
Miles (Statue)	Yards	1,760
Miles (Nautical)	Kilometers	1,852
Miles (Nautical)	Meters	1.8520
Millimeters	Inches	0.03937
Rods	Meters	5.0292
Yards	Centimeters	0.9144
Yards	Feet	3
Yards	Inches	36
Yards	Meters	0.9144

To Convert From	To	Multiply by
<b>PRESSURE</b>		
Kilograms/Sq. Cm.	Pounds per Sq. Inch	14,223
Kilograms/Sq. Meter	Pounds per Sq. Foot	0.2048
Kilograms/Cubic Meter	Pounds per Cubic Foot	0.0624
Pounds per Cubic Foot	Kilograms/Cubic Meter	16,019
Pounds per Sq. Foot	Kilograms/Sq. Meter	4.8824
Pounds per Sq. Inch	Kilograms/Sq. Cm.	0.0703
<b>VELOCITY</b>		
Feet/Minute	Meters per Second	0.00508
Feet/Second	Meters per Second	0.3048
Inches/Second	Meters per Second	0.0254
<b>VOLUME</b>		
Cubic Centimeters	Cubic Inches	0.06102
Cubic Feet	Cubic Inches	1,728
Cubic Feet	Cubic Meters	0.0283
Cubic Feet	Cubic Yards	0.0370
Cubic Feet	Gallons	7.481
Cubic Feet	Liters	28.32
Cubic Feet	Quarts	29.9222
Cubic Inches	Cubic Centimeters	16.39
Cubic Inches	Cubic Feet	0.0005787
Cubic Inches	Cubic Meters	0.00001639
Cubic Inches	Liters	0.0164
Cubic Inches	Gallons	0.004329
Cubic Inches	Quarts	0.01732
Cubic Meters	Cubic Feet	35.31
Cubic Meters	Cubic Inches	61,023
Cubic Meters	Cubic Yards	1.3087
Cubic Yards	Cubic Feet	27
Cubic Yards	Cubic Meters	0.7641
Gallons	Cubic Feet	0.1337
Gallons	Cubic Inches	231
Gallons	Cubic Meters	0.003785
Gallons	Liters	3.785
Gallons	Quarts	4
Liters	Cubic Feet	0.03531
Liters	Cubic Inches	61.017
Liters	Gallons	0.2642
Liters	Pints	2.1133
Liters	Quarts	1.057
Liters	Cubic Meters	0.0010



Our products are engineered and produced for performance, durability, ease of installation and the efficient use of resources.

Visit [ndspro.com](http://ndspro.com) for:



Videos



Tools/  
Calculators



Downloads



Case  
Studies



Request  
a Quote



# ndspro.com

NDS Customer Service  
851 N. Harvard Ave., Lindsay, CA 93247  
Phone: 800.726.1994 · 559.562.9888  
Fax: 800.726.1998 · 559.562.4488  
**Se Habla Español**

## New Mobile App – NDS Stormwater Drainage Tools

