

Closet Flanges



- The most innovative, most trusted, and most complete line of closet flanges on the market
- Fourteen new styles available, including nine new TKOs
- Knockout and open designs available in one-piece or with engineered stainless steel swivel rings
- Full Flush, Drop-Kick, and Push-Tite designs are exclusive to Sioux Chief



Supply • Drainage • Support • Testing • Specialties • Tools • Access





Total Knockout Closet Flange

Patent #5,377,361



883-AT



886-4PTM

- Ten years of proven performance
- Knockout will not break apart and cannot fall down drain pipe
- Strong, corrosion-resistant stainless steel ring eliminates cracked flanges
- Easier installation, no need to hold knockout while hammering
- Holds five floors (22 PSI) for head test

“ We have installed over 60,000 TKOs over the last three years. They have eliminated the call backs on knockouts in the sewer lines. We would highly recommend this product to anyone in the plumbing trade. ”

Jerry Johnson
AMPAM JA Crosen Company
Orlando, FL

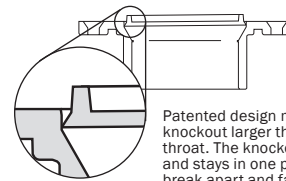

Patented design makes the knockout larger than the drain throat. The knockout falls down 1/8" and stays in one piece. It will not break apart and fall down drain line.

	PVC Item No.	ABS Item No.	Connection	Min. Qty.	Case Qty.	List Price
ONE-PIECE PLASTIC RING						
INDIVIDUALLY BAR-CODED BULK						
	883-PT	883-AT	3" hub/inside 4", flush to floor*	25	25	3.40 EA
	886-PTS	886-ATS	3" spigot	25	25	5.85 EA
	886-PT30	—	3" Sch. 30 hub	25	25	3.80 EA
	886-4PT	886-4AT	4" hub, flush to floor	25	25	5.85 EA
	886-4PTS	886-4ATS	4" spigot, flush to floor	25	25	5.85 EA
INDIVIDUALLY BAR-CODED IN A CUT CASE BOX						
	883-PTPK	883-ATPK	3" hub/inside 4", flush to floor*	8	8	3.54 EA
	886-PTSPK	886-ATSPK	3" spigot	8	8	5.97 EA
	886-4PTPK	886-4ATPK	4" hub, flush to floor	8	8	5.97 EA
	886-4PTSPK	886-4ATSPK	4" spigot, flush to floor	8	8	5.97 EA
STAINLESS STEEL SWIVEL RING						
INDIVIDUALLY BAR-CODED BULK						
	884-PTM	884-ATM	3" hub/inside 4", flush to floor*	24	24	6.50 EA
	886-PTMS	886-ATMS	3" spigot	25	25	11.44 EA
	888-PTM	888-ATM	3" inside fit*	25	25	6.12 EA
	886-PTM30	—	3" Sch. 30 hub	25	25	8.00 EA
	886-4PTM	886-4ATM	4" hub, flush to floor	25	25	8.84 EA
	886-4PTMS	886-4ATMS	4" spigot, flush to floor	25	25	8.84 EA
INDIVIDUALLY BAR-CODED IN A CUT CASE BOX						
	884-PTMPK	884-ATMPK	3" hub/inside 4", flush to floor*	8	8	6.64 EA
	886-PTMSPK	886-ATMSPK	3" spigot	8	8	11.56 EA
	888-PTMPK	888-ATMPK	3" inside fit*	8	8	6.24 EA
	886-PTM30PK	—	3" Sch. 30 hub	8	8	8.12 EA
	886-4PTMPK	886-4ATMPK	4" hub, flush to floor	8	8	8.96 EA
	886-4PTMSPK	886-4ATMSPK	4" spigot, flush to floor	8	8	8.96 EA

* The inside diameter of pipe can vary significantly. These flanges are designed to fit inside most, but may not fit all types of pipe.



Hit the raised rim of the TKO until the knockout cracks loose.



Remove loose knockout with pliers.

Push-Tite™ Gasketed Closet Flange

Patent Pending

NEW
2 MODELS



888-GPM



887-GATM



888-GPTMK

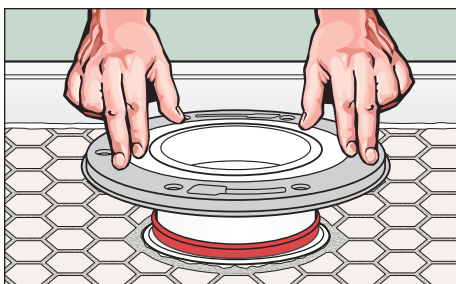

The Push-Tite fits flush-to-floor and installs into DWV pipe. The 887 models even glue over 3" PVC or ABS pipe if necessary. Lubricate the gasket before installation.

- Gasket seals inside DWV pipe
- Strong, adjustable stainless steel swivel ring means you adjust the ring, not the flange. No chance of breaking gasket seal
- Engineered elastomer gasket is chemical and heat resistant
- Both models have larger flow-through areas than similar gasketed closet flange
- New TKO model holds 5 PSI for air test

Create Your Own Extension for the 887 Push-Tite

When 4" drain pipe is well below the finished floor

- 1 Cut the hub of the Push-Tite about half way between the gasket and the ring.
- 2 Solvent weld a piece of 3" Sch. 40 DWV pipe (length equal to the distance from 2" inside the drain pipe to the top edge of the finished floor) between both halves of the hub.
- 3 Push pipe/flange assembly fully down into 4" pipe and fasten the ring to the floor.

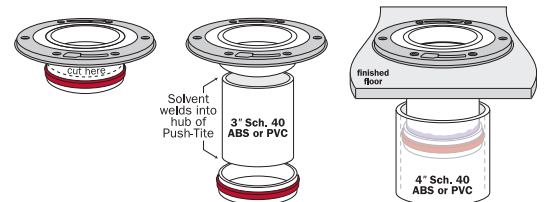

The 887 model Push-Tite is the only gasketed closet flange that will allow a 3" ball to pass with no obstructions



PVC Item No.	ABS Item No.	Connection	Min. Qty.	Case Qty.	List Price
OPEN FLANGE					
INDIVIDUALLY BAR-CODED IN A CUT CASE BOX					
NEW 888-GPM	—	gasketed 3" inside fit, 4" long tailpiece	6	6	25.24 EA
887-GPM	887-GAM	gasketed 4" inside fit, flush to floor	6	6	18.75 EA
WITH KNOCKOUT					
INDIVIDUALLY BAR-CODED IN A CUT CASE BOX					
887-GPTM	887-GATM	gasketed 4" inside fit, flush to floor	6	6	19.25 EA
NEW 887-GPTMK	—	Push-Tite Installation Kit: includes 887-GPTM, wax ring, closet bolts, shims	6	6	29.00 EA



Stainless Steel Swivel Ring Open Closet Flange



PVC Item No.	ABS Item No.	Connection	Min. Qty.	Case Qty.	List Price
INDIVIDUALLY BAR-CODED BULK					
NEW 888-PM	888-AM	3" inside fit, 4" long tailpiece*	12	12	9.00 EA
NEW 887-PM	887-AM	3" hub/inside 4", flush to floor*	25	25	6.35 EA
NEW 886-4PM	886-4AM	4" hub, flush to floor	25	25	8.45 EA
NEW 886-4PMS	886-4AMS	4" spigot, flush to floor	25	25	8.45 EA
INDIVIDUALLY BAR-CODED IN A CUT CASE BOX					
NEW 886-4PMSPK	886-4AMSPK	4" spigot, flush to floor	6	6	8.57 EA

* The inside diameter of pipe can vary significantly. These flanges are designed to fit inside most, but may not fit all types of pipe.

- Corrosion-resistant stainless steel swivel ring is engineered for maximum strength



One-Piece ABS/PVC Open Closet Flange



PVC Item No.	ABS Item No.	Connection	Min. Qty.	Case Qty.	List Price
INDIVIDUALLY BAR-CODED BULK					
NEW 888-P	888-A	3" inside fit*	20	20	3.75 EA
NEW 886-P	886-A	3" hub/inside 4", flush to floor*	20	20	3.00 EA
NEW 886-4P	886-4A	4" hub, flush to floor	25	25	4.83 EA
NEW 886-4PS	886-4AS	4" spigot, flush to floor	25	25	4.83 EA
INDIVIDUALLY BAR-CODED IN A CUT CASE BOX					
NEW 888-PPK	888-APK	3" inside fit*	10	10	3.88 EA
NEW 886-PPK	886-APK	3" hub/inside 4", flush to floor*	10	10	3.12 EA
NEW 886-4PPK	886-4APK	4" hub, flush to floor	6	6	4.95 EA

* The inside diameter of pipe can vary significantly. These flanges are designed to fit inside most, but may not fit all types of pipe.

Full Flush™ Offset Closet Flange



- Full-flow, 3" I.D. throat with no restriction
- Allows for 1½" offset in any direction for closet bowl setting
- Corrosion-resistant stainless steel swivel ring is engineered for maximum strength
- Solvent welds over 3" or inside 4" Sch. 40 DWV
- Fits flush-to-floor through any 4" opening
- UPC listed

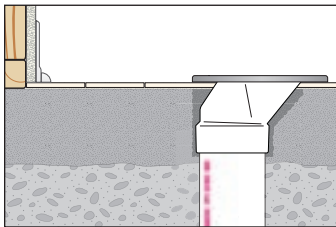

Correct Rough-in Mistake
1½" offset corrects for drain line set too close to wall.

Full Flush is the only offset closet flange that will allow a 3" ball to pass with no obstructions



PVC Item No.	ABS Item No.	Connection	Min. Qty.	Case Qty.	List Price
INDIVIDUALLY BAR-CODED BULK					
889-POM	889-AOM	3" hub/inside 4", flush to floor*	20	20	10.25 EA
INDIVIDUALLY BAR-CODED IN A CUT CASE BOX					
889-POMPK	889-AOMPK	3" hub/inside 4", flush to floor*	6	6	10.38 EA

* The inside diameter of pipe can vary significantly. These flanges are designed to fit inside most, but may not fit all types of pipe.

Drop-Kick™ 45° Outlet Closet Flange



- Full-flow, 3" I.D. throat—no restriction
- Solvent welds inside 3" Sch. 40 fitting hub
- Corrosion-resistant stainless steel swivel ring is engineered for maximum strength

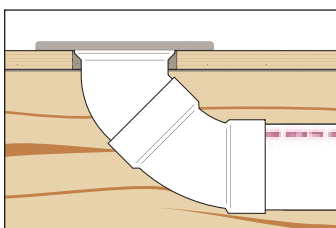

Using a standard 45° fitting, the Drop-Kick connects easily to horizontal drain lines.

Drop-Kick is the only outlet closet flange that will allow a 3" ball to pass with no obstructions

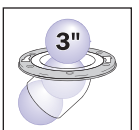

PVC Item No.	ABS Item No.	Connection	Min. Qty.	Case Qty.	List Price
INDIVIDUALLY BAR-CODED BULK					
889-45PM	889-45AM	3" spigot, flush to floor	20	20	14.50 EA
INDIVIDUALLY BAR-CODED IN A CUT CASE BOX					
889-45PMPK	889-45AMPK	3" spigot, flush to floor	10	10	14.63 EA

Cast Iron Closet Flange



- Fits over 4" cast iron DWV pipe
- Easy compression installation. Neoprene gasket
- Perfect for retro-fit or remodel applications

Item No.	Connection	Min. Qty.	Case Qty.	List Price
BULK				
890-i42B	4" cast iron compression connection	500	500	11.00 EA
INDIVIDUALLY BAR-CODED BULK				
890-i42	4" cast iron compression connection	5	5	12.00 EA



Brass Closet Flange Ring



890-4BPK



890-4BDPK

- Solid brass
- For use with lead pipe
- Deep seal model provides more surface area for better joint

Item No.	Description	Min. Qty.	Case Qty.	List Price
INDIVIDUALLY BAR-CODED IN A CUT CASE BOX				
890-4BPK	Brass closet flange ring	10	10	10.75 EA
890-4BDPK	Deep seal brass closet flange ring	10	10	17.50 EA

Quick Spacer™ Closet Flange Spacer Ring



- Fits under most closet flanges
- Each ring raises the flange 3/4" off the floor
- Use multiple rings for additional height

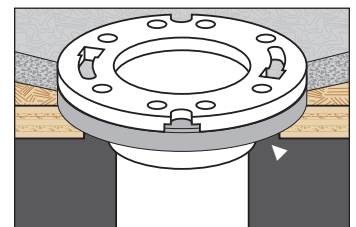

No more shim pieces

Fits under any closet flange and stops lightweight concrete pours from running under the flange.

Item No.	Description	Min. Qty.	Case Qty.	List Price
886-ER	3/4" closet flange spacer ring	25	25	2.00 EA

Ringer™

Stainless Steel Closet Ring



- Stainless steel ring is corrosion resistant
- Perfect for repairs to damaged closet flanges, or new concrete floor installations
- Fits securely over damaged flanges



Hanger card for display areas

Item No.	Description	Min. Qty.	Case Qty.	List Price
BAR-CODED CARDS IN A CUT CASE BOX				
886-MR	Stainless steel closet ring	20	20	4.40 EA

Raise-A-Ring™

Flange Extension Ring



- Build up existing flange when added subfloor, tile, etc. leaves flange at or below floor level
- Ring is 7/16" thick. Can be stacked if needed



Hanger card for display areas

Item No.	Description	Min. Qty.	Case Qty.	List Price
BAR-CODED CARDS IN A CUT CASE BOX				
886-R	Flange extension ring	20	20	2.75 EA
BAR-CODED BAGS IN A CUT CASE BOX				
886-411	Raise-A-Ring Kit: 886-R with 2 closet bolts, 2 shims/bag	20	20	5.00 EA

Urinal Flange Kit



- Hub or spigot connections available
- Kit includes: stainless steel bolts, nuts, washers, and gasket
- Horizontal slots fit 3 1/2" - 7" mounting centers

PVC Item No.	ABS Item No.	Description	Min. Qty.	Case Qty.	List Price
INDIVIDUALLY BAR-CODED BULK					
868-5P	868-5A	2" hub connection urinal flange kit	10	10	14.50 EA
868-9P	868-9A	2" spigot connection urinal flange kit	10	10	13.75 EA

Plumb Perfect™

Closet Bolt



- Tensile strength exceeds 1,100 lbs. per bolt
- Redesigned threads provide increased strength and smoother, faster threading
- 100% corrosion proof bolts are now available in convenient 2" and 3½" lengths in addition to standard 2½"
- Improved adaptability—open end nut now fits ½" sockets, and fits under most bolt caps. Bolt base loads into any flange



Wedge-It™

Multi-Purpose Stability Wedge



Soft PVC



Stiff Polypro

- Stiff polypropylene is driveable
- Soft rubber-like PVC is easy to trim and resists slipping on tile floors
- Dozens of uses on the job site, in the office, home, etc.
- Corrosion proof



DISTRIBUTED BY

tel: 1-800-821-3944
fax: 1-800-758-5950
www.siouxchief.com
P.O. Box 397
24110 South Peculiar Drive
Peculiar, Missouri 64078 USA



Closet Flanges



- The most innovative, most trusted, and most complete line of closet flanges on the market
- Fourteen new styles available, including nine new TKOs
- Knockout and open designs available in one-piece or with engineered stainless steel swivel rings
- Full Flush, Drop-Kick, and Push-Tite designs are exclusive to Sioux Chief



Supply • Drainage • Support • Testing • Specialties • Tools • Access





Total Knockout Closet Flange

Patent #5,377,361



883-AT



886-4PTM

- Ten years of proven performance
- Knockout will not break apart and cannot fall down drain pipe
- Strong, corrosion-resistant stainless steel ring eliminates cracked flanges
- Easier installation, no need to hold knockout while hammering
- Holds five floors (22 PSI) for head test

“ We have installed over 60,000 TKOs over the last three years. They have eliminated the call backs on knockouts in the sewer lines. We would highly recommend this product to anyone in the plumbing trade. ”

Jerry Johnson
AMPAM JA Crosen Company
Orlando, FL

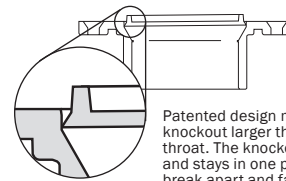

Patented design makes the knockout larger than the drain throat. The knockout falls down $\frac{1}{8}$ " and stays in one piece. It will not break apart and fall down drain line.

	PVC Item No.	ABS Item No.	Connection	Min. Qty.	Case Qty.	List Price
ONE-PIECE PLASTIC RING						
INDIVIDUALLY BAR-CODED BULK						
	883-PT	883-AT	3" hub/inside 4", flush to floor*	25	25	3.40 EA
	886-PTS	886-ATS	3" spigot	25	25	5.85 EA
	886-PT30	—	3" Sch. 30 hub	25	25	3.80 EA
	886-4PT	886-4AT	4" hub, flush to floor	25	25	5.85 EA
	886-4PTS	886-4ATS	4" spigot, flush to floor	25	25	5.85 EA
INDIVIDUALLY BAR-CODED IN A CUT CASE BOX						
	883-PTPK	883-ATPK	3" hub/inside 4", flush to floor*	8	8	3.54 EA
	886-PTSPK	886-ATSPK	3" spigot	8	8	5.97 EA
	886-4PTPK	886-4ATPK	4" hub, flush to floor	8	8	5.97 EA
	886-4PTSPK	886-4ATSPK	4" spigot, flush to floor	8	8	5.97 EA
STAINLESS STEEL SWIVEL RING						
INDIVIDUALLY BAR-CODED BULK						
	884-PTM	884-ATM	3" hub/inside 4", flush to floor*	24	24	6.50 EA
	886-PTMS	886-ATMS	3" spigot	25	25	11.44 EA
	888-PTM	888-ATM	3" inside fit*	25	25	6.12 EA
	886-PTM30	—	3" Sch. 30 hub	25	25	8.00 EA
	886-4PTM	886-4ATM	4" hub, flush to floor	25	25	8.84 EA
	886-4PTMS	886-4ATMS	4" spigot, flush to floor	25	25	8.84 EA
INDIVIDUALLY BAR-CODED IN A CUT CASE BOX						
	884-PTMPK	884-ATMPK	3" hub/inside 4", flush to floor*	8	8	6.64 EA
	886-PTMSPK	886-ATMSPK	3" spigot	8	8	11.56 EA
	888-PTMPK	888-ATMPK	3" inside fit*	8	8	6.24 EA
	886-PTM30PK	—	3" Sch. 30 hub	8	8	8.12 EA
	886-4PTMPK	886-4ATMPK	4" hub, flush to floor	8	8	8.96 EA
	886-4PTMSPK	886-4ATMSPK	4" spigot, flush to floor	8	8	8.96 EA

* The inside diameter of pipe can vary significantly. These flanges are designed to fit inside most, but may not fit all types of pipe.



Hit the raised rim of the TKO until the knockout cracks loose.



Remove loose knockout with pliers.

Push-Tite™

Gasketed Closet Flange

Patent Pending

NEW
2 MODELS



888-GPM



887-GATM



888-GPTMK

- Gasket seals inside DWV pipe
- Strong, adjustable stainless steel swivel ring means you adjust the ring, not the flange. No chance of breaking gasket seal
- Engineered elastomer gasket is chemical and heat resistant
- Both models have larger flow-through areas than similar gasketed closet flange
- New TKO model holds 5 PSI for air test

Create Your Own Extension for the 887 Push-Tite

When 4" drain pipe is well below the finished floor

- 1 Cut the hub of the Push-Tite about half way between the gasket and the ring.
- 2 Solvent weld a piece of 3" Sch. 40 DWV pipe (length equal to the distance from 2" inside the drain pipe to the top edge of the finished floor) between both halves of the hub.
- 3 Push pipe/flange assembly fully down into 4" pipe and fasten the ring to the floor.

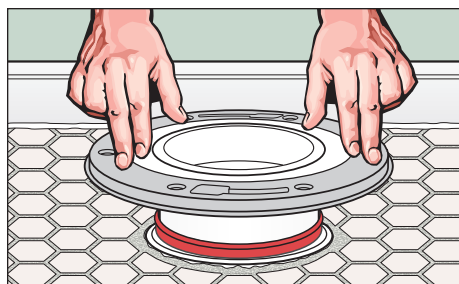
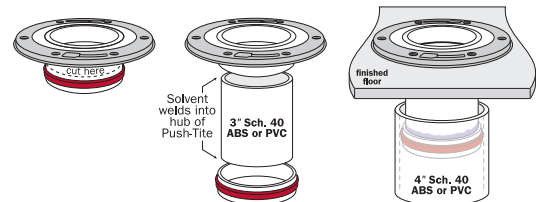

The Push-Tite fits flush-to-floor and installs into DWV pipe. The 887 models even glues over 3" PVC or ABS pipe if necessary. Lubricate the gasket before installation.

The 887 model Push-Tite is the only gasketed closet flange that will allow a 3" ball to pass with no obstructions



PVC Item No.	ABS Item No.	Connection	Min. Qty.	Case Qty.	List Price
OPEN FLANGE					
INDIVIDUALLY BAR-CODED IN A CUT CASE BOX					
NEW 888-GPM	—	gasketed 3" inside fit, 4" long tailpiece	6	6	25.24 EA
887-GPM	887-GAM	gasketed 4" inside fit, flush to floor	6	6	18.75 EA
WITH KNOCKOUT					
INDIVIDUALLY BAR-CODED IN A CUT CASE BOX					
887-GPTM	887-GATM	gasketed 4" inside fit, flush to floor	6	6	19.25 EA
NEW 887-GPTMK	—	Push-Tite Installation Kit: includes 887-GPTM, wax ring, closet bolts, shims	6	6	29.00 EA



Stainless Steel Swivel Ring Open Closet Flange



PVC Item No.	ABS Item No.	Connection	Min. Qty.	Case Qty.	List Price
INDIVIDUALLY BAR-CODED BULK					
NEW 888-PM	888-AM	3" inside fit, 4" long tailpiece*	12	12	9.00 EA
NEW 887-PM	887-AM	3" hub/inside 4", flush to floor*	25	25	6.35 EA
NEW 886-4PM	886-4AM	4" hub, flush to floor	25	25	8.45 EA
NEW 886-4PMS	886-4AMS	4" spigot, flush to floor	25	25	8.45 EA
INDIVIDUALLY BAR-CODED IN A CUT CASE BOX					
NEW 886-4PMSPK	886-4AMSPK	4" spigot, flush to floor	6	6	8.57 EA

* The inside diameter of pipe can vary significantly. These flanges are designed to fit inside most, but may not fit all types of pipe.

- Corrosion-resistant stainless steel swivel ring is engineered for maximum strength



One-Piece ABS/PVC Open Closet Flange



PVC Item No.	ABS Item No.	Connection	Min. Qty.	Case Qty.	List Price
INDIVIDUALLY BAR-CODED BULK					
NEW 888-P	888-A	3" inside fit*	20	20	3.75 EA
NEW 886-P	886-A	3" hub/inside 4", flush to floor*	20	20	3.00 EA
NEW 886-4P	886-4A	4" hub, flush to floor	25	25	4.83 EA
NEW 886-4PS	886-4AS	4" spigot, flush to floor	25	25	4.83 EA
INDIVIDUALLY BAR-CODED IN A CUT CASE BOX					
NEW 888-PPK	888-APK	3" inside fit*	10	10	3.88 EA
NEW 886-PPK	886-APK	3" hub/inside 4", flush to floor*	10	10	3.12 EA
NEW 886-4PPK	886-4APK	4" hub, flush to floor	6	6	4.95 EA

* The inside diameter of pipe can vary significantly. These flanges are designed to fit inside most, but may not fit all types of pipe.

Full Flush™ Offset Closet Flange



- Full-flow, 3" I.D. throat with no restriction
- Allows for 1½" offset in any direction for closet bowl setting
- Corrosion-resistant stainless steel swivel ring is engineered for maximum strength
- Solvent welds over 3" or inside 4" Sch. 40 DWV
- Fits flush-to-floor through any 4" opening
- UPC listed

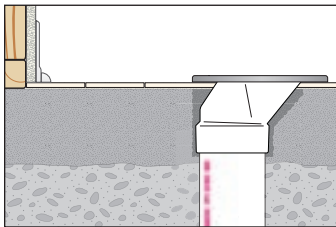

Correct Rough-in Mistake
1½" offset corrects for drain line set too close to wall.

Full Flush is the only offset closet flange that will allow a 3" ball to pass with no obstructions



PVC Item No.	ABS Item No.	Connection	Min. Qty.	Case Qty.	List Price
INDIVIDUALLY BAR-CODED BULK					
889-POM	889-AOM	3" hub/inside 4", flush to floor*	20	20	10.25 EA
INDIVIDUALLY BAR-CODED IN A CUT CASE BOX					
889-POMPK	889-AOMPK	3" hub/inside 4", flush to floor*	6	6	10.38 EA

* The inside diameter of pipe can vary significantly. These flanges are designed to fit inside most, but may not fit all types of pipe.

Drop-Kick™ 45° Outlet Closet Flange



- Full-flow, 3" I.D. throat—no restriction
- Solvent welds inside 3" Sch. 40 fitting hub
- Corrosion-resistant stainless steel swivel ring is engineered for maximum strength

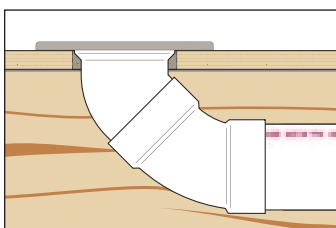

Using a standard 45° fitting, the Drop-Kick connects easily to horizontal drain lines.

Drop-Kick is the only outlet closet flange that will allow a 3" ball to pass with no obstructions

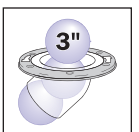

PVC Item No.	ABS Item No.	Connection	Min. Qty.	Case Qty.	List Price
INDIVIDUALLY BAR-CODED BULK					
889-45PM	889-45AM	3" spigot, flush to floor	20	20	14.50 EA
INDIVIDUALLY BAR-CODED IN A CUT CASE BOX					
889-45PMPK	889-45AMPK	3" spigot, flush to floor	10	10	14.63 EA

Cast Iron Closet Flange



- Fits over 4" cast iron DWV pipe
- Easy compression installation. Neoprene gasket
- Perfect for retro-fit or remodel applications

Item No.	Connection	Min. Qty.	Case Qty.	List Price
BULK				
890-i42B	4" cast iron compression connection	500	500	11.00 EA
INDIVIDUALLY BAR-CODED BULK				
890-i42	4" cast iron compression connection	5	5	12.00 EA



Brass Closet Flange Ring



890-4BPK



890-4BDPK

- Solid brass
- For use with lead pipe
- Deep seal model provides more surface area for better joint

Item No.	Description	Min. Qty.	Case Qty.	List Price
INDIVIDUALLY BAR-CODED IN A CUT CASE BOX				
890-4BPK	Brass closet flange ring	10	10	10.75 EA
890-4BDPK	Deep seal brass closet flange ring	10	10	17.50 EA

Quick Spacer™ Closet Flange Spacer Ring



- Fits under most closet flanges
- Each ring raises the flange 3/4" off the floor
- Use multiple rings for additional height

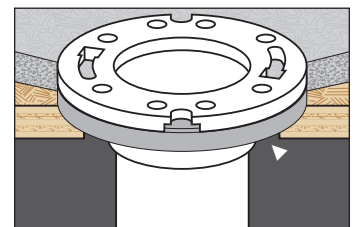

No more shim pieces

Fits under any closet flange and stops lightweight concrete pours from running under the flange.

Item No.	Description	Min. Qty.	Case Qty.	List Price
886-ER	3/4" closet flange spacer ring	25	25	2.00 EA

Ringer™

Stainless Steel Closet Ring



- Stainless steel ring is corrosion resistant
- Perfect for repairs to damaged closet flanges, or new concrete floor installations
- Fits securely over damaged flanges



Hanger card for display areas

Item No.	Description	Min. Qty.	Case Qty.	List Price
BAR-CODED CARDS IN A CUT CASE BOX				
886-MR	Stainless steel closet ring	20	20	4.40 EA

Raise-A-Ring™

Flange Extension Ring



- Build up existing flange when added subfloor, tile, etc. leaves flange at or below floor level
- Ring is 7/16" thick. Can be stacked if needed



Hanger card for display areas

Item No.	Description	Min. Qty.	Case Qty.	List Price
BAR-CODED CARDS IN A CUT CASE BOX				
886-R	Flange extension ring	20	20	2.75 EA
BAR-CODED BAGS IN A CUT CASE BOX				
886-411	Raise-A-Ring Kit: 886-R with 2 closet bolts, 2 shims/bag	20	20	5.00 EA

Urinal Flange Kit



- Hub or spigot connections available
- Kit includes: stainless steel bolts, nuts, washers, and gasket
- Horizontal slots fit 3 1/2" - 7" mounting centers

PVC Item No.	ABS Item No.	Description	Min. Qty.	Case Qty.	List Price
INDIVIDUALLY BAR-CODED BULK					
868-5P	868-5A	2" hub connection urinal flange kit	10	10	14.50 EA
868-9P	868-9A	2" spigot connection urinal flange kit	10	10	13.75 EA

Plumb Perfect™

Closet Bolt



- Tensile strength exceeds 1,100 lbs. per bolt
- Redesigned threads provide increased strength and smoother, faster threading
- 100% corrosion proof bolts are now available in convenient 2" and 3½" lengths in addition to standard 2½"
- Improved adaptability—open end nut now fits ½" sockets, and fits under most bolt caps. Bolt base loads into any flange



Wedge-It™

Multi-Purpose Stability Wedge



Soft PVC



Stiff Polypro

- Stiff polypropylene is driveable
- Soft rubber-like PVC is easy to trim and resists slipping on tile floors
- Dozens of uses on the job site, in the office, home, etc.
- Corrosion proof



DISTRIBUTED BY

tel: 1-800-821-3944
fax: 1-800-758-5950
www.siouxchief.com
P.O. Box 397
24110 South Peculiar Drive
Peculiar, Missouri 64078 USA

