

INSTALLATION INSTRUCTIONS:

- 1- Cut cleat 1/2" smaller than the longest duct side length with snips.
- 2- Push/Hammer cleat onto duct end on both sides, flange side facing out.
- 3- Push/Hammer other duct length into the other open side of the cleat profile.

NOTE:

Used for residential applications. Industrial tape, foil, or sealer can be used. Typically used to reinforce duct sizes 24" or greater.

WARNING!!

Improper installation may result in damage to product or inefficiencies in the system. Use proper PPE and equipment during cutting, bending, and installation processes. If local codes differ from these instructions follow local building codes.

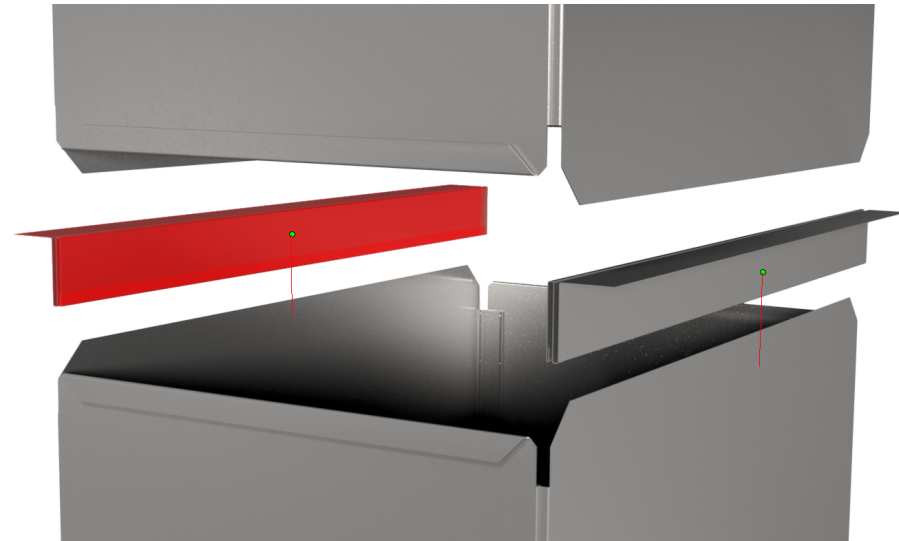
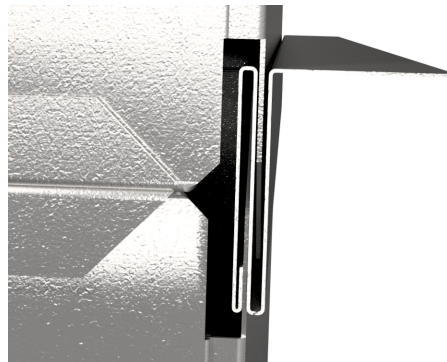

INSTALLATION VIEW



INSTALLED VIEW