



455 MALLEABLE SPLIT RING HANGER, EG, 2 1/2" PIPE, 2.875" OD, 1/2" ROD

CATALOG NUMBER

4550250EG



FEATURES

Recommended for the suspension of stationary non-insulated pipe lines

Allows for piping runs close to ceiling or walls

Conforms with Federal Specification WW-H-171 (Type 25), Manufacturers Standardization Society (MSS) SP-58 (Type 12)

PRODUCT ATTRIBUTES

Material: Cast Iron

Finish: Electrogalvanized

Pipe Size: 2 1/2"

Outer Diameter: 2 7/8"

Rod Size: 1/2"

A: 3 1/4"

B: 5/8"

Static Load: 300 lb

ADDITIONAL PRODUCT DETAILS

Bolt and rivet are carbon steel.

DIAGRAMS

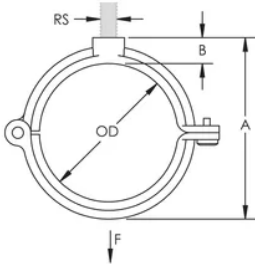

WARNING

nVent products shall be installed and used only as indicated in nVent's product instruction sheets and training materials. Instruction sheets are available at www.nvent.com and from your nVent customer service representative. Improper installation, misuse, misapplication or other failure to completely follow nVent's instructions and warnings may cause product malfunction, property damage, serious bodily injury and death and/or void your warranty.

North America

+1.800.753.9221

Option 1 – Customer Care

Option 2 – Technical Support

Europe

Netherlands:

+31 800-0200135

France:

+33 800 901 793

Europe

Germany:

800 1890272

Other Countries:

+31 13 5835404

APAC

Shanghai:

+ 86 21 2412 1618/19

Sydney:

+61 2 9751 8500



Our powerful portfolio of brands:
nVent.com **CADDY** **ERICO** **HOFFMAN** **RAYCHEM** **SCHROFF**
TRACER