



# SERVICE PARTS LIST

**BULLETIN NO.**  
**54-49-8402**

SPECIFY CATALOG NO. AND SERIAL NO. WHEN ORDERING PARTS		REVISED BULLETIN	DATE
<b>PACKOUT™ Organizers</b>			Sept. 2022
CATALOG NO.	SERIAL NUMBER	WIRING INSTRUCTION	

48-22-8430	PACKOUT™ Organizer Assembly	Page 1
48-22-8435	PACKOUT™ Compact Organizer Assembly	Page 2
48-22-8431	PACKOUT™ S-Organizer Assembly	Page 3
48-22-8436	PACKOUT™ S-Organizer Compact Assy.	Page 4
48-22-8432	PACKOUT™ Deep Organizer	Page 5

**EXAMPLE:**  
Component Parts (Small #) Are Included  
When Ordering The Assembly (Large #).

## 48-22-8430 PACKOUT™ Organizer

FIG.	PART NO.	DESCRIPTION OF PART	NO. REQ.
3	43-62-8430	Side Handle Service Kit	(1)
4	-----	Pin	(2)
5	44-20-8430	Latch Service Assembly (Set of 2)	(1)
7	43-44-8430	Lid Gasket (Not Shown)	(1)
9	31-01-0501	5 Bin Kit (Set of 1)	(2)
9a	-----	Large Bin	(1)
9b	-----	Small Bin	(4)
10	31-01-8430	Large Bin Kit (Set of 2)	(1)

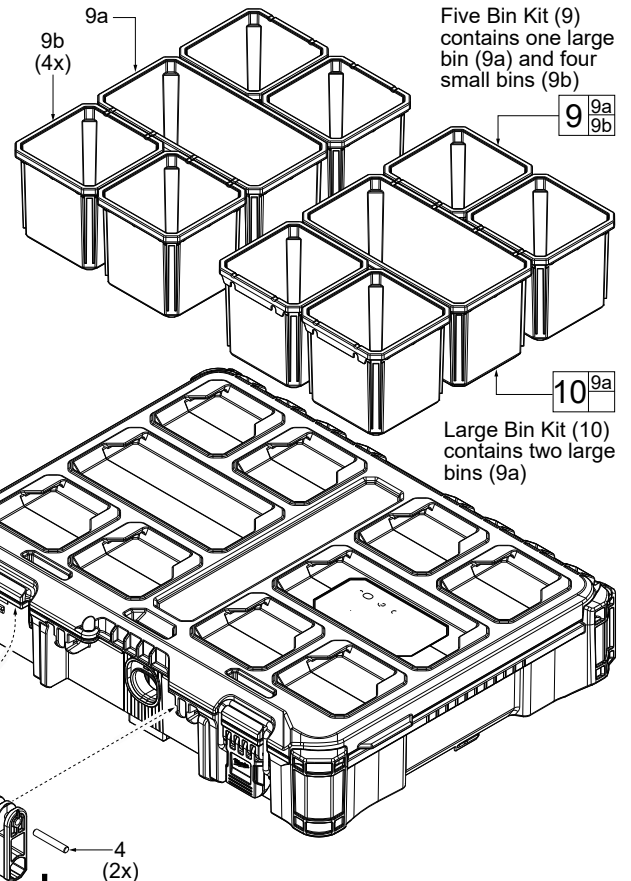

Pins to be installed from the  
inside of the handle.



As an aid to removing a damaged Latch Assembly, use two large flat blade screwdrivers. Push blades between parts as shown. Twist both screwdrivers at same time to force the blades into opening and work the latch assembly over the two locking tabs.

To install a new latch assembly, position entire latch assembly over locking tabs with the two top lugs partially inserted in 'catch cavity' of main housing. Engage latch bar onto lid and gently press latch lever to slide assembly over two locking tabs and into place.

This removal and installation process will be the same where other service latches are offered in this system.

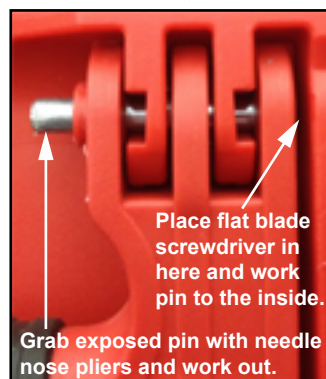

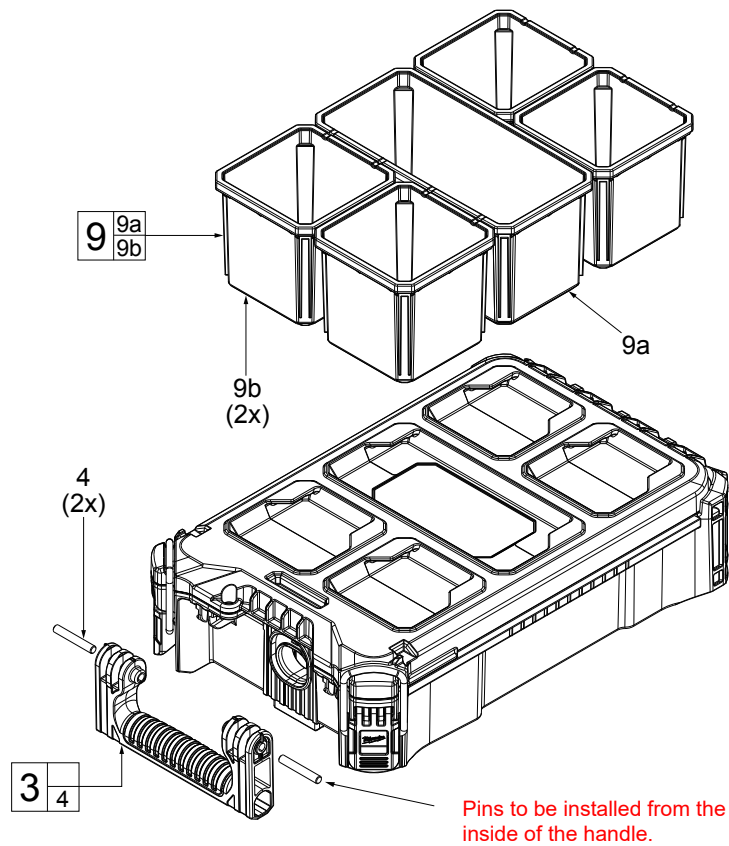

#### 48-22-8435 PACKOUT™ Compact Organizer

FIG.	PART NO.	DESCRIPTION OF PART	NO. REQ.
3	43-62-8435	Side Handle Service Kit	(1)
4	-----	Pin	(2)
7	43-44-8435	Lid Gasket (Not Shown)	(1)
9	31-01-0501	5 Bin Kit	(1)
9a	-----	Large Bin	(1)
9b	-----	Small Bin	(4)

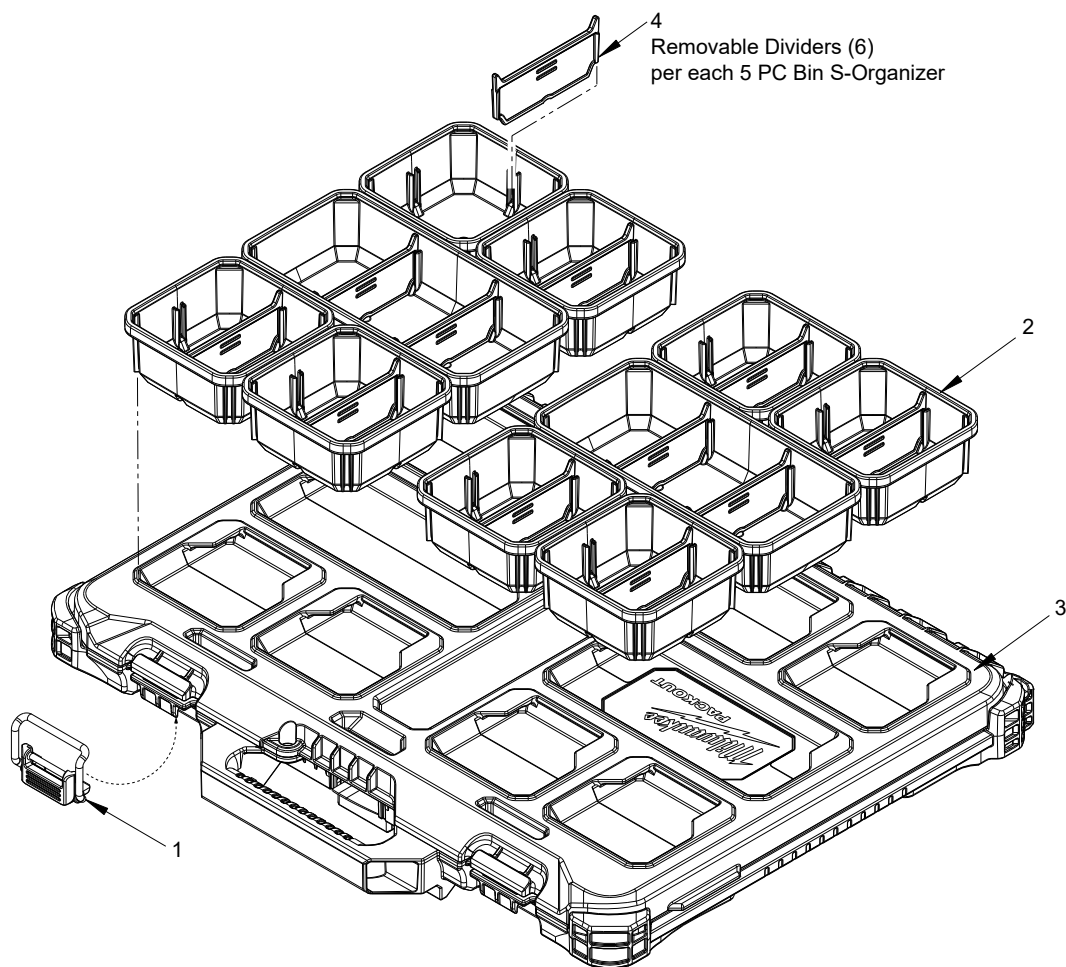

#### 48-22-8431 PACKOUT™ S-Organizer Assembly

FIG.	PART NO.	DESCRIPTION OF PART	NO. REQ.
1	44-20-8431	LP Organizer Latch (Set of 2)	(1)
2	31-01-0502	5 PC Bin S-Organizer with 6 Dividers	(2)
3	43-44-8430	Lid Gasket (Not Shown)	(1)
4	31-01-0503	Spare Divider Kit, 6 pcs.	(0)

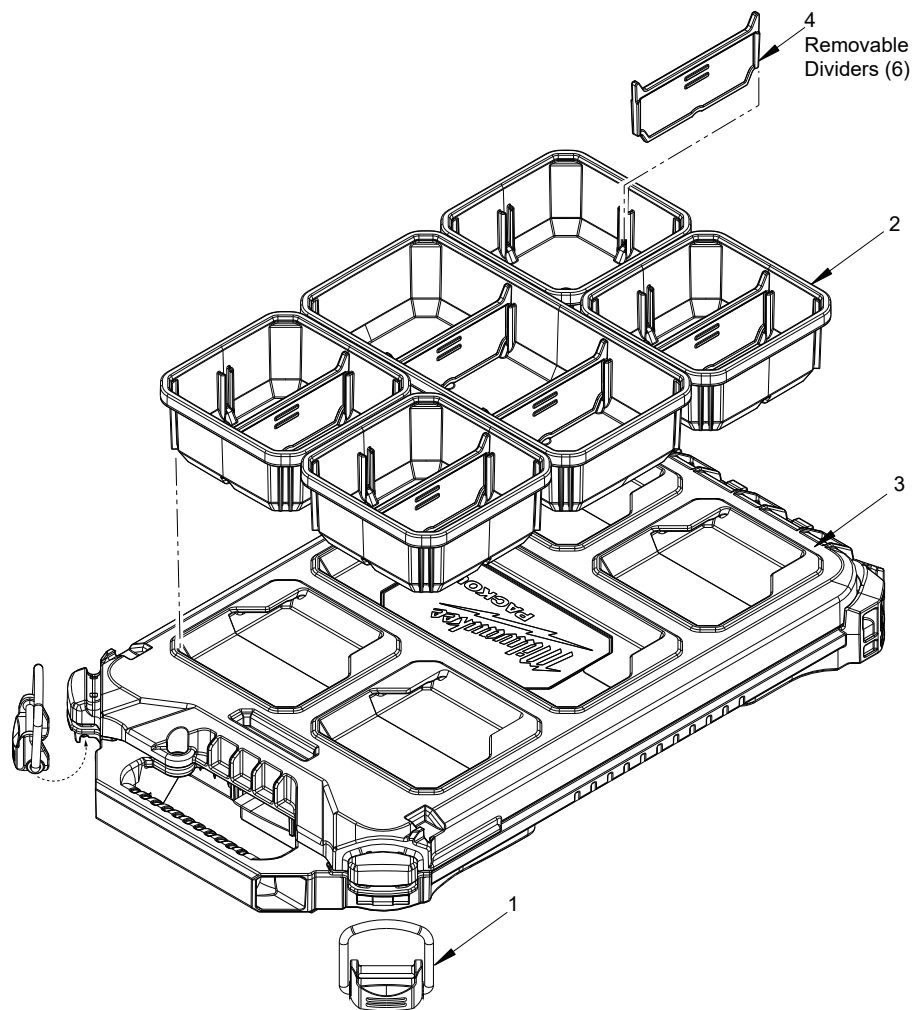

#### 48-22-8436 PACKOUT™ S-Organizer Compact Assembly

FIG.	PART NO.	DESCRIPTION OF PART	NO. REQ.
1	44-20-8436	LP Compact Org Latch (Set of 2)	(1)
2	31-01-0502	5 PC Bin S-Organizer with 6 Dividers	(1)
3	43-44-8435	Lid Gasket (Not Shown)	(1)
4	31-01-0503	Spare Divider Kit, 6 pcs.	(0)

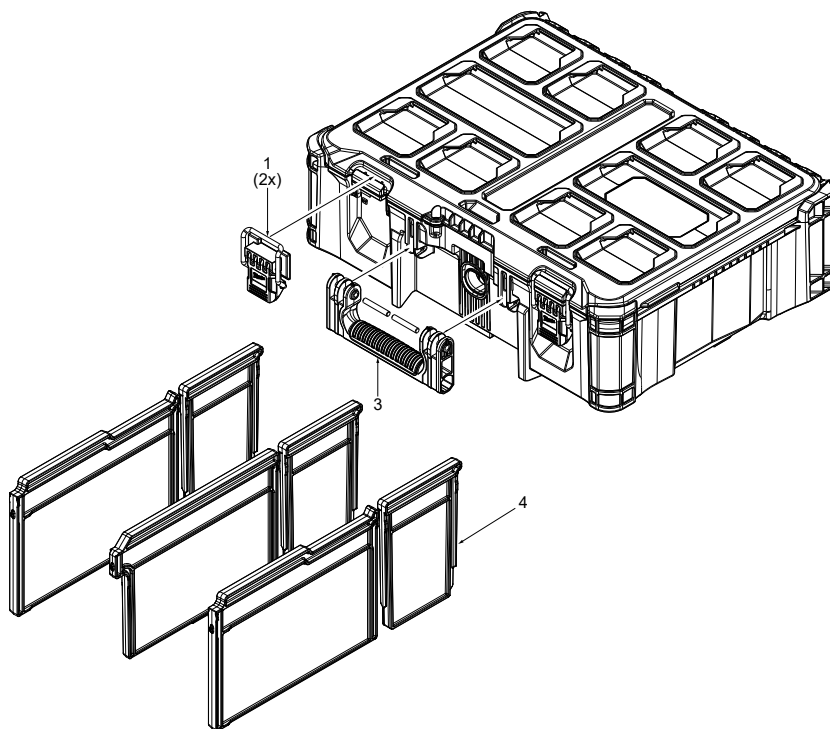

# **48-22-8432 PACKOUT™ Deep Organizer**

FIG.	PART NO.	DESCRIPTION OF PART	NO. REQ.
1	44-20-8430	Service Latch Assembly (Set of 1)	(2)
2	43-44-8430	Lid Service Gasket (Not Shown)	(1)
3	43-62-8430	Service Handle	(1)
4	31-01-8432	Divider Service Kit	(1)