

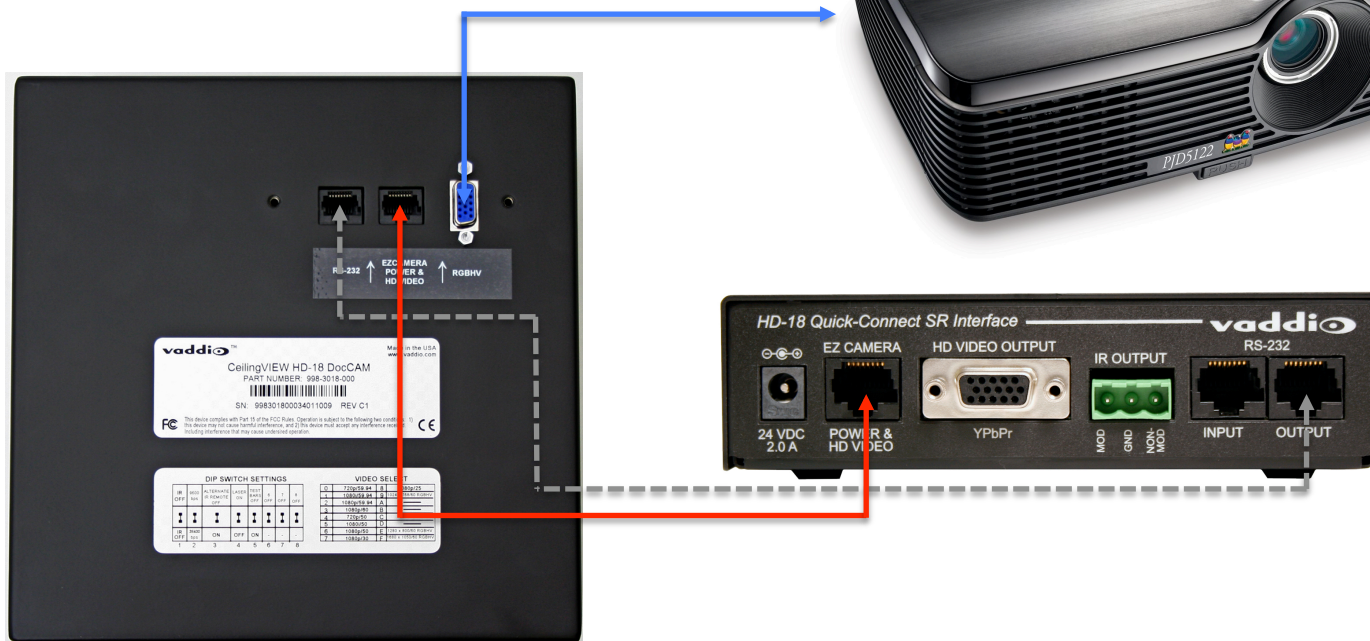

Things to remember:

- \*Cables not included
- \*Plenum rated wiring will be required in certain applications



- Notes:
- When RGBHV port on camera back box is used to directly connect to your video source the HD-18 Quick-Connect SR Interface will not deliver video.
  - The HD-18 Quick-Connect SR Interface is solely for delivering power and control to camera back box.
  - With rotary switch,(located near the camera lens) select 9,E, or F for the RGBHV resolution you would like.

DIP SWITCH SETTINGS							
IR ON	9600 bps	ALTERNATE IR REMOTE OFF	LASER ON	TEST BARS OFF	6 OFF	7 OFF	8 OFF
IR OFF	38400 bps	ON	OFF	ON	—	—	—
1	2	3	4	5	6	7	8

VIDEO SELECT			
0	720p/59.94	8	1080p/25
1	1080i/59.94	9	1024 x 768/60 RGBHV
2	1080p/59.94	A	—
3	1080p/60	B	—
4	720p/50	C	—
5	1080i/50	D	—
6	1080p/50	E	1280 x 800/60 RGBHV
7	1080p/30	F	1680 x 1050/60 RGBHV