



**Network Metered  
Network Switched  
Power Distribution Unit  
Quick Start Guide**



## Safety Precautions

- WARNING!** Read and understand all sections in this guide before installing or operating this product. Failure to heed any of the following WARNINGS may result in electric shock, fire, personal injury and death. Prior to operating this product, the user should read the online help and specifically the warnings in the online help.
- WARNING!** Connect this product to an AC power source whose voltage is within the range specified on the product's nameplate.
- WARNING!** Connect this product to an AC power source that is current limited by a suitably rated fuse or circuit breaker in accordance with national and local electrical codes.
- WARNING!** Use this product in a dry location.
- WARNING!** Connect this product to a protective earth ground. Never use a "ground lift adaptor" between the product's plug and the wall receptacle.
- WARNING!** If this product is a model that requires assembly of its line cord or plug, all such assembly must be performed by a licensed electrician and the line cord or plugs used must be suitably rated based on the product's nameplate ratings and national and local electrical codes.

### FCC Compliance Statement (Class A):

- This device complies with part 15 of the FCC Rules. Operation is subject to the following two conditions:
- (1) This device may not cause harmful interference, and
  - (2) This device must accept any interference received, including interference that may cause undesired operation.

### Federal Communications Commission (FCC) Statement :

This equipment has been tested and found to comply with the limits for a Class A digital device, pursuant to part 15 of the FCC Rules. These limits are designed to provide reasonable protection against harmful interference when the equipment is operated in a commercial environment. This equipment generates, uses, and can radiate radio frequency energy and, if not installed and used in accordance with the instruction manual, may cause harmful interference to radio communications. Operation of this equipment in a residential area is likely to cause harmful interference in which case the user will be required to correct the interference at his own expense.

### FCC Caution - §15.21:

Changes or modifications not expressly approved by the party responsible for compliance could void the user's authority to operate the equipment.



**CAUTION:**  
To reduce the risk of shock — Use indoors only in a dry location. No user serviceable parts inside. Refer servicing to qualified personnel. For use with IT equipment only. Disconnect power before servicing.

0U Network Metered PDU Overview

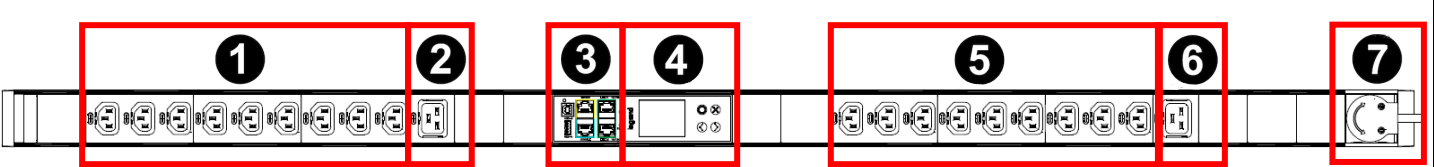

\*Model LP-42201 shown. PDU models may vary in features and design.

- |  |   |
|--|---|
| 1. IEC C13 Integrated Locking Receptacles                      | 4. LED Display: See LED Display (on page 9) |
| 2. IEC C19 Integrated Locking Receptacles                      | 5. IEC C13 Integrated Locking Receptacles   |
| 3. Controller with Connector Ports: See Controller (on page 8) | 6. IEC C19 Integrated Locking Receptacles   |
|  | 7. Rotatable Power Inlet Cord               |

1U Network Metered PDU Overview

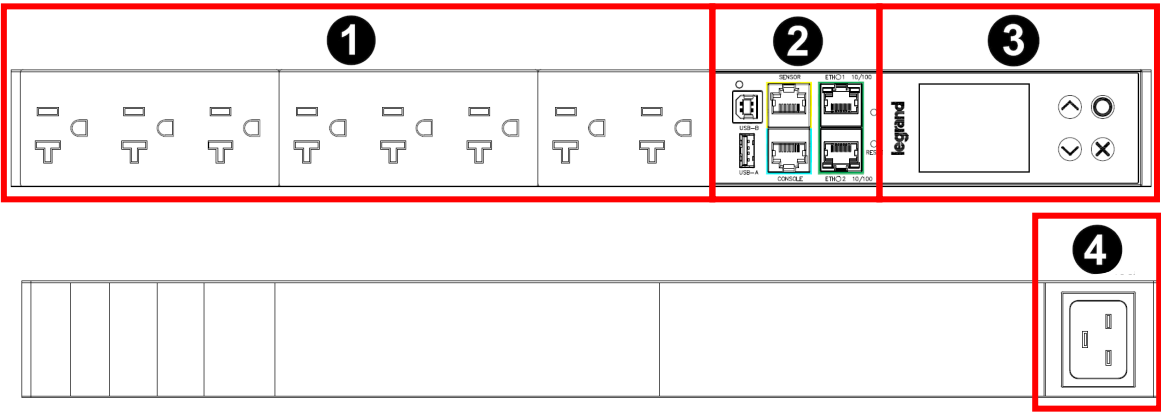

\*Model LP-41210 shown. PDU models may vary in features and design.

- |  |  |
|--|--|
| 1. NEMA 5-20R Receptacles                                      | 3. LED Display: See LED Display (on page 9)          |
| 2. Controller with Connector Ports: See Controller (on page 8) | 4. IEC C19 Receptacle for Removable Inlet Power Cord |

2U Network Metered PDU Overview

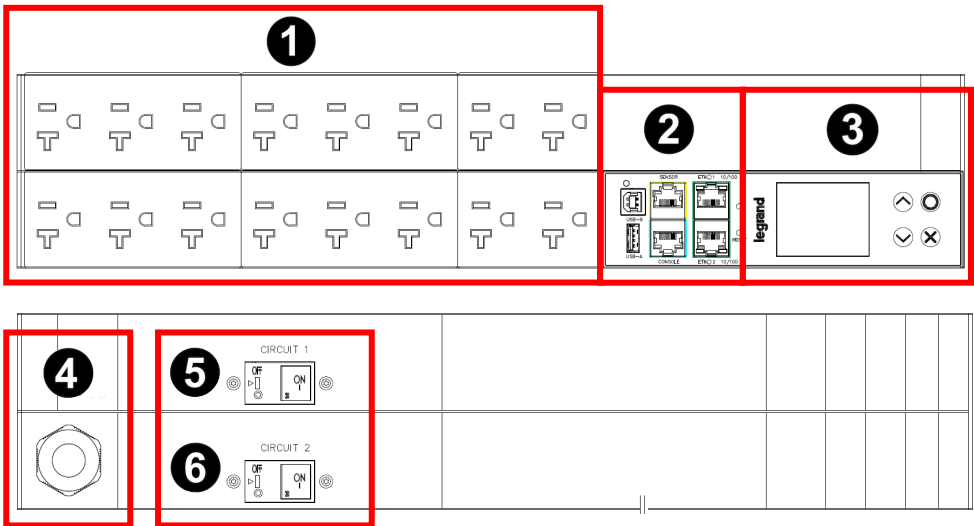

\*Model LP-41320 shown. PDU models may vary in features and design.

- |  |                     |
|--|---------------------|
| 1. NEMA 5-20R Receptacles                                      | 4. Inlet Power Cord |
| 2. Controller with Connector Ports: See Controller (on page 8) | 5. Circuit 1        |
| 3. LED Display: See LED Display (on page 9)                    | 6. Circuit 2        |

0U Network Switched PDU Overview



\*Model LP-62300 shown. PDU models may vary in features and design.

- |  |  |
|--|--|
| 1. IEC C13 Integrated Locking Receptacles                      | 7. IEC C19 Integrated Locking Receptacles  |
| 2. IEC C19 Integrated Locking Receptacles                      | 8. Circuit 2                               |
| 3. Circuit 1   | 9. IEC C13 Integrated Locking Receptacles  |
| 4. Controller with Connector Ports: See Controller (on page 8) | 10. IEC C19 Integrated Locking Receptacles |
| 5. LED Display: See LED Display (on page 9)                    | 11. Circuit 3                              |
| 6. IEC C13 Integrated Locking Receptacles                      | 12. Rotatable Power Inlet Cord             |

1U Network Switched PDU Overview

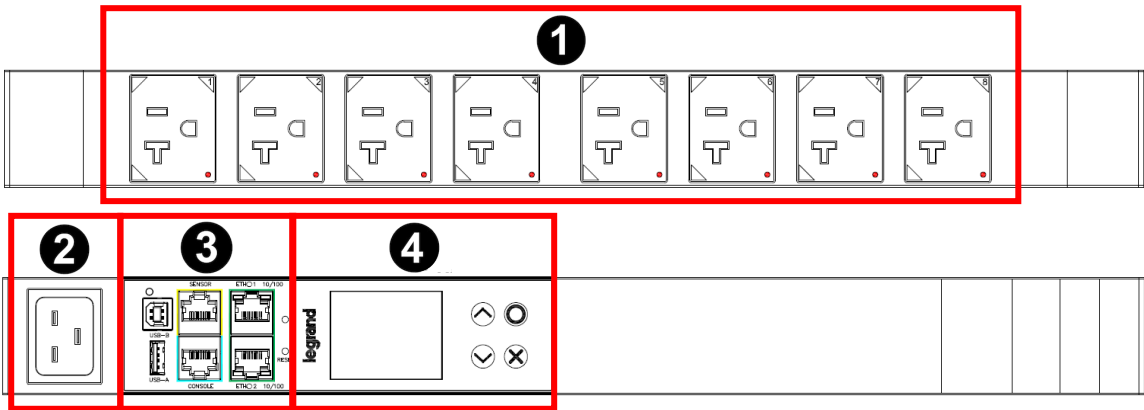

\*Model LP-61210 shown. PDU models may vary in features and design.

- |  |  |
|--|--|
| 1. NEMA 5-20R Receptacles                            | 3. Controller with Connector Ports: See Controller (on page 8) |
| 2. IEC C19 Receptacle for Removable Inlet Power Cord | 4. LED Display: See LED Display (on page 9)                    |

2U Network Switched PDU Overview

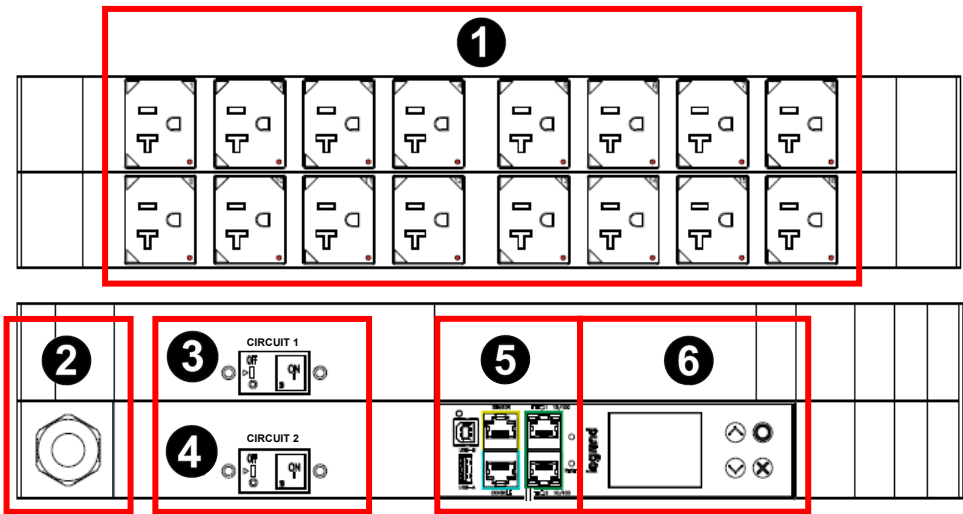

\*Model LP-61320 shown. PDU models may vary in features and design.

- |                           |  |
|---------------------------|--|
| 1. NEMA 5-20R Receptacles | 4. Circuit 2   |
| 2. Inlet Power Cord       | 5. Controller with Connector Ports: See Controller (on page 8) |
| 3. Circuit 1              | 6. LED Display: See LED Display (on page 9)                    |

# Vertical 0U Mounting

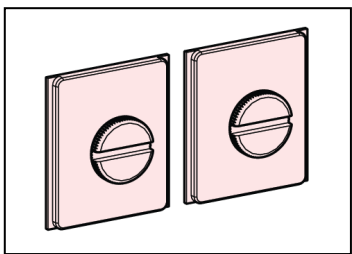

- 1. Slide flat button mount onto rear of PDU device.  
Determine the spacing that is required for the PDU to align with holes on PDU mounting bracket or rack and slide button mount into place.
- 2. Rotate button on mount to secure.
- 3. Mount by positioning the PDU at the rack, then pressing the buttons through the key-holes in the PDU mounting bracket.
- 4. Let the PDU drop down slightly to lock into place.

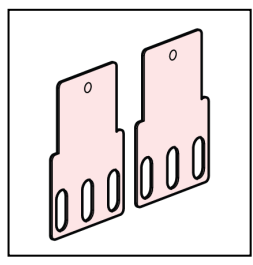
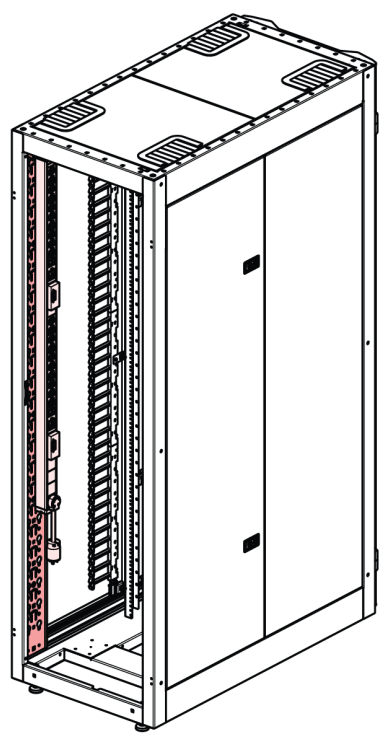
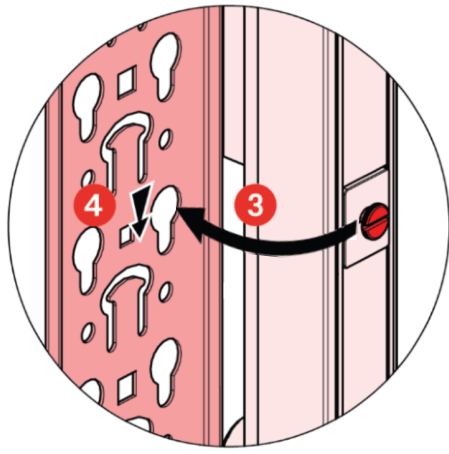
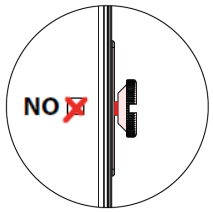
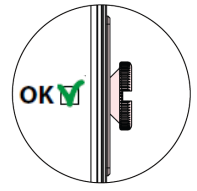
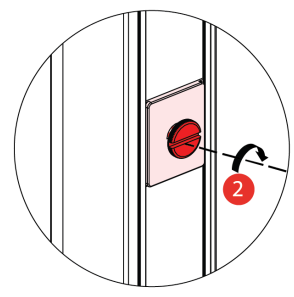
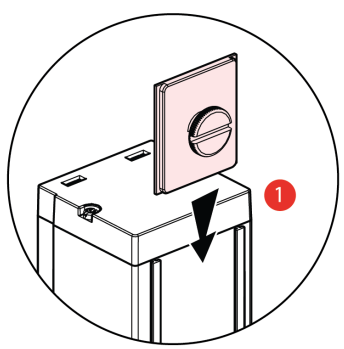

- 1. Slide brackets into both ends of the channel on the rear of the PDU. Align the raised side of the circular indentation to the rear face of the PDU to ensure a secure fit.
- 2. Using rack screws (not included), fasten the PDU to the rack by aligning the opening of the attached brackets.

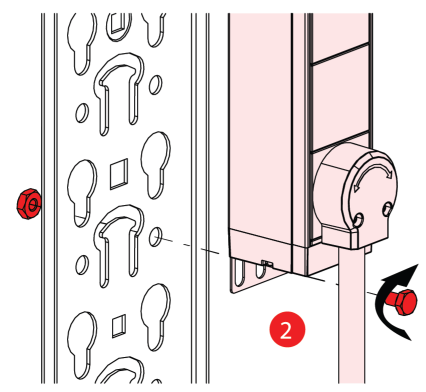
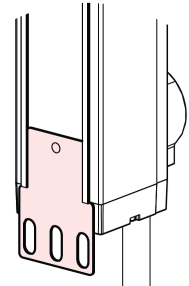
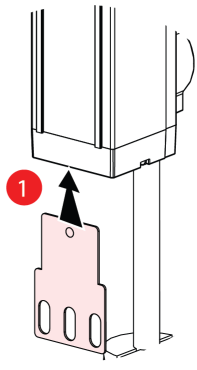

# Horizontal 1U & 2U Mounting

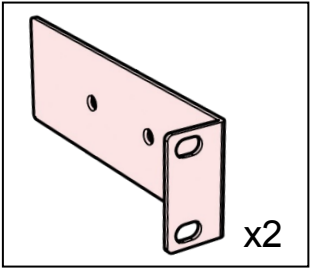

- 1. Attach mounting brackets to each end of the PDU using provided bracket screws.
- 2. Choose a location in the rack to mount the PDU. For rack rails with square holes, insert cage nuts (not included) in applicable rack spaces.
- 3. Using rack screws (not included), fasten the PDU to the rack by aligning the mounting holes of the attached brackets with the installed cage nuts or threaded rack rail holes. Tighten screws to secure.

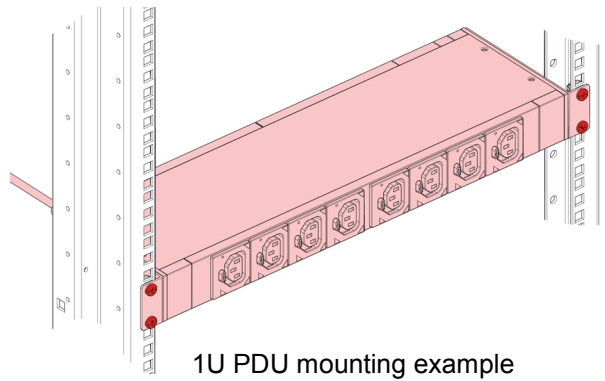
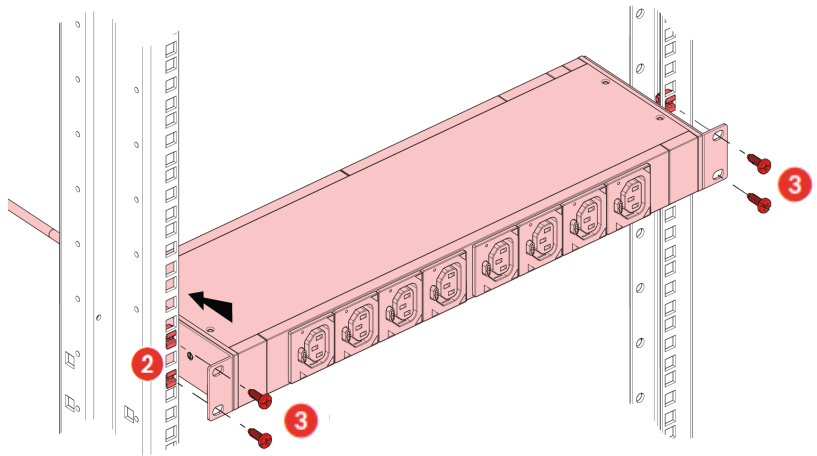
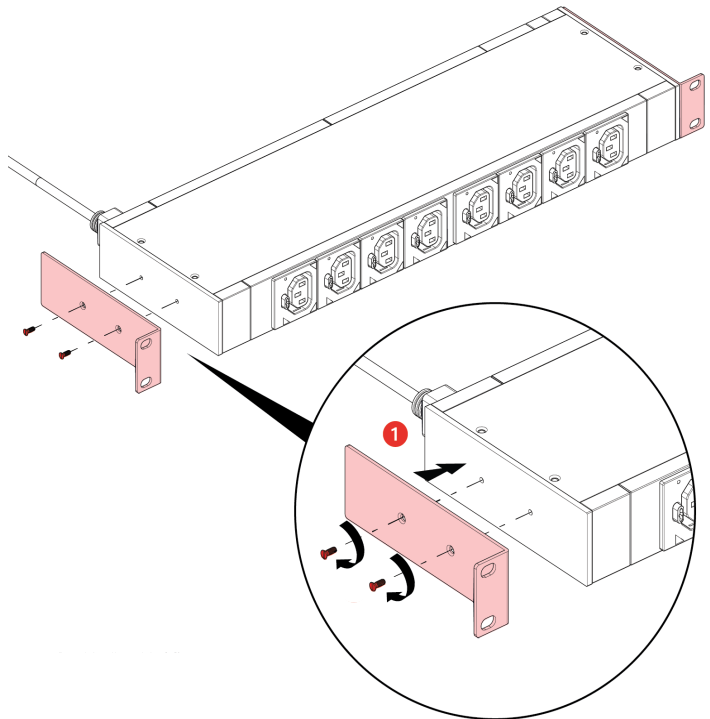

1U PDU mounting example

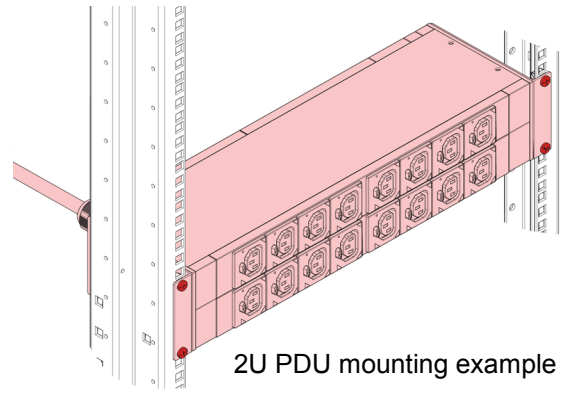

2U PDU mounting example

# Horizontal 1U & 2U Mounting (Rear Facing Option)

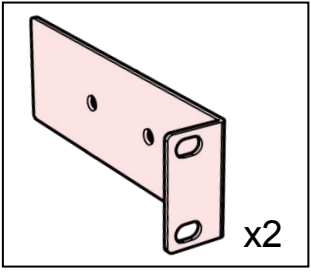

- 1. Reverse PDU for rear face mounting option.
- 2. Attach mounting brackets to each end of the PDU using provided bracket screws.
- 3. Choose a location in the rack to mount the PDU. For rack rails with square holes, insert cage nuts (not included) in applicable rack spaces.
- 4. Using rack screws (not included), fasten the PDU to the rack by aligning the mounting holes of the attached brackets with the installed cage nuts or threaded rack rail holes. Tighten screws to secure.

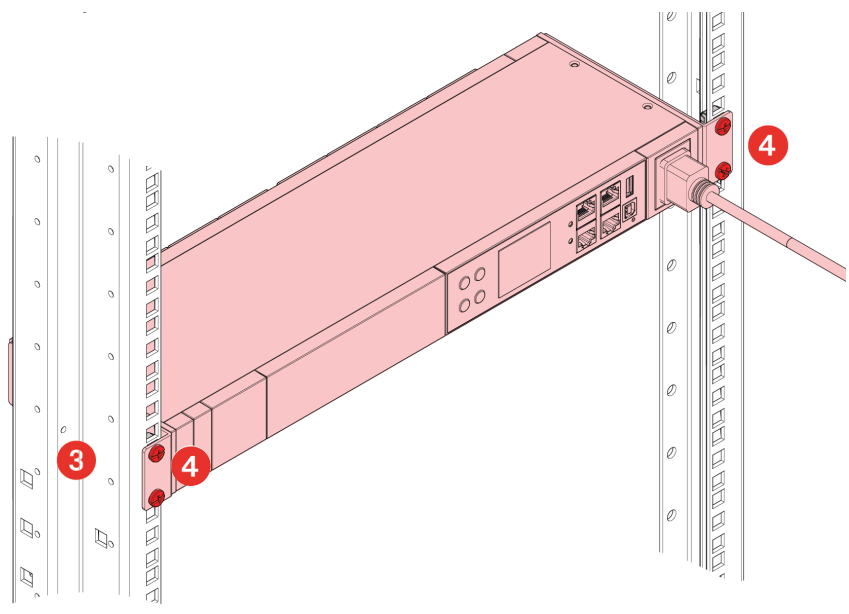
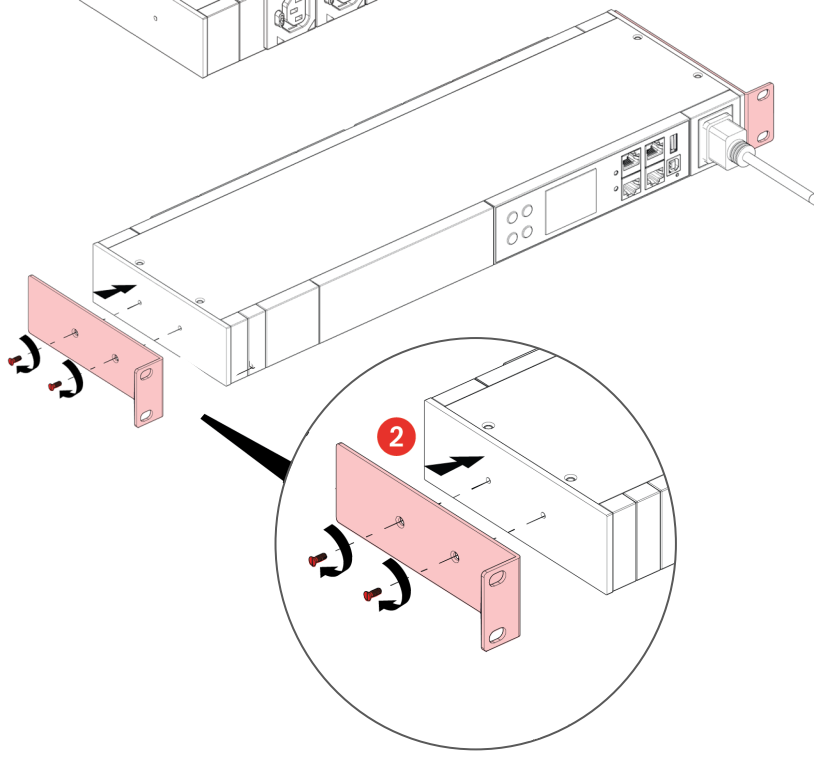
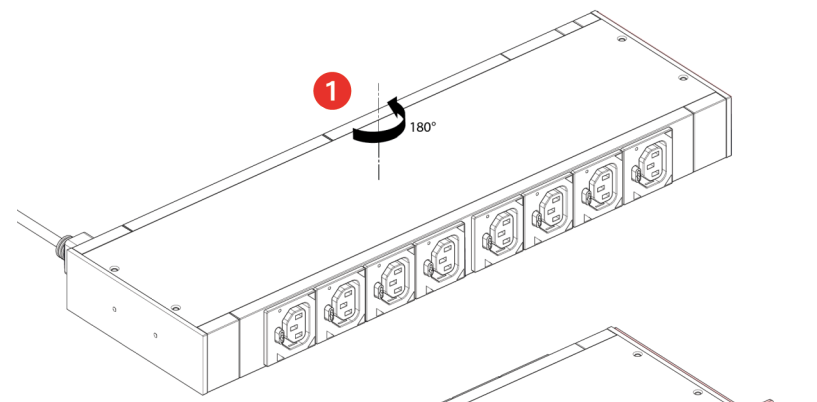



Power On the PDU

If your Legrand PDU model has circuit breakers, verify that all circuit breakers on the device are set to ON. If not, turn them ON.

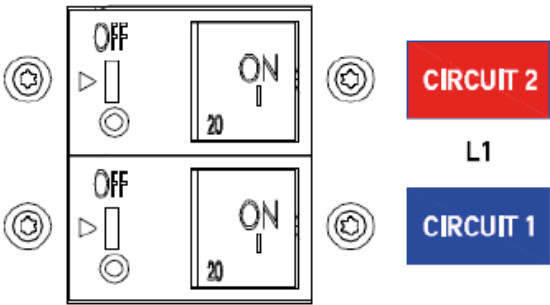

\*Note: PDU models may vary in features and design.

Plug each Legrand PDU into an appropriately rated branch circuit with the proper mating connector/receptacle. See the label or nameplate affixed to your Legrand PDU for appropriate input ratings or range of ratings.

Product Label Example



Outer Carton Label Example



Wait a few moments for the power-on self test and software loading. When complete, the front panel illuminates.

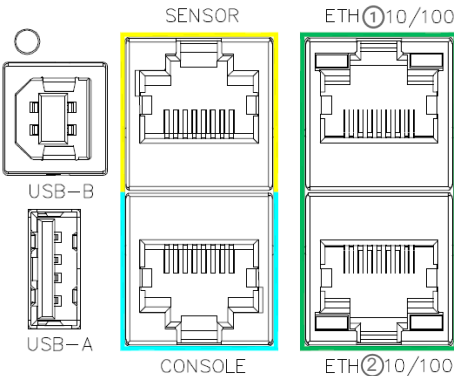

legrand



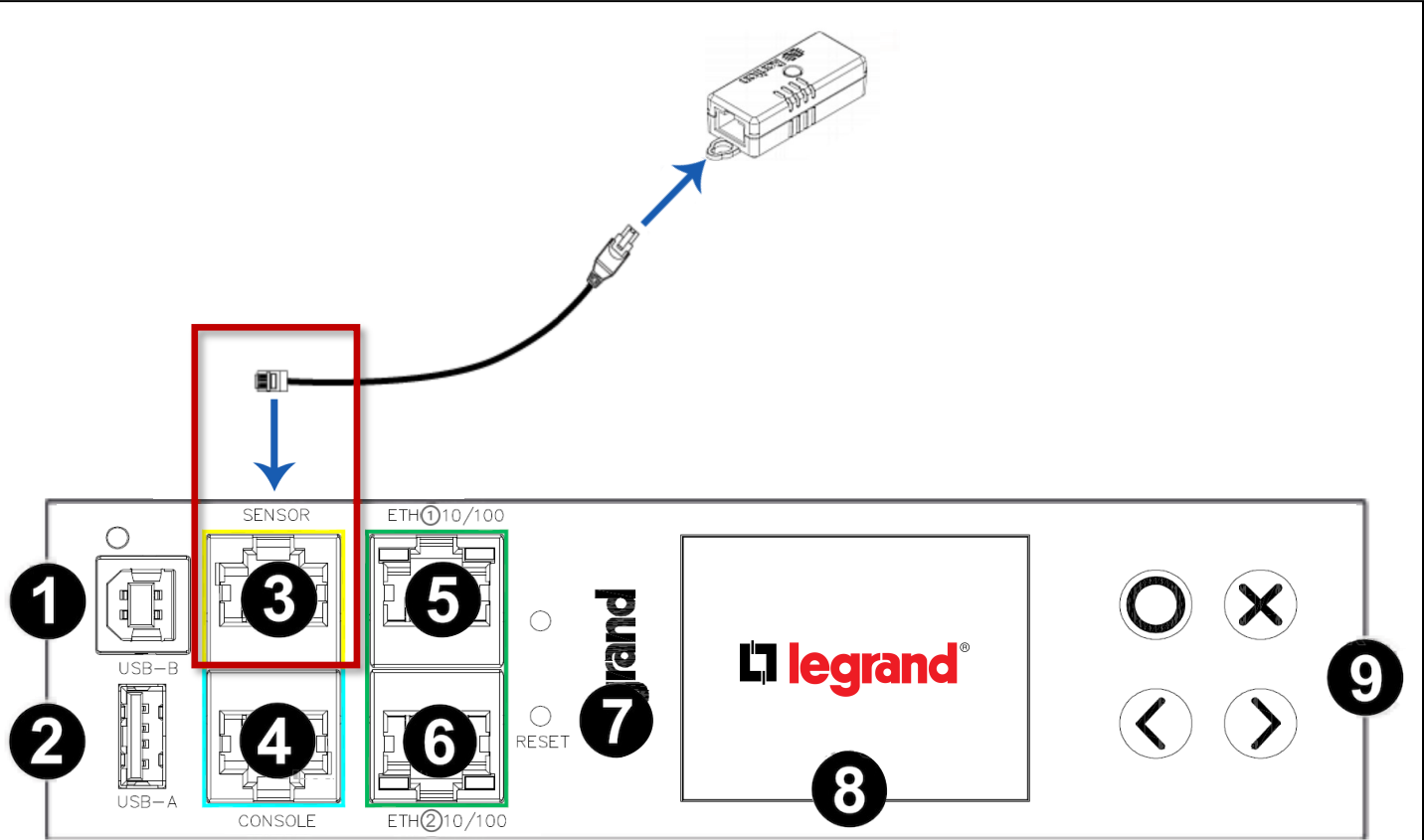

Controller



- 1. USB-B - Cascade devices to share a network connection.
  - Establish a USB connection to a computer for CLI use or disaster recovery.
- 2. USB-A - Powered USB 2.0 port.
  - Cascade devices to share a network connection.
  - Connect a USB device, such as a Logitech webcam or wireless LAN adapter.
- 3. Sensor Port - RJ-45 connector.
  - If you have optional environmental sensors or a hub, connect here. DPX3-T1H1 shown here. Some sensors require an RJ-45 adapter.
  - See Set Thresholds on Sensors (on page 12) for details on setting up your sensors for alerts.
- 4. Console Port - RJ-45 connector.
  - Establish a serial connection to a computer.
- 5. ETH1 & ETH2 10/100 Ports- Use either Ethernet port for network connection or cascading.
  - Supports up to 100Mbps.
- 6. ETH2 & ETH2 10/100 Port LEDs - Green LED: physical link and activity.
  - Yellow LED: communications at 10/100 BaseT speeds.
- 7. Reset Button - Pinhole reset button.
  - Resets to factory defaults when a serial connection is present.
  - Restarts the PDU software without loss of power to outlets when serial connection is not present.
- 8. LED Display - View PDU and outlet information.
  - Switch outlets on models with switching.
- 9. Control Buttons for LED Display - View alerts.

 Enter / Select

 Escape / Cancel

 Scroll Up

 Scroll Down

# LED Display

Use the front panel display buttons to access information about your PDU in the display.

Inlet I1

2/2

Voltage:  
**127** V

Frequency:  
**50.0** Hz

Current:  
**0.000** A

11:34 AM Menu

Alert List

No Alerts

Back 12:01 PM

- Automatic mode shows inlet pages or alerts when they are present.
- Scroll with arrow buttons to view all pages, indicated in top right corner.
- PDU models may vary in features and design.

Main Menu

Alerts

PDU

Inlet I1

Peripherals

Assets

Device Info

Auto 11:38 AM Select

- Scroll with arrow buttons to select items in menu.
- Check the bottom corners for available operations on each page.
- PDU models may vary in features and design.

Alerts

1 warned

Recent transitions

Temperature 1 12:27

Menu 12:27 PM Alert list

Alerts

1 critical  
1 warned

Recent transitions

Relative Humidity 1 12:31

Temperature 1 12:27

Menu 12:31 PM Alert list

- When alerts are present, display color is yellow or red.
- Display is red when any critical level alerts are present.
- PDU models may vary in features and design.

## Connect to the Network

### Wired Connections:

Connect the PDU ETH1 or ETH2 to your LAN using standard network patch cables.  
When connecting both ETH1 and ETH2 ports to your LAN, ensure that each connection is made to a different subnet.



### Wireless Connections:

Connect a supported USB wireless LAN adapter to the PDU USB-A port. OR: Connect a USB hub to the PDU USB-A port, then plug the supported USB wireless LAN adapter.



### Supported Wireless LAN Adapters and Configuration:

Network type: 802.11 A/B/G/N  
Protocol: WPA2 (RSN) • Key management: WPA-PSK, or WPA-EAP with PEAP and MSCHAPv2 authentication  
Encryption: CCMP (AES)

Wi-Fi LAN adapters	Supported 802.11 protocols
SparkLAN WUBR-508N	A/B/G/N
Proxim Orinoco 8494	A/B/G
Zyxel NWD271N	B/G
Edimax EW-7722UnD	A/B/G/N
TP-Link TL-WDN3200 v1	A/B/G/N
Raritan USB WIFI	A/B/G/N

## Web Interface

### Login to Web Interface

Use a supported web browser to go to the IP address of the PDU. You can retrieve the IP address from the LED display: Menu > Device Info > ETH1 or ETH2 page.

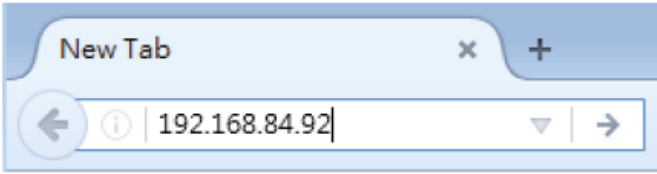

### Default Login:

User Name: admin  
Password: legrand

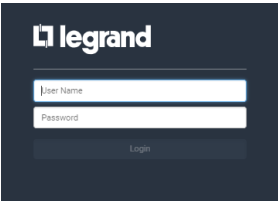

### Supported Web Browsers

Internet Explorer® 11  
Firefox® 52 and later  
Safari® (Mac)  
Google® Chrome® 52 and later  
Android 4.2 and later  
iOS 7.0 and later

### Web Interface Overview

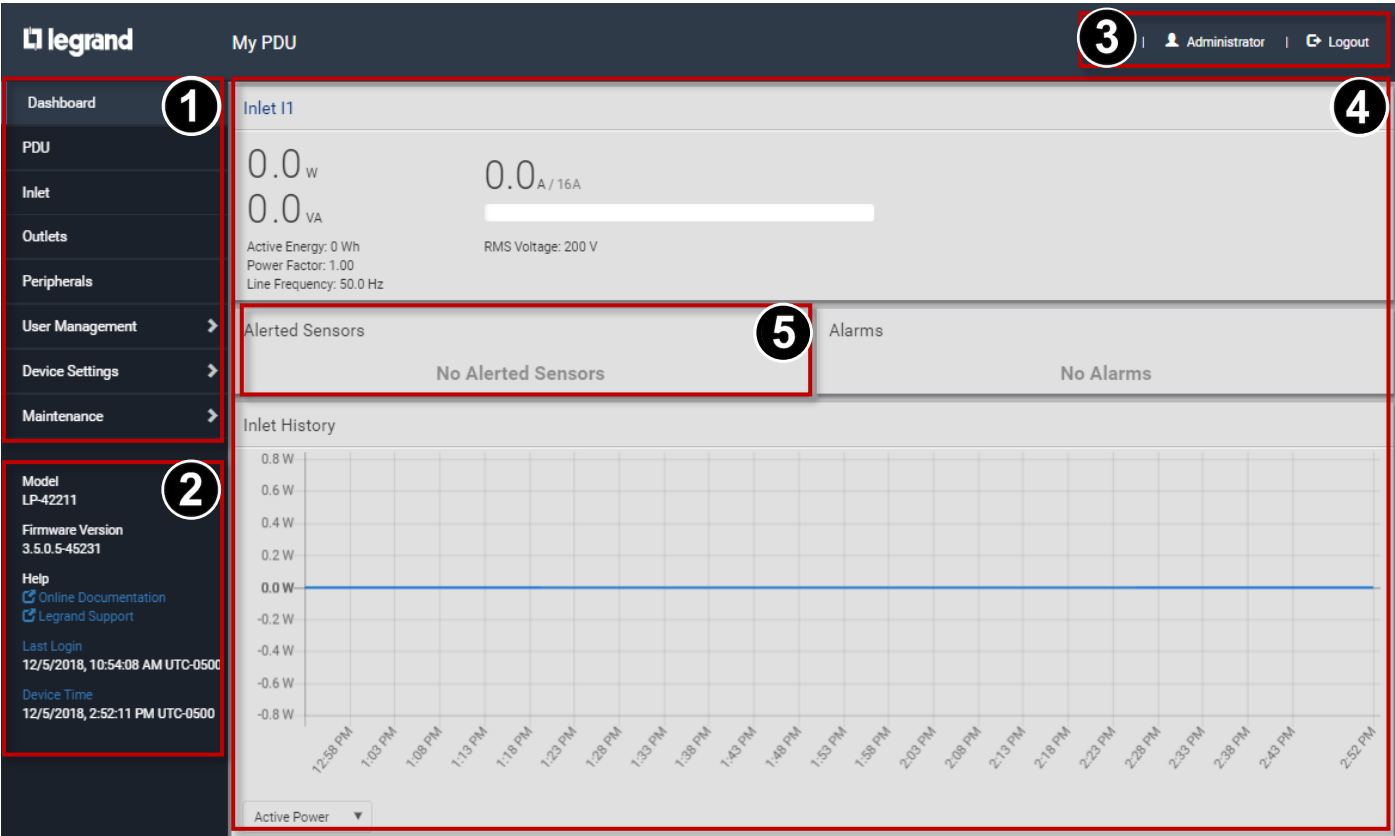

1. Menu - Click a Menu item to go to that page. Your menu items may vary based on your PDU model and accessories.
2. Info area - Model number
  - Firmware version
  - Help links: Click to go to online help and technical support.
  - Your last login date and time: Click to go to login history.
  - Device Time: Click to go to device time settings.
3. User Name and Logout - Logged in username
  - Click to logout.
4. Dashboard - This example shows the Dashboard page to view Inlet readings, Alerts, Alarms, Inlet History. Your dashboard may vary based on your PDU model.
5. Alerted Sensors
  - When internal or environmental sensors enter a warning or critical state, the Alerted Sensors appear here until they are cleared. Click to go to details.
  - You can set thresholds for these alerts. See **"Set Thresholds on Sensors"** on page 12.

Web Interface

Set Thresholds on Sensors

If you have optional environmental sensors, follow these tips for web configuration.

- Click Peripherals in the Menu to view your connected external sensors.
- Numeric sensors, such as temperature and humidity sensors, have threshold values that control when alerts appear. Alerts appear in the Dashboard and the LED display of your PDU.

legrand

My PDU

EN | Administrator | Logout

Dashboard

PDU

Inlet

Outlets

Peripherals

User Management

Device Settings

Maintenance

Peripheral Devices

#	Name	Reading	State	Type	Serial Number	Position	Actuator
1	Temperature 1	75.2 °F	normal	Temperature	QMSemu0004	Port 1, Chain position 4	
2	Relative Humidity 1	42 %	normal	Humidity	QMSemu0004	Port 1, Chain position 4	
3	Hall Effect 1		normal	Magnetic Contact	QLLemu0001	Port 1, Chain position 1	
4	On/Off 1		normal	Contact Closure	QLLemu0001	Port 1, Chain position 1, Channel 1	
5	On/Off 2		normal	Contact Closure	QLLemu0001	Port 1, Chain position 1, Channel 2	
6	On/Off 3		normal	Contact Closure	QLLemu0001	Port 1, Chain position 1, Channel 3	
7	On/Off 4		normal	Contact Closure	QLLemu0001	Port 1, Chain position 1, Channel 4	
8	On/Off 5		normal	Contact Closure	QLLemu0001	Port 1, Chain position 1, Channel 5	

- Click the Name to configure. When the sensor page opens, click Edit Thresholds.

legrand

My PDU

EN | Administrator | Logout

Dashboard

PDU

Inlet

Outlets

Peripherals

User Management

Device Settings

Maintenance

Temperature 1

Details

Peripheral device ID	1
Position	Port 1, Chain position 4
Serial number	QMSemu0004
Type	Temperature

Sensor

Reading	75.2 °F	Edit Thresholds
State	normal	
Last time changed	12/5/2018, 3:24:20 PM UTC-0500	

- Use the default threshold values, or clear the checkbox to configure your own threshold values.
- Clear the checkboxes for any alert levels you don't want. All sensors provide upper and lower warning and critical levels.

User Management

Device Settings

Maintenance

Model  
LP-42211

Firmware Version  
3.5.0.5-45231

Help  
Online Documentation  
Legrand Support

Last Login  
12/5/2018, 2:51:57 PM UTC-0500

Device Time  
12/5/2018, 3:25:45 PM UTC-0500

Sensor

Edit Thresholds

Use default thresholds

Lower critical	<input checked="" type="checkbox"/>	50	°F
Lower warning	<input checked="" type="checkbox"/>	59	°F
Upper warning	<input checked="" type="checkbox"/>	86	°F
Upper critical	<input checked="" type="checkbox"/>	95	°F
Deassertion hysteresis		1.8	°F
Assertion timeout		0	Samples

Cancel Save



