

XAP-1440 Mounting Guide

Mounting Installation Package Contents

1

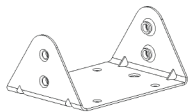

Stainless steel mount #1 (qty 1)

2

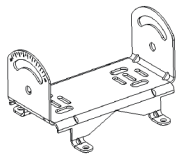

Stainless steel mount #2 (qty 1)

3

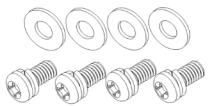

M4 machine screws (qty 4)
W4 flat washers (qty 4)

4



Screw anchors (qty 4)
Stainless steel screws (qty 4)

5

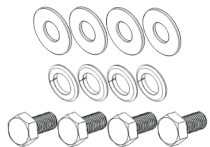

M5 machine screws (qty 4)
W5 flat washers (qty 4)
SW5 washers (qty 4)

6



1-1/2" stainless pipe strap (qty 1)

Install Mount on Bottom Cover

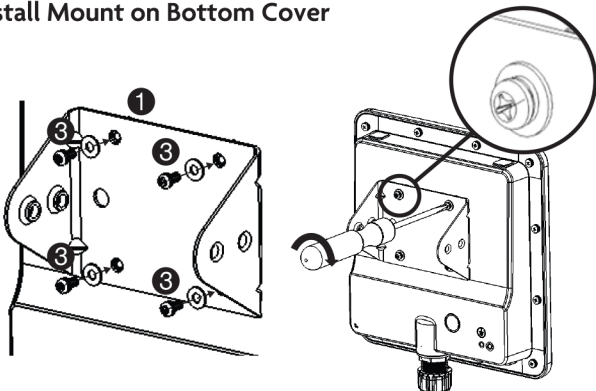

Use the M4 screws & W4 flat washers to attach the mount #1 to the access point.

Use a Phillips screwdriver to tighten all four the M4 screws.

Mounting on a Pole 1-1/2" to 2-1/2" (40~64 mm)

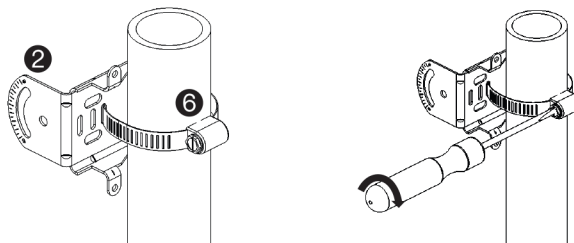

Attach stainless steel mount(2) to the pole using pipe strap/clamp. Installer may need to supply larger clamp if pole is larger than 1-1/2" diameter. Ensure strap/clamp is securely fastened.

Attach AP/Mount Assembly to Pole Mount

Step 1

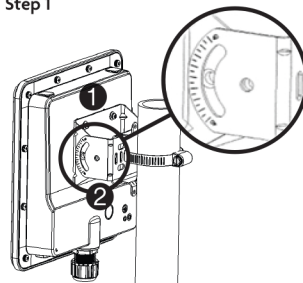

Step 2

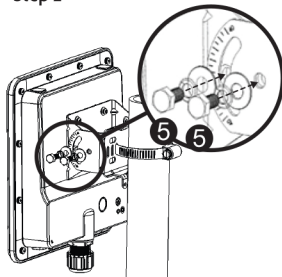

Step 3

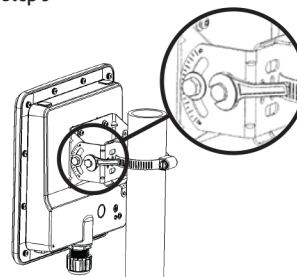

Step 1: Align mount #1 and mount #2 threaded holes.

Step 2: Attach mount halves using M5 screw, W5 flat washer, SW5 lock washer

Step 3: Use a wrench to tighten the four locking M5 screws.

Mounting on a Wall

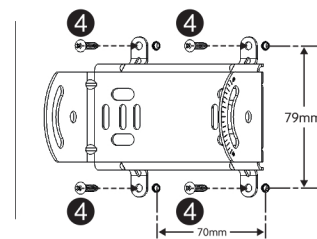

Pre-drill four blind holes in the wall. Hole spacing is 70mm horizontal and 79mm vertical.

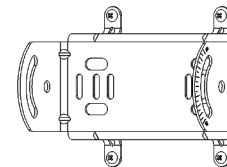

Attach mount #2 to the wall using four screws or screws and anchors.

Attach AP/Mount Assembly to Wall Mount

Step 1

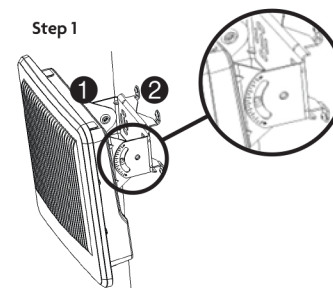

Step 2

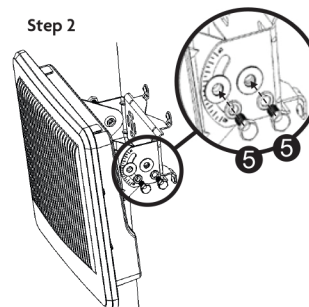

Step 3

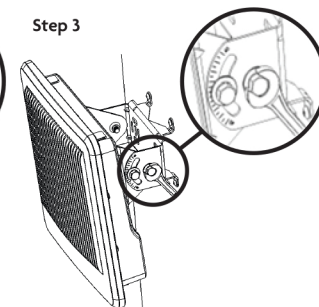

Step 1: Align mount #1 and mount #2 threaded holes.

Step 2: Attach mount halves using M5 screw, W5 flat washer, SW5 lock washer

Step 3: Use a wrench to tighten the four locking M5 screws.