

AMAZING AV EXPERIENCES

eMagazine

MOVING OUR GOVERNMENT & COMMUNITIES
FORWARD WITH TECHNOLOGY

TAA COMPLIANCE PG 10

WHY AV DESIGN MATTERS PG 12

Bringing Communities
Together with Digital
Signage PG 16

Virtual Courtroom Considerations and Solutions PG 26

SECURE CONFERENCING &
CLASSIFIED COLLABORATION
PG 42

MISSION CRITICAL COMMAND & CONTROL PG 44

FALL 2021 EDITION

DEPENDABLE SOLUTIONS

WITH LEGRAND | AV

When the duty is demanding to your community, city, state, or nation, your AV solutions have to perfectly perform.

All areas of government need exceptionally **reliable** AV solutions that keep services **running**, **communities** informed, and justice alive.

We understand the importance of proper design to guarantee dependable AV operation. The foundation for reliable AV performance starts with Legrand | AV.



MOVING OUR GOVERNMENT AND COMMUNITIES FORWARD

Steve Durkee
President of Legrand | AV

Every day, government and military operations are working for citizens. And every day, AV technology supports those efforts in countless ways. Our communications and collaboration tools create connections between people and the information they need to make decisions. Strategies evolve and are deployed over our networks and infrastructure. Together, these systems, agencies and people constantly maintain operations — adapting to change in real-time.

Flexibility is key to any operation today, and the government is no exception. Protocols evolve quickly and new messaging needs to be delivered. That's where digital signage truly shines, and we're seeing an increase in use. Portable or permanently mounted displays can be deployed and rearranged to adapt quickly wherever wayfinding or information are needed. That's perfect for adjusting to any sudden change in the details that need to be shared with public visitors or internally with mass notifications.

Also trending is hybrid communications. More courtrooms are going virtual, and even for in-person legal proceedings, cameras are being added to allow a closer look at participants and evidence. Additional PTZ cameras are being installed into meeting rooms, collaboration spaces and civic venues that are opening up to remote audiences through live streaming. Not only are people ready to improve connections with higher-quality video and sound, they're looking for a more professional presentation with pan-tilt-zoom and automated presenter tracking.

AV technology provides a crucial bridge between citizens and federal, state and local government. We see that clearly, because wherever there is a need to deliver a message or enhance collaboration, there has been an expansion in the methods and means that AV technology solves the problem. Our technologies are essential to keeping the channels of communication open.

We're here to support the people who build those connections, and those who rely on them, as together we continue to discover ways to improve the AV experience.

"Flexibility is key to any operation today, and government is no exception."

Steve Durkee

TABLE OF CONTENTS

6

AMERICAN RESCUE PLAN

How Does AV Benefit	6
---------------------	---

10

TAA COMPLIANCE

Secure AV Solutions that Meet Federal Regulations	10
---	----

12

AV FURNITURE

Why AV Furniture Design Matters	12
Frame To Furniture Basics	14



16

DIGITAL SIGNAGE

Mobile Cart Single Display	16
Floor Stand Dual Display	18
Floor Kiosk Back-To-Back Displays	20
Outdoor Pedestal Single Display	22
dvLED Video Wall	24



26

COURTROOMS

Virtual Courtroom Considerations	26
Virtual Courtroom - Mobile Cart	28
Courtroom / Council Chamber	30

32

MEETING SPACES







Multi-Camera Conferencing	32
Large Conferencing Room	34
Motion-Based Auto-Tracking Small / Medium Conference Room	36
Mobile Hybrid Conferencing Cart + Camera	38
Professional Home Office	40

42

MISSION CRITICAL

Secure Conferencing Room	42
--------------------------	----

Resources you will find in this eMag:

-  Automatic Download
-  Website Resource
-  Guidebooks & PDFs
-  Diagrams
-  Contact Us
-  Website Product Page

 Explore all State & Local Government Solutions

 Explore all Federal Government Solutions



44

COMMAND & CONTROL

Mission Critical Command Center with Video Wall	44
Rack Storage	46

48

POWER & REMOTE MANAGEMENT

Intelligent Power	48
-------------------	----

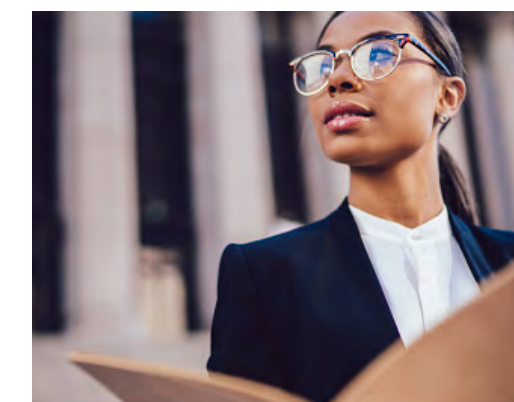

THE AMERICAN RESCUE PLAN ACT

HOW CAN AV BENEFIT?

TIPS & TECHNIQUES

“Many state and local AV projects that were cancelled in 2020 due to Covid-19 may be starting again. Reimbursements might be available through ARPA if budgets were reallocated due to the pandemic. We’ll see an uptick in AV installations for city council chambers, conference rooms and other AV applications.”

- Brian Retzlaf
Legrand | AV Solutions
Engineering Manager

The American Rescue Plan Act (**ARPA**) was signed into law on March 11, 2021. It includes \$350 billion for eligible state, local, territorial and Tribal governments to respond to COVID-19 and bring back jobs. The aid will be distributed in two tranches – 50% started going out in May 2021. The other 50% will start going out in May 2022.

That’s an impressive amount of funding heading to your local governments. Integrators who helped schools get up to speed with distance learning with CARES Act funding may be wondering if they can similarly leverage this new source of funding to help state and local governments. The answer? Not as directly. BUT DON’T GIVE UP!

We spoke with our resident **Solutions Team** expert, Brian Retzlaff, for some creative ways to start opening discussions with state and local government officials who spent the last 18 months dramatically tightening budgets to get through the pandemic. Luckily, that very budget cutting is how Retzlaff gets his foot in the door for new opportunities.



Brian Retzlaff
Legrand | AV
Solutions Engineering Manager

\$350 BILLION

FOR ELIGIBLE STATE,
LOCAL, TERRITORIAL
AND TRIBAL
GOVERNMENTS TO:



SUPPORT
public health
expenditures



ADDRESS
negative economic
impacts



REPLACE
lost public sector
revenue



PROVIDE
premium pay for
essential workers



INVEST
in water, sewer,
and broadband
infrastructure



Download the
infographic
here

REVIVE CANCELLED PROJECTS

Lots of local governments had to cancel AV projects as it became apparent that we were looking at a drawn-out period of belt-tightening. It makes total sense to cut what you can to keep from having to lay off workers and decrease service quality.

“What’s interesting is in my opinion, we’re seeing a resurgence of projects that had been delayed,” Retzlaff said. “Projects are coming back again that disappeared.”

According to the Treasury Department, one objective of the funding is to “Replace lost revenue for eligible state, local, territorial and Tribal governments to strengthen support for vital public services and help retain jobs.”

While not directly useable for AV purposes, that replaced revenue will ideally allow previously reallocated budgets to be back on the table. As these budgets open up, Brian says now’s the time to go back and see if those cancelled projects can be brought back to life. Perhaps you can even update the design to account for new health protocols. Dig up those abandoned government project bids from late 2019/early 2020 and see what you might be able to revive.

UNPRECEDENTED INFRASTRUCTURE INVESTMENTS

The Coronavirus State and Local Fiscal Recovery Funds can be used to make “necessary investments to improve access to clean drinking water, support vital wastewater and stormwater infrastructure, and to expand access to broadband internet.”

AV may not have a strong place in the broadband internet, but the water and wastewater investments should get integrators thinking about control rooms. Most municipalities will be looking to upgrade their water control systems, especially as we see droughts continue through large swaths of the country. For residents, consideration of water systems will quickly go from “I just turn on the tap and it’s there” to “what is my local government doing to solve the water crisis?” Get ahead of the issue with some **ready-to-go systems** that solve problems before they hit critical.

Command and control console systems are not just for big operations like NASA anymore, and they don’t have to be complex. A simple **monitoring and command desk** with a few displays on the wall should help any municipality keep their water and sewer infrastructure running smoothly.

Retzlaff recommends **Connexsys** mounts or **Fusion wall mounts** with the **connecting adapter** to position the displays precisely.

DIGITAL SIGNAGE FOR PUBLIC HEALTH

ARPA funds can be used to “support public health expenditures, by, for example, funding COVID-19 mitigation efforts, medical expenses, behavioral healthcare, and certain public health and safety staff,” according to the **Treasury Department**.

Mitigation and prevention efforts include a wide range of services needed to combat COVID-19. Public communication efforts, capital investment in public facilities to meet pandemic operational needs, and improvements in technology infrastructure are noted as acceptable expenses in the Secretary of the Treasury’s **interim final rule**.

The case could be made for digital signage improvements to help meet pandemic operational needs and public communication efforts.



“Even though the stimulus doesn’t directly support it, the need for digital signage in the support of public health is very high. We need to create wayfinding and other ways to direct traffic to get people where they need to be while maintaining safe distances,” Retzlaff said.

Legrand | AV recently published a handy **guide to digital signage solutions in government**, complete with eight diagrams to get you started.

BEYOND THE AMERICAN RESCUE PLAN ACT

While not related to ARPA directly, it’s important to note that with new houses popping up everywhere and with housing prices on the rise, additional revenue in property taxes will start making new government projects more feasible in a couple years.

“Now is a good time to meet with your government contacts to plan for future projects that can take advantage of increased revenues,” Retzlaff said. “So, start pitching AV infrastructure projects such as improvements to boardrooms, conference rooms, digital signage, council chambers and a host of smaller projects that weren’t previously financially feasible.”

See article online



DON'T FORGET - WE CAN HELP

Our Solutions Team is available to help you create AV designs for state, local and public institutions. This is especially useful for helping larger dealers avoid conflicts of interest when bidding for certain government entities that don’t allow a design and bid from the same vendor. We provide solutions engineering services for free. Yes. Free. **Learn more.**

Contact Legrand | AV’s Solutions Team by reaching out to your **territory sales manager**, or fill out this **simple form**.

Another infrastructure bill is coming soon. Be sure to check back for more tips on how the AV industry fits in.

HELPFUL LINKS:

See what projects qualify and how much your local government is receiving from ARPA.

- **More on Coronavirus State and Local Fiscal Recovery Funds**
- **Local Allocations in the American Rescue Plan Act**
- **ARPA frequently asked questions for Local Relief**

SCHEDULE A
CHAT WITH
THE TEAM

SEE A DESIGN
SAMPLE



TAA COMPLIANCE

SECURE AV SOLUTIONS THAT MEET FEDERAL REGULATIONS

TAA refers to the Trade Agreements Act (19 U.S.C. & 2501-2581), which is intended to promote fair and open international trade. TAA requires that the U.S. Government may purchase only products made in the United States or a “designated country.” Legrand | AV’s TAA compliant products are approved to be used in United States government projects and facilities.

COUNT ON LEGRAND | AV

Legrand | AV is the most comprehensive AV partner for common applications in the federal government such as mission critical command and control centers, secure conference rooms and digital signage communication. We deliver on what matters most to federal government agencies including:

- Extreme reliability
- Range of products
- One-stop shopping
- Stocking and availability
- Strong warranties
- Security
- Equipment monitoring and protection

US Facility Locations	Capabilities	Certifications
Eden Prairie, MN	Design	ISO 9001:2015, LEED-CI Silver
Shakopee, MN	Assembly, Shipping	ISO 9001:2015, UL Client Test Data Program
Minnetonka, MN	Design, R&D, Manufacturing, Shipping	–
Fairfield, NJ	Design, Manufacturing, Shipping	ISO 9001:2015, ISO 14001:2015
Warsaw, IN	Design, Manufacturing, Shipping	ISO 9001:2015, ISO 14001:2015
Blue Ash, OH	R&D, Manufacturing, Shipping	ISO 9001:2015, ISO 14001:2015
Dayton, OH	Shipping	–



See TAA PDF

The brands of Legrand | AV have proudly been designing, manufacturing and assembling products in the United States for decades.

EACH OF THESE PRODUCT LINES FROM LEGRAND | AV OFFER TAA COMPLIANT SKUS.

- Docking Stations
- Cat5e/Cat6/Cat6a Category Cables
- Conference Room Video Hub
- Wireless AV for HDMI®
- HDMI Switches
- Power Cords

- Flat Panel Mounts
- Projector Mounts
- Carts and Stands
- Workstation Mounts
- In-Wall Component Storage

- Electric Projection Screens
- Fixed Frame Projection Screens
- Manual Projection Screens
- Portable Projection Screens
- Interactive Projection Screens

- Managed Network Switches
- SFP Modules

- Credenzas
- Lecterns
- Conferencing Tables
- LundHalsey AV Furniture and Consoles
- Equipment Racks
- Cable Management

- Professional PTZ Cameras
- Videoconferencing Cameras
- Microphones, Speakers and Audio Equipment
- Video Switchers and AV Bridges
- Camera Mounts
- Professional Camera Extension Systems

For more information on TAA compliant products from Legrand | AV, please contact:



Brandon Ivey
National Solutions Manager,
Fed Govt/DoD
M: 757.651.1213 O: 973.839.1011
brandon.ivey@legrand.com



AV FURNITURE

4. HEAT AND HUMIDITY CONTROL

AV equipment is critical but incredibly sensitive. It has specific power and temperature requirements. Signals must maintain integrity between points.

Furniture designed for AV applications includes passive or active ventilation that keeps equipment safe from overheating. In fact, for every 10°F (6°C) degrees the temperature rises over 85°F (29°C) in a rack, the equipment life is reduced by 40%. With environmental monitoring in your remote power management system, alerts can be triggered when the temperature gets too high or can automatically trigger a fan to operate.

Humidity is also challenging to AV equipment. When humidity is generally 65% or higher, dust mixes with the moisture and lands on sensitive circuit boards. AV furniture can be loaded with filter kits and sensors to detect humidity levels.

5. MONITORING POWER TO KEEP EVERYTHING UP AND RUNNING

Surges, over voltage, under voltage, spikes and a host of other power problems can wreak devastation on AV equipment. One of the surprising primary causes of power supply failure is under voltage, and few power products properly protect against this anomaly. AV furniture can be equipped with surge protection, UPS systems and other power solutions for safeguarding and keeping vital equipment running through power events.

6. STORAGE, ORGANIZATION AND NEAT CABLE MANAGEMENT

One of the biggest advantages of furniture designed for AV is the solid rackmount capability that accepts components of varying depth, and neatly stacks and spaces them for ease of use and servicing. AV racks can use traditional accessories like shelves for smaller equipment storage and brush grommet panels for cable pass through while deterring dust. Cable management allows integrators to run cabling from one bay to the next, properly tie off and route cables internally, and get power to the rack and the unit surface—all these enhance the performance of the system.

[Download the Government AV Furniture Brochure](#)

to discover room-specific solutions from Legrand | AV you should consider in your next install.

1. ERGONOMICS FOR OPTIMIZED PERFORMANCE

Ergonomics are critical for maintaining the health, safety and performance of your teams—especially operators in a mission critical setting. Good ergonomics keep your teams alert and on top of their game.

2. PORTABILITY FOR RAPID DEPLOYMENT

Crises can happen anywhere, and a quick response on the ground needs AV solutions that can be easily deployed. Get your teams to the source with solutions that minimize setup and can easily be reconfigured to evolving needs of the team and situation.

3. SECURITY FOR SENSITIVE INTEL

Intel and information must be quickly and easily accessible to those with clearance and completely secure from those without it. Beyond safeguarding equipment with mechanical or electronic locks, we provide discrete storage locations and equipment segregation. This lets you physically separate equipment based on classification and eliminates the possibility of spillage from one system to another.

6 REASONS WHY AV FURNITURE DESIGN MATTERS

There's a lot on the line when it comes to secure communication between government agencies. You rely on furniture to safeguard sensitive equipment while providing the necessary features for uninterrupted uptime.

AV solutions must be dependable every day – even more so during critical situations affecting public health and safety.

Most furniture is designed purely for aesthetics, but AV furniture is engineered to support the distinct needs of AV equipment and provide the right ecosystem to keep it safe. Legrand | AV understands the importance of thoughtful furniture design to guarantee unflinching AV performance.

TIPS & TECHNIQUES

“ Custom furniture is a big part of a lot of government projects. Middle Atlantic has extensive experience designing and building pieces to fit specific purposes and protocols. The cool thing about our team is that with all that engineering knowledge, they rarely say no to a request. ”



- Brandon Ivey
Legrand | AV
National Solutions Manager
- Fed Govt / DoD

See article online

FRAME TO FURNITURE...
WHAT IS IT?

AV equipment used to live in a big rack room, away from the area where business was conducted. It didn't matter what the equipment was stored in or how it looked because you could just shut the door. Today, there are different options. We are looking to put AV equipment at the point of use.

Fully self-sufficient AV technology is being implemented into furniture to give the customer access exactly where they need it. All in all, furniture is infrastructure that is visible and needs to look "pretty" in a room.

When a customer is looking to deploy a new training center space where various AV technologies need to be housed, that's where technical furniture comes in! A lot of times, the equipment can live in a credenza, a lectern, or table. This furniture will house all the equipment necessary to record a training session or collaborate through technology.



FURNITURE SOLUTIONS
AT A GLANCE



CREDENZAS
The credenza series from Middle Atlantic is the perfect all-in-one AV storage solution. Middle Atlantic credenzas are available in a range of sizes and styles, built around the rack you trust.



LECTERNS
Middle Atlantic's lectern offering delivers a symmetry of technology support and design that meets the needs of any space. A full suite of lecterns is now available to fit any budget, system size, height requirement and aesthetic.
Choose from preconfigured models for a simplified ordering experience or configure a custom lectern for specific applications.



TABLES
Middle Atlantic T5 Series Conference Tables are the industry's only conference table designed to properly support AV technology for ultimate system reliability, 24/7/365.



CONSOLES
Middle Atlantic's monitoring and control console systems are unique because we've built in our racks and mounting expertise to support installation reliability.
Each system is designed and crafted to maintain Middle Atlantic's high quality standards and end user ergonomics.



MOBILE AV CARTS
Sometimes you just need more displays to fully cover the situation. Carts allow you to move displays between rooms when livestreaming or videoconferencing is needed in other spaces.

THE MIDDLE
ATLANTIC
FRAME TO
FURNITURE
PROCESS



STEP 1
The customer orders the size needed for their gear.



STEP 2
The frame is sent to the integrator for integration of AV gear, cable management, etc.



STEP 3
The wood kit is sent to the final site location to avoid any damage during equipment installation.



STEP 4
The customer can easily service the equipment, replace panels, and change the design later.

DIGITAL SIGNAGE

FLEXIBLE COMMUNICATION

MOBILE CART SINGLE DISPLAY

Serving as digital guideposts, mobile AV carts can support rapid changes in wayfinding and information on the fly. These easy-to-move digital signage setups roll right into place and deliver location-specific messaging in real-time.

Investment in a fleet of roving display stands will continue to pay dividends with every change in facility layout or traffic flow. Any time a multi-purpose area adds another function, these signs can help explain what's happening.

Make it easier to control and manage messaging anywhere these portable signs are planted. Add intelligent power accessories to enable remote management.

Available in a range of sizes and configurations to support larger displays and additional equipment, mobile AV carts are ready for service anywhere they're needed.

TIPS & TECHNIQUES

“Adaptable technology is more important than ever. Legrand | AV digital signage stands can also be configured as carts, and vice versa. So if you need to make the switch to a more mobile or permanent setup, it's easy to make the change.”



- Michelle Montazeri,
Legrand | AV National
Solutions Manager
Digital Signage

SEE ALL
DIGITAL SIGNAGE
SOLUTIONS FOR
GOVERNMENT
GUIDEBOOK



WHY WE LOVE IT

- Convenient way to meet health protocol guidelines in any location
- Accessories allow for ease in locating and servicing the equipment
- Place messages where they're sure to be seen

KICK IT UP A NOTCH

ADD INTELLIGENT POWER

WHY: Provides remote management for ultimate power control.

BIGGER IS BETTER

WHY: Upgrade to a larger AV Cart to handle bigger displays or more accessory shelves.

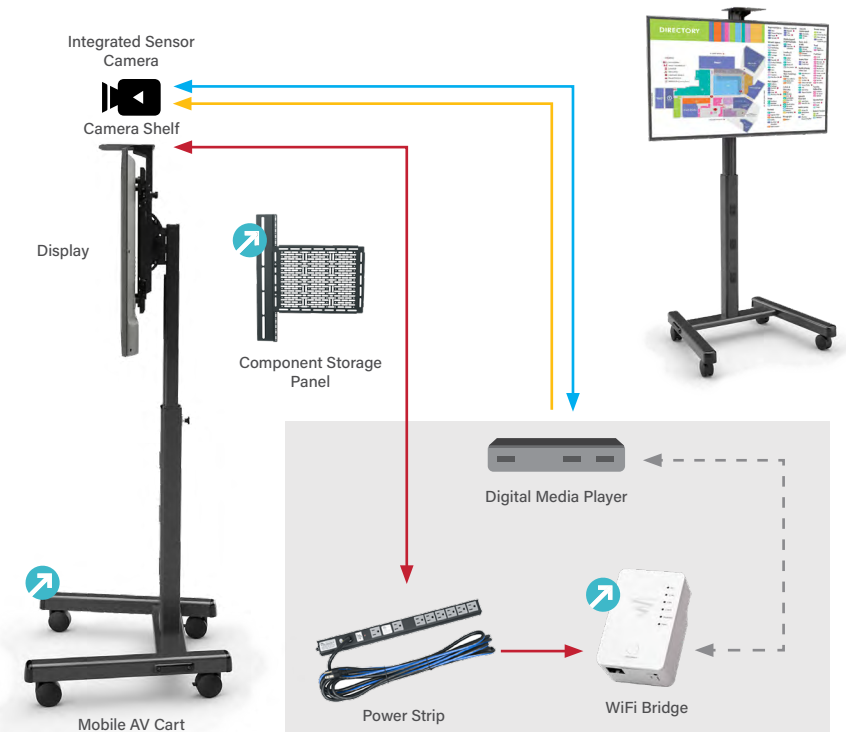

PART NUMBERS

- Chief Medium Flat Panel Mobile AV Cart **MFCUB**
- Chief Video Conferencing Camera Shelf **PAC715**
- Chief Component Storage Panel, Interface **CSMP9X12**
- Middle Atlantic Forward Small Device Mounting Clamps (Qty 2) **FWD-SIDELMP-4**
- Middle Atlantic Slim Power Strip **PD-815SC-20**
- C2G 3' CAT6 Snagless Cable **27131**
- C2G 6' High Speed HDMI Cable **29677**
- Luxul AC1200 WiFi Bridge + Range Extender **P40**

Get the Full
List of Parts
& Pricing

C2G has a new line of Performance Series HDMI cables, designed for AV installations, that can be used in any of these solutions. Check them out here!



DOUBLE DUTY MESSAGING

FLOOR-STAND DUAL DISPLAY

Things change every day – with back-to-back updates happening non-stop. That’s where the dual-display stand shines. It’s ready to provide information on both sides of an entry and exit, display specific instructions for different purposes on two sides of a room, or simply deliver information across a wide area.

This sleek stand is robust enough to remain a permanent fixture, but it’s also easy to move. A built-in component storage panel between the displays offers a secure mounting solution for digital media players, Wi-Fi and power equipment.

Add a camera shelf to support additional hardware for conferencing, livestreaming or sensors. Then connect easily across distance, with networked devices that allow for computers and other devices to be installed hundreds of feet from displays. Take advantage of intelligent power components to conveniently manage and control the system remotely.

TIPS & TECHNIQUES

“Whether you need to share important information with guests or employees, floor-stands are a cost-effective, simple solution to add communication options where you need them. Ensure everyone is informed no matter where they are with live updates on digital signage displays.”



- Michelle Montazeri,
Legrand | AV National
Solutions Manager
Digital Signage

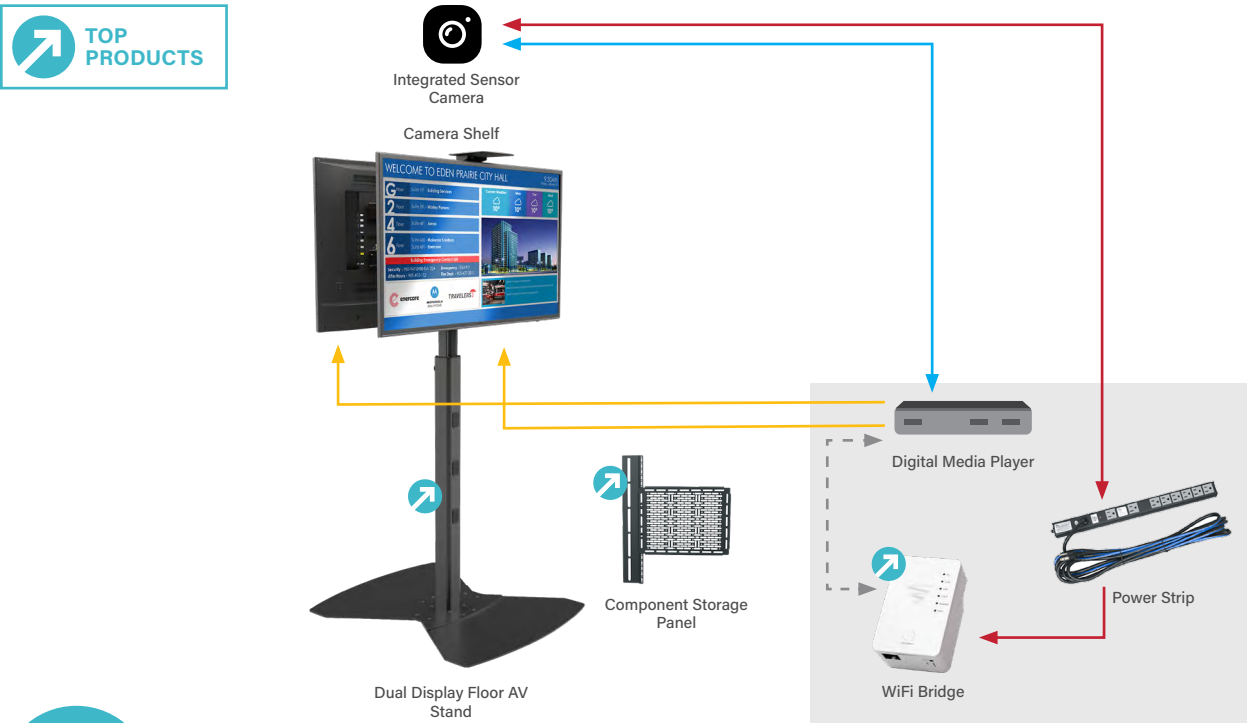

WHY WE LOVE IT

- Ideal for communicating court proceedings or announcing who's next in line for traffic court
- Back-to-back design allows for different information on each side of the stand
- Securely manage equipment on a storage panel between the displays
- Bring this portable solution just about anywhere

KICK IT UP A NOTCH

ADD INTELLIGENT POWER

WHY: Provides remote management for ultimate power control.

CHANGE CONTENT QUICKLY

WHY: IP Encoders/Decoders allow for content updates on-the-fly.

ADD REMOTE DEVICES

WHY: Updated HDBaseT systems allow computers and other devices to be hundreds of feet from the displays.

PART NUMBERS

- Chief Medium Flat Panel Dual Display Floor AV Stand **MF2UB**
- Chief Video Conferencing Camera Shelf **PAC715**
- Chief Component Storage Panel, Interface **CSMP9X12**
- Middle Atlantic Forward Small Device Mounting Clamps (Qty 2) **FWD-SIDECLMP-4**
- Middle Atlantic Slim Power Strip **PD-815SC-20**
- C2G 3' CAT6 Snagless Cable **27131**
- C2G 6' High Speed HDMI Cable (Qty 2) **29677**
- Luxul AC1200 WiFi Bridge + Range Extender **P40**





SAFE, SECURE & INTERACTIVE

FLOOR KIOSK BACK-TO-BACK DISPLAYS

Deliver dynamic content and be assured of safe interactivity with lockable kiosks that store and protect equipment. Designed to look great on a wall or in free-standing configurations, Impact Series Kiosks support single or dual displays. Plus they have plenty of room inside for all the essentials, like media players, power and network gear.

These kiosks are ideal for interaction in high-traffic areas. They're tamper-proof, yet designed for convenient service access. There are no exposed hinges or fasteners on the outside, but the inside is built for easy maintenance — the display stays mounted to the frame when the kiosk is opened. When it's locked back up again, the heavy-duty construction protects hardware, with integrated passive cooling or an optional fan kit.

TIPS & TECHNIQUES

“When paired with a TAA-compliant display, we can support a fully compliant digital signage solution with equipment tested and designed to work together.”



- Michelle Montazeri,
Legrand | AV National
Solutions Manager
Digital Signage



WHY WE LOVE IT

- Ideal for wayfinding signage in government centers or courthouses
- Modern design provides easy access to equipment in any environment
- Rack space of 2 RU allows for advanced power and network functions
- Intelligent power provides the ability to set and schedule content

KICK IT UP A NOTCH

CHANGE CONTENT QUICKLY

WHY: IP Encoders/Decoders allow for content updates on-the-fly.

ADD REMOTE DEVICES

WHY: Updated HDBaseT systems allow computers and other devices to be hundreds of feet from the displays.

PART NUMBERS

- Chief Impact Floor Mounted Back-to-Back Kiosk*
LF55UBP-B2B
- Chief Impact Freestanding Double Sided Base Accessory
PACLFB-B2B
- Middle Atlantic DC Fan Kit
DCFANKIT-4
- Middle Atlantic Select Series PDU with RackLink
RLNK-415R
- Middle Atlantic Select Series UPS Backup Power
UPS-S500R
- C2G 10' High Speed HDMI Cable (Qty2)
29678
- Luxul AC1200 WiFi Bridge + Range Extender
P40
- Luxul 12 Port/ 8 PoE+ Front-Facing Rackmount Switch
XMS-1208P



SEE ANOTHER KIOSK
SOLUTION, THE
ON-WALL KIOSK



SET WELCOMING EXPECTATIONS

OUTDOOR PEDESTAL SINGLE DISPLAY

Outdoor messaging is a great way to welcome and inform both, the public and employees, and even communicate messages in emergency situations. Set expectations with highly visible information outside entrances or across large areas. Once they're indoors, more information can be provided at check-in points with tablet stands and other strategically-placed displays.

This outdoor single-display pedestal is designed to withstand the elements. The pedestal equipment is protected from harsh conditions, and the mount itself is also shielded from damage by outdoor-rated paint that will retain a polished appearance for years to come.

Connect the outdoor pedestal display with a high-power wireless access point and HDBaseT-networked receivers and transmitters to deliver content from a digital signage player. Add an accessory charging station to keep visitors charged up while they stay informed. This total solution provides visitors with the information and security they need for a superior experience.

TIPS & TECHNIQUES

“Why limit your digital impact to internal spaces? Outdoor digital signage can ensure guests are aware of protocols in your space, updates to processes, and help set expectations. In doing so, you can put their mind at ease before they even walk through the door.”



- Michelle Montazeri,
Legrand | AV National
Solutions Manager
Digital Signage



WHY WE LOVE IT

- Robust design protects equipment from the elements
- Nearby charging station encourages longer dwell times at the display
- Outdoor-rated paint means premium appearance is retained for years

KICK IT UP A NOTCH

PERFECT VIEWING ANGLE
WHY: Articulating wall mount allows for many screens positions.

CHANGE CONTENT QUICKLY
WHY: IP Encoders/Decoders allow for content updates on-the-fly.



PART NUMBERS

- Chief Outdoor Flat Panel Single Ceiling/Pedestal Mount **OLCM1U**
- Chief 5-6' Outdoor Ceiling and Pedestal Column **ODAC0506B**
- Chief Outdoor Concrete Ceiling and Pedestal Plate **ODA330B**
- Chief Outdoor Plate Cover **ODAPCVRB**
- Middle Atlantic Charging Station with Accent Light, 2-Gang **XCSAL2GRU-BZ**
- C2G HDMI HDBaseT + USB over Cat Extender **29510**
- C2G 3' High Speed HDMI Cable (Qty 2) **50181**
- C2G 100' Cat6 Snagless Cable **10322**
- Luxul High Power AC1200 Dual-Band Outdoor Bridging Access Point **XWO-BAP1**

[Get the Full List of Parts & Pricing](#)

FOR SAFE SPACE ENTRY, SEE OUR TABLET STAND SOLUTION



EXPANDED VIEWPOINT

dvLED VIDEO WALL

Video walls are the backbone of a mission critical environment. LED video walls provide pristine viewing quality for data and graphics – critical in helping visualize information needed to make serious decisions.

In 24/7 mission critical control rooms, visual acuity and carefully calibrated line-of-sight are essential for optimal data sharing. A properly designed and scaled video wall can help prevent eyestrain and address other ergonomic concerns.

The TiLED™ Series is a modular system designed to support creative video wall configurations. Chief's mounting solutions connect together to scale endless video wall arrangements. Standard, off-the-shelf solution set means the product is stockable and ready to ship – no custom lead times.

With Chief's TAA-certified TiLED modular systems, video wall designs of all types are fully supported by a team of specialists who can help to configure and install a complete solution. Contact the TiLED Solutions Services team for insight and expertise on how to realize a full-scale dvLED application.

Completely customizable and heavily reliant on precision hardware, video walls also require advanced equipment for power, cooling and storage. Count on Legrand | AV for expert advice and recommendations for your next video wall project.

TIPS & TECHNIQUES

“ The implementation of dvLED can initially feel overwhelming. With our TAA-certified TiLED product, our solutions engineers offer help with design, installation, alignment and project management to realize a complete design that exceeds your expectations. ”



- Michelle Montazeri,
Legrand | AV National
Solutions Manager
Digital Signage

TOP PRODUCTS

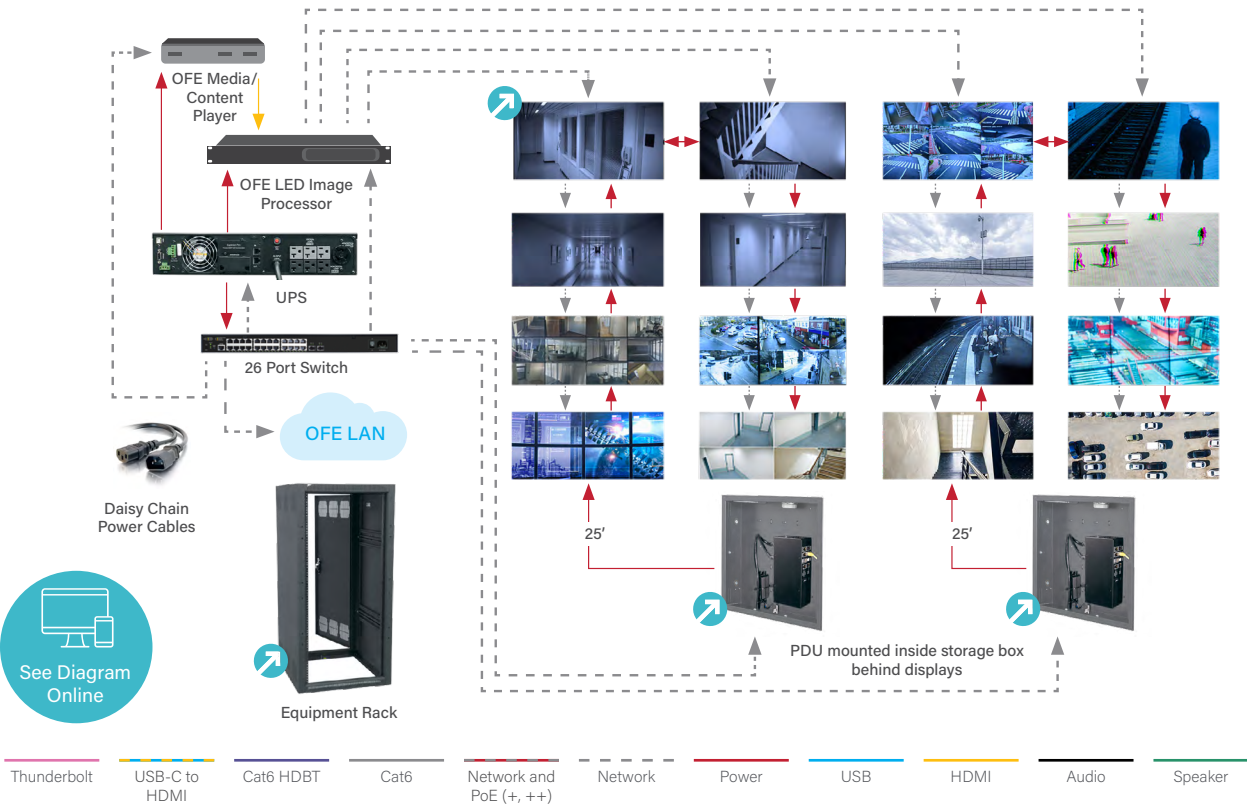

WHY WE LOVE IT

- Ideal for control rooms in transportation facilities, high security prisons, police, fire service and emergency medical service
- Modular system supports creative video wall design
- Easy to specify, easy to buy
- Installer-inspired solutions reduce installation time

KICK IT UP A NOTCH

ADD THE “WOW” FACTOR

WHY: Chief's TiLED modular designs capture maximum attention.

FINISH THE LOOK

WHY: Side covers add that polished finish to the job.

Need Help with Video Wall
Installs? Contact our TiLED
Solutions Services Here

PART NUMBERS

- Chief TiLED 1x4 LED Mount (Model will vary, Qty 4)
TIL1X4UU
- Chief Proximity In-Wall Storage Box with Flange
PAC526F
- Middle Atlantic Intelligent PDU (Qty 2)
RLNK-P420
- Middle Atlantic Equipment Rack and Front Door
BGR-19SA-27, BPFD-19A (not shown)
- Middle Atlantic Premium Online UPS with IP Card
UPS-OL2200R, UPS-OLIPCARD
- Middle Atlantic Forward Rack Accessories (not shown)
Forward Series
- Luxul 26 Port Stackable Switch
AMS-4424P
- C2G 3' HDMI Cable (Qty 2)
50181
- C2G 50' CAT6 Plenum Cable (Qty 6)
15274
- C2G 3' CAT6 Non-Plenum Cable (Qty 17)
27131
- C2G 25' IEC Power Cable (Qty 2)
14719
- C2G 3' IEC Daisy Chain C14 to C13 Power Cord (Qty 14)
10359

Get the Full
List of Parts
& Pricing

COURTROOMS

VIRTUAL COURTROOM CONSIDERATIONS AND SOLUTIONS

 See article online

Courts have been forced to severely prioritize their time since the pandemic onset, causing an impact on the community at all levels. Lawmakers are seeking ways to get back to business as usual through the integration of AV technology to connect legal professionals and conduct virtual hearings.

Explore these basic considerations for establishing a virtual courtroom AV setup:

CONSIDER WHO WILL BE USING THE EQUIPMENT

The ultimate goal of going virtual is to mimic the experience of a physical courtroom as closely as possible. To do so, it's logical to start with who is participating. Consider participation at a few different levels: Who is on camera? Who is speaking? Who is setting up the equipment?

"There is a dramatically different set of needs with a virtual courtroom where the only participants are employees of the court system versus when there will be potential litigants or other support staff involved in the virtual courtroom," said Legrand | AV Solutions Engineering Manager Brian Retzlaff.

Also consider how many people need to be in the room at one time. How many people will be using the equipment? Will it be by employees only, or will legal professionals also be using the courtroom equipment?

Mapping out the basics of how many people and the functionality requirements for each person is critical to selecting microphones, video cameras, displays, speakers and furniture.

AN IMMEDIATE FIX VS. A PERMANENT SOLUTION

Some of the first virtual court solutions relied on a laptop and web conferencing. Since then, many have discovered the technical limitations of such a setup, all while coming to the harsh realization that how we gathered before will be forever changed. It's time to consider hybrid solutions, with courtrooms that are prepped with the technology to provide an amazing in-person or virtual experience.

The effects of the pandemic continue to change courtrooms, and Legrand | AV is here to help you through the process. If you have additional questions, Retzlaff advises communicating with another court facility with an existing AV setup, a consultant or a local integrator who can sort through the details. Of course, our experts at Legrand | AV are always ready and willing to help you get started. "Seeking advice from experts and then trusting that advice is a great place to start," Retzlaff said.

Why are Virtual Courtrooms so important? Learn More.

CONSIDER THE PHYSICAL SPACE

The physical space can have a direct impact on the acoustics, and clarity of sound is absolutely essential for courtrooms. Large, open courtrooms repurposed for a virtual solution will require the audio system (sometimes preexisting) to support echo cancellation.

As far as providing quality video, professional PTZ (Pan-Tilt-Zoom) cameras provide an optimal experience for all parties.





VIRTUAL COURTROOM

MOBILE CART SOLUTION

Courts are expanding into more virtual video solutions. It just makes sense to use videoconferencing platforms for two-way livestreaming of proceedings and remote arraignments. New investments can go even further with the use of a mobile cart. Ready to roll in and link up with minimal fuss, the cart can be used over a closed network for remote arraignments, reducing the cost of transporting prisoners.

With a mobile livestreaming cart, all parties involved can clearly hear and see the proceedings, whether they're in the room or in a remote location. Selecting a PTZ camera is the first step toward clearer communication. Then, make sure everyone is heard with standalone microphones. This cost-effective portable solution can also easily be connected with an existing in-room audio system to transmit sound into the virtual courtroom.

TIPS & TECHNIQUES

“ This mobile cart adds full videoconferencing capability to courtrooms, and can also be used in judge's chambers or for consults with attorneys and experts. ”



- Brian Retzlaff
Legrand | AV Solutions
Engineering Manager

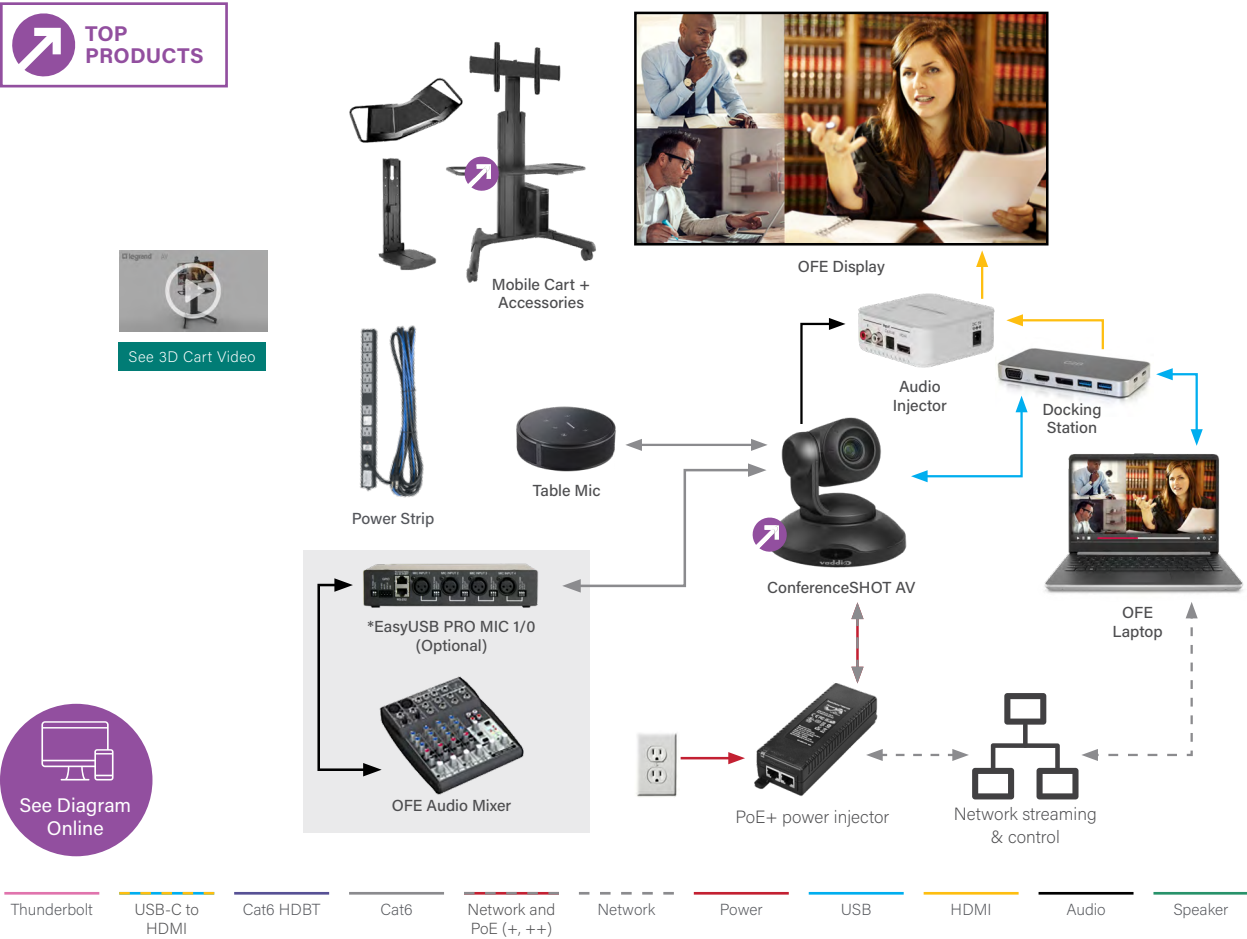
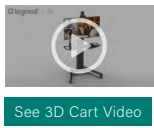

WHY WE LOVE IT

- Connect courtrooms and legal professionals through two-way video and audio for livestreaming
- Use existing audio systems and/or new microphones
- Easy to deploy and duplicate through multiple facilities and share with the staff

KICK IT UP A NOTCH

ALL-IN-ONE CONFERENCING

WHY: Upgrade to an all-in-one conferencing cart system with camera and audio built in.

AUDIO WITH EASE

WHY: Use the existing audio system with your portable conferencing cart.

PART NUMBERS

- Vaddio ConferenceSHOT AV **999-99950-500B**
- Chief Mobile Cart **LPAUB**
- Chief Above/Below Accessory Shelf **FCA800**
- Chief Accessory Shelf **FCA613B**
- Middle Atlantic Power Strip **PD-815SC-20**
- C2G Docking Station **28844**
- C2G 10' High Speed HDMI Cable (qty 2) **56784**
- C2G 10' Cat6 Cable (qty 2) **27153**

OPTIONAL

*Vaddio EasyUSB PRO MIC I/O **999-8520-000**





COURTROOM/ COUNCIL CHAMBER

COURTROOM / COUNCIL CHAMBER SOLUTION

TIPS & TECHNIQUES

“Funding for courtroom infrastructure enhancement is coming with stimulus packages, but there are additional ways that state and local courts can find the budget for technology improvements. In many municipalities, Law Library Funds can be used to add audiovisual equipment.”



- Brian Retzlaff
Legrand | AV Solutions
Engineering Manager

Courtroom technology provides a laser focus on the details, thanks to advanced imaging and audio options that capture all the crucial elements of a case. The increase in virtual court proceedings has pushed AV capabilities further, both remotely and in the room. Multi-camera setups make sure a clearer image goes on the record. An unobtrusive camera mounted on the back wall of a courtroom will capture the main room image. In-ceiling cameras can zoom in on the evidence and display the details to the jury.

Programmable camera presets can be configured to capture images of attorneys, witnesses or pieces of evidence. A long zoom will focus on the most important details. Some tech-savvy judges are also asking for their own joystick controller to select cameras or send video to different displays.

Key to these media-centric courtroom designs is adaptability, with efficient video switching and the ability to absolutely shut down all cameras when no recording is allowed. The RoboFLIP in-ceiling PTZ camera fully rotates into its ceiling enclosure when it's in standby mode, providing full assurance it's off and video feeds are not active.

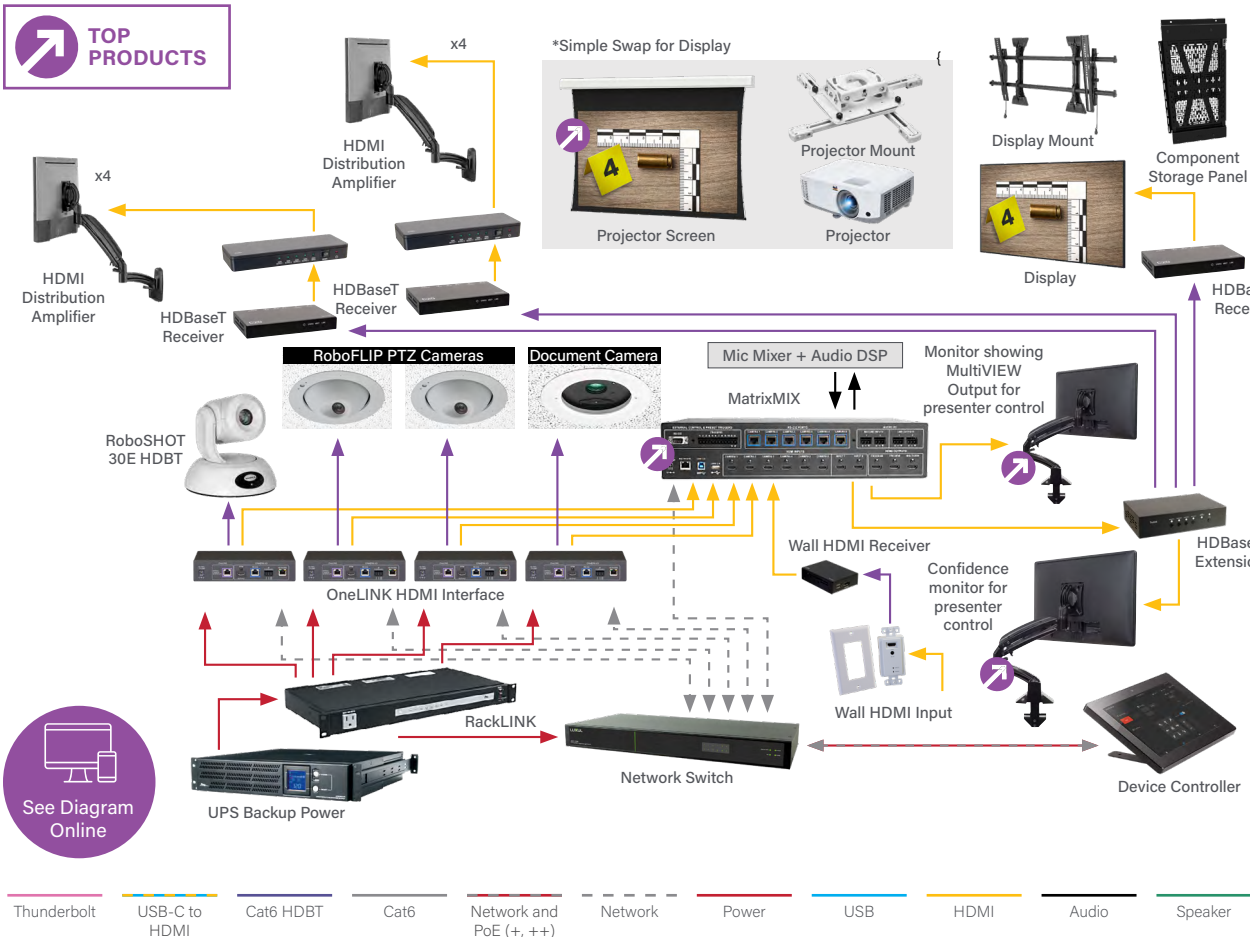

WHY WE LOVE IT

- In-ceiling camera installation provides a clean, aesthetic look
- Cameras provide a super-sharp image and long zoom for shooting the most important details
- Ability to switch video gives full camera control to get the perfect shot
- Multiple cameras gives everyone the best view, whether in-person or remote
- Remote participants can dial in to the courtroom or watch recorded proceedings

Ideal For: Courtrooms, council chambers and board meetings.

KICK IT UP A NOTCH

FULL CONTROL

WHY: Add a **joystick** and **touchscreen** monitor for complete operator control to line up the perfect shot.

MORE COVERAGE

WHY: Make sure you don't miss a single detail, add more cameras to cover all locations in the room.

↓ Get the Full
List of Parts
& Pricing

PART NUMBERS

Vaddio RoboFLIP 30 HDBT OneLINK HDMI System
999-99800-100

Vaddio RoboSHOT 30E HDBT OneLINK HDMI
999-99630-100W

Vaddio DocCAM 20 HDBT Document Camera with
OneLINK HDMI **999-9968-200**

➤ Vaddio AV Bridge MatrixMIX **999-5660-000**

Vaddio Device Controller **999-42300-000**

Chief Display Wall Mount **LTM1U**

Chief Component Storage Panel, Sliding **CSSMP15X10**

➤ Chief Kontour Dynamic Monitor Arm, Desk Mount
K1D120BXRH

Chief Kontour Charging Hub **KPWRB**

Chief Kontour Dynamic Monitor Arm, Wall Mount

K1W120BXRH

*Chief Projector Mount **RPAUW**

➤ *Da-Lite Tensioned Advantage Screen **21767**

Middle Atlantic L5 Series Lectern (**See Parts List**)

Middle Atlantic Premium+ PDU with RackLink **RLNK-P915R**

Middle Atlantic Premium Series UPS Rackmount Power
UPS-2200R

Wiremold Overfloor Raceway Base and Cover

OFRBC-8R

Luxul Managed Switch **AMS-1208P**

C2G Connectivity and Cabling

(**See Parts List**)

MEETINGS

MULTI-CAMERA CONFERENCING

AV OVER IP SYSTEMS

Create a superior collaboration experience by adding more cameras to your conferencing setup. With up to four different PTZ cameras, presenters can be more natural and can easily switch between close-ups of other participants, white boards or demo equipment. All content and even device power can be managed over the network with tools from the **EasyIP ecosystem**.

Set camera presets to switch easily between areas of focus. Ceiling microphones ensure that everyone in the room can be heard. Presenter tools like a step mat and sensor kit can automatically change camera angles without interrupting the flow of a meeting.

Smart infrastructure choices like intelligent power for remote system management, and in-wall storage boxes for hiding away hardware will further simplify and enhance the conferencing experience.

“Recording or live conferencing studios can be built flexibly and cost-effectively with tools from our EasyIP ecosystem. Start with the basics and then add more options to match your communications needs.”



- Bob Hivner
Legrand | AV Regional
Solutions and
Consultants Manager



SEE ALL
FLEXIBLE HYBRID
CONFERENCING
SOLUTIONS
GUIDEBOOK



WHY WE LOVE IT

- All video, power and control runs through a single switch
- IP-enabled system (PoE powered) allows up to four cameras
- Flexible to be used for multiple spaces including divisible meeting rooms
- Hybrid configuration with flexible furniture, flexible camera angles flexible audio
- For two-way video collaboration, training solutions, recording product demonstrations or any other flexible camera and audio solution

KICK IT UP A NOTCH

ADD INTELLIGENT POWER

WHY: Provides remote management for ultimate power control.

CONSIDER IN-WALL STORAGE

WHY: Get stealthy storage for clean, short cable runs and organization.

'NO-TOUCH' CAMERA ANGLE CHANGES

WHY: Presenters focus on the meeting not the tech with solutions like a step mat and sensor kit that automatically change the camera angle.



PART NUMBERS

Vaddio EasyIP 10 Camera (up to qty 4) **999-30200-000W** (White)

➤ Vaddio EasyIP Mixer **999-60320-000**

Vaddio EasyIP CeilingMIC D (up to qty 4) **999-85810-000**

Vaddio Device Controller **999-42300-000**

*Chief Ceiling Projector Mount (qty 2) **SYS474UW**

*Da-Lite Tensioned Contour Screen (qty 2) **29929LS**

Middle Atlantic Lectern L7 Series (**See Parts List**)

➤ Middle Atlantic C5 Credenza (**See Parts List**)

Middle Atlantic Premium Series UPS Backup Power **UPS-1000R-8**

Middle Atlantic UPS Network Interface Card **UPS-IPCARD**

Middle Atlantic Slim Power Strip **PD-815SC-20**

Luxul Network Switch **AMS-2624P**

C2G 50' Cat6 Plenum (qty 8) **15274**

C2G 15' Cat6 (qty 2) **22016**

C2G 23' HDMI Plenum Cable (qty 2) **41378**

C2G 15' HDMI Cable **50612**

C2G 10' USB 3.0 Cable **54175**

C2G Universal 4K HDMI Adapter Ring with Color Coded Adapters **29878**



Get the Full
List of Parts
& Pricing



LARGE CONFERENCE SPACES

FLEXIBLE HYBRID CONFERENCE

In spaces where large groups gather for training, lectures or all-hands meetings, a multi-functional AV system is a must. An automated setup allows everyone in the room to focus on the discussion, not the technology.

Multiple cameras provide coverage throughout the space. Camera presets make it easy to switch between the most frequently used shots. Presenter tracking allows speakers to move freely through the space, and extra accessories like a step mat and sensor kit enable automatic camera-angle changes. For lecture capture, livestreaming or large-scale presentations, graphics mixing adds polish to visual content.

TIPS & TECHNIQUES

“Government agencies usually have a dedicated VTC operator to manage the AV technology. Don't forget to add a VTC operator's desk into your room design. If built into a custom credenza, it can even help with creating the extra distance needed for physical security between networks.”



- Brandon Ivey
Legrand | AV National
Solutions Manager
Fed Govt / DoD

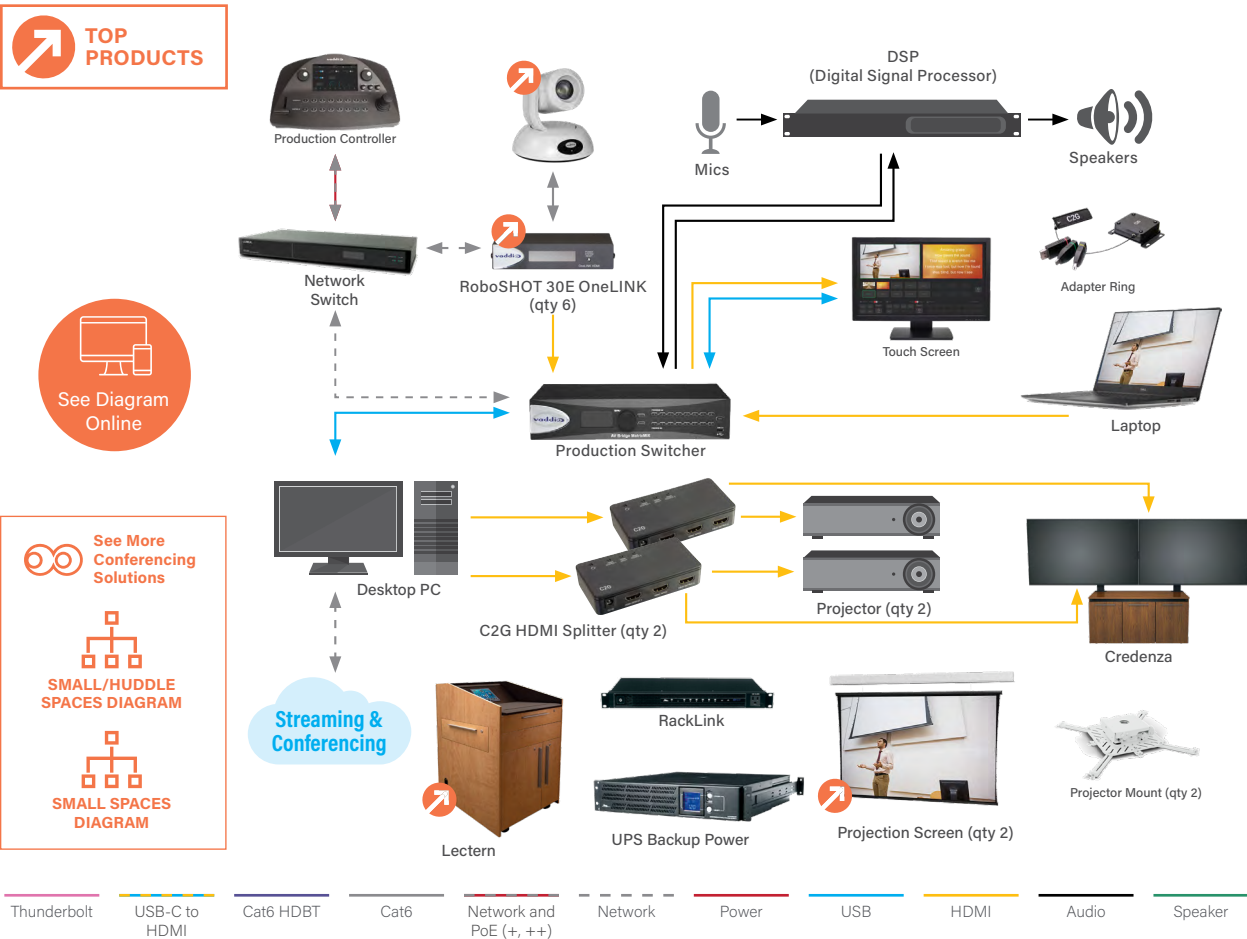

WHY WE LOVE IT

- For all-hands training rooms, auditoriums, boardrooms, lecture capture and livestreaming
- Multi-functional solutions combines switching, advanced camera control and graphics mixing
- Multiple cameras provide ability to set presets in several locations
- Creates automation for audience engagement with video overlays and triggers

KICK IT UP A NOTCH

'NO-TOUCH' CAMERA ANGLE CHANGES

WHY: Presenters focus on the meeting not the tech with solutions like a step mat and sensor kit that automatically change the camera angle.

PRESENTER TRACKING

WHY: Lets you move around the room while the camera follows you automatically.

PART NUMBERS

Vaddio AV Bridge MatrixMIX Production System (Includes PCC MatrixMIX and AV Bridge MatrixMIX) **999-5660-500**

Vaddio RoboSHOT 30E HDBT OneLINK HDMI System (qty 6) **999-99630-100W**

Vaddio TeleTouch 27" USB Touch-Screen **999-80000-027**

Chief Projector Mount (qty 2) **VCTUW**

Chief Vibration Isolating Coupler (qty 2) (Not Shown) **CMA348W**

Da-Lite Tensioned Advantage Screen (qty 2) **14112L**

Middle Atlantic L5 Series Lectern **(See Parts List)**

Middle Atlantic C5 Credenza Dual Display Mount **(See Parts List)**

Middle Atlantic Premium+ PDU with RackLink **RLNK-P915R**

Middle Atlantic Premium Series UPS Backup Power **UPS-1000R-IP**

Luxul Network Switch **AMS-2624P**

C2G HDMI Splitter (qty2) **41057**

C2G 100' Cat 6 Plenum Cable (qty 3) **15276**

C2G 50' Cat6 Plenum Cable (qty 3) **15274**

C2G 15' Cat6 Cable (qty 8) **22016**

C2G 35' HDMI Cable (qty 4) **41414**

C2G 10' HDMI Cable (qty 10) **56784**

C2G 10' USB 3.0 Cable **54175**

C2G Retractable Table Box Mount

4K HDMI Adapter Ring **29880**



Looking for
the right
display size?
Take a quick
course!



Get the Full
List of Parts
& Pricing



MOTION-BASED AUTO-TRACKING

FOR SMALL/MEDIUM CONFERENCE ROOMS

This highly automated setup makes it easier for teams to connect. It offers a significant upgrade for videoconferencing — without a big investment. Add this compact option to small meeting rooms, larger offices, or anywhere that might host hybrid collaboration between a few people in the room and others working remotely.

Designed around the Vaddio IntelliSHOT Motion-Tracking Camera, this solution is economical and aesthetically pleasing. With most of the hardware tucked away inside an in-wall storage box, a built-in microphone, and speakers installed in the ceiling, this system is as seamless as users have come to expect in the everyday web conferencing world.

The IntelliSHOT camera automatically reframes the image as people enter and exit the room, allowing for a perfectly zoomed in experience of all meeting attendees. The conversation between individuals feels more natural, as the camera automatically shifts the viewpoint to follow participant movement. Use wired network devices to make sure the connection is clear and secure, and add an AV Bridge to link a second camera and Dante® microphones for larger rooms.

TIPS & TECHNIQUES

“This is a very cost-effective conference room setup. You can essentially have a high-quality solution for the price of a webcam setup.”



- Brian Retzlaff
Legrand | AV Solutions
Engineering Manager

TOP
PRODUCTS

See Diagram
Online

See More
Conferencing
Solutions

FULL VIDEO
COVERAGE DIAGRAM

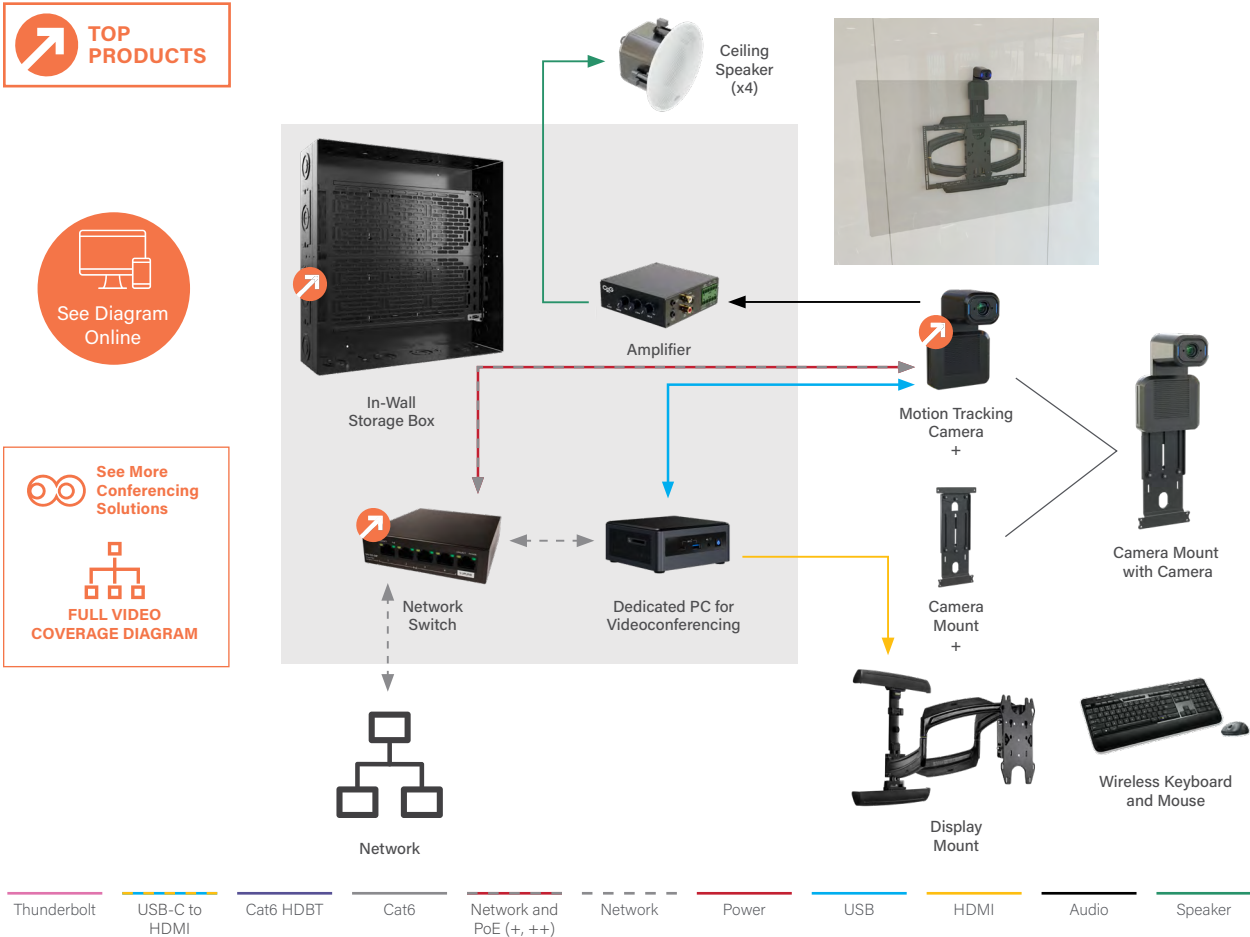

WHY WE LOVE IT

- Clean install with all the parts and pieces stored behind the articulating display for serviceability
- Professional camera automatically re-frames the shot as people enter and exit the conference room
- Recreates the one-to-one video experience for hybrid workplaces
- In ceiling speakers and built-in microphones ensure clear audio
- Wired network devices provide robust connectivity to ensure your video calls are reliable

KICK IT UP A NOTCH

ENHANCE THE ROOM SYSTEM

WHY: Add an **AV Bridge 2x1** to allow for a second camera and Dante microphones for larger spaces.

UPGRADE DISPLAYS TO SCREENS

WHY: For better viewing quality, add a **projection screen** and **projector mount**.

PART NUMBERS

- Vaddio IntelliSHOT Motion Tracking Camer **999-21100-000**
- Vaddio Ceiling Speaker (qty 2 pairs) **999-85600-000**
- Chief Swing Arm Display Mount **TS525TU**
- Chief Above/Below IntelliSHOT Mount **TA210E**
- Chief In-Wall Storage Box **PAC526F**
- Chief Plate for In-Wall Storage Box **PACL2**
- Middle Atlantic Forward Device Mounting Clips (qty 2) **FWD-SIDECLMP-4**
- Luxul Network Switch **SW-100-04P**
- C2G Amplifier **40880**
- C2G Speaker Wire **29206**
- C2G 5' HDMI Cable **29676**
- C2G 1' Cat6 Cable **27130**
- C2G 6' Cat6 Cable **03967**

Get the Full
List of Parts
& Pricing



EVERYTHING YOU NEED
TO KNOW ABOUT
PTZ CAMERAS.
START LEARNING!

ALL-IN-ONE MOBILE CONFERENCING

MOBILE HYBRID CONFERENCING CART + CAMERA

With the number of daily livestreaming and videoconferencing sessions continuing to rise, a mobile conferencing cart enables more teams to connect. Because this all-in-one solution includes a built-in camera and speakers, all you have to do is add a display and a laptop, and you're ready to collaborate anywhere.

From a human factors perspective, the cart's dynamic height adjust allows people of all abilities to access the screen. In terms of hardware, it's a platform that can easily be customized. For example, add an optional front-mounted controller shelf to your cart. For larger rooms, add a table mic to make sure everyone can be heard.

Then for even more flexibility, consider an upgrade with cable retractors. Why? A power cord retractor will give your cart more freedom to move — up to 15 feet from the outlet. A network cable retractor gives you an extension option that still keeps you directly connected to an ethernet jack. Now it's easier to get that higher-quality bandwidth no matter where your cart is parked.

TIPS & TECHNIQUES

"This cart is really ready to roll. It has a built-in camera and everything you need to support a mobile conferencing setup. Just add a display and you can roll it right into your next meeting."



- Brian Retzlaff
Legrand | AV Solutions
Engineering Manager

TOP PRODUCTS

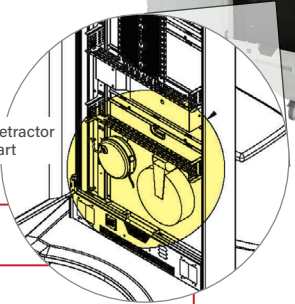
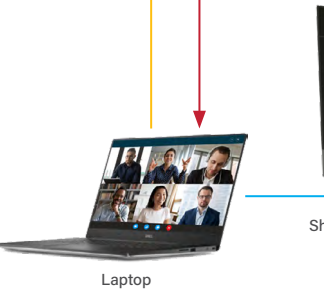

Thunderbolt USB-C to HDMI Cat6 HDBT Cat6 Network and PoE (+, ++)
Network Power USB HDMI Audio Speaker

WHY WE LOVE IT

- Just add a display and a laptop – and collaborate anywhere
- Optional shelf and cable retractors allow customization and convenience
- All-in-one design makes deployment quick and easy
- Roll it off the crate and into an active conference in minutes

KICK IT UP A NOTCH

ADD A POWER CORD RETRACTOR

WHY: Added flexibility—move the cart up to 15 feet from the outlet.

ADD CABLE RETRACTOR FOR NETWORK

WHY: Keep those high bandwidth connections high quality— and move up to 20 feet away from the ethernet jack.

ADD A DOCKING STATION

WHY: Makes it easy to use your own device for collaboration.

ADD A VADDIO TABLEMIC

WHY: Extend the pickup range so everyone can be heard.

PART NUMBERS

- Middle Atlantic FlexView Conferencing Cart with HuddleSHOT FC **FVS-HSFC-800SC-WH**
- Middle Atlantic Power Strip (not shown) **PD-815SC-20**
- Middle Atlantic Shelf **FVS-HS-FRTSHLF-WH**
- C2G 12' HDMI Cable **50185**

OPTIONS

- Middle Atlantic Power Cord Retractor Kit **FVS-800-RET15F**
- Middle Atlantic Cat6 Cord Retractor **FVS-800-CAT6-20F**
- Middle Atlantic RackLINK Power **RLNK-P415**
- Luxul 4 Port PoE+ Network Switch **SW-100-04P**
- C2G USB-C Docking Station **C2G54457**
- C2G 6' USB Thunderbolt Cable **28842**
- C2G 6' Cat6 Cable (Qty 3) **03967**
- C2G 12' Cat6 Cable **03970**



Get the Full
List of Parts
& Pricing



PROFESSIONAL HOME OFFICE

CONFERRING SPACE

By now every home office user is well aware of the limitations in basic camera and audio equipment. Blurry video and poor audio are simply not acceptable any longer. Trainers must be able to keep students engaged by offering more than just a single headshot. A professional camera such as the Vaddio ConferenceSHOT AV with built-in speaker will raise the bar. Pan-tilt-zoom video allows for natural movement and easy capture of images on a white board or other in-room demonstration surface. Camera presets and a remote control make it easy to get the perfect shot every time.

Home office users can boost their comfort with ergonomic solutions such as a dual-monitor mount, which can reduce eye strain and muscle tension. Add-ons like docking stations and WiFi boosting equipment can help make connections more seamless. An audio amplifier and soundbar improve sound quality and reduce the stress of listening to remote conversations.

TIPS & TECHNIQUES

“Many state and local government agencies are moving toward the hybrid workplace model. For many departments, a professional home office setup will deliver the experience expected from these entities.”



- Brian Retzlaff
Legrand | AV Solutions
Engineering Manager

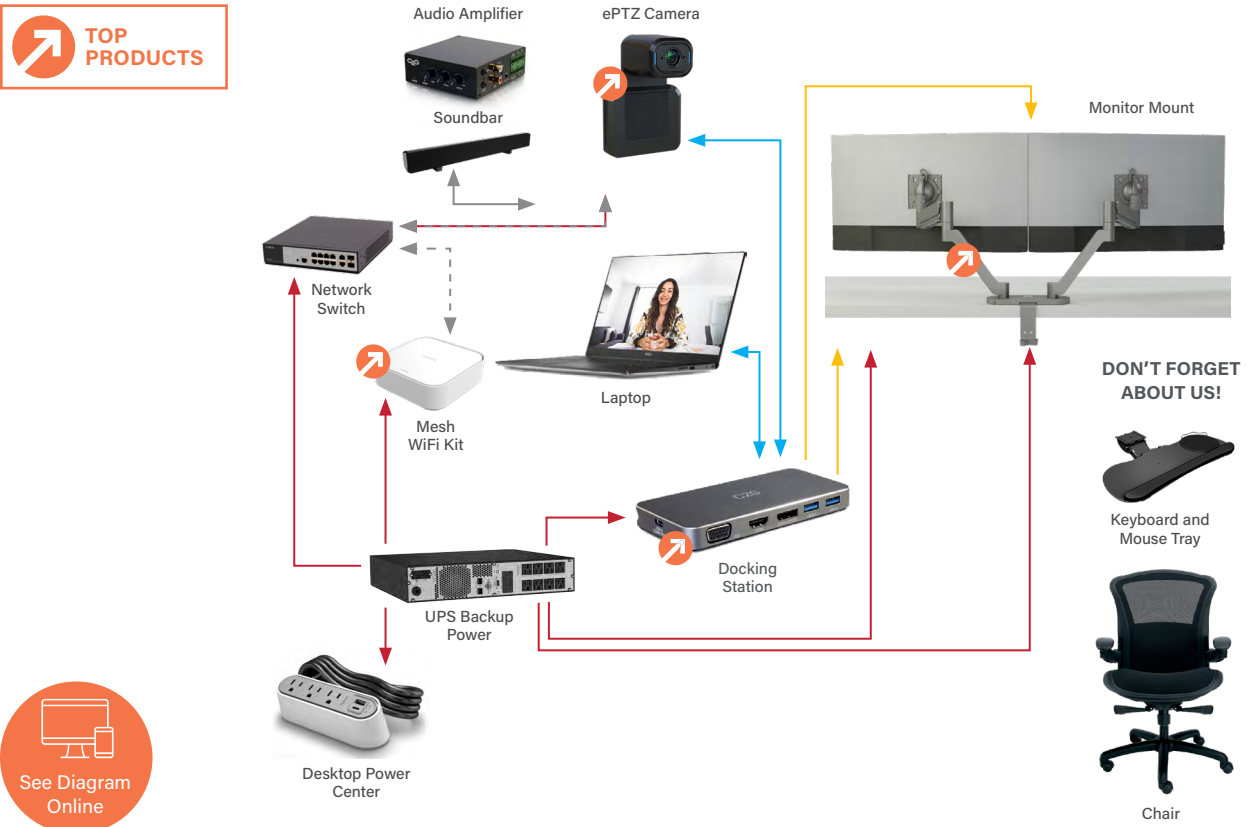

Thunderbolt USB-C to HDMI Cat6 HDBT Cat6 Network and PoE (+, ++, +++) Network Power USB HDMI Audio Speaker

WHY WE LOVE IT

- Professional camera raises the bar from webcam quality to a crisp, clear video
- Ergonomic dual monitor mount reduces muscle tension and eye strain
- Docking stations make setup easy if you're constantly on the go
- Reliable WiFi when failure is not an option for your important video calls
- Amplifier and soundbar for superb sound quality

KICK IT UP A NOTCH

GET COMFY
WHY: Great ergonomics are key for productivity & health. Check out the **Kontour Series** monitor arm mounts for larger monitors & our premium chair solutions too.

MORE WIFI
WHY: Permanent office space doesn't change the competition for bandwidth. Get maximum coverage.

SEE THE TAA COMPLIANCE
PDF FOR DESKTOP SOLUTIONS

- PART NUMBERS**
- Vaddio IntelliSHOT Camera **999-21100-000**
 - C2G Audio Amplifier **CG40880**
 - Vaddio EasyTalk Sound Bar **999-8565-000**
 - C2G 25' Plenum CMP-Rated Speaker Wire **29203**
 - Chief Koncis Monitor Arm Mount, Dual, Silver **DMA2S**
 - Chief Kontour Laptop Tray (if added to mount, laptop becomes 2nd monitor) **KRA300S**
 - Luxul Epic Mesh WiFi Kit (includes two nodes) **MK-10**
 - Luxul 12 Port PoE+ Switch **XMS-1208P**
 - Legrand UPS Backup Power **UPS-LL-1100RT**
 - Middle Atlantic UTB Series Universal TechBox **UTB-HR-A2-14**
 - Middle Atlantic Chair **CHAIR-ADV1-B**
 - Wiremold Desktop Power Center **WSPC320CWH**
 - C2G 10' Cat6 (qty. 2) **CG27133**
 - C2G 25' Cat6 (qty. 2) **CG27135**
 - C2G USB-C 7-in-1 Dual Display Docking Station Bundle **C2G54477**
- Note: Computers with Thunderbolt, consider an upgrade to the Thunderbolt docking station bundle **C2G54478**

Get the Full
List of Parts
& Pricing

MISSION CRITICAL

CLASSIFIED COLLABORATION

SECURE CONFERENCE ROOM SOLUTION

TIPS & TECHNIQUES

"We understand the requirements for security in Federal Government projects, with many standards often needing to be met in a single space, and we can help design technology systems and room configurations that meet those strict protocols."



- Bob Hivner
Legrand | AV
Regional Solutions and
Consultants Manager

An adjoining conference room with videoconferencing capabilities is vital to the success of any command and control center. When a simple conference space is transformed into a situation room, security becomes a much higher priority. From cabling and networks to furniture and secure equipment storage, proper AV design is vital — after all, lives may be on the line.

Credenzas with three or four bays make it easy to physically separate equipment based on classification levels. AV equipment can be configured to create a hard switch so classified content is protected.

High-quality conferencing is dependent on outstanding cameras, first-rate microphones and speakers, and connectivity to support them. For situations where it's critical to clearly know if the PTZ camera is on or off, the RoboFLIP PTZ Camera offers an innovative solution. How? RoboFLIP fully rotates into the ceiling when it's off and in standby mode, giving room occupants full assurance that video feeds are not active.



Secure
Equipment

Non-Secure
Equipment

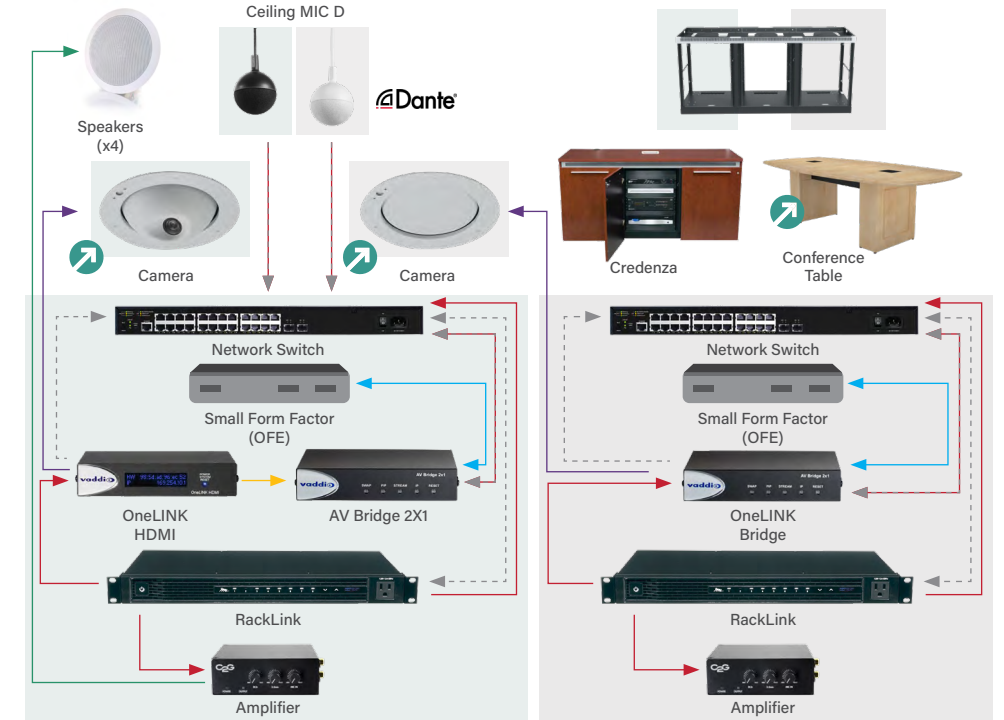

Thunderbolt USB-C to HDMI Cat6 HDBT Cat6 Network and PoE (+, ++)
Network Power USB HDMI Audio Speaker

WHY WE LOVE IT

- Three-bay credenzas make it easy to separate equipment based on classification levels
- T5 Conference Tables properly support AV technology for ultimate reliability 24/7/365
- RoboFLIP PTZ Camera rotates into the ceiling when it's in standby mode

PART NUMBERS

- C2G 5-in Ceiling Speakers (qty. 4) **39907**
Vaddio EasyIP Ceiling MIC D Dante Microphone **999-85820-000**
Vaddio RoboFLIP 30 HDBT Camera (Hides in ceiling when not in use) **999-99800-000**
FURNITURE
Middle Atlantic C5 Series Credenza (3-bay) **C5-FF27-3**
Middle Atlantic C5 Wood Kit **C5K3A1SSHB3ZP001**
Middle Atlantic T5 Series 8' Klasik Conference Table **T5KDD1BOV01ZP001**
Middle Atlantic T5 TechKit **T5-TECHKIT8B**
POWER AND CONTROL
Luxul Network Switch with POE+ **AMS-1816P**
C2G Amplifier **CG40881**
Vaddio OneLINK Bridge **999-9595-000**
Vaddio AV Bridge 2x1 **999-8250-000**
Vaddio OneLINK HDMI **999-1105-043**
Middle Atlantic RackLink **RLNK-P915R**





COMMAND & CONTROL

MISSION CRITICAL COMMAND CENTER WITH VIDEO WALL

TIPS & TECHNIQUES

“Eyestrain and unnecessary fatigue can be avoided when a video wall design is properly calibrated for line of sight. Our TiLED video wall configurator software factors in the ergonomics for all the operators in a space, whether they’re seated or standing, providing everyone with the best view possible.”



- Brandon Ivey
Legrand | AV National
Solutions Manager
Fed Govt / DoD

Each piece of a command center supports a mission-critical operation. The control room video wall is the center of attention. But when operators are working long hours in what may be intense situations, their success also depends on control room console design and furniture choices. Ergonomically-designed AV systems and furniture can reduce operator fatigue and ensure optimal performance throughout 24/7 operations. Custom consoles can be designed to your specifications with help from the design teams and applications engineering teams at Legrand | AV and LundHalsey.

At the front of the room, deliver pristine viewing for data and graphics with a seamless video wall built on Chief’s TAA-certified TiLED Series of modular mounts. Expanding outward to the operator stations, adjustable display mounts allow users to reposition multiple screens at once to their preferred viewing distance. Successful command centers also depend on details for optimal performance. For example, LED lighting strips on every console corner communicate security status clearly — at the touch of a button, change the color to indicate a change in protocol.

Throughout a command center, hardware choices ensure reliable operation. High-security server racks protect equipment. Intelligent power solutions keep the video wall functioning when power failure is not an option. Bridging cabinets connect consoles to create straight, convex or concave layouts, while providing additional rackmount storage.

A mission critical control room is the nerve center of your operation. Legrand | AV connects all the essential components of a command center you can depend on, every day, all day. Contact the Solutions Engineering team at Legrand | AV to get started on design services for customized large-scale video walls and operator stations.

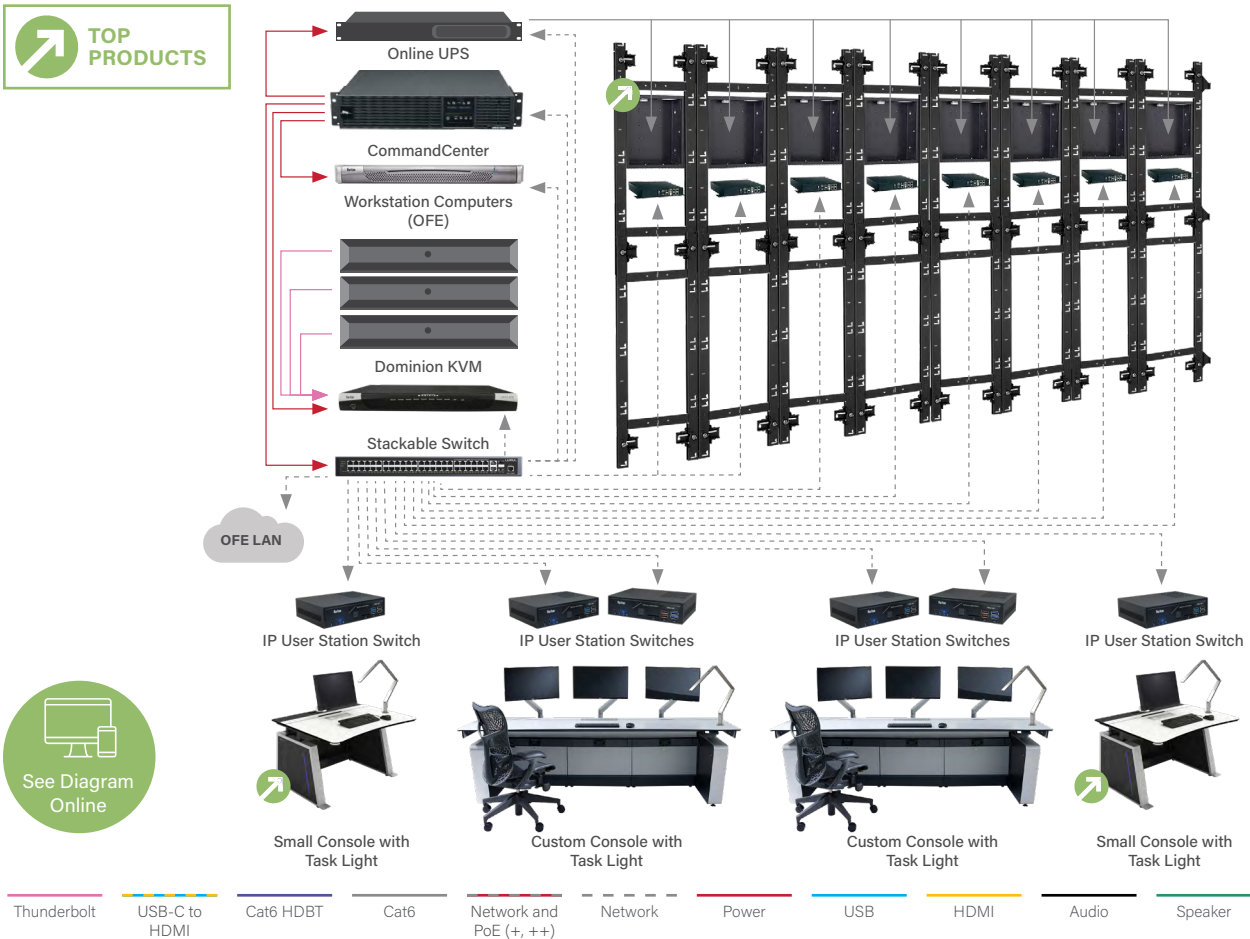

WHY WE LOVE IT

- Intelligent power solutions keep the video wall functioning when power failure is not an option
- Ergonomically-designed AV furniture maximizes operator productivity and enables top performance 24/7

KICK IT UP A NOTCH

CORNER LED LIGHTS

WHY: See status at a glance - for secured facilities using code red, code blue and so on.

BRIDGING CABINETS

WHY: Connect consoles together to create straight, convex or concave layouts, while providing rackmount storage as well.



EXPLORE MORE
MISSION CRITICAL
FURNITURE
SOLUTIONS



LEARN MORE
ABOUT
LUNDHALSEY



SEE THE TA
COMPLIANCE PDF
FOR DESKTOP
SOLUTIONS



CONTACT THE
SOLUTIONS
ENGINEERS TEAM
FOR DESIGN HELP

PART NUMBERS

POWER AND CONTROL

Middle Atlantic Products Online UPS with IP Card, (qty. 1)

UPS-OL3000R, UPS-OLIPCARD

Raritan CommandCenter® **CC-V1-128** with optional **CC-SG***

Raritan Dominion **KX III KVM** over IP **DKX3-808***

(Add on dongles for specific computer support)

Luxul 48-Port Managed Switch **SW-610-48P-F**

CONSOLES

Raritan Dominion KX III, KVM over IP User Station **DKX3-UST***

➔ LundHalsey VisionLine 24/7 Console, Small **LH-VLCSS**

LundHalsey VisionLine LED Task Light **LH-VLALGT**

LundHalsey Control Custom 24/7 Console **LH-CUSTOM**

Middle Atlantic Contour Freedom Chair **CHAIR-CF1-B**

VIDEO WALL

➔ Chief PAC Box **PAC527L**

➔ Chief TiLED Mounts for DvLED **TIL1x4UU**

(Model varies by LED Mfr)

Chief TiLED Vertical Connector Kit **TILVABU**

(Model varies by LED Mfr)

Middle Atlantic Premium+ PDU with RackLink, 4 Outlet 20A

RLNK-P420



Get the Full
List of Parts
& Pricing

*NOTE: Raritan products have a dedicated team. For details, contact government-sales@raritan.com.
NOTE: Video distribution and direct view LED system not shown in diagram.

SET THE FOUNDATION FOR RELIABILITY

RACK STORAGE

EQUIPMENT STORAGE WING

The equipment storage wing is the foundation of a command center. Robust equipment racks take into account not only the mounting of critical electronic components, but can also ensure long-term reliability when they are designed with proper heat and cable management.

RACK CONSIDERATIONS

Choosing the right racks will ensure stability and long life for the equipment that's installed inside. AV racks with a narrow form factor make for easier assembly and equipment maintenance. IT racks must hold longer server devices and have different thermal management requirements.

See Mission Critical Solutions



- AV RACK KIT INCLUDES:**
- Vertical PDU
 - Forward panels
 - Forward mounting accessories
 - Cable management
 - Thermal management

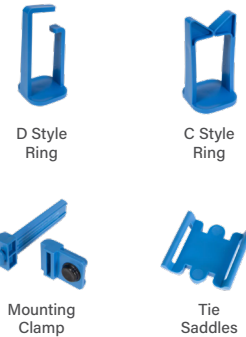
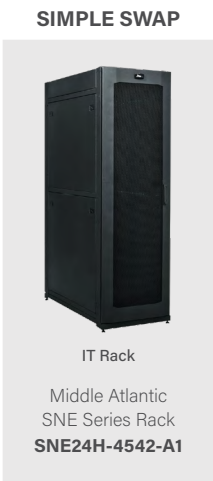
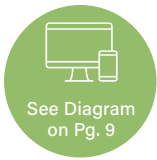

PART NUMBERS

RACKS FOR AV EQUIPMENT

Middle Atlantic Pre-Configured BGR for AV **BGR-4532-AV**

MIDDLE ATLANTIC RACK ACCESSORIES

Premium+ PDU with RackLINK 9 Outlet, 15A, 2-Stage Surge **RLNK-P915R**

Remote Temperature Sensor **RLNK-TEMP**

Compact Vertical PDU **PDT-2X1020**

D Style Ring Cable Management* **FWD-D-RING**

C Style Ring Cable Management* **FWD-C-RING**

Hook & Loop Tie Saddles* **FWD-TSW-15**

Small Device Mounting Clamps* **FWD-SIDECLMP-4**

Forward UPS Base for 32" Deep BGR (Includes UPS-2200R)

FWD-BS-2KVA-BGR32

Wire Grid Lace bar **FWD-LACE-WB3-44-45**

Horizontal Lacer Bar **FWD-LB-1A-4PK**

Racksheff **UFA-14.5-4**

SWITCHES

Luxul Network Switches for AV Equipment (Ports on the Rear) **Variety**

Luxul Network Switches for IT Equipment (Ports on the Front) **Variety**



*NOTE: Forward accessories are not compatible with SNE Series Racks.

POWER & REMOTE MANAGEMENT



INTELLIGENT POWER

There are many product solutions in the market that give you the ability to remotely solve common issues with AV systems. This helps prevent situations that leave clients without access to their AV system for hours, potentially during a big meeting, conference, or class. Saving clients the frustration of having to reschedule a meeting pays off for your business relationship and provides the AV experience your client expects.

POWER PROBLEMS WITH AV EQUIPMENT

Beyond the occasional device reboot, proactive monitoring is key to preventing total system failures, so get proactive with your services. It's no secret that AV equipment can be severely damaged by undervoltage (a.k.a. the silent killer), which you can't spot by sight. Monitoring the quality of the power to the devices and sending you alerts when specified thresholds are reached can save and extend the life of the equipment.

Equipment can also be damaged by overheating, which you may not catch right away if a fan goes out and you don't happen to be there. Remember, every 10°F (6°C) rise over 85°F (29°C) in a rack reduces the life of digital equipment by 40%! With environmental monitoring in your remote power management system, alerts can be triggered when the temperature gets too high, or can automatically trigger a fan to turn on.

There is also a feature in some systems called AutoPing. AutoPing is designed to continuously check if the network is still connected, so if for some reason the network goes down you are alerted and you can bring the network and equipment back online.

HOW REMOTE POWER MANAGEMENT KEEPS YOU AHEAD OF THE GAME

Being able to catch these issues right away through proactive email or text alerts saves the client from having to replace equipment or call you for simple tasks. It also comes with the added benefit of strengthening your business relationship. Trust is built by fixing issues before they become problems.

A challenge you may run into when working toward implementing a remote power management system is working with the IT department. The IT department can be hesitant or combative about not wanting to put an "unknown" IP device on their network. The primary reason is network security. Any device on the network creates a potential vulnerability to a network hack. Middle Atlantic's Premium+ PDUs with RackLink offer the industry's most robust suite of features for these situations.

Middle Atlantic's **Premium+ PDUs with RackLink** have features like; individual outlet control, AutoPing, amperage/voltage/wattage monitoring, temperature/humidity monitoring, sequencing, data logging, SNMP and **more**. From a connection standpoint, the PDUs with RackLink are flexible and can be connected in many ways to fit your unique situation. You can connect directly to the client's network, connect via a separate AV network, connect to any cloud platforms or control systems all through IP, RS-232, WiFi, APIs and/or contact closures. This flexibility allows for you to work with the client's preference on how to remotely manage and monitor the AV system power.

Hopefully this has provided you with valuable information to overcome some of the challenges or objections you might face when determining the best AV system for your clients. Remote power management, and remote management in general can keep AV systems up and running, give a longer life to the equipment, minimize system downtime, and build trust in your services. Our goal as AV providers should be to maximize the uptime of the AV experience.

 See Article Online

LEARN MORE ON
REMOTE POWER
MANAGEMENT

IMPROVING LIVES

CHIEF

NUVO

C2G

MIDDLE ATLANTIC

VADDIO

LUXUL

ON-Q

SANUS

DA-LITE

PROJECTA

We've created something unseen in our industries – a union that goes beyond products. A union that generates trust and partnership. With one direction uniting the brands of Legrand | AV, we're able to connect the world, and transform it. Join the journey to see what's next.

Find out more here.

legrand | AV

AMAZING AV EXPERIENCES | legrandav.com

USA 866.977.3901 av.support@legrand.com CANADA 877.345.4329 av.support@legrand.com

EMEA +31 495 580 840 av.emea.sales@legrand.com APAC +852 2145 4099 av.asia.sales@legrand.com

©2021 Legrand AV Inc. 210510 Rev A 9/21 C2G, Chief, Da-Lite, Luxul, Middle Atlantic, Projecta and Vaddio registered trademarks of Legrand AV Inc. All other brand names or marks are used for identification purposes and are trademarks of their respective owners. All patents are protected under existing designations. Other patents pending.