

# ZINTRA DIRECT STICK

## ADHESIVE FIX

### INSTALLATION INSTRUCTIONS





# ZINTRA DIRECT STICK

## ADHESIVE FIX

### INSTALLATION INSTRUCTIONS

#### PARTS AND HARDWARE

PANEL

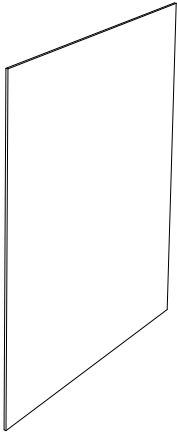

# ZINTRA DIRECT STICK

## ADHESIVE FIX

### INSTALLATION INSTRUCTIONS

#### YOU WILL NEED

SPIRIT LEVEL

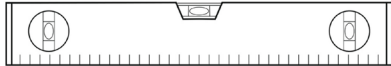

TAPE MEASURE

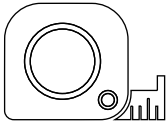

LOCTITE POWER GRAB EXPRESS HEAVY DUTY CONSTRUCTION ADHESIVE



APPROPRIATE APPLICATOR

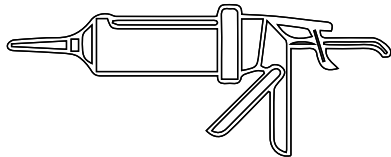

# ZINTRA DIRECT STICK ADHESIVE FIX INSTALLATION INSTRUCTIONS

## STEP 1

Be certain that your substrate will hold an adequate bond to the recommended adhesive(s). If in doubt about a coating or a finish already in place, an adhesion mock up test is recommended before you begin.

Cut, scribe and dry pre-fit all Zintra panels as necessary.

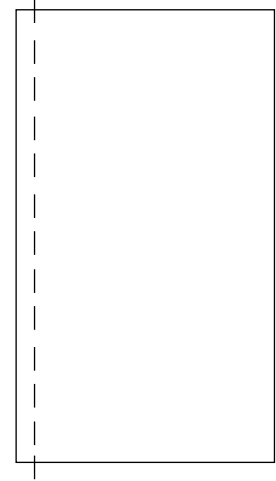

## STEP 2

Place the cartridge into the caulking gun, cut the nozzle to produce a 1/4" thick bead and puncture the inner seal. A 1/4" (0.64cm) bead will cover approximately 27 lineal feet (8.2 meters) per 9 fl oz tube.

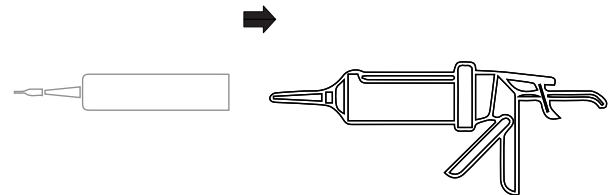

## STEP 3

Once all of the panels have been properly sized and trimmed, begin the application of the adhesive to the **BACK SIDE (ONLY)** of each panel. Use only Loctite Powergrab Heavy Duty Construction Adhesive or Pattex PL200 and follow suppliers instructions.

First apply a bead around the entire perimeter of the **BACK** of the panel. Place the bead to be no more than 1" in from the perimeter at any point.

Next, apply a zig zag or diagonal pattern of additional adhesive across the central sections of the panel, within the perimeter bead. See the images on the right for guidance.

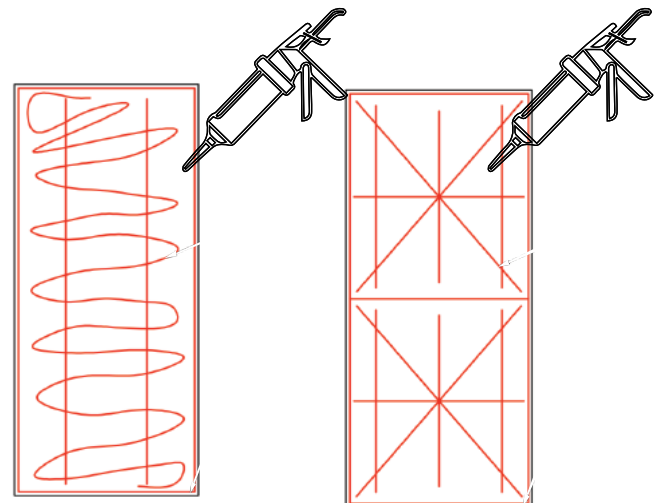

BACK SIDE ONLY

BACK SIDE ONLY

# ZINTRA DIRECT STICK ADHESIVE FIX INSTALLATION INSTRUCTIONS

## STEP 4

Apply the panel to the substrate within 20 minutes and monitor your adhesive to prevent it from skinning over. Set the panels into place and smooth with open palms.

Now, remove the panel from the substrate and hold it off the surface for one minute. Then reset the panel into place and smooth with firm pressure to set it. Use mechanical fasteners if you see the need to help this stay positioned while the adhesive remains wet.

Never use solvent based contact adhesives or any unauthorized adhesives.

Install all panels by maintaining the identical orientation of the sticker (and thus of the panel) for each and every panel installed. Do not reverse or flip panels.

