

rolly KIPPER

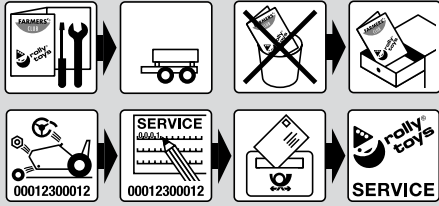
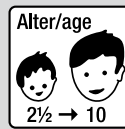

rolly toys Kundendienst Deutschland:

Tel: +49 (0) 95 68 / 856-142
 Fax: +49 (0) 95 68 / 856-183
 e-mail: service@rollytoys.de

2021/02

881.000.800.00

→ **

● +10	● +26	● +47
● +12	● +30	● +51
● +13	● +37	● +54
● +20	● +38	● +60
● +22	● +40	● +70
● +23	● +41	● +75
● +25	● +44	● +80

made in Germany



Tractor Model	Part Number
<input checked="" type="checkbox"/> rolly Dreiradtraktoren	05 ●●●●
<input type="checkbox"/> rollyMinitrac	13 ●●●●
<input checked="" type="checkbox"/> rollyKid	01 ●●●● / 02 ●●●●
<input checked="" type="checkbox"/> rollyJunior	80 ●●●● / 81 ●●●●
<input checked="" type="checkbox"/> rollyFarmtrac	60 ●●●● / 61 ●●●●
<input checked="" type="checkbox"/> rollyFarmtrac Classic	03 ●●●● / 04 ●●●●
<input checked="" type="checkbox"/> rollyFarmtrac Premium	70 ●●●● / 71 ●●●●
<input checked="" type="checkbox"/> rollyX-Trac	03 ●●●● / 04 ●●●●
<input checked="" type="checkbox"/> rollyTruck (Unimog)	03 ●●●●



Franz Schneider GmbH & Co KG
 P.O.Box 1460
 D-96459 · Neustadt bei Coburg · Germany
 Tel.: +49 (0) 95 68 / 856-0
 Fax.: +49 (0) 95 68 / 856-190
 www.rollytoys.com

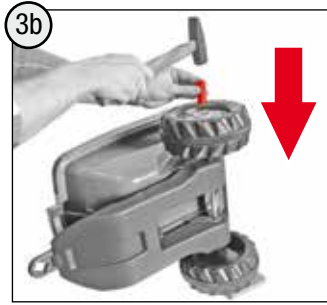
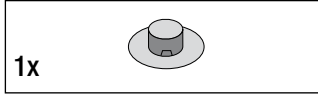
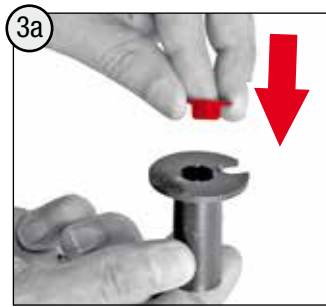
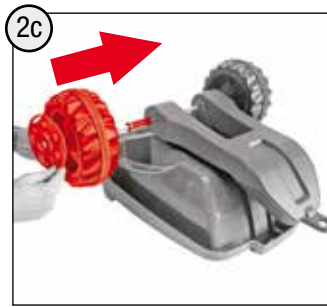
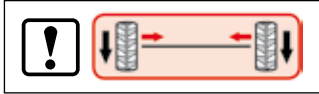
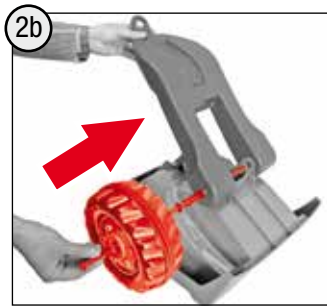
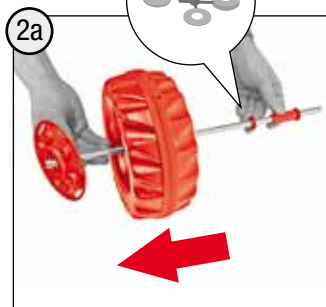
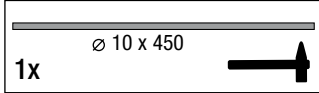
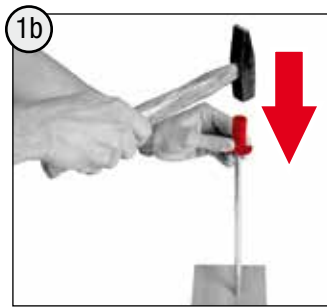
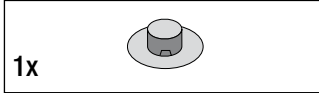
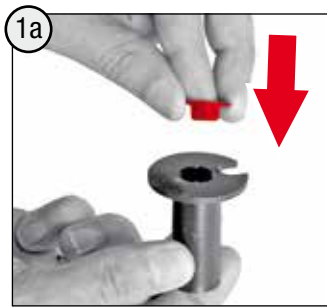

---NORTH & SOUTH AMERICA only---

180 days warranty

From the date of purchase + guaranteed spare part service

The warranty does not cover damages caused by improper use or neglect



WARNING

- CHOKING HAZARD - Small parts, Danger of being swallowed. Contains small parts in non assembled state. Must be assembled by adults.
- Toy is not suitable to carry children.
- If toy is defective stop using it, repairs may only be carried out by adults.
- Adult supervision required.
- Never use near steps, slopes, driveways, hills, roadways, alleys or swimming pool areas.
- Always wear shoes.
- Conforms to the requirements of ASTM Standard Consumer Safety Specification on Toy Safety, F 963.