

# rolly KIPPER

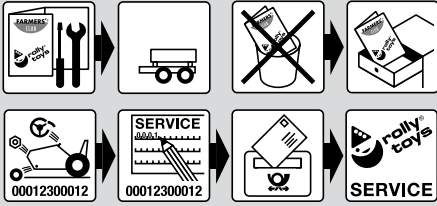
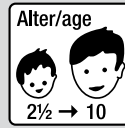

rolly toys Kundendienst Deutschland:

Tel: +49 (0) 95 68 / 856-142  
 Fax: +49 (0) 95 68 / 856-183  
 e-mail: service@rollytoys.de

2021/02

881.000.800.00

881 000 059 \*\*

100 200 100 00  
 ø 10

ø 10 x 450

881 000 100 \*\*

286 000 022 \*\*

210 x 85 - 10

201 000 004 80



881 017 000 00

→ **		
● +10	● +26	● +47
● +12	● +30	● +51
● +13	● +37	● +54
● +20	● +38	● +60
● +22	● +40	● +70
● +23	● +41	● +75
● +25	● +44	● +80

made in Germany



<input checked="" type="checkbox"/> roly Dreiradtraktoren	05 ●●●
<input type="checkbox"/> rolyMinitrac	13 ●●●
<input checked="" type="checkbox"/> rolyKid	01 ●●● / 02 ●●●
<input checked="" type="checkbox"/> rolyJunior	80 ●●● / 81 ●●●
<input checked="" type="checkbox"/> rolyFarmtrac	60 ●●● / 61 ●●●
<input checked="" type="checkbox"/> rolyFarmtrac Classic	03 ●●● / 04 ●●●
<input checked="" type="checkbox"/> rolyFarmtrac Premium	70 ●●● / 71 ●●●
<input checked="" type="checkbox"/> rolyX-Trac	03 ●●● / 04 ●●●
<input checked="" type="checkbox"/> rolyTruck (Unimog)	03 ●●●



Franz Schneider GmbH & Co KG  
 P.O.Box 1460  
 D-96459 · Neustadt bei Coburg · Germany  
 Tel.: +49 (0) 95 68 / 856-0  
 Fax.: +49 (0) 95 68 / 856-190  
 www.rollytoys.com

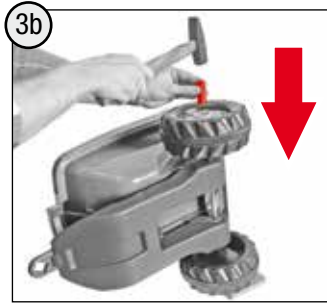
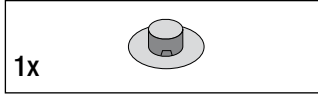
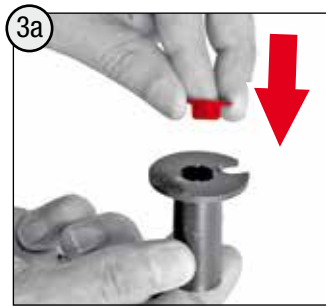
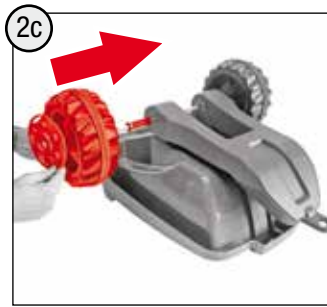
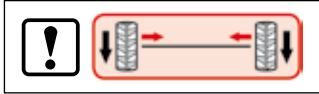
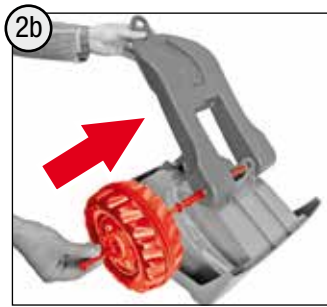
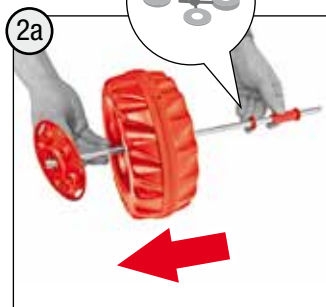
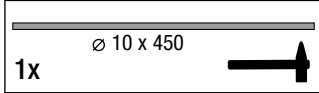
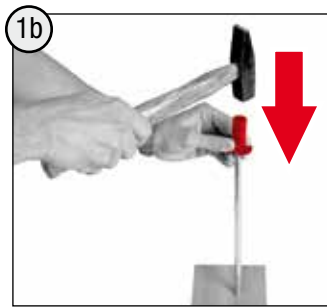
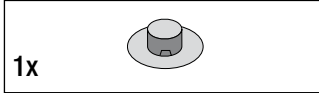
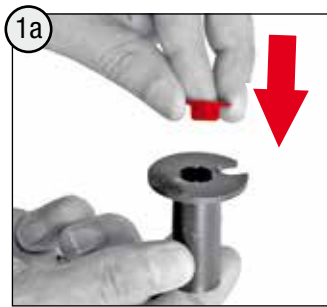

---NORTH & SOUTH AMERICA only---

**180 days warranty**

From the date of purchase + guaranteed spare part service

The warranty does not cover damages caused by improper use or neglect



## **WARNING**

- CHOKING HAZARD - Small parts, Danger of being swallowed. Contains small parts in non assembled state. Must be assembled by adults.
- Toy is not suitable to carry children.
- If toy is defective stop using it, repairs may only be carried out by adults.
- Adult supervision required.
- Never use near steps, slopes, driveways, hills, roadways, alleys or swimming pool areas.
- Always wear shoes.
- Conforms to the requirements of ASTM Standard Consumer Safety Specification on Toy Safety, F 963.