

Bauer-System

Beim Bauer System ist die V-Kupplung einteilig und becherförmig. An der M-Kupplung sitzt ein beweglicher Ring, an dem die Hebel angebracht sind.

Kugel zum Anschweißen

NW	Zoll	A	B
50	2"	49 mm	70 mm
76	3"	76 mm	98 mm
89	3,5"	89 mm	120 mm
108	4"	107 mm	145 mm
133	5"	132 mm	159 mm
159	6"	156 mm	179 mm
194	8"	192 mm	230 mm

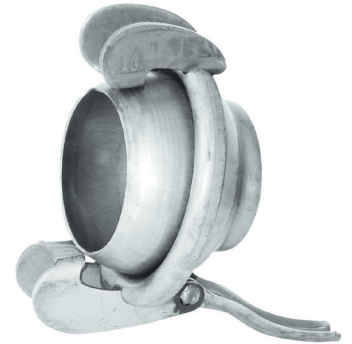
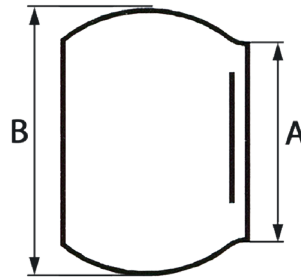

V-Kupplung zum Anschweißen

NW	Zoll	A	B
50	2"	49 mm	71 mm
76	3"	76 mm	99 mm
89	3,5"	89 mm	121 mm
108	4"	107 mm	148 mm
133	5"	132 mm	163 mm
159	6"	156 mm	182 mm
194	8"	192 mm	231 mm

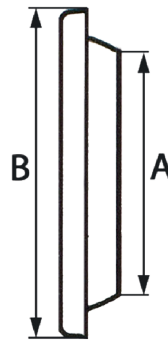

Hebelverschlussring

NW	Zoll	A	B
50	2"	62 mm	-
76	3"	89 mm	-
89	3,5"	113 mm	-
108	4"	133 mm	-
133	5"	150 mm	-
159	6"	170 mm	-
194	8"	248 mm	-

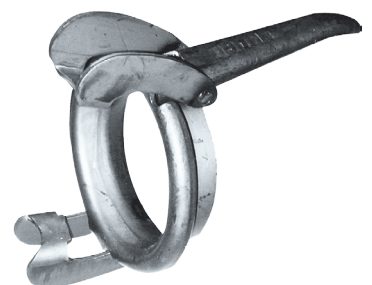
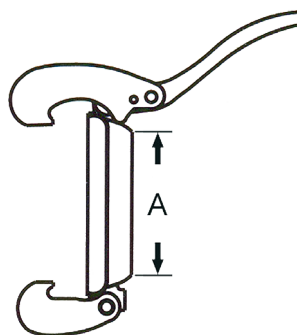

O-Ring

NW	Zoll	A	B
50	2"	83 mm	9 mm
76	3"	115 mm	13 mm
89	3,5"	134 mm	14 mm
108	4"	160 mm	15 mm
133	5"	190 mm	18 mm
159	6"	208 mm	19 mm
194	8"	253 mm	18 mm

