

beurer

LB 45



EN Air humidifier	
Instructions for use.....	3

CE

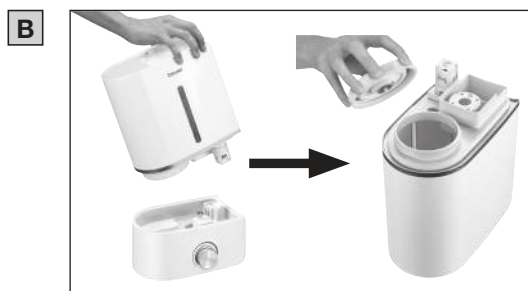
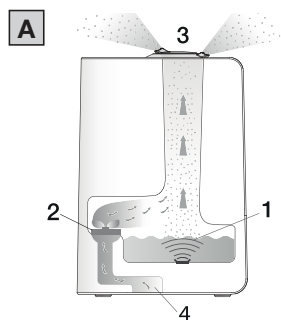
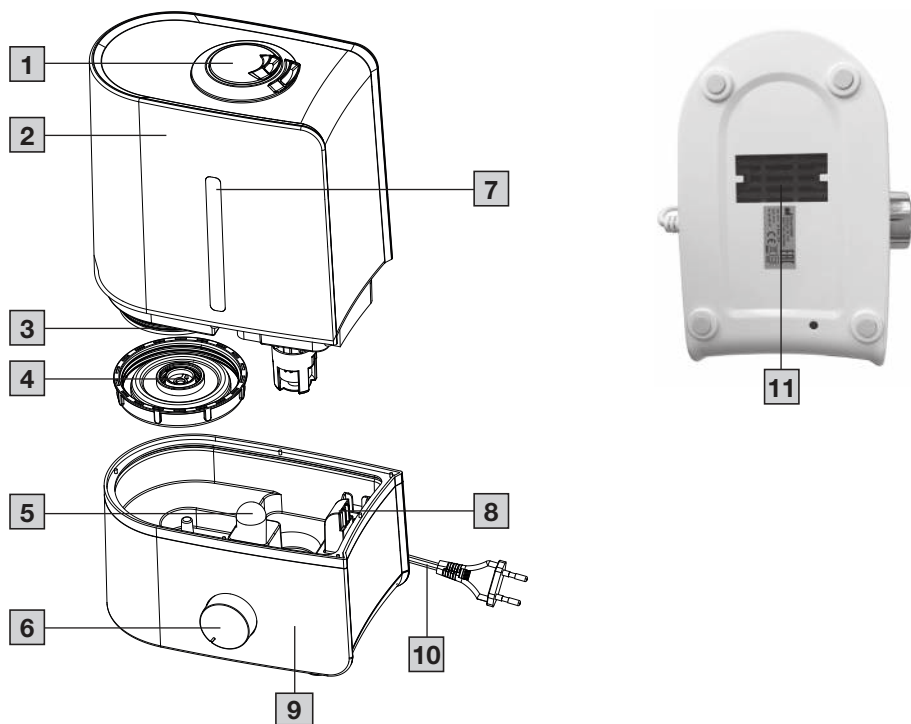



Read these instructions for use carefully and keep them for later use, be sure to make them accessible to other users and observe the information they contain.

Contents

1. Included in delivery	4	8. Cleaning and maintenance.....	6
2. Signs and symbols	4	9. Accessories and replacement parts.....	7
3. Safety notes	4	10. What if there are problems?	7
4. Intended use.....	5	11. Disposal.....	7
5. Gerätebeschreibung	5	12. Technical specifications	7
6. Initial use	5	13. Warranty / Service	7
7. Operation.....	6		

WARNING

- This device may be used by children over the age of eight and by people with reduced physical, sensory or mental skills or a lack of experience or knowledge, provided that they are supervised or have been instructed on how to use the device safely, and are fully aware of the consequent risks of use.
- Children must not play with the device.
- Cleaning and user maintenance must not be performed by children unless supervised.
- Disconnect the device from the mains supply during filling or cleaning.
- When the water evaporation is activated, the escaping steam is hot – risk of scalding.
- Do not use any solvent-based cleaning products.
- If the mains connection cable of this device is damaged, it must be disposed of. If it cannot be removed, the device must be disposed of.
- Be aware that high humidity levels may encourage the growth of biological organisms in the environment.
- Do not permit the area around the device to become damp or wet. If dampness occurs, turn the output of the device down. If the output volume cannot be turned down, use the device intermittently. Do not allow absorbent materials, such as carpeting, curtains, drapes, or tablecloths, to become damp.
- Never leave water in the reservoir when the appliance is not in use.
- Empty and clean the device before storage. Clean the device before next use.

- Micro-organisms that may be present in the water or in the environment where the appliance is used or stored, can grow in the water reservoir and be blown in the air causing very serious health risks when the water is not renewed and the tank is not cleaned properly every three days.











1. INCLUDED IN DELIVERY

Check that the exterior of the delivery cardboard packaging is intact and make sure that all components are present. Before use, ensure that the device and accessories show no visible damage and all packaging material has been removed. If you have any doubts, do not use the device and contact your retailer or the specified Customer Service address.

- 1x Air humidifier
- 15x Replacement aroma pads
- 1x Anti-limescale filter
- 1x These instructions for use

2. SIGNS AND SYMBOLS

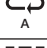
The following symbols appear in the instructions for use and on the type plate:

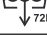
	WARNING Warning instruction indicating a risk of injury or damage to health
	IMPORTANT Safety note indicating possible damage to the device/accessory
	Product information Note on important information
	Separate the product and packaging elements and dispose of them in accordance with local regulations.
	Read the instructions
	The electronic device must not be disposed of with household waste
	Manufacturer
	CE labelling This product satisfies the requirements of the applicable European and national directives.
	Marking to identify the packaging material. A = Material code, B = Material number: 1-7 = Plastics, 20-22 = Paper and cardboard
	The products demonstrably meet the requirements of the Technical Regulations of the EAEU.
	Protection class II device The device is double-protected and thus corresponds to protection class 2
	water tank, periodical cleaning

	United Kingdom Conformity Assessed Mark
	Importer

3. SAFETY NOTES

Read these instructions for use carefully! Non-observance of the following information may result in personal injury or material damage. Store these instructions for use in a safe place and make them accessible to all users. Make sure you include these instructions for use when handing over the device to third parties.

WARNING

Keep packaging material away from children. There is the risk of suffocation.

Electric shock

WARNING

As with every electrical device, use this air humidifier carefully and cautiously in order to avoid hazards resulting from electric shock.

- Use the device only with the mains voltage specified on the device (the type plate is located underneath the base unit).
- Only insert the mains cable into the socket when the device is switched off.
- Never use the device if it or any of its accessories are visibly damaged.
- Do not use the device if it has sustained a fall or if water has penetrated the device interior.
- Do not use the device during a storm.
- In the event of defects or operational faults, switch off the device immediately. Pull the plug out of the mains socket.
- Do not pull on the mains cable or on the device to disconnect the plug from the socket.
- Never hold or carry the device by the mains cable.
- Do not clamp or pinch the mains cable.
- Keep the mains cable away from hot surfaces.
- Ensure that the mains cable and plug do not come into contact with water, steam or other liquids.
- Only use the device in dry internal rooms (e.g. never in the bathroom, sauna, etc.).
- Never reach for a device that has been submerged in water. Pull the plug out of the mains socket immediately.
- Do not drop the device or subject it to any impacts.

Repairs

WARNING

- Do not open the base unit.
- Only specialist personnel may perform repairs on electrical devices. Improper repairs may subject users to considerab-

le danger. For repairs, please contact Customer Services or an authorised retailer.

Risk of fire

WARNING

There is a risk of fire if the device is used improperly or these instructions for use are ignored.

- Never use the device underneath a cover, such as a blanket or pillow.
- Never use the device near highly flammable substances.

Operation

WARNING

- The device is only intended for the purpose described in these instructions for use. The manufacturer is not liable for damage resulting from improper or careless use.
- If you suffer from a severe respiratory or lung disease, consult your doctor before using the air humidifier.
- Switch off the device after every use and before cleaning. Pull the plug out of the mains socket.
- Ensure that the mains cable does not pose a trip hazard.

IMPORTANT

- Ensure that the device is placed on a firm, secure surface that is not susceptible to moisture.
- Do not insert any objects into openings on the device. Ensure that the moving parts can move freely at all times.
- Do not place any objects on the device.
- Do not expose the device to high temperatures.

4. INTENDED USE

This air humidifier is only intended for humidifying ambient air. The device is intended for private use only.

The air humidifier

- humidifies the air,
- runs quietly and is continuously adjustable,
- is suitable for rooms up to 30 m²,
- has a low energy consumption and switches off automatically when the water tank is empty,
- switches off automatically when the water tank is removed,
- contains an aroma compartment for room fragrancing,
- is easy to clean.

5. GERÄTEBESCHREIBUNG

The associated drawings are shown on page 3.

- 1 Mist outlet
- 2 Water tank
- 3 Anti-limescale filter
- 4 Water tank screw plug
- 5 Ultrasound membrane
- 6 Control dial
- 7 Fill level indicator
- 8 Aroma compartment with aroma pad

- 9 Base unit
- 10 Mains cable
- 11 Air filter

Principle behind the LB 45 air humidifier

- 1 A membrane, vibrated by ultrasound, moves the water and releases tiny water droplets from the surface.
- 2 The fan draws in air at the bottom of the device.
- 3 The air is humidified with the released water droplets and blown gently upwards towards the opening.
- 4 If you wish, the device can be used with aromas.

6. INITIAL USE

Unpacking the device

WARNING

Keep packaging material away from children. There is the risk of suffocation.

1. Open the cardboard packaging.
2. Remove the protective insert. Keep the plastic film closed.
3. Lift the device up and out of the packaging.
4. Remove the plastic covering.
5. Check the device, the mains plug and the cable for damage.

Installation location

WARNING

Read the safety notes before putting the device into operation.



- The immediate vicinity of the air humidifier can become damp.
- Calcareous water can leave white deposits.
- Do not place the device on the floor, but in a raised position (e.g. on a table or chest of drawers).
- Position the device so that the mist outlet is not directed towards objects.
- Do not use the air humidifier in rooms with significant temperature variations since this could lead to condensation inside the device.
- Empty any remaining water when the device is not in use.
- Place the air humidifier on a firm, level and water-resistant surface.

If the device should accidentally tip over, water may escape, even if the device is switched off and unplugged.

Water



- Do not add any essential oils or fragrances to the water. If additives are used, the plastic material may become discoloured and damaged. The ultrasound membrane gets stuck and is damaged.
- Use fresh drinking water in the device. If the drinking water is very hard, you can use demineralised or distilled water.
- Use warm water (30°C-45°C) and always fill the tank to the maximum level, otherwise the device could leak due to physical factors.
- **Tip!** If the water is hard, we recommend using the optional anti-limescale filter.

Filling the water tank

1. Remove the water tank from the base unit in an upward direction.
2. Turn the water tank over. The water tank is kept closed by means of a spring valve.
3. Open the screw plug on the water tank.
4. Fill the water tank with warm water (30°C-45°C). The water tank holds a maximum of 4.0 litres. The water level is visible from the outside.
5. Close the screw plug on the water tank tightly.
6. Turn the water tank over.
7. Place the water tank on the base unit.
Ensure that the water tank is sitting firmly on the base unit.

7. OPERATION

-  Check the humidity of your ambient air regularly. Intensive continuous operation can cause the ambient air to become excessively humid. The relative air humidity should not exceed 60%.

Switching on the device

1. Plug the mains cable into a suitable socket.
2. Turn the control dial clockwise. The fill level indicator starts to glow blue. Mist now flows from the mist outlet. If there is not enough water or no water at all in the water tank, the fill level indicator will light up red and the device will switch off for safety reasons. Should the device switch off, fill the water tank as described in the section "Filling the water tank".
3. Using the control dial, select the desired evaporation output. Evaporation is limited to a maximum of 300 ml per hour.

-  You may optionally add drops of aroma/scented oils to the aroma pad in the aroma compartment. This releases a fragrance into the air. Under no circumstances should you add the aroma directly to the water.

Switching off the device

1. Turn the control dial left as far as it will go, until you feel slight resistance and the control dial clicks. The fill level indicator goes out.
2. Unplug the mains cable from the mains socket.

8. CLEANING AND MAINTENANCE

Regular cleaning and disinfection is a prerequisite for hygienic and fault-free operation. The level of contamination of the device depends on the water quality and how long it has been in operation. In any case, we recommend the following cleaning intervals.

Every three days	As required	
x		Cleaning the ultrasound membrane with a cotton bud, rinsing the base unit
x		Rinsing the water tank, replacing the water
x		Cleaning the air humidifier inside and out
	x	Descaling

Use either a citric acid solution (30 g pure citric acid powder dissolved in 1 l water) or a vinegar solution (household vinegar

with 5% acid content mixed with water in a ratio of 1:2) as a descaling solution.



WARNING

Switch off the device after every use and before cleaning. Pull the plug out of the mains socket.



IMPORTANT

The water tank must be cleaned and the air humidifier completely emptied if the device has not been used for 72 hours.



- Clean the device using only the methods specified.
- Under no circumstances may water enter the inside of the housing.
- Do not use any solvent-based cleaning products.
- Use only a mild detergent or citric acid or vinegar-based solution to perform cleaning or disinfection work.

Cleaning the ultrasound membrane, rinsing the base unit



Empty the water from the base unit via the side rim in the direction indicated by the arrow. Ensure that no water gets inside the device, e.g. via the fan opening.

1. Clean the ultrasound membrane with a cotton bud.
2. Empty the water from the base unit via the side rim. Observe the markings on the device!
3. Should dirty residue remain in the base unit, pour some clean, fresh water into the base unit and tip it out via the side edge.

Rinsing the water tank, replacing the water

Clean the water tank at least every three days. Use a mild cleaning product or vinegar/vinegar-based cleaner.

1. Clean the thread of the screw plug using a soft brush.
2. Fill the water tank halfway with water.
3. Close the screw plug on the water tank.
4. Shake and turn the water tank over repeatedly.
5. Open and empty the water tank completely.
6. Repeat the process using clean, fresh water.

Cleaning the air humidifier inside and out

1. Empty the water from the base unit via the side rim.
2. Wipe the air humidifier with a damp cloth inside and out. Use only a mild detergent or citric acid or vinegar-based solution to perform cleaning or disinfection work.

Descaling

Descaling the ultrasound membrane

Hard water can cause limescale to build up in the device and, especially, on the ultrasound membrane. This forms white deposits. Descalate the device regularly.

1. Drop some descaling solution onto the ultrasound membrane.
2. Leave it to take effect for two to five minutes.
3. Clean the ultrasound membrane with a cotton bud.
4. Rinse the base unit several times with clean, fresh water.
5. Repeat this procedure if necessary.

Cleaning inside the base unit

1. Dip a damp, soft cloth briefly in descaling solution.
2. Wipe the inside of the base unit with the cloth.

- Carefully add some clean, fresh water into the base unit.
- Empty the water from the base unit via the side rim.
- Repeat the process using clean, fresh water.

Descaling the water tank

- Half-fill the water tank with descaling solution.
- Close the screw plug on the water tank.
- Shake and turn the water tank over repeatedly.
- Open and empty the water tank completely.
- Repeat the process several times using clean, fresh water.

9. ACCESSORIES AND REPLACEMENT PARTS

TIP!

If the water is hard, we recommend using the optional anti-limescale filter in addition to the anti-lime pads supplied.



- If the anti-limescale filter does not prevent limescale build-up, or if white deposits form on or in the device, the anti-limescale filter should be replaced.
- The service life of the anti-limescale filter is around 2 to 3 months at most.
- If the device is not used for a relatively long time, the anti-limescale filter must be removed from the water tank and dried out.

Fitting the anti-limescale filter

- Ensure that the device is switched off.
- Remove the water tank from the base unit in an upward direction.
- Turn the water tank over.
- Open the screw plug on the water tank.
- Screw the anti-limescale filter on the screw plug thread of the water tank.
- Close the screw plug on the water tank. The anti-limescale filter is now fitted.

Replacement items

For replacement parts and additional items visit www.beurer.com or contact the corresponding service address in your country (according to the service address list).

Replacement parts and additional items are also available from retailers.

Item	Item number
Beurer by Taoasis Aroma-Öl „Vitality“ (10 ml)	681.30
15 aroma pads	164.148
Anti-limescale filter	164.147

10. WHAT IF THERE ARE PROBLEMS?

Problem	Cause	Solution
No mist is produced	The mains cable is not plugged in.	Plug the mains cable into a suitable socket.
	The control dial is in the off position.	Turn the control dial clockwise towards the maximum position.
	The water level is too low; the water tank is empty.	Fill the water tank.

The mist has a strange smell	The device is new.	Lift up the water tank, turn the screw plug and remove it. Air the open, empty water tank in a cool, dry place for 12 hours.
	Stale or dirty water.	Empty the base unit and the water tank and clean them thoroughly. Fill the water tank with fresh water.
Strange noise	The water tank is not positioned correctly on the base unit.	Lift up the water tank and position it correctly on the base unit. The tank should sit tightly on the base unit.
	There is too little water in the water tank.	Fill the water tank.
	The device is not level and unstable.	Place the device on a firm, level surface.
Mist escapes from underneath the water tank	The water tank is not positioned correctly on the base unit.	Lift up the water tank. Check whether the join between the base unit and water tank is clean. Clean if required. Position the water tank correctly on the base unit. The tank should sit tightly on the base unit.

11. DISPOSAL

For environmental reasons, do not dispose of the device in the household waste at the end of its useful life. Dispose of the unit at a suitable local collection or recycling point. Dispose of the device in accordance with EC Directive – WEEE (Waste Electrical and Electronic Equipment). If you have any questions, please contact the local authorities responsible for waste disposal.



12. TECHNICAL SPECIFICATIONS

Dimensions (L x W x H)	approx. 21.5 cm x 14.7 cm x 31.7 cm
Cable length	approx. 1.5 m
Deadweight	approx. 1.5 kg
Mains voltage/frequency	100–240 V AC / 50/60 Hz
Nominal power	25 watts
Room size	up to 30 m ²
Maximum capacity	approx. 4 litres
Evaporation output	300 ml/hour

13. WARRANTY / SERVICE

Further information on the warranty and warranty conditions can be found in the warranty leaflet supplied.



Beurer GmbH • Söflinger Str. 218 • 89077 Ulm, Germany
www.beurer.com • www.beurer-gesundheitsratgeber.com • www.beurer-healthguide.com



BEURER UK Ltd.
Suite 16, Stonecross Place, Stonecross Lane North,
WA3 2SH
Lowton,
United Kingdom