

beurer

HA 50



EN Hearing amplifier
Instructions for use

CE 0483



A

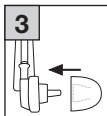
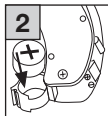
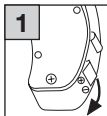

B



ENGLISH

Contents

1. Included in delivery	4	8. Cleaning and Maintenance.....	15
2. Signs and symbols	4	9. Accessories and	
3. Warning and safety notes.....	7	replacement parts	17
4. Intended use.....	13	10. What if there are problems?	17
5. Device description.....	13	11. Disposal.....	20
6. Initial use	14	12. Technical specifications	22
7. Usage	14	13. Warranty / service.....	23

Getting to know your device

The hearing amplifier is a device to help people hear better. It does this by amplifying sounds and then transmitting these to the ear. The hearing amplifier can neither prevent nor alleviate organically caused hearing loss.

The hearing amplifier offers you a variety of applications. Regardless of whether you want to watch a film, chat with friends or just feel like listening to the sounds of nature in the woods, the hearing amplifier helps you to hear sounds louder and more clearly.

1. INCLUDED IN DELIVERY

Check that the device packaging has not been tampered with and make sure that all contents are present. Before use, ensure that there is no visible damage to the device or accessories and that all packaging material has been removed. If you have any doubts, do not use the device and contact your retailer or the specified Customer Services address.

- 1 x Hearing amplifier
- 3 x Earplugs in different sizes
- 2 x Type 13/PR48 batteries
- 1 x Box for storage
- 1 x These instructions for use







2. SIGNS AND SYMBOLS





The following symbols appear in these instructions for use:

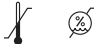
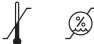

WARNING

Warning instruction indicating a risk of injury or damage to health.

 IMPORTANT	Safety note indicating possible damage to the unit/ accessory.
 Note	Note on important information.
	Observe the instructions for use
	Serial number
	Application part type B
	Disposal in accordance with the Waste Electrical and Electronic Equipment EC Directive – WEEE
	CE labelling This product satisfies the requirements of the applicable European and national directives.

	Manufacturer
<p>Storage/Transport</p> 	Permissible storage and transport temperature and humidity
<p>Operating</p> 	Permissible operating temperature and humidity
	Separate the packaging elements and dispose of them in accordance with local regulations.
	<p>Marking to identify the packaging material.</p> <p>A = Material code, B = Material number:</p> <p>1-7 = Plastics, 20-22 = Paper and cardboard</p>
	Separate the product and packaging elements and dispose of them in accordance with local regulations.

MD	Medical device
IP 41	Device protected against solid foreign objects ≥ 1 mm in diameter and greater, and against vertically falling drops of water
	Importer symbol

3. WARNING AND SAFETY NOTES



WARNING

- You must have your hearing checked by a doctor or qualified hearing care professional before using the hearing amplifier. The settings of the hearing amplifier should only be adjusted by a trained expert, for example an ENT specialist, an audiologist or a qualified hearing amplifier retailer.

- In the event of an existing or previous ear problem, you should consult your doctor before using the hearing amplifier.
- The device must NOT be used for patients suffering from an ear inflammation or infection.
- Do NOT use the hearing amplifier if you are suffering from an inflammation of the middle ear or ear canal.
- If you feel unwell or experience pain when wearing the hearing amplifier, stop using it immediately and contact your doctor.
- If your ear becomes inflamed or your skin irritated or you experience an increased accumulation of ear wax when wearing the hearing amplifier, stop using it immediately and contact your doctor.
- Stop using the hearing amplifier and seek medical attention if the following occurs:
 - Rash or eczema on areas of skin that come into contact with the hearing amplifier. (The hearing amplifier is made from a material that is kind to the skin. In rare cases, however, allergic reactions may occur that appear in the form of eczema.)
 - Use of the hearing amplifier results in discharge from the ear and/or necessitates ear treatment.

- Sudden, significant decrease in hearing ability.
- If parts of the hearing amplifier become stuck in the ear, seek medical attention immediately. Do not attempt to remove the parts yourself.
- At first, set the volume to a low setting and increase it gradually once you have become accustomed to the hearing amplifier.
- Do NOT set the volume control too high, as this may cause further damage to hearing over an extended period of time. This is particularly important to note, as the device achieves a high output power.
- Do NOT lend your hearing amplifier to others or use the hearing amplifiers of others, as there is a risk of hearing damage and infection.
- Do NOT pass on your hearing amplifier for use by other persons. The use of a hearing amplifier that was designed for someone else may cause hearing damage.
- The hearing amplifier is NOT suitable for use by children under 12 years of age.
- It is particularly difficult to diagnose hearing problems in children. Children should only be provided with a hearing amplifier following a thorough inspection by an ENT specialist.

- Keep the hearing amplifier, the accessories and the batteries away from children, as there is a risk of injury and choking.
- This device is NOT intended for use by people (including children) with restricted physical, sensory or mental skills or a lack of experience and/or a lack of knowledge, unless they are supervised by a person who has responsibility for their safety or they receive instructions from this person on how to use the device. Supervise children around the device to ensure they do not play with it.
- Do NOT use the hearing amplifier in potentially explosive and hazardous environments.
- Do NOT use the device in oxygen-rich environments and over an extended period of time.
- Please contact the manufacturer in the event of the following:
 - if you require assistance in the set-up, use or maintenance of the hearing amplifier; or
 - if the device behaves unexpectedly during operation or otherwise.
- If you have any doubts, do NOT use a damaged hearing amplifier; contact your retailer or the specified Customer Services address.

- Switch the device off immediately if it is faulty or not working properly.
- Do not attempt to open and/or repair the hearing amplifier yourself. Repairs may only be carried out by Customer Services or authorised retailers. Failure to comply will result in voiding of the warranty.



IMPORTANT

- Do NOT wear the hearing amplifier in the vicinity of strong electromagnetic fields or X-rays.
- Do NOT wear the hearing amplifier while bathing, showering or swimming.
- Protect the device from impacts, humidity, dirt, marked temperature fluctuations, direct sunlight and high levels of air humidity.
- High temperatures may develop in closed vehicles during summer. You should therefore never leave your hearing amplifier inside a vehicle.
- Do NOT drop the device or subject it to any shocks.
- If the hearing amplifier falls into water, dry it with a cloth and then have it inspected by your retailer.
- Never attempt to dry the hearing amplifier in a microwave, a tumble dryer or with a hair dryer. The hearing amplifier may otherwise become damaged.

- Do NOT use the hearing amplifier together with a mobile phone. (The radio waves of the mobile phone may cause background noise or a loss of volume.)
- Do NOT wear the hearing amplifier while applying cosmetics (e.g. make-up, hairspray, perfume or sun cream).
- Do NOT wear the hearing amplifier while undergoing short-wave therapy or medical treatments that are subject to strong radio frequency or magnetic fields.
- Take care when operating the switch and controller. Do NOT press too firmly.
- Do not insert any sharp objects into the microphone opening as this may damage the microphone.
- Do NOT touch the magnets of the hearing amplifier as this may damage the device.
- Do NOT touch the inside of the device. There are many sensitive parts that have been precisely configured. Under no circumstances should you poke at the inside of the hearing amplifier with a needle or similar object.

- Service your hearing amplifier at regular intervals. Make sure there are no foreign objects between the earplug and earpiece, as this could impair the sound.

4. INTENDED USE

The hearing amplifier is only to be used to help people to hear better. The device is only intended for the purpose described in these instructions for use. The manufacturer is not liable for damage resulting from improper or careless use.

5. DEVICE DESCRIPTION

The associated drawings are shown on page 3.

- | | |
|---|------------------------------|
| 1 Microphone | 4 Battery compartment |
| 2 Volume control | 5 Earpiece |
| 3 On/Off switch (“I” = switched on,
“O” = switched off) | 6 Earplug |

6. INITIAL USE

Remove the hearing amplifier from the packaging and check that the device and all accessories are included and not damaged. **A**

1. Open the battery compartment **4** on the hearing amplifier as shown.

Remove the protective film from the button cell battery included in delivery (type 13/PR48) and insert the battery into the battery compartment **4** as shown after 10 to 15 minutes. When inserting the battery, ensure that the correct polarity (+/-) is observed.

2. Close the battery compartment **4** again. Now connect your desired earplug **6** to the earplug **6**.

 Make sure the volume control **2** is initially set to the lowest setting before operating the hearing amplifier.

7. USAGE

1. Bring the hearing amplifier up to your ear as shown. **B**

Slowly insert the earplug **6** into your ear canal applying no force.

Make sure not to insert the earplug **6** too deeply into the ear canal. If the earplug **6** is not properly in place or feels uncomfortable, try a different earplug.

2. Move the On/Off switch **3** to “I” to switch on the hearing amplifier. Use the volume control **2** to adjust the volume to the desired level so that you can hear sounds clearly and distinctly.

-  • If you hear a slight whistling sound when wearing the hearing amplifier, check that your earplug **6** is fitted properly in your ear. If it is not snug enough, use a different earplug.
- The hearing amplifier does not heal an existing hearing impairment, but it does improve hearing and speech understanding.

8. CLEANING AND MAINTENANCE



IMPORTANT

- Always keep the hearing amplifier clean.
- Remove the batteries **4** from the device each time before cleaning.

- Please always treat the product with care and prevent the earplug **6** and acoustic opening from becoming obstructed with foreign matter. This impairs the function of the sound amplification.
- Clean the hearing amplifier and the earplugs **6** with a clean, dry cloth after each use. If they are very dirty, you can also moisten the cloth with a mild soapy solution. Never use abrasive, corrosive or solvent-based cleaning products.
- An elongated object or brush works well to remove any ear wax stuck in the earpiece **5**.
- Allow the hearing amplifier to dry fully after cleaning. Store the hearing amplifier in a safe, dry and clean place in the storage box.
- Under no circumstances should you hold the hearing amplifier under water, as this can cause liquid to enter and damage the hearing amplifier.

9. ACCESSORIES AND REPLACEMENT PARTS

Accessories and replacement parts are available from the corresponding listed service address under the stated material number.

Designation	Item number and/or order number
3 x Earplugs, HA50	163.940

10. WHAT IF THERE ARE PROBLEMS?

Problem	Possible causes
No sounds can be heard from the hearing amplifier.	<ul style="list-style-type: none">- Hearing amplifier is not switched on. 3- Battery is not inserted correctly (polarity). 4- Battery flat.- Microphone 1 is dirty.- Hearing amplifier is damaged.

Problem	Possible causes
The tone is very weak and faint.	<ul style="list-style-type: none"> - Volume setting 2 on hearing amplifier is too low. - Battery is almost flat. - Earplug 6 is dirty. - Microphone 1 is dirty. - The earpiece 5 may be damaged. - Battery compartment 4 not securely closed. Close the battery compartment.

Problem	Possible causes
Feedback sound is too loud.	<p>The earpiece 5 of the hearing amplifier does not fit correctly in the ear, meaning that the hearing amplifier may not function correctly in certain circumstances or an unpleasant whistling sound (acoustic feedback) can be heard. This can be prevented in the following ways:</p> <ul style="list-style-type: none"> - Switch off 3 the hearing amplifier and insert it into the ear. Ensure that it is inserted correctly. B - If the earpiece does not fit correctly in the ear, try it again with another attachment. It is recommended to use an earpiece that fits correctly. If you have any doubts, please contact Customer Services.

11. DISPOSAL

Notes on handling batteries

- If your skin or eyes come into contact with battery fluid, rinse the affected areas with water and seek medical assistance.
- Choking hazard! Small children may swallow and choke on batteries. Store the batteries out of the reach of small children.
- Observe the plus (+) and minus (-) polarity signs.
- If a battery has leaked, put on protective gloves and clean the battery compartment with a dry cloth.
- Risk of explosion! Never throw batteries into a fire.
- If the device is not to be used for a relatively long period, take the batteries out of the battery compartment.
- Do not use rechargeable batteries.
- Do not disassemble, open or crush the batteries.
- If you are not using the hearing amplifier, switch it off, remove the batteries and store it in the storage box.
- Batteries must NOT be short-circuited.

- Normal batteries must NOT be charged (risk of explosion)!

Battery disposal

- The empty, completely flat batteries must be disposed of through specially designated collection boxes, recycling points or electronics retailers. You are legally required to dispose of the batteries.
- The codes below are printed on batteries containing harmful substances:
Pb = Battery contains lead,
Cd = Battery contains cadmium,
Hg = Battery contains mercury.



General disposal

For environmental reasons, do not dispose of the device in the household waste at the end of its useful life. Dispose of the unit at a suitable local collection or recycling point. Dispose of the device in accordance with EC Directive – WEEE (Waste Electrical and Electronic Equipment). If you have any questions, please contact the local authorities responsible for waste disposal.



12. TECHNICAL SPECIFICATIONS

Max. output level:	128 dB \pm 4 dB
Sound pressure level:	129.4 dB in accordance with IEC 60118-7
Sound amplification:	40 dB \pm 5 dB
Overall harmonic distortion:	$\leq 5\%$ @ 1600Hz
Frequency range:	100~6000 Hz
Input noise:	≤ 30 dB
Voltage:	1.4 V $\overline{\overline{=}}$
Power supply:	≤ 5 mA
Operating conditions:	Temperature: -10°C ~ +40°C
	Relative humidity: 30% ~ 75%
	Atmospheric pressure: 700 ~ 1600 hPa
Storage and transportation conditions	Temperature: -10°C ~ +55°C
	Relative humidity: 10% ~ 90%
	Atmospheric pressure: 500 ~ 1600 hPa

The serial number is located on the device or in the battery compartment.

13. WARRANTY / SERVICE

Further information on the guarantee and guarantee conditions can be found in the guarantee leaflet supplied.

 Beurer GmbH • Söflinger Str. 218 • 89077 Ulm, Germany • www.beurer.com
www.beurer-gesundheitsratgeber.com • www.beurer-healthguide.com



Beurer UK Ltd., Suite 16, Stonecross Place, Yew Tree Way
WA3 2SH Golborne, United Kingdom

CE 0483