

GL 49 mg/dL  
& mmol/L

**beurer**  
medical



Coloured target scale and display to help you to interpret the measurement



Electronic diary available on PC

Transfer of the values via *Bluetooth®* to the "beurer HealthManager" app or via USB cable to a PC

Large, backlit display with self-explanatory user menu

Easy to use: handy test strips, easy measurement marking for optimised diabetes management: before eating, after eating, general marking

Blood volume check: measurement only possible with sufficient sample of blood

Starter set: GL 49 measuring device, LD 04 lancing device, 10 lancet needles, 10 test strips, USB cable, case, instructions for use, brief instructions, blood glucose diary

Ketone warning on display

GlucoMemory software in German and English: simple overview of results and trends in target range

Including "beurer HealthManager" app for download

"beurer HealthManager" software for download free of charge at: [www.beurer.com](http://www.beurer.com) > SERVICE > Download

Required volume of blood: 0.5 microlitres

Duration of measurement: approx. 5 seconds

Code-free

Measured value memory for 900 measurements with date, time and measurement marking

Calculating the average value for 7, 14, 30 or 90 days for  
- all measurements                      - marked measurements

Blood sample: fresh whole blood (capillary) or venous whole blood

Plasma-calibrated

Measurement range: 20 – 630 mg/dL / 1,1 – 35,0 mmol/L

Fully fulfils EN ISO 15197:2015 (compulsory since May 2016)

Automatic switch-off

Product dimensions (L/H/D): 95 x 53 x 15 mm



GL 49 mg/dL  
& mmol/L

**beurer**  
medical



## CONNECTION

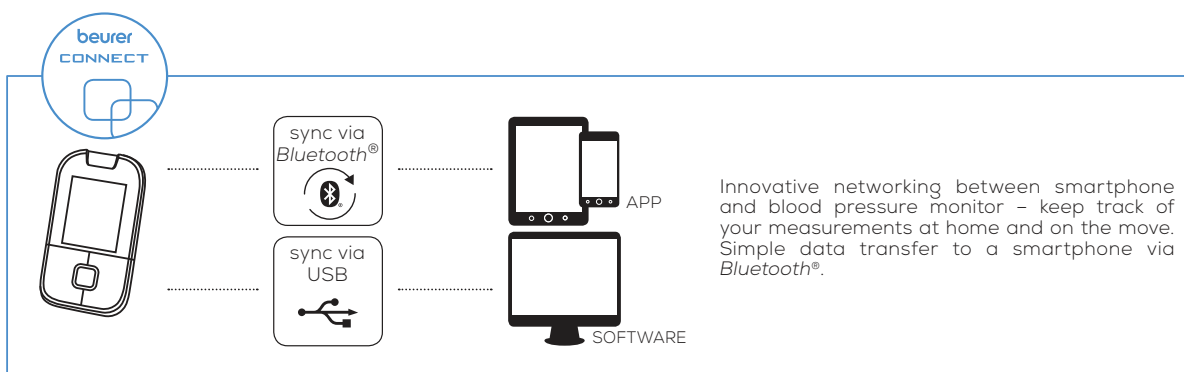

Synchronisation with

- iOS ≥ 12.0
- Android™ ≥ 8.0
- Bluetooth® ≥ 4.0



List of supported devices

\* tested online application "beurer HealthManager" Cloud

GL49\_2020-04-27\_03\_EN\_BEU Subject to errors and changes

The Bluetooth® word mark and logos are registered trademarks owned by Bluetooth SIG, Inc. and any use of such marks by Beurer GmbH is under license. Other trademarks and trade names are those of their respective owners.

Apple and the Apple logo are trademarks of Apple Inc., registered in the U.S. and other countries. App Store is a service mark of Apple Inc., registered in the U.S. and other countries.

Google Play and the Google Play logo are trademarks of Google LLC.

Android is a trademark of Google LLC.