

beurer

LV 500 PureFlow



EN 2-in-1 air purifier and fan
Instructions for use

CE

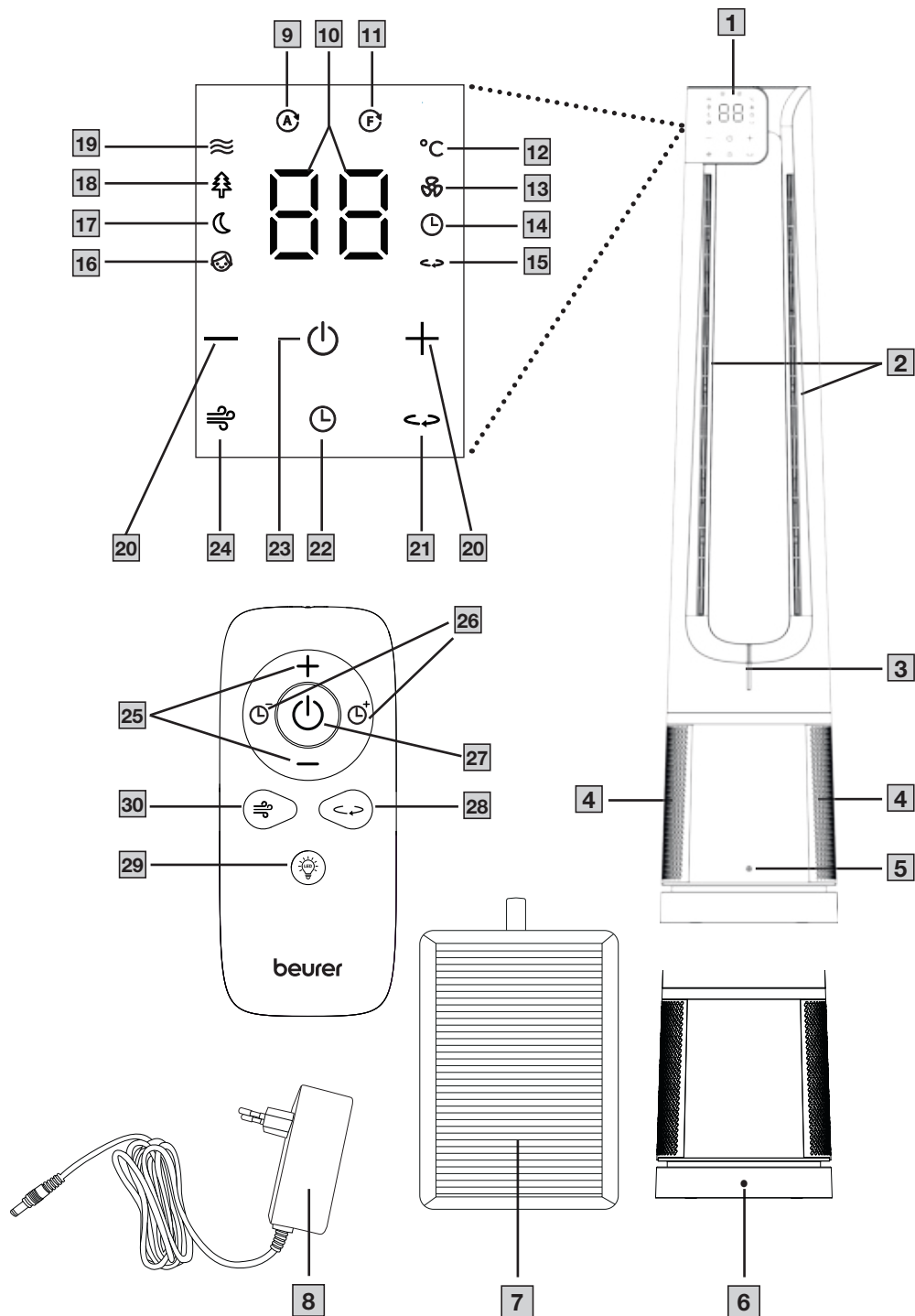



Read these instructions for use carefully. Observe the warnings and safety notes. Keep these instructions for use for future reference. Make the instructions for use accessible to other users. If the device is passed on, provide the next user with these instructions for use.

CONTENTS

1. Included in delivery	3	6.6 Setting the oscillation.....	7
2. Signs and symbols	3	6.7 Switching off the device.....	7
3. Intended Purpose	4	6.8 Changing the filters.....	7
4. Warnings and safety notes	4	7. Cleaning and maintenance.....	7
5. Device description.....	5	7.1 Cleaning the filters	7
6. Usage	6	7.2 Cleaning the housing	7
6.1 Setting up the device	6	8. Accessories and/or replacement parts	7
6.2 Switching on the device.....	6	9. What if there are problems?	7
6.3 Selecting the fan speed	6	10. Disposal.....	8
6.4 Selecting the ventilation modes.....	6	11. Technical specifications	8
6.5 Setting the timer	6	12. Guarantee.....	8

1. INCLUDED IN DELIVERY

Check that the exterior of the cardboard delivery packaging is intact and make sure that all contents are present. Before use, ensure that there is no visible damage to the device and accessories and/or replacement parts, and that all packaging material has been removed. If you have any doubts, do not use the device and contact your retailer or the specified Customer Service address.

- 1 air purifier and fan 2-in-1
- 1 remote control
- 2 combi filters (pre-filter, HEPA filter class H13, activated carbon)
- 1 CR2025 button cell battery
- 1 mains adapter

2. SIGNS AND SYMBOLS

The following symbols are used on the device, in these instructions for use, on the packaging and on the type plate for the device:

⚠ DANGER

Indicates an imminent danger. If it is not avoided, death or serious injury will occur.

⚠ WARNING

Indicates a potentially impending danger. If it is not avoided, there is a risk of death or serious injury.

⚠ CAUTION

Indicates a potentially imminent hazard. If it is not avoided, slight or minor injuries may result.

NOTICE

Indicates a potentially harmful situation. If it is not avoided, the device or something in its vicinity may be damaged.



Do not dispose of batteries containing hazardous substances with household waste



Manufacturer



CE labelling

This product satisfies the requirements of the applicable European and national directives.



Separate the product and packaging elements and dispose of them in accordance with local regulations.



Marking to identify the packaging material. A = Material code, B = Material number: 1-7 = Plastics, 20-22 = Paper and cardboard



Protection class II device

The device is double-insulated and, therefore, is in protection class 2



The products demonstrably meet the requirements of the Technical Regulations of the EAEU



United Kingdom Conformity Assessed Mark



Importer



For indoor use only



Keep out of reach of children



Batteries must not be disposed of with household waste



Direct current



Product information







Note on important information

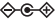

Read the instructions



The electronic device must not be disposed of with household waste

	Alternating current
	Polarity of d.c. power connector
	Safety isolating transformer, short-circuit proof
	Energy efficiency level 4
	Switch mode power supply unit
	Protected against solid foreign objects 12.5 mm in diameter and larger
$t_a=45^{\circ}\text{C}$	Rated ambient temperature
	Do not use the power adapter if the plug is damaged.

3. INTENDED PURPOSE

This device is intended exclusively for circulating and cleaning the air indoors.

The device is intended for private use only.

This device must only be used for the purpose for which it was designed and in the manner specified in the instructions for use. Any form of improper use can be dangerous. Any other use not recommended by the manufacturer may result in fire, electric shock or personal injury. The manufacturer is not liable for damage resulting from improper or careless use.

4. WARNINGS AND SAFETY NOTES

⚠ WARNING

- The device is only intended for domestic/private use, not for commercial use.
- This device may be used by children over the age of 8 and by people with reduced physical, sensory or mental skills or a lack of experience or knowledge, provided that they are supervised or have been instructed on how to use the device safely, and are fully aware of the consequent risks of use.
- Children must not play with the device.
- Cleaning and user maintenance must not be performed by children unless supervised.

- Disconnect the device from the power supply during cleaning.
- Clean the device using only the methods specified. Under no circumstances must liquid enter the fan unit.
- Do not use any solvent-based cleaning products.
- If the mains connection cable of this device is damaged, it must be disposed of. If it cannot be removed, the device must be disposed of.

⚠ WARNING

- If you suffer from a severe respiratory or lung disease, consult your doctor before using the device.
- Danger of suffocation! Keep packaging material away from children.

⚠ WARNING

Electric shock

As with every electrical device, use this device carefully and cautiously, in order to avoid hazards due to electric shock.

- Do not use the device if there is visible damage to the device or accessories (e.g. if the cable or mains adapter is damaged, if the motor fan does not rotate, after a malfunction of the device, or if it has been dropped or damaged in any way. In any of these cases, contact Customer Services).
- Only operate the device at the voltages indicated on the device (the type plate is located on the bottom of the device).
- Only operate the device with the mains adapter provided and at the mains voltage specified on the mains adapter.
- Do not operate the device during a storm.
- In the event of defects or operational faults, switch the device off immediately and disconnect it from the mains socket.
- Do not pull on the mains cable or on the device to disconnect the mains adapter from the socket.
- Never hold or carry the device by the mains adapter. Keep the cable away from hot surfaces.
- Never hold or carry the device by the display.
- Always switch off the device before disconnecting the mains adapter.
- Never unplug the mains adapter with wet or damp hands.
- To avoid the risk of fire or electric shock, plug the device directly into a proper power outlet.
- In order to protect persons against electrical hazards, DO NOT immerse the device in water or other fluids. Do not use near water.
- Children are not able to assess the dangers associated with the use of electrical devices. Therefore, children must always be supervised when they are near the device.
- Always unplug the mains adapter of the device before moving it, opening the air intakes, changing or cleaning the filters, or when the device is not in use.
- Do not place any objects in device openings or in rotating parts. Ensure that the moving parts can move freely at all times. Never drop objects into the openings of the device.
- Do not operate the device outside.
- Never block the air intake or air outlet or grilles/outlets. Do not place the device on a soft surface such as a bed or sofa, as this

could cause the device to tip over and the air intake or outlet to become blocked.

- DO NOT place any objects on the device.
- DO NOT cover the cable with carpets, runners or anything similar.
- DO NOT run the cable under furniture or equipment.
- DO NOT run the cable in high traffic areas.
- Run the cable so that it does not pose a trip hazard.
- DO NOT attempt to repair or adjust any electrical or mechanical functions on this device. Failure to follow this rule shall void your guarantee. Apart from the filters, there are no user-serviceable parts inside the device. Any maintenance work must be carried out by qualified personnel only.
- To reduce the risk of fire or electric shock, do not use this device with a solid-state speed controller (dimmer).
- Ensure that the openings of the device and the mains cable do not come into contact with water, steam, or other liquids.
- Never pick up a device that has fallen into water. Unplug the mains adapter immediately.

⚠ WARNING

Risk of fire!

There may be a risk of fire if the device is used improperly or these instructions for use are ignored!

- Never operate the device underneath a cover, such as a blanket, pillow, etc.
- Never use the device near petrol or other highly flammable substances.
- To reduce the risk of fire, do not place the cable near heating coils, heated pads, ovens or radiators.
- Do not operate the device in close proximity to flammable or explosive gas mixtures.
- Keep the device away from sources of heat, as the housing could melt and trigger a fire.

⚠ WARNING

Repairs

- Only specialist personnel may perform repairs on electrical devices. Improper repairs may put users in significant danger. For repairs, please contact Customer Services or an authorised retailer.
- Do not open the fan unit.

NOTICE

Handling

- After each use and before each time it is cleaned, switch off the device and pull the mains adapter out of the socket.
- Do not place any objects on the device.
- Do not expose the device to high temperatures.
- Protect the device against sunlight and impact, and do not drop it.
- Never shake the device.
- Place the device on a stable, level and dry surface.
- Ensure that the cable does not pose a trip hazard.

Notes on handling batteries

⚠ WARNING

- **Risk of explosion! Risk of fire!** Failure to comply with the following points can result in personal injury or cause overheating, leakage, venting, breakage, explosion, or fire on the battery.
- This device contains non-rechargeable batteries which must not be charged.
- Do not throw batteries into a fire.
- Never charge, forcibly discharge, heat, disassemble, open, crush, deform, encapsulate, or modify batteries.

- Never short-circuit batteries or battery compartment contacts.
- Protect the batteries from direct sunlight, rain, heat, and water.
- Exposure of batteries to an environment with extremely high temperatures or an extremely low air pressure may result in explosion or leakage of flammable liquids and gases.
- Dispose of defective and discharged batteries immediately and properly (see chapter on disposal).
- Do not use modified or damaged batteries.
- Always select the correct battery type.
- Always insert the batteries correctly, taking into account the polarity (+ / -).
- Never mix batteries of different manufacturers, capacities (new and used), size, or type within a device.
- If a battery has leaked, put on protective gloves and clean the battery compartment with a dry cloth.
- If fluid from a battery comes into contact with your skin or eyes, wash the affected areas with water and seek medical assistance.
- **Choking hazard!** Keep batteries out of the reach of children. Seek medical attention immediately if swallowed. Swallowing them may cause burns, severe internal injuries, and death.
- Never allow children to replace batteries without adult supervision.

⚠ CAUTION

- Store batteries in a well-ventilated, dry, and cool place in a non-conductive container in which the batteries cannot be short-circuited to each other or by other metal objects.
- Keep batteries clean and dry.
- Keep batteries away from water.
- If the device is not going to be used for a long period of time, remove the batteries from the battery compartment.

NOTICE

- Do not use rechargeable batteries.

5. DEVICE DESCRIPTION

The associated drawings are shown on page 2.

Device

- 1 Display with control panel
- 2 Air outlet
- 3 Ambient air indicator
- 4 Air intake
- 5 PM 2.5 fine dust particle sensor
- 6 Connection socket for mains adapter
- 7 Filter
- 8 Mains adapter

Display with control panel

- 9 Automatic symbol (automatic mode is active)
- 10 7-segment indicator
- 11 Filter indicator (lights up when the filters need to be replaced)
- 12 Temperature symbol
- 13 Fan setting symbol

- 14** Timer symbol
- 15** Oscillation symbol
(lights up when the rotation is active)
- 16** Child symbol (lights up when child mode is on)
- 17** Sleep symbol (lights up when sleep mode is on)
- 18** Nature mode (lights up when nature mode is on)
- 19** Basic mode (lights up when basic mode is on)
- 20** +/- buttons
(to adjust the fan setting and timer)
- 21** Oscillation button
(to switch the rotation on/off)
- 22** Timer button
(to activate the timer)
- 23** ON/OFF button
(to switch the device on/off)
- 24** Mode button
(to switch between modes)

Remote control

- 25** +/- buttons
(to adjust the fan setting)
- 26** Timer button
(to adjust the timer)
- 27** ON/OFF button
(to switch the device on/off)
- 28** Oscillation button
(to switch the rotation on/off)
- 29** LED button
(to switch all indicator lights on/off)
- 30** Mode button
(to switch between modes)

6. USAGE

6.1 Setting up the device

1. Open the cardboard packaging.
2. Carefully remove the device from the cardboard packaging.
3. Remove all the packaging materials and the transport securing tapes from the device. Then check the device for damage.
4. Remove the filters **7** from the device (see "Changing the filters" section) and take them out of the plastic covering film. Then re-insert the filters **7** into the device.
5. Place the device on a level and stable surface to prevent vibrations and noise.
6. Set up the device in your immediate vicinity. Leave a clearance of at least 30 cm on all sides around the device.
7. Pull out the battery strip on the remote control.



⚠ CAUTION

Make sure that the air intake **4** and air outlet **2** are never blocked.

6.2 Switching on the device

1. Plug the mains cable of the mains adapter **8** into the connection socket **6** on the rear of the device. Only then may the mains adapter be plugged into the socket. The ON/OFF button **23** appears in the control panel.
2. To switch on the device, press the ON/OFF button (either on the remote control **27** or on the control panel **23**). A beep sounds when the device is switched on. After being switched on, the device runs automatically at the lowest fan speed setting and in basic mode **19**. The ambient air indicator **3** switches on automatically. After approx. 30 seconds, the ambient air indicator **3** will indicate the current air quality using a colour, which corresponds to the concentration of particles in the ambient air around the device.

Ambient air indicator colour	Air quality	PM 2.5 value in µg/m³
blue	good	≤ 12
yellow	acceptable	12.1 – 55.4
red	very poor	≥ 55.5

6.3 Selecting the fan speed

The device has 12 different fan speeds, which can be set using the +/- buttons (either on the remote control **25** or on the control panel **20**). The currently set fan speed appears on the display.

6.4 Selecting the ventilation modes

The device has five different modes (basic, nature, child, sleep and automatic, which cannot be set manually).

1. Use the Mode button (either on the remote control **30** or on the control panel **24**) to set your preferred fan speed. The currently set mode is shown on the display.

	Basic mode 19 (Continuous air flow)
	Nature mode 18 (Simulates winds as they are experienced in nature)
	Sleep mode 17 (Starts at fan speed 12, switches to fan speed 6 after 10 minutes and to fan speed 3 after another 10 minutes, display and indicator light switch off after 10 seconds. Press any button to reactivate.)
	Child mode 16 (Starts at fan speed 6 and switches to fan speed 3 after 10 minutes, oscillation on, timer set to 3 hours, display and indicator light switch off after 10 seconds. Press any button to reactivate.)
	Automatic mode 9 (Automatically adjusts the fan speed in line with the ambient air quality)

6.5 Setting the timer

The device has an optional timer (1 to 12 hours). After the set time has elapsed, the device switches off automatically.

1. To set a timer, use the timer button **22** on the control panel and select the duration using the + / - buttons **20**. Alternatively, the timer can also be set using the timer buttons **26** on the remote control.
2. If the TIMER button is not pressed for 3 seconds, the currently set timer time is confirmed and shown on the display. To end the timer prematurely, set the timer to 0 hours.

6.6 Setting the oscillation

To optionally set the device to slowly rotate back and forth when in use, press the oscillation button (either on the remote control 28 or on the control panel 21). Pressing the oscillation button again stops the rotation and the device stays in its new position.

6.7 Switching off the device

To switch off the device, press the ON/OFF button (either on the remote control 27 or on the control panel 23). All indicators on the display go out. The ON/OFF button 23 remains illuminated. When the device is switched off, it returns to its initial/central position. If the device is not going to be used for an extended period of time, disconnect the mains adapter from the socket.

6.8 Changing the filters

Change the filters 7 after 6 months at the latest. The filter indicator 11 will light up automatically after 1440 operating hours.

To change the filters, proceed as follows:

- 1. Press the ON/OFF button (either on the remote control 27 or on the control panel 23) to switch off the device.
- 2. Disconnect the device from the socket.
- 3. Fold out the two air intake covers 4 as shown.
- 4. Dispose of the old filters properly (see section "Disposal").
- 5. Insert the two new filters as shown.
- 6. Put the two air intake covers 4 back in as shown.
- 7. Connect the device to a suitable socket.
- 8. Press the ON/OFF button once to switch on the device.
- 9. Press and hold the oscillation button 28 on the activated device for 5 seconds until the filter indicator 11 goes out. The filter indicator will now not light up again automatically until 1440 operating hours have passed.

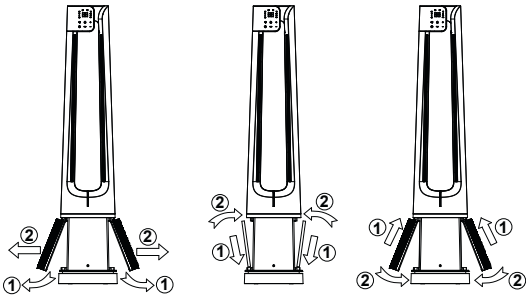

7. CLEANING AND MAINTENANCE

⚠ WARNING

Before cleaning, always ensure that the device has been unplugged! Make sure that no moisture gets inside the device.

7.1 Cleaning the filters

- Regular cleaning of the filters 7 (once a month) is required to ensure hygienic and fault-free operation. Clean the outside of the filters with the brush attachment of a vacuum cleaner or a dry cloth.

NOTICE

- The filters should be changed after 1440 operating hours (see "Changing the filters" section). The filters cannot be washed.

7.2 Cleaning the housing

- Do not use solvents, other aggressive cleaning/scrubbing agents, or alcohol, as these substances could damage the surface. Do not use any abrasive or hard objects for cleaning.
- If there is heavy dirt, clean the housing using a slightly damp cloth (dampened with water or a mild cleaning solution).
- If the device is not going to be used for an extended period of time, clean the device and store it in its original packaging in a dry environment and without weighing it down.

8. ACCESSORIES AND/OR REPLACEMENT PARTS

To purchase accessories and/or replacement parts, visit www.beurer.com or contact the corresponding service address (as per the service address list) for your country. Accessories and/or replacement parts are also available from retailers.

Designation	Item number and/or order number
2x combi filters (pre-filter, HEPA filter class H13, activated carbon)	110.190

9. WHAT IF THERE ARE PROBLEMS?

Problem	Possible cause	Solution
The device cannot be switched on using the control panel.	The device is not plugged in.	Connect the device to a suitable socket.
	The device is faulty.	Contact Customer Services at: www.beurer.com
The device cannot be switched on using the remote control.	The battery in the remote control is flat.	Insert a new battery into the remote control.
	The device is faulty.	Contact Customer Services at: www.beurer.com
	The device is not plugged in.	Connect the device to a suitable socket.
The device is very loud	The device is standing on an unstable and uneven surface.	Place the device on a stable and level surface.
	The filter is dirty.	Clean the filter (see section "Cleaning and maintenance").
Insufficient air flow.	The air intake/air outlet is blocked.	Ensure that the air intake/air outlet is not blocked.
	The mains adapter is not connected to the socket and/or is not switched on.	Connect the mains adapter and switch on the device.
Control panel does not light up/nothing displayed.	The device is in sleep or child mode.	Press any button to re-activate the display with the control panel.

10. DISPOSAL

For environmental reasons, do not dispose of the device in household waste at the end of its service life. Dispose of the device at a suitable local collection or recycling point in your country. Observe the local regulations for material disposal. Dispose of the device in accordance with EC Directive – WEEE (Waste Electrical and Electronic Equipment). If you have any questions, please contact the local authorities responsible for waste disposal. You can obtain the location of collection points for old devices from the local authorities.



Used, completely flat batteries must be disposed of via specially designated collection boxes, recycling points or electronics retailers. You are legally required to appropriately dispose of the batteries. The codes below are printed on batteries containing harmful substances:

- Pb = battery contains lead
- Cd = battery contains cadmium
- Hg = battery contains mercury



Dispose of the filters in a separate disposable bag. Then wash your hands thoroughly. Follow the advice of your local health authorities concerning how to handle potentially infected surfaces.

11. TECHNICAL SPECIFICATIONS

Model	LV 500 PureFlow
Power supply	<u>Mains adapter</u> Input: 100-240 V~, 50-60 Hz, 2.0 A Output: 24.0 V ---, 2.0 A <u>Device</u> Input: 24.0 V ---, 2.0 A, 48 W
Power consumption	Low fan speed = approx. 20 W Medium fan speed = approx. 35 W High fan speed = approx. 48 W
Dimensions (L x W x H)	111 x 23 x 23 cm

Weight	Remote control: approx. 30 g Device: approx. 5.0 kg
Battery for remote control	1 x CR2025
Volume	approx. 59 dB (at highest level of operation)
Permissible operating conditions	+5°C to +40°C, ≤ 90% relative humidity (non-condensing)
Protection class	2
Average efficiency during operation	89.51 %
Efficiency at low load (10%)	87.12 %
No-load power consumption	0.096 W
ERP directive	See last page of these instructions for use

12. GUARANTEE

Further information on the guarantee and guarantee conditions can be found in the guarantee leaflet supplied.

Item	Symbol	Tested	Unit
Maximum fan flow rate	F	33.60	m³/min
Fan power input	P	38.00	W
Service value	SV	0.90	(m³/min)/W
Standby power consumption	P _{SB}	0.30	W
Seasonal electricity consumption	Q	12.50	kWh/a
Fan sound power level	L _{WA}	64.20	dB(A)
Maximum air velocity	c	2.70	m/s
Measurement standard for determining the service relationship	EN IEC 60879:2019		

 Beurer GmbH • Söflinger Str. 218 • 89077 Ulm, Germany
www.beurer.com

 BEURER UK Ltd.
Suite 16, Stonecross Place, Stonecross Lane North
WA3 2SH Llowten
United Kingdom

