

# beurer

**SI 31**



**EN** Steam Vaporiser  
Instructions for use

**CE**

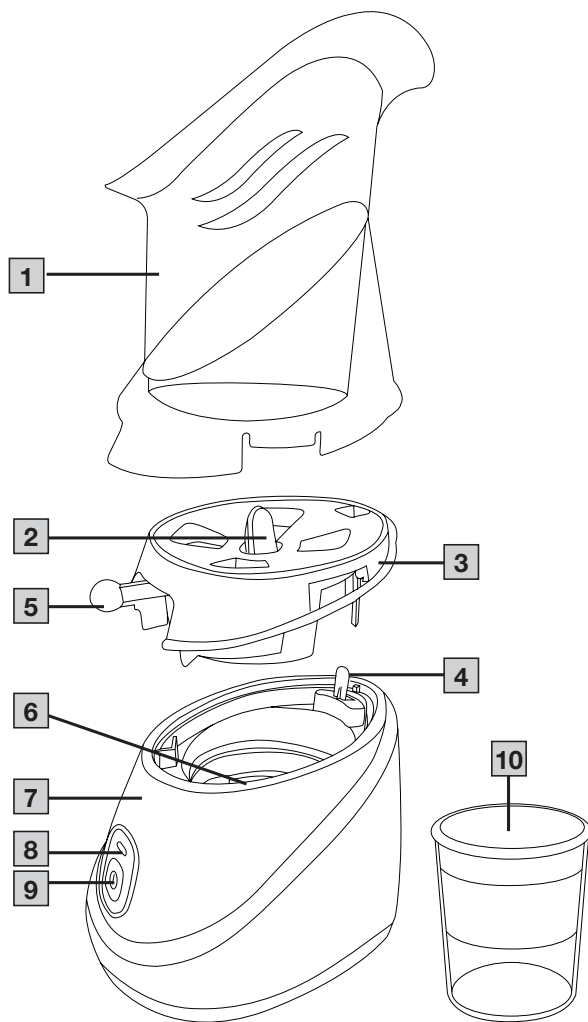

# ENGLISH



Read these instructions for use carefully and keep them for later use. Make them accessible to other users and note the information they contain.

## CONTENTS

1. Included in delivery .....	3
2. Signs and symbols .....	3
3. Intended use .....	3
4. Warnings and safety notes .....	4
5. Device description .....	5
6. To use .....	5
7. Cleaning and maintenance .....	6
8. Accessories and/OR replacement parts .....	7
9. What if there are problems? .....	7
10. Disposal .....	7
11. Technical specifications .....	7
12. Warranty/ service .....	7

## 1. INCLUDED IN DELIVERY

Check that the exterior of the cardboard delivery packaging is intact and make sure that all contents are present. Before use, ensure that there is no visible damage to the device or accessories and that all packaging material has been removed. If you have any doubts, do not use the device and contact your retailer or the specified Customer Service address.

- Steam Vaporiser
- Measuring Cup
- Inhaler Attachment
- These instructions for use

## 2. SIGNS AND SYMBOLS

The following symbols are used on the device, in these instructions for use, on the packaging and on the type plate for the device:

	<b>Warning</b> Warning instruction indicating a risk of injury or damage to health
	<b>Important</b> Safety note indicating possible damage to the device/ accessory
	<b>Product information</b> Note on important information
	Read the instructions
	Protection class II device

	Manufacturer
	<b>CE labelling</b> This product satisfies the requirements of the applicable European and national directives.
	Marking to identify the packaging material. A = Material code, B = Material number: 1-7 = Plastics, 20-22 = Paper and cardboard
	Batch code
	Separate the product and packaging elements and dispose of them in accordance with local regulations.
	The electronic device must not be disposed of with household waste
	Item number
	Importer
	Temperature limit
	Humidity limitation

## 3. INTENDED USE

This device has been specially developed to generate steam by evaporation and humidify the ambient air, skin and upper airways. Once it has been properly prepared, the device can be used again. Preparation involves exchanging the Inhaler Attachments and disinfecting the surface of the device using a conventional disinfectant.

Please note that the Inhaler Attachments should always be exchanged if the device is used by more than one person. We recommend that you replace the Inhaler Attachment after one year.

## 4. WARNINGS AND SAFETY NOTES

### WARNING

- Before use, ensure that there is no visible damage to the device or accessories. If you have any doubts, do not use the device and contact your retailer or the specified Customer Service address.
- In the event of device faults, please see Chapter "What if there are problems?".
- This is not a medical device. Always consult your doctor if you require medical treatment.
- This device may be used by children over the age of 8 and by people with reduced physical, sensory or mental skills or a lack of experience or knowledge, provided that they are supervised or have been instructed on how to use the device safely, and are fully aware of the consequent risks of use.
- Children must not play with the device.
- Please observe the general hygiene measures when using the steam vaporiser.
- If the device does not work properly, or you feel unwell or experience pain, stop using it immediately.
- Do not position your face too close to the Inhaler Attachment, otherwise the hot steam could cause burn injuries. Close your eyes during the treatment and protect heat-sensitive zones.
- Do not place your face directly on the Inhaler Attachment, there is a risk of the appliance tipping over and a risk of skin burns.
- Never open the device (remove the cover) while it is in operation. Allow the device to cool down first. Otherwise, you may get burnt.
- Do not operate the device in the presence of flammable gases or if there is a high oxygen concentration.
- Never leave the device unattended while in use.
- The device must be switched off and the plug pulled out before every cleaning and/or maintenance procedure.
- Keep packaging material away from children (risk of suffocation).
- To avoid the risk of entanglement and strangulation, store the cable out of the reach of small children.
- Do not use any additional parts that are not recommended by the manufacturer.
- The device must only be connected to the mains voltage that is specified on the type plate.
- Never submerge the device in water and do not use it in the bathroom. Under no circumstances may liquid enter the device.
- Protect the device from heavy impact.
- Never touch the mains cable with wet hands, as you could get an electric shock.
- Do not pull the mains plug out of the socket using the mains cable.

- Do not crush or bend the mains cable, pull it over sharp-edged objects or leave it dangling down, and protect it from sources of heat.
- We recommend that the power cable is completely unrolled to avoid dangerous overheating.
- If the mains connection cable of this device is damaged, it must be replaced by the manufacturer, its customer service department or a similarly qualified person to avoid any risks.
- If the device is opened, there is a risk of electric shock. Disconnection from the power supply network is only guaranteed if the mains plug is unplugged.
- If the device has been dropped, exposed to high levels of moisture or suffered any other damage, it must no longer be used. If in doubt, contact Customer Services or the retailer.
- The steam vaporiser may only be operated with the appropriate accessories.
- For hygiene reasons, it is essential that every user uses their own accessories.

### IMPORTANT

- Power cuts, sudden interference or other unfavourable conditions could lead to the device becoming inoperable. For this reason, we recommend that you have a spare device at your disposal.
- Never use the device with extension cables.
- Never store the device or the power cable near to sources of heat.
- Do not use the device in a room in which a spray has previously been used. Air the room before carrying out the treatment.
- Never insert anything into the vents.
- Never block the vents.
- Never use the device when the water reservoir is empty.
- Always disconnect the mains plug from the mains socket after use.
- Store the device in a location protected against climatic influences. The device must be stored in the environmental conditions specified.

## PROTECTION

- The device has a protection fuse. This may only be replaced by authorised specialist personnel.
- The device also has a thermal fuse, which switches the steam vaporiser off if it overheats. In the event of overheating, the light on the ON/OFF button does not turn off. If this happens, proceed as follows:
  1. Switch off the device first.
  2. Pull the mains plug out of the socket.
  3. Wait for at least 30 minutes until the device has cooled down completely.
  4. Switch the device back on and check whether it is working properly again. If it does, you can continue using the device

again. If it does not, please contact Customer Services or an authorised retailer.

- Do not operate the appliance without water. Unplug this product before filling. Fill with water only. Never add any medications or inhalant liquids to the Water Reservoir. Do not overfill.
- Never move or lift the inhaler while it is in use. Steam is produced by boiling water; tilting can cause water spill and possible burns.
- The appliance should always be placed on a firm, flat water-proof surface. Be sure the appliance is in a stable position and the power cord is out of the way to prevent the unit from being tipped over.
- Never use appliance while sleepy or drowsy.

## General notes

### IMPORTANT

- The device is suitable only:
  - for use on people,
  - for the purpose for which it was developed and as specified in these instructions for use.
- Any form of improper use can be dangerous.
- In the event of an acute emergency, providing first aid must take top priority.
- Only use water with low chalk content or distilled water. Other liquids may potentially cause a fault in the steam vaporiser.
- This device is not intended for commercial or clinical use; it is designed exclusively for self-treatment in a private home. In addition, other liquids can cause undesirable behavior, e.g. splashing of the liquid, which in turn can lead to skin burns.

## Prior to initial use

### IMPORTANT



- Remove all packaging material before using the device.
- Protect the device against dust, dirt and humidity and never cover the device while it is in use.
- Do not operate the device in a very dusty area.
- Switch the device off immediately if it is faulty or not working properly.
- The manufacturer is not liable for damage resulting from improper or incorrect use.

## Repairs

-  • Under no circumstances should you open or repair the device yourself, as faultless functionality can no longer be guaranteed thereafter. Failure to comply with this instruction will void the warranty.
- The device is maintenance-free.
- For repairs, please contact Customer Services or an authorised retailer.

## 5. DEVICE DESCRIPTION

The associated drawings are shown on page 2.

-  Inhaler Attachment
-  Vapor Pad Holders
-  Vent Assembly
-  Latching Clip
-  Flow Lever
-  Water Reservoir
-  Base
-  Indicator Light
-  On/Off Button
-  Measuring Cup

## 6. TO USE

-  Follow the instructions in the Chapter “Cleaning and maintenance” before using the device for the first time or if it has not been used for an extended period.

1. Remove the device from the packaging. Ensure that there is a mains socket close to the set-up area.
2. Fully extend the power cord. Place Inhaler on a flat, stable, water-resistant surface for use.
3. Remove the Inhaler Attachment by lifting it straight up.
4. Press the Latching Clip and lift the Vent Assembly straight up to separate it from the Base.
5. Fill the Water Reservoir with clean, clear water up to the MAX mark (1.35 fl oz /40 ml). Do not overfill. Use with water only. Do not add any medication or inhalant liquids to the Water Reservoir.
6. Attach the Vent Assembly. Guide the Latching Clip through the opening provided and press the Vent Assembly onto the base until the Latching Clip clicks into place.
7. Attach Inhaler Attachment.
8. Connect the power cord to an electrical outlet.
9. Press the On/Off Button; the Indicator Light will illuminate.
10. After 3-5 minutes, the Steam Inhaler will begin to emit steam.  
CAUTION: The water reservoir and water will become very hot.
11. Slide the Flow Lever left to decrease the amount of steam and to the right to increase the amount of steam.
12. Place your face over the Inhaler Attachment. Do not rest your face on the Inhaler Attachment; this may cause steam to es-

cape under the attachment or cause the inhaler to tip over. Keep enough distance from the Inhaler Attachment so that the temperature of the steam feels comfortable and not too hot. Breathe normally through your nose and mouth, inhaling steam into your nasal and throat passages. Continue treatment for five to fifteen minutes.

13. When your treatment is completed, press the On/Off Button to switch off the device. The Indicator Light will shut off. Disconnect the power cord from the electrical outlet. Let the Steam Inhaler cool before moving or refilling it. Do not operate the Steam Inhaler when it is empty.

### Treatment during the cold season

During use, sit in an upright and relaxed position at a table and not in an armchair, so as to avoid compressing the airways and therefore impairing effectiveness. Breathe in deeply.

### Treatment for cosmetic facial care

Sit in front of the device. Bend forward far enough that your face is over the Inhaler Attachment. After the treatment, wash your face with cold water. Now apply a facial cream or face mask. The open pores allow the active ingredients to penetrate deep into the skin. Do not use the facial sauna for more than a total of 20 minutes per day. It is recommended that 2 to 3 treatments are performed per week. As soon as the production of steam starts to diminish (maximum duration approx. 15 minutes), press the On/Off Button to switch off the device

### Using Vapor Pads

1. Make sure that the device is switched off before inserting a vapor pad.
2. Open the package of the vapor pad. Do not touch the pad with your hands. If the pad contacts your hands/ fingers, do not rub your face or eyes as it may cause irritation.
3. Place the vapor pad on top of the Vent Assembly between the two vapor pad holders.

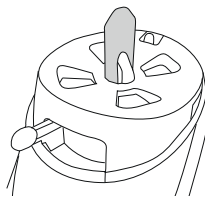

After each use, pull the mains plug out of the socket. Allow the device to cool down completely (approximately 20 minutes). Clean the device and the Inhaler Attachment used after every use as described in the "Cleaning and maintenance" chapter

## 7. CLEANING AND MAINTENANCE

### WARNING

Adhere to the following hygiene instructions to avoid health risks. The device must be switched off, disconnected from the mains and allowed to cool down for at least 20 minutes each time before cleaning.

### After Each Use

1. Remove Inhaler Attachment and Vent Assembly and wipe dry with a clean cloth or paper towel.
2. If any water is left in the Water Reservoir, pour the water out and wipe the Water Reservoir and Base with a dry, clean cloth or paper towel. Never immerse the Base in water or other liquid.
3. Attach the Vent Assembly and Inhaler Attachment. Store in a cool, dry place.

### Routine Maintenance

Perform the following cleaning procedures if using the Steam Inhaler ten or more times a week, when scale builds up in the Water Reservoir, or if not used for long periods:

1. Remove Inhaler Attachment and Vent Assembly.
2. Pour approx. 60 ml of undiluted white vinegar into the Water Reservoir and let sit for 10 minutes.
3. Empty the white vinegar and clean the Water Reservoir with fresh, clean tap water.
4. Dry the Water Reservoir and Base with a clean cloth or paper towel.
5. Wash Inhaler Attachment with mild soap and warm water then carefully rinse off all soap with fresh, clean tap water.
6. Dry the Inhaler Attachment with a clean cloth or paper towel.
7. Attach Vent Assembly and Inhaler Attachment. Store them in a cool, dry place.

### Cleaning the main unit

- Never submerge the main unit in water.
- Clean the main unit using a soft, slightly damp cloth and a mild cleaning agent. Then wipe dry with a soft, lint-free cloth. Do not use any chemical or abrasive cleaning agents.

 Vapor pads without addition can be used. Add aroma oils only to the pad. Never put any oils into the water reservoir. However, no solutions containing salt should be used. Only use medicinal herbs, oils and other aromatic substances that are intended and suitable for use with a steam mask and are licensed for this by the producer of these substances.

### Storage

- Do not store in damp conditions (such as in a bathroom) and do not transport with any damp items.
- When storing and transporting, protect from prolonged direct sunlight.
- Store the device in a dry place, ideally in the original packaging.

8. ACCESSORIES AND/OR REPLACEMENT PARTS

Accessories and replacement parts are available on the homepage [www.beurer.de](http://www.beurer.de), under "Service". Please state the corresponding order number.

Desigation	Article number
Inhaler Attachment	110.180
10 aroma pads	163.801

9. WHAT IF THERE ARE PROBLEMS?

Problem/question	Possible cause/remedy
The ON/OFF switch has been switched on, but the device is not working.	1. Check the power connection to the socket and check whether the mains plug has been plugged in correctly.
	2. The device has a thermal fuse. Following switch-off, the mains plug must be pulled out and a waiting period observed (see the section on fuses in Chapter „Warnings and safety notes“).
The device is switched on but produces no or hardly any steam.	Check that there is water in the Water Reservoir.
Does everyone need a separate Inhaler Attachment?	Yes, this is absolutely essential for hygiene reasons.

10. DISPOSAL

For environmental reasons, do not dispose of the device in the household waste.  
Please dispose of the device in accordance with EC Directive – WEEE (Waste Electrical and Electronic Equipment).  
If you have any questions, please contact the local authorities responsible for waste disposal.



11. TECHNICAL SPECIFICATIONS

Type	SI 31
Dimensions (Includes Inhaler Attachment) (W x H x D)	153.5 x 193 x 247.5 mm
Weight	530 g (with Inhaler Attachment and measuring cup)

Filling volume of internal water heater	Max. 40 ml
Mains connection	230 V~; 50 Hz; 230 VA
Power consumption	60 W
Steam temperature 2 cm over the Inhaler Attachment	Approx. 43°C
Water boiling time	Approx. 3 - 5 minutes
Maximum operation time	Approx. 15 minutes
Operating conditions	Temperature: +10°C to +40°C Relative humidity: 30% to 85%
Storage and transportation conditions	Temperature: -10°C to +50°C Relative humidity: 30% to 85%

Subject to technical changes.  
Please contact the specified service address to obtain further information, such as the CE Declaration of Conformity.

12. WARRANTY / SERVICE

Further information on the guarantee and guarantee conditions can be found in the guarantee leaflet supplied.



UK Importer: Beurer UK Ltd., Suite 16, Stonecross Place, Stonecross Lane North, WA3 2SH Lowton,  
United Kingdom



Beurer GmbH • Söflinger Str. 218 • 89077 Ulm, Germany • [www.beurer.com](http://www.beurer.com)  
[www.beurer-healthguide.com](http://www.beurer-healthguide.com) • [www.beurer-gesundheitsratgeber.com](http://www.beurer-gesundheitsratgeber.com)

