

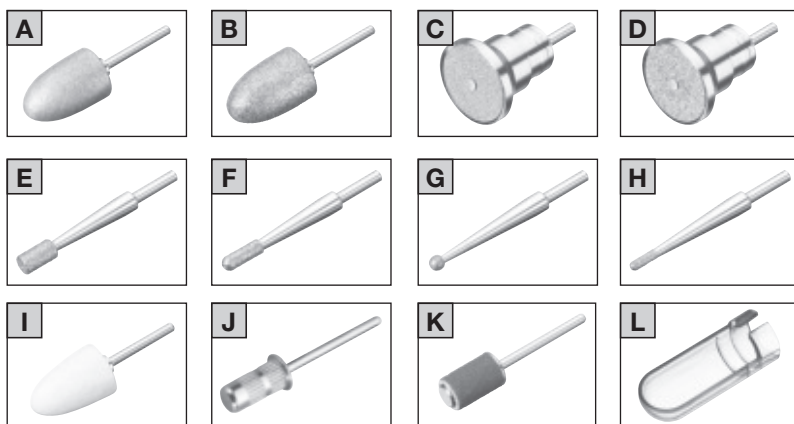

EN Manicure/pedicure station
Instructions for use

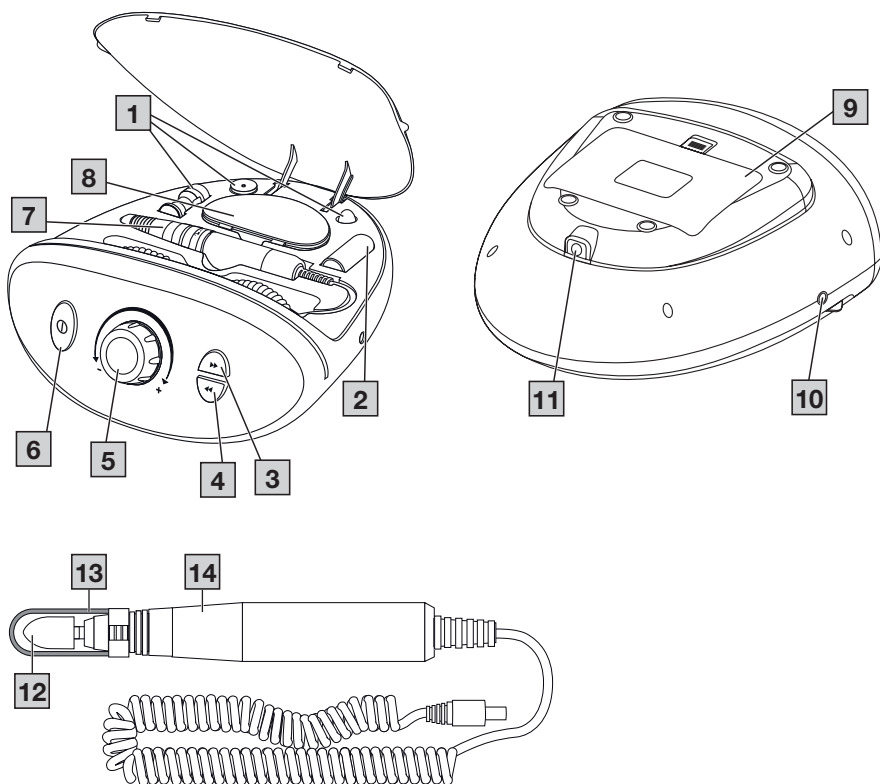



Read these instructions for use carefully. Observe the warnings and safety notes. Keep these instructions for use for future reference. Make the instructions for use accessible to other users. If the device is passed on, provide the next user with these instructions for use.

Table of contents

1. Warnings and safety notes	4	8. Cleaning and maintenance	7
2. Signs and symbols	5	9. Accessories and/or replacement parts	7
3. Intended use	5	10. What if there are problems?	7
4. Included in delivery	5	11. Disposal	7
5. Device description	5	12. Technical specifications	7
6. Initial use	6	13. Warranty/service	7
7. Usage	6		

1. WARNINGS AND SAFETY NOTES











⚠ WARNING

- The device is only intended for domestic/private use, not for commercial use.
- This device may be used by children over the age of 8 and by people with reduced physical, sensory or mental skills or a lack of experience or knowledge, provided that they are supervised or have been instructed on how to use the device safely, and are fully aware of the consequent risks of use.
- Children must not play with the device.
- Cleaning and user maintenance must not be performed by children unless supervised.
- Do not use the device if it shows signs of damage or does not function properly. In such cases, contact Customer Services.
- Repairs must only be carried out by Customer Services or authorised suppliers.
- If the mains connection cable of this device is damaged, it must be disposed of. If it cannot be removed, the device must be disposed of.
- Under no circumstances should you open or repair the device yourself, as faultless functionality can no longer be guaranteed thereafter. Failure to comply will invalidate the warranty.
- Check the results regularly during the treatment. It is particularly important for diabetics to do so as they have a lower sensitivity to pain and could injure themselves more easily. The 10 professional attachments supplied with the MP 100 are in principle suitable for diabetics. However, please use with particular care and do not use at high speed. If you have any doubts, consult your doctor.
- This device may only be used for the purpose for which it is designed and in the manner specified in the instructions for use. Any improper use can be dangerous.
- The device may heat up faster when in prolonged, intensive use, for example to sand off calluses on the feet. Allow the device to cool down for a relatively long time between individual applications to prevent skin burns. For your own safety, permanently check the heat development of the device. This applies in particular to persons that are not as sensitive to heat than others.
- Keep the device and mains cable and mains adapter away from water.
- Before use, ensure that the device and accessories show no visible damage. If you have any doubts, do not use the device and contact your retailer or the specified Customer Services address.
- Please check the device frequently for signs of any wear and tear or damage. If there are signs indicating the above or if this device was used improperly, it must be returned to the manufacturer or retailer before further use.
- In the event of defects and operational faults, switch off the device immediately.

- Repairs must only be carried out by Customer Services or authorised suppliers. Never attempt to repair the device yourself! Failure to comply will invalidate the warranty.
- Only use the device with the supplied accessories.
- Always monitor the device when it is in operation.
- Store the device out of the reach of children. The device is not suitable for children.
- Never use the device under a blanket, pillow or cushion, etc.
- Protect the device from impacts, humidity, dirt, chemicals, marked temperature fluctuations and direct sunlight.
- Do not use the device for periods longer than 15 minutes without a pause. After this period, have a break of at least 30 minutes to prevent the motor from overheating.
- Do not use the device while bathing or showering. Do not store the device in areas where it may fall into the bathtub or wash basin.
- Immediately disconnect the mains adapter if the device has fallen into water.
- Never pull the mains adapter out of the socket using the mains cable or with wet hands.
- Do not use the device if it is visibly damaged, does not function properly or if the mains plug or mains adapter is damaged. In these cases, contact Customer Services.
- Attachments may be used by one person only for hygienic reasons.
- Wear appropriate protective equipment (FFP2 mask, protective gloves and protective glasses) when using on acrylic, gel or artificial nails.

2. SIGNS AND SYMBOLS

The following symbols are used in these instructions for use, on the packaging and on the type plate for the device:

	WARNING
Indicates a potentially impending danger. If it is not avoided, there is a risk of death or serious injury.	
	CAUTION
Indicates a potentially impending danger. If it is not avoided, slight or minor injuries may result.	
	NOTICE
Indicates a potentially harmful situation. If it is not avoided, the system or something in its vicinity may be damaged.	
	Read the instructions
	The electronic device must not be disposed of with household waste
	Manufacturer
	Protection class II device
	For indoor use only
	Separate the packaging elements and dispose of them in accordance with local regulations.
	Marking to identify the packaging material. A = Material code, B = Material number: 1-7 = Plastics, 20-22 = Paper and cardboard

	Importer symbol
	CE labelling This product satisfies the requirements of the applicable European and national directives.
	United Kingdom Conformity Assessed Mark
	Direct current
	The products demonstrably meet the requirements of the Technical Regulations of the EAEU.
	Energy efficiency level 6
	Protected against solid foreign objects 12.5 mm in diameter and larger
	Safety isolating transformer, short-circuit proof
	Separate the product and packaging elements and dispose of them in accordance with local regulations.
	Do not use the power adapter if the plug is damaged.
	Switch mode power supply unit
	Polarity of d.c. power connector

3. INTENDED USE

Use the device exclusively to treat hands (manicure) and feet (pedicure).

The device is only intended for the purpose described in these instructions for use. The manufacturer is not liable for damage resulting from improper or careless use. The device is suitable for private use, and not for medical or commercial purposes.

4. INCLUDED IN DELIVERY

Check that the exterior of the cardboard delivery packaging is intact and make sure that all contents are included in the delivery. Before use, ensure that there is no visible damage to the device and accessories and/or replacement parts, and that all packaging material has been removed. If you have any doubts, do not use the device and contact your retailer or the specified Customer Services address.

- 1 x MP 100 base station
- 1 x MP 100 hand-held device
- 1 x Mains adapter
- 10 x Professional attachments
- 1 x Protective cap for nail dust
- 30 x Single-use attachments made of sandpaper

5. DEVICE DESCRIPTION

The associated drawings are shown on page 3.

- 1 Professional attachments
- 2 Protective cap for nail dust
- 3 Clockwise rotation

- 4** Anti-clockwise rotation
- 5** Speed controller
- 6** ON/OFF button ①
- 7** Hand-held device
- 8** Storage box for professional attachments
- 9** Cover flap for storing the mains adapter
- 10** Hand-held connection
- 11** Mains adapter connection
- 12** Professional attachment
- 13** Protective cap for nail dust
- 14** Safety lock

6. INITIAL USE



- Check to ensure that the package contains all the parts that should be included in the delivery. If any parts are missing or damaged, contact Customer Services.
- Remove all packaging material.

⚠ WARNING

Keep packaging material away from children! Choking hazard.

- Place the device on a firm, level and dry surface.
- Connect the mains lead of the mains adapter with the mains adapter connection on the base station.

Inserting a professional attachment

1. Turn the safety lock to the open position  and carefully push the selected professional attachment onto the hand-held device, up to the stop.
2. To lock the professional attachment in place, carefully turn the sealing ring onto the closed position .
3. Attach the protective cap for nail dust to the tip of the hand-held device from the top.
4. Connect the hand-held device cable to the hand-held connection on the base station.

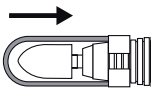

⚠ CAUTION

Make sure the speed controller is set to the lowest setting before connecting the mains adapter to the mains electricity.

5. Insert the mains adapter into the socket.

7. USAGE

⚠ WARNING

Check the results during the treatment. This applies in particular for diabetics as they have less sensitive hands and feet. Stop treatment as soon as it becomes unpleasant.

⚠ CAUTION

Ensure the axle can always rotate freely. Do not permanently block the axle as otherwise the device may become hot and damage.

When filing, always move from the outside of the nail towards the tip!

NOTE

Please observe that professional attachments show reduced performance on soaked or wet skin. For this reason, we recommend that you do not soak the foot in water before treatment.

1. Press the ON/OFF button ① to start treatment.

NOTE

If the safety lock is not turned to the closed position, the device cannot be switched on.

2. Select the desired speed using the speed controller.
3. Select the desired direction of rotation using the buttons for clockwise and anti-clockwise rotation.
4. Do not press too hard and always carefully move the attachments towards the area to be treated. Move the device towards the area to be treated and apply slight pressure while slowly moving the device in circles.

NOTE

If a large amount of pressure is placed on the rotating attachment, the device automatically switches off. Press the ON/OFF button again to switch the device back on.

5. Apply moisturiser to the treated areas after each use.

Attachments

⚠ WARNING

Take special care when using professional attachments. Improper use, particularly at high speeds, may cause injuries.

A Sapphire cone, fine

Suitable for removing dry skin, calluses on the sole of the foot and heel, and treating the nails. Do not remove all calluses to maintain natural skin protection.

B Sapphire cone, coarse

Suitable to quickly remove hard skin and large calluses on the sole of the foot and heel. This attachment is intended for application on large areas. Do not remove all calluses to maintain natural skin protection.

C Sapphire wheel, fine

Suitable to file and treating nails, fine-grain sapphire wheel. The special feature of this sapphire wheel is that the internal sanding disc rotates whereas the external housing does not. This makes it possible to precisely file nails without the risk of burning the skin with the quickly rotating wheel.

D Sapphire wheel, coarse

Coarse-grain sapphire wheel, suitable for filing and treating nails. This attachment makes it possible to cut even thick nails. However, also take care during use as it quickly removes large areas of the nail.

E Cylindrical cutter

Suitable for buffing rough surfaces and coarse smoothing of toenails. For this purpose, place the cylindrical cutter horizontally on the nail surface and remove the nail layer by moving the device in slow circles.

F Flame-shape cutter

Suitable for removing ingrowing nails For this purpose, carefully position the flame-shape cutter on the area to be treated and remove the necessary nail parts.

G Sapphire cutter, round

Suitable for carefully removing corns. If you are using this attachment, please keep in mind that you may penetrate deeper into the skin when removing the skin layers of the corn, therefore damaging the periosteum.

H Nail cutter

Suitable for exposing ingrown nails and cutting dead nail parts. Operate the nail cutter at a low speed.

I Felt cone

Suitable for smoothing and buffing the tips of nails after filing and for cleaning the surface of nails. Always move the device in circles and never keep the felt cone in one position as friction may cause heat. Please note that the felt material may naturally change colour over time while in storage. This is a normal property of the material and is not a defect.

J Attachment for using the sandpaper attachments

Suitable for fitting sandpaper attachments.

K Single-use attachments made of sandpaper

Suitable for removing dry skin, calluses on the sole of the foot and heel, and treating the nails The special feature of the single-use sandpaper attachments is that they can be removed and disposed of after a single use. 30 single-use attachments are included in the scope of delivery.

Do not remove all calluses to maintain natural skin protection.

L Protective cap for nail dust

Prevents nail dust from escaping.

8. CLEANING AND MAINTENANCE

⚠ WARNING

Before beginning cleaning, always pull the mains adapter out of the socket!

- Clean the base station and the hand-held device with a damp cloth. If it is very dirty, you can also moisten the cloth with a mild soapy solution.
- For hygienic reasons, you may use alcohol and a cloth or brush to clean the attachments. Allow the attachments to dry afterwards.
- Do not use any chemical or abrasive cleaning agents.
- Ensure that no water enters the device. If this should happen, reuse the device only when it has fully dried out.
- Do not submerge the base station and mains adapter in water or any other fluids.

9. ACCESSORIES AND/OR REPLACEMENT PARTS

To purchase accessories and/or replacement parts, visit www.beurer.com or contact the corresponding service address (as per the service address list) for your country. Accessories and/or replacement parts are also available from retailers.

Replacement part	Material number
------------------	-----------------

1 x Sapphire cone, fine 1 x Sapphire cone, coarse 1 x Sapphire wheel, fine 1 x Sapphire wheel, coarse 1 x Cylindrical cutter 1 x Flame-shape cutter 1 x Sapphire cutter, round 1 x Nail cutter 1 x Felt cone 30 x Single-use attachments made of sandpaper 1 x Protective cap for nail dust	570.64
Attachment for using the sandpaper attachments	164.291
Mains adapter	164.292

10. WHAT IF THERE ARE PROBLEMS?

Problem	Possible cause	Solution
Hand-held device will not switch on.	Mains adapter not plugged in	Insert the mains adapter into the socket.
	No voltage at mains socket	Check your fusebox.
	Hand-held device not connected to base station.	Connect the hand-held device to the base station.

11. DISPOSAL

For environmental reasons, do not dispose of the device in the household waste at the end of its useful life. Dispose of the device at a suitable local collection or recycling point in your country. Dispose of the device in accordance with EC Directive – WEEE (Waste Electrical and Electronic Equipment). If you have any questions, please contact the local authorities responsible for waste disposal..



12. TECHNICAL SPECIFICATIONS

Power supply: Entrance Exit	Input: 100-240 V~, 50/60 Hz, 0.8 A Output: 15.0 V === 2.0 A, 30.0 W
Average efficiency during operation	≥ 88,22 %
Efficiency at low load (10%)	≥ 88,08 %
No-load power consumption	≤ 0,065 W
Dimensions (L x W x H)	22,0 x 23,5 x 11,0 cm
Weight	Approx. 1,18 kg

Subject to technical changes

13. WARRANTY/SERVICE

Further information on the warranty and warranty conditions can be found in the warranty leaflet supplied.

