

# 137kVA



DE-W137 (R6105AZLDS)

Generating set Technical Data Sheet



ISO 9001:2015



*Available for purchase through auction from*

***whauctions.com***

**STANDARD SPECIFICATION**

**General features:**

- Composed of RICARDO diesel engine and DELLENT brushless alternator
- 24V DC start motor and storage battery
- Brushless, Self-excited, IP23, insulation class H alternator
- 50°C radiator as standard
- digital auto-start panel control system as standard, key start panel is optional.
- Fuel tank in base frame
- Optional open type or silent type
- All generator sets are gone through rigorous testing before being released to the market place, including 50% load, 75% load, 100% load, 110% load and all protection function (overspeed stop, high water temperature, low oil pressure, battery charging fail, emergency stop)

**Genset Main Technical Data**

**3-PH, 50Hz@1500RPM, 380/220V (Can Be Made According To Customers' Special Requirements)**

GENSET MODEL	Genset Specification					Engine Specification				Alternator Model
	KVA		Cons 100% (L/H)	dB (A) @7M	Tank (L)	Model	Cyl.	Gov.	Asp.	
	ESP	PRP								
<b>DE-W137</b>	<b>137</b>	<b>125</b>	<b>26.3</b>	<b>78</b>	<b>220</b>	<b>R6105AZLDS</b>	<b>6</b>	<b>M</b>	<b>TAC</b>	<b>DE274D</b>

- Electric Power must be considered cooling fan loss, alternator efficiency, altitude derating and ambient temperature.
- ESP= Standby power standby duty, operation under variable load without overload .  
PRP= Prime power continuous duty operation, under variable load. Variable load should not exceed a 70% average of the Prime Power during any operating period of 24 hours. 10% overload permissible for a period of 1 hour within a 12 hours period of operation.

**As the engine factories always recommend :**

The operation should always avoid or reduce the time that engine being operated under light or no-load condition. If the engine must be operated under light or no-load condition, the period should be limited within 10 minutes .  
Normally the load power should be no less than 30% of prime power .

- E= Electronic speed governor.  
M= Mechanical speed governor.
- Asp= Aspiration;  
NA= Naturally Asp;
- TC= Turbocharged  
TAC= Turbocharged air intercooled  
TAAC= Turbocharged air-air intercooled
- Technical data is subject to work test conditions.

**Reliable Performance**

**Voltage regulation**

Voltage regulation maintained within  $\pm 0.5\%$  as follow:

- Power factor Between 0.8~1.0 lag
- From no load to full load, any steady load
- Speed droop variation under 4.5%

**Frequency/Speed undulation**

- Change load from 0-100%, Frequency/Speed Droop Ratio within 5%.
- Load from 25-100%, any steady load Frequency/Speed undulation within 0.25%

**Effect factor of telecom**

- TIF( MA MG1-22) better than 50
- THF( BS EN60034) better than 2%

**Criterion**

- ISO8528, GB/T2820
- EN12601:2001, EN60034-22:1997, EN60204-1:2006
- ISO9001:2015 Quality Control System

**Dimension and Weight**

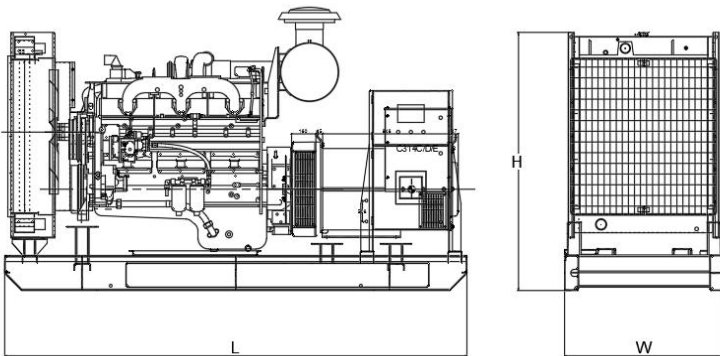

**Open Type**  
 Overall size (L\*W\*H)  
 2300\*900\*1430  
**Weight: 1230kg**

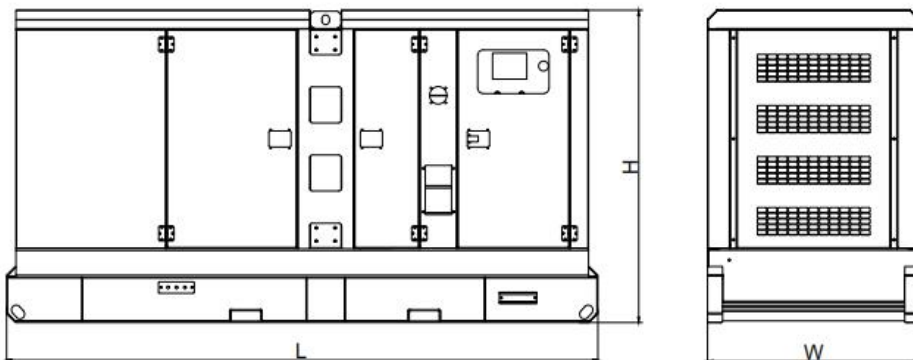

**Silent Type**  
 Overall size (L\*W\*H)  
 2980\*1100\*1550  
**Weight: 1780kg**

**Engine Specification**

**RICARDO Diesel Engine**

**Technical Data**

Engine Model	R6105AZLDS
Number of Cylinders	6
Cylinder arrangement	in-line
Aspiration	Turbocharged air intercooled
Bore×Stroke (mm×mm)	105×130
Displacement (Liter)	6.75
Compression Ratio	17:1
Prime Power/Speed (kW/rpm)	120/1500RPM
Standby Power/Speed (kW/rpm)	132/1500RPM
Speed Governor	Mechanical
Cooling System	Water-cooled, 50°C radiator as standard
Total lubrication system capacity (L)	17
Coolant capacity (without radiator) (L)	23
Fuel Consumption	218 g/kW*h
Starter Motor	DC24V
Start type	Electrical

**Alternator Specification**

**DELLENT Alternator (Standard)**

**Technical Data**

Alternator Model	DE274D
Rated output power	100KW/125KVA
Exciter type	Brushless, Self-excited
Power factor	0.8
Voltage Adjust range	≥5%
Voltage Regulation NL-FL	≤±1%
Insulation Grade	H
Protection Grade	IP23

**Control System**

**1. Standard: Deepsea DSE6020 AMF Digital Controller**

Providing the standard functions as follows:

(Also can be made according to the customers' special requirements)

- \* Automatic Start/Stop
- \* Offer electronic(CAN) and non-electronic(magnetic pick-up/alternator sensing) engine versions
- \* offer a number of flexible inputs,outputs and engine protections
- \* Parameters display (V/A/Hz/Hour)
- \* Engine monitoring and protection
- \* Charge alternator exciting and Charge alternator fail alarm
- \* Running hour counting
- \* Emergency stop pushbutton
- \* Monitoring speed,frequency,voltage,current,oil pressure,coolant temperature and fuel level,the modules will display warnings,shutdown and engine status information on the back-lit LCD screen and illuminated LED.
- \* Protection System: Over speed、High Engine Temperature、Low Oil Pressure、Emergency Stop.And the other protection function pre-setting.

Digital Auto-start Generator controller integrating digital, intelligent and network techniques is used for automatic control system of diesel generator.It can carry out functions including automatic start/stop ,data measure and alarming.Optionally assembled with the ATS,it can carry out auto-switching between the outer power and generating set power.(AMF)

- 2. Option: Deepsea DSE7320 AMF Digital Auto Start**
- 3. Option: ComAp AMF20 / AMF25 Digital Auto Start**
- 4. Option: Deepsea DSE6120 AMF Digital Auto Start**



**(1) DSE6020**



**(2) DSE7320**



**(3) AMF25**