



2 Floors



4 Bedrooms



1 En suite

HACHESTON FOUR BEDROOM HOME

A four bedroom detached home comprising a spacious lounge and fantastic open plan kitchen / dining / family area, featuring French doors leading to the rear garden. Downstairs also comprises a utility cupboard and cloakroom. Upstairs, three of the four bedrooms are spacious doubles, with the master bedroom benefitting from fitted wardrobes and an en suite shower room.

HACHESTON

FOUR BEDROOM HOME

◇ DIMENSIONS

First Floor:

Bedroom 1

2.82m x 3.28m
9'3" x 10'9"

En Suite

Bedroom 2

3.16m x 3.18m
10'4" x 10'5"

Bedroom 3

2.37m x 3.15m
7'9" x 10'4"

Bedroom 4 / Study

3.48m x 2.28m
11'5" x 7'6"

Bathroom

Ground Floor:

Lounge

3.76m x 4.77m
12'4" x 15'8"

Kitchen / Dining / Family

6.71m x 3.85m
22'0" x 12'8"

(W) Wardrobes

(U) Utility

(C) Cloaks

◀▶ Measurement Points

△ External Access

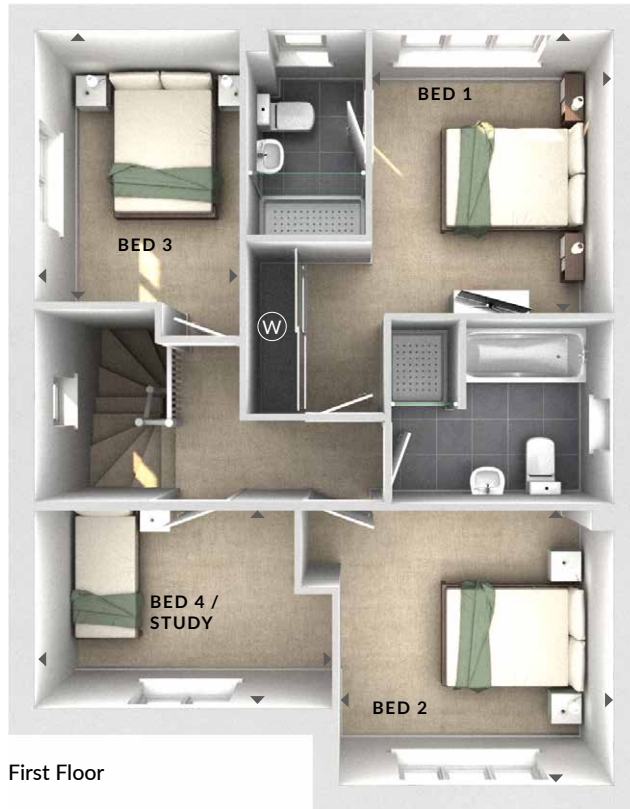

First Floor



Ground Floor

Additional window to lounge in selected plots only. Please speak to Sales Advisor for details.

© Bloor Homes
402 QA Brick 6.2

These particulars are intended as a preliminary guide for prospective purchasers and should not be relied upon. The elevational treatment for individual house types shows a typical arrangement. Details of materials and design treatments may vary. Any artist impressions shown are not intended to represent any particular plot. Purchasers are advised to inspect the layout plan to establish the arrangement of the house and surrounding property. Internal layouts show a general arrangement which may vary from plot to plot. Room sizes given are approx. overall finished room sizes and subject to normal building tolerances (ie ± 75mm). In all instances purchasers are advised to inspect plot specific information available from our sales team. Nothing in these particulars or verbal assurance shall form or constitute part of any contract, and are given without any responsibility on behalf of Bloor Homes.

BLOOR HOMES