

# NOBLELIFT

Material Handling

[www.noblelift.com](http://www.noblelift.com)

## RT35/45P<sub>10</sub> RT35/45B



### Features:

- Safe and reliable
- Energy efficient
- Strong chassis and excellent view
- Comfortable driving and easy operation
- Optional function



Small  
Turning Radius



Capacity  
1600-2000Kg



Easy  
Maintenance



Powerful  
Battery



Robust  
Design



Low noise

NEW / *Noblelift Products*  
ARRIVAL

NOBLELIFT INTELLIGENT EQUIPMENT CO., LTD



## Safe and reliable:

- The tilting of the fork can effectively improve the stability of the whole vehicle and the loading capacity at height.
- The electro-hydraulic proportional control system has good fretting performance, more stable work and more precise control.
- Speed limit function, when the forklift lifts to a certain height, the driving speed of the forklift will automatically decrease to ensure the safety of high position operation.
- The height limit function, the lifting motor will automatically power off to ensure the safety of lifting when the forks lift to the maximum height.
- Turning speed limit control prevents the truck from tipping sideways when turning, ensuring the safety of the truck when turning.
- Smooth deceleration when the mast reaches/backwards to the end can ensure the stability of the mast movement.
- The motor temperature detection and control can effectively prevent the motor from being damaged due to excessive temperature.
- The motor current detection and control can effectively prevent the motor from being damaged due to excessive current.
- The combination of electromagnetic brake and hydraulic brake has a short braking distance, no deviation, no impact, and is safe and reliable.
- The parking electromagnetic brake can realize the one-key start operation function no matter it is on the slope or on the smooth ground.
- Using CAN bus communication technology, electrical wiring is simple, the compatibility is good, and the reliability is high.
- AC frequency conversion speed control technology enables stepless closed-loop speed control of driving, lifting, and steering drives, which is accurate and reliable.

## Energy efficient:

- High-speed lifting and lowering control improves your work efficiency.
- It adopts AC drive motor, hydraulic pump motor and steering motor, with long service life, maintenance-free and reliable performance.
- Regenerative braking to achieve energy recovery and extend battery life.
- All lights use LED, durable and energy-saving.

## Robust Design & Excellent Stability

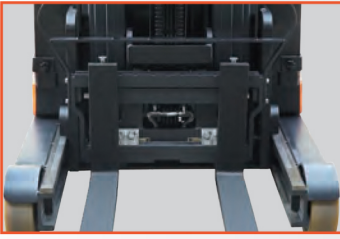

■ The powerful chassis structure and reasonable center of mass distribution make the forklift have excellent stability.



■ The large arc of the back wall of the chassis coincides with the turning radius of the vehicle, which is beautiful and has a small turning radius.



■ The reasonable layout of the lifting cylinder and pipeline system, the mast pipeline is simple and beautiful, and the vision is good.



■ The high-precision forward sliding rail and excellent clearance compensation design make the forward movement of the masts more stable.

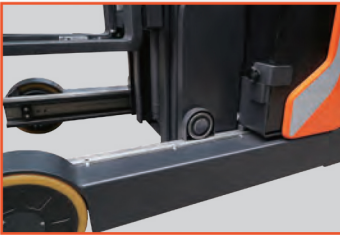

## Optional function



■ Side battery extraction.

■ HD video camera.



■ Electronic height preselected system.



■ Integrated side-shift.





## Comfortable driving and



■ The spacious driving space and ergonomic layout reflect the humanized design of the vehicle.



■ Low-noise gear hydraulic pump reduces the lifting noise of the whole vehicle. Travel motor controllers, hydraulic pump motor controllers and steering motor controllers of international well-known brands are self-protected, maintenance-free, and have superior performance.



■ The steering wheel and central control console can be adjusted freely in all directions to suit your best operating habits.



■ In order to replace the battery its tray should be reached forward. The mechanism for battery's tray release is located near with operator's foot.



# easy operation



■ Multi-function color LCD instrument can display information such as steering wheel position, battery power, power alarm, fault code, running time, driving speed etc.  
The driving speeds of low, medium and high third gear can be set through the meter.



■ Shock-absorbing seat, adjustable backrest, and seat belt as standard.



■ Centralized control console, fingertip operation, convenient and accurate.



■ Adopting AC EPS electronic power steering system, the steering is light and has automatic centering function, and the 180 °/ 360 °steering mode can be switched in real time.





Type sheet for industrial truck acc. to VDI 2198

Model	Lift height h3 (in)	Mast height h1 (in)	Extended mast height h4 (in)	Free lift h2 (in)
RT35Pro/RT35B RT45Pro/RT45B	117	88	213	62
	197	94	233	68
	217	101	252	75
	236	108	272	81
	256	114	292	88
	276	121	311	94
	295	127	331	101
	315	134	351	107
	335	140	370	114
	354	147	390	121
	374	154	410	127

Types	RT45Pro/45B		
Lift height h3 (in)	374in		
h3 (in)	Q (lb)		
374	1764	1323	882
354	2205	1543	1323
335	2646	1984	1764
315	3086	2425	2205
295	3527	2866	2646
276	3968	3306	3086
248	4409	3748	3527
C (in)	24	28	31

Types	RT35Pro/35B		
Lift height h3 (in)	374in		
h3 (in)	Q (lb)		
374	1323	882	441
354	1764	1102	661
335	1984	1323	882
315	2205	1653	500
295	2646	2094	1543
276	3086	2535	1984
248	3527	2866	2425
C (in)	24	28	31

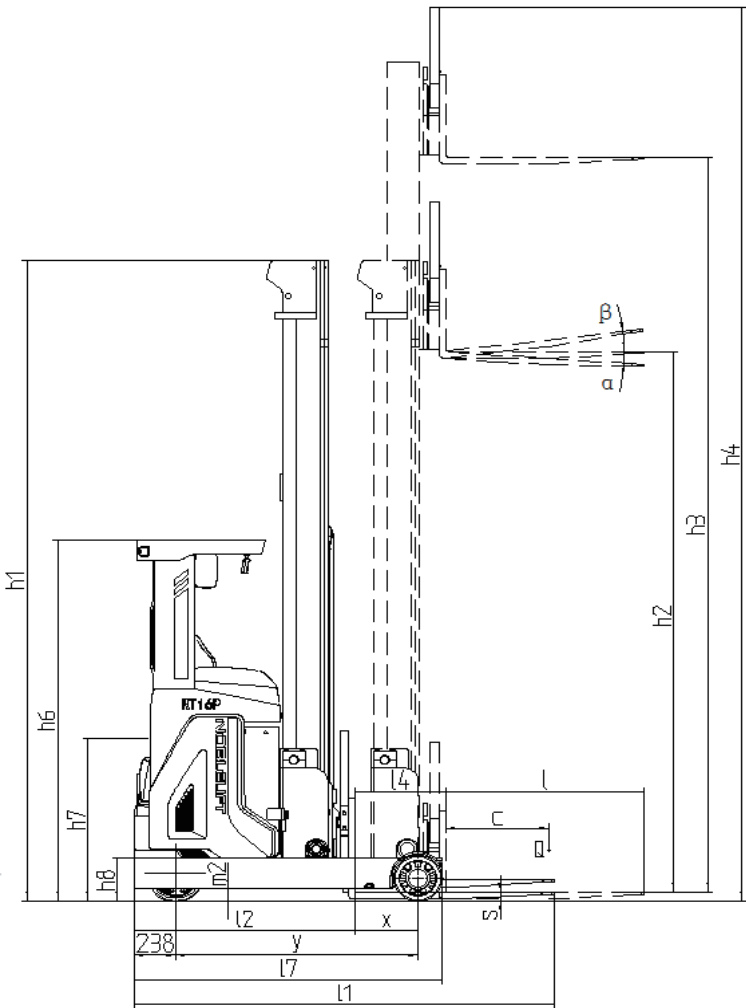
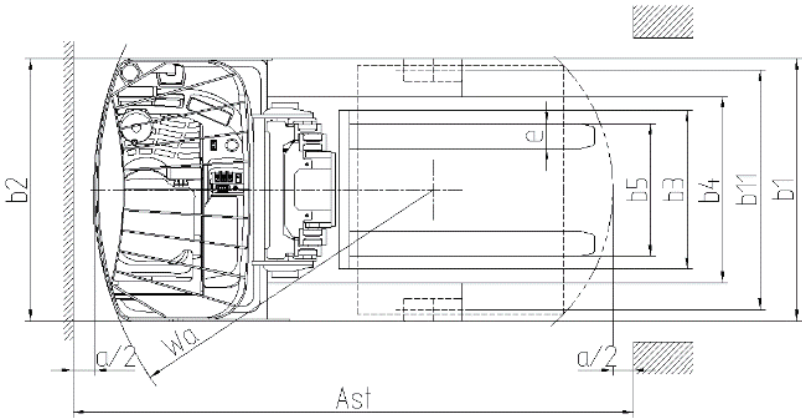



Type sheet for industrial truck acc. to VDI 2198

dentification						
1.1	Manufacturer		NOBLELIFT			
1.2	Model		RT35Pro	RT45Pro	RT35B	RT45B
1.3	Drive		Electric	Electric	Electric	Electric
1.4	Operator type		Seated	Seated	Seated	Seated
1.5	Load capacity / rated load	Q (lb)	3527	4409	3527	4409
1.6	Load centre	c (in)	23.6	23.6	23.6	23.6
1.8	Load distance, centre of support arm wheel to face of forks	x (in)	14.37/6.93	15.55/7.87	14.37/6.93	15.55/7.87
1.9	Wheelbase	y (in)	55.1	59.0	55.1	59.0
Weights						
2.1	Service weight including battery	lb	8730	9303	8778	9370
2.3	Axle load, mast retracted without load, drive/support arm wheel	lb	5335/3395	5643/3660	5400/3395	5688/3682
2.4	Axle load, mast extended with load, drive/support arm wheel	lb	1829/10494	1645/12068	1962/10362	1688/12090
2.5	Axle load, mast retracted with load, drive/support arm wheel	lb	4629/7627	5004/8708	4629/7518	5049/8730
Wheels						
3.1	Drive/support arm wheel		PU	PU	PU	PU
3.2	Wheel size, front	Øxw (in)	Ø 13.50x5.51	Ø 13.50x5.51	Ø 13.50x5.51	Ø 13.50x5.51
3.3	Wheel size, rear	Øxw (in)	Ø 11.22x4.33	Ø 11.22x4.33	Ø 11.22x4.33	Ø 11.22x4.33
3.5	Wheels, number front/rear (x=driven wheels)		1x/2	1x/2	1x/2	1x/2
3.7	Track width, rear	b11 (in)	45.67	45.67	45.67	45.67
Dimensions						
4.1	Tilt of fork, forward/backward	deg	4°/-2°	4°/-2°	4°/-2°	4°/-2°
4.2	Height, mast extended	h1 ( )	153.5	153.5	153.5	153.5
4.3	Free lift	h2 (in)	129.5	129.5	129.5	129.5
4.4	Lift height	h3 (in)	374.0	374.0	374.0	374.0
4.5	Extended mast height	h4 (in)	409.8	409.8	409.8	409.8
4.7	Height of overhead guard (cab)	h6 (in)	86.6	86.6	86.6	86.6
4.8	Seat height	h7 (in)	37.8	37.8	37.8	37.8
4.10	Height of support arms	h8 (in)	10.6	10.6	10.6	10.6
4.15	Height of lowered forks	h13 (in)	1.6	1.6	1.6	1.6
4.19	Overall length	l1 (in)	95.0	98.0	95.0	98.0
4.20	Length to face of forks	l2 (in)	50.1	52.7	50.1	52.7
4.21	Overall width	b1 (in)	50.0	50.0	50.0	50.0
4.22	Fork dimensions	s/e/l (in)	1.4/3.9/45	1.6/4.7/45	1.4/3.9/45	1.6/4.7/45
4.23	Fork carriage ISO 2328, class/type A, B		2/A	2/A	2/A	2/A
4.25	Width across forks	b5 (in)	7.84-29.13/7.84-32.20	9.45-29.13/9.45-32.2	7.84-29.13/7.84-32.20	9.45-29.13/9.45-32.2
4.26	Distance between support arms	b4 (in)	35.4	35.4	35.4	35.4
4.28	Reach distance	l4 (in)	20.7	23.4	20.7	23.4
4.31	Ground clearance, with load, below mast	m1 (in)	3.5	3.5	3.5	3.5
4.32	Ground clearance, centre of wheelbase	m2 (in)	3.0	3.0	3.0	3.0
4.33	Aisle width for pallets 1000 x 1200 crossways	Ast(in)	107	112	107	112
4.34	Aisle width for pallets 800 x 1200 lengthways	Ast(in)	109	114	109	114
4.35	Turning radius	Wa (in)	65	69	65	69
4.37	Length across support arms	l7 (in)	70	75	70	75
Performance data						
5.1	Travel speed, with/without load	mph	6.34/6.34	6.34/6.34	6.34/6.34	6.34/6.34
5.2	Lift speed, with/without load	fmp	68.9/98.43	68.9/98.43	68.9/98.43	68.9/98.43
5.3	Lowering speed, with/without load	fmp	88.58/88.58	88.58/88.58	17.72/17.72	88.58/88.58
5.4	Reach speed, with/without load	fmp	19.68/19.68	19.68/19.68	19.68/19.68	19.68/19.68
5.8	Max. gradeability, with/without load	%	10/15	10/15	10/15	10/15
5.10	Service brake		Hydraulic/electric	Hydraulic/electric	Hydraulic/electric	Hydraulic/electric
Electric motor						
6.1	Drive motor rating S2 60 min	hp	8.7	8.7	8.7	8.7
6.2	Lift motor rating S3 15%	hp	17	17	17	17
6.4	Battery voltage, nominal capacity K5	V/Ah	48 420/560	48/560	48 420/560	48/560
6.5	Battery weight	lb	1653	2094	1653	2094
Other						
8.1	Type of drive control		AC	AC	AC	AC
8.4	Sound level at the driver's ear according to EN 12 053		68	68	68	68



Type sheet for industrial truck acc. to VDI 2198

Model	Lift height h3 (in)	Mast height h1 (in)	Extended mast height h4 (in)	Free lift h2 (in)
RT45P	394	160	430	134
	413	167	449	140
	433	173	469	147
	453	180	489	153
	472	186	508	160
	492	193	528	167

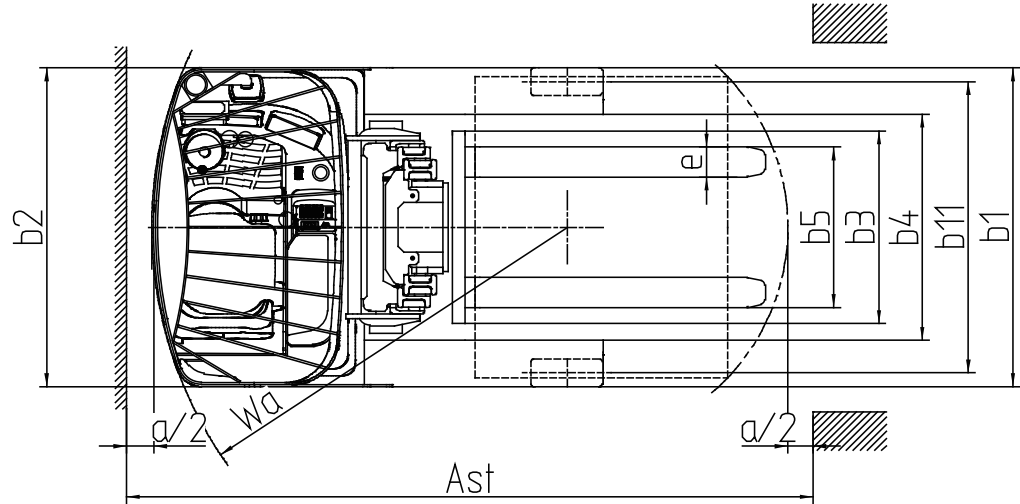
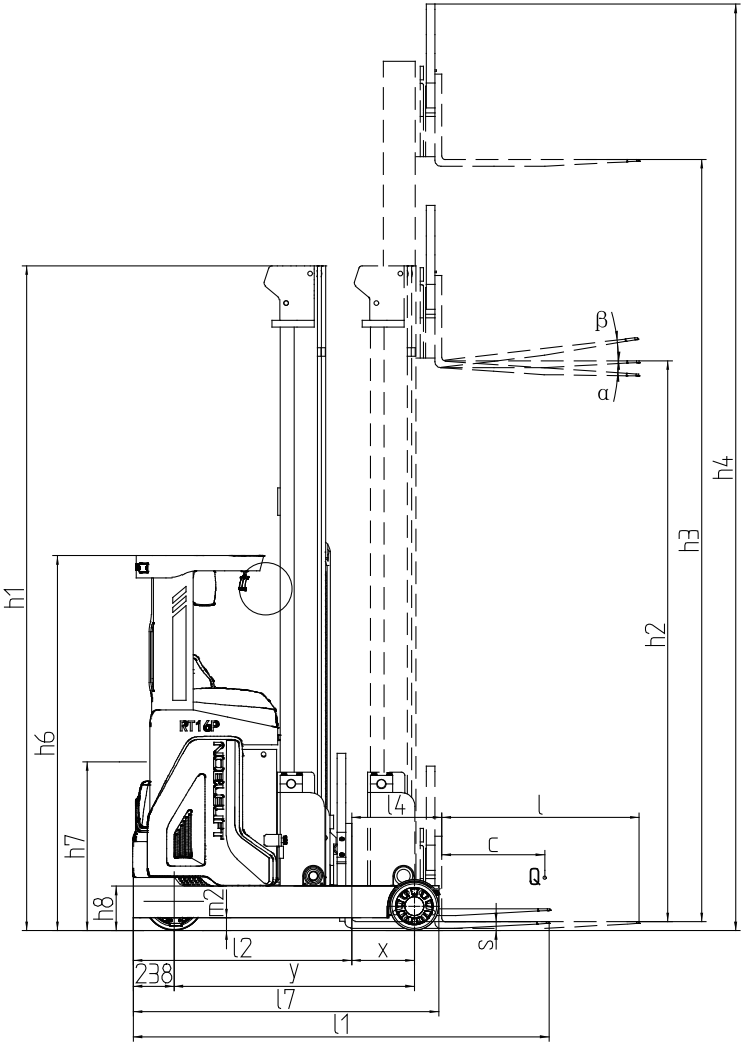
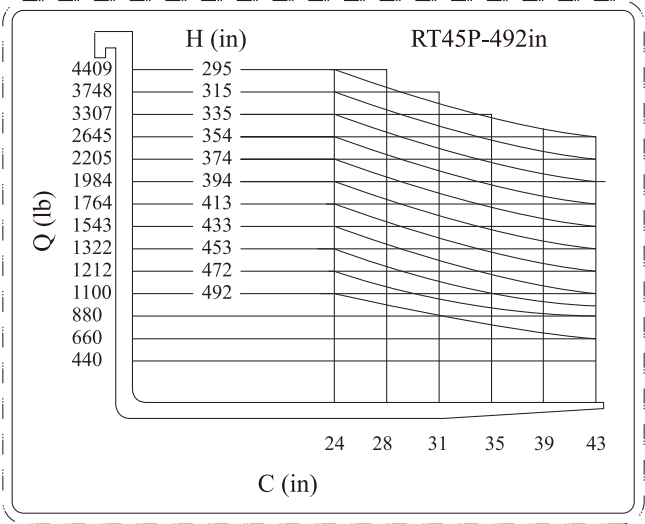



# Type sheet for industrial truck acc. to VDI 2198

## Identification

1.1	Manufacturer		NOBLELIFT
1.2	Model		RT45P
1.3	Drive		Electric
1.4	Operator type		Seated
1.5	Load capacity / rated load	Q (lb)	4409
1.6	Load centre	c (in)	23.6
1.8	Load distance, centre of support arm wheel to face of forks	x (in)	15.94/9.21
1.9	Wheelbase	y (in)	62.6

## Weights

2.1	Service weight including battery	lb	11464
2.3	Axle load, mast retracted without load, drive/support arm wheel	lb	-
2.4	Axle load, mast extended with load, drive/support arm wheel	lb	-
2.5	Axle load, mast retracted with load, drive/support arm wheel	lb	-

## Wheels

3.1	Drive/support arm wheel		PU
3.2	Wheel size, front	Øxw (in)	Ø 15.98 x 5.98
3.3	Wheel size, rear	Øxw (in)	Ø 12.99 x 5.51
3.5	Wheels, number front/rear (x=driven wheels)		1x/2
3.7	Track width, rear	b11 (in)	50.78

## Dimensions

4.1	Tilt of fork, forward/backward	deg	4°/-2°
4.2	Height, mast extended	h1 (in)	193
4.3	Free lift	h2 (in)	169
4.4	Lift height	h3 (in)	492
4.5	Extended mast height	h4 (in)	528
4.7	Height of overhead guard (cab)	h6 (in)	86.6
4.8	Seat height	h7 (in)	43.3
4.10	Height of support arms	h8 (in)	10.6
4.15	Height of lowered forks	h13 (in)	1.57
4.19	Overall length	l1 (in)	101.6
4.20	Length to face of forks	l2 (in)	56
4.21	Overall width	b1/b2 (in)	56.29/50
4.22	Fork dimensions	s/e/l (in)	1.6/4.7/45
4.23	Fork carriage ISO 2328, class/type A, B		2/A
4.25	Width across forks	b5 (in)	9.45-29.13
4.26	Distance between support arms	b4 (in)	39
4.28	Reach distance	l4 (in)	25
4.31	Ground clearance, with load, below mast	m1 (in)	3.54
4.32	Ground clearance, centre of wheelbase	m2 (in)	2.95
4.33	Aisle width for pallets 1000 x 1200 crossways	Ast(in)	113.4
4.34	Aisle width for pallets 800 x 1200 lengthways	Ast(in)	117
4.35	Turning radius	Wa (in)	72.4
4.37	Length across support arms	l7 (in)	78.7

## Performance data

5.1	Travel speed, with/without load	mph	6.22/6.84
5.2	Lift speed, with/without load	fmp	68.9/98.4
5.3	Lowering speed, with/without load	fmp	88.58/88.58
5.4	Reach speed, with/without load	fmp	19.68/19.68
5.8	Max. gradeability, with/without load	%	10/10
5.10	Service brake		Hydraulic/electric

## Electric motor

6.1	Drive motor rating S2 60 min	hp	9.5
6.2	Lift motor rating S3 15%	hp	17
6.4	Battery voltage, nominal capacity K5	V/Ah	48/700
6.5	Battery weight	lb	2524(700Ah)

## Other

8.1	Type of drive control		AC
8.4	Sound level at the driver's ear according to EN 12 053		68



We promise, We deliver

## Noblelift Headquarters

Add: #528 Changzhou Road, Taihu  
Sub-district, Changxing, 313100, China  
TEL: +86 572 6210311 / 6120989  
FAX: +86 572 6129336  
WEB: [www.noblelift.com](http://www.noblelift.com)  
Email: [info@noblelift.com](mailto:info@noblelift.com)



Official website



Our Wechat

## Noblelift North America Corp.

Add: 2461 S Wolf Road, Des Plaines, IL 60018  
Tel: 847-595-7100  
Fax: 847-595-7200  
Email: [sales@nobleliftna.com](mailto:sales@nobleliftna.com)  
Http: [www.nobleliftna.com](http://www.nobleliftna.com)

## Noblelift Europe GmbH

Add: Borsigstrasse 9d-93092 Barbing  
Germany  
TEL: +49 9401 607930  
FAX: +49 9401 6079329  
WEB: [www.noblelifteurope.com](http://www.noblelifteurope.com)  
Email: [mail@noblelifteurope.com](mailto:mail@noblelifteurope.com)

## Noblelift Russia

ООО "Ноблелифт Рус"  
194292, Санкт-Петербург  
Домостроительная ул. 4А офис 301  
Бизнес-центр "Парнас"  
тел.: +7 (800) 700-28-97  
Email: [sales@noblelift.com.ru](mailto:sales@noblelift.com.ru)