

4. Enter your WiFi password.

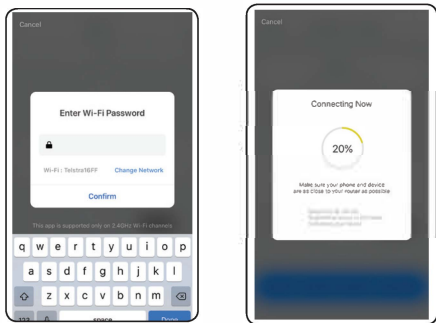

Connection will now begin.

5. Once connected you'll get a menu 'Adding device succeeded'.

Select the room device and press 'Done'.

You can click on the pen to change the device name.

6. The smart device can now be controlled by the BrilliantSmart app.



Go to www.brilliantsmart.com.au for full instructions and features.

Warning

1. To prevent injury, this apparatus must be installed Safely and correctly.
2. Do not open or tamper with smart device. Injury may occur.
3. For indoor use only. Not suitable outdoors.
5. Do not allow children to play with wall switch tuning ON/OFF rapidly. This can cause smart device to reset.
6. Power Surge/Power Loss could possibly reset smart device. If this happens follow setup instructions.

NB: BrilliantSmart app screens may differ due to application updates & improvements.

Disposal

Please dispose of this packaging material thoughtfully.

Please dispose of this product thoughtfully once it has passed its useful life.

When your smart device comes to the end of its life or you choose to update or upgrade it, please do not dispose of it with your normal household waste. Please recycle where facilities exist.

When disposing of this fitting, check with your local authority for suitable options.

MADE IN CHINA

1881 07/19 01

Troubleshooting

Problem:
Smart device does not switch ON

Possible Cause	Suggested Solution
No Mains Power	Check connections, fuses and switches

Problem:
Cannot link smart device with BrilliantSmart app

Possible Cause	Suggested Solution
1. Modem signal weak	Place device and modem closer together
2. Router/modem/smart phone firewall is enabled	Disable firewalls on all devices
3. Internet connection is down	Contact your provider
4. BrilliantSmart app not installed correctly	Remove app and re-install

For any other problems connecting your smart device to BrilliantSmart app please visit:

www.brilliantsmart.com.au/faqs

Brilliant Lighting

956 Stud Road
Rowville Vic 3178 Australia

www.brilliantlighting.com.au

Australian Sales

T 03 9765 2555
T 1800 817 754 (interstate only)
F 03 9763 0277
E sales@brilliantlighting.com.au

New Zealand Sales

T 09 974 9618
E sales@brilliantlighting.co.nz



WiFi RGB+W A60
E27 or B22 Globe
SERIES II
20698 20699



USER MANUAL

Box content

Smart RGB+W A60 LED E27 or B22 x 1
User Manual x 1

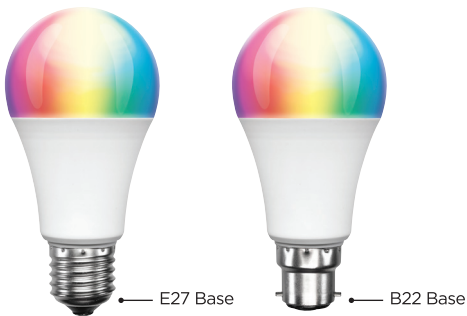

Technical Specifications

Model No: 20698 20699
Colour LED: Red Green Blue White
Dimming: via BrilliantSmart App
Power: 8.5W/globe
Lumens: 800lm/globe (white only)
Supply voltage: 240V AC 50Hz
Dimensions: E27: 112 x 60mm B22: 110 x 60mm
Weight: 42gm/globe
Security: Mac Encryption; WEP/WAPI/TKIP/AES
WiFi Standard: IEEE802.11b/g/n
System Req's: iOS 8.0 or higher, Android 4.1 or higher

Installation Guide

IMPORTANT SAFETY ISSUES

Ensure the power is disconnected before installing.
This product is NOT suitable for damp or explosive environments.
Modification of this product will void any warranty.
Indoor use only.

INSTALLATION

POWER IS TO BE TURNED OFF AT EXISTING WALL SWITCH PRIOR TO INSTALLATION.

Insert smart device into a suitable type light socket/lamp holder by gently pushing then slight twist till globe is locked in position clockwise.

Be sure smart globe is secured in socket/lamp holder.

Turn on smart device via existing wall switch and follow the BrilliantSmart app steps.

Connect to your WiFi

Ensure your mobile phone is connected to your 2.4GHz WiFi network.

Your mobile phone and your smart device needs to be within good signal strength range of your WiFi router. (Refer to your router specifications for max range.)

Download the BrilliantSmart App

Please download the free BrilliantSmart app from the App store or Google Play store, or scan the QR code below.

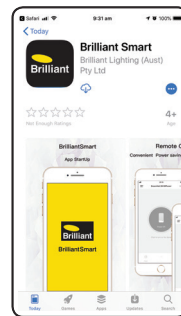

Register the BrilliantSmart App

Open the BrilliantSmart app.

For new users, register a new account or if existing user, login with your user name and password.

Configure your BrilliantSmart App

Setting up your Home

You can setup multiple homes or locations. Click **'Add Home'** button. Or Click on **'Home'** top left if you are adding or modifying details then **'Home Management'** to setup your home(s), add or rename rooms and share devices.

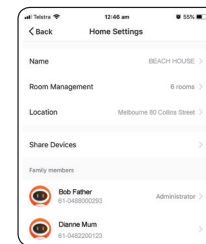

Add your Smart Device to your App

1. On initial power-on, the globe will begin blinking rapidly and be ready to pair (2 times per second).
(If smart globe does not start blinking, turn wall switch OFF/ON 3 times or until light starts to blink rapidly.)
2. Open the BrilliantSmart App, tap **'Add Device'** (if empty room) or **'+'** to add your smart globe.
3. Select **'Lighting'** in the list of devices. If globe is blinking rapidly then press **'Confirm indicator rapidly blink'**.

