



# OYSTER LIGHT KIT (E27 HOLDER) FOR PACIFICA AC CEILING FAN – 21899/05 (WHITE COLOUR)

Congratulation on the purchase of your new Brilliant OYSTER Light Kit for AC ceiling Fan. Before first using, it is most important that you read and follow these instructions, even if you feel you are quite familiar with this type of product. Keep this document handy for future reference.

**THIS FITTING MUST BE INSTALLED BY A QUALIFIED ELECTRICAL CONTRACTOR in accordance with the latest AS/NZS 3000 and relevant amendments**

## FOR YOUR SAFETY

- To prevent electrical shock, please ensure that POWER is DISCONNECTED before installation.
- During use the light head and/or light assembly may become hot.
- Do not install in a position where the fitting can be easily accessed by children or the infirm.
- Do not touch any parts of the assembly with bare hands while it is 'ON'.
- Be aware of the height of your installation. Refer to 'Working at Heights' guide from your local or State Authorities.
- Any alterations or additions to building wiring **must be completed by a licensed electrician** or person authorised by legislation to work on the fixed wiring of any electrical installation.



SPECIFICATION:			
Input:	220-240V AC 50Hz	Housing Material:	Steel
Globe Type:	E27 (GLOBE NOT INCLUDED)	Dimensions:	Ø 205 mm x 100 mm
Protection:	Class I (earth connection through fan shaft)	Weight:	0.572 kg (without globe)
Maximum Power:	20 W LED	Recommended Ceiling Fan:	PACIFICA AC CEILING FAN (21896/05 & 21897/05)
Diffuser:	Frosted glass shade		

Before first using your new fitting, it is most important that you read and follow these instructions, even if you feel you are quite familiar with this type of product. Retain this document for future reference.

**THIS FITTING MUST BE INSTALLED BY A QUALIFIED ELECTRICAL CONTRACTOR in accordance with the latest AS/NZS 3000 and relevant amendments**

## INSTALLATION

- 1) Ensure the Mains Supply is switched 'OFF'. ( Fig. 1)
- 2) Unpack the fixture carefully and place it on a flat surface. Dispose of the packaging material thoughtfully.
- 3) Remove the screw in button from the fan by unscrew it anticlockwise. (Fig 2)
- 4) Use appropriate tool like long nose pliers to pull the wires out one at a time from the fan. (Fig. 3)
- 5) Remove the diffuser by unscrew the decorative screw nut. (Fig. 4). Keep it aside.
- 6) Attach the light housing to the fan where previously screw in button was removed. (Fig. 5)
- 7) Double check the light housing after attached and ensure it secure tighten and firmly. (Fig. 6). If require trim off the access wires to reasonable length before wiring up to the terminal block.
- 8) Remove the terminal block cover. Connect the Live (L) and Neutral (N) according to the markings on the terminal block. Ensure all connections are firm and secure. (Fig. 7)
- 9) Replace the terminal block cover and ensure it secure.
- 10) Install suitable E27 LED globe (not supplied) into the lampholder. Ensure not to exceed the maximum wattage 20W. Then attach and secure the diffuser back to the light housing. (Fig. 8)
- 11) Installation completed. (Fig. 9)
- 12) Reconnect the mains supply. (Fig. 10)
- 13) Turn ON the light.

### Remarks:

- Ensure fan light wires are connected to a light switch if the fan previously is using a wall control switch.
- If using remote control, ensure the remote control is equipped with light function and ensure the wires are connected correctly.

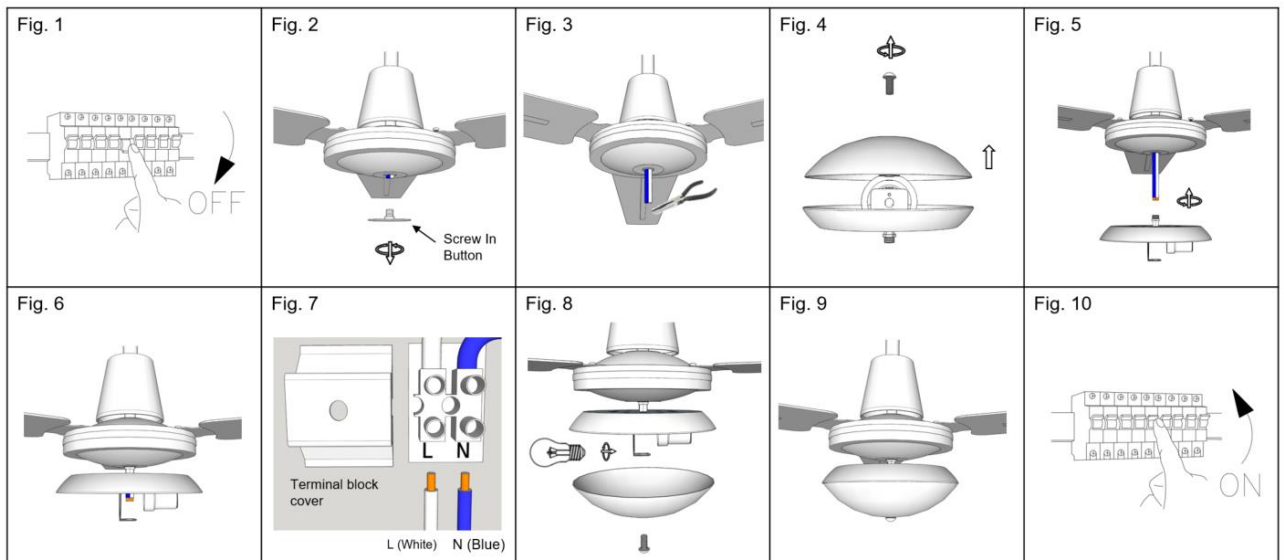



# OYSTER LIGHT KIT (E27 HOLDER) FOR PACIFICA AC CEILING FAN – 21899/05 (WHITE COLOUR)

## WARNINGS

- Do not operate this fitting in harsh environmental conditions such as building sites.
- Do not install it on surfaces which can move or vibrate.
- Do not immerse any part of the fitting into water or any liquid.
- Ensure wire connections are firm.
- Do not attempt to perform modification or change parts within the light fixture.
- Dispose of packaging thoughtfully.

## Recommended Brilliant Ceiling Fan

Fan	Model Number
PACIFICA 48"	21896/05
PACIFICA 56"	21897/05

## Warranty:

Brilliant Lighting warrants this product against defects in manufacture and workmanship for a period of 1 year from date of purchase or as specified elsewhere. For products used in non-domestic or commercial applications, Brilliant Lighting warrants this product for a period of 3 months from date of purchase. This warranty is only valid for products installed and operated within the guidelines specified by Brilliant Lighting, and within the correct operating voltage ranges as stated on the product's rating label.

Warranty does not include damage or loss arising from incorrect installation, operation or maintenance of this product, damage caused through modification, incorrect installation, service by unqualified or unauthorised personnel or lack of regular maintenance and cleaning. Proof of installation by qualified personnel may be required, e.g. Electrical Safety Certificate. Proof of purchase must be supplied with all warranty claims.

This warranty is provided in addition to any other rights and remedies of the customer under any law. In applications not intended for household, personal or domestic use, liability is limited to replacement or reimbursement of product only. Brilliant Lighting does not warranty the costs of removal or re-installation of this product or associated components.

The warranty does not cover Ripple Control noise/interference (identified by a periodic or intermittent hum). This must be addressed with your energy service provider. The warranty does not cover noises or faults due to poor installation

*Our goods come with guarantees that cannot be excluded under the Australian Consumer Law. You are entitled to a replacement or refund for a major failure and compensation for any other reasonably foreseeable loss or damage. You are also entitled to have the goods repaired or replaced if goods fail to be of acceptable quality and the failure does not amount to a major failure.*

Any claim under this warranty must be made within the specified warranty period from date of purchase of this product. To make a claim under the warranty; at your own expense take the product (with proof of purchase – receipt or similar) to the store where you purchased the product or contact Brilliant Lighting at the address below.

This warranty is given by:

**Brilliant Lighting (Aust) Pty. Ltd.**  
**ABN 37 006 203 694**  
**956 Stud Road Rowville, VIC 3178**  
**Phone: 03 9765 2555**  
**Email: [warranty@brilliantlighting.com.au](mailto:warranty@brilliantlighting.com.au)**  
**Web: [www.brilliantlighting.com.au](http://www.brilliantlighting.com.au)**  
**MADE IN CHINA**