

# 3/16/06-07 JEEP LIBERTY REAR REGULATOR REPAIR KIT

**SKU# 2557-0004 - Package Contents:** (1) Window Bracket, (2) Screws, (4) Flat Washers, (2) Lock Washers, (2) Nuts

Figure 1

## 1. Remove the Regulator

Raise the window up to the top of the door by hand. You may need to disconnect the window bracket from the window to do this. Press the pin through the hole in the glass to remove the bracket from the glass. Secure the glass in the up position.

Disconnect the power to the motor, loosen the regulator and motor bolts, unclip the plastic tube from the door, then remove the assembly.

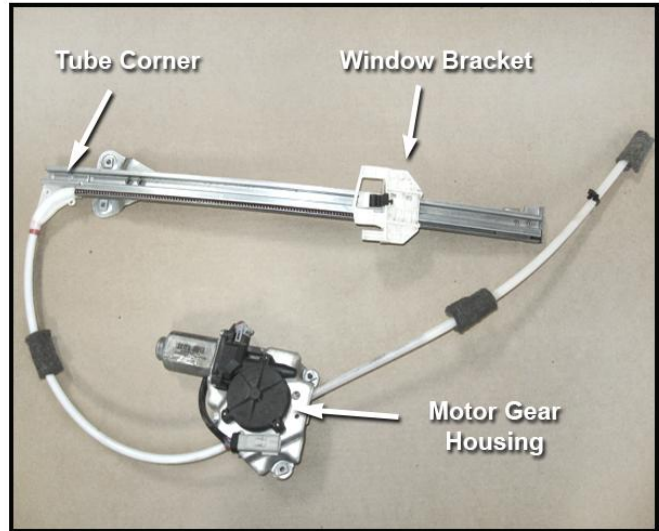

## 2. Disassemble the Regulator

Using a Torx T-20, remove the 3 motor gear housing screws.

Remove the rivet from the tube corner. (Figure 2) Do not damage the rail while removing the rivet. On the opposite side of the rivet, bend the 2 tabs up enough to allow the tube corner to be removed from the rail. (Figure 3)

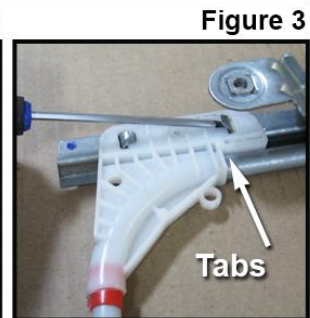
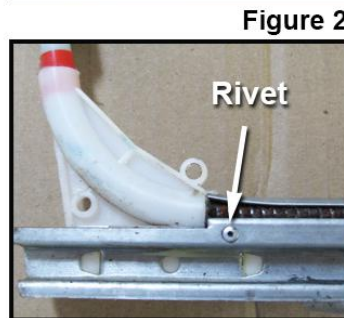

Figure 2

Figure 3

Remove the tube and cable from the rail. Remove any remaining pieces of rivet from the tube corner.



Figure 4

## 3. Modify Spiral Cable, Thread Into Bracket

Remove approximately 1" of the fuzz from 1 end of the spiral cable (a wire wheel works best). (Figure 4) It is most likely necessary to grind down the first thread on the spiral cable to get it to screw into the bracket more easily.

Screw the spiral cable onto the new window bracket as shown. (Figure 5) Threading the cable onto the bracket takes some force. The cable needs to extend about 1/8" past the last loop on the bracket

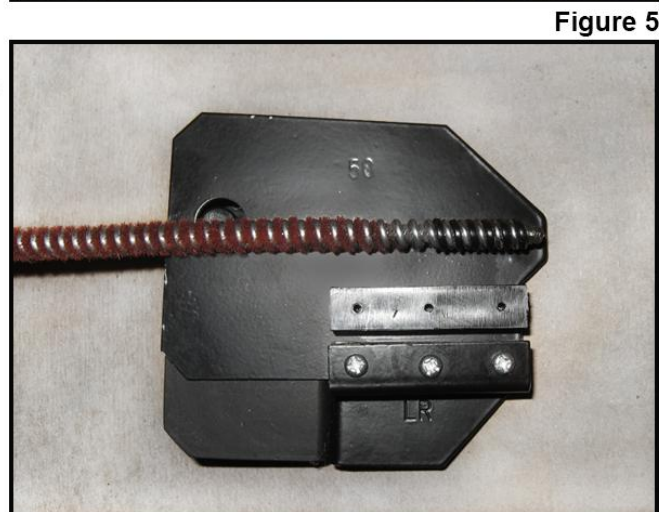

Figure 5

## 4. Slide New Bracket onto Guide Rail

Slide the new window bracket/cable assembly into the guide rail. (Figures 6 & 7) Run the bracket up and down in the guide rail a few times. There can not be any binding or excessive friction.

If you feel binding, check to see if the loops on the bracket were bent out of alignment during the installation of the cable to the bracket. Wear in the powder coat on the loops of the bracket may show you where the bracket is binding. Bend them back into place if needed.

## 5. Re-assemble the Regulator

Run the cable back into the plastic tube. Bring the plastic tube and guide rail together, putting the plastic corner over the metal tabs.

Use one of the screws provided (only 1 is used) to replace the tube corner rivet. Insert the screw with 1 flat washer on it through the rail, then use the other flat washer, the lock washer, and nut on the "tabs" side of the assembly. (Figure 8) Bend the 2 metal tabs down before you tighten the screw.

Install the motor back onto the regulator, making sure the gear is fully seated in its original position.

## 6. Re-Install and Test the Regulator

Reinstall the regulator into the door.

Using the window switch, position the window bracket so that you are able to see it in the door opening. Lower the glass into the window bracket, in between the 2 sides of the rubber sleeve. (Figure 9) Push the window bracket pin to allow the glass to slide completely into the sleeve. Ensure the pin is through the glass and locked into place.

Test the operation of the window a few times. Look and listen for any issues.

Figure 6

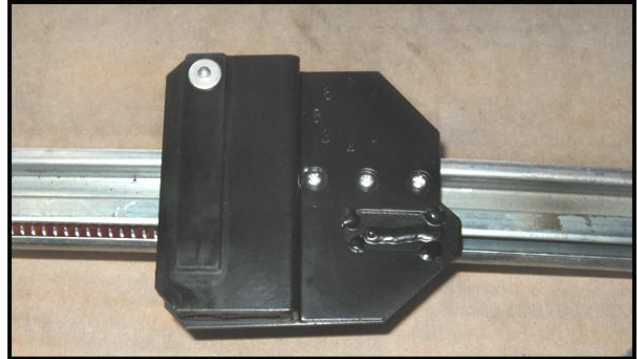

Figure 7

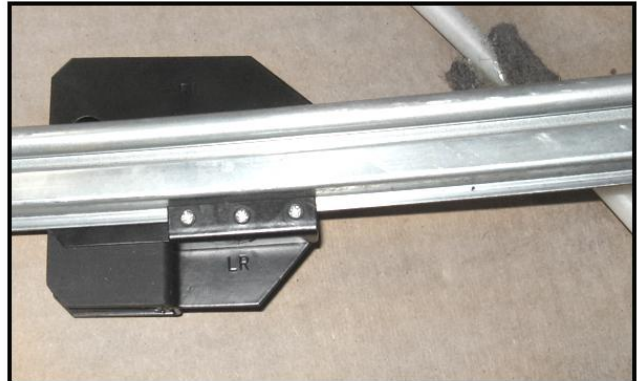

Figure 8

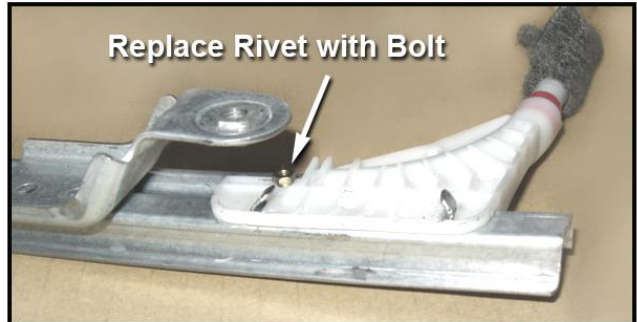

Figure 9

