



Fire and Rescue

Helmets and Accessories





Quality
Designed with you in mind, Bullard fire helmets offer durability, design, and dependability. Bullard fire helmets are built to last.

Comfort
Made with adjustments for fitting, Bullard fire helmets are designed for a comfortable fit and offer removable parts for easy replacement.

Choices
Bullard offers the most expansive line of head protection for structural, ARFF, wildland, and emergency/search and rescue applications in the world.

Expertise
Known for our engineering and design expertise, Bullard puts protection and comfort at the forefront of our products.

Innovation
Leading the market in innovation since the launch of the first fiberglass fire helmet in 1947, Bullard introduced the first thermoplastic fire helmet, first optically correct faceshield, and first fully integrated helmet lighting solution.

Best in Class Warranty
Bullard offers a best in class warranty. Bullard warrants to the original purchaser that the firefighter helmet and non-electronic components are free of defects in materials and workmanship under normal use and service for a period of five (5) years from the date of manufacture on the helmet shell and lifetime (as defined in NFPA 1851: 10 years) warranty on the non-electronic components.

Table of Contents

ReTrak Helmet Series.....3
UST Traditional Structural Series.....5
FX/PX Contemporary Structural Series7
LT Contemporary Structural Series.....9
AX ARFF Series11
Wildfire® Wildland Series.....12
USRX Urban Search and Rescue Helmet13
Advent® Rescue Series.....13
Magma® Series14
Accessories15
Leather Fronts17
Badges and Ornamentation.....17



UST ReTrak™ Helmet Series
Traditional Thermoglas® Fiberglass



FX and PX ReTrak™ Helmet Series
Lightweight, heavy-duty Thermoplastic or Fiberglass



LT Structural Series
Low-profile Thermoplastic



AX ARFF Series
Specialized for Air Rescue Firefighting



Wildfire® Wildland Series
Tough shell and lightweight design for wildland firefighters



USRX Search and Rescue Helmet
Extreme urban search and rescue



Advent® ER and Rescue Series
Advanced protection, lightweight



Magma® Series
Magma Helmets are EN 443-2008 Certified



Accessories & Ornamentation

Available Colors

Model	Red	White	Yellow	Black	Blue	Orange	Lime Yellow	Pink	Green	Camo	Pink Camo	Winter Camo	Blaze Camo	Glow	Silver	Fluorescent Red	Fluorescent Yellow
UST	●	○	●	●	●	●	●	●	●								
USTM (Matte)	●	○	●	●						●	●	●	●				
FX	●	○	●	●	●	●	●	●	●								
PX	●	○	●	●	●	●	●										
LT	●	○	●	●	●	●	●										
AX	●	○	●	●	●	●	●										
Wildfire	●	○	●	●	●	●	●										
USRX	●	○	●	●	●	●	●										
Advent	●	○	●		●	●											
Magma	●	○	●	●	●	●			●					●	●	●	●

ReTrak™ Helmet Series

The ReTrak Helmet Series offers emergency responders a fire helmet with an integrated visor engineered based directly on feedback from firefighters

ReTrak Features:

- Simple one-handed operation
- Easily accommodates eyewear
- Increased area of protection
- Comfort nosepiece
- Quick removal for cleaning
- Made in the USA

Traditional UST/USTM and PX/FX ReTrak Helmets are now available and meet NFPA 1971/ANSI/ISEA Z87.1+ requirements.



UST Series Helmets



UST with TrakLite and Leather Front

UST Series structural firefighter helmets provide classic traditional style in an affordable, easy-to-maintain design. With an outer shell made of Thermoglas®, the UST offers toughness and durability. Chipping and cracking found in conventional fiberglass is virtually eliminated. Thermoglas qualities also include the highest level of chemical resistance and stability at extreme temperatures.

Available in either glossy finish (UST) or a matte finish with a textured, non-glossy look (USTM), the UST Series helmets are the preference of the traditional firefighter. Get the look of a leather helmet with the protection of an NFPA 1971 certified model. UST helmets are available with ReTrak™ and TrakLite®. See page 15 for details.

UST Series Helmets

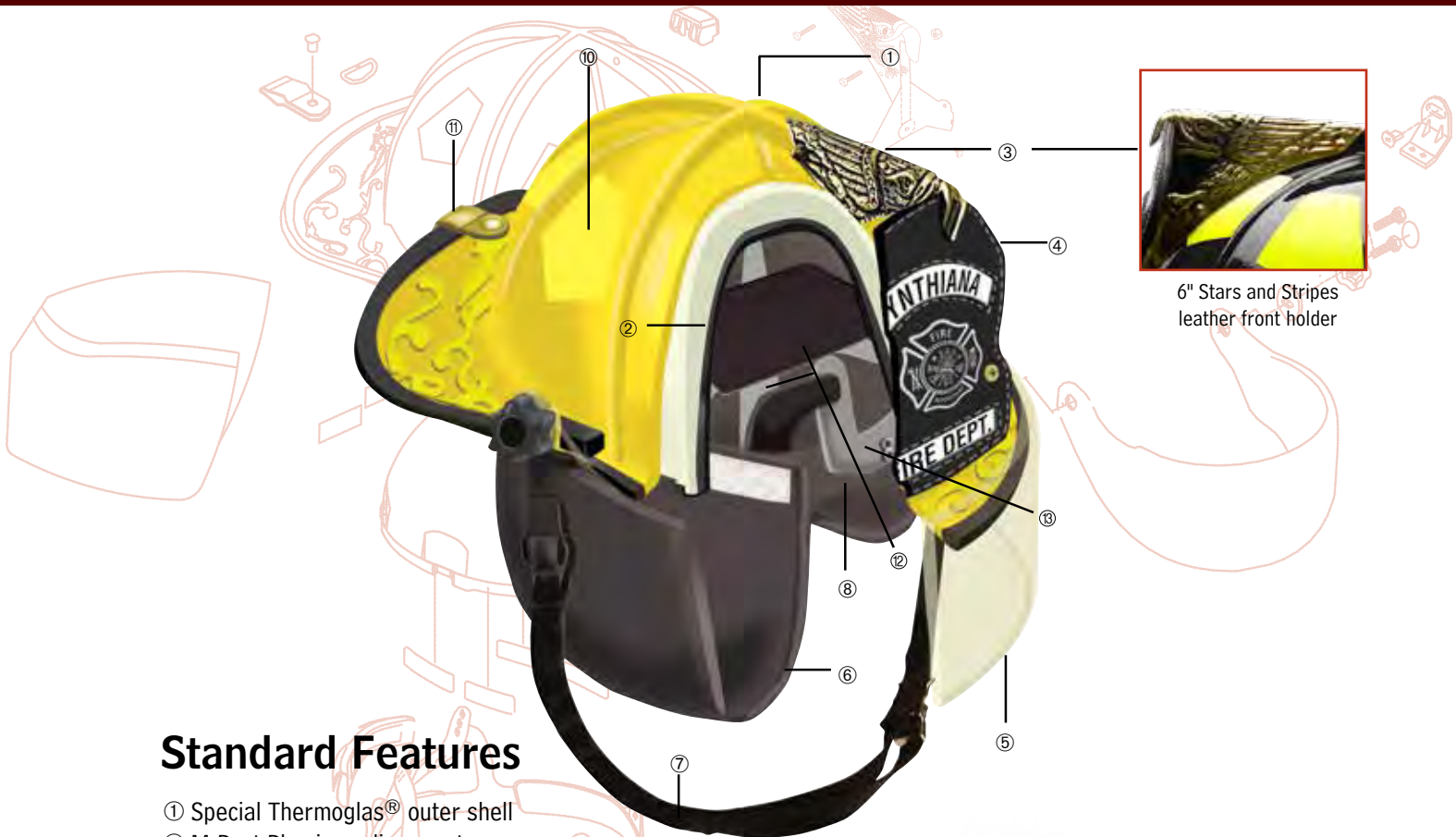

Standard Features

- ① Special Thermoglas® outer shell
- ② M-Pact Plus inner liner system
- ③ Replaceable brass eagle or Canadian maple leaf
- ④ Custom leather front (sold separately)
- ⑤ 4" optically correct faceshield or ESS goggles
- ⑥ Nomex® ear/neck protector
- ⑦ Chinstrap with postman's slide
- ⑧ Sure-Lock® ratchet headband with comfort brow pad
- ⑨ Leather ratchet cover (not shown)
- ⑩ Scotchlite® reflective markings
- ⑪ Brass D-ring
- ⑫ Crown straps with crown pad
- ⑬ U-Fit system with 36 comfort settings



Optional Features

- ①A ReTrak Integrated Helmet Visor
- ②A TrakLite Integrated Helmet Lighting

UST Series Striping Options Offer Additional Accountability

		• Lime-Yellow Scotchlite® Retroreflective Stripes
		• Red-Orange Scotchlite Retroreflective Stripes
		• Lime-Yellow Triple Trim Scotchlite Retroreflective Stripes
		• Red-Orange Triple Trim Scotchlite Retroreflective Stripes

NFPA 1971 Certified

FX Series and PX Series Helmets



PX with TrakLite and Leather Front

The FX and PX Series from Bullard offers a lightweight contemporary look with a lower profile and less restrictive, compact design than traditional styles. FX and PX Series helmets comply with NFPA, Australian, and European requirements, as well as advanced military fire standards.

FX Series

FX composite helmets are resistant to chemical attack and stable under high heat exposure. Featuring color pigment that is molded directly throughout the outer shell, nicks and chips are less visible.

PX Series

The PX helmets have an advanced, specially formulated, high-heat thermoplastic outer shell, which makes the PX the ideal fire helmet for heavy duty applications. No other fire helmet has the proven on-the-job performance or long-lasting durability of the PX.

The FX and PX Series Helmets are available with ReTrak and TrakLite®. See page 15 for details.

FX Series and PX Series Helmets



Standard Features

- ① Fiberglass (FX) or Thermoplastic (PX) outer shell
- ② M-Pact Plus inner liner system
- ③ 4" optically correct faceshield or ESS goggles
- ④ Nomex® ear/neck protector
- ⑤ Chinstrap with postman's slide
- ⑥ Sure-Lock® ratchet headband with comfort brow pad
- ⑦ Leather ratchet cover (not shown)
- ⑧ Scotchlite® reflective markings
- ⑨ Stainless steel D-ring
- ⑩ Crown straps with crown pad
- ⑪ U-Fit system with 36 comfort settings

Optional Features

- ①A ReTrak Integrated Helmet Visor
- ②A TrakLite Integrated Helmet Lighting



NFPA 1971 Certified
EN443 Certified (FXE)
AS/NZS 4067 (PXAS)

FX and PX Series Striping Options Offer Additional Accountability



- Lime-Yellow Scotchlite® Retroreflective Stripes
- Red-Orange Scotchlite Retroreflective Stripes

LT Series Helmets



LT with TrakLite and Leather Front

The LT Series is an advanced, lightweight, thermoplastic structural fire helmet that incorporates 20 years of Bullard polymer technology and engineering expertise.

Beyond the compact, low-profile design, the LT Series features the innovative Quick-Attach Blade System for rapid installation and removal of both faceshields and goggles without any tools. Simply press on or off the faceshield or goggle in seconds, creating flexibility to choose the right option for the right application.

The LT offers the lightest configuration in an NFPA 1971 compliant fire helmet on the market. Experience a reduction in stress and fatigue with this lightweight helmet, without giving up performance. The LT Series Helmets are available with TrakLite®. See page 16 for details.

LT Series Helmets



Standard Features

- ① High-heat Thermoplastic outer shell
- ② M-Pact inner liner system with SmartRidge design
- ③ Quick-Attach blade system
- ④ 4” optically correct faceshield or ESS goggles
- ⑤ Rip-stop Nomex® ear/neck protector
- ⑥ Chinstrap with postman’s slide
- ⑦ Sure-Lock® ratchet headband
- ⑧ Leather ratchet cover (not shown)
- ⑨ Scotchlite® reflective markings
- ⑩ Stainless steel D-ring
- ⑪ Four-point crown strap assembly
- ⑫ U-Fit system with 36 comfort settings



Optional Features

- ①A TrakLite Integrated Helmet Lighting

NFPA 1971 Certified

LT Series Stripping Options Offer Additional Accountability	
	<ul style="list-style-type: none">• Lime-Yellow Scotchlite® Retroreflective Stripes• Red-Orange Scotchlite Retroreflective Stripes

AX Series Air Rescue Fire Fighter Helmets

Wildfire® Series Helmets



AX Series helmets are engineered specifically for the adverse environmental conditions during proximity fire fighting incidents that release high levels of radiant, convective, and conductive heat.

The standard AX model is based on either the FX, UST, or USRX or structural fire helmet platform. When combined with an aluminized helmet shell cover, aluminized shroud, and a 6" gold-coated faceshield, it meets the proximity fire fighting protective helmet requirements of NFPA 1971.

Standard Features

- ① Fiberglass or Thermoplastic (USRX) outer shell
- ② Inner liner system
- ③ 6" gold-coated faceshield
- ④ Sure-Lock® ratchet headband with comfort brow pad
- ⑤ Aluminized helmet cover
- ⑥ Standard aluminized shroud
- ⑦ Crown straps with crown pad
- ⑧ U-Fit system with 36 comfort settings

NFPA 1971 Certified



FH911C Series Helmets

The C Series is the traditional cap style wildland helmet. The lightweight, low-profile design offers superior protection in all wildland firefighting conditions. FH911C Series helmets exceed all NFPA 1977 requirements, as well as ANSI/ISEA Z89.1, Type I, Class E & G.

FH911H Series Helmets

Bullard H Series is a full-brim style wildland helmet. With a 360-degree brim, the H Series provides additional protection from sunlight, as well as airborne debris. FH911H Series helmets exceed all the requirements of NFPA 1977 as well as ANSI/ISEA Z89.1, Type I, Class E & G.

FH911XL

Same as Model FH911H with extra-large full-brim thermoplastic shell. Available with ratchet suspension only.

NFPA 1977 and ANSI/ISEA Z89.1, Type I, Class E & G Certified

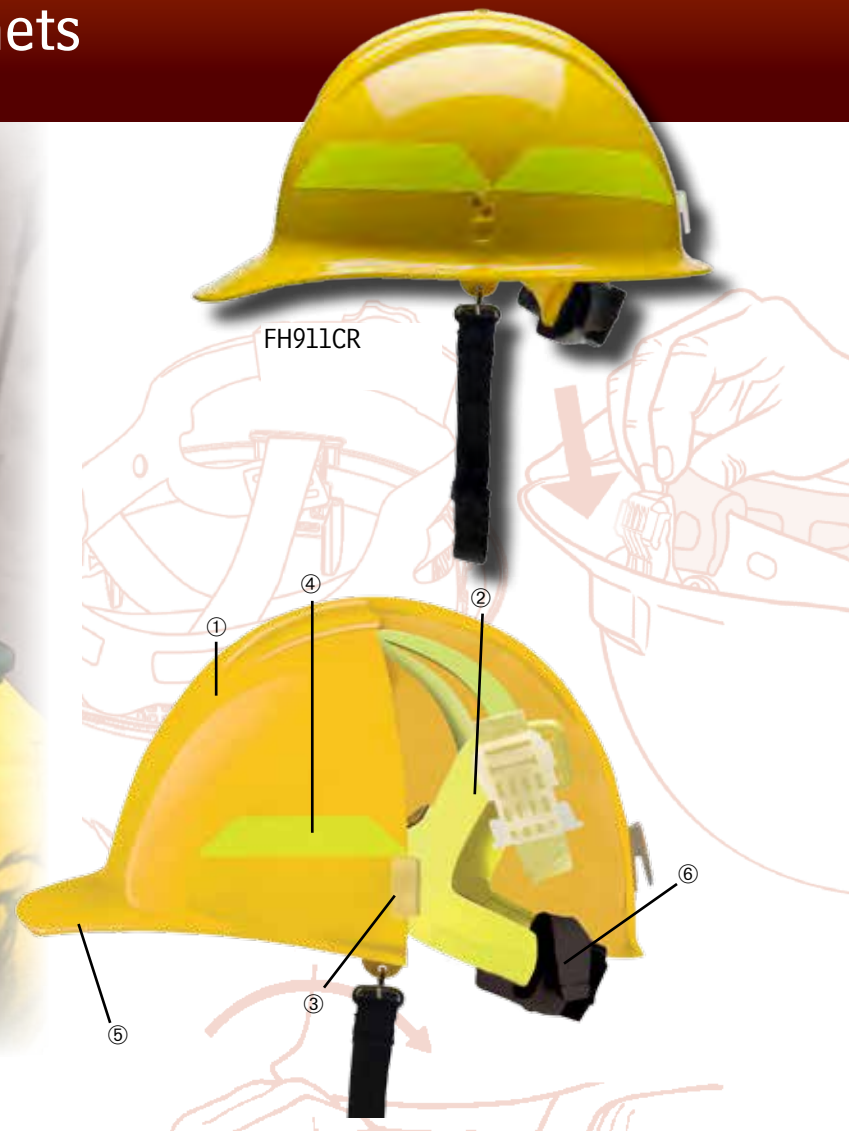

Standard Features

- ① Heat-resistant Thermoplastic outer shell
- ② 6-point FRS6PC (pinlock) suspension or FRS6RC (ratchet)
- ③ Goggle clips
- ④ Scotchlite® reflective markings
- ⑤ Underbrim anti-glare strip
- ⑥ Leather ratchet cover (on ratchet models)
- ⑦ Velcro® attachments inside shell for Ear/Neck Protector (not shown)

Wildfire Series Stripping Options Offer Additional Accountability



- Lime-Yellow Scotchlite® Retroreflective Stripes
- Red-Orange Scotchlite Retroreflective Stripes

Search and Rescue Helmets



Advent® Series Rescue Helmets

The Advent® helmet offers paramedics, emergency medical personnel, hazardous response teams, and search and rescue personnel a revolutionary concept in head protection. This helmet provides top, front, side, and rear impact and penetration protection. Advent meets and exceeds ANSI/ISEA Z89.1, Type II, Class E & G requirements and is half the weight of conventional firefighter helmets.

USRX Urban Search and Rescue Helmet

USRX rescue helmets are engineered for extreme search and rescue conditions. Featuring a streamlined design, USRX rescue helmets incorporate recommendations from USAR teams and other rescue professionals. The result is an integrated assembly of advanced materials and quality components that provide superior head protection, comfort, and long-lasting durability. The USRX is dual certified to meet both NFPA 1951 and NFPA 1971 for Urban Search and Rescue and Structural Firefighting.



USRX



Standard Features

- ① High-heat Thermoplastic outer shell
- ② M-Pact inner liner system with SmartRidge design
- ③ Quick-Attach blade system
- ④ ESS goggles or 4" faceshield
- ⑤ Nomex® ear/neck protector
- ⑥ Three-point chinstrap
- ⑦ Sure-Lock® ratchet headband
- ⑧ Leather ratchet cover (not shown)
- ⑨ Four-point crown strap assembly
- ⑩ U-Fit system with 36 comfort settings

Magma® Series Helmets



Magma Type B



Magma® Helmets

The Magma® helmet system is based on a platform that enables firefighters to configure their individual helmet. Whether a type A half-shell helmet or type B three-quarter-shell helmet, the construction kit offers it all, while keeping the design thoroughly consistent and lightweight. The system allows for customized choices without compromising comfort, safety, and functionality.

Magma® Helmets are EN 443 Certified; Visor and Eye Protection is EN 14458 Certified.

NOTE: While Magma helmets are not NFPA-compliant, Bullard European style FX (FXE) complies with NFPA and CE requirements.

Standard Features

- ① Fiberglass outer shell
- ② Spacious inner visor
- ③ Customizable front frame
- ④ Polyurethane inner liner
- ⑤ Ratchet head ring
- ⑥ Flashlight adapter
- ⑦ Chin Strap
- ⑧ Nomex® ear neck protector (non-standard)



ReTrak™ Integrated Visor

The ReTrak Helmet Series offers emergency responders a fire helmet with an integrated visor that easily accommodates eyewear and features a simple one-handed operation. ReTrak is available for Bullard's UST/USTM Traditional and FX/PX Modern Helmets.



ESS FP2 Goggles

Goggles

Eye Safety Systems (ESS) brand of goggles are available in a variety of designs to meet any structural, rescue and wildland requirements for eye protection. Bullard, in conjunction with ESS, has developed and certified specific ESS goggles for use with all Bullard helmets. These high performance goggles provide additional eye protection options that can address primary eye protection issues defined in NFPA 1500, OSHA Standards 29CFR, and ANSI/ISEA Z87.1 requirements.

Faceshields

Available in 4- and 6-inch sizes, Bullard offers faceshields to fit any structural, ARFF, and rescue application.



Bourke Eyeshields

Bourke eyeshields (Non-NFPA) are available for purchase.



TrakLite® Helmet Integrated Lighting

Bullard's UST, FX, PX, and LT are available with TrakLite® helmet lighting. Featuring eight forward-facing, long-lasting, bright LED lights, TrakLite is the only light on the market that is integrated into the helmet design for excellent weight balance and illumination.

* TrakLite is CSA-certified Nonincendive Electrical Equipment for use in Class I, Division 2 Hazardous Locations.

Ear/Neck Protectors

Standard on many helmet models, Bullard ear/neck and face protection is offered in Nomex® and PBI/Kevlar® options. Flame-retardant facecloth and moisture barrier options enhance the comfort and protection needed for any fire and rescue condition.



Model R223 Ear/Neck Protector



REDEFINED

Up to 22 **BOLD** characters

REENGINEERED

Strong **CRISP** stitching

REFINED

Rugged, high **QUALITY** leather

RECREATED

Easily **CUSTOMIZED** at
www.BuildYourBullard.com



Build Your Bullard

Easy. Complete. Personal.



Leather Fronts. Reimagined.

Bullard's reengineered leather fronts accommodate up to 22 bold characters. These rugged, high quality leather fronts are available in four (4) distinct styles with strong, crisp stitching. Choose from patent-leather or flat-finish genuine leather.

Badges and Ornamentation

Customize your department's head protection for increased visibility, quick on-scene accountability, and promotion. Choose from a variety of options; special customization available upon request.

Visit www.BuildYourBullard.com to build the leather front that meets your needs.



Bullard
LOGO SHOP

Your logo can be
pad printed on the FX,
PX, LT, USRX, Advent,
Wildfire, and Magma
helmets.



- Build **YOUR** fire helmet and leather front at www.BuildYourBullard.com
- Choose your style, color, text, ornamentation, and more!





Americas:
Bullard
1898 Safety Way
Cynthiana, KY 41031-9303 • USA
Toll-free within USA: 877-BULLARD (285-5273)
Tel: +1-859-234-6616
Fax: +1-859-234-8987

Europe:
Bullard GmbH
Lilienthalstrasse 12
53424 Remagen • Germany
Tel: +49-2642 999980
Fax: +49-2642 9999829

Asia-Pacific:
Bullard Asia Pacific Pte. Ltd.
LHK Building
701, Sims Drive, #04-03
Singapore 387383
Tel: +65-6745-0556
Fax: +65-6745-5176

©2017 Bullard. All rights reserved.
Bullard, Advent, Magma, Sure-Lock, Thermoglas, TrakLite, and Wildfire are registered trademarks of Bullard.
ReTrak is a registered trademarks of Bullard.
Nomex and Kevlar are trademarks of DuPont Company.
Scotchlite is a trademark of 3M Corp.
Ultem is a trademark of General Electric.
Velcro is a registered trademark of Velcro USA.
8057 (0417)



ISO 9001
certified

www.bullard.com

BETTER UNDER FIRE.



Bullard®

www.bullard.com

magma

The new Magma fire helmet platform concept.

Choose your personalized Magma from two unique configurations, Type A (half size shell) or Type B (three-quarter size shell) with a unified look

- Sleek design accommodates a wide variety of accessories and electronic components
- Can be easily reconfigured for new applications
- Magma offers low weight and the most superior comfort in its class
- Built Bullard Tough – meeting your expectations

* Helmet type A and B according to EN443:2008

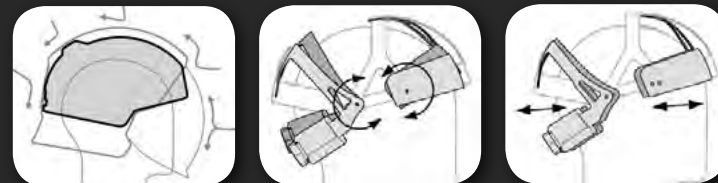

The layout of the platform, outer shell and visor encloses the inner compartment against all risks. No comparable helmet offers a similar protection against heat, flames, sparks and fluids.

The Magma head ring is made from just three components. Clearly laid out and easy to operate.

The front and rear height of the head ring can be adjusted separately, just like the wearing height.

These functions ensure sufficient space for a perfect fit of the protective goggles, the mask and for maximized head size coverage from 50-65 cm.



Strap system with 4-point attachment, adjusts itself automatically. Easy adjustment even with gloves on. The x-shaped design of the neck straps fits comfortably and obtains best results in pull off test.

The three-dimensional visor covers the retracted front frame for a maximum upper and lateral field of view, while also covering the complete face up to the chin, leaving enough space for spectacles, protective goggles and even a respirator mask.

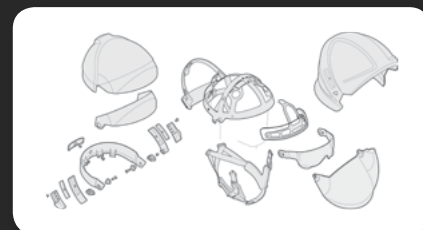

The helmet is compatible with all conventional respirator masks – whether with rubber straps or adjustable two-point mask connection.

Radio with bone or swan microphones are located where it should and can be mounted in no time and without using tools to the designated attachment points.

Lighting

By intention Bullard decided not to go with a torch model orientated system due to the fast evolvement of the LED technology and the large variety of requirements.

The newly developed torch adapter from Bullard can accommodate most types of torches.

The adapter is attached to the ergonomical position: below the eye line, for a low-reflection illumination even in intensive smoke conditions and also for a low centre of gravity.

Neck Protector

Neck protector made from Nomex or aluminized aramid fiber with inner layer. „Dutch Ear-Neck-Protector 2-layer version or 4-layer version with watertight membrane.



Colors and Ranking

Magma offers a huge range of colors and color combinations as well as various options for ranking by colors, logos and text on the front frame „beneath the visor“ or on the outer shell.

- modular platform concept
- optional bi-colour design
- largest protection zone
- designed to prevent from view and hearing restrictions
- largest visor, full face protection
- full inside insulation against hazards
- multiple adjustments for perfect fit
- universal light adaption
- only 29 components for easy handling, maintenance and low lifetime costs
- no fix life time limitation



Americas:
Bullard
1898 Safety Way
Cynthiana, KY 41031-9303 • USA
Toll-free within the USA:
877-BULLARD (285-5273)
Tel: +1-859-234-6616
Fax: +1-859-234-8987

Europa:
Bullard GmbH
Lilienthalstrasse 12
53424 Remagen • Tyskland
Tel: +49-2642 999980
Fax: +49-2642 9999829

Asia-Pacific:
Bullard Asia Pacific Pte. Ltd.
LHK Building
701, Sims Drive, #04-03
Singapore 387383
Tel: +65-6745-0556
Fax: +65-6745-5176



www.bullard.com

Magma is a registered trademark of Bullard.
8395 EN (0915)



FIREFIGHTING HELMET

FOR ONBOARD VESSEL



Model: H1500

Luminescent, Ratchet Suspension
Option: Leather/Nomex neck-protector



Model: H1000

Yellow, Pinlock Suspension
Leather neck-protector

EN443:2008 CERTIFIED
SOLAS/MED APPROVED

