

### READ ALL INSTRUCTIONS AND WARNINGS BEFORE WEARING THIS HELMET

Carefully read and understand these instructions. Use this helmet exclusively for the activities for which it is certified (see labeling) and in strict accordance with ANSI/ISEA Z89.1. Please refer to the shell label for specific standard "Type" and "Class."

#### WARNING

Hard hats/helmets are designed to provide limited protection to the head by reducing the force of falling objects striking the top of the hat shell. While limited protection is provided in other parts of the shell, this helmet was not designed to provide front, side, or rear impact protection. Avoid contact with electrical wires. Never alter or modify the shell or suspension system. Always use Bullard replacement parts. Improper use of this helmet can cause serious or fatal injury. If the instructions are not followed correctly the level of protection offered by the helmet can be significantly reduced.

Inspect your helmet regularly. Check for cracks and any sign of damage before each use. Replace helmet immediately if you notice any signs of wear, damage, abuse, or environmental degradation. If the helmet has sustained a forcible blow/impact, dispose of immediately, even if damage is not visible. Failure to follow these warnings could result in death or serious injury.

Intended use of this helmet involves activities that are extremely dangerous. Failure to follow these instructions and any of these warnings may result in serious injury or even death.

For adequate protection this helmet must fit or be adjusted to the size of wearer's head (see Adjusting the Suspension Size below). The helmet is made to absorb the energy of a blow by partial destruction to the shell or foam liner, and even though such damage may not be readily apparent, any helmet subjected to severe impact should be replaced. The attention of users is also drawn to the danger of modifying or removing any of the original component parts of the helmet other than as recommended by the helmet manufacturer. Helmets should not be adapted for the purpose of fitting attachments in any way not recommended by the helmet manufacture. Do not apply paints, solvents, adhesives, or self-adhesives except in accordance with instructions from the helmet manufacturer. Minimum operating temperatures as marked. Provides electrical insulation as marked.

### INSTRUCTIONS FOR USE

#### Adjusting the Suspension Size:

The Cen10 helmet is equipped with the FlexGen ratchet suspension. To adjust the suspension, turn ratchet knob counterclockwise until headband opens to largest size. Place helmet on your head and turn ratchet clockwise until it fits comfortably snug.

DO NOT OVERTIGHTEN. See Figure 1



Figure 1

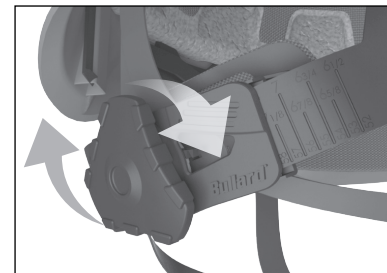

#### Replacement Recommendations:

Bullard recommends replacement every 12-18 months or more frequently as needed for key replaceable parts such as the comfort crown pad liner, ratchet cover, brow pads, and chin strap.

#### Replacement Parts Instructions:

The comfort crown pad liner, ratchet cover, and brow are easily removed as these are attached via Velcro. To remove and replace the chin strap, unclip from the helmet and attach new piece. See Figure 2

Figure 2

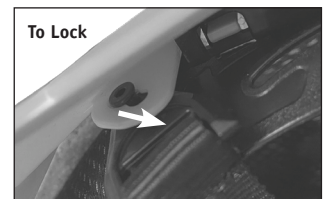
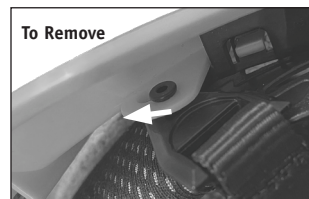

#### Cleaning, Replacing, and Storage:

Clean the helmet with mild soap and lukewarm water. Do not use paint, solvents, chemicals, adhesives, gasoline, or like substances on this helmet. The impact resistance and other protective properties of the helmet may be diminished by such substances. Damage caused by these substances may not be apparent or readily detectable by the user.

**NOTE:**

Stickers may contain materials that in time can alter the physical properties of the helmet. Before applying any of these products, verify their compatibility with PC/ABS.

**Service Life:**

This helmet does not have an indefinite service life. Conditions found in many work environments such as exposure to ultraviolet light, temperature extremes, chemical exposure, and wear and tear from daily use will reduce the protective properties of the helmet over time.

The helmet in its entirety should be replaced every five years. Please refer to your company guidelines to see if your employer has a specific replacement program. It is noted that you must inspect your helmet regularly for cracks or any damage before use. If any damage appears, this will compromise the protection the helmet is providing. It is noted that while Bullard is recommending replacement of the helmet every 5 years, due to working condition such as environment, storage of helmet, chemical exposure, etc., you may need to replace the helmet prior to the 5 year mark.

**Storage:**

Store helmet in clean, dry environment, not over 120 degrees (49 degree C). Do not store in direct sunlight. Do not store helmet in areas such as the dashboard of an automobile or truck bed of work vehicle.

**Three-Year Limited Warranty**

Bullard warrants to the original purchaser that the helmet system is free of defects in materials and workmanship under normal use and service for a period of three years from the date of manufacture. Under this warranty, Bullard's obligation is limited to repairing or replacing articles that are returned within the warranty period and that, after examination, are shown to Bullard's satisfaction to be defective, subject to following limitations:

- Helmet must be returned to Bullard with shipping charges prepaid;
- Helmet must not be altered from its original factory configuration; and
- Helmet must not have been misused, abused, or damaged in storage or transit.

In no event shall Bullard be responsible for damages resulting from loss of use or other indirect, incidental, consequential or special costs, expenses or damages incurred by purchaser, notwithstanding that Bullard has been advised of the possibility of such damages.

ANY IMPLIED WARRANTIES, INCLUDING WARRANTIES OF MERCHANTABILITY AND FITNESS FOR PARTICULAR PURPOSE, ARE LIMITED TO THREE (3) YEARS FROM THE DATE THE PRODUCT WAS MANUFACTURED.

The above imitations or exclusions may not apply in all states. Some states do not allow the exclusion or limitations of incidental or consequential damages or allow limitations on how long an implied warranty lasts. This warranty gives you specific legal rights, and you may have other rights which vary between states.

**Return Authorization:**

Contact Bullard Customer Service to obtain written permission to return product. Material returned for credit will be subject to factory inspection.

Current products or products under warranty may be subject to a restocking charge. Returned articles should be sent to Bullard with shipping prepaid.

**Use and care booklet**  
**Cen10 Safety Helmet**  
**For Industrial Use**

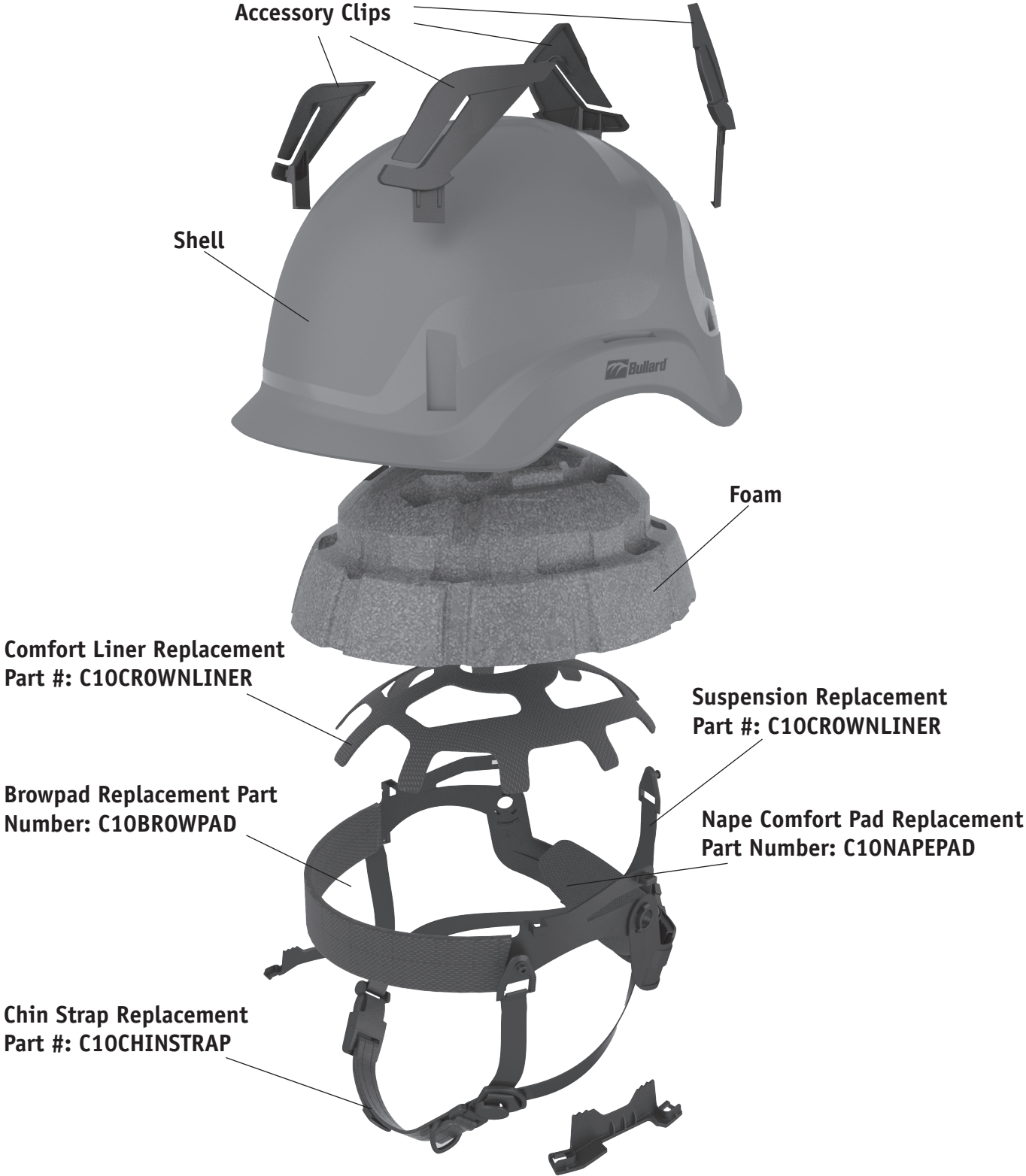



**Bullard Center**  
2421 Fortune Drive  
Lexington, KY 40509 • USA  
877-BULLARD (285-5273)  
Tel: +1-859-234-6616  
Fax: +1-859-246-0243

**Americas Operations**  
1898 Safety Way  
Cynthiana, KY 41031 • USA  
877-BULLARD (285-5273)  
Tel: +1-859-234-6616  
Fax: +1-859-234-8987

**Bullard GmbH**  
Dieselstrasse 8a  
53424 Remagen • Germany  
Tel: +49-2642 999980  
Fax: +49-2642 9999829

**Bullard Asia Pacific Pte. Ltd.**  
51 Changi Business Park Central 2  
#03-04 The Signature  
Singapore 486066  
Tel: +65 6745 0556

©2022 Bullard. All rights reserved.