

EPN-51927



GRAVITY LATCH WITH 1-SIDED KEY ENTRY (STANDARD & DECORATIVE LATCH)

Installation Instructions

English.....	1
Français.....	7
Español.....	13



Read all instructions prior to installing product.
Refer to manufacturers safety instructions when operating any tools.

To register your product, please visit: barretteoutdoorliving.com

▲ WARNING:

- Improper installation of this product can result in personal injury. Always wear safety goggles when cutting, drilling and assembling the product.
- Incorrect installation may cause harm to the gate or individual.
- Not pool code approved.

NOTICE:

- DO NOT attempt to assemble the kit if parts are missing or damaged.
- DO NOT return the product to the store, for assistance or replacement parts call: 1-800-336-2383.

BEFORE YOU BEGIN:

Make sure your gate gap is between $\frac{3}{4}$ " and $1 \frac{1}{4}$ " before starting, this is the working gap range for this latch.

TOOLS NEEDED:

Gate
Safety Glasses
Pencil
Drill
$\frac{5}{16}$ " Drill Bit
$\frac{3}{32}$ " Drill Bit
Phillips Driver Bit/Screwdriver
Hacksaw

Component list:

Item	QTY	Description
1	1	Outer Latch
2	1	Striker
3	2	Outer Bracket Screws
4	7	1" Square/Phillips Self-Drilling Screws
5	2	Keys*
6	1	Outer Bracket

*Included with locking latch styles.

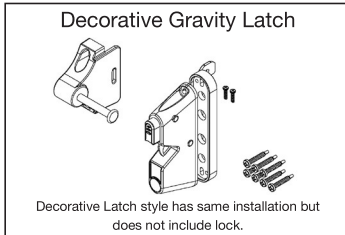

Gravity Latch With One-Sided Key Entry

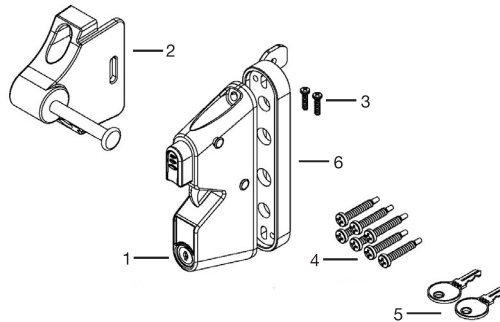

1. Determine height of latch.

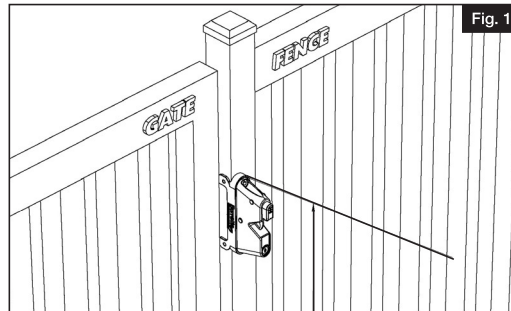

To obtain and review a copy of the warranty please visit: barretteoutdoorliving.com. You may also contact us at 1-800-336 2383 or email Cs.outdoorliving@ebarrette.com

2.

Hold up outer bracket and mark three holes on the front of post (Fig. 2) and two holes on the side of the post (Fig. 3). For right-handed installation refer to Figures 4 and 5.

Left-Handed Installation:

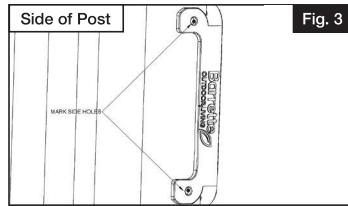
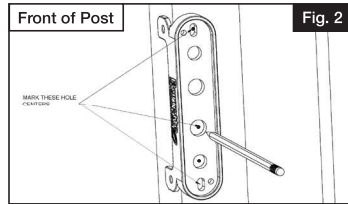

Right-Handed Installation:

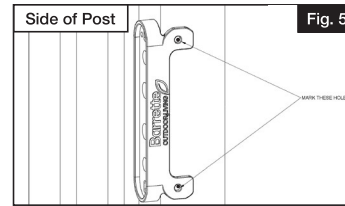
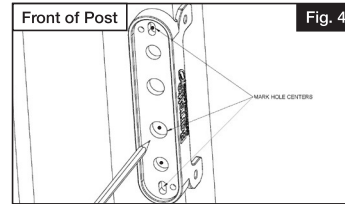

3.

Screw outer bracket to outer latch using small outer bracket screws (Fig. 6). Brackets are reversible and can go on either side of post depending on opening (Fig. 7).

Left-Handed Installation:

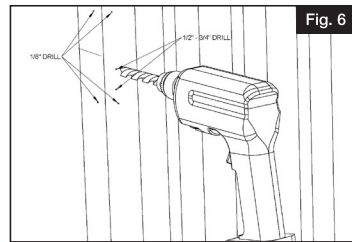

Right-Handed Installation:

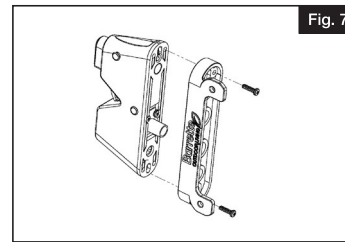

4.

Drill holes according to marks. See illustration for sizes (Fig. 8 and Fig.9). For right-handed installation refer to Figures 10 and 11.

Left-Handed Installation:

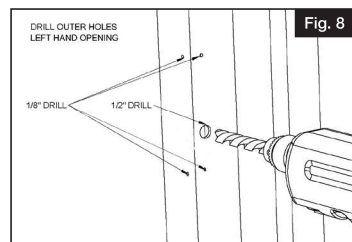

Right-Handed Installation:

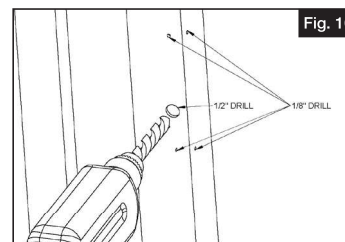

5. Install outer latch using large screws (Fig. 11). For right-handed installation refer to Figure 12.

Left-Handed Installation:

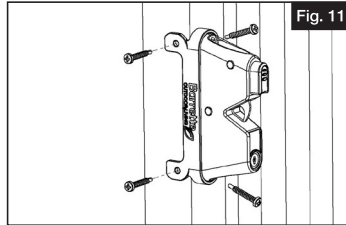

Right-Handed Installation:

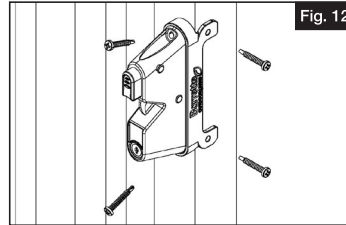

6. Line up striker on gate and attach in middle of latch. Mark a line to indicate the height (Fig. 13).

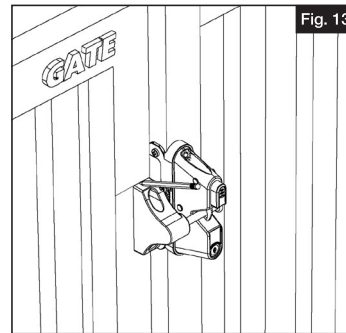

7. Unlatch striker to open gate. Re-align striker with line and mark holes on front and side (Fig. 14).

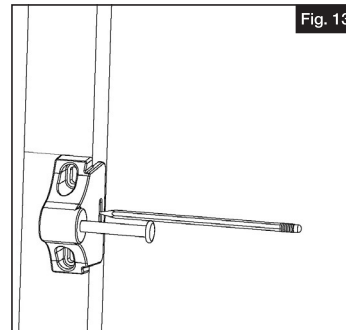

8. Pre-drill with 1/8" drill and then install striker with screws (Fig. 14). Check alignment with latch and adjust striker height if needed.

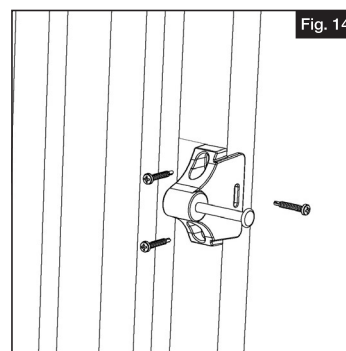



Barrette Outdoor Living
545 Tilton Rd, Egg Harbor City, NJ. 08215
barretteoutdoorliving.com • (800) 336-2383