

# BMS6282 Storage Shed

## ASSEMBLY INSTRUCTIONS

### BMS6282 Remises de jardin

### INSTRUCTIONS D'ASSEMBLAGE

### BMS6282 Casetas de almacenamiento

### INSTRUCCIONES DE ARMADO



#### Tools Required

Outil requis

Herramientas necesarias

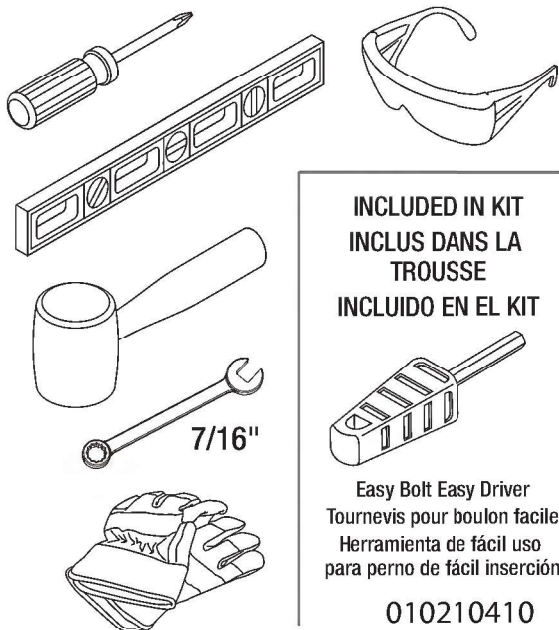

INCLUDED IN KIT  
INCLUS DANS LA  
TROUSSE  
INCLUIDO EN EL KIT

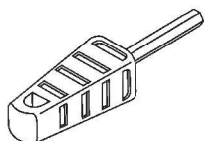

Easy Bolt Easy Driver  
Tournevis pour boulon facile  
Herramienta de fácil uso  
para perno de fácil inserción

010210410



English	3
Français	19
Español	35
한국어	53
日本	69

**SUNCAST®**

Smart. Inside & Out®

# Register your product for Limited Warranty!

Must register product within 90 days of purchase for limited warranty

## Enregistrez votre produit au programme de garantie limitée

Vous devez enregistrer votre produit au programme de garantie limitée dans les 90 jours suivant votre achat.

## ¡Registre su producto para obtener una garantía limitada!

Debe registrar el producto dentro de los 90 días posteriores a la compra para obtener una garantía limitada



### Scan for updated Limited Warranty

Scanner pour obtenir la garantie limitée à jour

Escanear para obtener garantía limitada actualizada

**[www.suncast.com/warranty](http://www.suncast.com/warranty) or call US 1 (800) 846-2345**

[www.suncast.com/warranty](http://www.suncast.com/warranty) ou appelez-nous 1 (800) 846-2345

[www.suncast.com/warranty](http://www.suncast.com/warranty) o llámenos 1 (800) 846-2345

## Have Questions?

We are here to help. Check out our resource library along with helpful tips, videos and FAQ's.

You may call the Contact Center directly at: 1 (800) 846-2345 or write

Suncast Corporation, Contact Center, 701 N. Kirk Road, Batavia, IL 60510 (USA)

### Des questions?

Nous pouvons vous aider. Consultez notre bibliothèque de ressources où vous trouverez des conseils utiles, des vidéos et une FAQ.

Vous pouvez communiquer directement avec le centre d'appels au: 1-800-846-2345 ou écrire à

Suncast Corporation, Contact Center, 701 N. Kirk Road, Batavia, IL 60510 (États-Unis)

### ¿Alguna pregunta?

Estamos aquí para ayudarle. Consulte nuestra biblioteca de recursos junto con sugerencias útiles, videos y preguntas frecuentes.

Puede llamar al Centro de atención directamente al: 1 (800) 846-2345 o escribir a

Suncast Corporation, Contact Center, 701 N. Kirk Road, Batavia, IL 60510 (EE.UU.)

**To purchase Suncast replacement parts and learn about other Suncast products visit us online or call.**

Pour acheter des pièces de rechange Suncast et pour plus d'informations sur d'autres articles Suncast, rendez-vous sur notre site Internet ou appelez-nous.

Para comprar piezas de repuesto Suncast y obtener más información acerca de otros productos Suncast, visítenos en línea o llámenos por teléfono.



**[www.suncast.com](http://www.suncast.com)**

1-800-846-2345 or 1-630-381-6309.

1-800-846-2345 ou le 1-630-381-6309.

1-800-846-2345 o al 1-630-381-6309.



## Before You Begin...

- **Consult your local authorities for any permits required to construct shed.**  
Prior to the construction of your shed, check with the local building code official to review any required permits or building limitations.
- **A level and sturdy foundation is required before shed construction can begin.**  
Review the site preparation information within the manual before beginning assembly.
- **Read instructions thoroughly prior to assembly.**  
This kit contains parts that can be damaged if assembled incorrectly or in the wrong sequence.
- **Please follow instructions.**  
Suncast is not responsible for replacing parts lost or damaged due to incorrect assembly.
- **Assistance is required during entire assembly.** 

## **IMPORTANT**

OPEN ALL BOXES FIRST AND NEATLY LAYOUT PARTS. SMALL PARTS MAY BE CONTAINED IN EACH BOX. PLEASE REFERENCE THE PARTS LIST WITHIN THIS MANUAL TO VERIFY ALL PARTS ARE PRESENT.

COMPLETE SITE PREPARATION AND FOUNDATION CONSTRUCTION BEFORE UNPACKING ALL PARTS.



## Caution

- Proper site preparation required.
- Shed not intended for use in extreme weather conditions.
- Shed not intended for storage of flammable or caustic chemicals.
- Store heavy items near the bottom of shed.
- Shed not intended for use by children.
- DO NOT stand, sit, or store items on storage shed roof.
- Treat carefully in extreme temperatures.
- Repair or replace broken parts immediately.
- Suncast is not responsible for damage caused by weather or misuse.
- At regular intervals inspect your shed to make sure that assembly integrity has been maintained.
- Periodically check that the location you have chosen to set your shed is still level.
- This kit contains parts with metal edges. Please be careful when handling.



## Shed Safety and Care

- Hot items, such as recently used grills, blowtorches, etc., must not be stored in the shed.
- Heavy articles should not be leaned against the walls, as this may cause panel distortion and permanent damage.
- Keep roof clean of snow and leaves.
- The shed walls and roof sections have a textured exterior, much like vinyl home siding. Over time, dust may accumulate in the texture. When combined with moisture, this could encourage the growth of moss or mold on the shed. To maintain the look of your shed, we recommend cleaning it each year with mild soap and water.  
**DO NOT** use bleach, ammonia, or other caustic cleaners, and **DO NOT** use stiff bristle brushes. Failure to perform annual cleaning could result in permanent staining of the plastic. This is not a manufacturing defect and is not covered under warranty.

## Assembly Day Tips

- Complete site preparation and foundation construction before unpacking parts and beginning assembly.
- **DO NOT** attempt to assemble on a day with strong winds.
- **DO NOT** attempt to assemble on days when temperature is below 32 degrees.
- Set aside appropriate amount of time to completely assemble shed. Assembly time is approximately 3 hours.
- Make sure you have assistance nearby to lift and secure parts in place.
- Wear light duty work gloves while assembling shed.
- Once roof is assembled, a flashlight may be of use when assembling smaller components inside shed.
- **DO NOT** use a hand drill to tighten provided Easy Bolts. Use 010210410 Easy Bolt Easy Driver tool (provided) **ONLY**.
- Suncast provides extra hardware for small fasteners for customer convenience. In some cases, there will be extra small fasteners once the assembly is complete.

**Note:** This product contains parts that are used in different orientations to construct the shed. Please take note of the orientation of the parts shown throughout this instruction manual. Failure to follow instructions could result in damage to parts. Suncast is not responsible for replacing parts lost or damaged due to incorrect assembly.

## IMPORTANT

OPEN ALL BOXES FIRST AND NEATLY LAY OUT PARTS. SMALL PARTS MAY BE CONTAINED IN EACH BOX. PLEASE REFERENCE THE PARTS LIST WITHIN THIS MANUAL TO VERIFY ALL PARTS ARE PRESENT.

COMPLETE SITE PREPARATION AND FOUNDATION CONSTRUCTION BEFORE UNPACKING ALL PARTS.

## Parts - Walls and Floors

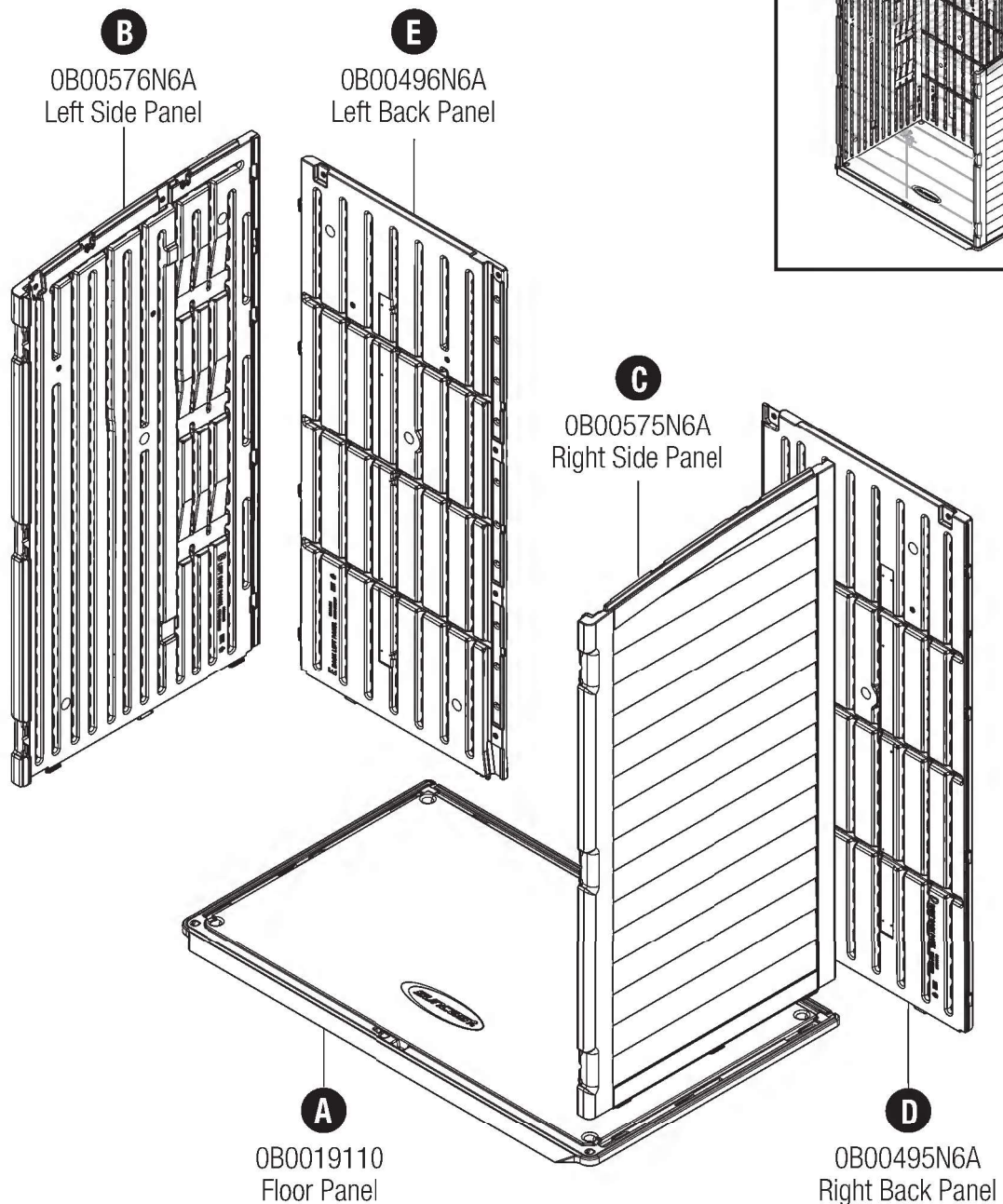

## Parts - Doors

### IMPORTANT

OPEN ALL BOXES FIRST AND NEATLY LAY OUT PARTS. SMALL PARTS MAY BE CONTAINED IN EACH BOX. PLEASE REFERENCE THE PARTS LIST WITHIN THIS MANUAL TO VERIFY ALL PARTS ARE PRESENT.

COMPLETE SITE PREPARATION AND FOUNDATION CONSTRUCTION BEFORE UNPACKING ALL PARTS.

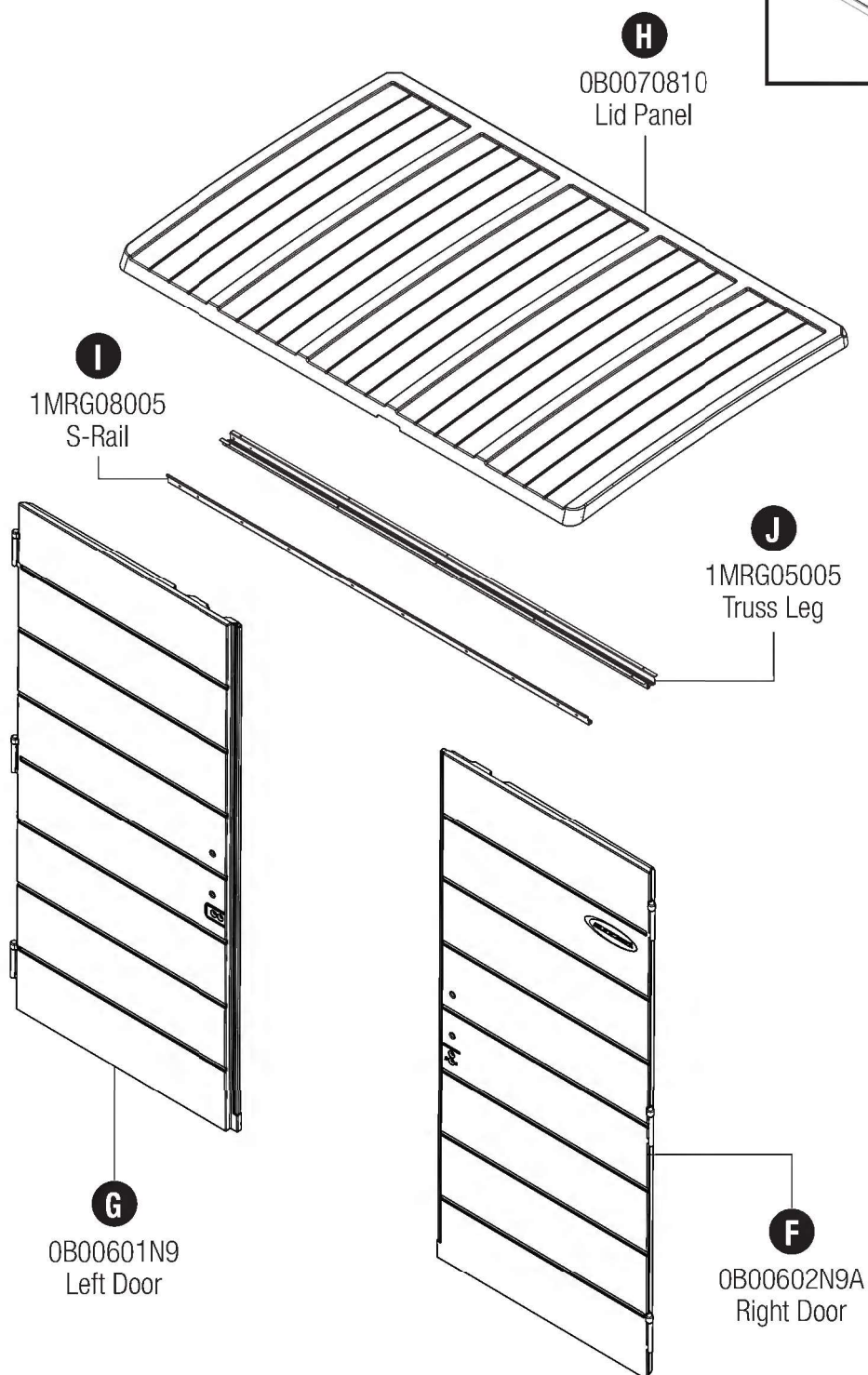
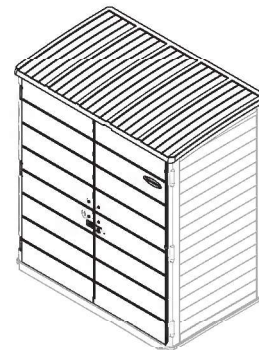

# Hardware

## 0860108 - Hinge Kit

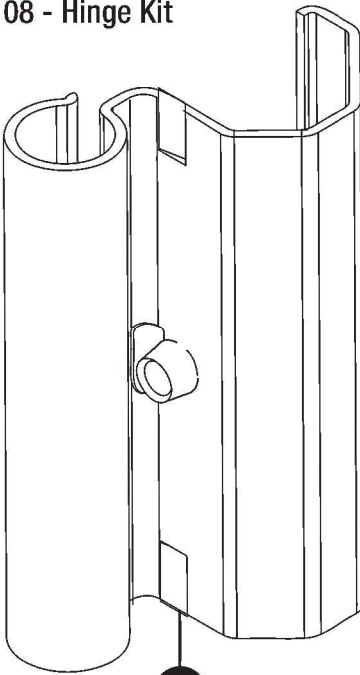

**AA**

OMP000022  
Metal Hinge Plate  
x6

## 0480452 - Hardware Bag



**UU**

0210180  
#8 x 5/8" Screw  
x9

## Hardware Bag

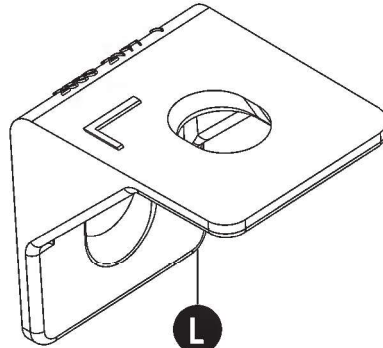

**L**

0102197N6  
Roof Retainer  
x7

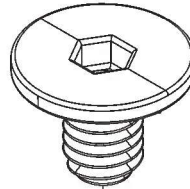

**EE**

Easy Bolt 7/8"  
x17

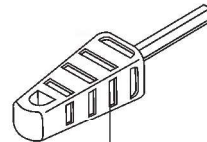

**FF**

010210410  
Easy Bolt Driver

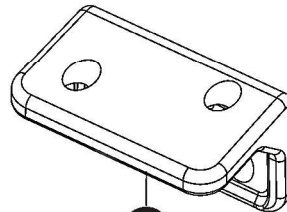

**II**

0102721  
Roof Bracket  
x2

## 0480524 - Hardware Bag

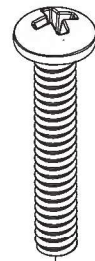

**GG**

0631017  
1/4 - 20 x 1-1/2"  
Machine Screw  
x7

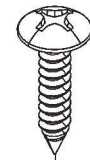

**HH**

0631149  
#10 x 3/4"  
Pan Head Screw  
x28

## 0440631 - Hardware Bag

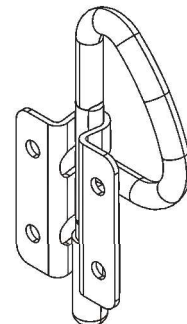

**O**

0280384  
D-Ring Slide Bolt  
x2

Extra hardware provided. Not all is used.

# Hardware - Door Handle Kit Parts

## 0464523 - Door Handle Kit

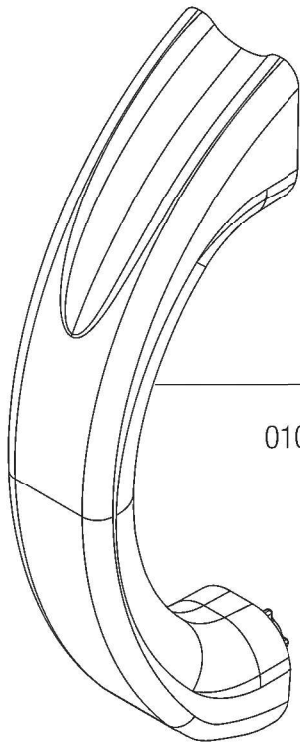

**JJ**  
010247910A  
Handle  
x2



## 0480370 – Door Handle Hardware

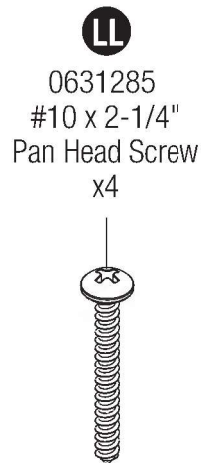

**LL**  
0631285  
#10 x 2-1/4"  
Pan Head Screw  
x4

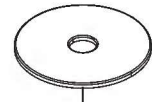

**MM**  
0631284  
#10 x 1"  
Fender Washer  
x4

## 0464504 - Door Latch Kit

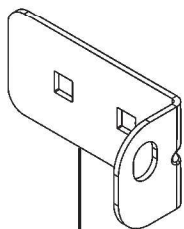

**NN**  
OMP000020  
Left Latch Plate

**00**  
Door Latch Assembly

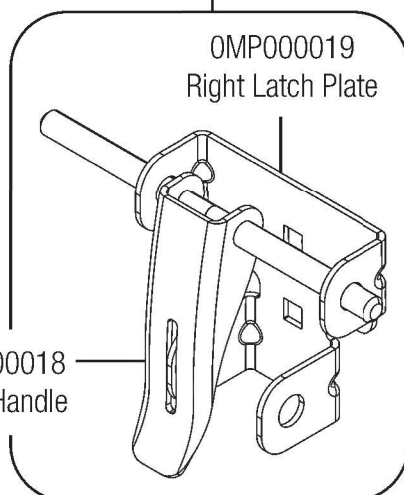

OMP000019  
Right Latch Plate

OMP000018  
Latch Handle

## 0480439A - Hardware Bag

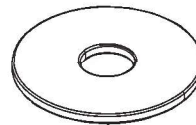

**RR**  
0631733A  
1/4" Washer  
x4

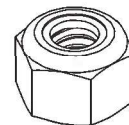

**SS**  
0631732A  
1/4" - 20  
Lock nut  
x4

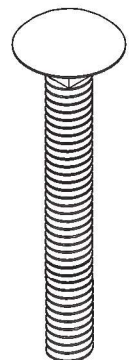

**TT**  
0631734A  
1/4 - 20 x 1-1/2"  
Carriage bolt  
x4

# Site Preparation and Platform Construction

Materials **NOT** supplied with Shed Kit

**Note:** Site preparation is required for this shed. Placing the shed on a constructed foundation is required. Without a constructed foundation, settling will probably occur, causing distortion and damage to the shed. Suncast is not responsible for replacing parts damaged or property lost due to incorrect assembly. Warranty requires foundation.

**Note:** Complete the site preparation and foundation construction before unpacking parts and beginning assembly. For tips on site preparation, go to [www.suncast.com](http://www.suncast.com), consult retailer, or local code.

## To prepare your shed site, follow the below steps:

- 1) Consult your local authorities for building codes and covenants before beginning foundation or erecting shed.
- 2) Before any digging, check with local utilities to determine location of buried cables, pipes, etc.
- 3) Decide which type of foundation you want:
  - Concrete slab, 4" thick

**OR**

### - Wood platform

Use exterior grade wood. The wood platform should be set on pier blocks or footing. Consult your local retailer for help to determine the best anchoring method for your particular installation. The provided plans are sized for the minimum number of cuts to lumber and plywood.

- 4) Prepare the building site:
  - The ground should slope away from the foundation area to provide drainage.
  - The foundation surface must be flat and level.
  - A vapor barrier should be provided to prevent excessive condensation in the shed.
  - Follow local building codes for a proper vapor barrier.
- 5) Anchoring the shed to the foundation:
  - Consult your local retailer for help to determine the best anchoring method for your particular installation.
  - To secure the shed to a concrete slab, use masonry fasteners available at your local hardware retailer.
  - To secure the shed to a wood platform, use 1/4" x 3" long lag screws with washers.

## Anchoring floor panel to concrete slab

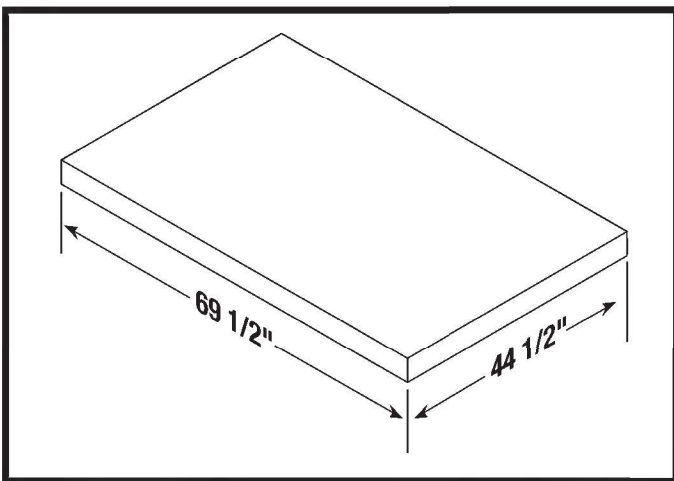

- Secure shed to concrete slab using masonry fasteners.
- Dimensions allow for shed to fit within the nearest 1" on each side.

## Anchoring floor panel to wood platform

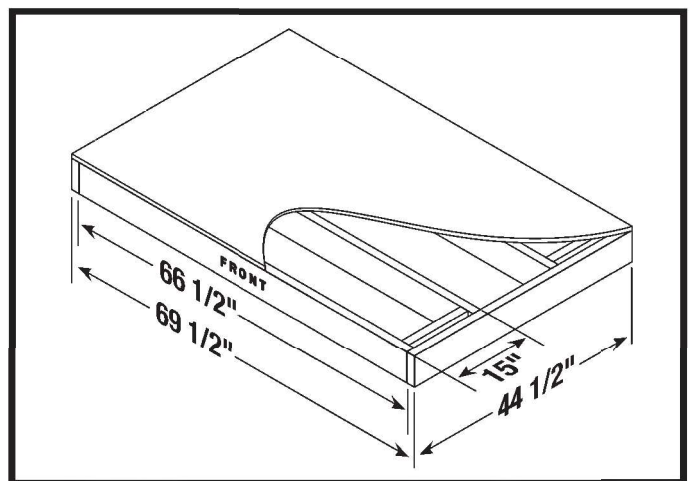

- Secure shed to wood platform using 1/4" x 3" lag screws.

# Site Preparation and Platform Construction (continued)

Materials **NOT** supplied with Shed Kit

## Wood platform critical spacing

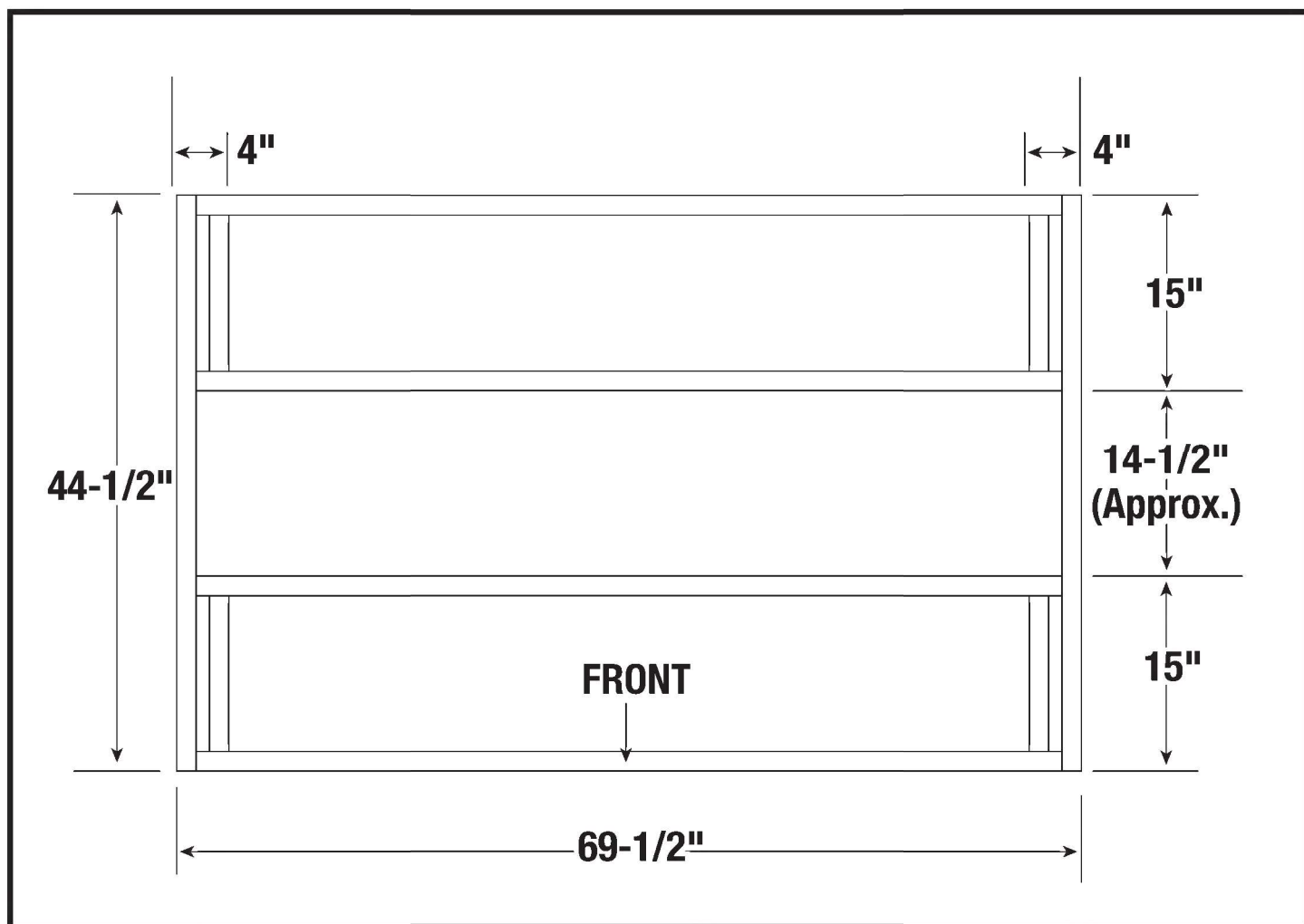

- Check all critical spacing measurements.

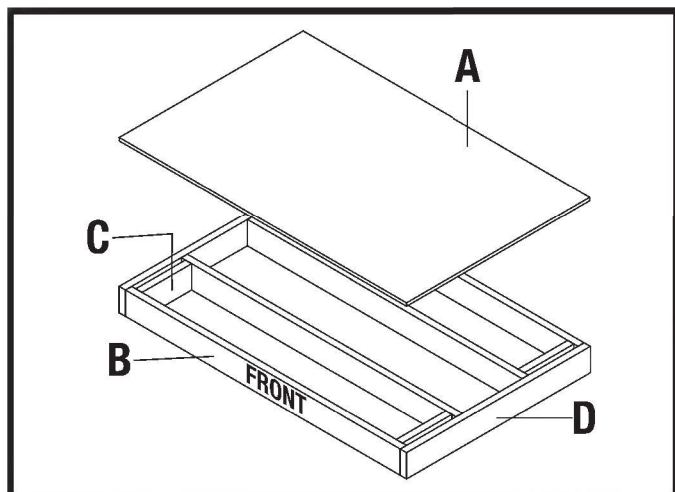



## Materials list

Item	Qty	Size
A	1	44-1/2" x 69-1/2" x 3/4"
B	4	2" x 6" x 66-1/2"
C	4	2" x 6" x 12"
D	2	2" x 6" x 44-1/2"

**Note:** dimensional lumber is actually 1/2" smaller than noted sizes.

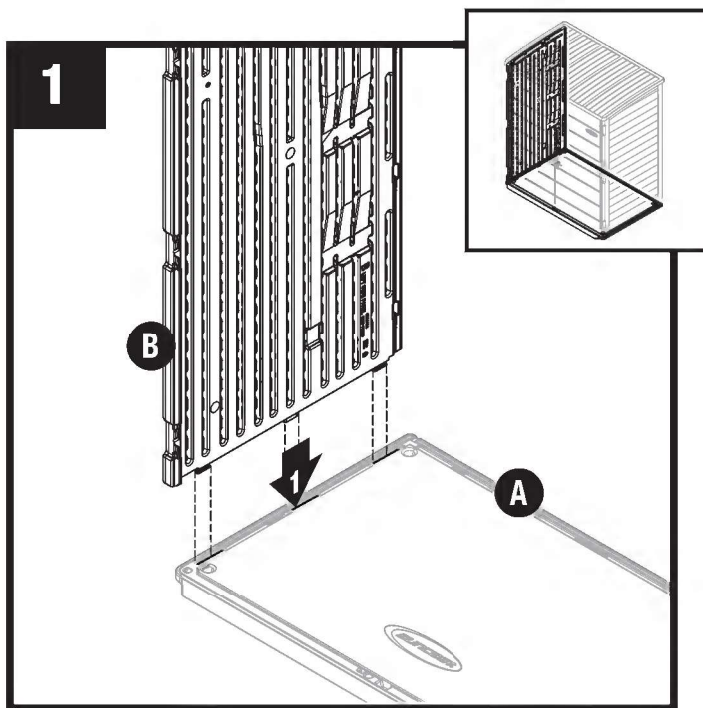
# Assembly/Walls



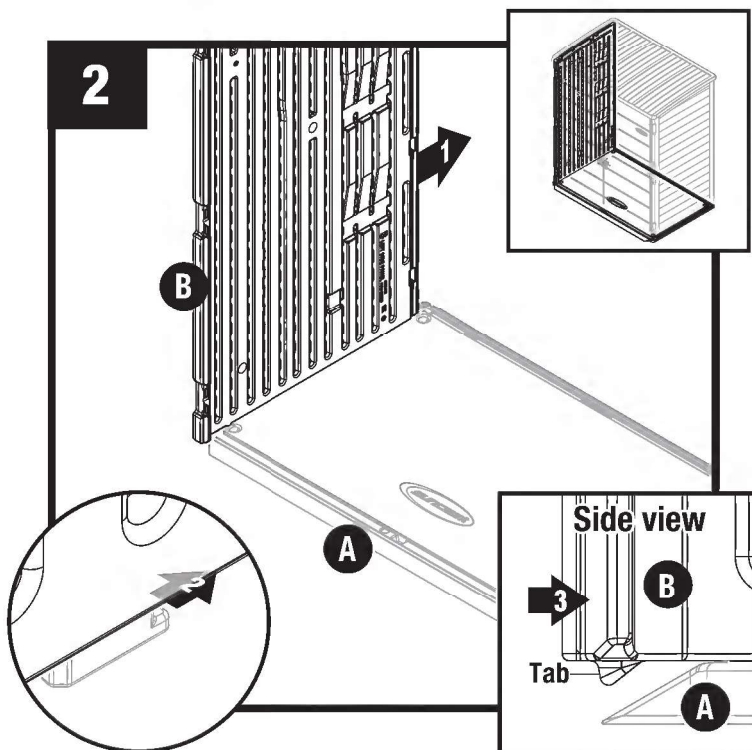

 Align tabs on bottom left side panel (B) with slots on floor (A). Lower panel into slots.

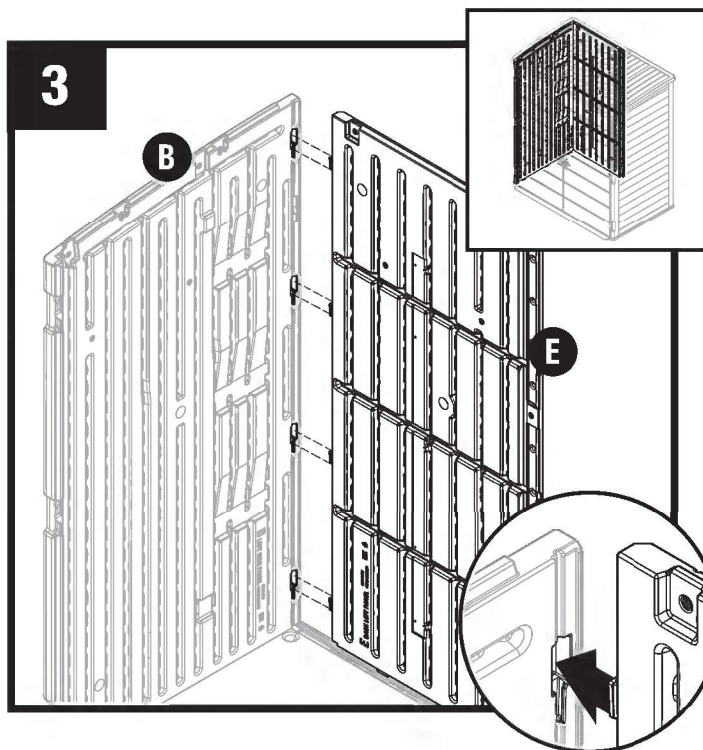

 Lock side panel (B) by sliding panel toward rear of floor panel (front corner tab will slide into position).

 **Note:** Use a rubber mallet to 'push' left side panel (B) into locked position.



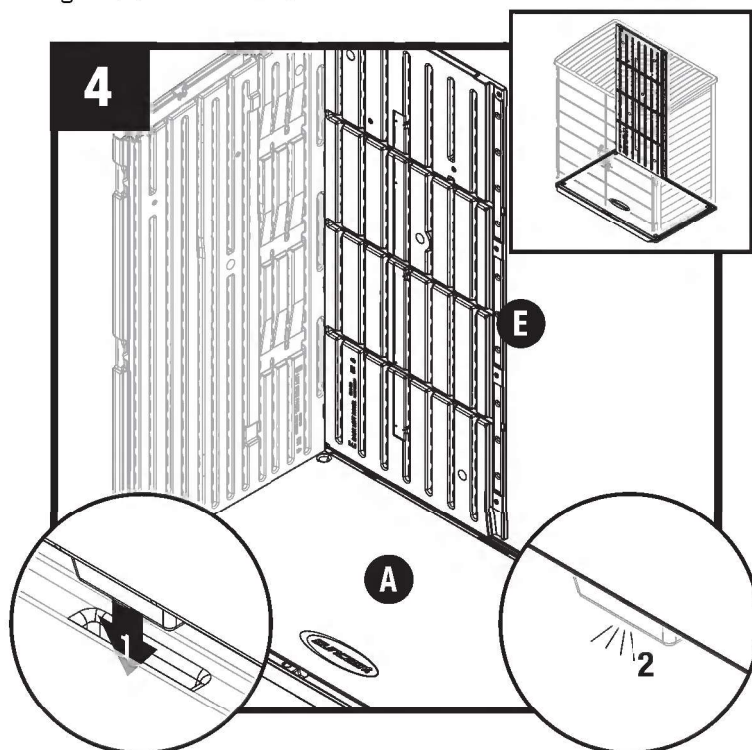

 Align tabs on side of left back panel (E) with slots on the left side panel (B). Slide back left panel down to lock tabs into left side panel.



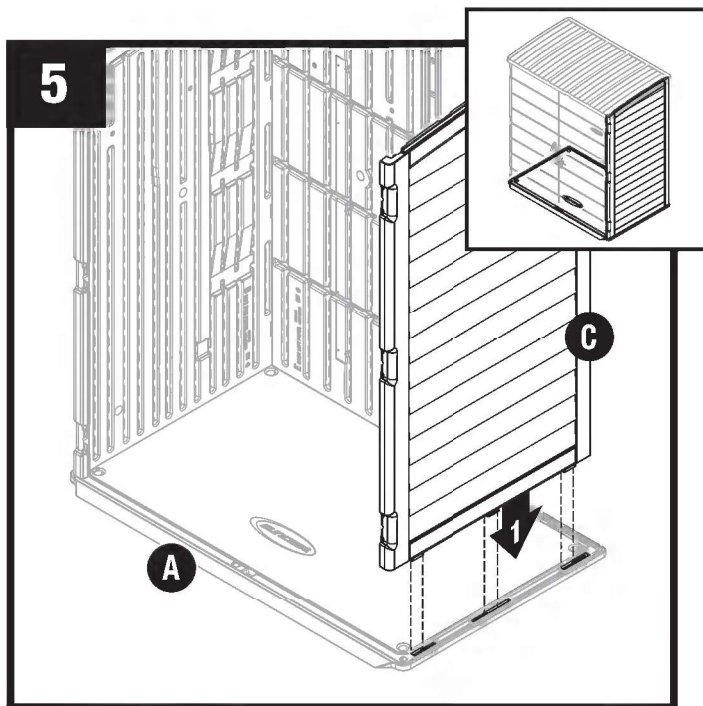

Lower the back left panel (E) tabs into the slots of floor (A). The back left panel tabs will 'snap' into place when in correct position.

## Assembly Walls (continued)

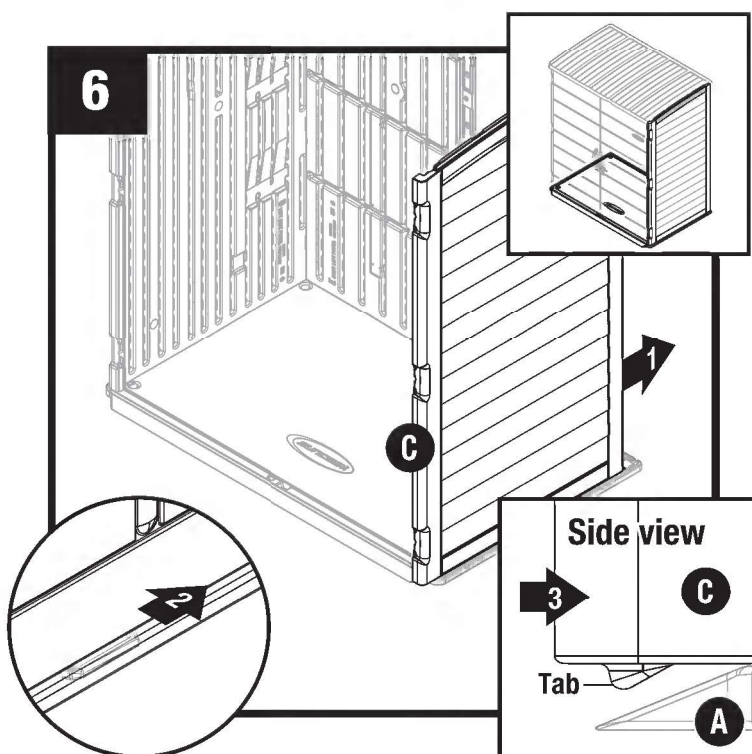

 Align tabs on bottom right side panel (C) with slots on floor (A). Lower panel into slots.



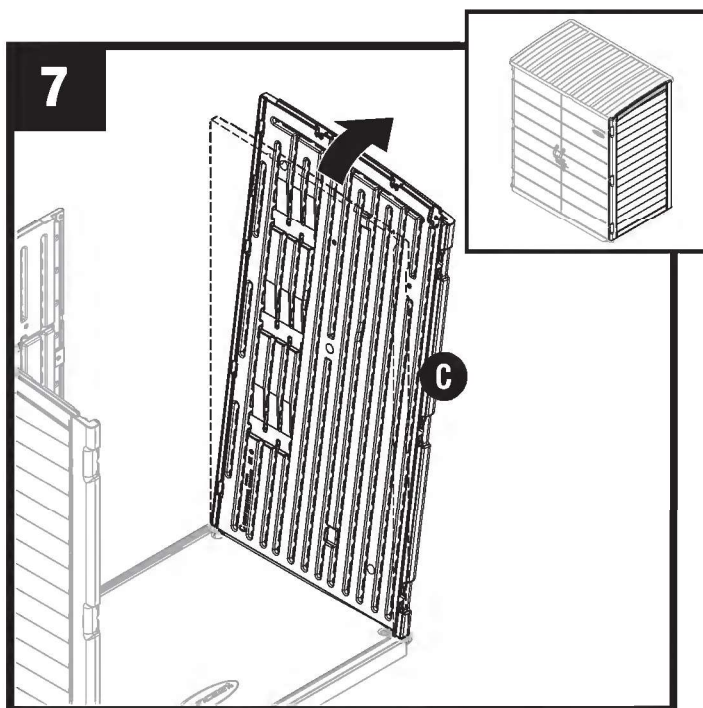

 Lock side panel (C) by sliding panel toward rear of floor panel (front corner tab will slide over floor and into position).

 **Note:** Use a rubber mallet to 'push' right side panel (C) into locked position.

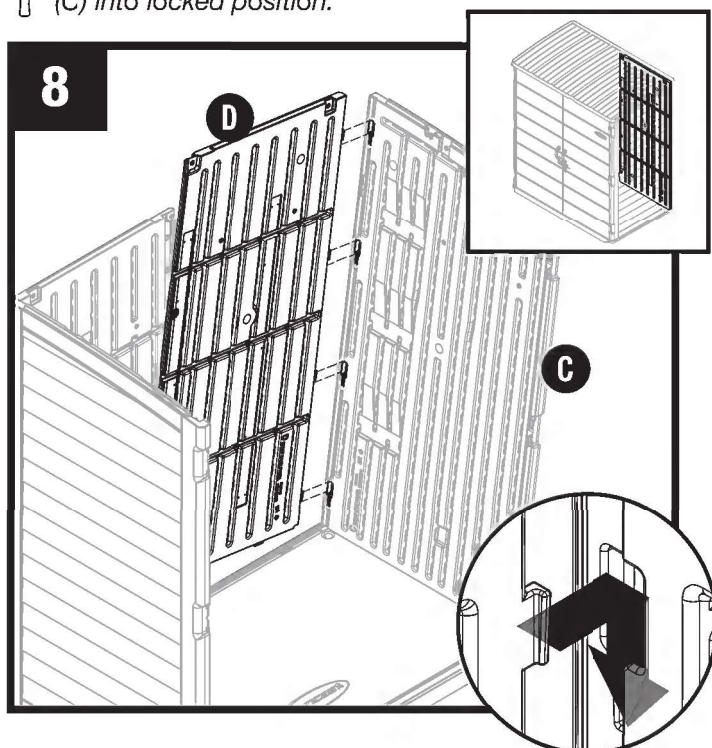

Tilt right panel (C) outward.



 At an angle, align tabs on side of right back panel (D) with slots on right side panel (C). Slide back right back panel in and down into right side panel to secure.

## Assembly Walls (continued)

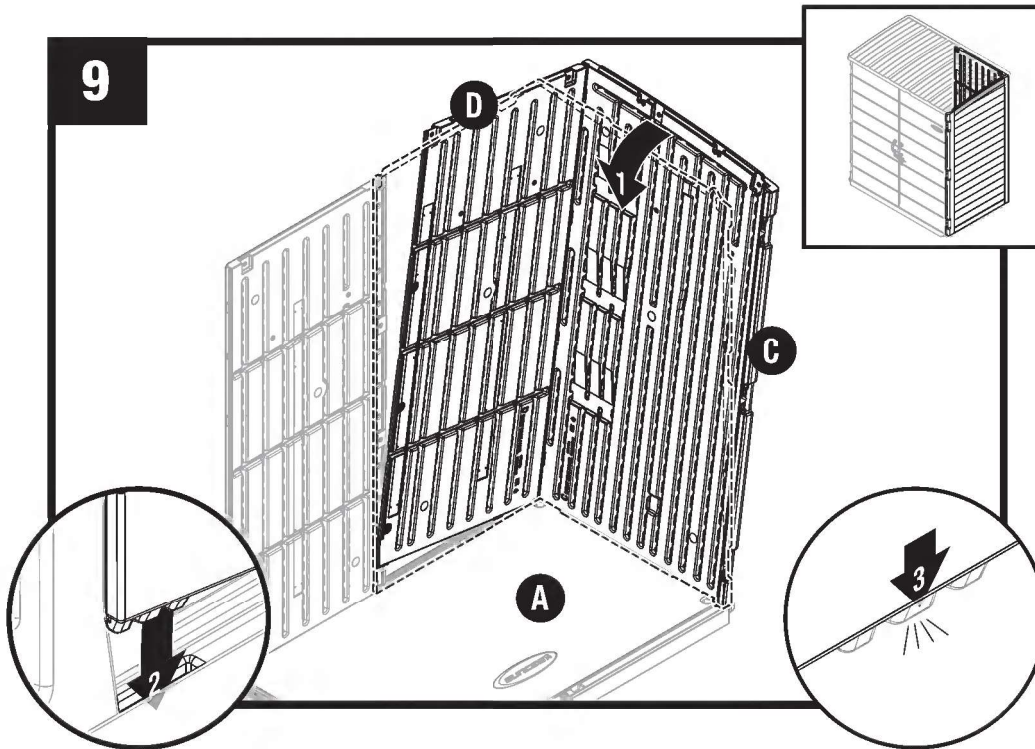

Tilt right back panel (D) and right side panel (C) back into the upright position (lowering the back right panel tabs into the slots of floor (A)). The back right panel tabs will 'snap' into place when in correct position.

**Note:** Left side panel not shown for clarity.

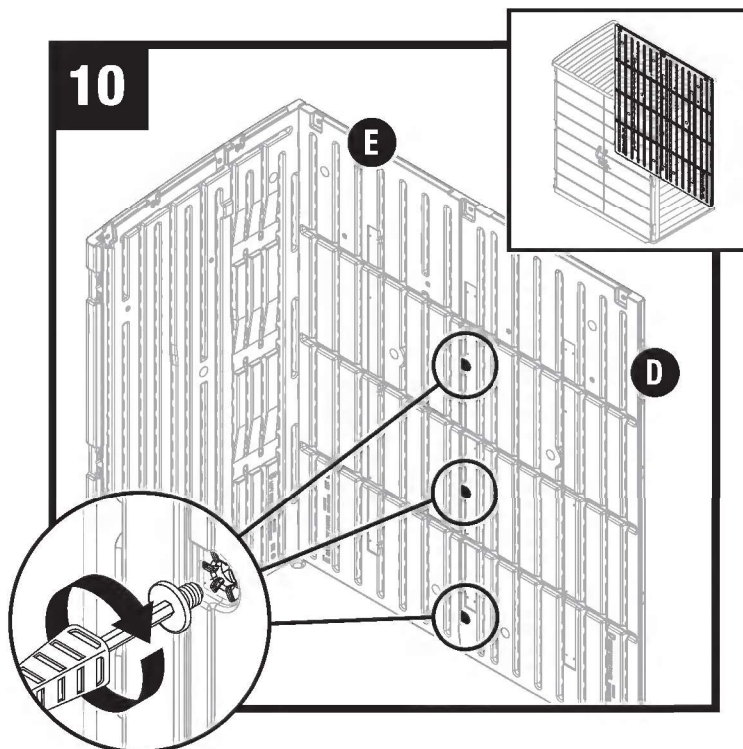

Secure back panels (E, D) together using three easy bolts (EE) and working from bottom to top. Use easy bolt easy driver (FF) to hand tighten. Easy bolt head will be flush when fully seated. **Do Not** over tighten easy bolts.

**Note:** Top easy bolt location will be installed in a later step.

**Note:** Right side panel not shown for clarity. You may hear a 'click' when easy bolt has been tightened completely.

# Assembly-Roof

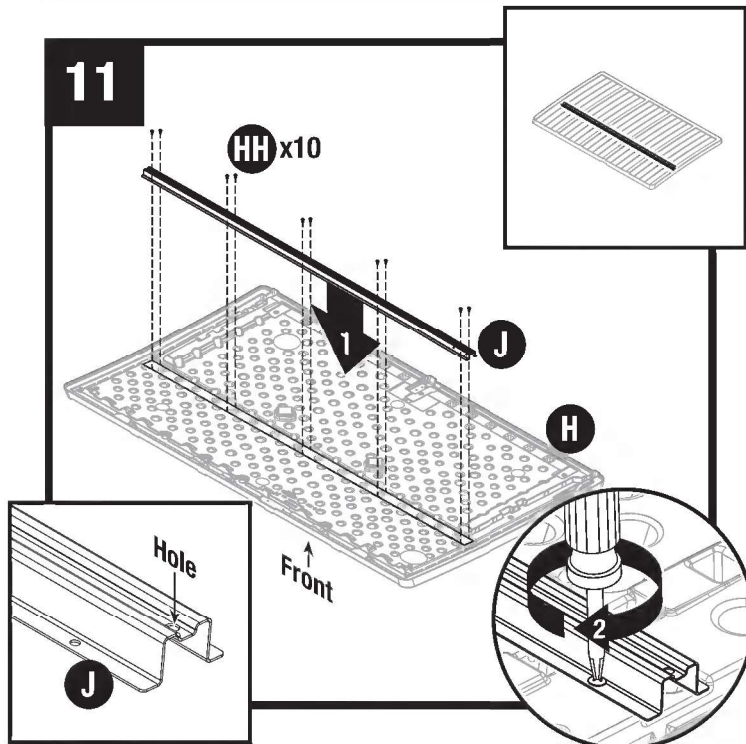

Place roof on flat surface and lower support bracket (J) into channel on under side of roof panel (H). Support bracket (J) top hole must be on the right side for proper orientation. Align holes in truss leg to rockets on roof panel. Attach bracket using ten screws (HH).

**Note:** Support bracket must be installed in orientation shown above. Roof will not fit if bracket is installed backwards.

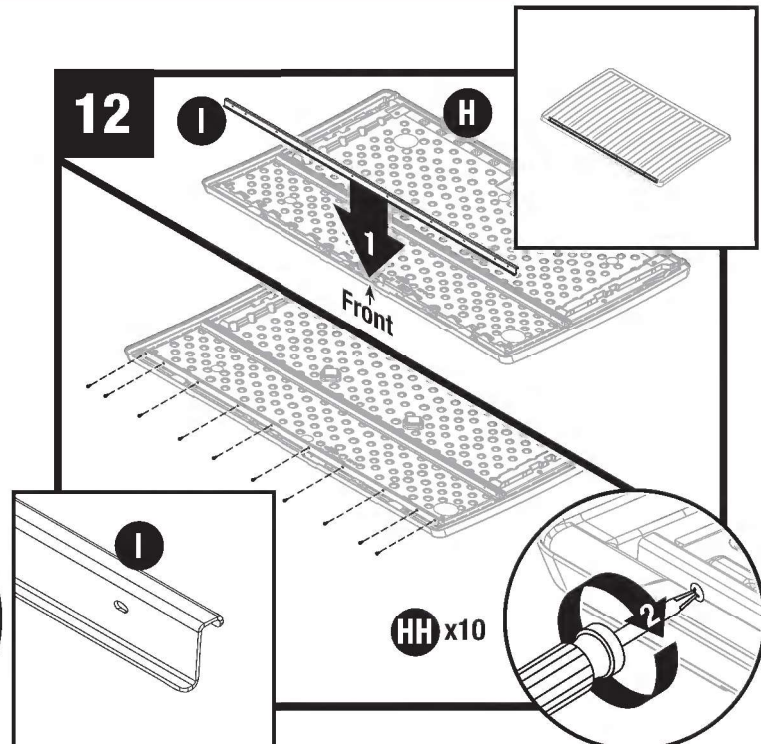

Lower S-rail (I) into position on roof (H). Attach using ten screws (HH). S-bracket (I) proper orientation is shown above.

**Note:** There are no pre-drilled holes on the roof. Use force when starting to drive self-tapping screws. Once the screw pierces the plastic, it will drive easier.

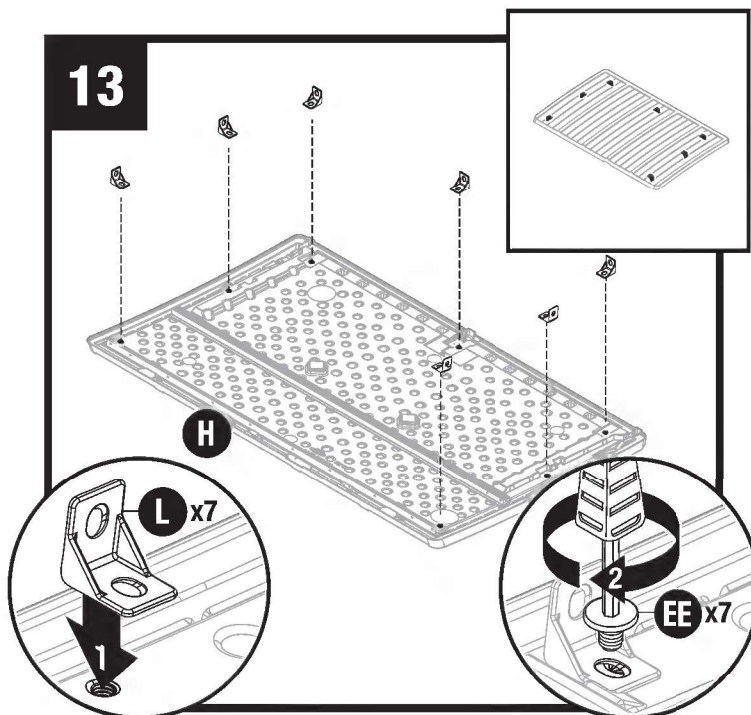

Lower roof bracket (L) into position on roof. Secure bracket with easy bolt. Use easy bolt easy driver (FF) to hand tighten. Easy bolt head will be flush when fully seated. **Do Not** over tighten easy bolts.

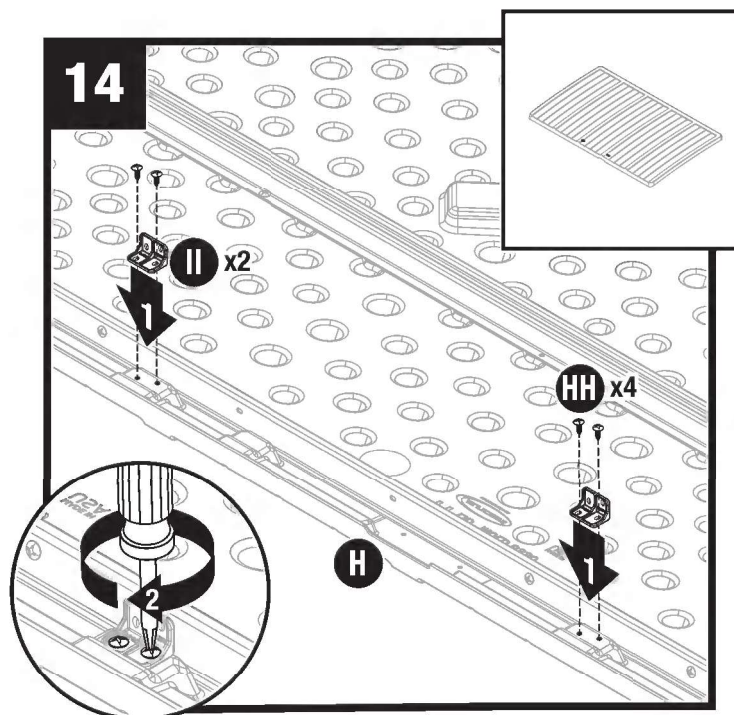

Attach door clip brackets (II) to bottom of roof panel (H) using two screws (HH).

**Note:** The vertical portion of the bracket must be oriented towards the inside of the shed.

## Assembly–Roof/Doors

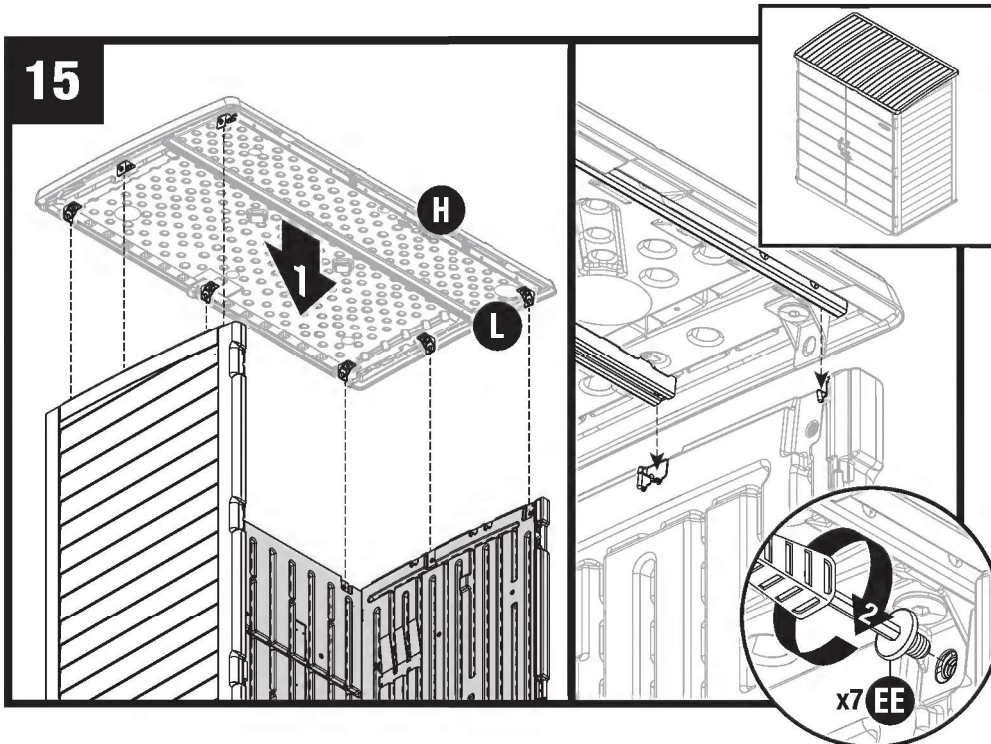

Lower roof panel (H) and line up roof brackets (L) with holes on walls. The truss legs and S-rail (pre-assembled to roof) will fit into notches in side panels (this helps to properly align roof properly). Secure bracket with seven easy bolts (EE). Use easy bolt easy driver (FF) to hand tighten. **Do Not** over-tighten easy bolts.

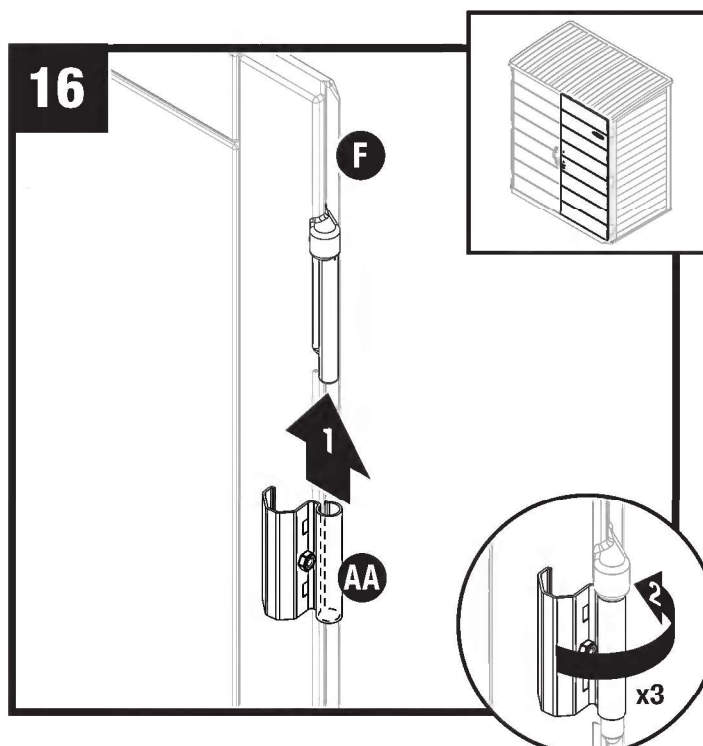

Stand right door (F) upright with hinge mounts facing right. Slide one metal hinge plate (AA) onto each hinge mount. Rotate metal hinge plates to open position.

Repeat for left door (G).

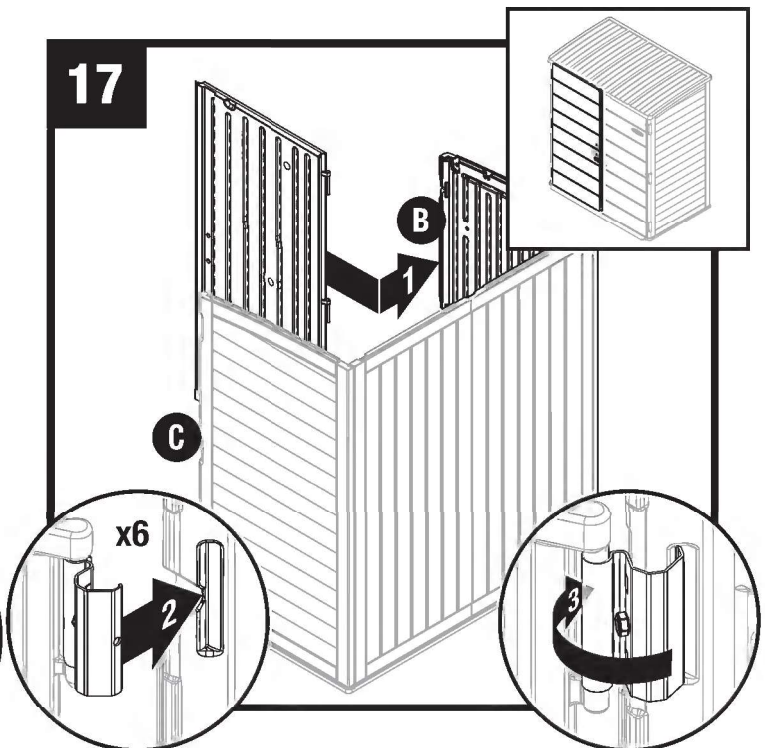

Slide one metal hinge plate over each of the six hinge receptacles on inside of side panels (B) and (C).

## Assembly-Doors

18

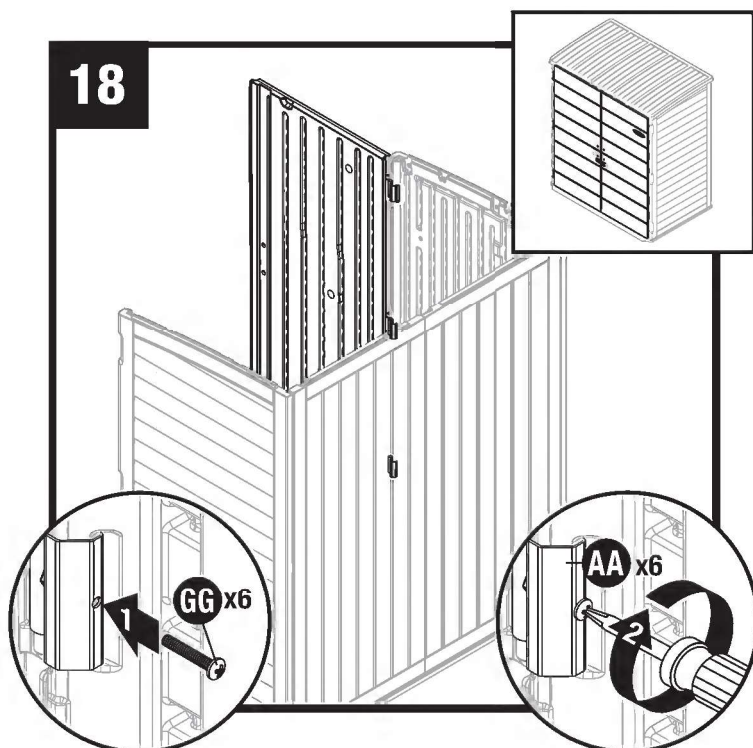

Secure each door hinge (AA) with one screw (GG).

19

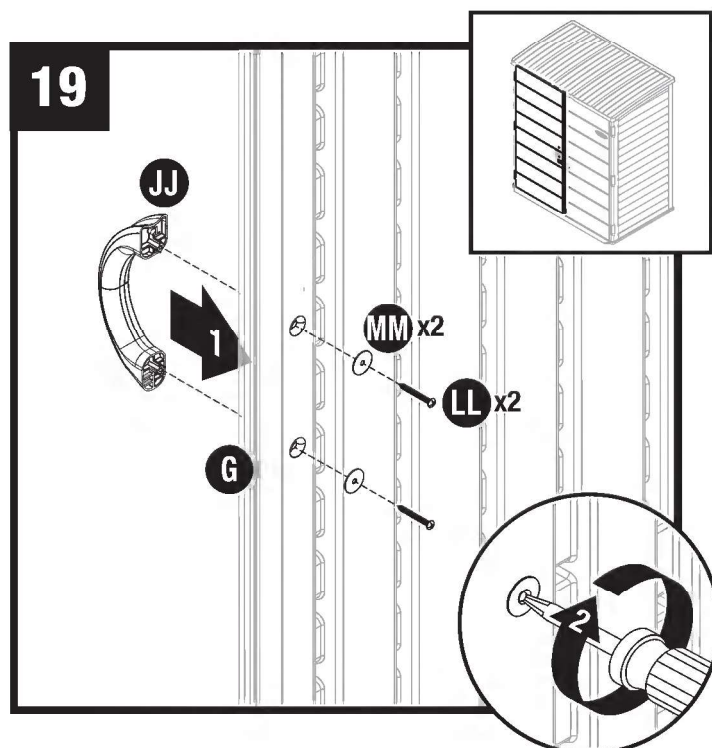

Attach left handle (JJ) to left door (G) using washers (MM) and screws (LL). Repeat for right door (F) and right door handle (KK).

20

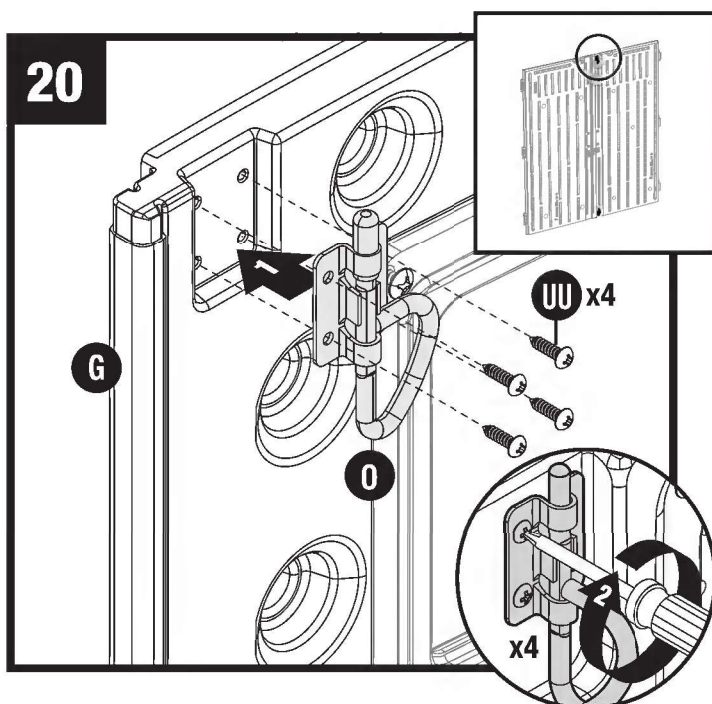

At top interior side of left door (G), attach D-ring slide bolt (O) with four screws (UU) through provided holes.

21

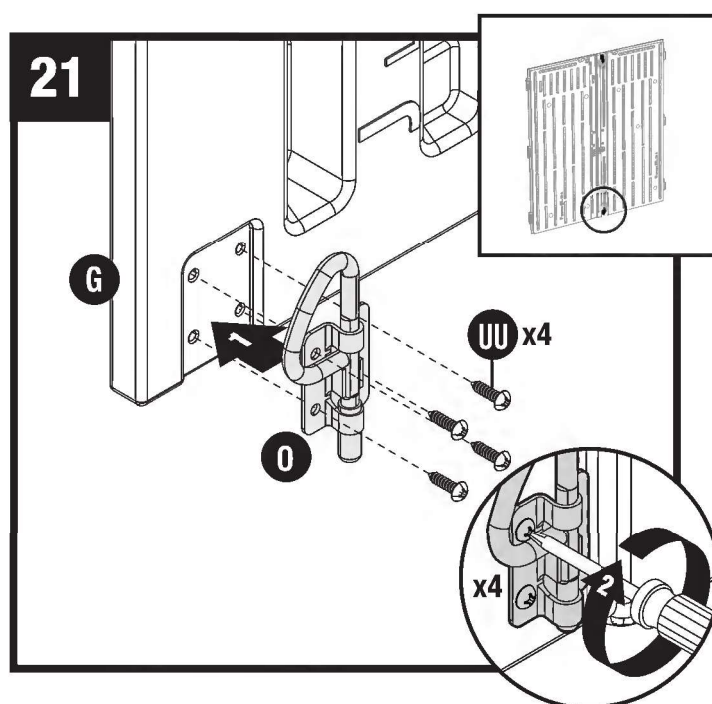

At bottom interior side of left door (G), attach D-ring slide bolt (O) with four screws (UU) through provided holes.

## Assembly Doors (continued)

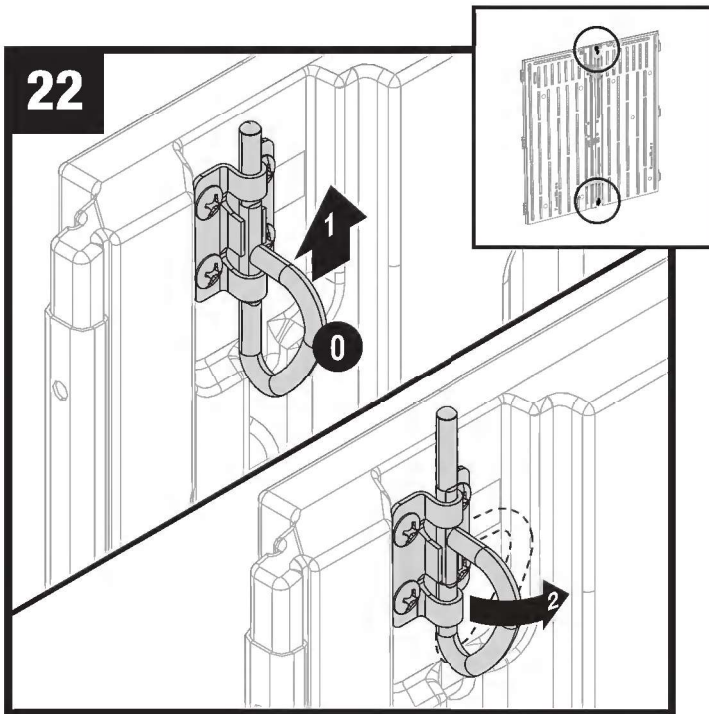

Lift upper D-ring (O) up to engage in front of Roof (H). Turn D-ring to right for locked position.

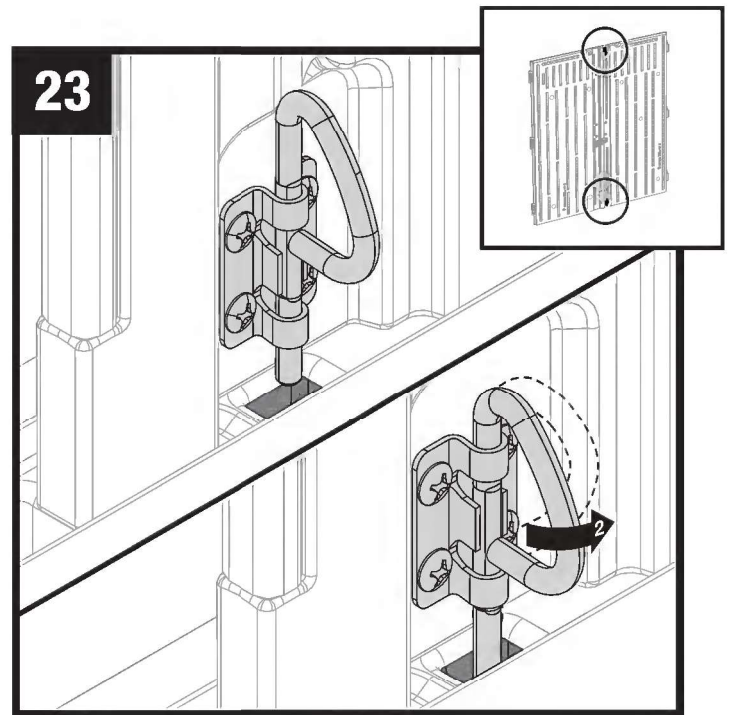

Push lower D-ring (O) down to engage with hole in floor. Turn D-ring to right for locked position.

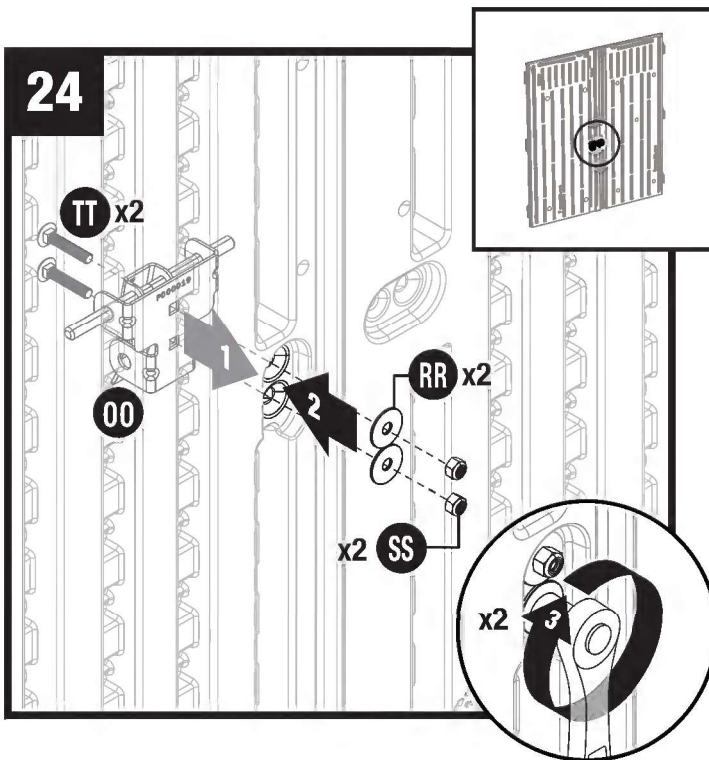

Insert two screws (TT) into door latch assembly (OO) and through right door. The screws will need to puncture through a thin layer of plastic to get through the door. While holding plate in place on exterior of door, secure each screw with two washers (RR) and two locking nuts (SS).

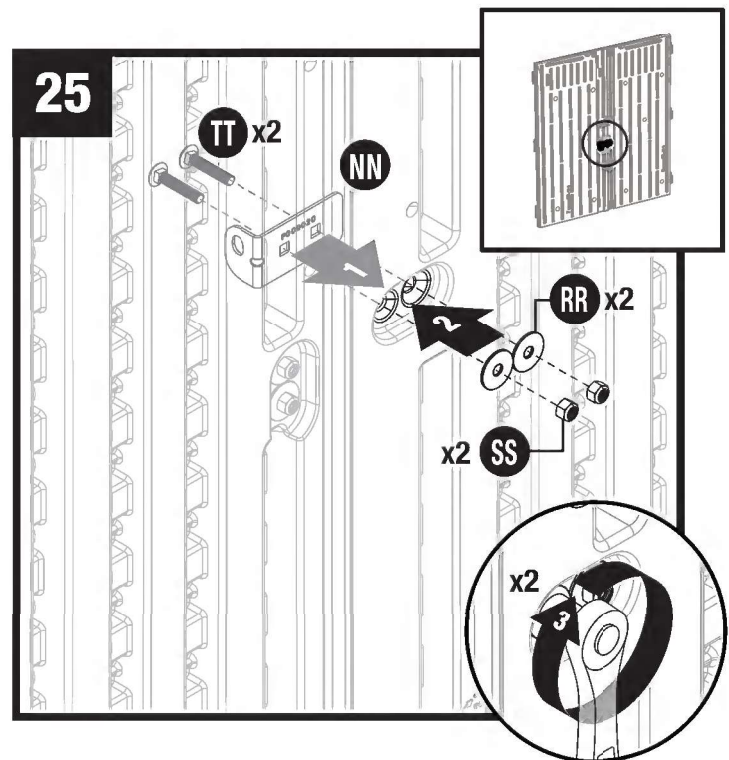

Insert screws (TT) into left latch plate (NN) and through left door. The screws will need to puncture through a thin layer of plastic to get through the door. While holding plate in place on exterior of door, secure each screw with two washers (RR) and two locking nuts (SS).

## Optional Interior Wood Shelf (materials not included)

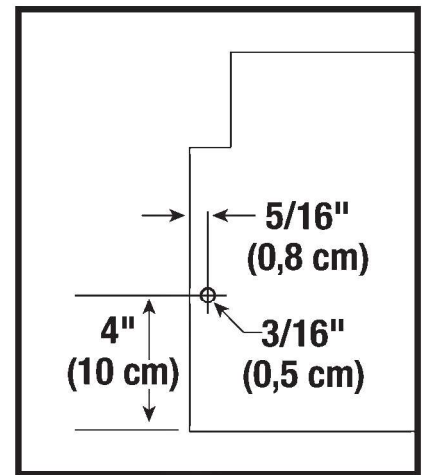
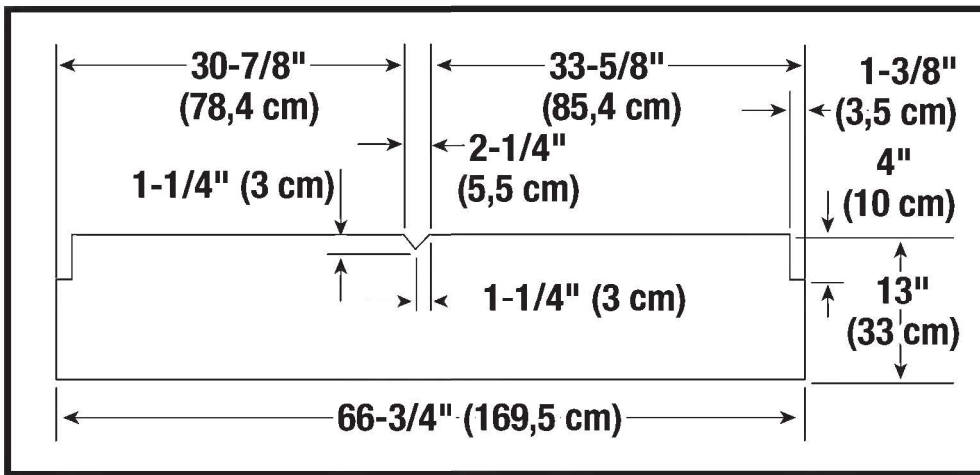

- Three optional wood shelves can be added to your storage shed.
- Cut shelves from 3/4" thick wood using dimensions above.
- Drill one 3/16" pilot hole on each side of shelf.

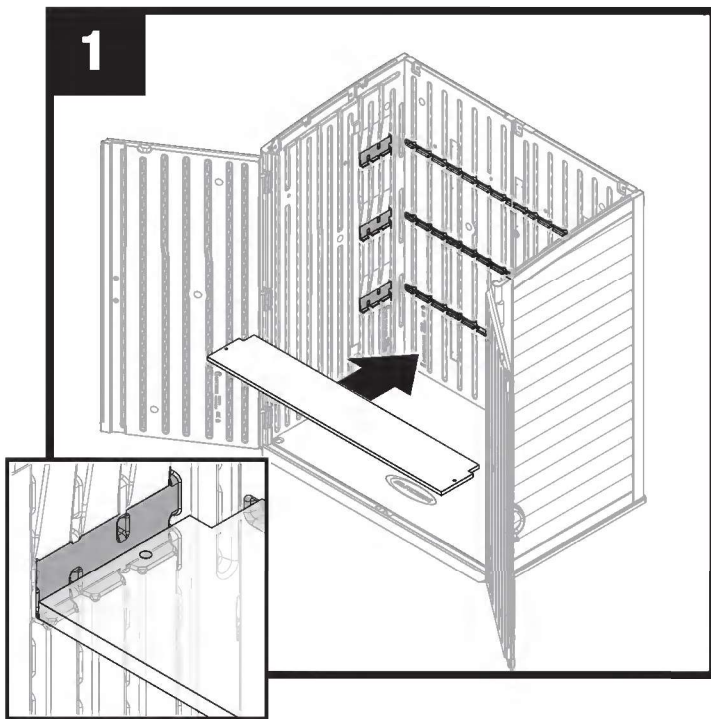

Place shelf into shed. Shelf must be completely seated into shelf supports on side and back panels.

Note: Roof not shown for clarity.

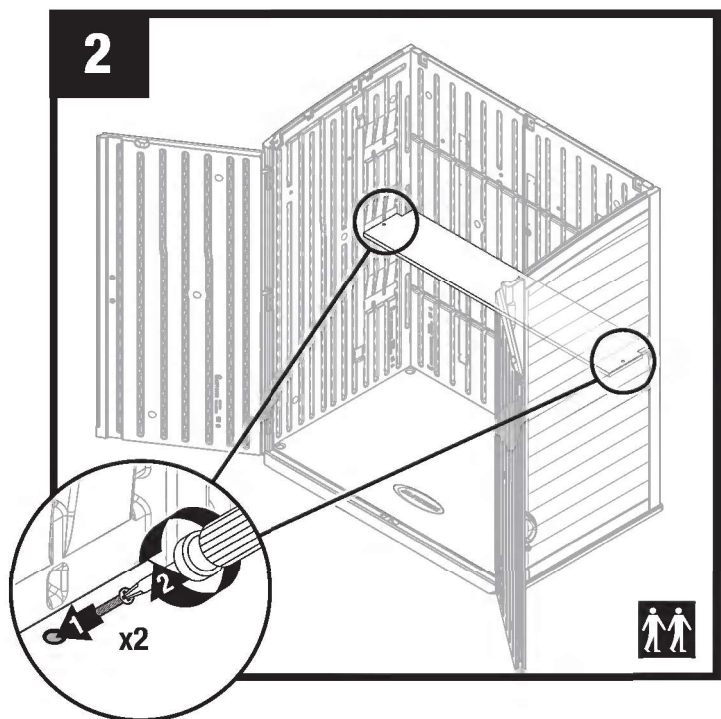

To secure shelf, insert one #8 x 1.25" drywall screw (not provided) through each pilot hole and into side panels.

Note: Press inward on side panels if needed to secure shelf fully seated into shelf supports on side and back panels.