

# Quick Space Pure

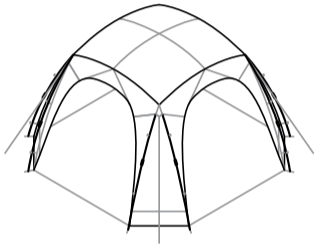

**12x + 1** T-Pegs



**1x** Mesh  
Organizer

**1**

# Instructions

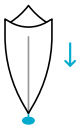
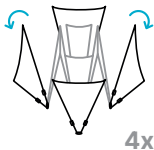
**1****2**

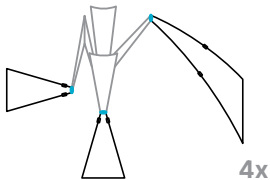
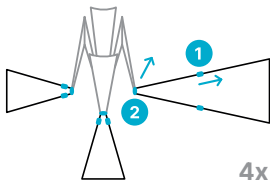
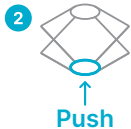
**2****Expand poles, push side hubs up**

### 3 Push center hub up

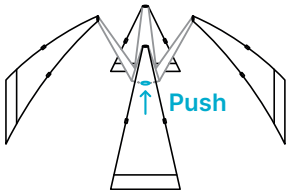

# 4 Connect ground straps

→ ←  
III III  
4x

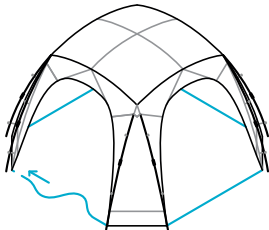

5

## Main Pegs

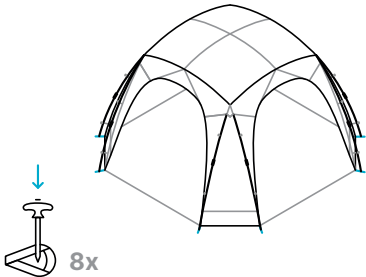

6

## Guy Lines

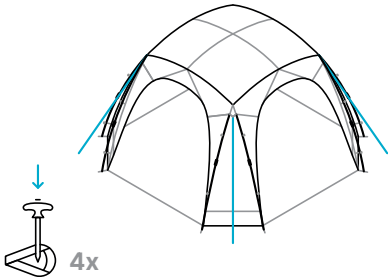

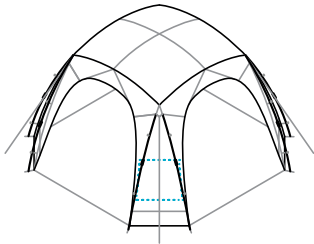
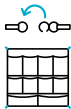

# 1 Deconstruction

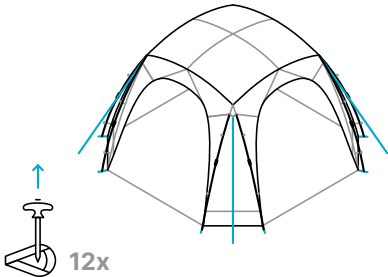

## 2 Remove ground straps

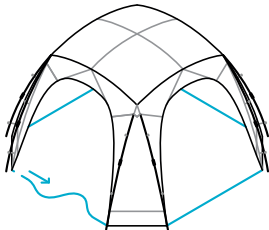

3

Pull center hub down

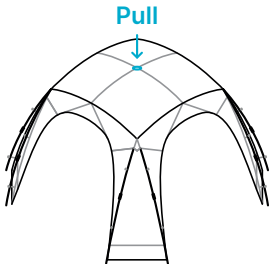

4

Pull in poles, push side hub down

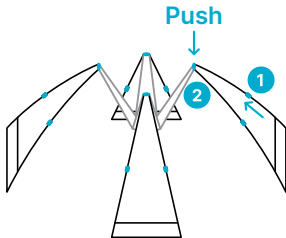
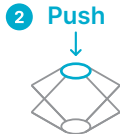
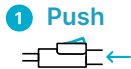

# 5 Fold side panels inwards

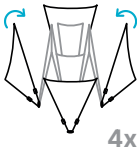
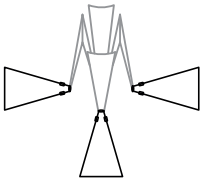

1



2

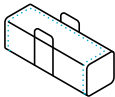

A

# Additional Equipment

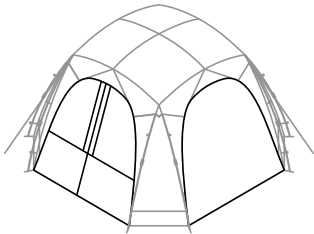

**Sidewalls**