

INTRODUCTION

About the project

In July 2024 Westminster City Council launched the Paddington Green and Little Venice Canalside Public Realm Improvements project with the ambition of creating safer, more accessible, and greener public spaces. Throughout September and October 2024 we carried out initial community engagement to understand your experiences and aspirations for the spaces, as well as your concerns about any changes. We listened to your views and translated this feedback into key objectives, which informed a series of design ideas.

This exhibition showcases the design ideas that have come out of this initial phase. Now is your opportunity to **tell us what you think about each of the ideas to help us refine a preferred proposal to take forward to the next stage.** A short online survey will be open for five weeks from **Monday 14th April until Sunday 18th May.** We encourage all those who live, work or study around Paddington Green & Little Venice Canalside to submit their feedback.

It is important to note that the Council has earmarked some funding that can be used for the delivery of these proposals. However, further progression of these will be subject to public feedback, additional technical studies and detailed design development. Also, statutory consultations may be required.

Background

In 2023, the Council published its *Paddington Public Realm Strategy* which focused on improving public spaces and connections for walking and cycling across this part of Westminster. The strategy aims to transform Paddington's disconnected neighbourhoods into a vibrant, healthy and inclusive area. Paddington Green and Little Venice Canalside are part of the first phase of projects being taken forward, alongside Warwick Avenue.

More information about the *Paddington Public Realm Strategy* can be found here: www.westminster.gov.uk/paddington-place/paddington-public-realm-strategy

Team

The Council's Place Shaping, Highways and Parks teams are managing the project and have appointed a design team led by East urban designers, with JCLA landscape design, Studio Dekka lighting design, NRP traffic and transport, WSP highways engineers, alongside Appleyard & Trew cost consultants.

Contact

If you have any queries, or would like more information please contact us via email:

paddingtonplaceplan@westminster.gov.uk

The process so far

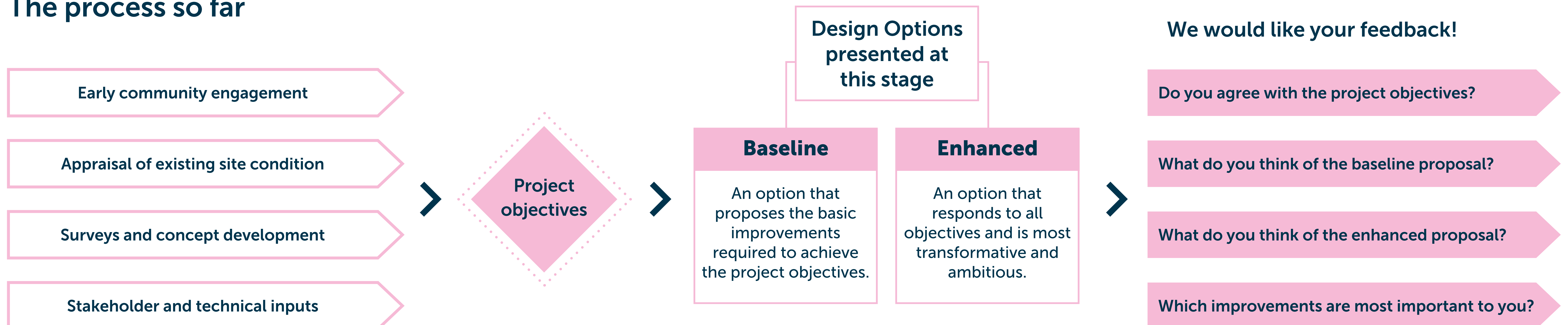

Sites for consultation

The project is split across 7 different sites, clustered in two main areas:

The **Paddington Green** exhibition will be located at the City of Westminster College forecourt and will showcase design options for:

- Churchyard Walk
- St. Mary's Churchyard
- Paddington Green
- Westway Underpass

The **Little Venice Canalside** exhibition will be held at Stone Wharf and will present options for:

- Rembrandt Gardens
- Stone Wharf
- Porteus Triangle & Underpass

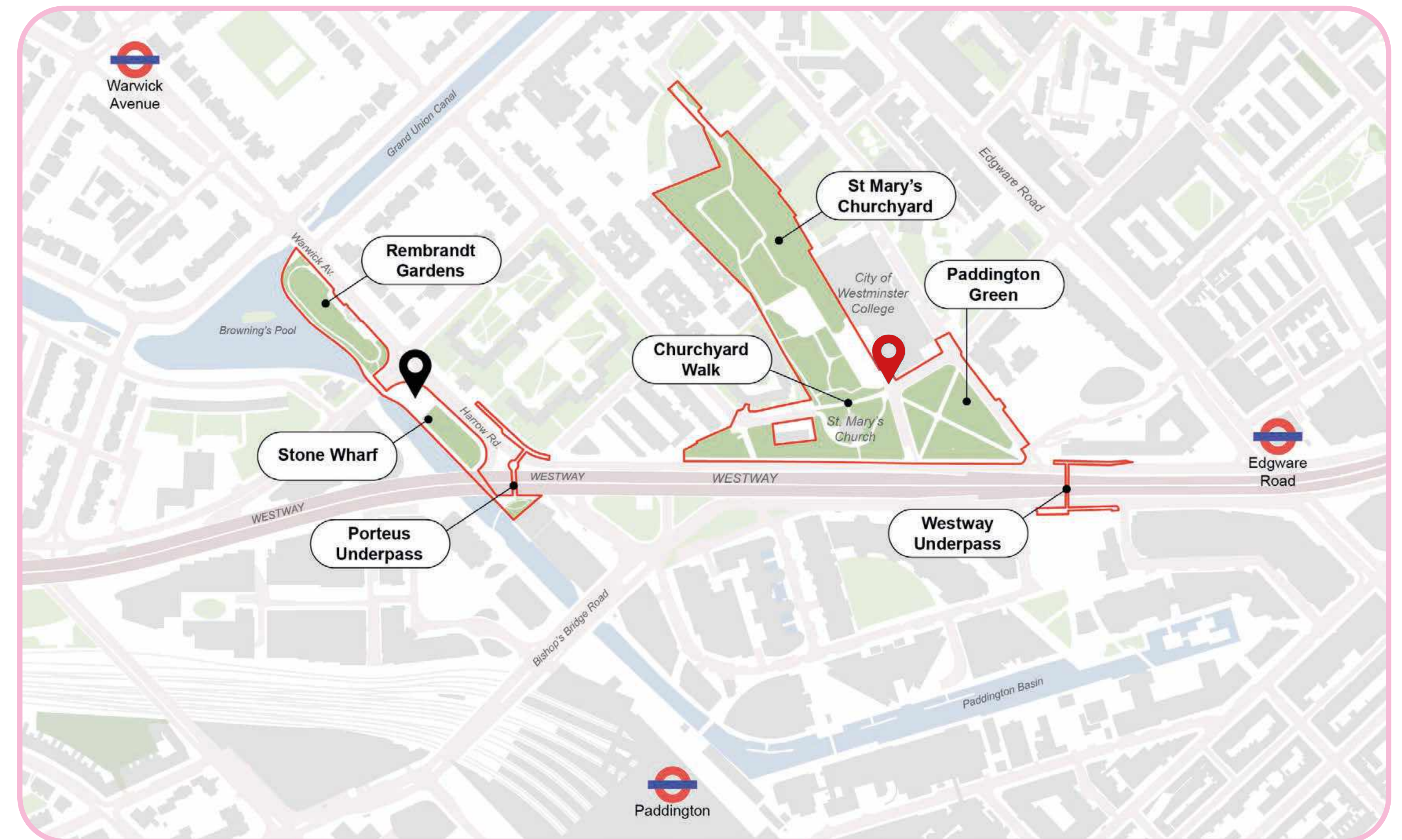

Paddington Green Exhibition (you are here!)

Little Venice Canalside Exhibition

What we heard

St Mary's Square

St Mary's Square is a functional space that could be enhanced with clearer signage that it is a dead-end for vehicular traffic. Residents also propose creating opportunities for play, such as a "play street" during times of reduced vehicular activity. Churchyard Walk has been identified as a challenging space due to its enclosed feeling and disrepair, with residents suggesting widening the path and adding more lighting.

St Mary's Churchyard

St Mary's Churchyard is valued for its natural environment and historical character but has also been described as not providing much in terms of activities. There were suggestions that the edges of the park and area surrounding the sports centre could be enhanced with better planting, while new uses such as an accessible playground, water features and outdoor gym equipment can maximise its potential.

Paddington Green

Paddington Green is appreciated for its green character, but some see the planting as "unimaginative" and describe the noise from Harrow Road as dominating. Comments seek biodiversity enhancements and better seating arrangements. Some residents also suggested a better use of the World War II bunker and its promotion as a historical asset.

"Playing games in the evening here and in the Churchyard would be nice"

"Remove or reduce the railings and create well lit and nicely landscaped pathways and cycle routes"

"Church walk is not good for people with prams - everyone gets blocked"

"Lighting creates a sombre effect - we need different types of lighting"

"Outdoor gym equipment is much needed here, but away from the flats to manage noise"

"Increase planting towards Harrow Road to block some of the noise"

"Cycleway should go through here; not realistic to expect cyclists to go around"

"St. Mary's Square and Church Walk should be wider - an avenue all the way through with lighting and wayfinding"

"There are often collisions between cars parking around the college and pedestrians"

"There should be more information about all the gravestones and the history of this area"

"Some of the areas on the outskirts of the park could be made more interesting, perhaps with some hedges, bushes, or similar"

"It needs more benches. The existing ones are always occupied signifying that more are needed"

Project Objectives

The Vision for Paddington Green and the Churchyard is to become an exemplar local green space at the heart of the surrounding community by providing a varied and rich landscape that is playful, inclusive and accessible to all.

Ensuring that ease of movement and safety is at the epicentre of each proposal will address issues of security, severances, inclusivity and social inactivity both in the short-term and in the long-term. This will be addressed with comprehensive lighting proposals that respond to their context, and by ensuring routes are well overlooked at all times, with widened and more accessible accesses.

The project objectives presented here have been shaped by community feedback, stakeholder engagement and technical surveys. All design options we put forward respond to these, in different levels of ambition.

- Key entrances
- Key public spaces
- Play opportunities
- Primary routes to be safe and accessible
- Accesses and connections to surroundings
- Views of interest
- Wayfinding and lighting opportunities
- Increased biodiversity
- Open-up views through vegetation

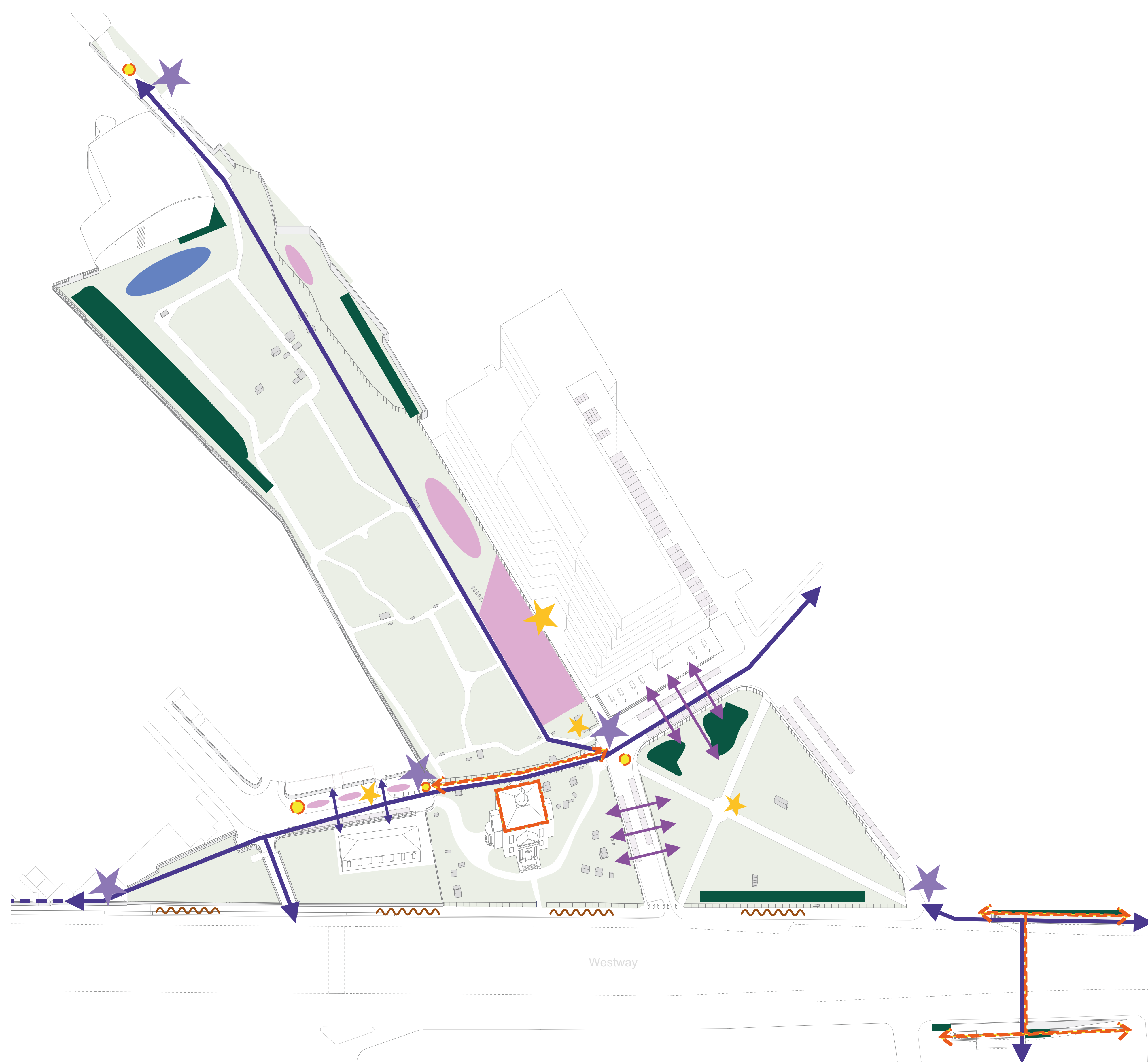

Paddington Green and St Mary's Churchyard

- Protect the spaces' existing character and celebrate history and heritage
- Enhance Biodiversity and Greening
- Enhance accessibility across all sites
- Enhance legibility and wayfinding
- Enhance lighting and remove blind corners
- Enhance the College forecourt to improve pedestrian safety
- Enhance entrance points to the park and the Church
- Enhance underpass to make it safer and more inviting
- Create a main East-West route connecting the Churchyard to its surroundings
- Create more definition of spaces in St Mary's Churchyard
- Create new uses and activities in St Mary's Churchyard



TWO LEVELS OF AMBITION

Baseline
Exemplar public spaces that are accessible, inclusive and safe for all

The aim of the baseline idea is to provide an improved East-West pedestrian route, increase safety through lighting and safer crossings, as well as creating an inclusive play offer.

The baseline proposals would involve minimal changes to the Churchyard and to the location of on-street parking.

Existing trees would be retained and protected.



Baseline + Enhanced
A transformed area that is playful, accessible, inclusive and safe for all

The aim of the enhanced idea is to create a new East-West pedestrian and cycle route with a school play street and enlarged college forecourt with parking reallocated fully in the direct vicinity. New entrances to the Churchyard, better pathways and a new large inclusive playground are also proposed.

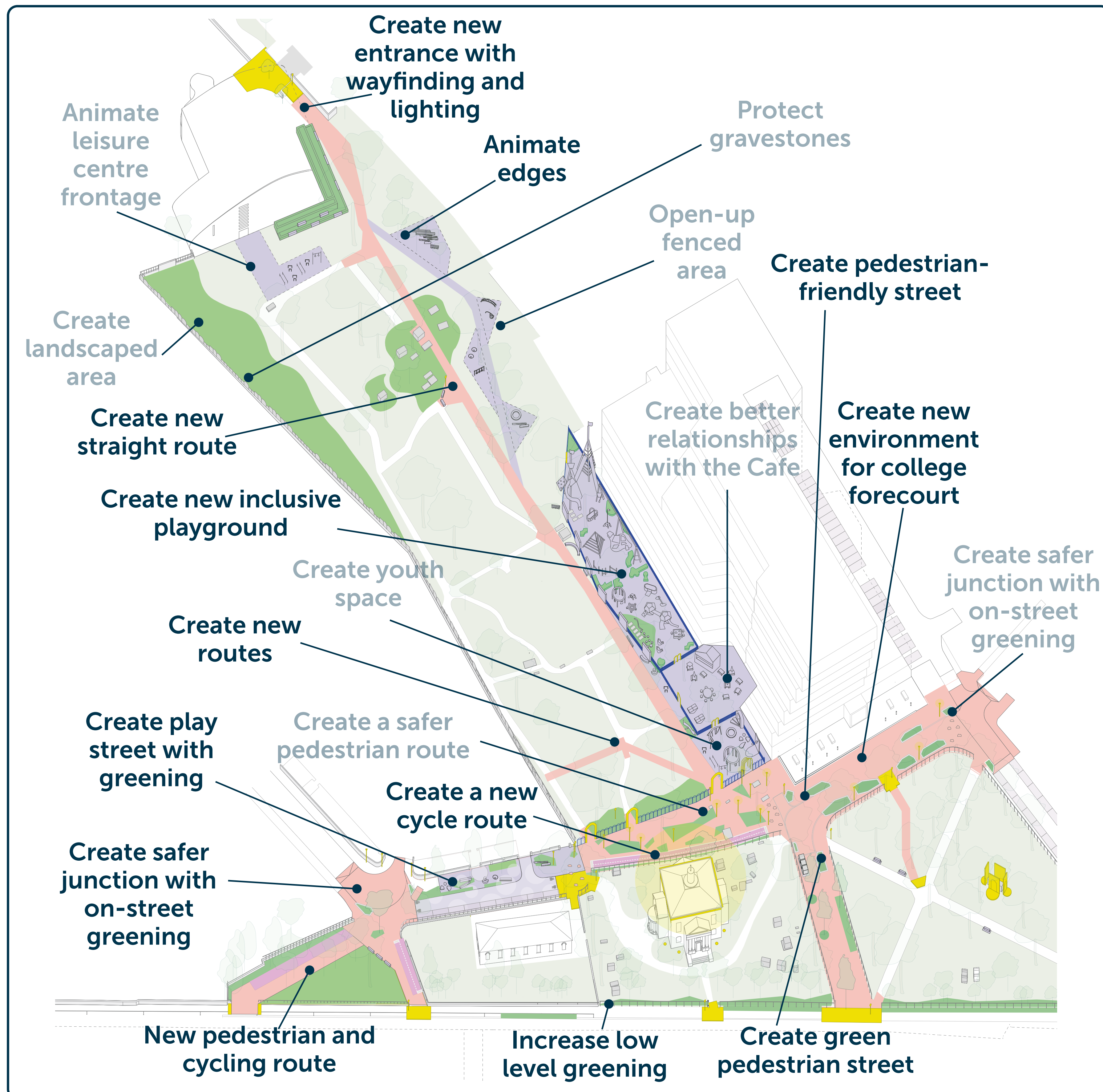
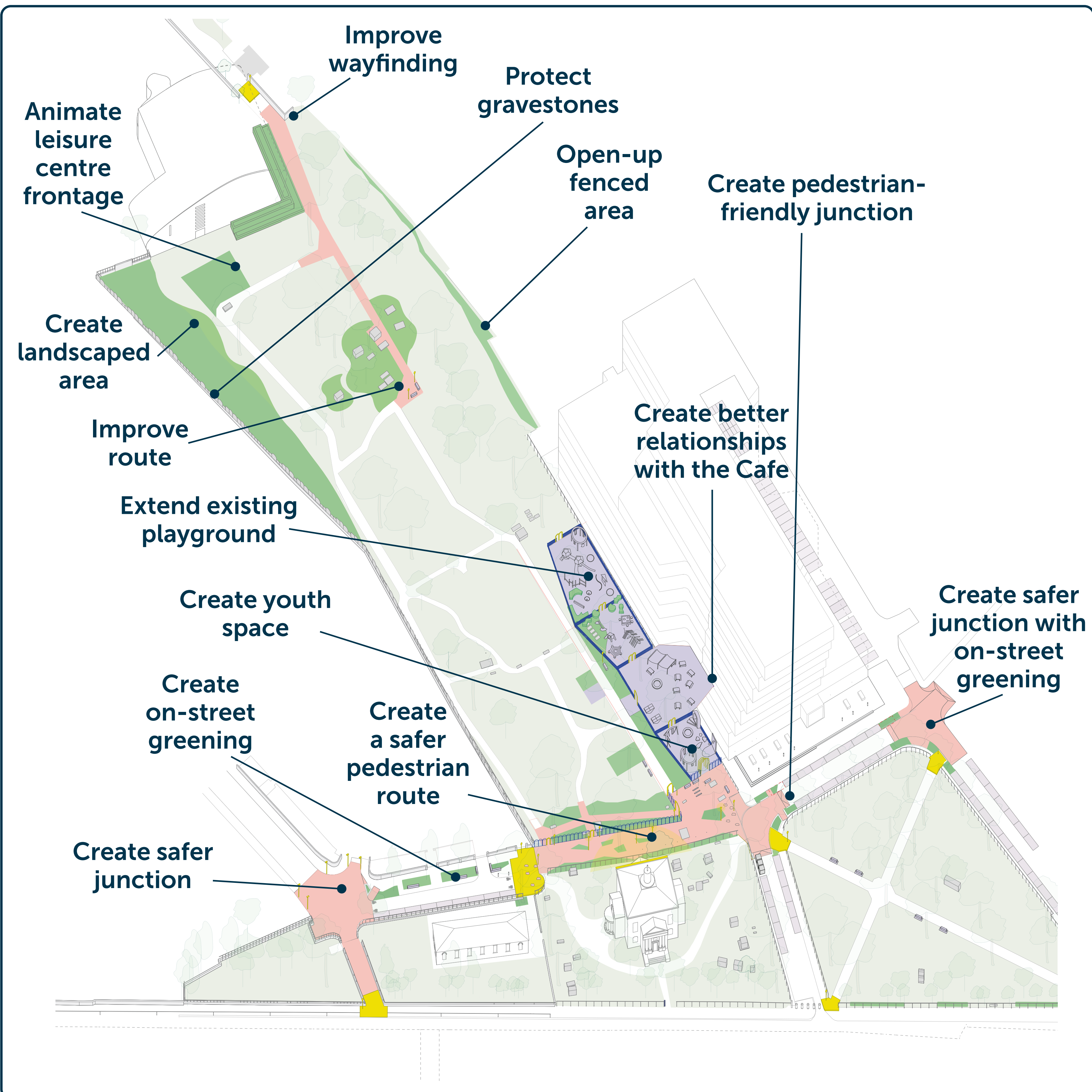

Accessibility and Safety
More continuous routes, smoother surfaces, and improved crossings to benefit everyone, especially those with mobility needs.

Leisure and Activity
More lively with added seating, play areas, and social spaces, transforming empty spaces into community-friendly hubs.

Boundaries
New boundaries, to increase legibility, accessibility and safety.

Wayfinding and Lighting
More legible routes with improved signage and clearer pathways accompanied with appropriate lighting features.

Biodiversity and Greening
Protecting natural and historic elements, increasing extents of green areas and biodiversity.



Rain Gardens



Play-on-the-Way



Lighting Routes



Gravestones Incorporated in Public Space



Feature Lighting



How does the Baseline Option respond to project objectives?

Protect and celebrate St Mary's Church heritage

- ① Creating entrance forecourt
- ② Protecting and restoring low level historic hedgerows

Improve accessibility, legibility and promote healthy public spaces

- ③ Widen, green and improved lighting for safer pedestrian route at Church Walk
- ④ Improving bin facilities
- ⑤ Replacing fence line to widen route
- ⑥ Creating raised tables for safer pedestrian experience
- ⑦ Creating wayfinding strategy, with signs in specific places
- ⑧ Improving lighting
- ⑨ Creating linear biodiverse planting and rain gardens
- ⑩ Creating new entrances with celebratory structures and wayfinding
- ⑪ Lighting Church

Animate the different green spaces to offer a variety of playful activities

- ⑫ Creating informal play-on-the way

Concept drawings illustrating the proposals. These drawings do not reflect materiality or design of special features, which will be developed at a later stage.



Proposed: Improved and widen route at Church Walk



Existing: Church Walk connection route



Existing: Church Square and Nursery building



Proposed: Safe, welcoming and playful street, here showing Church Square





Play Street



Feature Lighting



Shared and Planted Routes



Celebrate History in Public Spaces



Lighting Routes



How does the Enhanced Option respond to project objectives?

Protect and celebrate St Mary's Church heritage

- ① Creating entrance forecourt
- ② Protecting and restoring low level historic hedgerows

Improve accessibility, legibility and promote healthy public spaces

- ③ Improving bin facilities
- ④ Replacing fence line to widen route
- ⑤ Creating raised tables for safer pedestrian experience
- ⑥ Creating wayfinding strategy, with signs in specific places
- ⑦ Improving lighting
- ⑧ Creating linear biodiverse planting and rain gardens
- ⑨ Creating new entrances with celebratory structures and wayfinding
- ⑩ Lighting Church on all sides
- ⑪ Creating new pedestrian route with segregated cycling lanes
- ⑫ Planting new trees
- ⑬ Creating green sustainable drainage features
- ⑭ Expanding cycle parking

Animate the different green spaces to offer a variety of playful activities

- ⑮ Creating play street
- ⑯ Creating new pedestrian area with seating and planting
- ⑰ Creating green promenade street with new trees

Concept drawings illustrating the proposals. These drawings do not reflect materiality or design of special features, which will be developed at a later stage.



Proposed: New pedestrian route and cycle lanes at Church Walk



Existing: Church Walk connection route



Existing: Church Square and Nursery building



Proposed: New welcoming play street, here showing Church Square





Existing: Children play area by the College



Existing: Overgrown and boarded-up green area along the Churchyard Eastern edge

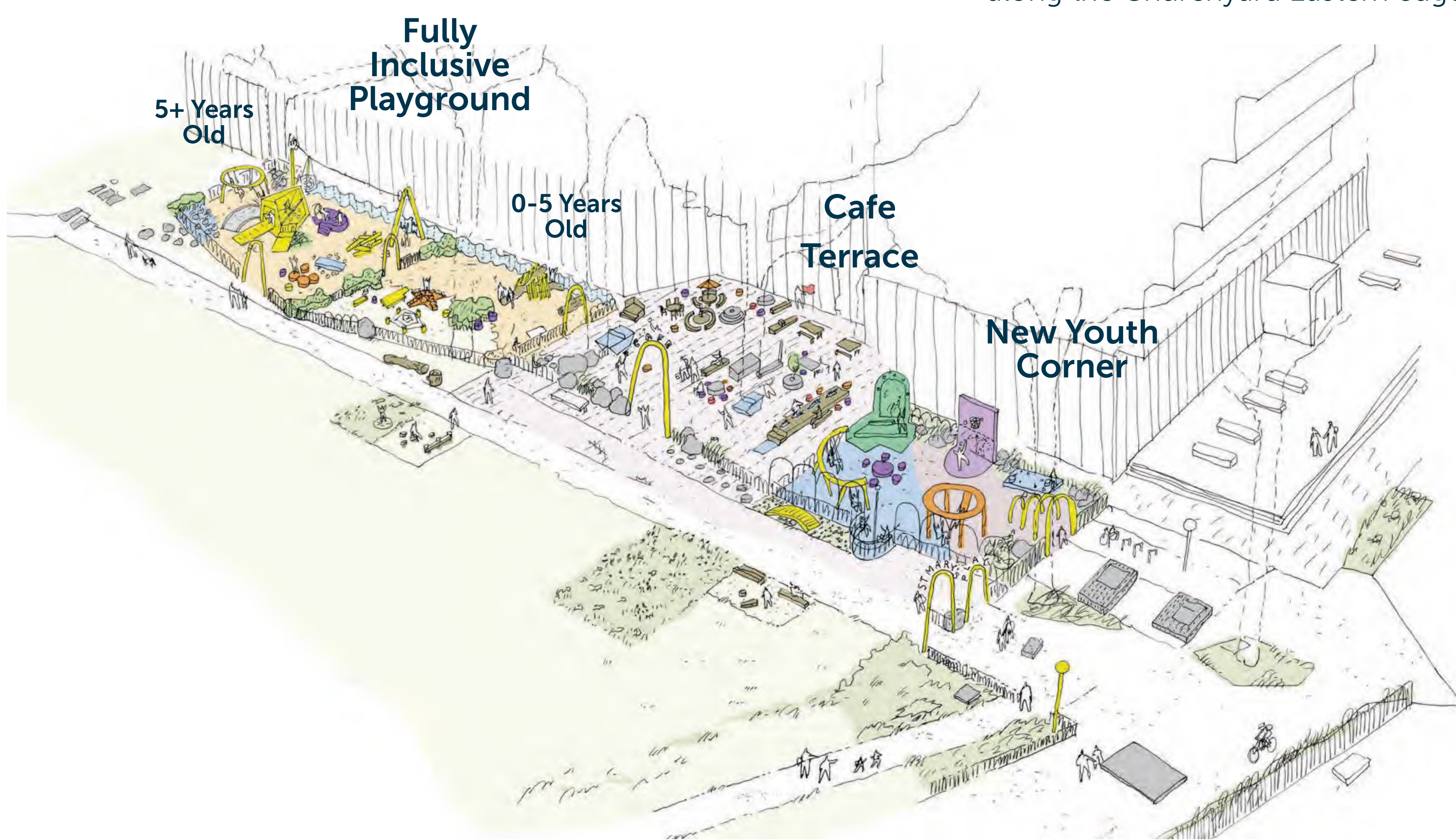

Baseline Option : A refurbished playground with a new inclusive play area extension



Flower Bulb Carpets



Improved Playground



Heritage Celebration Spaces



Low Level Swale Planting

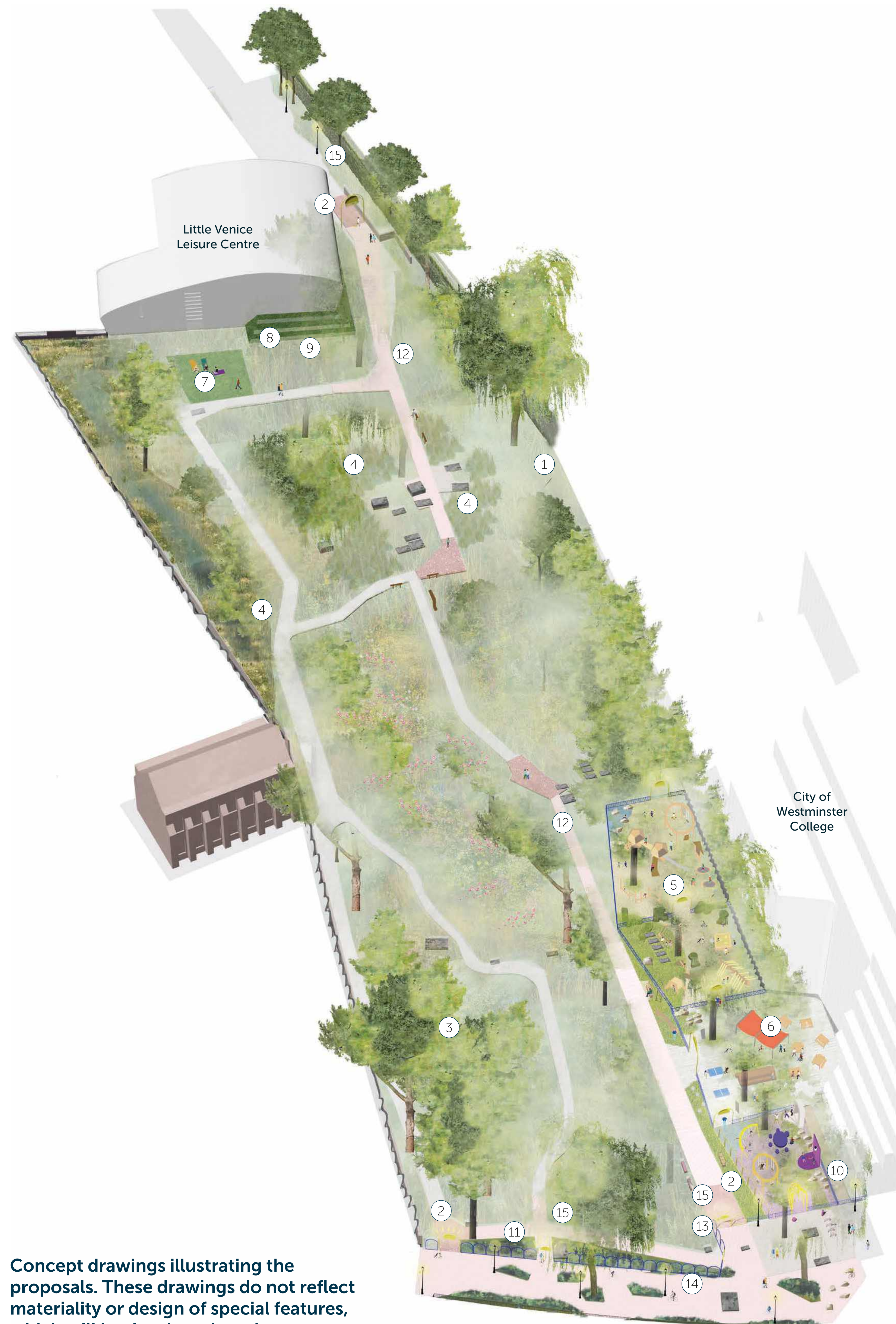

Concept drawings illustrating the proposals. These drawings do not reflect materiality or design of special features, which will be developed at a later stage.

How does the Baseline Option respond to project objectives?

Protect and celebrate St Mary's Churchyard greenery and heritage

- ① Opening fence area and restoring low level historic planting with grasses and flower bulbs
- ② Creating entrance mats
- ③ Protecting all existing trees, wild-flower meadows and gravestones
- ④ Increasing biodiversity by planting bulbs and low level flower carpets

Animate the different green spaces to offer a variety of playful activities

- ⑤ Creating new large inclusive playground for 0-12+ years old and adults with disabilities.
- ⑥ Creating cafe terrace
- ⑦ Creating a flatten quite exercise area (yoga, outdoor gym equipment, stretching..)
- ⑧ Creating tiered biodiverse planting
- ⑨ Creating picnic mowed grass areas
- ⑩ Create inclusive youth corner

Improve accessibility, safety and promote healthy public spaces

- ⑪ Replacing the fences and location
- ⑫ Upgrading the pathway and creating a portion of a straight route through with end to end visibility
- ⑬ Creating wayfinding strategy, with signs in specific places
- ⑭ Improving lighting
- ⑮ Creating new entrances with celebratory structures and wayfinding





Existing: Children play area by the College



Existing: Overgrown and boarded-up green area along the Churchyard Eastern edge

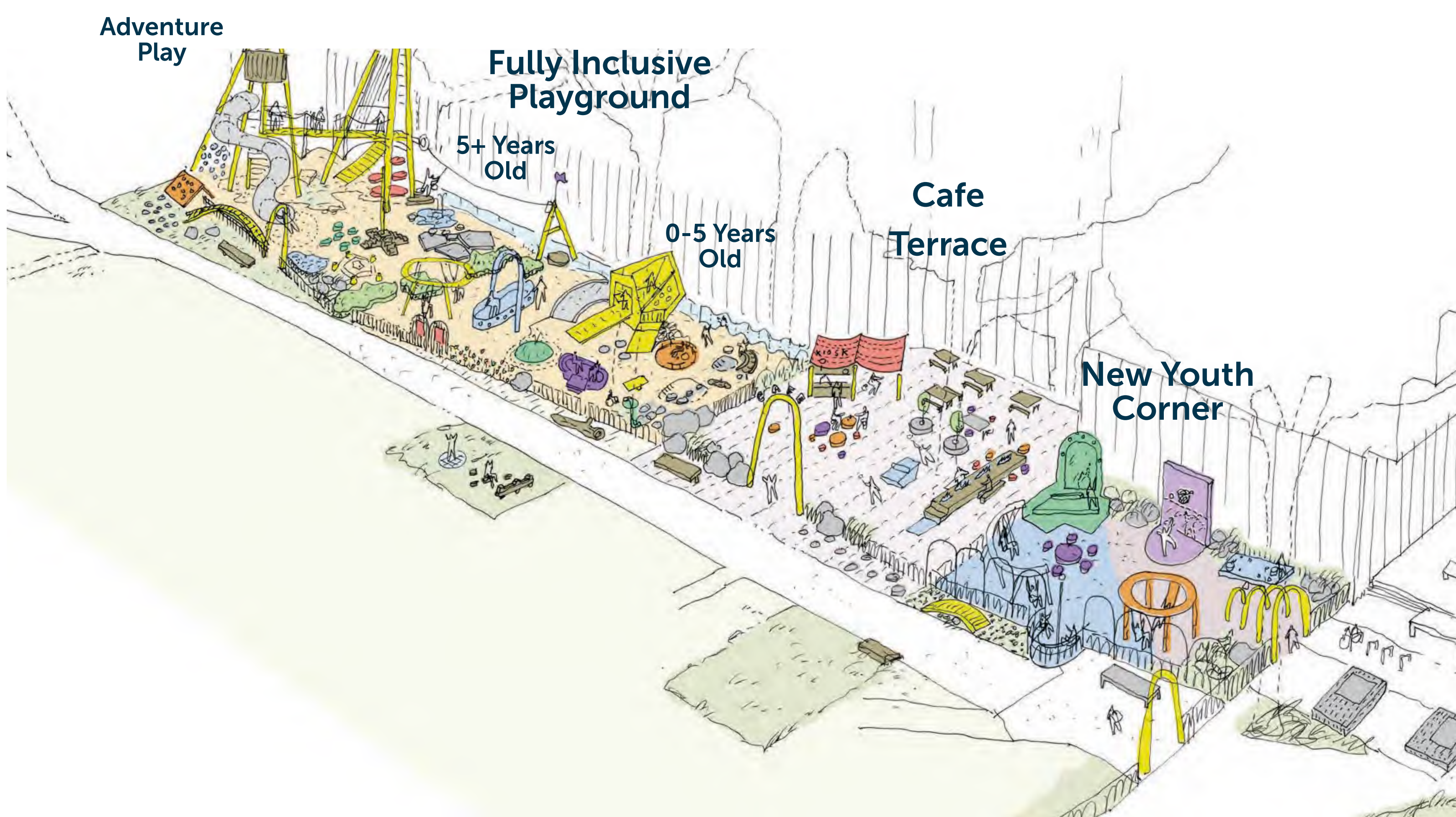

Enhanced Option : A new youth corner and a large inclusive playground



Straighter Paths



Natural Play Pockets



Adventure Playground



Inclusive Play

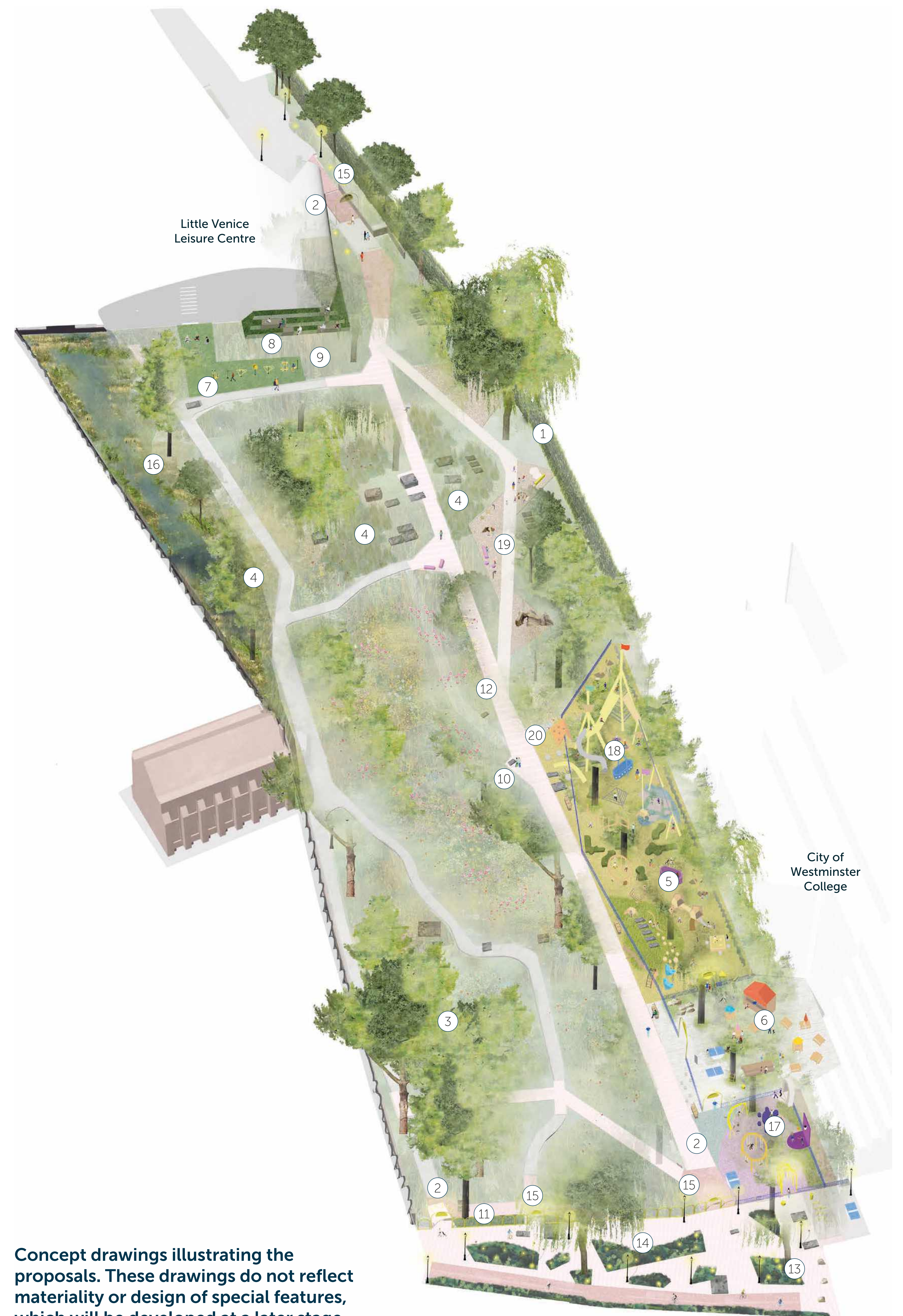

City of Westminster
 College

How does the Enhanced Option respond to project objectives?

Protect and celebrate St Mary's Churchyard greenery and heritage

- ① Opening fence area and restoring low level historic planting with grasses and flower bulbs
- ② Creating entrance mats
- ③ Protecting all existing trees, wild-flower meadows and gravestones
- ④ Increasing biodiversity by planting bulbs and low level flower carpets

Animate the different green spaces to offer a variety of playful activities

- ⑤ Creating new large inclusive playground for 0-12+ years old and adults with disabilities.
- ⑥ Creating cafe terrace
- ⑦ Creating a flatten quite exercise area (yoga, outdoor gym equipment, stretching..)
- ⑧ Creating tiered biodiverse planting with seating

- ⑨ Creating picnic mowed grass areas

- ⑩ Create inclusive seating
- ⑬ Creating youth corner
- ⑭ Creating new adventure play area
- ⑮ Creating nature-based play pockets
- ⑯ Creating play-on-the-way opportunities

Improve accessibility, safety and promote healthy public spaces

- ⑪ Replacing the fences and location
- ⑫ Upgrading the pathway and creating a continuous new straight route through with end to end visibility
- ⑬ Creating wayfinding strategy, with signs in specific places
- ⑭ Improving lighting
- ⑮ Creating new entrances with celebratory structures and wayfinding

Concept drawings illustrating the proposals. These drawings do not reflect materiality or design of special features, which will be developed at a later stage.



TWO LEVELS OF AMBITIONS

Baseline

Improved routes across the Westway

The aim of the baseline proposals is to improve the pedestrian experience from and to the Westway.

The baseline proposals would involve minimal changes to the kerb lines and parking provisions.

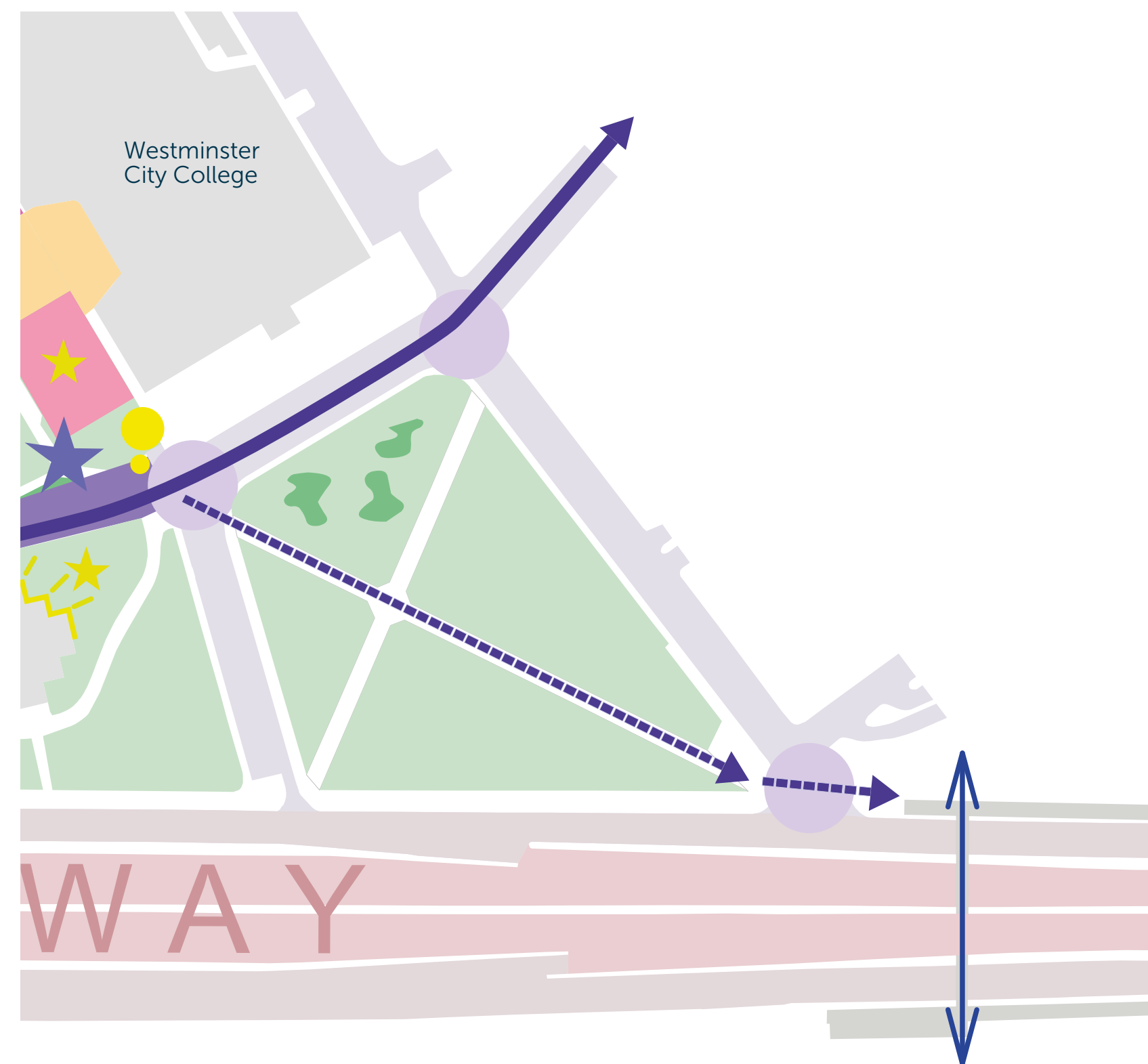

- Entrances
- Play and heritage trail
- Greening and biodiversity
- Safer and more accessible route
- Secondary route improvements
- Connect to surrounding developments
- Wayfinding and lighting

Baseline

+ Enhanced

New routes and enhanced experience along the Westway

The aim of the enhanced proposal is to create new pedestrian routes through each public space, offering greener and healthier street environments.

The enhanced proposals would involve parking spaces to be relocated to the College's side.

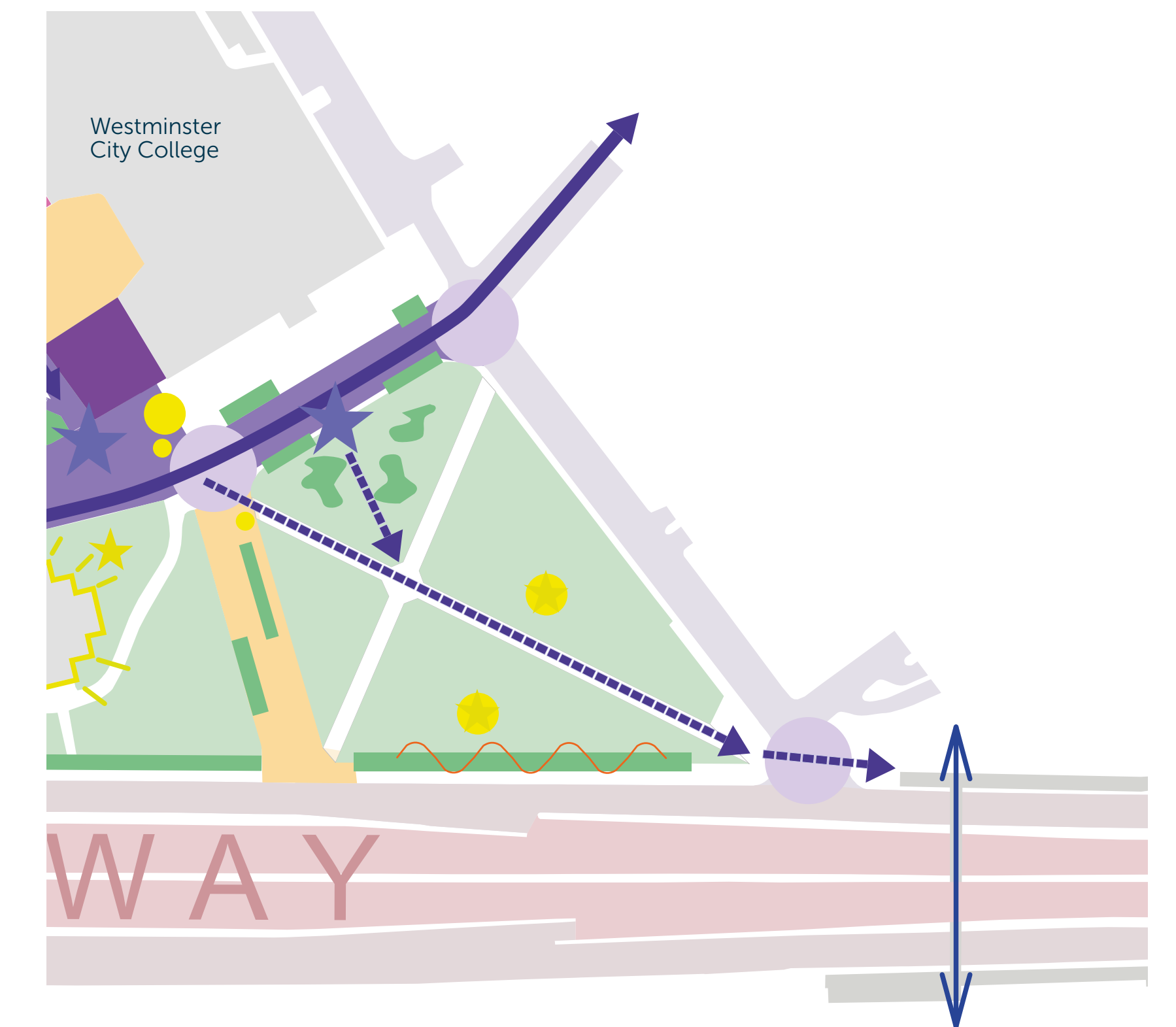

- Entrances
- Play and heritage trail
- Greening and biodiversity
- Seating and greening street
- Safer and more accessible route
- Secondary route improvements
- Connect to surrounding developments
- Wayfinding and lighting
- Noise and pollution mitigation

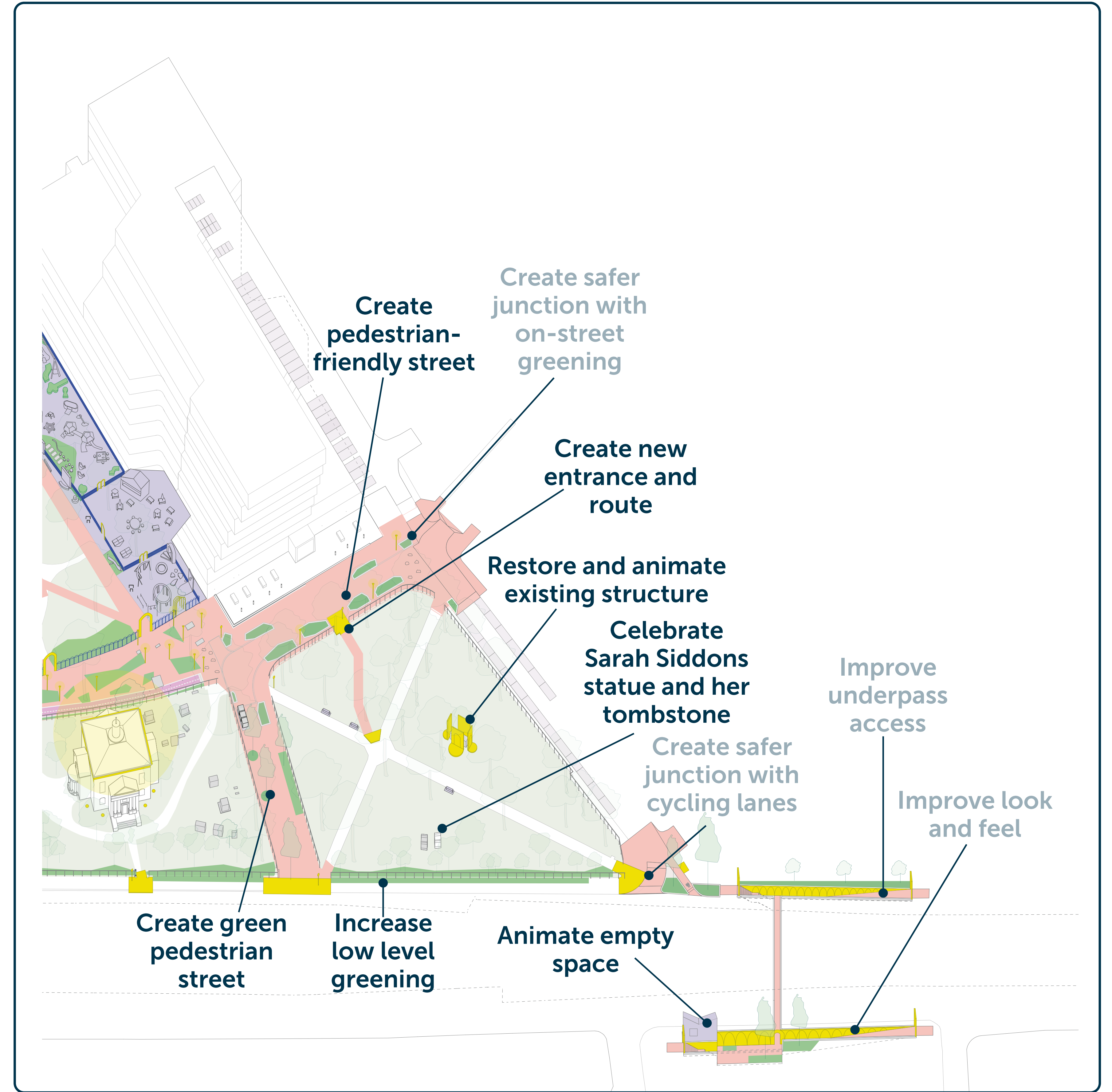
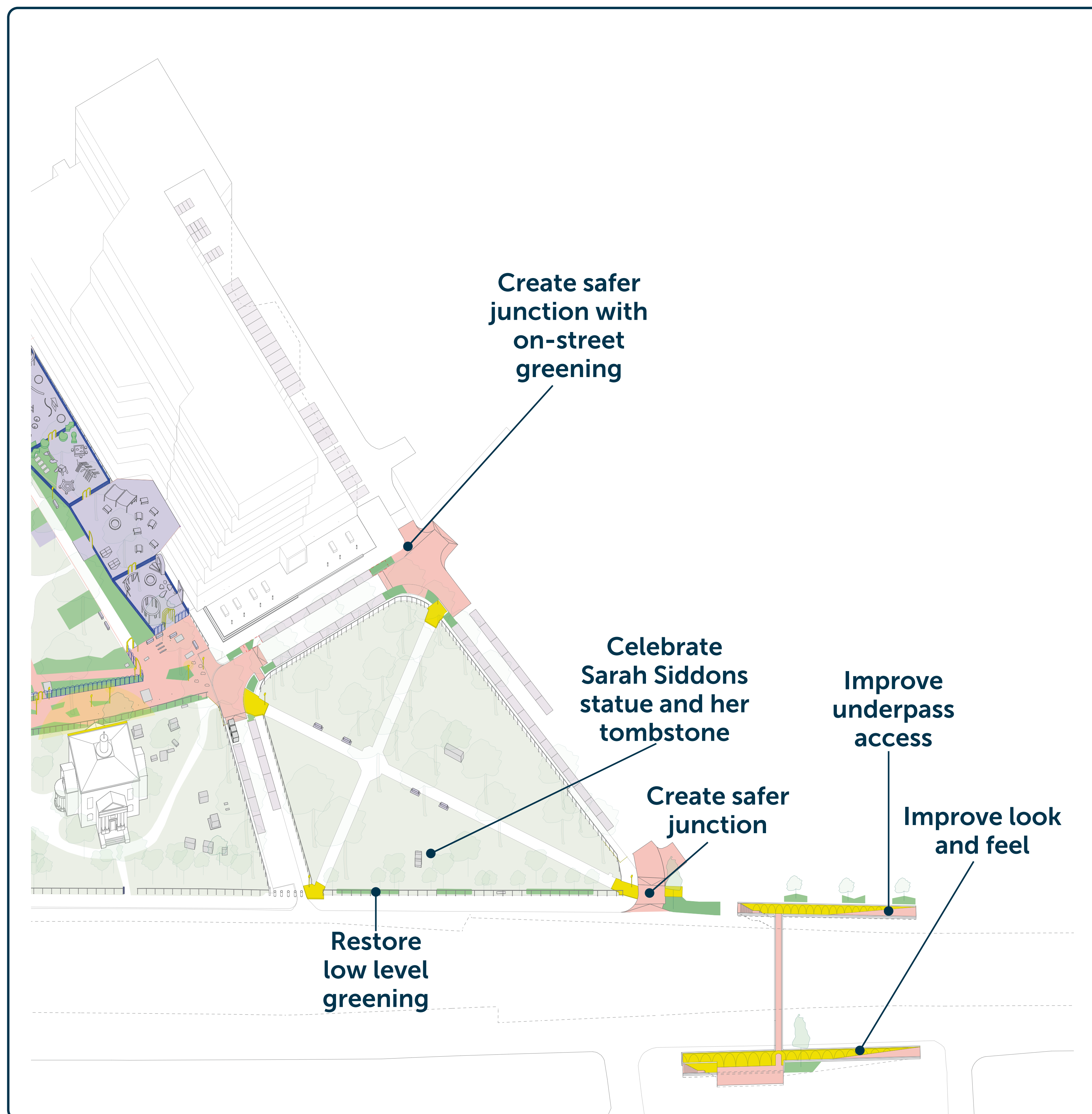

Accessibility and Safety

More continuous routes, smoother surfaces, and improved crossings to benefit everyone, especially those with mobility needs.

Leisure and Activity

More lively with added seating, play areas, and social spaces, transforming empty spaces into community-friendly hubs.

Boundaries

New boundaries, to increase legibility, accessibility and safety.

Wayfinding and Lighting

More legible routes with improved signage and clearer pathways accompanied with appropriate lighting features.

Biodiversity and Greening

Protecting natural and historic elements, increasing extents of green areas and biodiversity.



BASELINE OPTION



Safer Underpass



Rain Gardens



Raised Anti-Speeding Tables



Low Level Biodiversity



Improved Entrances



Celebrate History in Public Spaces



Concept drawings illustrating the proposals. These drawings do not reflect materiality or design of special features, which will be developed at a later stage.

How does the Baseline Option respond to project objectives?

Protect and celebrate Paddington Green's heritage

- ① Protecting and restoring low level historic hedgerows
- ② Creating entrance mats
- ③ Protecting all existing trees
- ④ Improve bin facilities

Improve accessibility, legibility, safety and promote healthy public spaces

- ⑤ Widening pedestrian route with allowance for cycling access
- ⑥ Creating on-street sustainable drainage systems with planting
- ⑦ Creating raised tables for safer pedestrian experience
- ⑧ Creating wayfinding strategy, with signs in specific places
- ⑨ Improve lighting
- ⑩ Improve entrances with celebratory structures and wayfinding
- ⑪ Improving cladding, tiling and lighting
- ⑫ Upgrading junction's layout with raised table and safer crossing

Animate the different edges to offer a variety of playful activities

- ⑬ Improving seating areas
- ⑭ Relocating two parking spaces
- ⑮ Creating artwork on walls



Proposed: New raised tables and entrances to Paddington Green



Existing: College forecourt with St Mary's Church in the background



Existing: Westway Underpass southern entrance



Proposed: A safer and more inviting route at the underpass





Rain Gardens



Raised Anti-Speeding Tables



Playful Tiles



Playful Opportunities

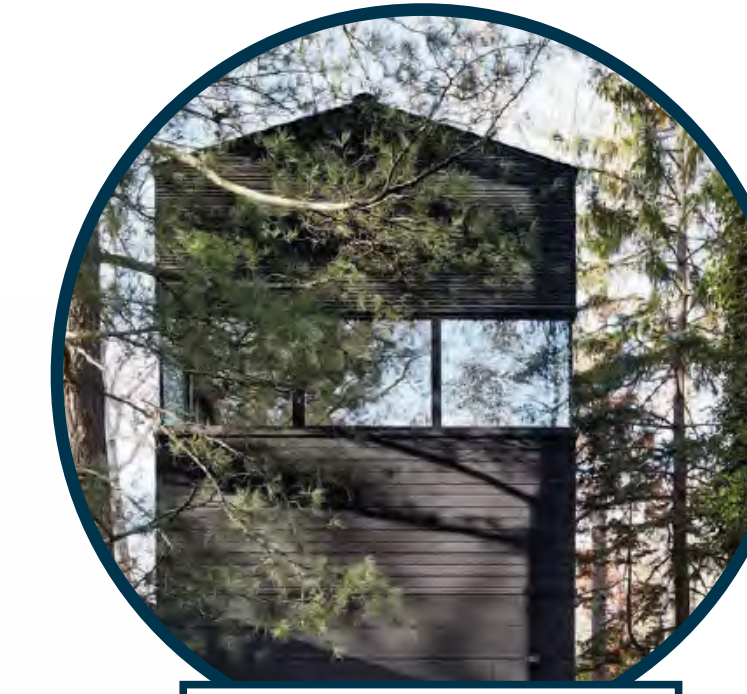

Workspace Pavilion

How does the Enhanced Option respond to project objectives?

Protect and celebrate Paddington Green's heritage

- ① Protecting and restoring low level historic hedgerows
- ② Creating entrance mats
- ③ Protecting all existing trees
- ④ Improve bin facilities
- ②② Increasing biodiversity with flower bulb carpet

Improve accessibility, legibility, safety and promote healthy public spaces

- ⑤ Widening pedestrian route with allowance for cycling access
- ⑥ Creating on-street sustainable drainage systems with planting
- ⑦ Creating raised tables for safer pedestrian experience
- ⑧ Creating wayfinding strategy, with signs in specific places
- ⑨ Improve lighting
- ⑩ Creating new entrances with celebratory structures and wayfinding
- ⑪ Improving cladding and tiling
- ⑫ Upgrading junction's layout with raised table and safer crossing and segregated cycling lanes
- ⑬ Creating new entrance and connecting pathway
- ⑭ Creating linear biodiverse planting and rain gardens

Animate the different edges to offer a variety of playful activities

- ⑬ Improving seating areas
- Relocating parking spaces
- ⑭ Creating artwork on underpass walls
- ⑮ Turn statue of Sarah Siddon to face into the green
- ⑯ Creating playful and celebratory structure for the existing bunker
- ⑰ Creating small workspace building opportunity
- ⑱ Creating green promenade street with new trees



Concept drawings illustrating the proposals. These drawings do not reflect materiality or design of special features, which will be developed at a later stage.

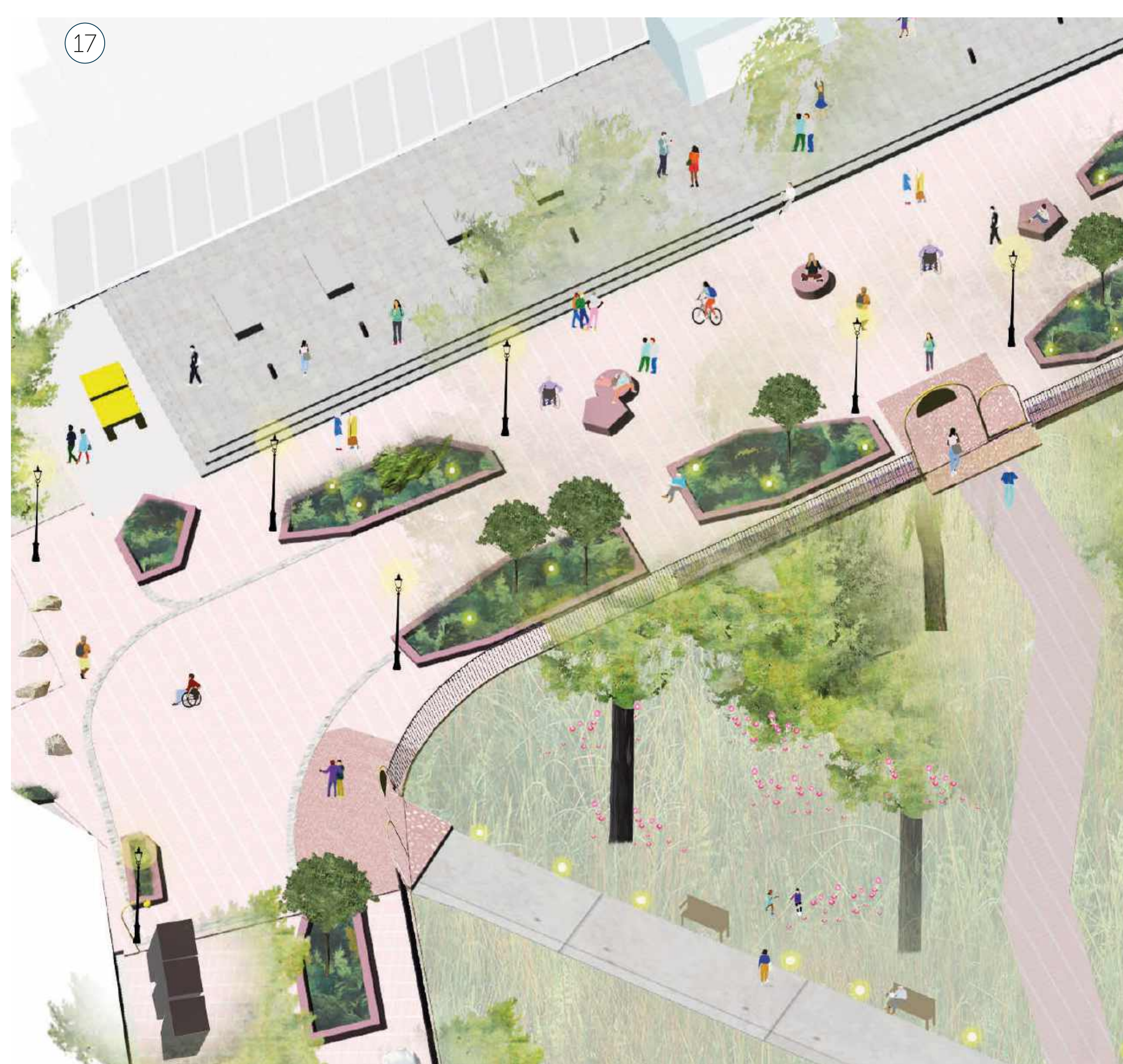

Proposed: New pedestrian street with vehicular access maintained.



Existing: College forecourt looking towards Church Street



Existing: Westway Underpass southern entrance



Proposed: A greener, safer and more inviting route at the underpass

