

## **SELECTRONIC™** **Proximity Faucets**

### **Cast Spout**

6055.104 6056.104 6057.105  
6055.105 6056.105 6057.102  
6055.102 6056.102

### **6" GN Spout**

6055.164 6056.164 6057.165  
6055.165 6056.165 6057.163  
6055.163 6056.163



**Cast Spout and  
Goose Neck Spout**



**CAUTION:** Use only American Standard supplied cable sets. Using non-AS supplied cables, or cutting, splicing or modifying any components will void the warranty.

<b>Product No.'s &amp; Options</b>	<b>1</b>
<b>Specifications</b>	<b>2</b>
<b>How to Install</b>	<b>2-3</b>
<b>Electrical Hook-up</b>	<b>4-6</b>
<b>Maintenance</b>	<b>7-8</b>
<b>FAQ,s</b>	<b>9-10</b>
<b>Replacement Parts</b>	<b>11</b>

Certified to comply with ASME A112.18.1M  
© 2005 American Standard

M968809 Rev.1.7

*American Standard*

**NOTE TO INSTALLER:** Please give this manual to the customer after installation.

To learn more about American Standard Faucets visit our website at: [www.us.amstd.com](http://www.us.amstd.com) or U.S. customer's e-mail us at: [sensor@americanstandard.com](mailto:sensor@americanstandard.com)

**For Parts, Service, Warranty or other Assistance,**  
please call **(855) 752-9259 (In Canada: 1-800-387-0369)**  
(In Toronto Area only: 1-905-3061093)

Thank you for selecting American-Standard...the benchmark of fine quality for over 100 years. To ensure that your installation proceeds smoothly--please read these instructions carefully before you begin.

## UNPACKING

All American Standard Faucets Are Water Tested At Our Factory.  
Some Residual Water May Remain In The Faucet During Shipping.

1. Remove the fitting and loose items from the carton. The illustration below shows the fitting and all loose items after they have been removed from the carton. Some items may be packaged partially assembled to other items.

1. Selectronic Spout Assembly

2. Mounting Kit

3. Electrical Enclosure

4. Supply Hose

5a. DC Battery (for 6055 series)

5b. AC Power Supply (for 6056 series)

5c. 10 ft. Extension Wire (for 6057 series)

6. Y-Connector

7. 4" Deck plate ( optional must be ordered separately)

8. 8" Deck plate ( optional must be ordered separately)

9. Mixing Valve ( optional must be ordered separately)

10. Key for vandal resistant aerator

11. 27" Extension Wire (for 6057 series)

### How to order the Selectronic Product

1. Choose Power Supply
2. Choose Desired Spout

#### Base Product

- Single Hole Sink
- Single Inlet



#### Deck Plate (optional)

- 1 and 3 Hole Sinks
- Single Inlet



#### Mixing Valve (optional)

- 1 and 3 Hole Sinks
- Hot and Cold Inlets

	Cast Spout	6" GN Spout
Base Product	<p>PRODUCT No.s</p> <p>6055.104 6055.105 6055.102  6056.104 6056.105 6056.102  6057.105 6057.102</p>	<p>PRODUCT No.s</p> <p>6055.164 6055.165 6055.163  6056.164 6056.165 6056.163  6057.165 6057.163</p>
Deck Plate	<p>605P400</p> <p>605P800</p>	
Mixing Valve	<p>605XTMV</p>	

**Fig. 1**

## Roughing-in Dimensions

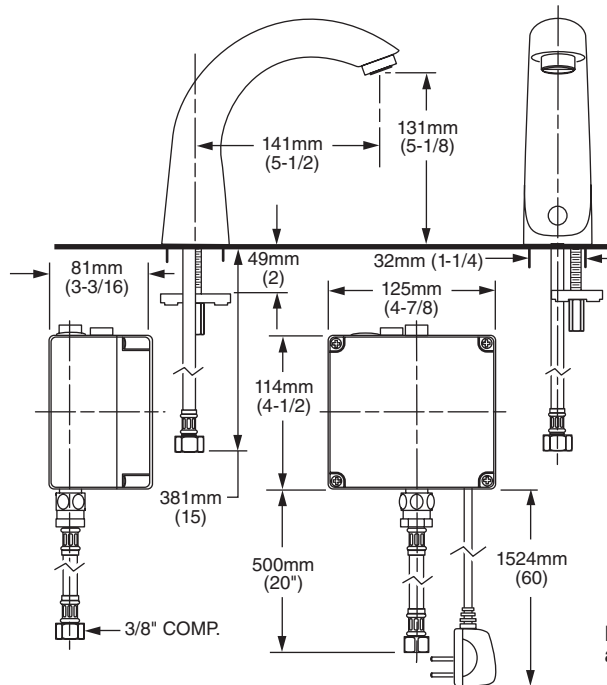

**CAUTION:** Use only American Standard supplied cable sets. Using non-AS supplied cables, or cutting, splicing or modifying any components will void the warranty.

### GENERAL DESCRIPTION:

Electronic faucet with proximity operation. Vandal resistant solid brass construction single post mounting. Operates on DC (battery) or AC permanent power. In-line strainer for solenoid is integral. Single inlet 3/8 compression, built-in checks, and flexible stainless steel 15" reach inlet hose for spout connection.

**Note:** All plumbing and electrical wiring must be installed in accordance with applicable codes, regulations and standards.

## TOOLS REQUIRED; Fig. 2

- 1 Channel Locks
- 2 Adjustable Wrench
- 3 Plumbers' Putty or Caulking
- 4 Phillips Screwdriver
- 5 Flat Blade Screwdriver
- 6 Electric Drill & 1/4" Drill Bit
- 7 Tape Measure

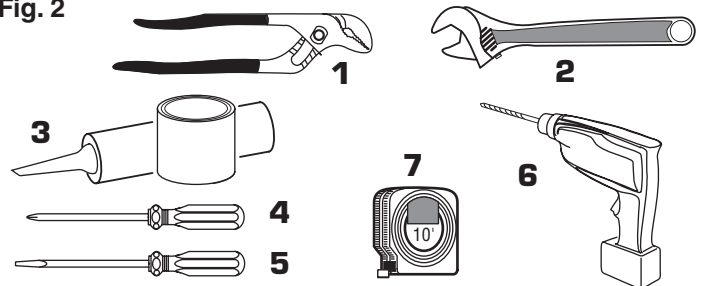
**Fig. 2**

## INSTALLATION

### 1 INSTALL SPOUT ASSEMBLY; Fig. 1

**CAUTION** Turn off hot and cold water supplies before beginning

1. (Optional) Assemble DECK PLATE (1) and PUTTY PLATE (2) to FAUCET BODY (3) with SCREW (4). **Fig. 1.**
2. Connect the two 27" EXTENSION CABLES (5) to the Faucet Sensor Cables. **Fig. 1.**
3. Insert 27" EXTENSION CABLES (5), FLEX HOSE (6) and SPOUT SHANK (7) through center hole of mounting surface. **Fig. 1a.**
4. Assemble "C" WASHER (8) and LOCKNUT (10) onto threads of SPOUT SHANK (7) from underside of mounting surface. **Fig. 1b.**
5. Align FAUCET (3) and tighten LOCKNUT (10). If using DECK PLATE (1) hand tighten DECK PLATE SPIN NUTS (11) to secure FAUCET (3) to mounting surface. **Fig. 1b.**

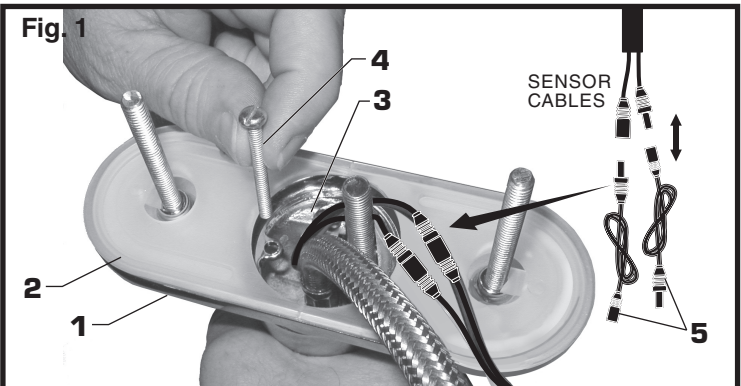
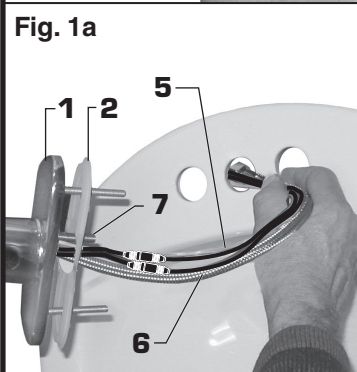
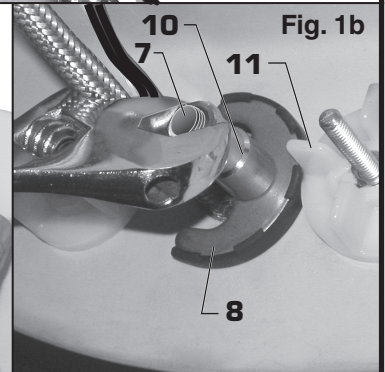
**Fig. 1****Fig. 1a****Fig. 1b**

## 2 MOUNT ENCLOSURE; Fig. 2

1. Determine location of ENCLOSURE (1). It must be located with-in the 14" (356mm) by 21" (533mm) shaded area shown in **Figure 2** in order for electrical connections from the spout assembly to be made.

**NOTE: ENCLOSURE SUPPLY HOSE is 20". Distance between wall supply and ENCLOSURE (1) must be taken into consideration.**

2. Remove 4 screws from COVER (2) and pull off COVER (2). Hold the ENCLOSURE (1) in desired location and mark the four mounting hole locations as shown. **Fig. 2.**

**NOTE: For AC installation see "AC VERSION; Fig. 2." Make power supply connection before mounting ENCLOSURE (1) to wall.**

3. The ENCLOSURE (1) works best if secured to a wall stud or cross brace within the wall, using the SCREWS (3) supplied. If the ENCLOSURE (1) is to be installed on a tile or plaster wall the ANCHORS (4) and SCREWS (3) should be used.

4. For installations on drywall or tiled walls; use ANCHORS (4) and SCREWS (3) for securing ENCLOSURE (1) to finished wall. Drill four 1/4" dia. holes a minimum of 1-3/4" deep. Insert the four ANCHORS (4) flush with face of the finished wall. Align the ENCLOSURE (1) and Install the MOUNTING SCREWS (3). Tighten to secure ENCLOSURE (1) to mounting surface.

## 3 CONNECT SPOUT HOSE TO ENCLOSURE; Fig. 3

1. Connect SUPPLY NUT (1) from spout assembly to nipple on top of ENCLOSURE (2). Tighten with adjustable wrench to make a water tight connection. **Fig. 3.**

## 4 CONNECT WATER SUPPLY TO ENCLOSURE AND WALL SUPPLY; Fig. 4

**NOTE; If using the optional Mixing Valve See Sheet #M968808 for installation instructions.**

1. Insert FIBER WASHER (4) into SUPPLY NUT (1) on ENCLOSURE (2).

2. Connect SUPPLY NUT (1) on ENCLOSURE (2) to FLEXIBLE SUPPLY HOSE (3). Tighten to make a water tight connection. Use two wrenches to tighten if necessary. **Fig. 4.**

3. Connect FLEXIBLE SUPPLY (3) directly to wall supply. Connection on FLEXIBLE SUPPLY (3) is 3/8" compression. Use adjustable wrench to tighten connection. Do not over tighten. **Fig. 4a.**

**Note:** FLEXIBLE SUPPLY (3) measures 20" from the bottom of the ENCLOSURE (1) base. If additional supply length is required, installer must purchase parts separately.  
**Important:** If FLEXIBLE SUPPLY (3) is too long, loop to avoid kinking.

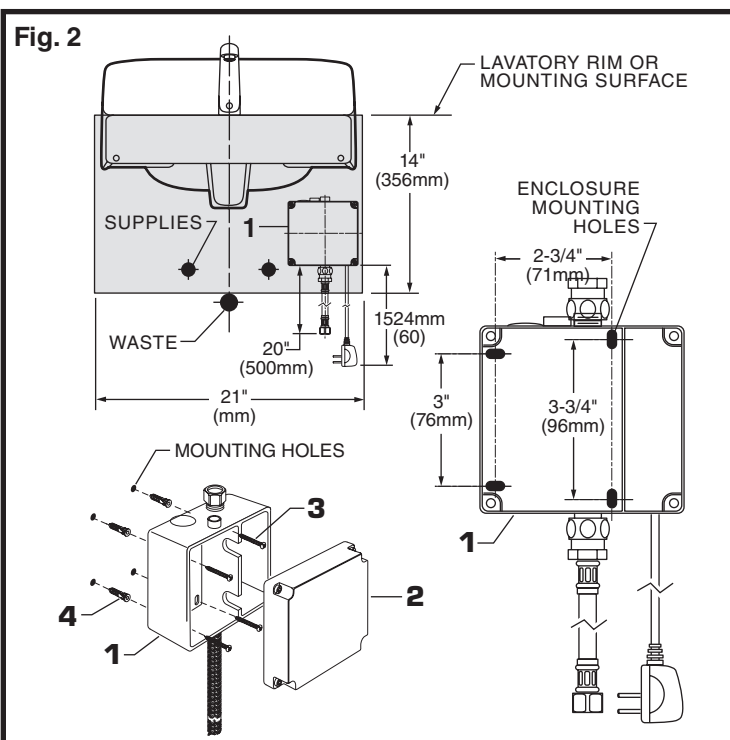

**NOTE: If using Mixing Valve (optional) See Sheet #M968808 for installation instructions.**

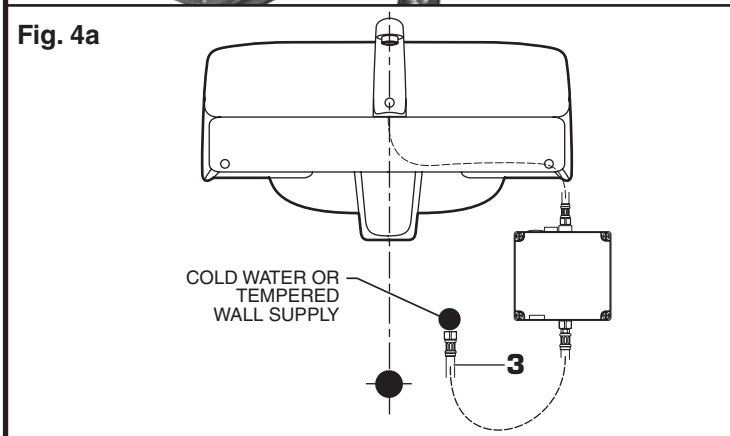
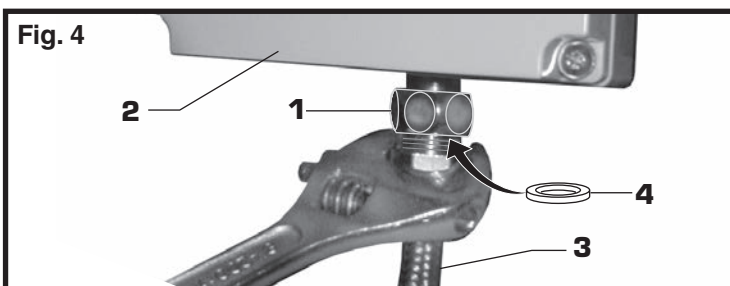
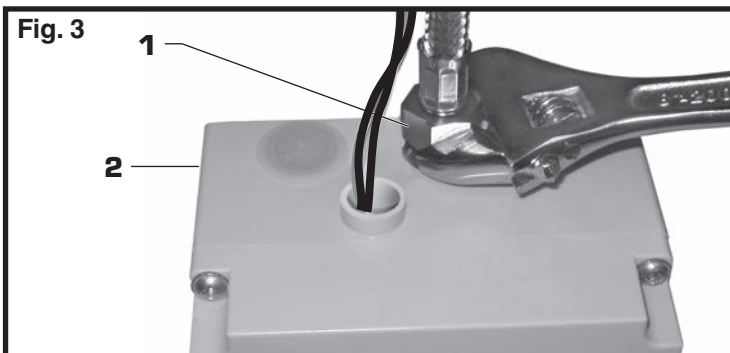

# ELECTRICAL INSTALLATION

## 1 DC VERSION (BATTERY); Fig. 1

1. Remove ENCLOSURE COVER (1). **Fig. 1.**
2. Feed the EXTENSION CABLES (2) from the Faucet through the top of ENCLOSURE (3). **Fig. 1a.**
3. Install BATTERY (4) if not already installed, make sure the shape of the BATTERY (4) follows the shape of the BATTERY HOLDER (5). **Fig. 1b.**
4. Insert the BATTERY CONNECTOR (5a) through GROMMET (6) as shown. **Fig. 1c.**
5. Connect SOLENOID CABLE (7) and BATTERY CONNECTOR (5a) to EXTENSION CABLES (2) from Faucet Sensor. **Fig. 1d.**
6. Replace ENCLOSURE COVER (1). Tighten cover screws firmly.

**CAUTION:** Use only American Standard supplied cable sets. Using non-AS supplied cables, or cutting, splicing or modifying any components will void the warranty.

Fig. 1

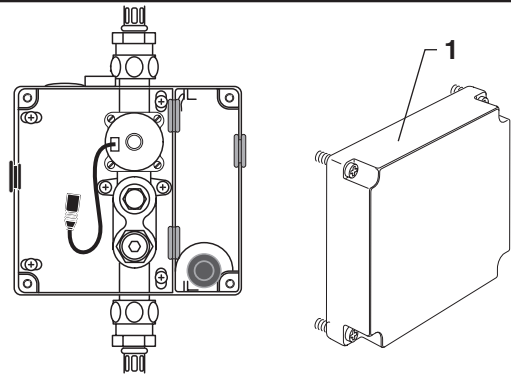

Fig. 1a

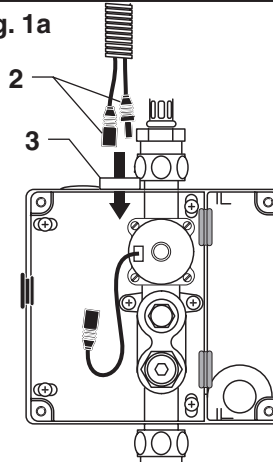

Fig. 1b

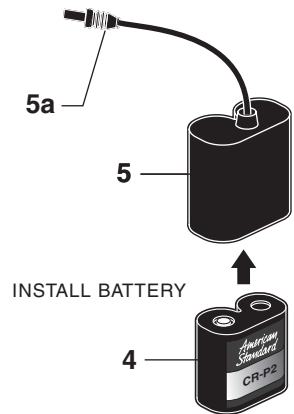

Fig. 1c

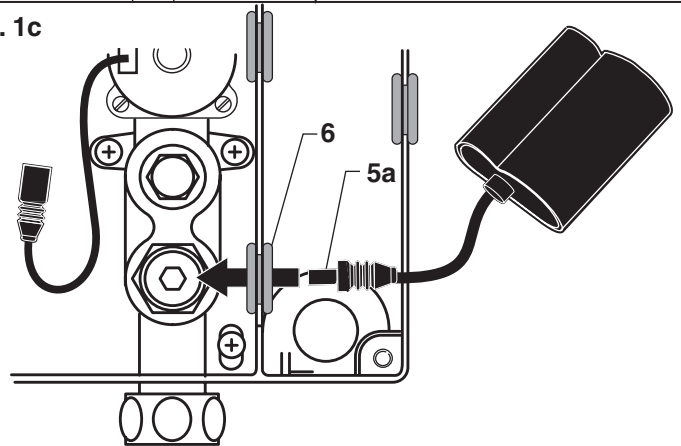
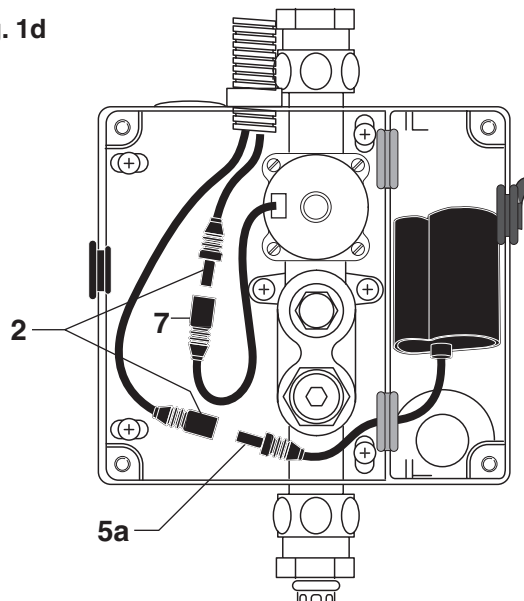

Fig. 1d





## 2 AC VERSION; Fig. 2

### CAUTION

Before opening ENCLOSURE disconnect AC power supply.

**NOTE:** For AC installation see Fig. 2b.  
Make power supply connection before mounting ENCLOSURE (1) to wall.

1. Remove ENCLOSURE COVER (1). Fig. 2.
2. Feed the EXTENSION CABLES (2) from the Faucet through the top of ENCLOSURE (3). Fig. 2a.
3. Remove SPLIT PLUG (4) from POWER SUPPLY GROMMET (5). Insert POWER CORD (7) into SPLIT PLUG (4). Insert POWER CORD CONNECTOR (6) through POWER SUPPLY GROMMET (5). Push SPLIT PLUG (4) into POWER SUPPLY GROMMET (5) to seal. Fig. 2b.
4. Insert POWER CORD CONNECTOR (6) through GROMMET (8) as shown.
5. Connect SOLENOID CABLE (9) and POWER CORD CONNECTOR (6) to EXTENSION CABLES (2) from Faucet Sensor. Fig. 2d.
6. Replace ENCLOSURE COVER (1). Tighten cover screws firmly.

Fig. 2

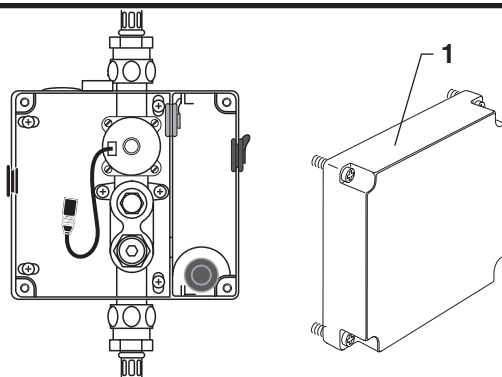

Fig. 2a

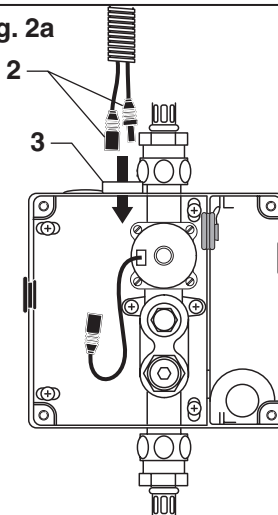

Fig. 2b

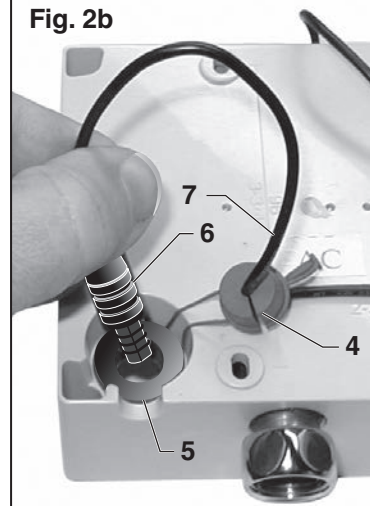

Fig. 2c

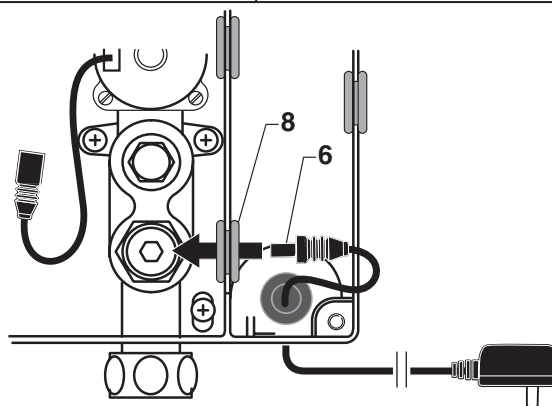
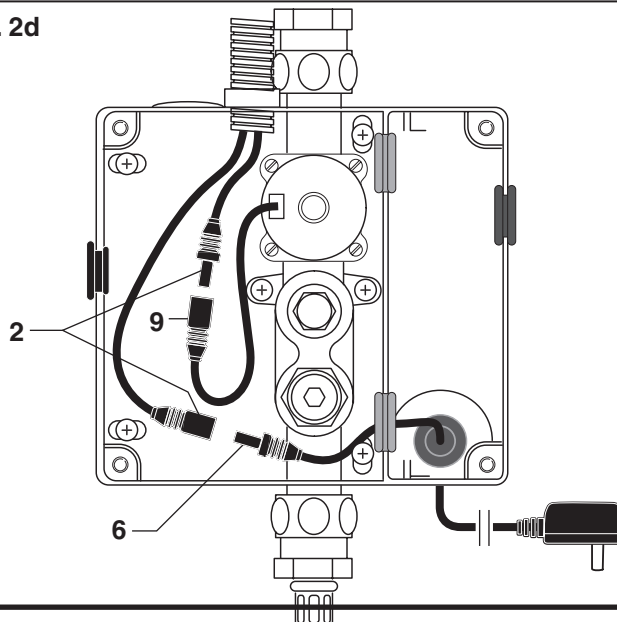
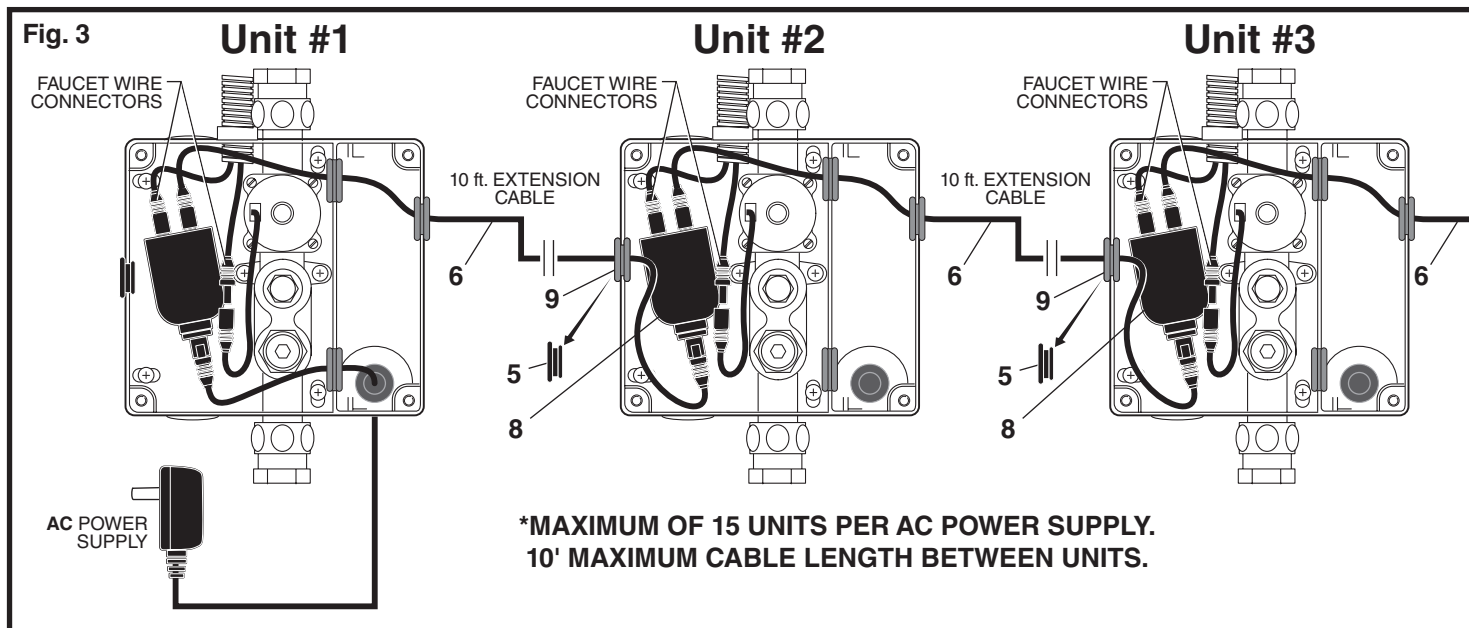

Fig. 2d





### 3 FOR AC-VERSION (MULTI HOOK-UP); Fig. 3, 3a, 3b

**NOTE:** For AC installation see "AC VERSION; Fig. 2b." Make power supply connection before mounting ENCLOSURE (1) to wall.

1. Remove COVERS from all ENCLOSURES (2). **Fig. 3.**
2. Remove SOLID BLACK INSERT (5) from left side of all ENCLOSURES (2), except from **Unit #1**. Replace with GRAY GROMMET (9). (Supplied with each Faucet). **Fig. 3.**
3. **All Units:** Connect the two 27" EXTENSION CABLES (4) to the Faucet Sensor Cables. Feed the 27" EXTENSION CABLE CONNECTORS (1, 1a) from the Faucet through the top of ENCLOSURE (2). **Fig. 3a.**
4. Connect one 27" EXTENSION CABLE (1) to the SOLENOID (3). **Fig. 3, 3a.** Connect the second 27" EXTENSION CABLE (1a) to the top of the Y-CONNECTOR (8).
5. Connect the 10 ft. EXTENSION CABLE (6) to the top of the Y-CONNECTOR (8). Feed the other end through the two GRAY GROMMETS (9) and connect to the bottom of the next Y-CONNECTOR (8). Place Y-CONNECTOR (8) into ENCLOSURE (2) as shown **Fig. 3a, 3b.**
6. Repeat Steps above for each additional **Unit**, for a Max. of 15 **Units** on one POWER SUPPLY (7). **Fig. 3.**
7. Replace ENCLOSURE COVERS. Tighten cover screws firmly.

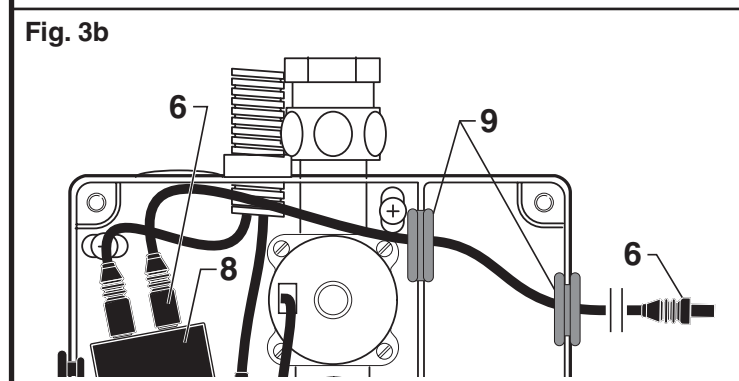
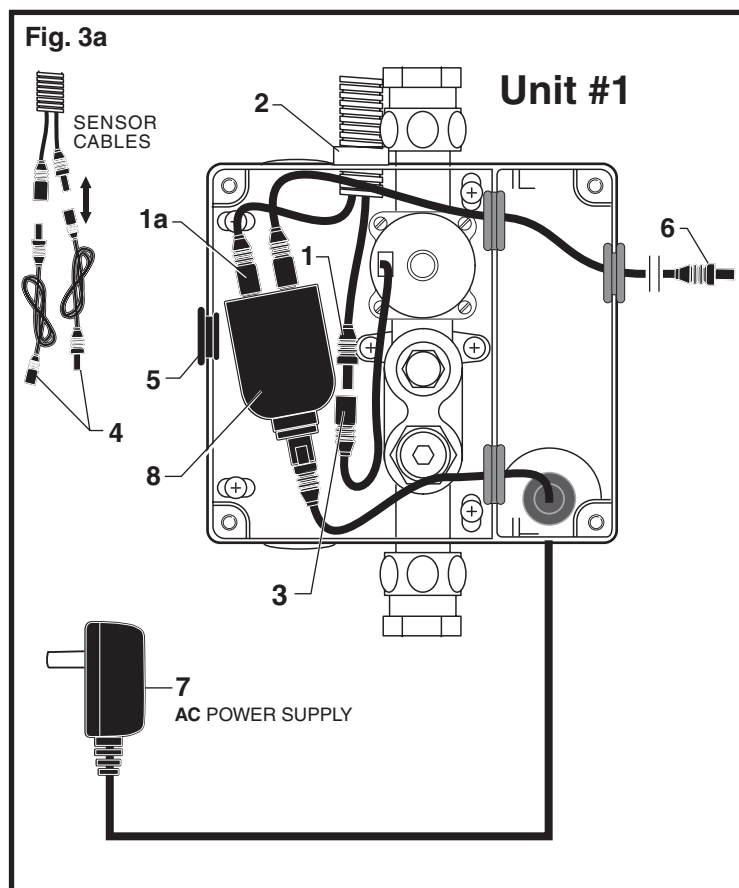

# MAINTENANCE

## 1 HAND WASH SENSOR OPERATION; Fig. 1

When the Sensor detects a user, the water immediately starts to flow. Water flow will stop Two seconds after user is out of sensor range. The off delay allows the user to comfortably move his hands without the flow cycling on to off. As a precaution, a safety timer will turn off the water, after the sensor has been blocked for 59 seconds. The water will stay off until the blockage is removed from the detection zone.

**Detection Zone: 2" - 10" (50mm - 250mm)**

**Default: Set at Factory 6" (150mm)**



## 2 HOW TO CHANGE SENSOR RANGE; (Factory set at 6") Fig. 2

1. Setting the Detection Zone (Distance):  
Remove cover from ENCLOSURE. Disconnect Power Supply (1), then reconnect. **Fig. 2.**

2. While the SENSOR CONTROL LED (2) is blinking slowly, place your hand 1 - 2 in. (30-50mm) in front of the sensor. **Fig. 2a.**

3. When the LED stops blinking and stays "ON", move your hand to the desired position and hold in place until the LED begins to blink again. **Fig. 2a.**

4. Once the SENSOR CONTROL LED (2) begins to blink again, remove your hand from the detection zone. When the flashing stops, the detection distance is set.

5. Replace ENCLOSURE COVERS (2). Tighten cover screws firmly.

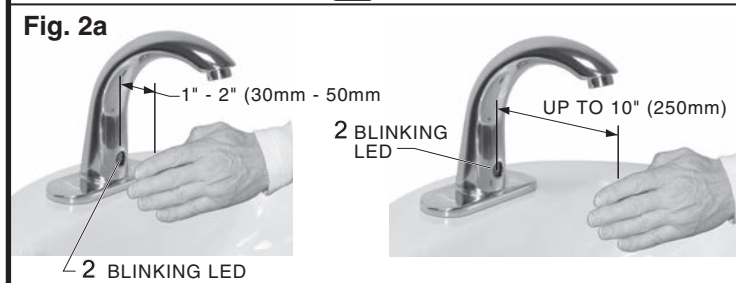
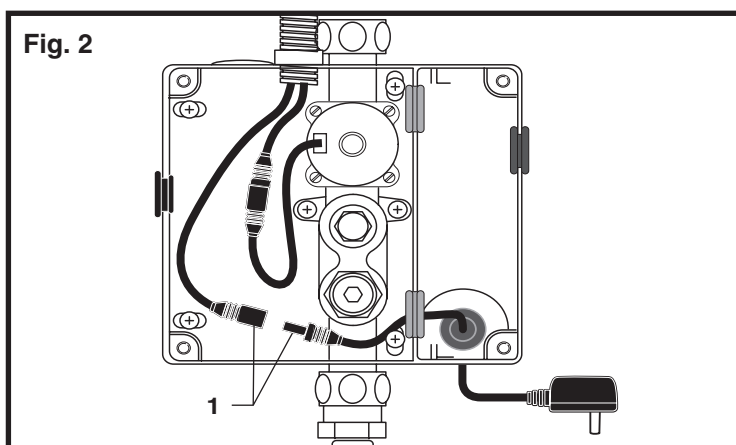

## 3 HOW TO INSTALL AND CHANGE BATTERY; Fig. 3

1. Remove COVER from ENCLOSURE (1). **Fig. 3.**

2. Remove old BATTERY (2). Install new BATTERY (3) making sure the terminal side is inserted first and shape of the battery follows the shape of the BATTERY HOLDER (4). **Fig. 3.**

3. Replace ENCLOSURE COVER. Tighten cover screws firmly. **Fig. 3.**

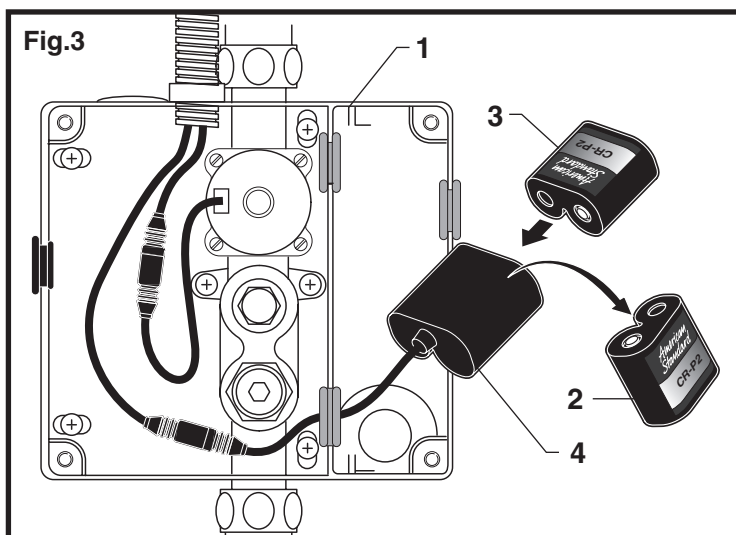



## 4 HOW TO CLEAN FILTER; Fig. 4

**CAUTION** Before opening ENCLOSURE disconnect AC power supply.

1. Remove ENCLOSURE COVER.
2. Close SUPPLY STOP (1) with 4mm Hex wrench.  
Note: Keep water flowing out of faucet while shutting off.
3. Unthread STRAINER (2) using a 7/16" socket.
4. Pull out the STRAINER (2) and clean with an old toothbrush. Rinse thoroughly with water.
5. Install the STRAINER (2) back in its place and tighten with a 7/16" socket.  
**Caution: do not over tighten strainer.**  
**Note: It is recommended to clean strainer every 6 months.**
6. Open SUPPLY STOP (1) with 4mm Hex wrench.
7. Replace ENCLOSURE COVER. Tighten cover screws firmly.

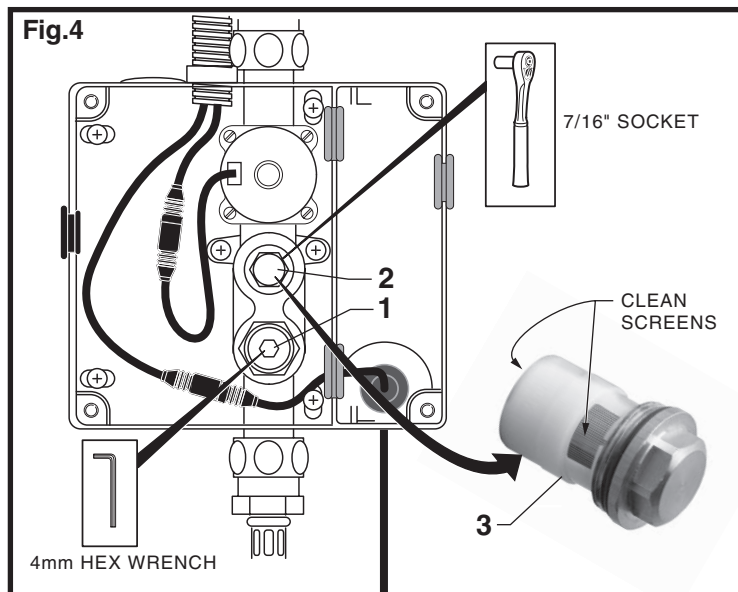

## 5 HOW TO CLEAN AND REMOVE THE AERATOR; Fig. 5

1. Remove AERATOR HOUSING (1) with KEY supplied with faucet.
3. Remove AERATOR (2) from HOUSING (1).
2. Clean the AERATOR SCREENS (3) with a old tooth brush to remove dirt.
4. Rinse Clean with water. Reassemble and install into spout end. Be sure black seal washer is in place.

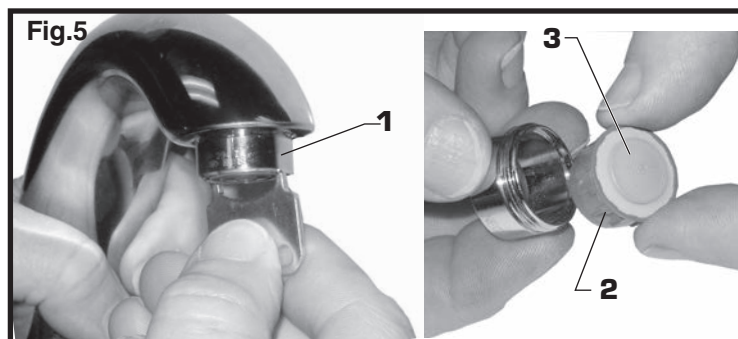

## 6 HOW TO CONVERT RIGID GOOSE NECK SPOUT TO SWING SPOUT Fig. 6

The GN SPOUT is shipped from the factory as a rigid assembly. To convert the GN SPOUT into a SWING SPOUT proceed as follows:

1. Remove SET SCREW (1) from back of GN SPOUT (2) with a flat blade screwdriver. Fig. 6.
2. Install SWIVEL SET SCREW (3) into opening in the GN SPOUT (2). SWIVEL SET SCREW (3) is found in hardware bag within product box.

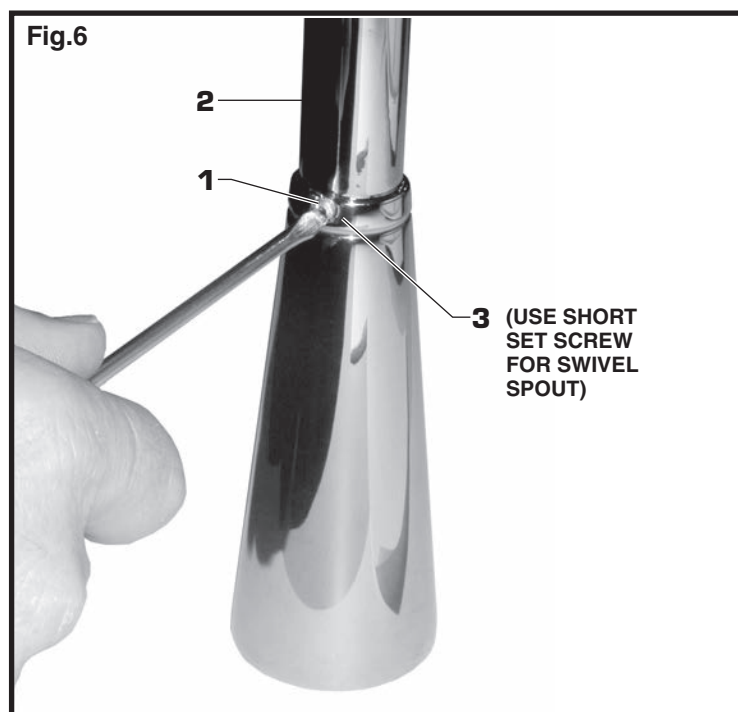

## 7 GENERAL CLEANING; Fig. 7

1. For general cleaning use a damp, soft cloth to clean the spout and the sensor.
2. For cleaning dirt use a soft cloth with diluted dish washing detergent. Wipe the area using a wet cloth and dry using a soft cloth.

### CAUTION

**Do not scratch the sensor when cleaning.**

**Avoid using anything that may scratch the spout surface.** Never use polishing power, detergent or a nylon scrub brush. They will damage the surface of the spout or Sensor.

Fig.7



## FAQ'S

**Q:** How will I know if battery needs to be replaced?

**A:** Valve does not open and sensor blinks 2 times interrupted by pause for up to 7 days.

**Q:** Why has the flow rate of the faucet reduced significantly?

**A:** Check and clean aerator and strainer.

**Q:** There is no flow out of faucet when I'm in the sensor range?

**A:** Check sensor. If sensor blinks 2 times interrupted by pause, replace battery, or call (855) 752-9259.

**Q:** Why does the faucet operate the opposite of expected-Turns On when not in sensor range, but turns off when in sensor range?

**A:** Sensor wires to solenoid are reversed.

**Q:** What is the normal operating pressure range?

**A:** Faucet will operate with supply pressures ranging from 20-80 psi.

# TROUBLESHOOTING FLOW CHARTS

## UNIT DOES NOT FUNCTION

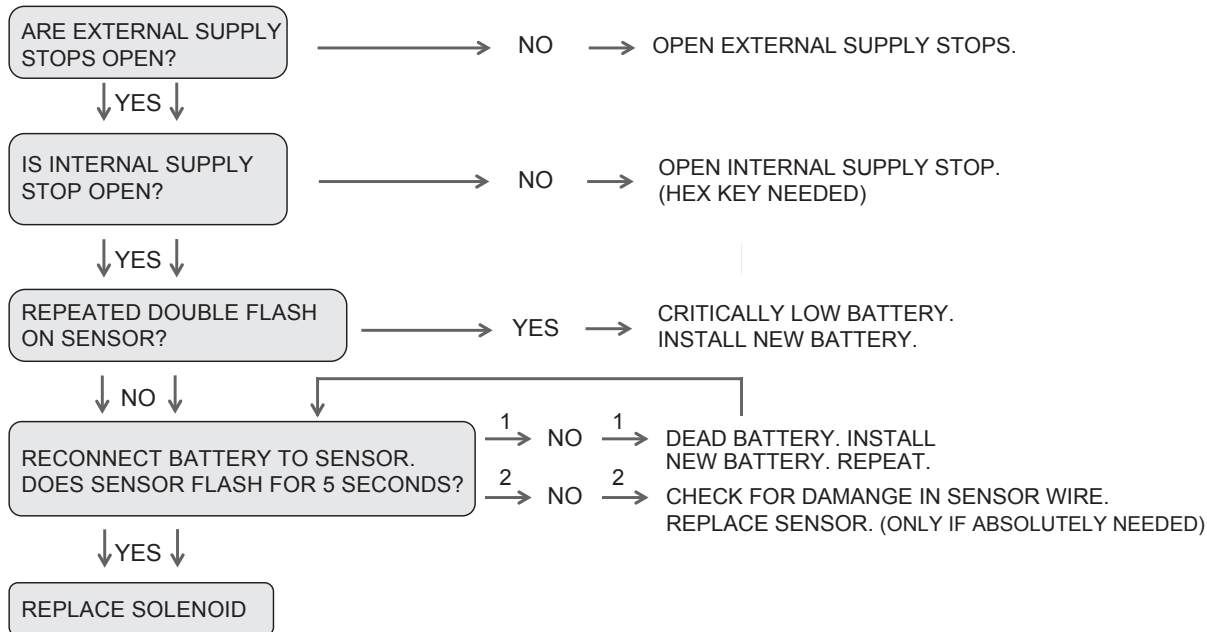

## WATER IS CONTINUOUSLY RUNNING

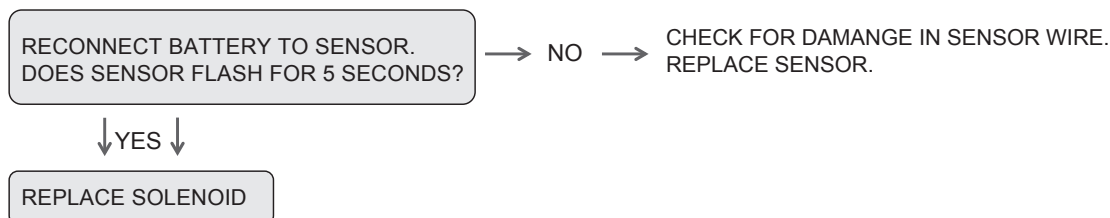

## LOW FLOW ISSUES

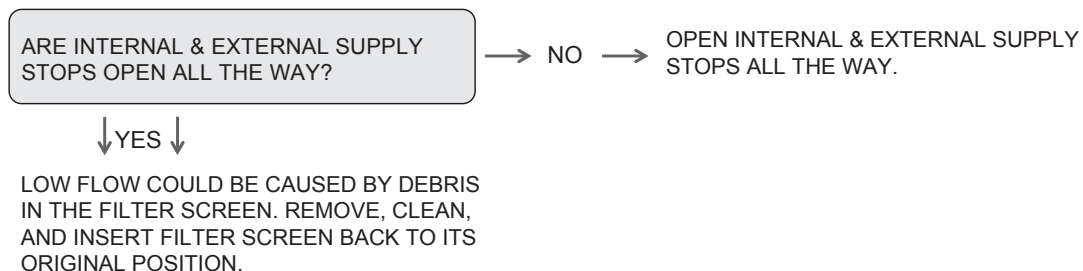

HOT LINE FOR HELP  
For toll-free information and answers to your questions, call:  
(855) 752-9259  
Weekdays 8:00 a.m. to 6:00 p.m. EST  
IN MEXICO 01-800-839-1200  
IN CANADA 1-800-387-0369 (TORONTO 1-905-306-1093)  
Weekdays 8:00 a.m. to 7:00 p.m. EST

Product names listed herein are trademarks of AS America, Inc.

After February 2014

### PRODUCT NUMBERS

#### Cast Spout

6055.104	6056.104	6057.105
6055.105	6056.105	6057.102
6055.102	6056.102	

#### 6" GN Spout

6055.164	6056.164	6057.165
6055.165	6056.165	6057.163
6055.163	6056.163	

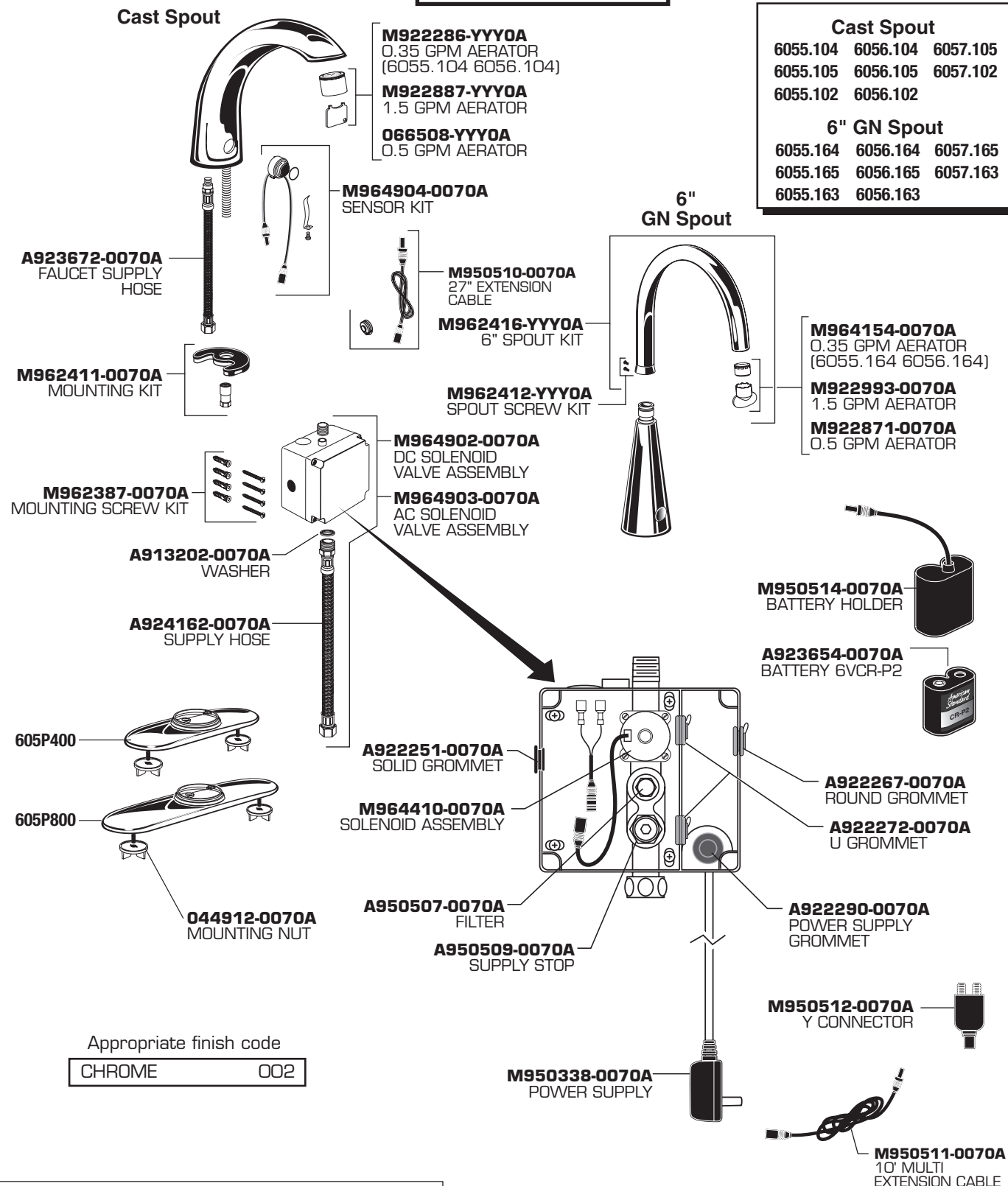

Appropriate finish code

CHROME 002



HOT LINE FOR HELP  
For toll-free information and answers to your questions, call:  
(855) 752-9259  
Weekdays 8:00 a.m. to 8:00 p.m. EST

IN CANADA 1-800-387-0369 (TORONTO 1-905-306-1093)  
Weekdays 8:00 a.m. to 7:00 p.m. EST

Product names listed herein are trademarks of American Standard Inc.  
© American Standard Inc. 2005