

SUBMITTAL DATA SHEET

No-Lead Low Pressure Valves Swing Check Valve - 72050T

FNPT X FNPT



A.Y. McDonald Mfg. Co. No-Lead Low Pressure Valves are constructed from heavy duty no-lead bronze and are recommended for residential and commercial applications and positive shut-off with various inlet configurations.

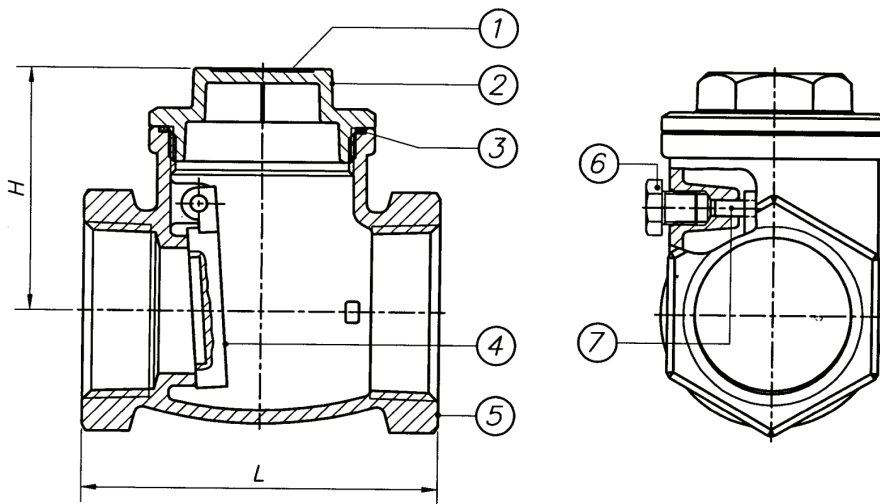

Dimensions

Size	H	L
1/2"	1.42	2.09
3/4"	1.56	2.36
1"	1.77	2.62
1 1/4"	2.07	3.19
1 1/2"	2.17	3.54
2"	2.74	4.21
2 1/2"	3.09	5.14
3"	3.80	5.77
4"	4.25	6.84

Materials

No.	Part	Material
1	Cover	No-Lead Brass
2	Body	No-Lead Brass
3	Disc	No-Lead Brass
4	Pin	No-Lead Brass
5	Screw	No-Lead Brass

SUBMITTAL INFORMATION

- 200 WOG (15 Working Back Pressure)
- Sizes: 1/2", 3/4", 1", 1 1/4", 1 1/2", 2", 2 1/2", 3", & 4"
- Threads conform to ANSI B1.20.1
- Solder ends conform to ANSI B16.18
- Metal to metal seat
- Directional

NO-LEAD: The weighted average of the wetted surface of this no-lead product contacted by consumable water contains less than one quarter of one percent (0.25%) lead.



A.Y. McDonald Mfg. Co.
P.O. Box 508
Dubuque, IA 52004-0508

Toll Free: 1-800-292-2737
Fax: 1-800-832-9296
Hours: 7:00 a.m. - 5:00 p.m., CST

sales@aymcdonald.com
www.aymcdonald.com

A.Y. McDonald considers the information on this assembly drawing correct when published. Item and option availability, including specifications, are subject to change without notice.

Submitted by: