

ROUGHING IN DIMENSIONS MAY VARY AND ARE SUBJECT TO CHANGE. NO RESPONSIBILITY IS ASSUMED FOR USE OF SUPERCEDED OR VOIDED DATA.

**CHICAGO
FAUCETS®**

Last As Long As The Building

2100 SOUTH CLEARWATER DRIVE
DES PLAINES, ILLINOIS 60018-5999

FITTING NO.

802-VE2805-335

SUBMITTED MODEL NO.

JOB NAME

ITEM NO.

SUBMITTED AS SHOWN

SUBMITTED AS NOTED

SEE ATTACHED FOR
SUBMITTED MODIFICATION

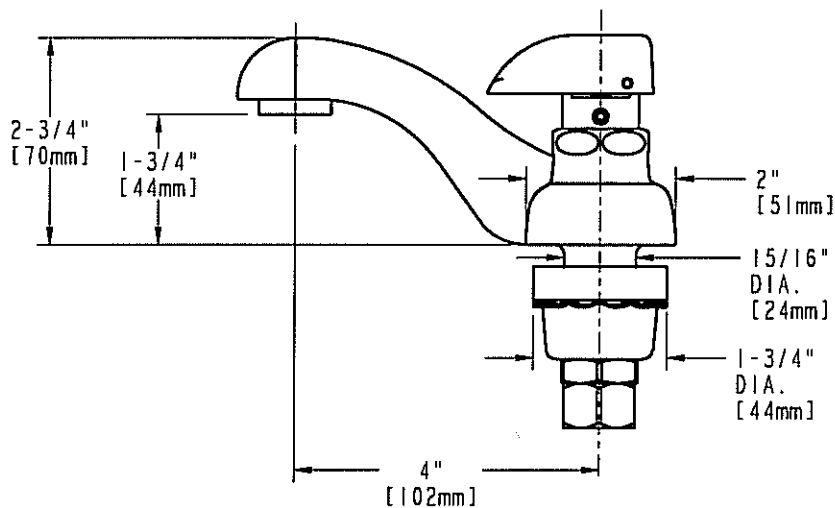
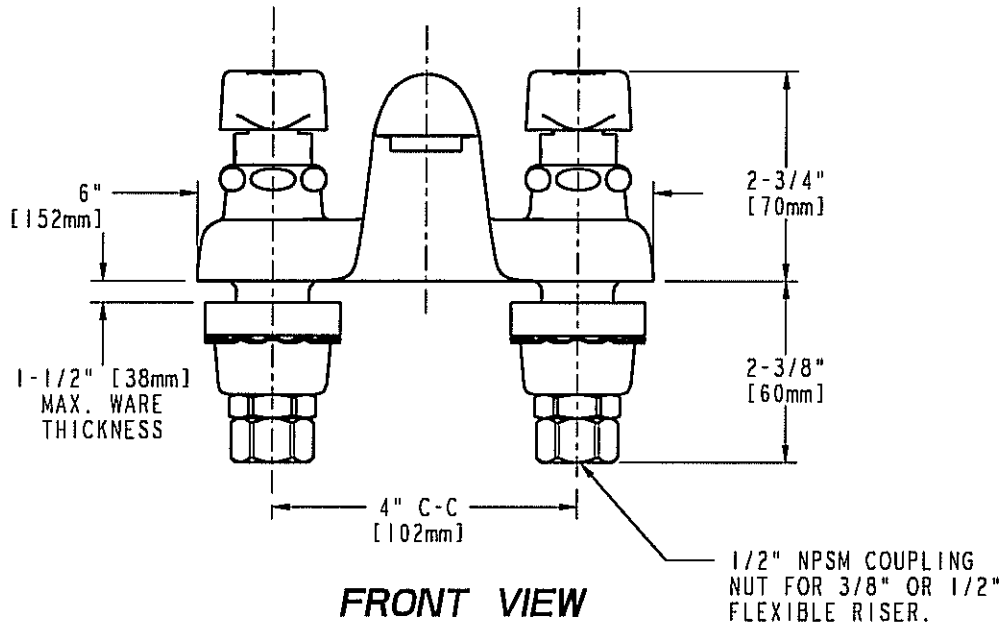

DIMENSIONS IN INCHES AND [MILLIMETERS].

TECHNICAL DATA

- DECK MOUNTED LAVATORY FAUCET
- 4" INTEGRAL SPOUT
- 335 TIP-TAP PUSH-TILT HANDLES
- NAIAD SELF-CLOSING CARTRIDGES
- FINISH: CHROME PLATE

- E2805 VANDAL PROOF ECONO-FLO SPRAY OUTLET
- 0.5 GPM [1.9 L/min.] MAXIMUM FLOW RATE
- ASME A112.18.1M
- CSA B125
- NSF 61, SECTION 9

DATE: 01-15-03

BY: JAR

CHK'D: *SD*

APP'D:

REV: B

802-VE2805-335