

Formerly IIT5 Series

T13H163 TRIM



- **Scald Guard** Cartridge Requires less Maintenance.



- Long Life, Low Maintenance, with Machined Brass Parts.

- **Blue/Red Visual valve cover indicator** for **Cold, Hot/Cold mixing** and **Hot outlet water** handle positions.

- Safer Operation as Lever Handle **ALWAYS OPENS** with **"COLD"** water first.



- Low TURNING FORCE Vandal Resistant Metal Lever Handle for Easier Operation. ADA compliant.
- Maximum Temperature Control PRE-SETTING Stop is located under the Handle. Meets ASSE 1016 High Temperature Rotational Limit Stop Requirement.

- Delta Monitor® shower/bath valves are **ENGINEERED** to provide user **PROTECTION** through the following built-in **SAFEGUARDS:**

- Monitor PRESSURE BALANCE Control.
- Lever Handle ALWAYS OPENS Cold Water Flow First.
- Limit Stop for PRE-SETTING Maximum Temperature.
- INTEGRAL CHECKS in the Cartridge Prevent Crossflow between Hot and Cold Water Inlets.
- Wider COMFORT Zone.



- **ADA Compliant handle** meets Handicapped Accessibility Standard ASME A117.1 of less than 5 LBS. Operating Force.

Refer to www.specselect.com for individual models.

R10000-UNWS
ROUGH-IN
(INTEGRAL STOPS SUPPLIED STANDARD – NOT SHOWN)

- **Mounting Bracket** – Provides a sturdy method to secure the valve to a stringer and prevents rocking.

- **Square Plasterguard** – Standard tile size allows for simple 90° cuts.

- **Heavy Duty Forged Brass** one piece valve body.

- **Heat-Resistant Pressure Test Cap** – Allows for water testing up to 300 psi before the valve cartridge is installed. Easy access for flushing out the system.

- **Chrome Plated Bonnet Nut** – Allows for easy removal during maintenance, even after years of use.

- **1/2" Universel Inlets** to accept 1/2" copper, 1/2" iron pipe, PEX or CPVC adaptors.

- **1/2" Universel Outlets**, inlets/outlets have male threads.

- **Integral Stops (supplied standard with R10000-UNWS and R10700-UNWS Rough-Ins – NOT SHOWN)** for service and maintenance at any individual tub and shower valve allowing continued normal use of other valves in the same room or area.

- **Increased Flow** allows faster filling of tubs.

- **R10700-UNWS** – Rough-In for Pressure Balancing Valve with separate In-Wall Diverter Valve.

MultiChoice™ Universal Pressure Balance Tub and Shower

TECK®

DELTA
COMMERCIAL

Specification: (example)

- ☐ **R10000-UNWS** ROUGH-IN only
 - Concealed in-wall MultiChoice™ universal valve
 - Back-to-back capability, Integral screwdriver stops
 - **Heavy Duty forged brass** valve body
 - 1/2" Universal inlets to accept 1/2" copper, 1/2" iron pipe, PEX or CPVC adaptors
 - 1/2" Male thread inlets/outlets
- ☐ **FINISH TRIM ONLY:**
 - Pressure Balancing cartridge with checks
 - Polished chrome plated finish
 - 57mm (2.24") ADA Compliant valve handle and ... with ... (add product variation) with ... (add shower)



T13H153



T13H163



Engineer/Architect Approval

Model Specified:

Approval:

Date:

TUB AND SHOWER DESCRIPTION	PRODUCT NO.
ROUGH-IN Valve	R10000-UNWS
FINISH TRIM only	T13H

Formerly IIT5 Series



PRODUCT VARIATION	SHOWER	HANDLE
0 <input type="checkbox"/>	0 Specify "0" When No Shower Outlet Required <input type="checkbox"/>	0 <input type="checkbox"/>
1 Shower Valve Only <input type="checkbox"/>	1 Standard Brass Fixed Spray Showerhead Arm & Flange 2.2 USGPM (8.4 L/min.) <input type="checkbox"/>	1 <input type="checkbox"/>
2 Tub and Shower <input type="checkbox"/>	2 Dual Spray Touch-Clean Showerhead, Arm & Flange 2.5 USGPM (9.5 L/min.) <input type="checkbox"/>	2 <input type="checkbox"/>
3 <input type="checkbox"/>	3 Push-Clean Showerhead Arm & Flange 2.5 USGPM (9.5 L/min.) <input type="checkbox"/>	3 57mm (2.24") Lever Blade Handle <input type="checkbox"/>
4 <input type="checkbox"/>	4 <input type="checkbox"/>	4 <input type="checkbox"/>
5 <input type="checkbox"/>	5 Handshower, VB (ASSE) 610mm (24") Combination S/S Slide Grab Bar 2.5 USGPM (9.5 L/min.) <input type="checkbox"/>	5 <input type="checkbox"/>
6 <input type="checkbox"/>	6 30° Vandal Resistant Cast Wallmount Showerhead 2.0 USGPM (7.6 L/min.) <input type="checkbox"/>	6 <input type="checkbox"/>
7 <input type="checkbox"/>	7 Handshower, VB (ASSE) Wall Elbow, 2 Wall Hooks 2.5 USGPM (9.5 L/min.) <input type="checkbox"/>	7 <input type="checkbox"/>
8 <input type="checkbox"/>	8 H2Okinetic Technology™ Showerhead, Arm & Flange, 1.6 USGPM (6.0 L/min.) <input type="checkbox"/>	8 <input type="checkbox"/>
9 <input type="checkbox"/>	9 Adjustable, Metal Showerhead, Arm & Flange, 2.5 USGPM (9.5 L/min.) <input type="checkbox"/>	9 <input type="checkbox"/>

SET SCREW SHOWER ARM FLANGE SUPPLIED ON SHOWER OPTION NO. 1, 2, 3, 8, AND 9.

Refer to www.specselect.com for individual models.

See Page 2.C.7 for additional Rough-In options.

FLOWRATES ARE AT 80 PSI.

See Page 2.C.4 for Add-On options available.

Note: Use this page front and back as a product submittal sheet.

Delta reserves the right (1) to make changes in specifications and materials, and (2) to change or discontinue models, both without notice or obligation. Dimensions are for reference only. See current full-line price book or www.specselect.com for finish options and product availability.

Approvals:

- CSA certified
- Complies to ASME A112.18.1
- Pressure Balance Handle ADA Compliant and meet Handicapped Accessibility  Standard ASME A117.1 of less than 5 lbs. operating force.
- ASSE 1016
- Handshower Vacuum Breaker Certified under ANSI A1121.3 (ASSE 1011)
- IAPMO listed

(Contact Delta Representative for State and/or Local Approvals.)

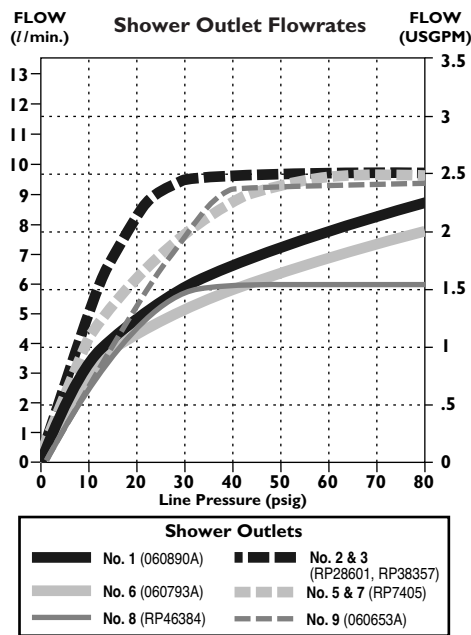
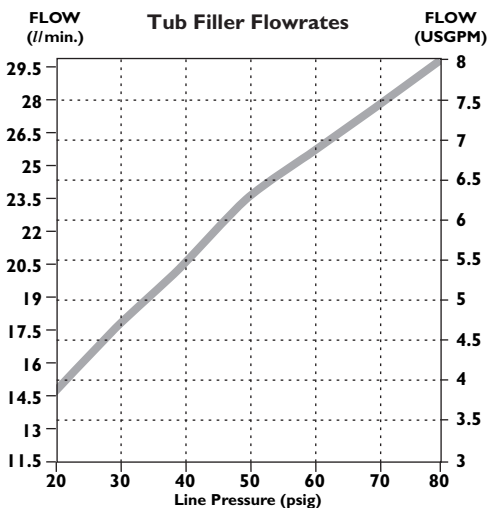
FLOWRATE vs PRESSURE

FLOWRATE vs PRESSURE

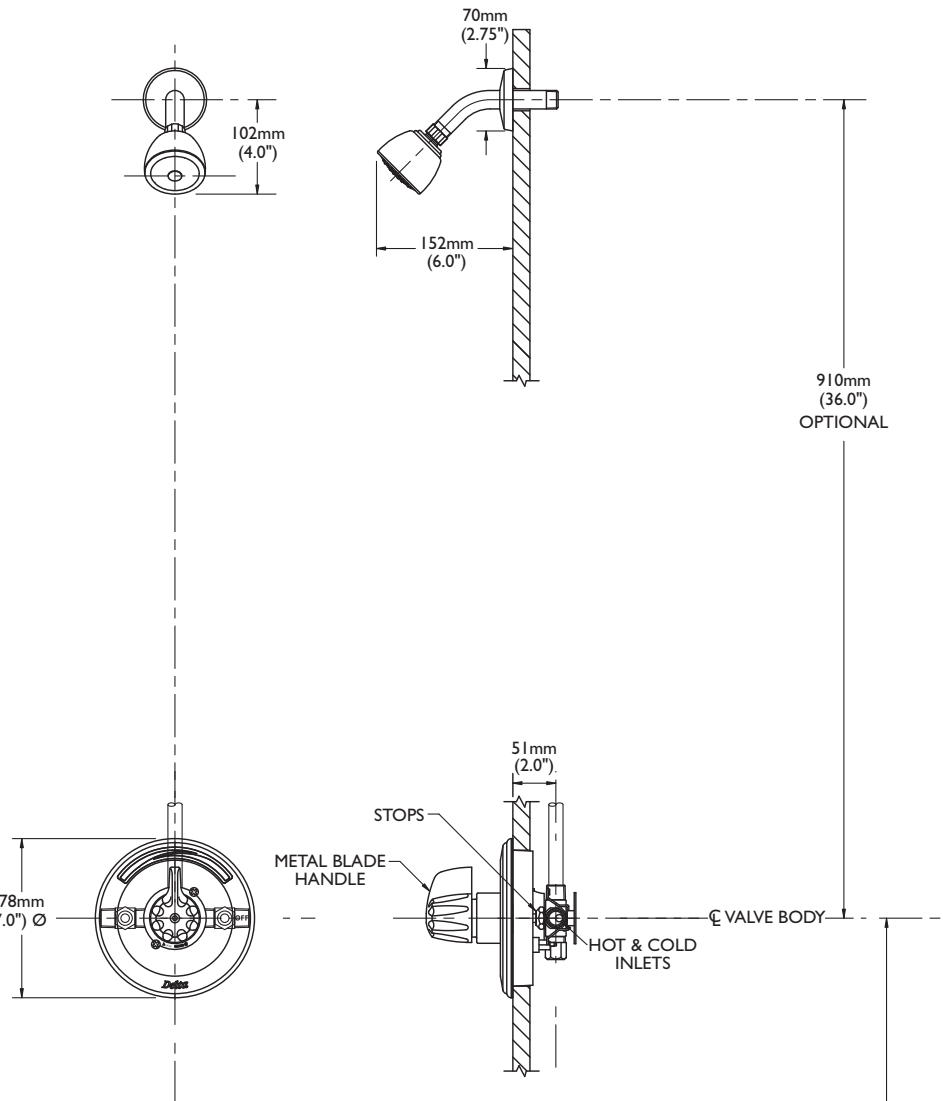
Refer to www.specselect.com for individual models.



FRONT VIEW

SIDE VIEW

**R10000-UNWS Rough-In
with
T13H133 Trim**

P/B VALVE INLETS:

1/2" Universal inlets accept 1/2" copper,
1/2" iron pipe, PEX or CPVC adaptors
1/2" Male thread inlets/outlets

Note: Measurements may vary $\pm 6\text{mm}$ (0.25")

Note: Use this page front and back as a product submittal sheet.

MultiChoice™ Universal Pressure Balance Tub and Shower with Diverter Valve for Dual Showers

TECK®



Specification: (example)

- ☐ **R10700-UNWS ROUGH-IN only**
 - Concealed in-wall MultiChoice™ universal valve
 - **Heavy Duty forged brass** valve body, Integral screwdriver stops
 - 1/2" Universal inlets to accept 1/2" copper, 1/2" iron pipe, PEX or CPVC adaptors
 - 1/2" Male thread inlets/outlets, Back-to-back capability
 - In-wall diverter valve
- ☐ **FINISH TRIM ONLY:**
 - Pressure Balancing cartridge with checks
 - Polished chrome plated finish
 - 57mm (2.24") ADA Compliant valve handle
 - 68mm (2.68") ADA Compliant diverter handle
 - and ... with ... (add product variation)
 - with ... (add shower)



T13H923

Engineer/Architect Approval

Model Specified:

Approval:

Date:

TUB AND SHOWER DESCRIPTION	PRODUCT NO.
ROUGH-IN with Diverter Valve & Stops	R10700-UNWS
FINISH TRIM only	T13H

Formerly IIT5 Series



PRODUCT VARIATION	SHOWER	HANDLE
0 <input type="checkbox"/>	Specify "0" When No Shower Outlet Required <input type="checkbox"/>	0 <input type="checkbox"/>
1 <input type="checkbox"/>	Standard Brass Fixed Spray Showerhead Arm & Flange 2.2 USGPM (8.4 L/min.) <input type="checkbox"/>	1 <input type="checkbox"/>
2 <input type="checkbox"/>	Dual Spray Touch-Clean Showerhead, Arm & Flange 2.5 USGPM (9.5 L/min.) <input type="checkbox"/>	2 <input type="checkbox"/>
3 Shower, Handshower, ASSE VB, Diverter Valve, 610mm (24") Combination S/S Slide/Grab Bar (1) <input type="checkbox"/>	3 Push-Clean Showerhead Arm & Flange 2.5 USGPM (9.5 L/min.) <input type="checkbox"/>	3 57mm (2.24") Lever Blade Handle <input checked="" type="checkbox"/>
4 <input type="checkbox"/>	4 <input type="checkbox"/>	4 <input type="checkbox"/>
5 Shower, Handshower, Diverter Valve, VB, Wall Elbow, 2 Wall Hooks (1) <input type="checkbox"/>	5 <input type="checkbox"/>	5 <input type="checkbox"/>
6 Tub & Shower (Same as No. 5 above) but with Diverter Spout (1) <input type="checkbox"/>	6 30° Vandal Resistant Cast Wallmount Showerhead 2.0 USGPM (7.6 L/min.) <input type="checkbox"/>	6 <input type="checkbox"/>
7 <input type="checkbox"/>	7 <input type="checkbox"/>	7 <input type="checkbox"/>
8 <input type="checkbox"/>	8 H ₂ Okinetic Technology™ Showerhead, Arm & Flange, 1.6 USGPM (6.0 L/min.) <input type="checkbox"/>	8 <input type="checkbox"/>
9 Tub & Shower (Same as No. 3 above) but with Diverter Spout (1) <input type="checkbox"/>	9 Adjustable, Metal Showerhead, Arm & Flange, 2.5 USGPM (9.5 L/min.) <input type="checkbox"/>	9 <input type="checkbox"/>

(1) Product Variations 3 and 5 to 9 require selection of the second showerhead from Shower Option No. 1, 2, 3, 8, and 9.

Set screw shower arm flange supplied on Shower Option No. 1, 2, 3, 8, and 9.

Refer to www.specselect.com for individual models.

See Page 2.C.7 for additional Rough-In options.

Note: Use this page front and back as a product submittal sheet.

Delta reserves the right (1) to make changes in specifications and materials, and (2) to change or discontinue models, both without notice or obligation. Dimensions are for reference only. See current full-line price book or www.specselect.com for finish options and product availability.

Flowrates are at 80 PSI.

See Page 2.C.4 for Add-On options available.



Tub and Shower Add-On Options

TECK®



DESCRIPTION	ADD-ON NUMBER		
P/B Valve Add-On Options	—		

HOSE, ETC.

0	USE "0" For No Selection	<input checked="" type="checkbox"/>
1	Quick Disconnect For Hose (2)	<input type="checkbox"/>
2	1753mm (69") Long CP Brass Double Spiral Hose (2)	<input type="checkbox"/>
3	Same as No. 2 Above but with Quick Disconnect (2)	<input type="checkbox"/>
4		<input type="checkbox"/>

MISCELLANEOUS

0	USE "0" For No Selection	<input type="checkbox"/>
1		<input type="checkbox"/>
2		<input type="checkbox"/>
3	Adjustable Volume Control (attaches to showerarm)	<input type="checkbox"/>
4		<input type="checkbox"/>
5	914mm (36") Combination S/S Slide/Grab Bar (3)	<input type="checkbox"/>



Notes:

- (1) A Number from each option column must be used for a **complete Product Add-On**
- (2) **Base Product** for the **HOSE, ETC.** options must be from **PRODUCT VARIATION TRIM No.'s 3, 5, 6 or 9** or must include **SHOWER** option **No. 5 or 7**
- (3) **Base Product** for combination S/S Slide/Grab Bar must be from **PRODUCT VARIATION TRIM No.'s 3 or 9**, or must include **SHOWER** option **No. 5**

HOW TO SELECT AND SPECIFY ADD-ON OPTIONS:

Example No. 1: Base Product selected is R10700-UNWS Rough-in, and a T13H323 with 36" Combination S/S Slide/Grab Bar.
36" Combination S/S Slide/Grab Bar Add-On Suffix Number is -05
Product Number to Specify: R10700-UNWS Rough-in and T13H323-05 Trim

060733A

610mm (24") sliding handshower bar, vertical mounting pin, polished chrome plated finish, vandal resistant concealed mounting. (**NOTE:** Sliding bar **NOT** to be used as a grab bar.)

060262A

As above but 1219mm (48") long

060304A 

610mm (24") combination stainless steel slide/grab bar, 1778 mm (70") white vinyl hose, push button handshower head, ASSE vacuum breaker, wall supply elbow & flange.

060306A 

As above but with 914 mm (36") stainless steel slide/grab bar.

060827A

Brass swivel handshower connector, polished chrome plated finish, with hole for vertical mounting pin, 1/2" NPS inlet/outlet).

RP7406

As above but plastic and chrome plated brass.

060828A

Brass showerarm mount with pin, polished chrome plated finish.

RP12504

Brass wallmounted bracket, vertical mounting pin, polished chrome plated finish.

060303A

Brass wallmounted elbow, flange, polished chrome plated finish, 1/2" NPT inlet & outlet.

060798A

1/2" NPT inlet/outlet polished chrome plated brass atmospheric in-line vacuum breaker. Certified under ANSI A1121.3 (ASSE 1011).

RP32550

Brass showerarm mounted diverter tee, polished chrome plated finish.

RP7405

Handshower head with stop button and 2.5 USGPM (9.5 L/min.) flow control. (See Shower No. 5 & 7 - Page 2.C.2 See Product Variation No. 3, 5, 6 & 9 - Page 2.C.3)

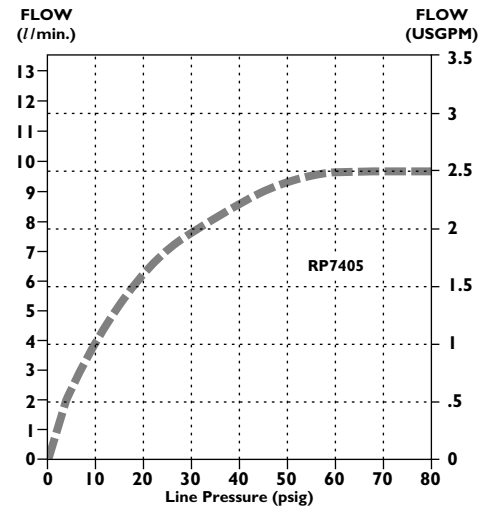
FLOWRATE vs PRESSURE

060312A

1778mm (70") long white vinyl handshower hose, nylon reinforced.

060731A

1753mm (69") long chrome plated brass double spiral handshower hose.

060252A

Quick disconnect connectors for handshower hose.

Note: Measurements may vary ± 6 mm (0.25")

❑ 060852A

Brass body diverter valve, ADA compliant lever handle, polished chrome plated metal trim.
(See Product Variations No.'s 3, 5, 6 & 9 – Page 2.C.3)



Specification: (example)

76 mm (3") Diameter wall thermometer, 18 to 82 degrees C (0 to 180 degrees F), stainless steel construction with shatterproof Lexan lens, complete with cast brass tee, polished chrome plated brass nipple and set screw wall flange.

❑ 060274A



Specification: (example)

In-wall, volume control stop, TUF-TECK institutional structure, polished chrome plated finish exposed metal trim, color indexed metal handle with vandal resistant screw, 1/2" FIP inlet/outlet.



❑ 54T1200

With 70mm (2-3/4") ADA compliant lever blade handle and integral stop.

❑ 060732A

Brass body volume control, polished chrome plated finish, flow adjustment lever handle, 1/2" NPS inlet/outlet.



❑ 060605A

Forged brass Toe Tester Spout, polished chrome plated finish, 1/2" FIP inlet.



❑ 060710A

Brass bent showerarm, metal set screw wall flange, polished chrome plated finish.
(Supplied with Shower No. 1, 2, 3, 8, & 9)



Specification: (example)

Cast brass institutional wallmounted shower head, polished chrome plated finish, 2.0 USGPM (7.6 L/min.) flow control fixed spray, concealed cast brass mounting plate, vandal resistant front mounting screws, universal 1/2" FIP/copper sweat inlet.

❑ 060793A

30° spray angle from wall.

(See Shower No. 6 – Page 2.C.2 and 2.C.3)

❑ 060890A

Brass body showerhead fixed 2.2 USGPM (8.4 L/min.) flow control spray, polished chrome plate finished.
(See Shower No. 1 – Page 2.C.2 and 2.C.3)

❑ RP28601

Dual Spray Touch-Clean®, chrome plated finish, brass ball showerhead, 2.5 USGPM (9.5 L/min.).
(See Shower No. 2 – Page 2.C.2 and 2.C.3)

❑ RP38357

Touch-Clean™, polished chrome plated finish, brass ball showerhead, 2.5 USGPM (9.5 L/min.).
(See Shower No. 3 – Page 2.C.2 and 2.C.3)

❑ 060653A

Adjustable, metal showerhead, 2.5 USGPM (9.5 L/min.). 3 spray modes: full, massage, and combination spray.
(See Shower No. 9 – Page 2.C.2 and 2.C.3)

❑ RP46384

H₂Okinetic Technology™ Showerhead, 1.6 USGPM (6.0 L/min.).
(See Shower No. 8 – Page 2.C.2 and 2.C.3)

060793A SHOWERHEAD

ANCHOR PLATE

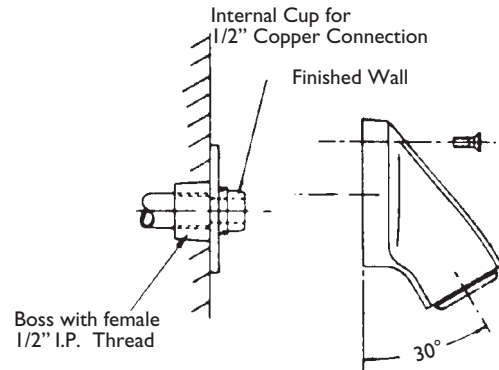
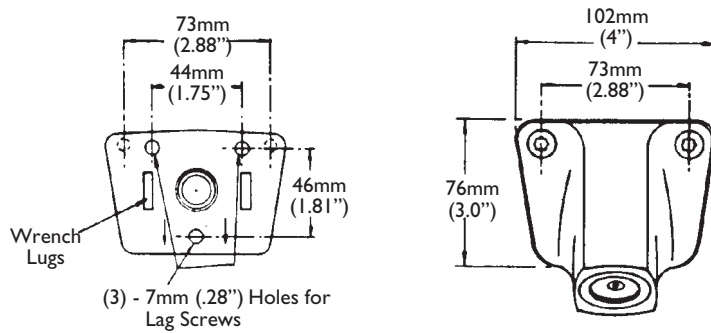

54T1200 CONTROL VALVE

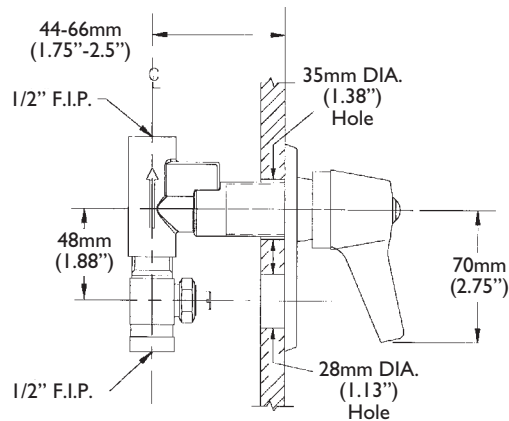

060852A DIVERTER VALVE

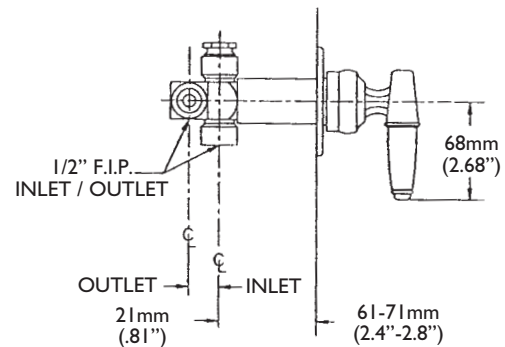

060274A WALL THERMOMETER

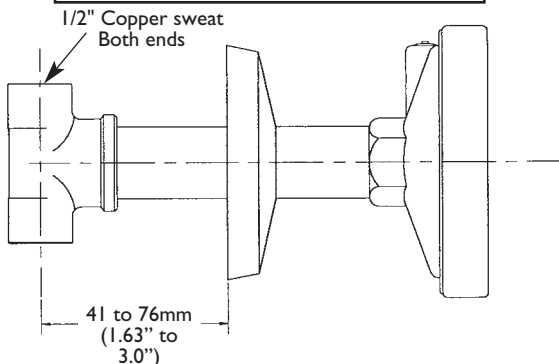

060605A TOE TESTER SPOUT

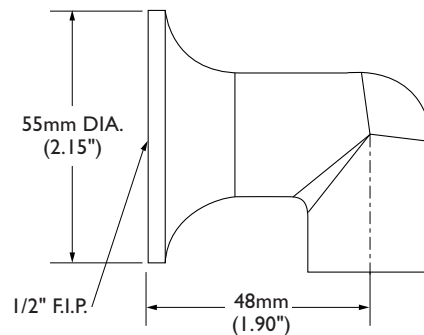

Note: Measurements may vary $\pm 6\text{mm}$ (0.25")

Note: Use this page front and back as a product submittal sheet.

060123A

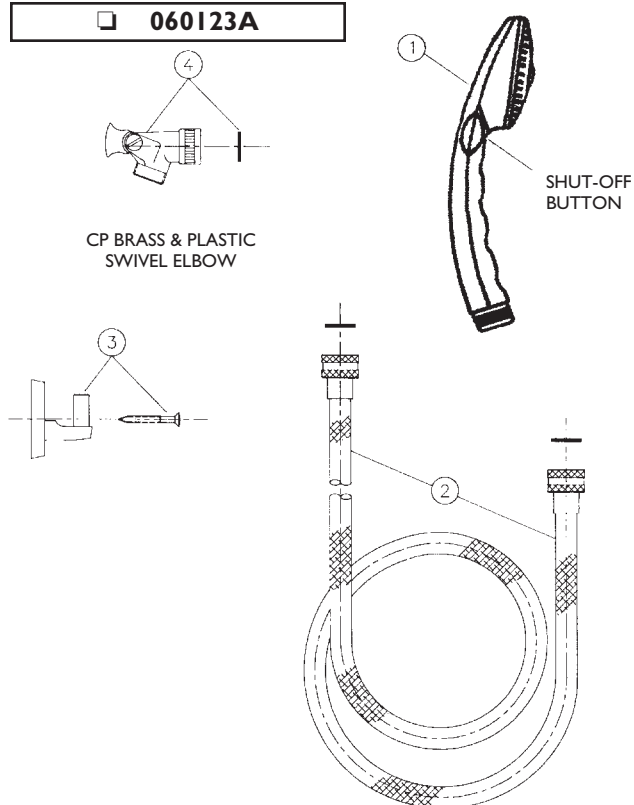

ITEM #	DESCRIPTION
1	Handshower with Shut-off Button 2.5 U.S.GPM (9.5 L/min.) Flow Control
2	1778mm (70") Long White Vinyl Handshower Hose with Nylon Reinforcement
3	CP Brass Wallmount Bracket w/Vertical Mounting Pin and Screws
4	CP Brass & Plastic Swivel Handshower Elbow for Vertical Mounting Pin

060124A

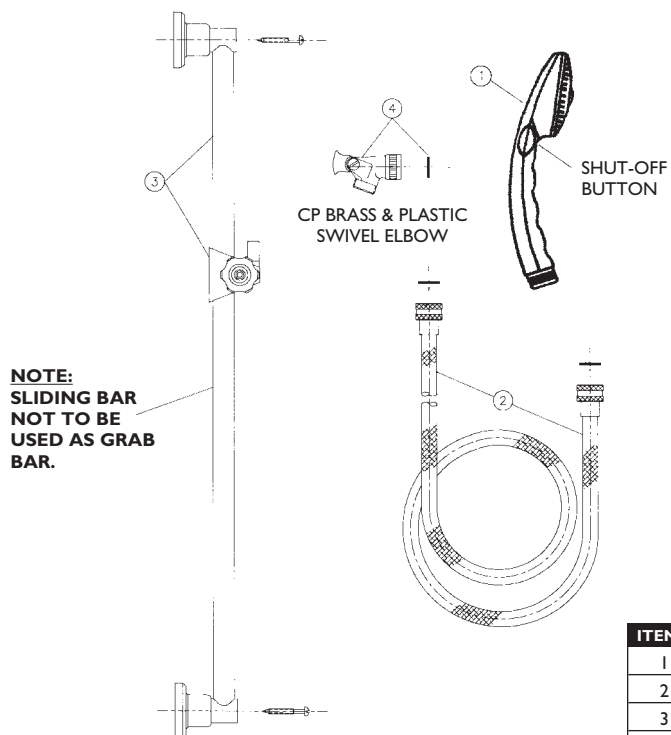

ITEM #	DESCRIPTION
1	Handshower with Shut-off Button 2.5 U.S.GPM (9.5 L/min.) Flow Control
2	1778mm (70") Long White Vinyl Handshower Hose with Nylon Reinforcement
3	610mm (24") CP Sliding Handshower Bar w/Vertical Mounting Pin and Screws
4	CP Brass & Plastic Swivel Handshower Elbow for Vertical Mounting Pin

Note: Measurements may vary $\pm 6\text{mm}$ (0.25")

060127A

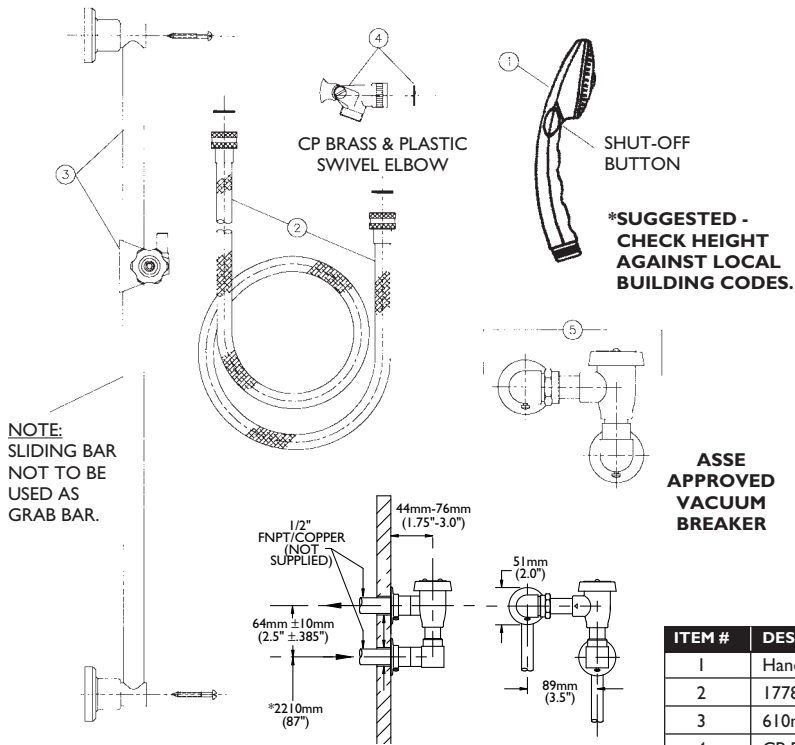

NOTE:
SLIDING BAR
NOT TO BE
USED AS
GRAB BAR.

ASSE
APPROVED
VACUUM
BREAKER

FLOWRATE vs PRESSURE

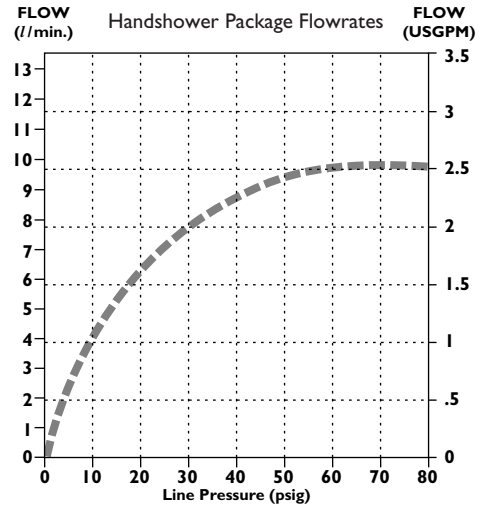

ITEM #	DESCRIPTION
1	Handshower with Shut-off Button 2.5 U.S.GPM (9.5 L/min.) Flow Control
2	1778mm (70") Long White Vinyl Handshower Hose with Nylon Reinforcement
3	610mm (24") CP Sliding Handshower Bar w/Vertical Mounting Pin and Screws
4	CP Brass & Plastic Swivel Handshower Elbow for Vertical Mounting Pin
5	Wall Mounted ASSE Approved Vacuum Breaker

060132A

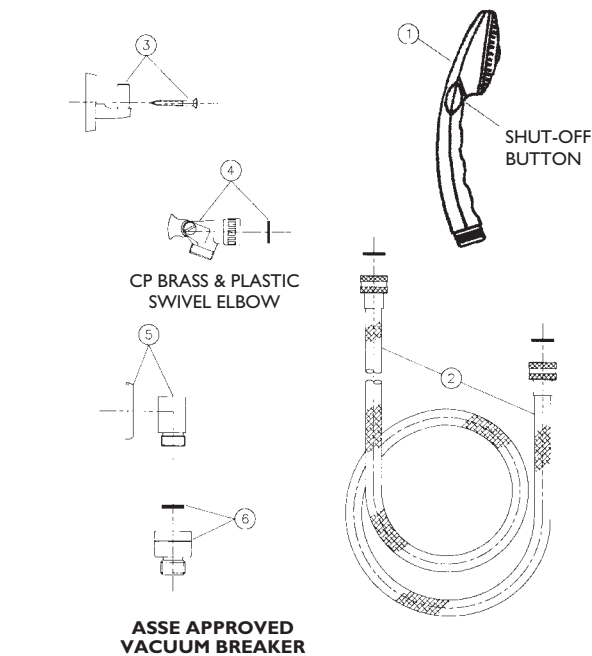

ITEM #	DESCRIPTION
1	Handshower with Shut-off Button 2.5 U.S.GPM (9.5 L/min.) Flow Control
2	1778mm (70") Long White Vinyl Handshower Hose with Nylon Reinforcement
3	CP Brass Wallmount Bracket w/Vertical Mounting Pin and Screws
4	CP Brass & Plastic Swivel Handshower Elbow for Vertical Mounting Pin
5	CP Brass Wallmount Elbow and Flange
6	CP Brass ASSE Approved Vacuum Breaker

Note: Measurements may vary $\pm 6\text{mm}$ (0.25")

Multichoice™ Universal Rough Valve Body

HDF®

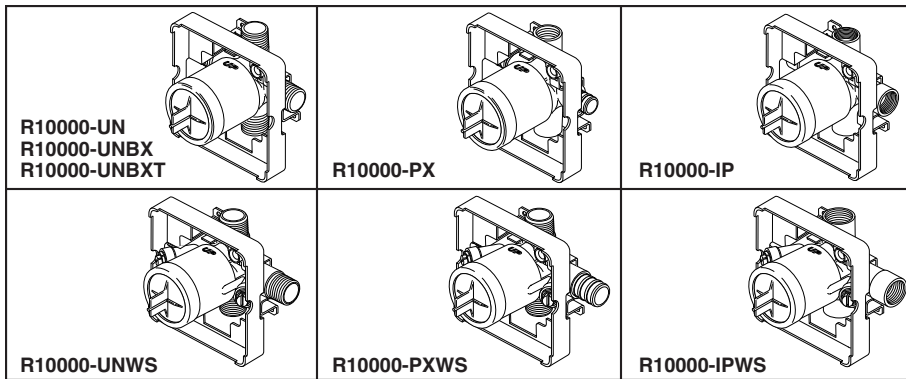

- R10000-UN (Case Qty 12)
- R10000-UNBX (Case Qty 3)
- R10000-UNBXT (Case Qty 3)
- R10000-UNWS (Case Qty 12)
- R10000-PX (Case Qty 12)
- R10000-PXWS (Case Qty 12)
- R10000-IP (Case Qty 12)
- R10000-IPWS (Case Qty 12)

STANDARD SPECIFICATIONS:

- Forged brass body.
- Back-to-Back installation capabilities.
- Can be tested with air (200 PSI) or water (300 PSI) without valve using supplied test cap.
- Square plasterguard allows for right angle cuts.
- Thin wall mounting.
- For use with Multichoice™ Universal single or dual function trim. Cartridge ships with trim.

Submitted Model No.: _____

Specific Features: _____

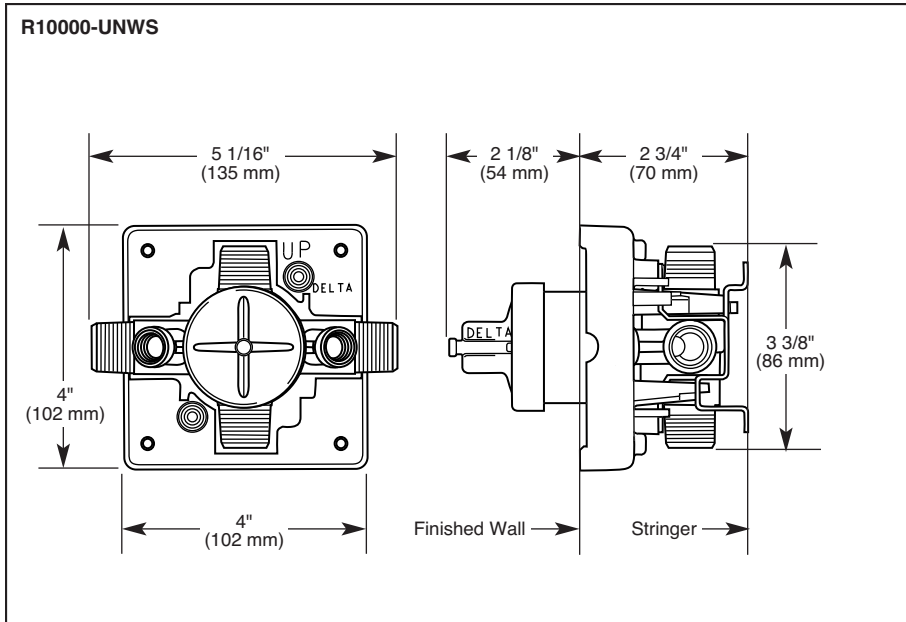
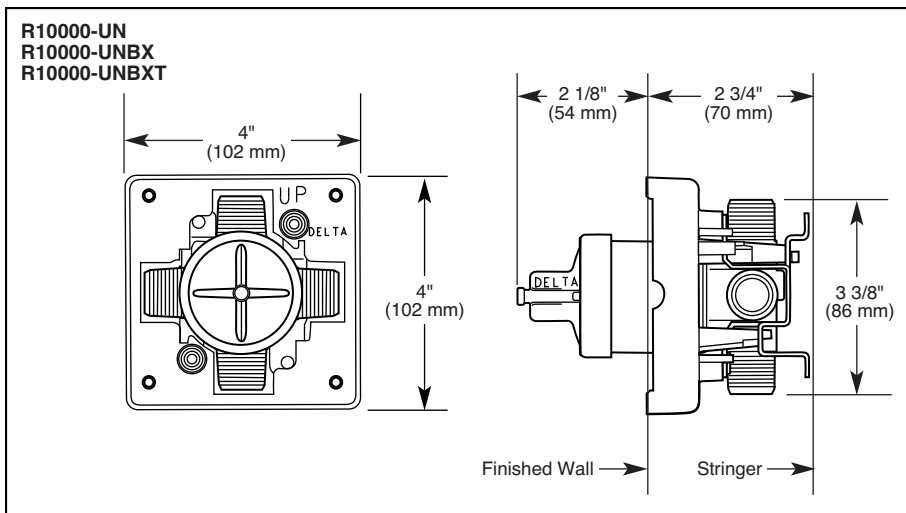

COMPLIES WITH:

- ASME A112.18.1 / CSA B125.1

Delta reserves the right (1) to make changes in specifications and materials, and (2) to change or discontinue models, both without notice or obligation. Dimensions are for reference only. See current full-line price book or www.specselect.com for finish options and product availability.

Tub and Shower Faucet Trim

HDF®

DELTA
COMMERCIAL

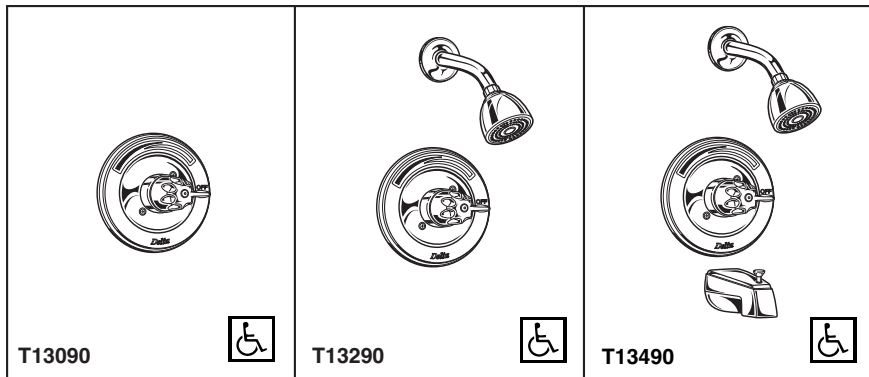

Submitted Model No.: _____

Specific Features: _____

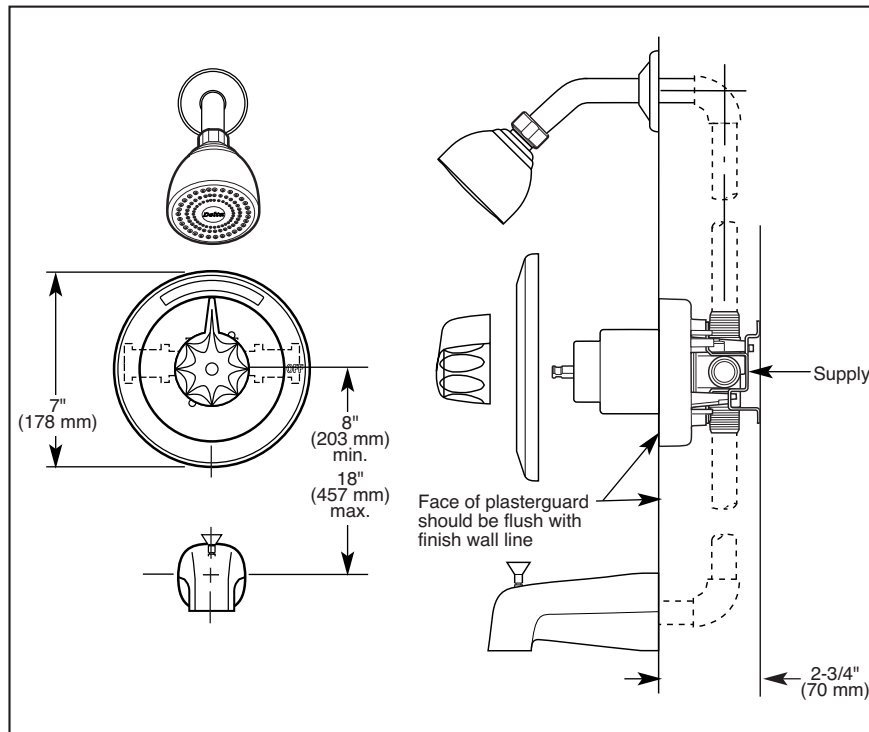

- Valve Only (T13090)
- Shower Only (T13290)
- Tub/Shower (T13490)

STANDARD SPECIFICATIONS:

- Monitor® 13 Series pressure balanced bath mixing valve with Scald-Guard®.
- Maintains a balanced pressure of hot and cold water even when a valve is turned on or off elsewhere in the system.
- For use with MultiChoice™ Universal rough valve body. (R10000 Series)
- Back-to-back installation capability.
- Temperature only controlled with vandal resistant blade handle.
- Field adjustable to limit handle rotation into hot water zone.
- 120° maximum handle rotation.
- All parts replaceable from the front of the valve.
- Push Clean™ Showerhead/1 Spray Pattern (T13290, T13490)
- Metal Tub Filler with Pull-up Diverter (T13490)



COMPLIES WITH:

- ASME A112.18.1
- CSA B125
- Indicates ADA compliance to ICC/ANSI A117.1
- ASSE 1016

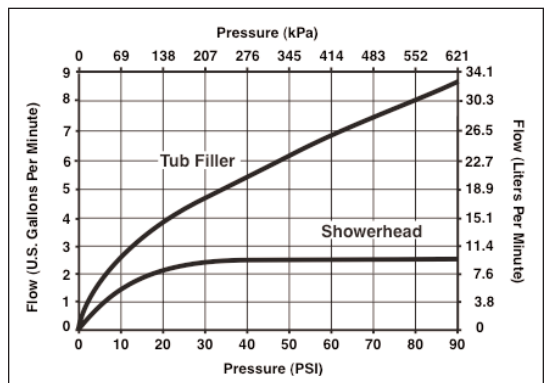

Delta reserves the right (1) to make changes in specifications and materials, and (2) to change or discontinue models, both without notice or obligation. Dimensions are for reference only. See current full-line price book or www.specselect.com for finish options and product availability.

Tub and Shower Faucet Trim

HDF®

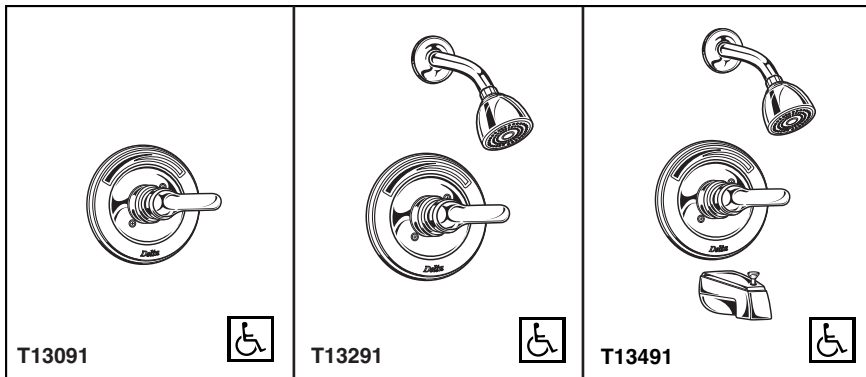

- Valve Only (T13091)
- Shower Only (T13291)
- Tub/Shower (T13491)

STANDARD SPECIFICATIONS:

- Monitor® 13 Series pressure balanced bath mixing valve with Scald-Guard®.
- Maintains a balanced pressure of hot and cold water even when a valve is turned on or off elsewhere in the system.
- For use with MultiChoice™ Universal rough valve body. (R10000 Series)
- Back-to-back installation capability.
- Temperature only controlled with metal lever handle.
- Field adjustable to limit handle rotation into hot water zone.
- 120° maximum handle rotation.
- All parts replaceable from the front of the valve.
- Push Clean™ Showerhead/1 Spray Pattern (T13291, T13491)
- Metal Tub Filler with Pull-up Diverter (T13491)

Submitted Model No.: _____

Specific Features: _____

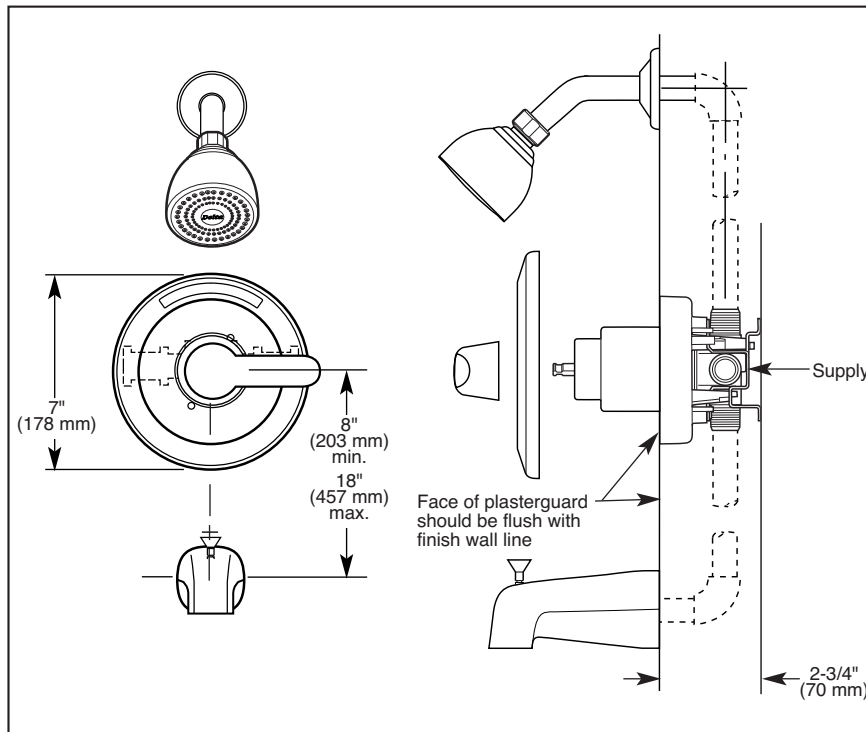

COMPLIES WITH:

- ASME A112.18.1
- CSA B125
- Indicates ADA compliance to ICC/ANSI A117.1
- ASSE 1016

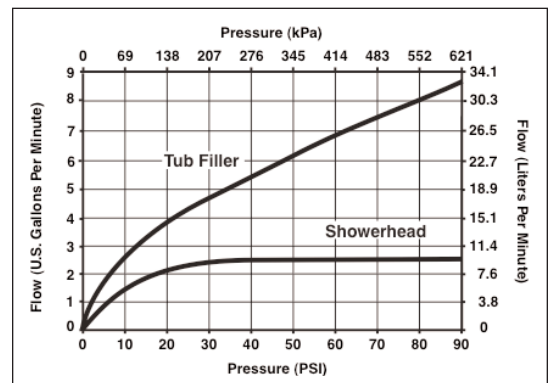

Delta reserves the right (1) to make changes in specifications and materials, and (2) to change or discontinue models, both without notice or obligation. Dimensions are for reference only. See current full-line price book or www.specselect.com for finish options and product availability.

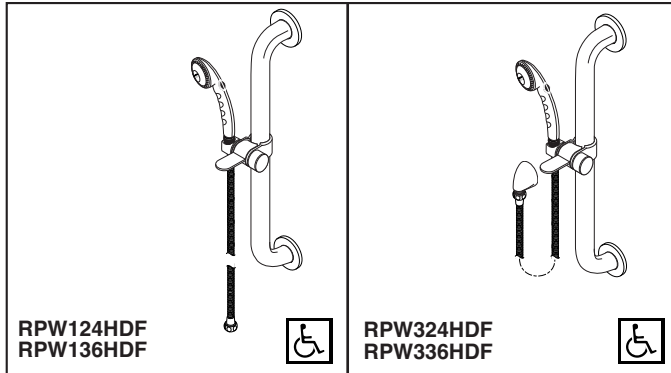

Submitted Model No.: _____

Specific Features: _____

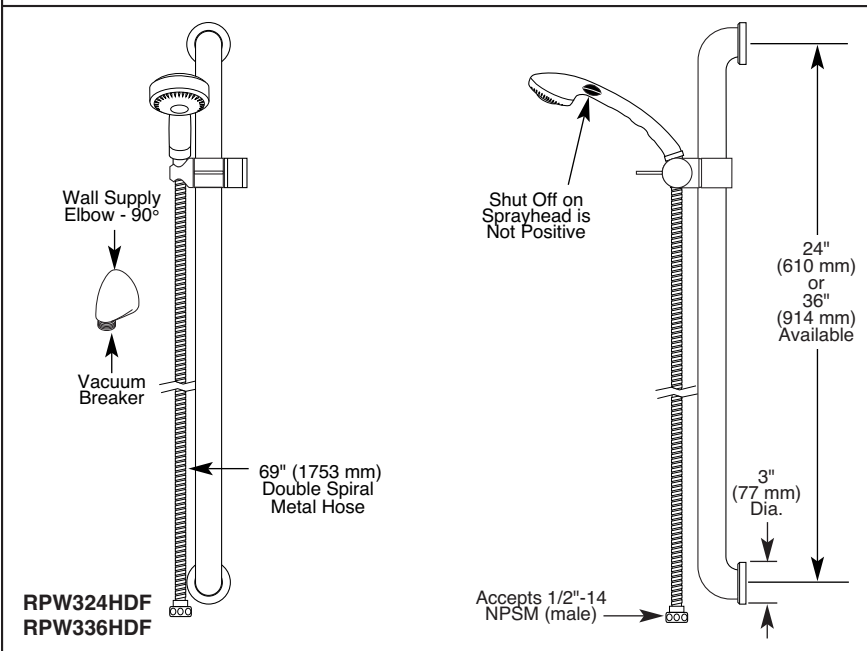
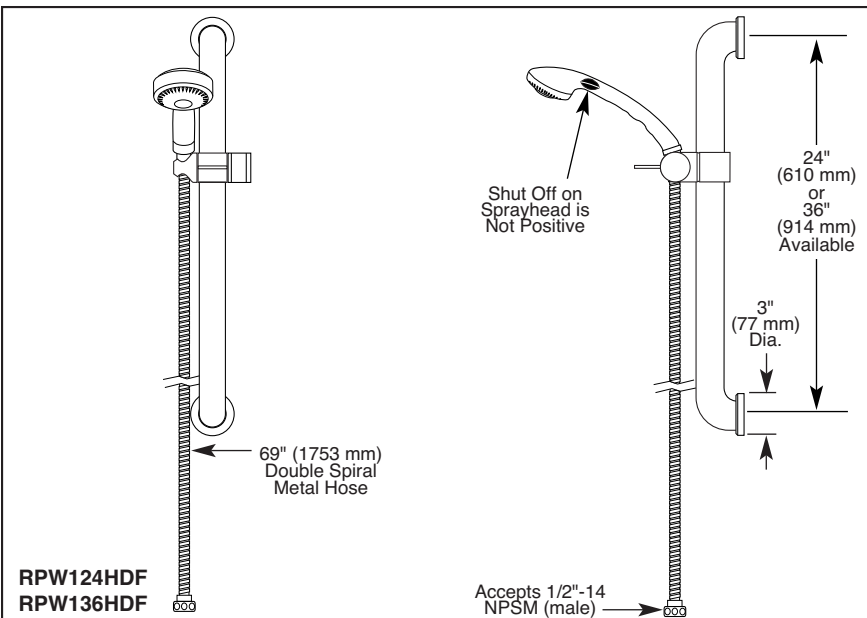

- 24" (610 mm) Slide/Grab Bar (RPW124HDF, RPW324HDF)
- 36" (914 mm) Slide/Grab Bars (RPW136HDF, RPW336HDF)
- Atmospheric Vacuum Breaker (RPW324HDF, RPW336HDF)
- 90° Wall Supply Elbow (RPW324HDF, RPW336HDF)

STANDARD SPECIFICATIONS:

- Personal white ABS hand held shower with fixed spray with push button on-off control, not a positive shut-off.
- 69" (1753 mm) double spiral metal hose.
- 24" (610 mm) and 36" (914 mm) stainless steel finish slide/grab bars.
- ADA compliant adjustable slide mechanism.
- Chrome plated atmospheric vacuum breaker, 1/2" IPS female inlet, 1/2"-14 NPSM male threaded outlet for exposed applications only. (Models RPW324HDF and RPW336HDF only).
- 90° chrome plated wall supply elbow, 1/2" IPS female inlet; 1/2"-14 NPSM male threaded outlet. (Models RPW324HDF and RPW336HDF only).
- 2.5 gpm @ 80 psi (9.5 L/min @ 552 kPa) from sprayhead.

COMPLIES WITH:

- ☐ Indicates ADA compliance to ICC/ANSI A117.1

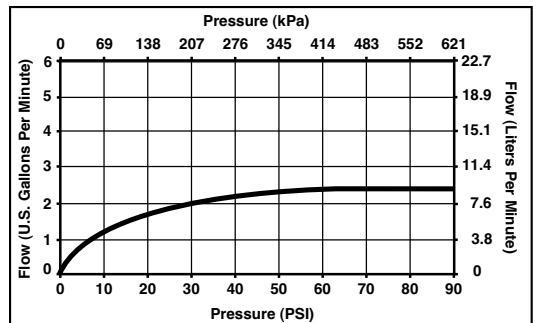

Delta reserves the right (1) to make changes in specifications and materials, and (2) to change or discontinue models, both without notice or obligation. Dimensions are for reference only. See current full-line price book or www.specselect.com for finish options and product availability.