

**BASIC SLEEVE.  
"-B" VERSION, 7 3/4" TALL.  
(Fig. 1)**

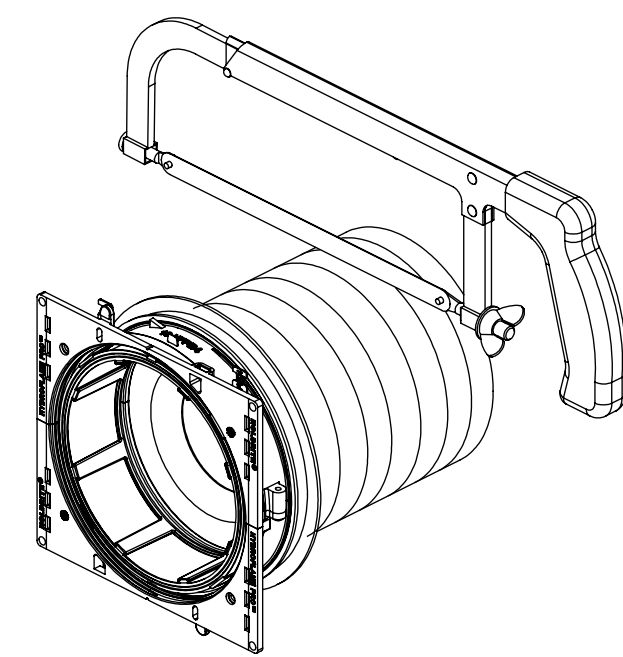

**CUT SLEEVE, IF DESIRED  
HEIGHT IS UNDER 7-3/4".  
(CAN BE CUT AS SHORT AS 2-1/2")  
(Fig. 2)**

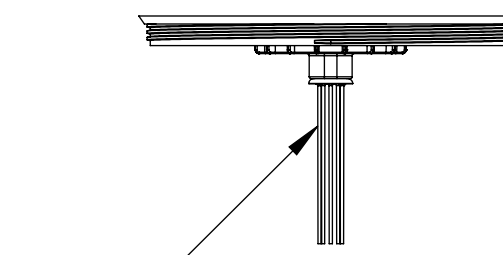

**Pull out Locator Whiskers  
(optional)**

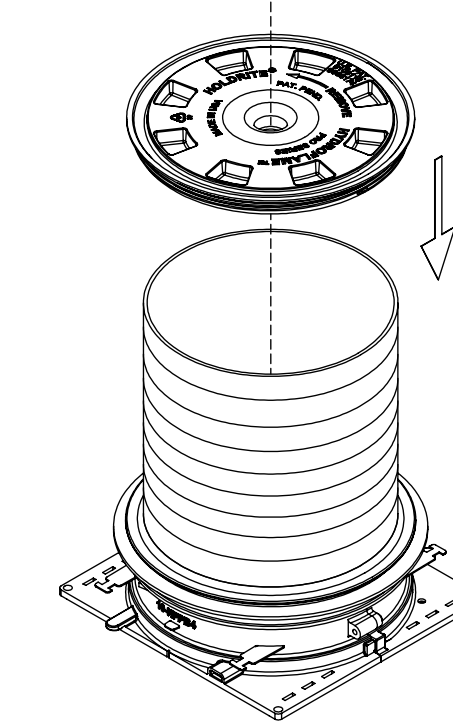

**Push Locator Whiskers until locked in place.  
(Optional, screw can be used to strengthen attachment)  
Note: Push Cap down onto Sleeve until it snaps on.  
Rotate clockwise, slightly, if desired.**

**RE-INSTALL CAP & INSERT LOCATOR WHISKERS.  
(Fig. 3)**

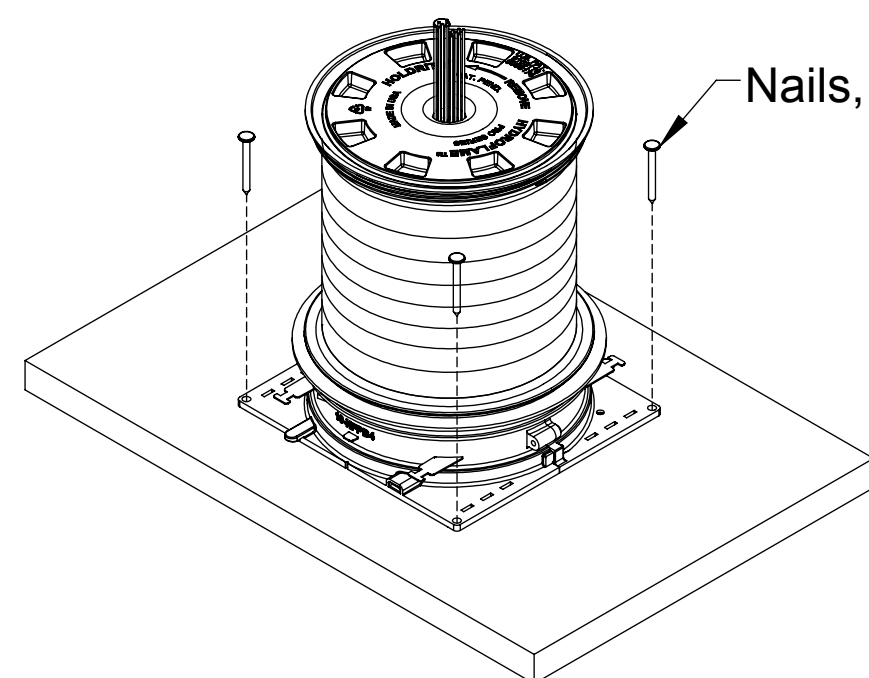

**Nails, 4 places recommended**

**NAIL TO FORM DECK.  
(Fig. 4)**

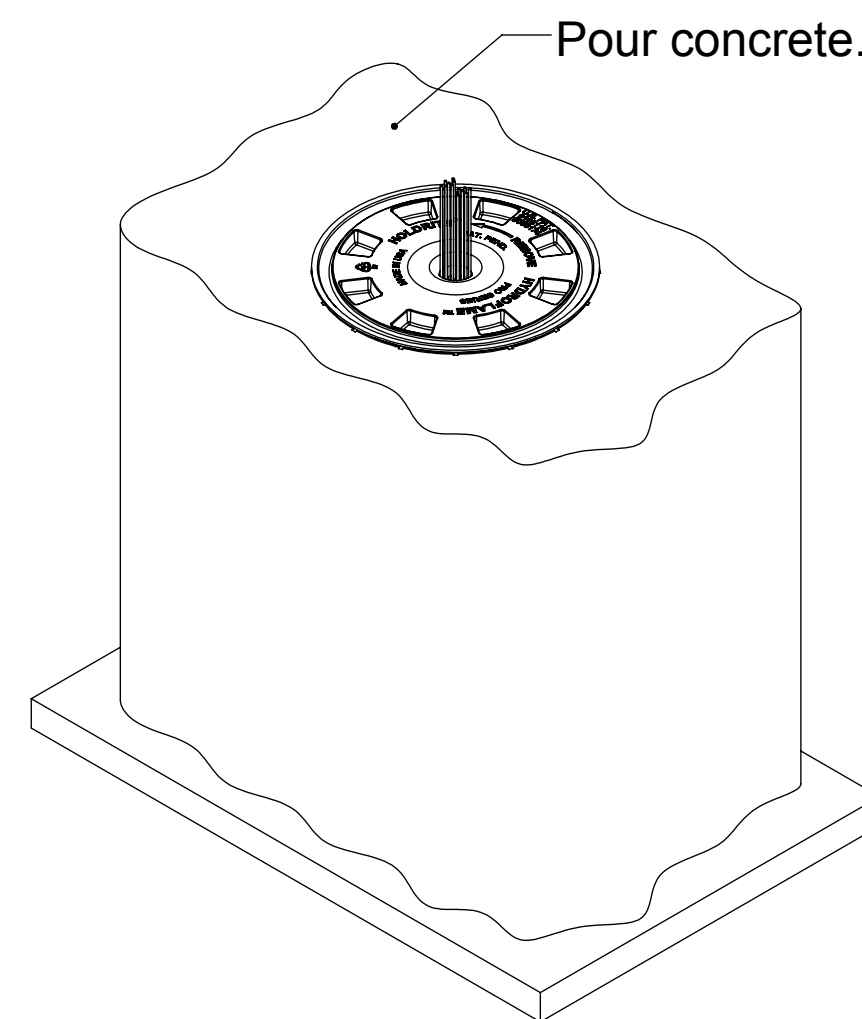

**Pour concrete.**

**POUR CONCRETE.  
(Fig. 5)**

**Turn Wrench,  
counter-clock-wise.**

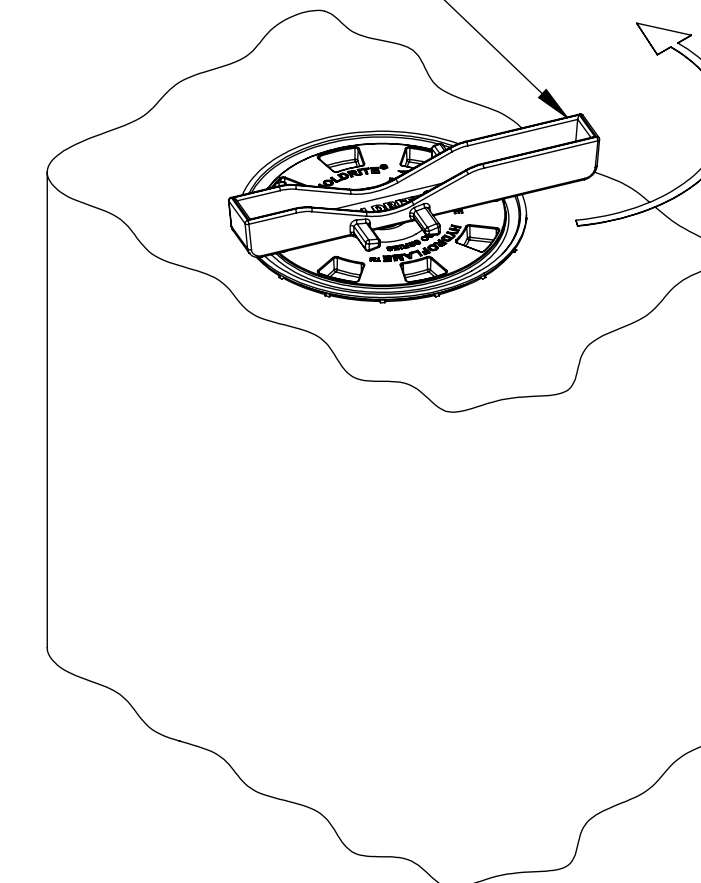

**REMOVE CAP WITH HF WRENCH,  
OR BREAK-OUT WITH HAMMER.  
(Fig. 6)**

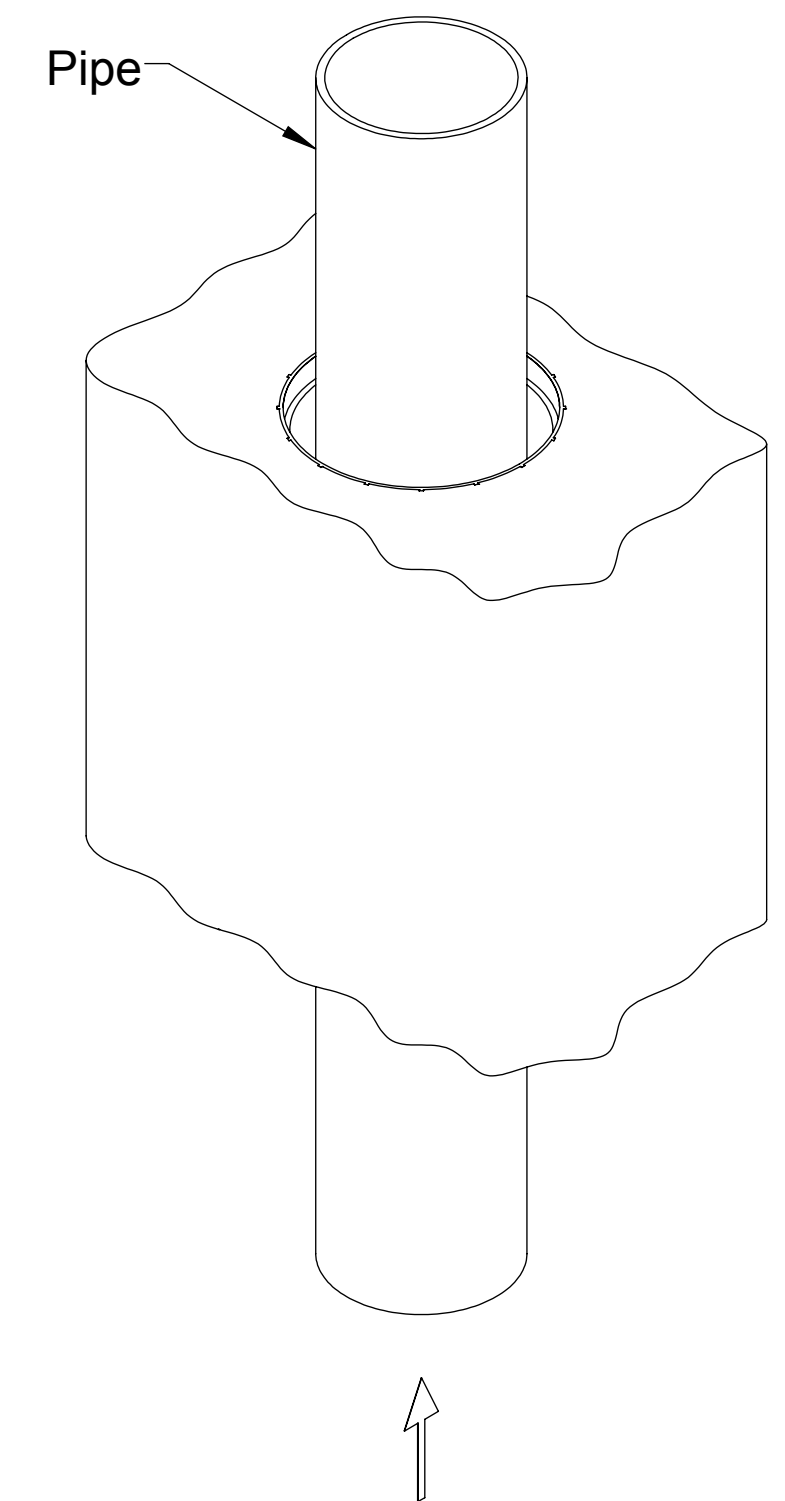

**INSTALL PIPE FROM BELOW.  
(SOAPY WATER EASES PIPE INSERTION)  
(Fig. 7)**