

PRODUCT SPECIFICATION DRAWING

TESTRITE® #TRW2 thru #TRW6 (2", 3", 4" & 6")

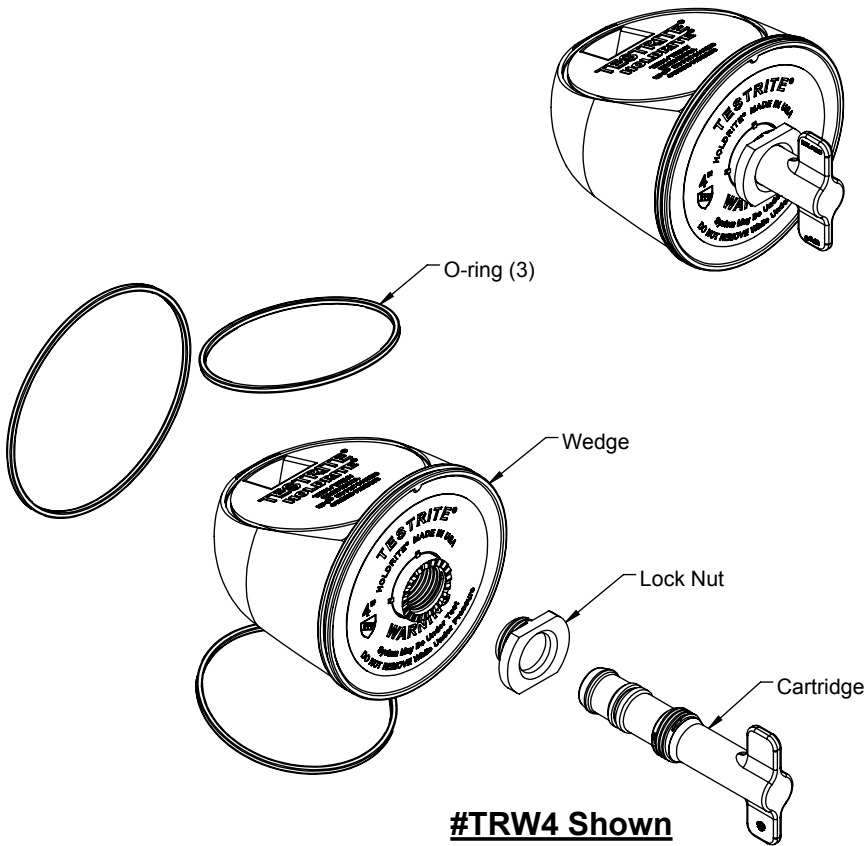

DIMENSION CHART	
Size	Dim "A" (closed)
2"	2.84" (2-13/16")
3"	2.52" (2-1/2")
4"	1.63" (1-5/8")
6"	1.93" (1-15/16")

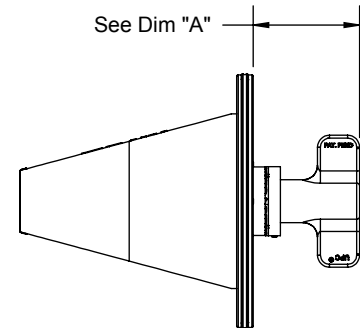

The TESTRITE® TRW2 through TRW6 (TEST WEDGES) are used in conjunction with TESTRITE TEE'S, which allow temporary blocking of the DWV stack for testing. Available in 2", 3", 4" & 6".

Product Information:

- Material:
 - Wedge: Nylon 6/6
 - Fill Drain Cartridge: NYLON 6/6, Black
 - Lock Nut: Nylon 6/6, Black
- Pressure ratings with TestRite's fittings up to 50' head of water / 5 psi (air):
 - 2" & 3" up to 50' head, 4" & 6" up to 40' head
- For use only with TestRite® fittings
- Patents issued and Patents Pending

THIS INFORMATION IS PROPRIETARY TO HOLDRITE AND IS SUBJECT TO CHANGE WITHOUT NOTICE. IT MAY NOT BE REPRODUCED IN PART OR WHOLE WITHOUT WRITTEN AUTHORIZATION.

HOLDRITE®
CONVERTING WAKESHIFT METHODS INTO ENGINEERED SOLUTIONS™

800-321-0316 OR 760-744-6944 / FAX: 760-744-0507 / WWW.HOLDRITE.COM
spec_#TRW2 thru #TRW6 (RevG)

Product Submittal	
Job Name:	
Date:	
Part Number:	Qty:
Architect / Owner:	
Contractor:	
Notes:	