



OLYMPIA FAUCETS, INC.

Interchange City Distribution Center #20
1277 Heil Quaker Boulevard
La Vergne, TN 37086
(888) 772-7701
www.olympiafaucets.com

Model Number: B-8170, B-8171, B-8172,
B-8180, B-8181, B-8182, B-8190, B-8191

Warnings and Notes:

Check with local plumbing code requirements before installation.
This product should be installed by a local listed plumber.
Do not use plumbers putty on threads.

Installation Steps:

Two Handle Laundry Faucet

Tools:



Adjustable Wrench



Plumbers Putty



Teflon Tape



Rags

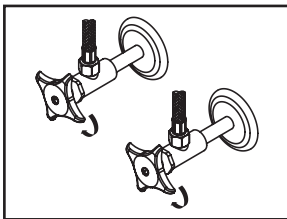

(1) Shut off water supplies. Remove old faucet. Clean mounting surface in preparation for new faucet.

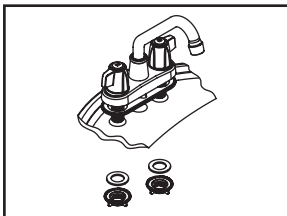

(2) Apply plumbers putty under the base gasket, with base gasket on the bottom of deck plate, place faucet in position on the sink. Slide washers on shanks and secure the locknut to the shanks from underneath of the sink.

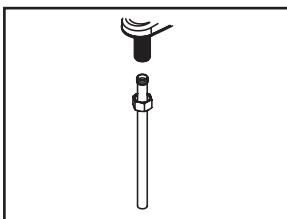

(3a) when using ball-nose flexible supplies to connect faucet to water supply valves, slip coupling nut onto flexible supply. Ball-nose coupling will go partially into shank. Tighten coupling nut (DO NOT OVERTIGHTEN). Install opposite end according to manufacturer's instruction for both tubes.

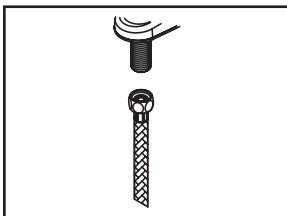

(3b) when using stainless steel braided faucet supply hose; this faucet requires one end of the supply hose to have a 1/2" female IPS connection. The other end of this supply hose must match the thread on the water supply valve under your sink. Once you've identified the required size, carefully follow the manufacturer's installation instructions for each hose.

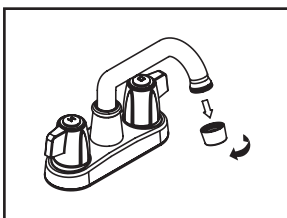

(4) Important: After installation is complete, remove aerator. Turn water supply on and allow both hot and cold water to run at least one minute each. While water is running, check for leaks. Turn off water and replace aerator.

Exploded Drawing:

	ITEM #	DESCRIPTION
A	OP-190014C,H	ADA Wrist Blade Handle Cold, Hot
B	OP-490040	Bonnet Nut
C	OP-390004	Cartridge–Brass Post
D	OP-490041	Springs and Seats
E	OP-450011	Deck Plate
F	OP-450012	Base Gasket
G	OP-590003	Mounting Locknut & Washer
H	OP-590001	Supply Nuts
I	OP-250004	Gooseneck Spout (B-8170 Spout)
I1	OP-250005	Gooseneck Spout (B-8180 Spout)
I2	OP-250007	Hi-Rise Spout (B-8190 Spout)
1	OP-450013	Handle Screw
2	OP-490001C,H	Cold & Hot Indicator
3	OP-490035	1.5 GPM Aerator
4	OP-450010	Spout Bonnet Nut
5	OP-490038	Spout Snap Ring
6	OP-490039	Spout O-ring
7	OP-450014	Hose Thread Adapter

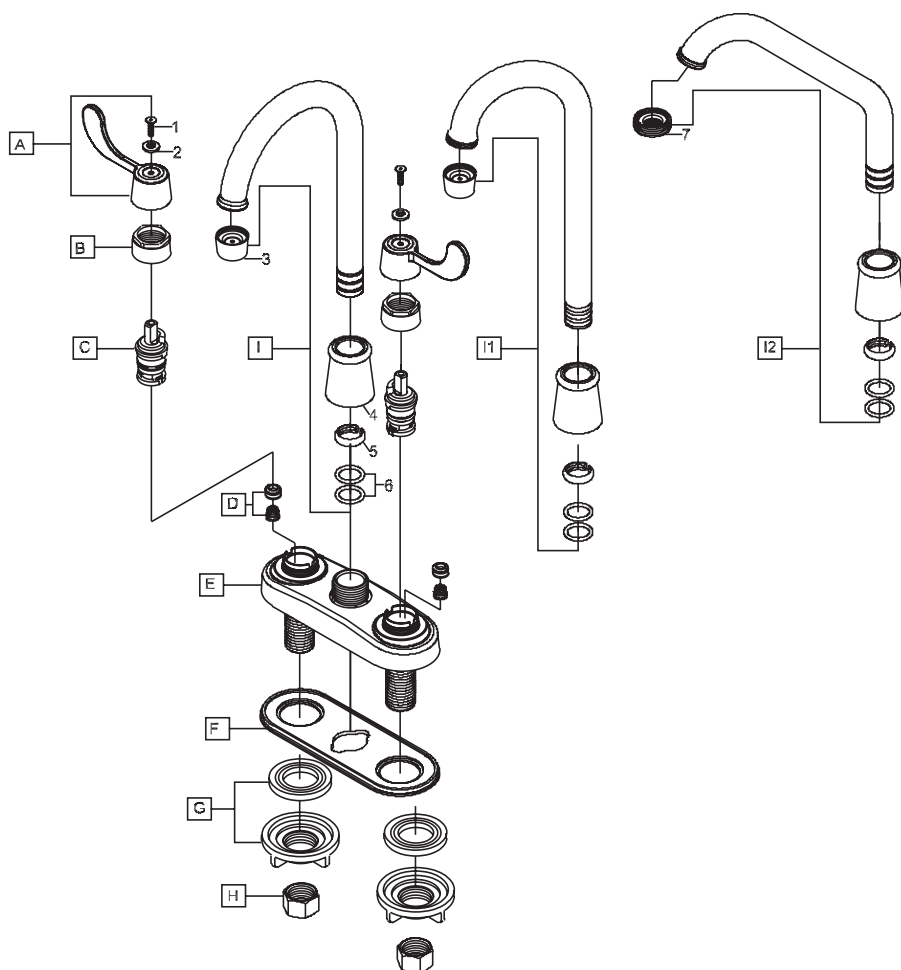

 OLYMPIA

For more care information or trouble shooting inquiries about your Olympia product, Please call:
OLYMPIA FAUCETS, INC. (888) 772-7701
 7AM - 8PM EST (4AM to 5PM PST)
www.olympiafaucets.com