

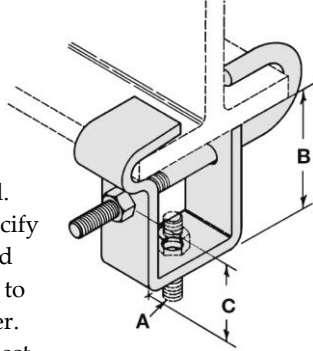

# CENTER LOAD BEAM CLAMPS

**Fig. 635**  
**ADJUSTABLE STEEL**  
**BEAM CLAMP**



Available in stainless steel. To order, specify 304 or 316 and add suffix SS to figure number. Price on request.

**FUNCTION:** Designed to be used in the suspension of a hanger rod from an I-Beam. The clamp is adjustable from 3½" (88.9) to 8" (203.2) and can be used with flange thicknesses up to ½" (12.7).

**APPROVALS:** Complies with Federal Specifications A-A-1192A (Type 27) and Manufacturers' Standardization Society ANSI/SP-69 and SP-58 (Type 27).

**ORDERING:** Specify rod size and figure number.

**MATERIAL:** Low carbon steel

**FINISH:** Plain or electro-galvanized

Rod Size A	Flange Width				B		C		Max. Rec. Load		Wt. Each	
	Min.		Max.						lbs.	kN	lbs.	kg
3⁄8	3 1⁄2	(88.90)	8	(203.20)	2 3⁄4	(69.85)	1 1⁄2	(38.10)	300	(1.33)	1.04	(.47)
1⁄2	3 1⁄2	(88.90)	8	(203.20)	2 3⁄4	(69.85)	1 1⁄2	(38.10)	700	(3.11)	1.45	(.66)
5⁄8	3 1⁄2	(88.90)	8	(203.20)	2 3⁄4	(69.85)	1 1⁄2	(38.10)	1000	(4.45)	1.96	(.89)
3⁄4	6	(152.40)	8	(203.20)	4	(101.60)	2	(50.80)	1800	(8.01)	6.50	(2.95)

**Note:** For proper installation, tighten hex nut until lock washer is completely flat.

Unless otherwise specified, all dimensions on drawings and in charts are in inches and dimensions shown in parentheses are in millimeters.