

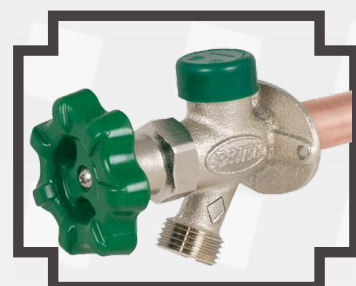

**SPEC SHEETS**

**2015**

# TABLE OF CONTENTS



**Residential Hydrants**  
Pages 4-21



**Commercial Hydrants**  
Pages 23-38

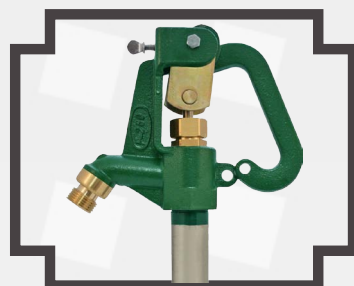

**Ground Hydrants**  
Pages 40-49

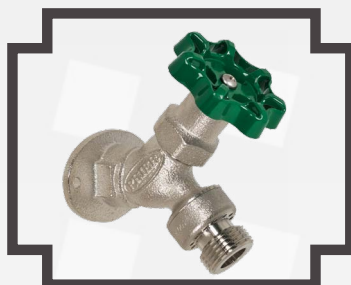

**Angle Sill Faucets**  
Pages 51-56



**Plumbing Brass**  
Pages 58-61



**Drainage Products**  
Pages 63-73



**Specialty Valves**  
Pages 75-82

<b>Page 4</b>	<b>300 Wall Hydrant</b>
<b>Page 6</b>	<b>400 Half Turn Anti-Siphon Wall Hydrant</b>
<b>Page 8</b>	<b>400-LF Half Turn Anti-Siphon Wall Hydrant</b>
<b>Page 10</b>	<b>408 Internal Vacuum Breaker Wall Hydrant</b>
<b>Page 12</b>	<b>C-134 Full Turn Wall Hydrant</b>
<b>Page 14</b>	<b>C-144 Full Turn Anti-Siphon Wall Hydrant</b>
<b>Page 16</b>	<b>P-164 Quarter Turn Anti- Siphon Wall Hydrant</b>
<b>Page 18</b>	<b>C-108 Hot and Cold Anti Siphon Wall Hydrant</b>
<b>Page 20</b>	<b>C-434 Self-Draining Anti-Siphon Wall Hydrant</b>

## RESIDENTIAL HYDRANTS



4515 East 139th Street  
Grandview, MO 64030  
(800) 362-9055  
Fax (800) 362-1463  
www.PRIER.com



4515 East 139th Street  
Grandview, MO 64030  
(800) 362-9055  
Fax (800) 362-1463  
www.PRIER.com

Application

## 300 Series Freezeless Wall Hydrant

### Mansfield Style M-300



- Residential
- Freezeless
- Solid Brass Body
- Easy Grip Handle



PRIER 300 Series provides a year round source of water to areas of structures that are subject to freezing temperatures. The hydrant valve is connected to the supply piping in the heated portion of the structure, eliminating the possibility of freezing.

The PRIER 300 Series is one of the original freezeless hydrant designs and is installed throughout the United States. It is available from stock in lengths from 4" to 14".

Features

- Integral cast backflange
- Wide screw holes easily secure mounting screws
- Solid brass body and seat
- Satin nickel plated body maintains attractive finish
- Stainless steel handle screw
- Easy grip polycarbonate operating handle
- Durable ACME threads secure stem at seat end
- AFG teflon with graphite packing for easy maintenance
- Spacer wedge
- Standard "OO" size seat washer
- Spout aligning mark
- Field repairable with no special tools
- Option of grey or beige handle

### Inlet Styles

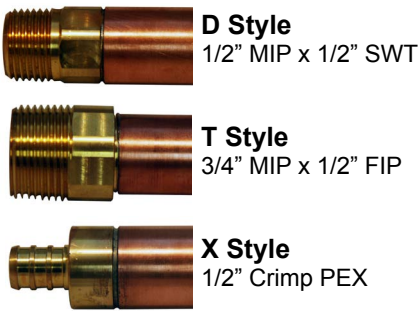

Ordering

**378-10**

**Inlet**  
78-D- 1/2" MPT x 1/2" SWT  
79-T- 3/4" MPT x 1/2" FPT  
90-X- 1/2" Crimp PEX

**Handle Color**  
- Grey Handle  
B- Beige Handle

**Length**  
CC- Close Coupled  
04- 4" Insertion  
06- 6" Insertion  
08- 8" Insertion  
10- 10" Insertion  
12- 12" Insertion  
14- 14" Insertion

Replacement Parts

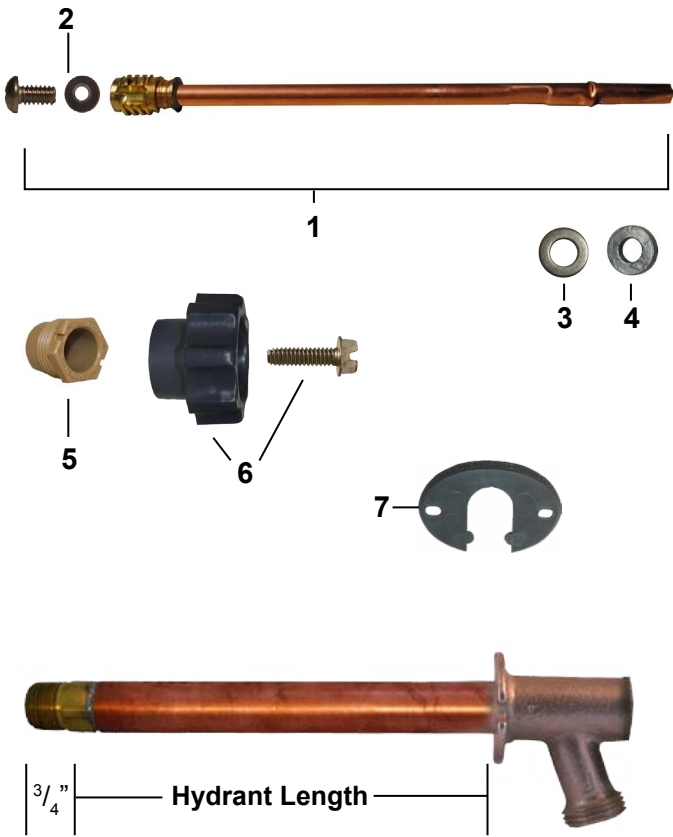

ID	Part No.	Description
1	See Below	Stem Assembly, Contains: 1, 2, 3, 4
2	C-134KT-802	Seat Washer Replacement Kit (00 Beveled)
3	324-1006	Washer (Stainless Steel)
4	339-3002	Packing for Left Hand Packing Nut (Graphite)
5	337-3001	Left Hand Thread Packing Nut (Plastic)
6	630-7965	Handle & Screw Kit (Grey Plastic Handle & Stainless Steel Screw)
	630-7975	Handle & Screw Kit (Beige Plastic Handle & Stainless Steel Screw)
7	337-3012	Space Wedge (Grey, Plastic)
	337-3013	Space Wedge (Beige, Plastic)
	630-7755	Service Kit for 300/400/500 Series Contains: 2, 3, 4, 5

\*The 630-7755 Wall Hydrant Repair Kit includes parts for the 300, 400 and 500 Series hydrants, some of which are not pictured here. When repairing a hydrant you will have parts left over.

Replacement Stems



G Style Manufactured April 2013 - Present

Part No.	Style	Description	Stem Length
M-231-3104	G	Stem for 4" 300 Series Hydrant	6 9/16" OAL
M-231-3106	G	Stem for 6" 300 Series Hydrant	8 9/16" OAL
M-231-3108	G	Stem for 8" 300 Series Hydrant	10 9/16" OAL
M-231-3110	G	Stem for 10" 300 Series Hydrant	12 9/16" OAL
M-231-3112	G	Stem for 12" 300 Series Hydrant	14 9/16" OAL
M-231-3114	G	Stem for 14" 300 Series Hydrant	16 9/16" OAL

\*\*For the **old style 300 Series** wall hydrant stems, see 300 Series retired style spec sheet at [www.PRIER.com](http://www.PRIER.com).





4515 East 139th Street  
Grandview, MO 64030  
(800) 362-9055  
Fax (800) 362-1463  
www.PRIER.com

## 400 Series Freezeless Wall Hydrant

### Mansfield Style M-400



- Residential
- Freezeless
- Anti-Siphon
- Backflow Check Valve



PRIER 400 Series provides a year round source of water to areas of structures that are subject to freezing temperatures. The hydrant valve is connected to the supply piping in the heated portion of the structure, eliminating the possibility of freezing. The PRIER 400 Series features a half-turn design for years of easy operation.

The PRIER 400 Series has all the characteristics of the proven 300 Series Wall Hydrant, with the added protection of a vacuum breaker and backflow preventor. It is available from stock in lengths from 4" to 14".

- ASSE 1019 and C-UPC approved
- Easy half-turn operation
- Integral cast backflange
- Wide screw holes easily secure mounting screws
- Solid brass body and seat
- Satin nickel plated body maintains attractive finish
- Stainless steel handle screw
- Easy grip polycarbonate operating handle
- Durable ACME threads secure stem at seat end
- Solid stem design with EPDM backflow preventor
- AFG teflon with graphite packing for easy maintenance
- Field repairable with no special tools
- Spout aligning mark

### Inlet Styles



**478-10**

**Handle Color**  
- Grey Handle  
B- Beige Handle

**Inlet**  
78-D- 1/2" MPT x 1/2" SWT  
79-T- 3/4" MPT x 1/2" FPT  
81-S- 3/4" Push-On x 1/2" SWT  
82-F- 3/4" MPT x 3/4" SWT  
90-X- 1/2" Crimp PEX  
91-W- 1/2" Wirsbo PEX®  
92-FX- 3/4" Crimp PEX  
93-FW- 3/4" Wirsbo PEX®

**Length**  
CC- Close Coupled  
04- 4" Insertion  
06- 6" Insertion  
08- 8" Insertion  
10- 10" Insertion  
12- 12" Insertion  
14- 14" Insertion

## Replacement Parts

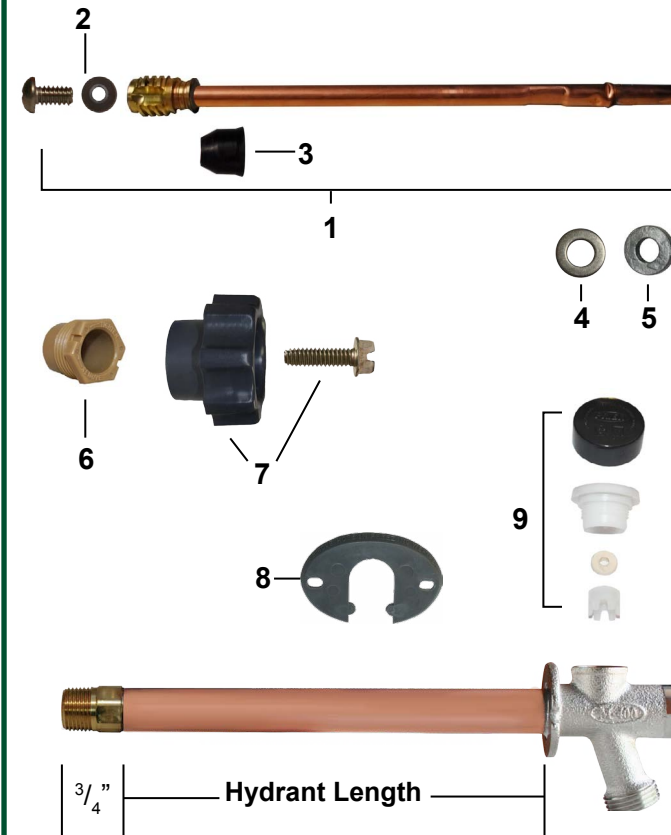

ID	Part No.	Description
1	See Below	Stem Assembly, Contains: 1, 2, 3, 4, 5
2	C-134KT-802	Seat Washer Replacement Kit (00 Beveled)
3	336-0002	Backflow Check Valve for 400 Series
4	324-1006	Washer (Stainless Steel)
5	339-3002	Packing for Left Hand Packing Nut (Graphite)
6	337-3001	Left Hand Thread Packing Nut (Plastic)
7	630-7965	Handle & Screw Kit (Grey Plastic Handle & Stainless Steel Screw)
	630-7975	Handle & Screw Kit (Beige Plastic Handle & Stainless Steel Screw)
8	337-3012	Space Wedge (Grey, Plastic)
	337-3013	Space Wedge (Beige, Plastic)
9	630-7500	Vacuum Breaker Replacement Kit (Plastic Parts with Rubber Washer)
	630-7755	Service Kit for 300/400/500 Series Contains: 2, 3, 4, 5, 6

\*The 630-7755 Wall Hydrant Repair Kit includes parts for the 300, 400 and 500 Series hydrants, some of which are not pictured here. When repairing a hydrant you will have parts left over.

## Replacement Stems



**H Style Manufactured April 2013 - Present**

Part No.	Style	Description	Stem Length
M-231-3204	H	Stem for 4" 400 Series Hydrant	6 9/16" OAL
M-231-3206	H	Stem for 6" 400 Series Hydrant	8 9/16" OAL
M-231-3208	H	Stem for 8" 400 Series Hydrant	10 9/16" OAL
M-231-3210	H	Stem for 10" 400 Series Hydrant	12 9/16" OAL
M-231-3212	H	Stem for 12" 400 Series Hydrant	14 9/16" OAL
M-231-3214	H	Stem for 14" 400 Series Hydrant	16 9/16" OAL

\*\*For the **old style 400 Series** wall hydrant stems, see 400 Series retired style spec sheet at [www.PRIER.com](http://www.PRIER.com). For older styles made prior to 2007, see the retired 500 Series spec sheet.





4515 East 139th Street  
Grandview, MO 64030  
(800) 362-9055  
Fax (800) 362-1463  
www.PRIER.com



4515 East 139th Street  
Grandview, MO 64030  
(800) 362-9055  
Fax (800) 362-1463  
www.PRIER.com

Application

# 400 Series Freezeless Wall Hydrant

## Mansfield Style M-400-LF

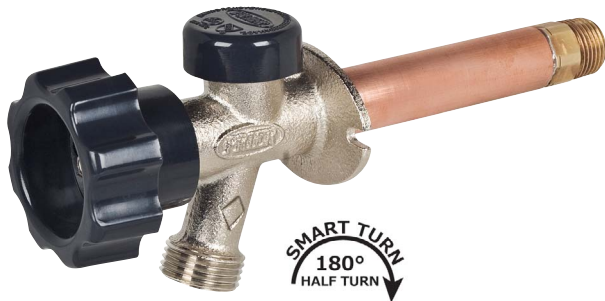

- Residential
- Freezeless
- Anti-Siphon
- Backflow Check Valve
- Lead Free



PRIER 400-LF Series is made with lead free brass and provides a year round source of water to areas of structures that are subject to freezing temperatures. The hydrant valve is connected to the supply piping in the heated portion of the structure, eliminating the possibility of freezing. The PRIER 400 Series features half-turn design for years of easy operation.

The PRIER 400 Series has all the characteristics of the proven 300 Series Wall Hydrant, with the added protection of a vacuum breaker and backflow preventor. It is available from stock in lengths from 4" to 14".

Features

- Body and seat composed of solid lead free brass (PB ≤ 0.25%)
- ASSE 1019 and C-UPC approved
- Meets NSF 61
- Easy half-turn operation
- Integral cast backflange
- Wide screw holes easily secure mounting screws
- Solid brass body and seat
- Satin nickel plated body maintains attractive finish
- Stainless steel handle screw
- Easy grip polycarbonate operating handle
- Durable ACME threads secure stem at seat end
- Solid stem design with EPDM backflow preventor
- AFG teflon with graphite packing for easy maintenance
- Field repairable with no special tools
- Spout aligning mark

## Inlet Styles



**D Style**  
1/2" MIP x 1/2" SWT

**X Style**  
1/2" Crimp PEX

Ordering

# 478-10-LF

**Inlet**  
78-D- 1/2" MPT x 1/2" SWT  
90-X- 1/2" Crimp PEX

**Length**  
CC- Close Coupled  
04- 4" Insertion  
06- 6" Insertion  
08- 8" Insertion  
10- 10" Insertion  
12- 12" Insertion  
14- 14" Insertion

**Handle Color**  
- Grey Handle  
B- Beige Handle

Replacement Parts

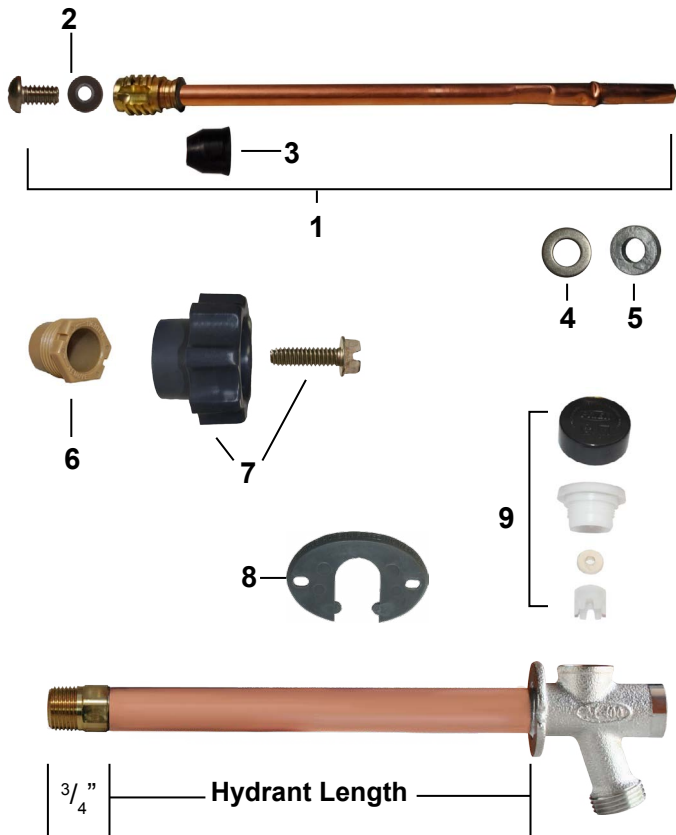

ID	Part No.	Description
1	See Below	Stem Assembly, Contains: 1, 2, 3, 4, 5
2	C-134KT-802	Seat Washer Replacement Kit (00 Beveled)
3	336-0002	Backflow Check Valve for 400 Series
4	324-1006	Washer (Stainless Steel)
5	339-3002	Packing for Left Hand Packing Nut (Graphite)
6	337-3001	Left Hand Thread Packing Nut (Plastic)
7	630-7965	Handle & Screw Kit (Grey Plastic Handle & Stainless Steel Screw)
	630-7975	Handle & Screw Kit (Beige Plastic Handle & Stainless Steel Screw)
8	337-3012	Space Wedge (Grey, Plastic)
	337-3013	Space Wedge (Beige, Plastic)
9	630-7500	Vacuum Breaker Replacement Kit (Plastic Parts with Rubber Washer)
	630-7755	Service Kit for 300/400/500 Series Contains: 2, 3, 4, 5, 6

\*The 630-7755 Wall Hydrant Repair Kit includes parts for the 300, 400 and 500 Series hydrants, some of which are not pictured here. When repairing a hydrant you will have parts left over.

Replacement Stems



H Style Manufactured April 2013 - Present

Part No.	Style	Description	Stem Length
M-231-3204-LF	H	Stem for 4" 400 Series Lead Free Hydrant	6 9/16" OAL
M-231-3206-LF	H	Stem for 6" 400 Series Lead Free Hydrant	8 9/16" OAL
M-231-3208-LF	H	Stem for 8" 400 Series Lead Free Hydrant	10 9/16" OAL
M-231-3210-LF	H	Stem for 10" 400 Series Lead Free Hydrant	12 9/16" OAL
M-231-3212-LF	H	Stem for 12" 400 Series Lead Free Hydrant	14 9/16" OAL
M-231-3214-LF	H	Stem for 14" 400 Series Lead Free Hydrant	16 9/16" OAL

\*\*For the **old style 400 Series** wall hydrant stems, see 400 Series retired style spec sheet at [www.PRIER.com](http://www.PRIER.com). For older styles made prior to 2007, see the retired 500 Series spec sheet.



4515 East 139th Street  
Grandview, MO 64030  
(800) 362-9055  
Fax (800) 362-1463  
www.PRIER.com



4515 East 139th Street  
Grandview, MO 64030  
(800) 362-9055  
Fax (800) 362-1463  
www.PRIER.com

Application

# 408 Series Freezeless Wall Hydrant

## Internal Vacuum Breaker

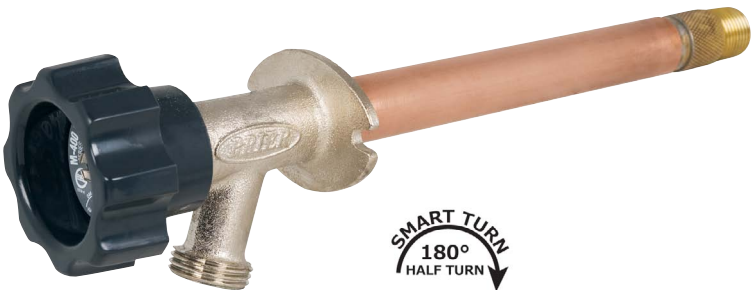

- Residential
- Freezeless
- Anti-Siphon
- Backflow Check Valve



PRIER 408 Series provides a year round source of water to areas of structures that are subject to freezing temperatures. The hydrant valve is connected to the supply piping in the heated portion of the structure, eliminating the possibility of freezing. The PRIER 408 Series features the half-turn design for years of easy operation.

The PRIER 408 Series has all the characteristics of the proven historically proved 300 Series Wall Hydrant, with the added protection of an integral vacuum breaker and backflow preventor. PRIER's design incorporates the vacuum breaker and backflow preventor into the operating stem, eliminating an external vacuum breaker on top of the valve.

Features

- ASSE 1019 and C-UPC approved
- Internal vacuum breaker and backflow preventor
- Easy half-turn operation
- Integral cast backflange
- Wide screw holes easily secure mounting screws
- Siding wedge included with each valve
- Solid brass body and seat
- Satin nickel plated body maintains finish indefinitely
- Easy grip polycarbonate operating handle
- Stainless steel handle Screw
- Full circle seat threads secure stem to seat end
- AFG teflon and graphite packing for easy maintenance
- Each valve air-tested at factory for leak free quality
- Spout aligning mark

## Inlet Styles

- D Style**  
1/2" MIP x 1/2" SWT
- X Style**  
1/2" Crimp PEX
- T Style**  
3/4" MIP x 1/2" FIP
- F Style**  
3/4" MIP x 3/4" SWT
- FX Style**  
3/4" Crimp PEX

Ordering

408-10

Inlet

- 08-D- 1/2" MPT x 1/2" SWT
- 09-T- 3/4" MPT x 1/2" FPT
- 12-F- 3/4" MPT x 3/4" SWT
- 20-X- 1/2" Crimp PEX
- 21-FX- 3/4" Crimp PEX

Length

- CC- Close Coupled
- 04- 4" Insertion
- 06- 6" Insertion
- 08- 8" Insertion
- 10- 10" Insertion
- 12- 12" Insertion
- 14- 14" Insertion

Replacement Parts

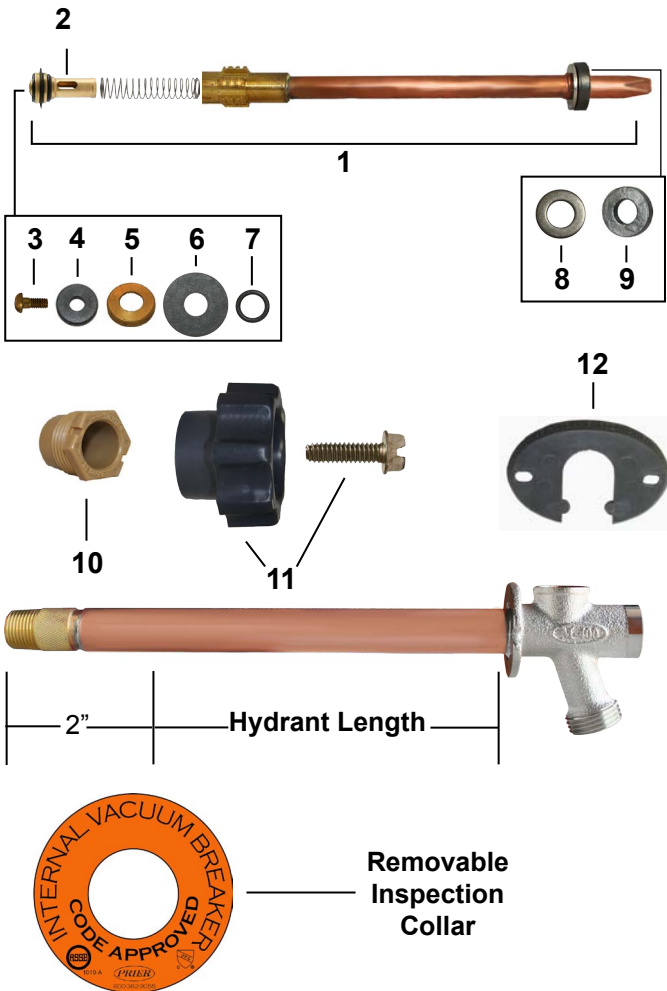

ID	Part No.	Description
1	See Below	Stem Assembly Contains: 1, 2, 3, 4, 5, 6, 7, 8, 9
2	231-3201	BFP Assembly
3	910-3008	Bibb Screw (Brass)
4	936-3012	Bibb Washer (Rubber)
5	310-3016	Cage Washer (Brass)
6	936-3011	BFP Washer (Rubber)
7	936-3002	Stem End O-Ring (Rubber)
8	324-1006	Washer (Stainless Steel)
9	339-3002	Packing for Left Hand Packing Nut (Graphite)
10	337-3001	Left Hand Thread Packing Nut (Plastic)
11	630-7965	Handle & Screw Kit (Grey Plastic Handle & Stainless Steel Screw)
	630-7965	Handle & Screw Kit (Beige Plastic Handle & Stainless Steel Screw)
12	337-3012	Space Wedge (Grey, Plastic)
	337-3013	Space Wedge (Beige, Plastic)
	630-7755	Service Kit for 300/400/500 Series Contains: 3, 4, 5, 6, 7, 8, 9, 10

\*The 630-7755 Wall Hydrant Repair Kit includes parts for the 300, 400 and 500 Series hydrants, some of which are not pictured here. When repairing a hydrant you will have parts left over.

Replacement Stems



Part No.	Description	Stem Length
M-123-4090	Stem for 4" 400 Series Hydrant	8" OAL
M-123-4092	Stem for 6" 400 Series Hydrant	10" OAL
M-123-4093	Stem for 8" 400 Series Hydrant	12" OAL
M-123-4094	Stem for 10" 400 Series Hydrant	14" OAL
M-123-4095	Stem for 12" 400 Series Hydrant	16" OAL
M-123-4096	Stem for 14" 400 Series Hydrant	18" OAL

\*\*400 Series stems are made to fit the 400, 408 and 400-LF Series Wall Hydrants only. They are not interchangeable with any other models. For parts for Mansfield style anti-siphon hydrants made prior to 2007, see the retired 500 Series spec sheet.





4515 East 139th Street  
Grandview, MO 64030  
(800) 362-9055  
Fax (800) 362-1463  
www.PRIER.com



4515 East 139th Street  
Grandview, MO 64030  
(800) 362-9055  
Fax (800) 362-1463  
www.PRIER.com

Application

# C-134/234 Series Freezeless Wall Hydrant

## Original Heavy Duty Style

C-234 Loose Key Design



- Residential
- Freezeless
- Slim Seat
- Satin Nickel Plated



PRIER C-134 provides a year round source of water to areas of structures that are subject to freezing temperatures. The hydrant valve is connected to the supply piping in the heated portion of the structure, eliminating the possibility of freezing. Ordering the C-234 gives you the same style hydrant but with a vandal proof extended lockshield with operating key.

The PRIER C-134 is the original freezeless hydrant that is made in the same heavy pattern fashion that made it famous. It is available from stock in lengths from Close Coupled to 24". Longer sizes are available upon request.

Features

- C-UPC approved
- Integral cast flange with built-in drainage pitch
- Enclosed screw holes easily secure mounting screws
- Solid brass body, valve stem cap, seat and stem ends
- Satin nickel plated body maintains attractive finish
- Stainless steel seat washer screw and handle screw
- Powder coated cast aluminum handle
- Durable ACME threads secure stem at seat end
- Lock shield cap for stronger valve design
- AFG teflon with graphite packing for easy maintenance
- Standard "OO" size seat washer
- Spout aligning mark
- Slim seat inlet for easier installation

Ordering

# C-134D10

**Operator**  
1- Handle Operated  
2- Vandal Proof Lockshield

**Inlet**  
D- 1/2" MPT x 1/2" SWT  
F- 3/4" MPT x 3/4" SWT  
S- 1/2" SWT x 3/4" Push-On  
T- 3/4" MIP x 1/2" FIP  
W- 1/2" Wirsbo PEX®  
X- 1/2" Crimp PEX  
FX- 3/4" Crimp PEX  
FW- 3/4" Wirsbo PEX®

**Length**  
CC- Close Coupled  
04- 4" Insertion  
06- 6" Insertion  
08- 8" Insertion  
10- 10" Insertion  
12- 12" Insertion  
14- 14" Insertion  
16- 16" Insertion  
18- 18" Insertion  
20- 20" Insertion  
22- 22" Insertion  
24- 24" Insertion  
XX- Special Size

## Inlet Styles

- D Style**  
1/2" MIP x 1/2" SWT
- S Style**  
1/2" SWT x 3/4" Push-On
- X Style**  
1/2" Crimp PEX
- W Style**  
1/2" Wirsbo® PEX
- T Style**  
3/4" MIP x 1/2" FIP
- F Style**  
3/4" MIP x 3/4" SWT
- FX Style**  
3/4" Crimp PEX
- FW Style**  
3/4" Wirsbo® PEX

Replacement Parts

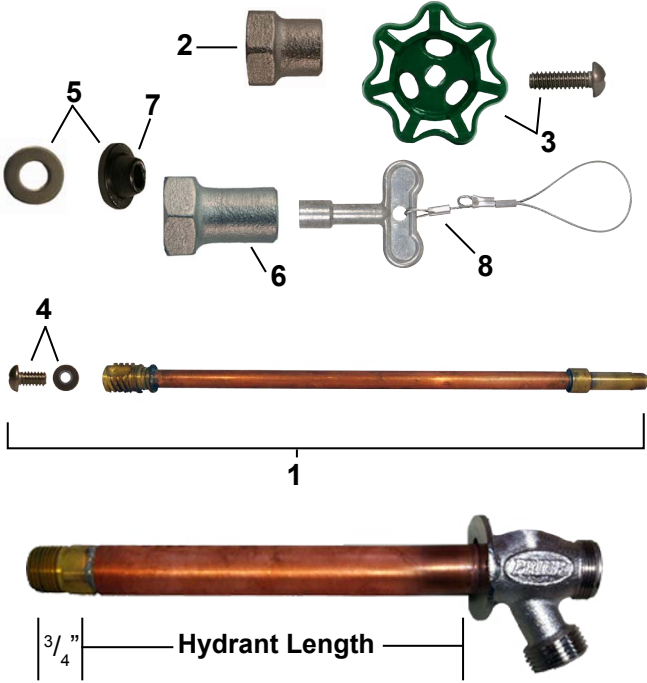

ID	Part No.	Description
1	See Below	Stem Assembly, Contains: 1, 4
2	300-1008	Valve Stem Cap
3	C-134KT-805	Oval Handle and Screw Kit
4	C-134KT-802	Seat Washer Replacement Kit (00 Beveled)
5	C-134KT-803	Stem Packing Replacement Kit
6	310-1015	Valve Stem Cap for Loose Key
7	390-1001	Stem Packing Only
8	C-108KT-808	Oval Style Key on Lanyard
	C-134KT-804	Loose Key Conversion Kit Contains: 5, 6, 8
	C-134KT-807	C-134 Overhaul Kit Contains: 3, 4, 5

Replacement Stems



G Style Manufactured April 2013 - Present

Part No.	Style	Description	Stem Length
P-231-11CC	G	Close Coupled Stem for C-134 Hydrant	4 3/8" OAL
P-231-1104	G	Stem for 4" C-134 Hydrant	6 7/8" OAL
P-231-1106	G	Stem for 6" C-134 Hydrant	8 7/8" OAL
P-231-1108	G	Stem for 8" C-134 Hydrant	10 7/8" OAL
P-231-1110	G	Stem for 10" C-134 Hydrant	12 7/8" OAL
P-231-1112	G	Stem for 12" C-134 Hydrant	14 7/8" OAL
P-231-1114	G	Stem for 14" C-134 Hydrant	16 7/8" OAL
P-231-1116	G	Stem for 16" C-134 Hydrant	18 7/8" OAL
P-231-1118	G	Stem for 18" C-134 Hydrant	20 7/8" OAL
P-231-1120	G	Stem for 20" C-134 Hydrant	22 7/8" OAL
P-231-1122	G	Stem for 22" C-134 Hydrant	24 7/8" OAL
P-231-1124	G	Stem for 24" C-134 Hydrant	26 7/8" OAL
P-231-11US	G	*Universal Replacement Stem for C-134 Hydrant	Up to 16 7/8" OAL

\*\*For the **old style C-134 Series** wall hydrant stems, see C-134 Series retired style spec sheet at [www.PRIER.com](http://www.PRIER.com). PRIER universal stems are replacement stems for any size from close coupled to 14." They require cutting the rod to proper length and soldering the brass stem end to the rod as directed in instructions.





4515 East 139th Street  
Grandview, MO 64030  
(800) 362-9055  
Fax (800) 362-1463  
www.PRIER.com



4515 East 139th Street  
Grandview, MO 64030  
(800) 362-9055  
Fax (800) 362-1463  
www.PRIER.com

Application

# C-144/244 Series Freezeless Wall Hydrant

With Anti-Siphon Vacuum Breaker

- Residential
- Freezeless
- Anti-Siphon
- Backflow Check Valve

C-244 Loose Key Design



PRIER C-144 provides a year round source of water to areas of structures that are subject to freezing temperatures. The hydrant valve is connected to the supply piping in the heated portion of the structure, eliminating the possibility of freezing. Ordering the C-244 gives you the same style hydrant but with a vandal proof extended lockshield and operating key.

The PRIER C-144 has all the characteristics of the historically proven C-134 with the added protection of an anti-siphon vacuum breaker and backflow check valve. It is available from stock in lengths from close coupled to 24", longer sizes are available on request.

Features

- ASSE 1019 and C-UPC approved
- Anti-siphon vacuum breaker with backflow check valve
- Integral cast flange with built-in drainage pitch
- Enclosed screw holes easily secure mounting screws
- Solid brass body, valve stem cap, seat and stem ends
- Satin nickel plated body maintains attractive finish
- Stainless steel seat washer screw and handle screw
- Powder coated cast aluminum handle
- Durable ACME threads secure stem at seat end
- Lock shield cap for stronger valve design
- AFG teflon with graphite packing for easy maintenance
- Standard "OO" size seat washer
- Spout aligning mark
- Slim seat inlet for easier installation

## Inlet Styles



Ordering

C-144D10

**Operator**  
1- Handle Operated  
2- Vandal Proof Lockshield

**Inlet**  
D- 1/2" MPT x 1/2" SWT  
F- 3/4" MPT x 3/4" SWT  
S- 1/2" SWT x 3/4" Push-On  
T- 3/4" MIP x 1/2" FIP  
W- 1/2" Wirsbo PEX®  
X- 1/2" Crimp PEX  
FX- 3/4" Crimp PEX  
FW- 3/4" Wirsbo PEX®

**Length**  
CC- Close Coupled  
04- 4" Insertion  
06- 6" Insertion  
08- 8" Insertion  
10- 10" Insertion  
12- 12" Insertion  
14- 14" Insertion  
16- 16" Insertion  
18- 18" Insertion  
20- 20" Insertion  
22- 22" Insertion  
24- 24" Insertion  
XX- Special Size

Replacement Parts

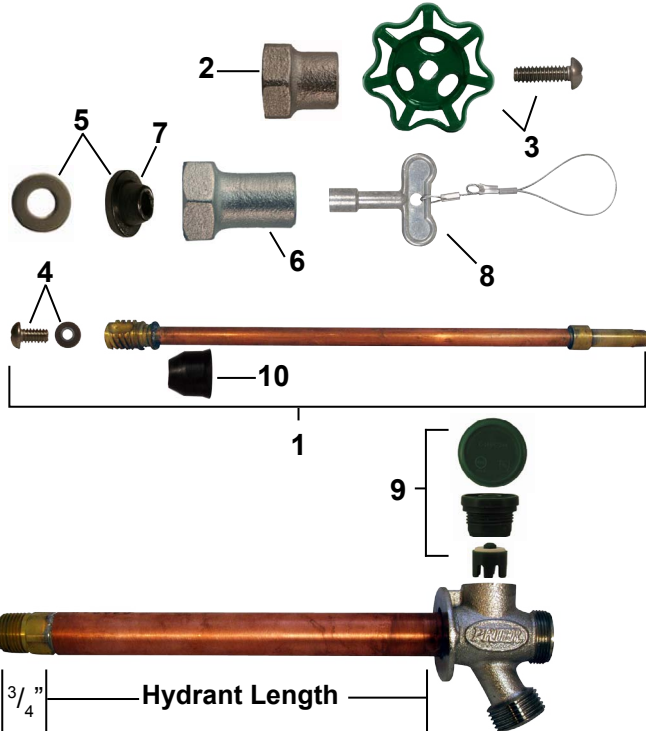

ID	Part No.	Description
1	See Below	Stem Assembly, Contains: 1, 4, 10
2	300-1008	Valve Stem Cap
3	C-134KT-805	Oval Handle and Screw Kit
4	C-134KT-802	Seat Washer Replacement Kit (00 Beveled)
5	C-134KT-803	Stem Packing Replacement Kit
6	310-1015	Valve Stem Cap for Loose Key
7	390-1001	Stem Packing Only
8	C-108KT-808	Oval Style Key on Lanyard
9	C-144KT-806	Vacuum Breaker Replacement Kit
10	336-0002	Backflow Check Valve for C-144
	C-134KT-804	Loose Key Conversion Kit Contains: 5,6,8
	C-144KT-807	C-144 Overhaul Kit Contains: 3, 4, 5, 9, 10

Replacement Stems



G Style Manufactured April 2013 - Present

Part No.	Style	Description	Stem Length
P-231-12CC	G	Close Coupled Stem for C-144 Hydrant	4 3/8" OAL
P-231-1204	G	Stem for 4" C-144 Hydrant	6 7/8" OAL
P-231-1206	G	Stem for 6" C-144 Hydrant	8 7/8" OAL
P-231-1208	G	Stem for 8" C-144 Hydrant	10 7/8" OAL
P-231-1210	G	Stem for 10" C-144 Hydrant	12 7/8" OAL
P-231-1212	G	Stem for 12" C-144 Hydrant	14 7/8" OAL
P-231-1214	G	Stem for 14" C-144 Hydrant	16 7/8" OAL
P-231-1216	G	Stem for 16" C-144 Hydrant	18 7/8" OAL
P-231-1218	G	Stem for 18" C-144 Hydrant	20 7/8" OAL
P-231-1220	G	Stem for 20" C-144 Hydrant	22 7/8" OAL
P-231-1222	G	Stem for 22" C-144 Hydrant	24 7/8" OAL
P-231-1224	G	Stem for 24" C-144 Hydrant	26 7/8" OAL
P-231-12US	G	*Universal Replacement Stem for C-144 Hydrant	Up to 16 7/8" OAL

\*\*For the **old style C-144 Series** wall hydrant stems, see C-144 Series retired style spec sheet at [www.PRIER.com](http://www.PRIER.com). PRIER universal stems are replacement stems for any size from close coupled to 14." They require cutting the rod to proper length and soldering the brass stem end to the rod as directed in instructions.



4515 East 139th Street  
Grandview, MO 64030  
(800) 362-9055  
Fax (800) 362-1463  
www.PRIER.com



4515 East 139th Street  
Grandview, MO 64030  
(800) 362-9055  
Fax (800) 362-1463  
www.PRIER.com

Application

# P-164/264 Series Freezeless Wall Hydrant

## Quarter Turn with Soft Grip Handle

P-264 Loose Key Design



- Residential
- Freezeless
- Anti-Siphon
- Backflow Check Valve



PRIER P-164 provides a year round source of water to areas of structures that are subject to freezing temperatures. The hydrant valve is connected to the supply piping in the heated portion of the structure, eliminating the possibility of freezing. The P-164 has the added benefit of an easy operation quarter turn that features a proven compression type seal. Additionally, the P-164 features a soft grip operating handle for easy operation in wet conditions and cold weather.

Ordering the P-264 gives you the same style hydrant but with a vandal proof extended lockshield and operating key. It is available from stock in lengths from close coupled to 24", longer sizes are available on request.

Features

- ASSE 1019 and C-UPC approved
- Quarter-turn soft-grip coated cast aluminum handle
- Anti-siphon vacuum breaker with backflow check valve
- Integral cast flange with built-in drainage pitch
- Enclosed screw holes easily secure mounting screws
- Solid brass body, valve stem cap, seat and stem ends
- Satin nickel plated body maintains attractive finish
- Stainless steel seat washer screw and handle screw
- Durable ACME threads secure stem at seat end
- Lock shield cap for stronger valve design
- AFG teflon with graphite packing for easy maintenance
- Standard "OO" size seat washer
- Spout aligning mark
- Slim seat inlet for easier installation

Ordering

P-164D10

Operator  
1- Handle Operated  
2- Vandal Proof Lockshield

Inlet  
D- 1/2" MPT x 1/2" SWT  
F- 3/4" MPT x 1/4" SWT  
S- 1/2" SWT x 3/4" Push-On  
T- 3/4" MIP x 1/2" FIP  
W- 1/2" Wirsbo PEX®  
X- 1/2" Crimp PEX  
FX- 3/4" Crimp PEX  
FW- 3/4" Wirsbo PEX®

Length  
CC- Close Coupled  
04- 4" Insertion  
06- 6" Insertion  
08- 8" Insertion  
10- 10" Insertion  
12- 12" Insertion  
14- 14" Insertion  
16- 16" Insertion  
18- 18" Insertion  
20- 20" Insertion  
22- 22" Insertion  
24- 24" Insertion  
XX- Special Size

## Inlet Styles



Replacement Parts

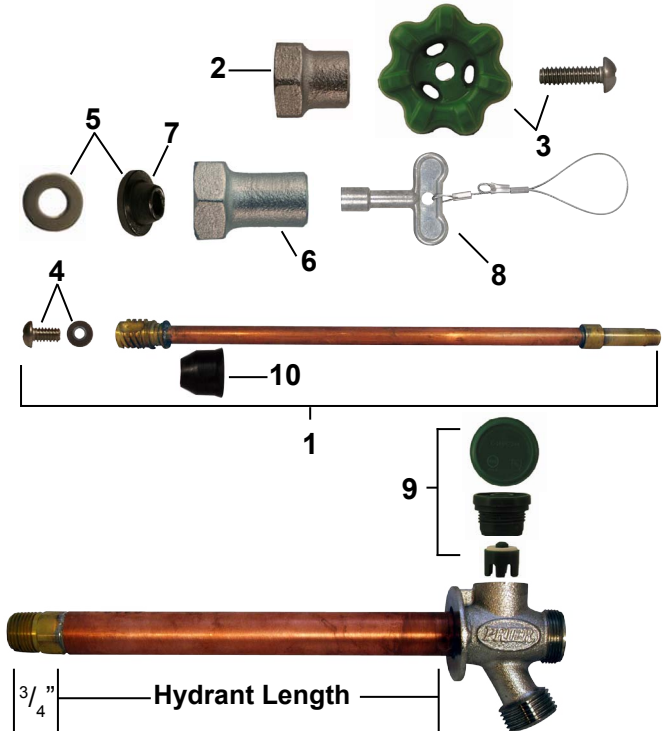

ID	Part No.	Description
1	See Below	Stem Assembly, Contains: 1, 4, 10
2	300-1008	Valve Stem Cap
3	P-164KT-805	Oval Handle and Screw Kit
4	C-134KT-802	Seat Washer Replacement Kit (00 Beveled)
5	C-134KT-803	Stem Packing Replacement Kit
6	310-1015	Valve Stem Cap for Loose Key
7	390-1001	Stem Packing Only
8	C-108KT-808	Oval Style Key on Lanyard
9	C-144KT-806	Vacuum Breaker Replacement Kit
10	336-0002	Backflow Check Valve for P-164
	C-134KT-804	Loose Key Conversion Kit Contains: 5,6,8
	P-164KT-807	P-164 Overhaul Kit Contains: 3, 4, 5, 9, 10

Replacement Stems



H Style Manufactured April 2013 - Present

Part No.	Style	Description	Stem Length
P-231-15CC	H	Close Coupled Stem for P-164 Hydrant	4 1/2" OAL
P-231-1504	H	Stem for 4" P-164 Hydrant	7" OAL
P-231-1506	H	Stem for 6" P-164 Hydrant	9" OAL
P-231-1508	H	Stem for 8" P-164 Hydrant	11" OAL
P-231-1510	H	Stem for 10" P-164 Hydrant	13" OAL
P-231-1512	H	Stem for 12" P-164 Hydrant	15" OAL
P-231-1514	H	Stem for 14" P-164 Hydrant	17" OAL
P-231-1516	H	Stem for 16" P-164 Hydrant	19" OAL
P-231-1518	H	Stem for 18" P-164 Hydrant	21" OAL
P-231-1520	H	Stem for 20" P-164 Hydrant	23" OAL
P-231-1522	H	Stem for 22" P-164 Hydrant	25" OAL
P-231-1524	H	Stem for 24" P-164 Hydrant	27" OAL
P-231-15US	H	*Universal Replacement Stem for P-164 Hydrant	Up to 17" OAL

\*\*For the **old style P-164 Series** wall hydrant stems, see P-164 Series retired style spec sheet at [www.PRIER.com](http://www.PRIER.com). PRIER universal stems are replacement stems for any size from close coupled to 14." They require cutting the rod to proper length and soldering the brass stem end to the rod as directed in instructions.





4515 East 139th Street  
Grandview, MO 64030  
(800) 362-9055  
Fax (800) 362-1463  
www.PRIER.com



4515 East 139th Street  
Grandview, MO 64030  
(800) 362-9055  
Fax (800) 362-1463  
www.PRIER.com

## Application

# C-108/208 Hot & Cold Wall Hydrant

## Vertical or Horizontal Installation

### C-208 Loose Key Design

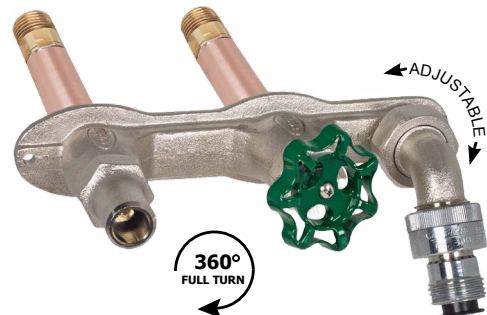

- Residential
- Freezeless
- Anti-Siphon
- Hot & Cold Mixing



PRIER C-108 provides a year round source of tempered water to areas of structures that are subject to freezing temperatures. The hydrant valve is connected to the supply piping in the heated portion of the structure, eliminating the possibility of freezing. The hot side is loose key operated to prevent unauthorized operation. Unique to its patented design, the same product is available as horizontal or vertical. Ordering the C-208 gives you the same style hydrant but with vandal proof extended lockshields with operating key on both hot and cold stems.

The PRIER C-108 has all the characteristics of the historically proven C-134 with the added protection of a self-draining anti-siphon vacuum breaker and backflow check valve. It is available from stock in lengths from close coupled to 24", longer sizes are available on request.

## Features

- Horizontal or vertical installation with same product
- Anti-siphon vacuum breaker with backflow check valve
- Internal checks to prevent thermal migration
- 3 1/2" center-to-center installation template provided
- Enclosed screw holes easily secure mounting screws
- Solid brass body, valve stem cap, seat and stem Ends
- Satin nickel plated body maintains attractive finish
- Stainless steel seat washer screw and handle screw
- Durable ACME threads secure stem at seat end
- Lock shield cap for stronger valve design
- AFG teflon with graphite packing for easy maintenance
- Standard "OO" size seat washer
- Spout aligning mark

## Ordering

### C-108D10

#### Operator

1- Handle Operated

2- Vandal Proof Lockshield

#### Inlet

D- 1/2" MPT x 1/2" SWT

F- 3/4" MPT x 3/4" SWT

S- 1/2" SWT x 3/4" Push-On

T- 3/4" MIP x 1/2" FIP

W- 1/2" Wirsbo PEX®

X- 1/2" Crimp PEX

FX- 3/4" Crimp PEX

FW- 3/4" Wirsbo PEX®

#### Length

CC- Close Coupled

04- 4" Insertion

06- 6" Insertion

08- 8" Insertion

10- 10" Insertion

12- 12" Insertion

14- 14" Insertion

16- 16" Insertion

18- 18" Insertion

20- 20" Insertion

22- 22" Insertion

24- 24" Insertion

XX- Special Size

## Inlet Styles



**D Style**  
1/2" MIP x 1/2" SWT



**S Style**  
1/2" SWT x 3/4" Push-On



**X Style**  
1/2" Crimp PEX

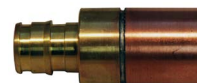

**W Style**  
1/2" Wirsbo® PEX



**T Style**  
3/4" MIP x 1/2" FIP



**F Style**  
3/4" MIP x 3/4" SWT



**FX Style**  
3/4" Crimp PEX



**FW Style**  
3/4" Wirsbo® PEX

## Replacement Parts

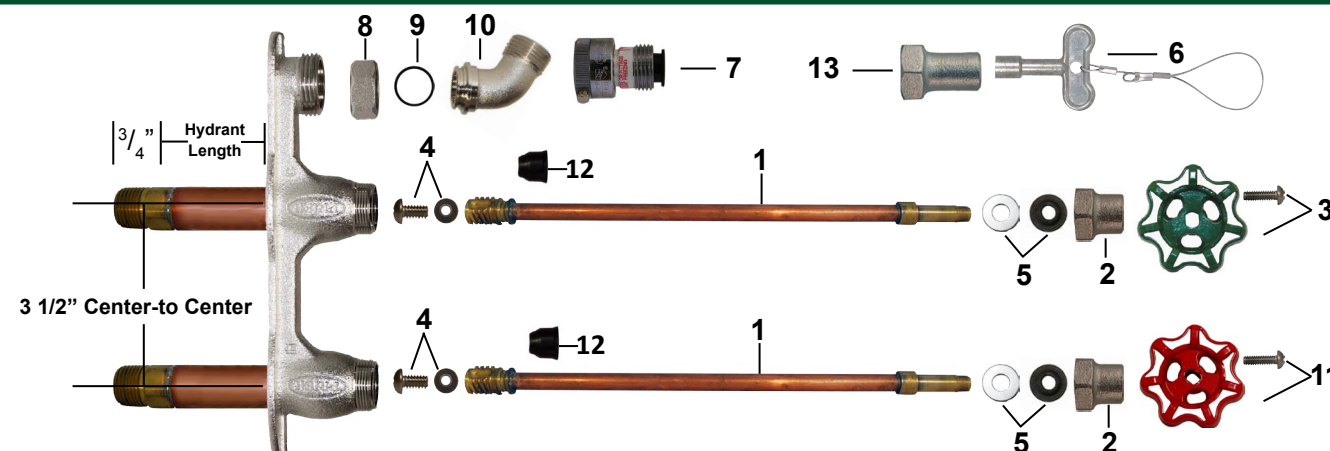

ID	Part No.	Description	ID	Part No.	Description
1	See Below	Stem Assembly, Contains: 1, 4, 12	8	300-0030	Hose Thread Nut
2	300-1008	Valve Stem Cap	9	336-0005	O-Ring for Hose Thread Adapter
3	C-134KT-805	Oval Handle and Screw Kit	10	300-0029	Hose Thread Adapter
4	C-134KT-802	Seat Washer Kit (00 Beveled)	11	C-108KT-805	Red Handle and Screw Kit
5	C-134KT-803	Stem Packing Kit	12	336-0002	Backflow Check Valve for C-108
6	C-108KT-808	Loose Key on Lanyard	13	310-1015	Loose Key Valve Stem Cap
7	P-003CP	Replacement Vacuum Breaker		C-134KT-804	Loose Key Conversion Kit, Contains: 5, 6, 13

## Replacement Stems



**G Style Manufactured April 2013 - Present**

Part No.	Style	Description	Stem Length
P-231-12CC	G	Close Coupled Stem for C-108 Hydrant	4 3/8" OAL
P-231-1204	G	Stem for 4" C-108 Hydrant	6 7/8" OAL
P-231-1206	G	Stem for 6" C-108 Hydrant	8 7/8" OAL
P-231-1208	G	Stem for 8" C-108 Hydrant	10 7/8" OAL
P-231-1210	G	Stem for 10" C-108 Hydrant	12 7/8" OAL
P-231-1212	G	Stem for 12" C-108 Hydrant	14 7/8" OAL
P-231-1214	G	Stem for 14" C-108 Hydrant	16 7/8" OAL
P-231-1216	G	Stem for 16" C-108 Hydrant	18 7/8" OAL
P-231-1218	G	Stem for 18" C-108 Hydrant	20 7/8" OAL
P-231-1220	G	Stem for 20" C-108 Hydrant	22 7/8" OAL
P-231-1222	G	Stem for 22" C-108 Hydrant	24 7/8" OAL
P-231-1224	G	Stem for 24" C-108 Hydrant	26 7/8" OAL
P-231-12US	G	*Universal Replacement Stem for C-108 Hydrant	Up to 16 7/8" OAL

**\*\*For the old style C-108 Series wall hydrant stems, see C-108 Series retired style spec sheet at www.PRIER.com. PRIER universal stems are replacement stems for any size from close coupled to 14." They require cutting the rod to proper length and soldering the brass stem end to the rod as directed in instructions.**





4515 East 139th Street  
Grandview, MO 64030  
(800) 362-9055  
Fax (800) 362-1463  
www.PRIER.com



4515 East 139th Street  
Grandview, MO 64030  
(800) 362-9055  
Fax (800) 362-1463  
www.PRIER.com

Application

# C-434 Heavy Residential Wall Hydrant

With Integral P-004 Vacuum Breaker



- Residential
- Freezeless
- Anti-Siphon
- Double Check Valve



PRIER C-434 provides a year round source of water to areas of structures that are subject to freezing temperatures. The hydrant valve is connected to the supply piping in the heated portion of the structure, eliminating the possibility of freezing. To assure freeze protection, the hydrant will drain even with the hose attached and under pressure without sprayback!

The C-434 combines freezeless hydrant features with self-draining, anti-siphon and two backflow check valves! The vacuum breaker/backflow preventer provides protection against cross-connection of the potable water supply, while venting to eliminate any vacuum. Upon closure, valve drains even with closed end hose attached. No special installation tools are required.

Features

- ASSE 1052 and C-UPC approved
- Double check valve and anti-siphon vacuum breaker
- Drains automatically with hose attached
- Integral cast flange with built-in drainage pitch
- Solid brass body, valve stem cap, seat and stem ends
- Satin nickel plated body, cap and vacuum breaker
- Durable ACME threads secure stem at seat end
- Compact and powder coated cast aluminum handle
- Metal collar covers drainage holes and protects against insect nesting while closing under pressure
- Multiple vent holes ensure proper draining
- Cycle tested to simulate 25 years minimum service
- Patent protected

## Inlet Styles



## Materials

**Brass** Body, Stem Ends (2), Seat, Valve Stem Cap  
**Hard Copper** Operating Stem, Shaft  
**EPDM** Drain Seal O-Ring, Triple Seal Stopper, Packing  
**Silicone** Vacuum Breaker Washer  
**Acetal** Vacuum Breaker Check Spider  
**Stainless Steel** Handle Screw and Seat Pin  
**Aluminum** Operating Handle

Ordering

C-434D10

**Inlet**  
D- 1/2" MPT x 1/2" SWT  
F- 3/4" MPT x 3/4" SWT  
T- 3/4" MIP x 1/2" FIP  
W- 1/2" Wirsbo PEX®  
X- 1/2" Crimp PEX

**Length**  
CC- Close Coupled  
04- 4" Insertion  
06- 6" Insertion  
08- 8" Insertion  
10- 10" Insertion  
12- 12" Insertion  
14- 14" Insertion  
16- 16" Insertion  
18- 18" Insertion  
20- 20" Insertion  
22- 22" Insertion  
24- 24" Insertion  
XX- Special Size

Replacement Parts

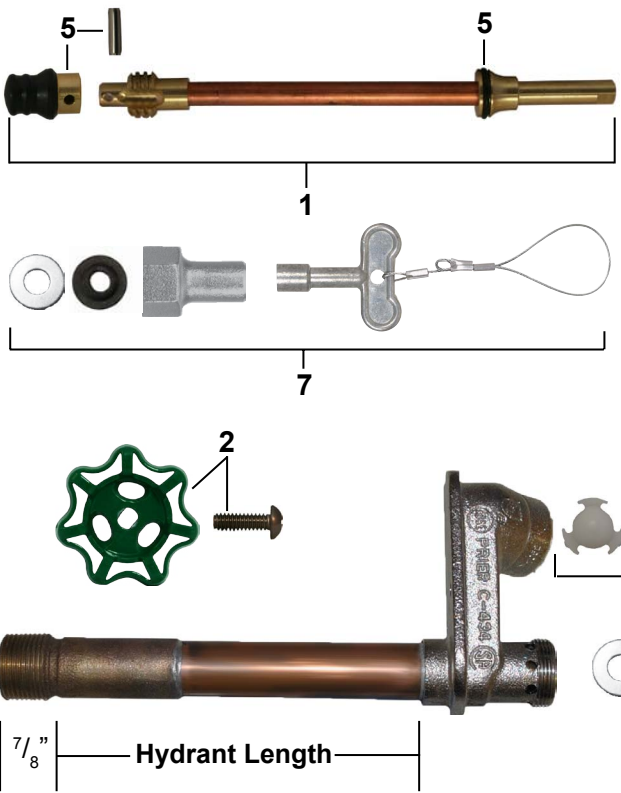

ID	Part No.	Description
1	See Below	Stem Assembly, Contains: 1, 5
2	C-134KT-805	Operating Handle and Screw Kit
3	C-434KT-903	Stem Packing and Washer Kit
4	C-434KT-906	Vacuum Breaker Repair Kit
5	C-434KT-902	Stopper and Pin Kit (with tool and o-ring)
6	300-1011	Valve Stem Cap for C-434
7	C-434KT-804	Loose Key Conversion Kit to C-534
	C-434KT-907	Overhaul Kit for C-434 Contains: 2, 3, 4, 5

Replacement Stems



Part No.	Description	Stem Length
P-231-04CC	Close Coupled Stem for C-434/C-534 Hydrant	3 7/8" OAL
P-231-0404	Stem for 4" C-434/C-534 Hydrant	6 3/4" OAL
P-231-0406	Stem for 6" C-434/C-534 Hydrant	8 3/4" OAL
P-231-0408	Stem for 8" C-434/C-534 Hydrant	10 3/4" OAL
P-231-0410	Stem for 10" C-434/C-534 Hydrant	12 3/4" OAL
P-231-0412	Stem for 12" C-434/C-534 Hydrant	14 3/4" OAL
P-231-0414	Stem for 14" C-434/C-534 Hydrant	16 3/4" OAL
P-231-0416	Stem for 16" C-434/C-534 Hydrant	18 3/4" OAL
P-231-0418	Stem for 18" C-434/C-534 Hydrant	20 3/4" OAL
P-231-0420	Stem for 20" C-434/C-534 Hydrant	22 3/4" OAL
P-231-0422	Stem for 22" C-434/C-534 Hydrant	24 3/4" OAL
P-231-0424	Stem for 24" C-434/C-534 Hydrant	26 3/4" OAL

\*\*For the old style C-434 Series wall hydrant stems, see C-434 Series retired style spec sheet at www.PRIER.com.

Page 23

C-534 Light Duty Commercial Wall Hydrant

Page 25

C-633 Mild Climate Commercial Wall Hydrant

Page 27

C-634 Heavy Duty Commercial Wall Hydrant

Page 29

C-734 Heavy Commercial Mixing Hydrant

Page 31

P-RH1 Flush Mount Roof Hydrant

Page 33

P-RH2 Post Mount Roof Hydrant

Page 35

P-RH3 Mild Climate Roof Hydrant

Page 37

P-RMB Universal Mounting Bracket

COMMERCIAL

HYDRANTS

Application

C-534 Commercial Wall Hydrant

With Integral P-004 Vacuum Breaker



- Commercial
- Freezeless
- Anti-Siphon
- Double Check Valve



PRIER C-534 provides a year round source of water to areas of structures that are subject to freezing temperatures. The hydrant valve is connected to the supply piping in the heated portion of the structure, eliminating the possibility of freezing. To assure freeze protection, the hydrant will drain even with the hose attached and under pressure without sprayback!

The C-534 combines freezeless hydrant features with self-draining, anti-siphon and two backflow check valves! The vacuum breaker/backflow presenter provides protection against cross-connection of the potable water supply, while venting to eliminate any vacuum. The C-534 has an extended vandal proof lockshield with loose key. Upon closure, valve drains even with closed end hose attached. No special installation tools are required.

Features

- ASSE 1052 and C-UPC approved
- Double check valve and anti-siphon vacuum breaker
- Drains automatically with hose attached
- Integral cast flange with built-in drainage pitch
- Solid brass body, valve stem cap, seat and stem ends
- Satin nickel plated body, cap and vacuum breaker
- Durable ACME threads secure stem at seat end
- Compact and powder coated cast aluminum handle
- Metal collar covers drainage holes and protects against insect nesting while closing under pressure
- Multiple vent holes ensure proper draining
- Cycle tested to simulate 25 years minimum service
- Patent protected

Inlet Styles

- D Style**  
1/2" MIP x 1/2" SWT
- F Style**  
3/4" MIP x 3/4" SWT
- T Style**  
3/4" MIP x 1/2" FIP
- X Style**  
1/2" Crimp PEX

Ordering

C-534D10

- Inlet

D- 1/2" MPT x 1/2" SWT  
F- 3/4" MPT x 3/4" SWT  
T- 3/4" MIP x 1/2" FIP  
X- 1/2" Crimp PEX
- Length

CC- Close Coupled  
04- 4" Insertion  
06- 6" Insertion  
08- 8" Insertion  
10- 10" Insertion  
12- 12" Insertion  
14- 14" Insertion  
16- 16" Insertion  
18- 18" Insertion  
20- 20" Insertion  
22- 22" Insertion  
24- 24" Insertion  
XX- Special Size

Materials

- Brass

Hard Copper

EPDM

Silicone

Acetal

Stainless Steel

Aluminum
- Body, Stem Ends (2), Seat, Valve Stem Cap  
Operating Stem, Shaft  
Drain Seal O-Ring, Triple Seal Stopper, Packing  
Vacuum Breaker Washer  
Vacuum Breaker Check Spider  
Seat Pin  
Loose Key





4515 East 139th Street  
Grandview, MO 64030  
(800) 362-9055  
Fax (800) 362-1463  
www.PRIER.com

Replacement Parts & Stems

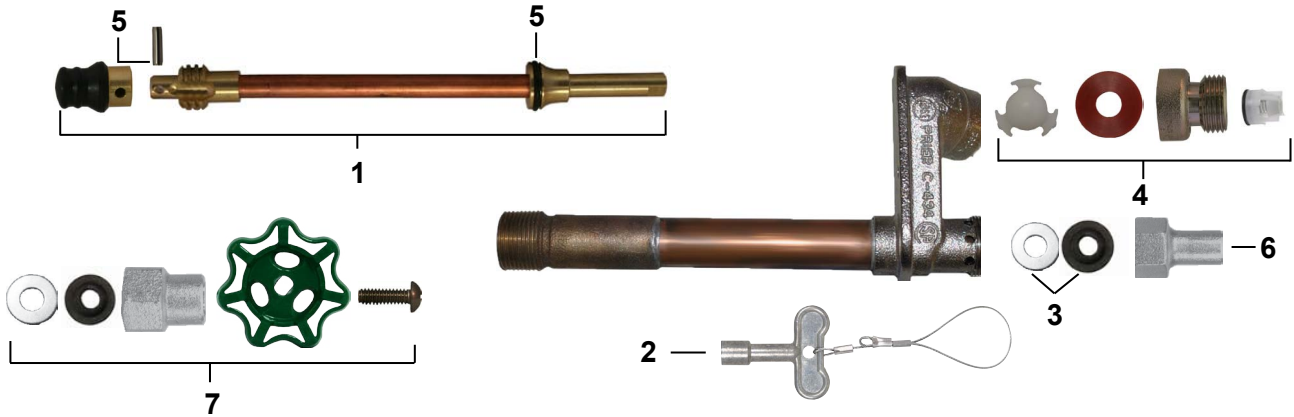

ID	Part No.	Description	ID	Part No.	Description
1	See Below	Stem Assembly, Contains: 1, 5		P-231-0420	Stem for 20" C-434/C-534 Hydrant, 22 3/4" OAL
	P-231-04CC	Stem for CC C-434/C-534 Hydrant, 3 7/8" OAL		P-231-0422	Stem for 22" C-434/C-534 Hydrant, 24 3/4" OAL
	P-231-0404	Stem for 4" C-434/C-534 Hydrant, 6 3/4" OAL		P-231-0424	Stem for 24" C-434/C-534 Hydrant, 26 3/4" OAL
	P-231-0406	Stem for 6" C-434/C-534 Hydrant, 8 3/4" OAL	2	C-108KT-808	Loose Key on Lanyard
	P-231-0408	Stem for 8" C-434/C-534 Hydrant, 10 3/4" OAL	3	C-434KT-903	Stem Packing and Washer Kit
	P-231-0410	Stem for 10" C-434/C-534 Hydrant, 12 3/4" OAL	4	C-434KT-906	Vacuum Breaker Repair Kit
	P-231-0412	Stem for 12" C-434/C-534 Hydrant, 14 3/4" OAL	5	C-434KT-902	Stopper and Pin Kit (with tool and o-ring)
	P-231-0414	Stem for 14" C-434/C-534 Hydrant, 16 3/4" OAL	6	300-1021	Valve Stem Cap for C-534
	P-231-0416	Stem for 16" C-434/C-534 Hydrant, 18 3/4" OAL	7	C-534KT-804	Handle Conversion Kit to C-434
	P-231-0418	Stem for 18" C-434/C-534 Hydrant, 20 3/4" OAL		C-534KT-907	Overhaul Kit for C-534, Contains: 2, 3, 4, 5, 6

\*\*For the **old style C-534 Series** wall hydrant stems, see C-534 Series retired style spec sheet at [www.PRIER.com](http://www.PRIER.com).

Rough-In Dimensions Specs

Cross Section Top View

Front Face Plate View

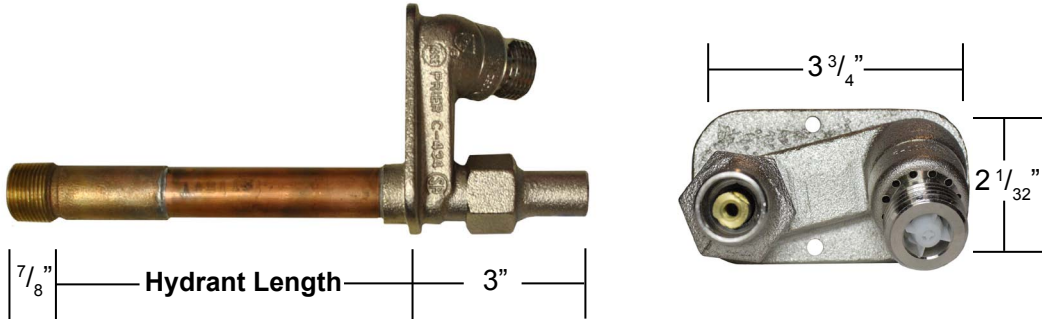

Furnish and install Freezeless Model C-534 Commercial Wall Hydrant as manufactured by PRIER Products, Inc. Hydrant shall have automatic draining capabilities with integral ASSE 1052 approved double check vacuum breaker/backflow preventor. Hydrant shall have 3/4" hose connection with freezeless water flow and self-draining functions. After hydrant is turned in the "off" position, hydrant must be capable of draining even with the hose attached and under pressure without sprayback. Hydrant shall be constructed of all non-ferrous materials with EPDM sealing mechanisms. Hydrant body must be satin nickel plated. For stability of operation, hydrant stem shall be secured at the seat end with ACME type threads and at the handle end with the packing nut. Lockshield must be long enough to ensure operation only with the included operating key.

Hydrant must be installed through a 1 1/8" diameter hole without any custom brick cutting. Hydrant body shall incorporate proper drainage pitch to ensure proper drainage. Operating Key is to be furnished with each hydrant. Hydrant insertion length to be 2 inches. \*Close coupled to 24" in 2" increments.



4515 East 139th Street  
Grandview, MO 64030  
(800) 362-9055  
Fax (800) 362-1463  
www.PRIER.com

Application

## C-633 Mild Climate Commercial Wall Hydrant

With Integral P-004 Vacuum Breaker



C-633NSV  
360° Swivel Inlet



C-633NCC  
Straight Pattern Inlet

- Commercial/Industrial
- Anti-Siphon
- Backflow Check Valve



The C-633 Series is a heavy duty wall hydrant designed for installation in mild climates. The C-633NSV has a versatile 360° swivel, while the C-633NCC has a straight brass pipe connection. Both models have inlets that will connect to either 3/4" MPT or 1" FPT pipe in tight spaces. These commercial wall hydrants are key operated, code approved, flow up to 19 GPM and have a box option that will allow for installation inside a 6" wall. The PRIER C-633 Mild Climate Wall Hydrants provide a year-round hose threaded source of water for structures. The C-633 has two options; one that includes a 360° swivel that allows a simple piping orientation inside a narrow wall. The other, is a close-coupled design for straight supply piping applications.

The ASSE 1052-approved integral vacuum breaker/backflow preventer provides protection against cross-connection with the potable water system, utilizing a check valve to prevent back pressure and a vacuum breaker to vent in the case of siphonage. A removable operating key is provided to prevent unauthorized usage of the hydrant.

Features

- High flow rate, 19 gallons per minute at 25 PSI differential
- Heavy patterned, high quality brass castings
- Self-draining, even with hose attached and under pressure
- Tested to 250,000 cycles; designed to last the life of the plumbing system
- EPDM stopper with "triple seal" positive shutoff system for drip-free shutoff
- Satin nickel plated body retains original finish for years
- Can be installed in horizontal or vertical position
- Self-cleaning spring less backflow check valve prevents water hammer and system noise
- Drainage ports are large enough to drain valve, and small enough to prevent insect nesting
- Listed and labeled to ASSE 1019-B or ASSE 1052, IAPMO/C-UPC

Ordering

### Wall Hydrant Only C-633NCC

Inlet  
N- 1" MPT x 3/4" FPT  
P- 1" Male SWT x 3/4" Female SWT  
V- 3/4" ProPress Ready  
\*P and V inlets only available with CC length

Length  
CC- Close Coupled  
SV- 360° Swivel



### Optional Hydrant Box C-634BX1

Box Finish  
1- Satin Nickel Plated  
2- Rough Brass







4515 East 139th Street  
Grandview, MO 64030  
(800) 362-9055  
Fax (800) 362-1463  
www.PRIER.com



4515 East 139th Street  
Grandview, MO 64030  
(800) 362-9055  
Fax (800) 362-1463  
www.PRIER.com

Replacement Parts & Stems

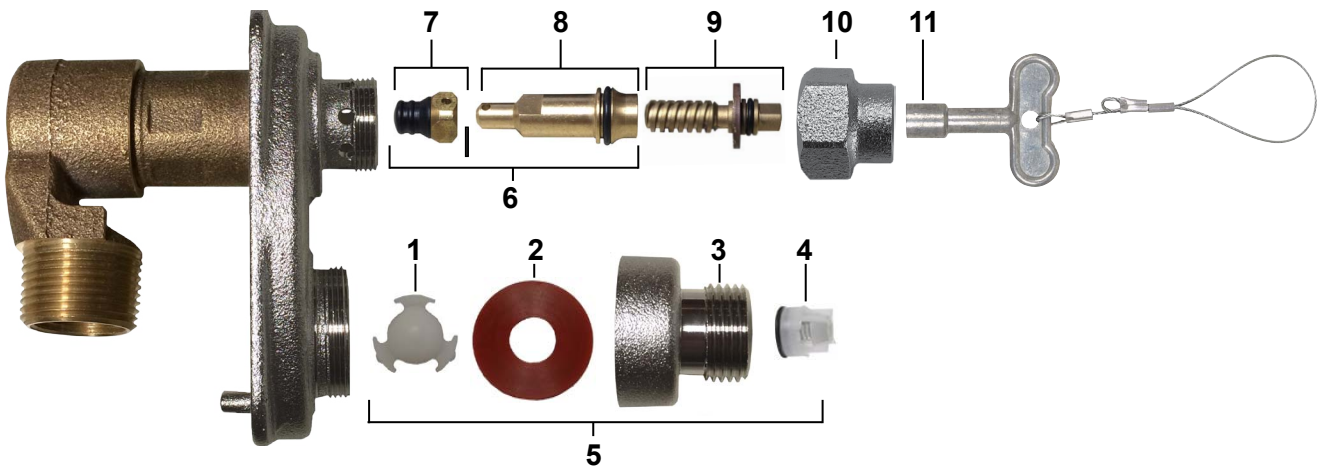

ID	Part No.	Description	ID	Part No.	Description
1	337-6001	Check Spider-Vacuum Breaker	7	C-634KT-802	Stopper Kit, Includes Stopper and Pin
2	346-6001	Diaphragm-Vacuum Breaker	8	C-633KT-809	Worm Sleeve with O-Ring
3	300-6004	3/4" Hose Piece (NP Brass)	9	C-634KT-809	Worm Drive Assembly with O-Ring
	310-6009	1" Hose Piece (NP Brass)	10	300-6003	Valve Stem Cap (NP Brass)
4	399-0001	Secondary Check	11	C-108KT-808	Loose Key on Lanyard
5	C-634KT-806	Vacuum Breaker Assembly		C-633KT-807	C-633 Overhaul Kit, Contains: 5, 6, 7, 11
6	231-06CC	Stem Assembly			

Rough-In Dimensions  
Specs

C-633NSV (360° Swivel)

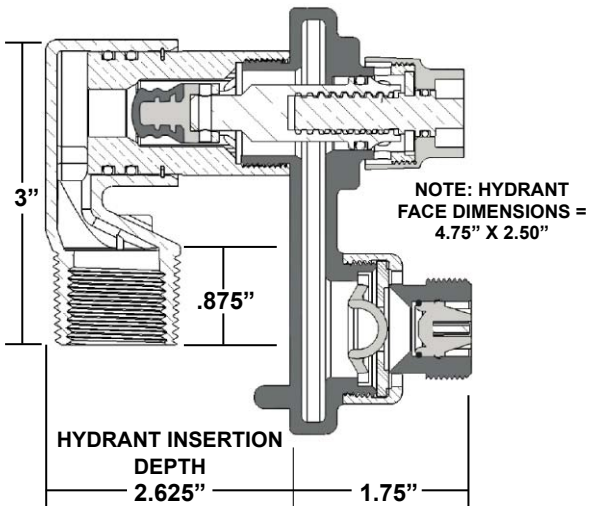

C-633NCC (Straight)

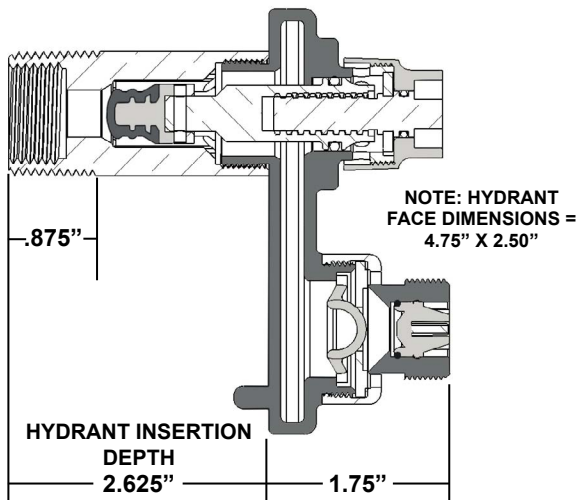

Furnish and install (choose C-633NSV Model or C-633NCC Model) commercial key operated wall hydrant manufactured by PRIER Products, Inc. Hydrant shall be surface mounted and shall have automatic draining capabilities with integral vacuum breaker/backflow preventer. Hydrant shall be capable of flowing a minimum of 15 gallons per minute at 25 PSI pressure change. Hydrant shaft shall be brass with threaded and sealed connections. Hydrant shall have (choose 3/4" or 1") hose connection with self draining functions, one piece valve plunger, satin nickel finish, brass operating rod with positive triple-seal shutoff mechanism. Hydrant shall be approved under ASSE 1019-B or ASSE 1052 (choose option) standards. Operating key with lanyard to be furnished with each hydrant. Hydrant insertion to be specified as C-633NCC (straight with 3/4" FPT x 1" MPT connections), C-633PCC (straight with 3/4" x 1" sweat connections), C-633VCC (straight with 3/4" press-ready connection) or C-633NSV (90° elbow swivel with 3/4" FPT x 1" MPT connections).

Optional: Furnish and install hydrant box for each hydrant. Hydrant box shall be manufactured in solid cast brass with a (choose from natural brass or satin-nickel plated brass) finish. Access to the hydrant box shall be provided by (choose hydrant's key or cylinder lock and key).

Application

## C-634 Heavy Commercial Wall Hydrant

With Integral P-004 Vacuum Breaker



- Commercial/Industrial
- Freezeless
- Anti-Siphon
- Backflow Check Valve



PRIER C-634 provides a year round source of water to areas of structures that are subject to freezing temperatures. The hydrant valve is connected to the supply piping in the heated portion of the structure, eliminating the possibility of freezing. To assure freeze protection, the hydrant will drain even with the hose attached and under pressure.

The integral vacuum breaker/backflow preventor provides protection against cross-connection with the potable water system, utilizing a check valve to prevent back pressure and a vacuum breaker to vent in the case of siphonage. A removable operating key is provided to prevent unauthorized usage of the hydrant. No special installation tools are required.

Features

- High flow rate, 19 gallons per minute at 25 PSI differential
- Heavy pattern cast brass hydrant for use with or without brass or satin nickel box
- Satin nickel plated body retains original finish for years
- Heavy duty brass piping, significantly stronger than ordinary copper tubing, with threaded and sealed joints
- Simple, solderless design and solid non-ferrous operating rod for long wear life
- Patented PRIER "triple seal" positive shutoff system offers triple redundancy to assure shutoff
- Patented PRIER quick opening and modulating design require less force and fewer turns to operate
- Both 3/4" & 1" hose threads meet ASSE 1019 or ASSE 1052 & CSA B64.2 standards, listed at ASSE, CSA & IAPMO
- Vacuum breaker operates at lower differential and features self cleaning design to prevent clogging
- Multiple vent holes ensure proper draining and reduce problems associated with insect nesting
- Design enables valve to be easily secured to any type of inner wall, utilizing the provided clamping ring
- Single hole design assists in installation, the product is ideal for tilt-up construction, stone fronts or metal buildings

Ordering

Wall Hydrant Only

C-634N10

Hose Thread Outlet  
4- 3/4" Garden Hose  
6- 1" Hose

Inlet  
N- 1" MPT x 3/4" FPT  
P- 1" Male SWT x 3/4" Female SWT  
V- 3/4" Copper-Press Fitting Ready

Length  
CC- Close Coupled  
04- 4" Insertion  
06- 6" Insertion  
08- 8" Insertion  
10- 10" Insertion  
12- 12" Insertion  
14- 14" Insertion  
16- 16" Insertion  
18- 18" Insertion  
20- 20" Insertion  
22- 22" Insertion  
24- 24" Insertion  
XX- Special Size



Optional Hydrant Box

C-634BX1

Box Finish  
1- Satin Nickel Plated  
2- Rough Brass





4515 East 139th Street  
Grandview, MO 64030  
(800) 362-9055  
Fax (800) 362-1463  
www.PRIER.com

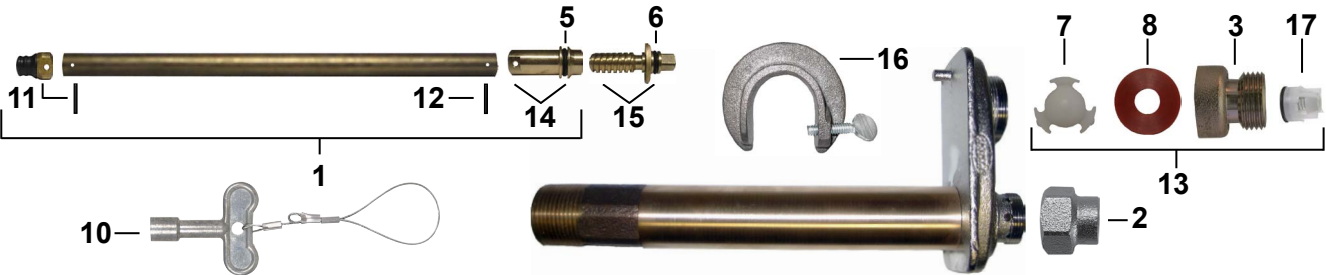

ID	Part No.	Description	ID	Part No.	Description
1	See Below	Stem Assembly, Contains: 5, 13	310-6009	1" Hose Piece for C-636 (NP Brass)	
	P-231-0604	Stem for 4" C-634 Hydrant, 4 11/16" OAL	5	336-0001	O-Ring Worm Sleeve
	P-231-0606	Stem for 6" C-634 Hydrant, 6 11/16" OAL	6	336-6001	O-Ring Worm Drive
	P-231-0608	Stem for 8" C-634 Hydrant, 8 11/16" OAL	7	337-6001	Check Spider-Vacuum Breaker
	P-231-0610	Stem for 10" C-634 Hydrant, 10 11/16" OAL	8	346-6001	Diaphragm-Vacuum Breaker
	P-231-0612	Stem for 12" C-634 Hydrant, 12 11/16" OAL	10	C-108KT-808	Loose Key on Lanyard
	P-231-0614	Stem for 14" C-634 Hydrant, 14 11/16" OAL	11	C-634KT-802	Stopper Kit, Includes Stopper and Pin
	P-231-0616	Stem for 16" C-634 Hydrant, 16 11/16" OAL	12	324-0004	Pin Only
	P-231-0618	Stem for 18" C-634 Hydrant, 18 11/16" OAL	13	C-634KT-806	Vacuum Breaker Assembly
	P-231-0620	Stem for 20" C-634 Hydrant, 20 11/16" OAL	14	C-634KT-808	Worm Sleeve with O-Ring, Pin and Tool
	P-231-0622	Stem for 22" C-634 Hydrant, 22 11/16" OAL	15	C-634KT-809	Worm Drive Assembly with O-Ring
	P-231-0624	Stem for 24" C-634 Hydrant, 24 11/16" OAL	16	C-634WCR	Wall Clamping Ring
2	300-6003	Valve Stem Cap (NP Brass)	17	399-0001	Secondary Check for ASSE 1052
3	300-6004	3/4" Hose Piece (NP Brass)		C-634KT-807	C-634 Overhaul Kit, Contains: 10, 11, 12, 13, 14

**\*\*For the old style C-634 Series wall hydrant stems, see C-634 Series retired style spec sheet at [www.PRIER.com](http://www.PRIER.com).**

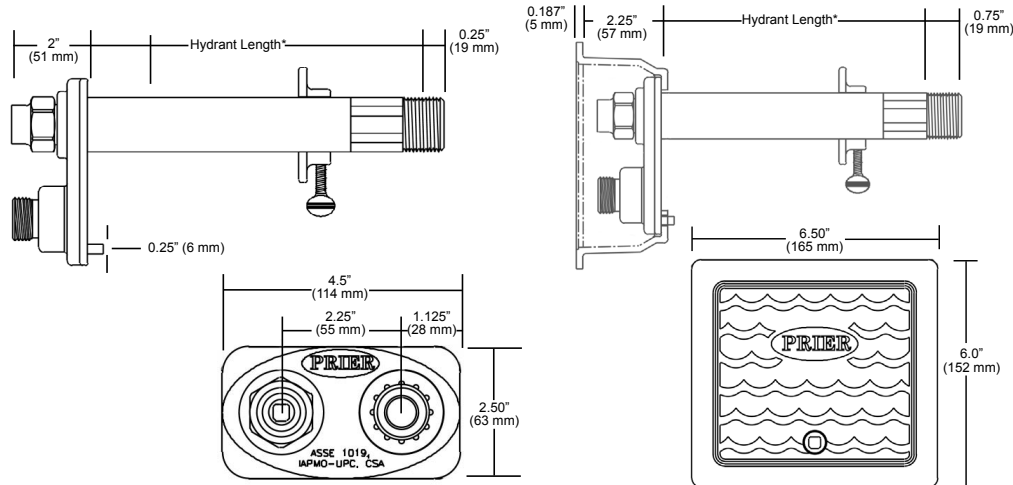

**Inlet Styles**  
**N Style**  
3/4" (19 mm) FPT  
x 1" (25 mm) NPT  
**P Style**  
3/4" (19 mm) Female SWT  
x 1" (25 mm) Male SWT  
**V Style**  
3/4" (19 mm) ProPress Ready

*Standard Hydrant Lengths	
4"	102 mm
6"	152 mm
8"	203 mm
10"	254 mm
12"	305 mm
14"	356 mm
16"	406 mm
18"	457 mm
20"	508 mm
22"	559 mm
24"	607 mm

Furnish and install Model C-634 Heavy Commercial Wall Hydrant manufactured by PRIER Products, Inc. Hydrant shall be surface mount and installed through 1 3/8" round opening. Hydrant shall have automatic draining capabilities with integral vacuum breaker/backflow preventor. Hydrant shall flow 19 gallons per minute minimum at 25 PSI Differential and be at full flow in 2 handle rotations. Hydrant shaft shall be brass with threaded and sealed connections. Hydrant shall have 3/4" or 1" (choose one) hose connection with freezeless water flow and self-draining functions, one piece valve plunger, satin nickel finish, brass operating rod with positive triple seal shutoff mechanism. Hydrant shall be approved under ASSE 1052 standard. Operating key & wall clamping ring to be furnished with each hydrant. Hydrant insertion length to be 1/2 inches.

Optional: Furnish and install flush-mount hydrant box for each valve. Hydrant box shall be manufactured of solid cast brass with a brass or satin nickel plated brass (choose one) finish. Box may be installed separately and hydrant be insertable and removable from front of the box. Access to the hydrant box shall be provided by the same operating key as the valve. \*4" to 24" in 2" increments.



4515 East 139th Street  
Grandview, MO 64030  
(800) 362-9055  
Fax (800) 362-1463  
www.PRIER.com

## C-734/754 Heavy Commercial Mixing Hydrant

### Application



- Commercial/Industrial
- Freezeless
- Hot & Cold Mixing
- ASSE/IAPMO Listed



PRIER C-734 Heavy Commercial Hot & Cold Mixing Hydrant provides a year round source of tempered water to areas of structures that are subject to freezing temperatures. The hydrant valve is connected to the supply piping in the heated portion of the structure, eliminating the possibility of freezing. The Hydrant is available with a self-draining vacuum breaker and backflow check valve (PRIER Model C-754) to protect against any cross contamination possibilities. Common applications include garbage can wash stations at restaurants and service station bay washers.

A removable operating key is provided to prevent unauthorized usage of the hydrant. No special installation tools are required.

### Features

- Heavy pattern standard hydrant for use with or without polished brass or nickel bronze box
- Natural brass finish
- Heavy duty brass piping, stronger than ordinary copper tubing, with threaded and sealed joints
- Simple, solderless design for years of reliable operation
- Solid non-ferrous operating rod for long wear life
- Vacuum breaker and backflow preventor approved under ASSE 1011 and CSA B64.2
- Design enables stable and easy clamping to inner wall, providing secure hold on non-brick surfaces

### Ordering

**Wall Hydrant Only**  
**C-734N10**

**Hose Thread Outlet**  
3- 3/4" Garden Hose  
5- Self-Draining  
Vacuum Breaker

**Inlet**  
N- 1" MPT x 3/4" FPT

**Length**  
04- 4" Insertion  
06- 6" Insertion  
08- 8" Insertion  
10- 10" Insertion  
12- 12" Insertion  
14- 14" Insertion  
16- 16" Insertion  
18- 18" Insertion  
20- 20" Insertion  
22- 22" Insertion  
24- 24" Insertion  
XX- Special Size

**Optional Hydrant Box**  
**C-734BX1**

**Box Finish**  
3- Standard Depth  
5- Deep Box  
for C-754

**Box Finish**  
1- Satin Nickel Plated  
2- Rough Brass





4515 East 139th Street  
Grandview, MO 64030  
(800) 362-9055  
Fax (800) 362-1463  
www.PRIER.com

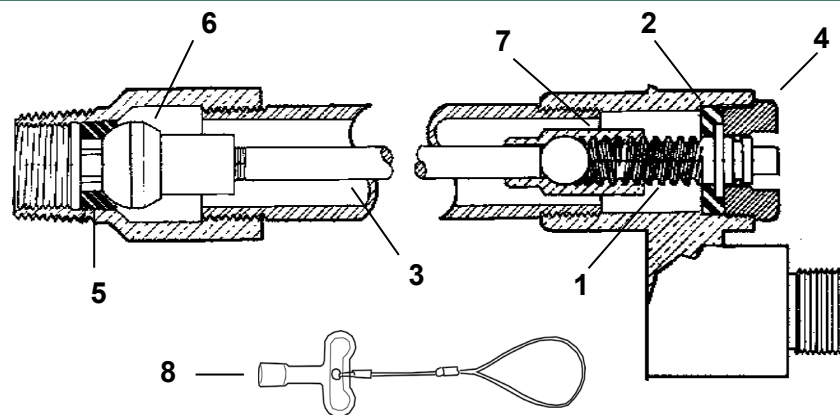

ID	Part No.	Description
1	392-4005	Drive Screw Assembly (Brass)
2	391-4008	Retainer Seal (Nylon)
3	Call PRIER	Operating Rod (Brass)
4	310-4009	Face Nut (Brass)
5	391-2018	Seat (Nylon)
6	392-2020	Plunger (Butyl with Brass Insert)
7	310-4003	Worm Sleeve (Brass)
8	C-108KT-808	Loose Key on Lanyard (Die Cast Aluminum)

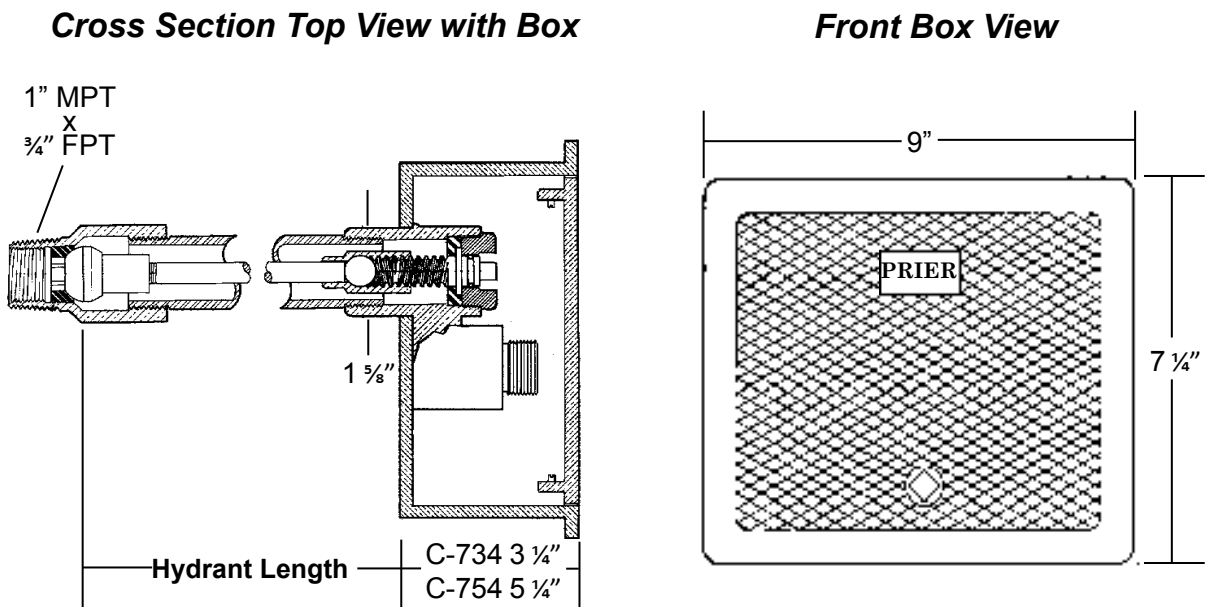

Furnish and install Freezeless Model C-734 (or C-754 with Anti-Siphon Vacuum Breaker and Backflow Check Valve) Commercial Hot & Cold Mixing Hydrant by PRIER. Hydrant shaft shall be brass with threaded and sealed connections. Hydrant shall have 3/4" hose connection with freezeless water flow and self-draining functions with brass operating rod. Hydrant shall be approved under ASSE standards. Two operating keys to be furnished with each hydrant. Hydrant insertion length to be 2 inches.

Optional: Furnish and install water box for each hydrant. Hydrant box shall be manufactured of solid cast brass with a polished brass or polished nickel bronze finish. Access to the water box shall be provided by the same operating key as the freezeless hydrant. \*4" to 24" in 2" increments.



4515 East 139th Street  
Grandview, MO 64030  
(800) 362-9055  
Fax (800) 362-1463  
www.PRIER.com

# P-RH1 Flush Mount Roof Hydrant

With Integral P-004 Vacuum Breaker and Dual Backflow Preventor

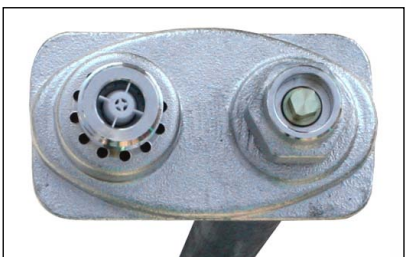

close-up view

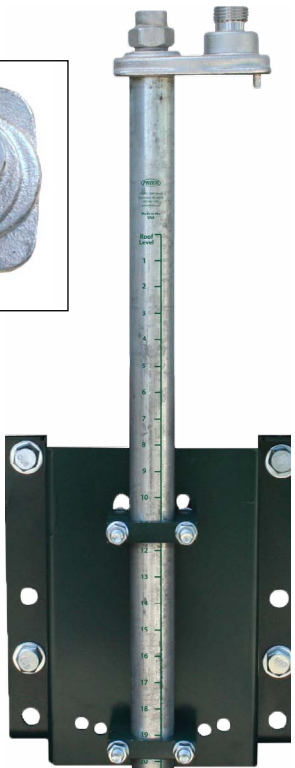

- Commercial/Industrial
- Freezeless
- Anti-Siphon
- Self Draining



PRIER's P-RH1 Flush Mount Roof Hydrant provides a year round source of water to roof surfaces in areas with freezing temperatures. The hydrant is installed flush to the roof, allowing the hose to run in 360°. The hydrant valve is connected to the supply piping in the heated portion of the structure, and is self-draining, eliminating the possibility of freezing. A removable operating key is provided for operation.

The PRIER Roof Mounting Bracket enables the hydrant to be mounted to any structural member with rigid support, instead of to the skin of the building like competitive products.

This bracket requires only a single penetration point of 1 3/4", and can be mounted to concrete, wood, steel, I-beams, truss, perlins or other structural members with standard construction materials (Unistrut, all-thread, etc.).

- Mounts to any roof structural member (truss, I-beam, concrete roof, etc.)
- Single hole penetration of 1 3/4"
- Single person installation with standard tools
- ASSE 1052 approved vacuum breaker
- Freezeless anti-siphon hydrant is flush to the roof allowing hose to run in 360°
- "Triple Seal" positive shut off system for drip-free shut off
- Heavy duty brass construction
- Self draining with 1/8" NPT drainage port
- Repair can be easily accomplished at roof level
- Designed to be installed with standard construction materials (Unistrut, all-thread, etc.)
- 3/4" garden hose threads standard; 1" threads optional
- Includes operating key
- Tremendous flow of 19 gallons per minute at 25 PSI
- Adjustable bracket to accommodate roof angles up to 4/12

## P-RH1

- Length
- H1- Flush Mount Roof Hydrant
  - H2- Post Mount Roof Hydrant
  - H3- Mild Climate Roof Hydrant
  - MB- Roof Hydrant Mounting Bracket







4515 East 139th Street  
Grandview, MO 64030  
(800) 362-9055  
Fax (800) 362-1463  
www.PRIER.com



4515 East 139th Street  
Grandview, MO 64030  
(800) 362-9055  
Fax (800) 362-1463  
www.PRIER.com

Replacement Parts

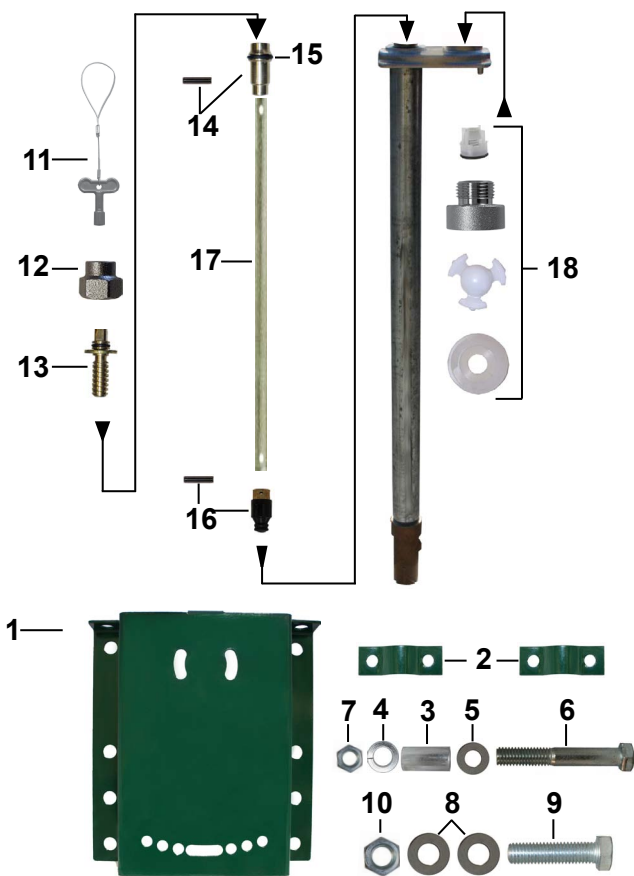

ID	Part No.	Description
1	314-0021	Mounting Bracket
2	314-0022	Pipe Bracket
3	314-0023	Stand Off
4	314-0025	3/8" Lock Washer
5	324-1006	3/8" Flat Washer
6	314-0024	3/8" Shoulder Bolt
7	314-0027	3/8" Nut
8	314-0029	1/2" Flat Washer
9	314-0028	1/2" Bolt
10	314-0030	1/2" Hex Nut
11	C-108KT-808	Loose Key on Lanyard
12	300-6003	Valve Stem Cap
13	C-634KT-809	Worm Drive Assembly
14	C-634KT-808	Worm Sleeve Assembly
15	336-0001	O-Ring for Worm Sleeve
	P-260KT-802	Stopper Assembly, Contains: 15, 16
17	Call PRIER	Stem Shaft
18	C-634KT-806	Vacuum Breaker Assembly
	231-0803	3' Stem Assembly, 37 1/8" OAL Contains: 14, 15, 16, 17

Side Hydrant View

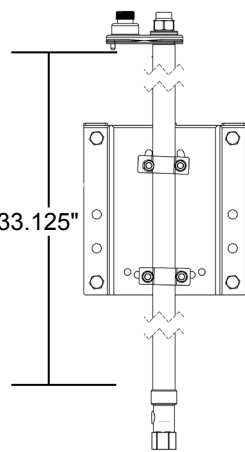

Bottom Bracket View

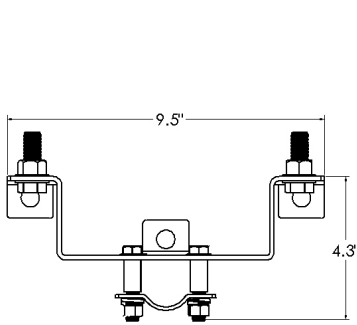

Front Bracket View

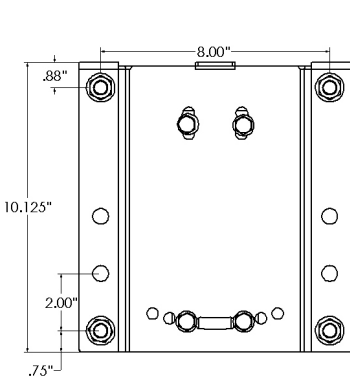

Furnish and install Model P-RH1 commercial key operated roof hydrant manufactured by PRIER Products, Inc. Hydrant shall be installed through a 1 3/4" single penetration in the roof and mounted to the interior structure with the Universal Roof Hydrant Mounting Bracket (P-RMB) provided. This bracket must be manufactured of heavy gauge powder coated steel and must allow for adjustment to meet roof angles up to 4/12. The mounting bracket shall be mounted to concrete, a roofing truss, steel I-beam or interior wall with standard construction materials (all-thread, Unistrut or other). The hydrant shall be flush mounted and have automatic draining capabilities with integral vacuum breaker/backflow preventer. Hydrant shall be brass with freezeless water flow and self draining functions, one piece valve plunger, satin nickel finish and a triple-seal shut off mechanism. Hydrant shall be capable of flowing a minimum of 15 gallons per minute at 25 PSI pressure change. The hydrant shall have a 3/4" inlet and a 1/8" NPT drainage port to be connected to the drain waste line inside the structure. Hydrant shall be approved under the ASSE 1052 standard. The roof penetration is to be sealed by the roofing contractor in accordance with the roofing codes and conditions in their municipality.

Rough-In Dimensions Specs

Application

P-RH2 Post Mount Roof Hydrant

With Integral P-004 Vacuum Breaker  
and Dual Backflow Preventor



close-up view



- Commercial/Industrial
- Freezeless
- Anti-Siphon
- Self Draining



PRIER's P-RH2 Post Mount Roof Hydrant provides a year round source of water to roof surfaces in areas with freezing temperatures. The hydrant stands 30" above the roof for easy hose access. The hydrant valve is connected to the supply piping in the heated portion of the structure, and is self-draining, eliminating the possibility of freezing. This valve has a built in vacuum breaker that allows the hydrant to drain even if the hose is left on.

The Roof Mounting Bracket enables the hydrant to be mounted to any structural member with rigid support, instead of to the skin of the building like competitive products.

This bracket requires only a single penetration point of 1 3/4", and can be mounted to concrete, wood, steel, I-beams, truss, perlin or other structural member with standard construction materials (Unistrut, all-thread, etc.).

Features

- Triple seal EPDM stopper for long wear life
- Bracket mounts to any roof structural member (truss, I-beam, concrete roof, etc.)
- Single hole penetration of 1 3/4"
- Single person installation with standard tools
- Hydrant has 3/4" inlet and multi-pass seat for high flow rates
- Freezeless anti-siphon hydrant stands 30" above the roof for easy hose access
- Heavy duty cast iron head and lockable lever handle
- Bucket hook on spout
- Designed to be installed with standard construction materials (Unistrut, all-thread, etc.)
- Self draining with 1/8" NPT drainage port
- Repair can be easily accomplished at roof level
- Flow rate adjustment
- ASSE 1052 approved vacuum breaker and backflow preventer
- Adjustable bracket to accommodate roof angles up to 4/12

Ordering

P-RH2

- Length
- H1- Flush Mount Roof Hydrant
  - H2- Post Mount Roof Hydrant
  - H3- Mild Climate Roof Hydrant
  - MB- Roof Hydrant Mounting Bracket





4515 East 139th Street  
Grandview, MO 64030  
(800) 362-9055  
Fax (800) 362-1463  
www.PRIER.com



4515 East 139th Street  
Grandview, MO 64030  
(800) 362-9055  
Fax (800) 362-1463  
www.PRIER.com

Replacement Parts

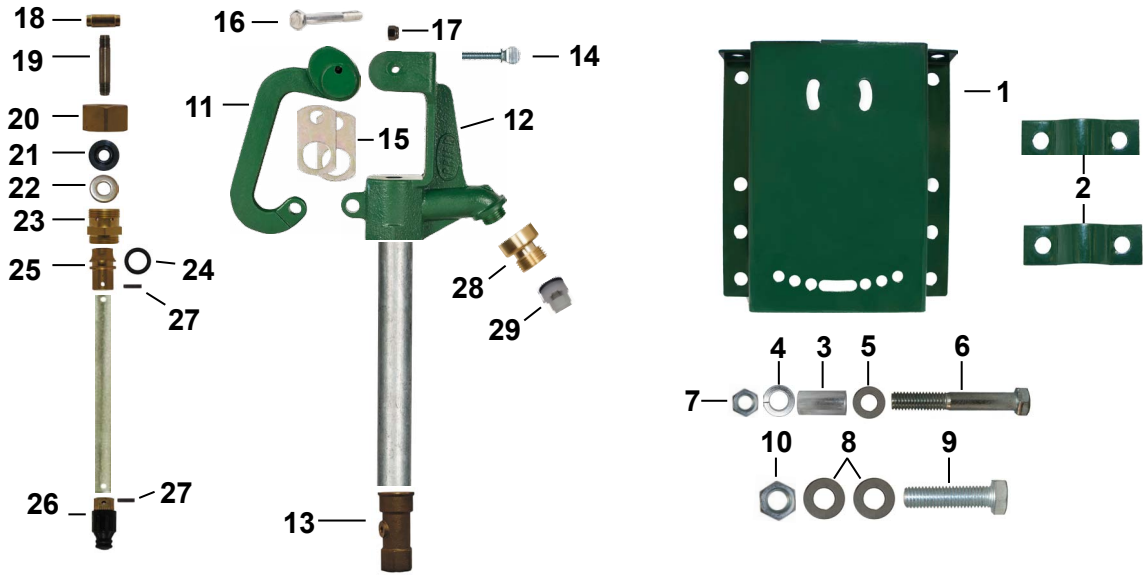

ID	Part No.	Description	ID	Part No.	Description
1	314-0021	Mounting Bracket	16	314-0008	Handle Bolt (Stainless Steel)
2	314-0022	Pipe Bracket	17	314-0009	Nylon Hex Nut (Stainless Steel)
3	314-0023	Stand Off	18	314-7001	Adjustable Connector Nut (Zinc)
4	314-0025	3/8" Lock Washer	19	314-7002	Upper Rod (Stainless Steel)
5	324-1006	3/8" Flat Washer	20	310-7005	Valve Stem Cap (Brass)
6	314-0024	3/8" Shoulder Bolt	21	336-0008	Packing (EPDM)
7	314-0027	3/8" Nut	22	324-1003	Washer (Stainless Steel)
8	314-0029	1/2" Flat Washer	23	310-7003	Seal Adapter (Brass)
9	314-0028	1/2" Bolt	24	336-0001	O-Ring (EPDM)
10	314-0030	1/2" Hex Nut	25	310-7001	Seal Sleeve (Brass)
11	301-7003	Handle (Cast Iron)	26	399-7001	Stopper (EPDM over Brass)
12	301-7001	Hydrant Head (Cast Iron)	27	324-0004	Spring Pin, Quantity 2 Required (Stainless Steel)
13	300-7001	Seat (Cast Brass)	28	310-7006	Hose Piece, 3/4" Hose Thread (Brass)
14	315-0001	Thumb Screw (Zinc Plated Steel)	29	399-0001	Check Valve (Plastic, Rubber, Stainless Steel)
15	304-7001	Draw Straps, Quantity 2 Required (Zinc Plated Steel)		P-260KT-802	Stopper Repair Kit, Contains: 24, 26, 27

Rough-In Dimensions Specs

Side Hydrant View

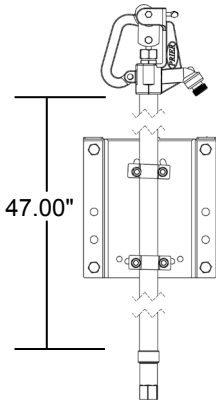

Bottom Bracket View

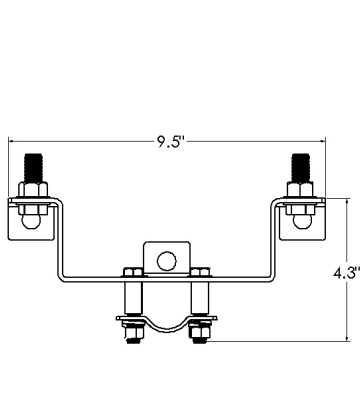

Front Bracket View

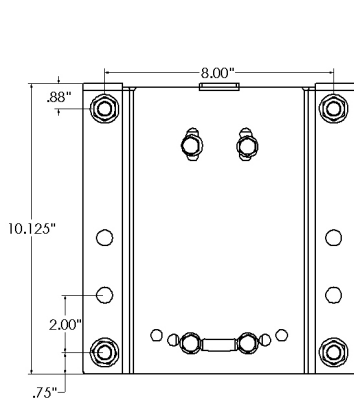

Furnish and install Model P-RH2 commercial Post Mount Roof Hydrant manufactured by PRIER Products, Inc. Hydrant shall be installed through a 1 3/4" single penetration in the roof and mounted to the interior structure with the Universal Roof Hydrant Mounting Bracket (P-RMB) provided. This bracket must be manufactured of heavy gauge powder coated steel and must allow for adjustment to meet roof angles up to 4/12. The mounting bracket shall be mounted to concrete, a roofing truss, steel I-beam or interior wall with standard construction materials (all-thread, Unistrut or other). The hydrant shall have automatic draining capabilities with integral vacuum breaker/backflow preventer. Hydrant shall be cast iron with freezeless water flow and self draining functions, one piece valve plunger and a triple-seal shut off mechanism. The hydrant shall have a 3/4" inlet and a 1/8" NPT drainage port to be connected to the drain waste line inside the structure. Hydrant shall be approved under the ASSE 1052 standard. The roof penetration is to be sealed by the roofing contractor in accordance with the roofing codes and conditions in their municipality.

Application

P-RH3 Mild Climate Roof Hydrant

With Integral P-004 Vacuum Breaker  
and Dual Backflow Preventor



close-up view



- Commercial/Industrial
- Freezeless
- Anti-Siphon
- Wheel Handle Operated



PRIER's P-RH3 Mild Climate Roof Hydrant provides a year round source of water to roof surfaces in mild climate areas. The hydrant consists of a commercial sill faucet mounted onto a post for easy access. The hydrant valve is connected to the supply piping in the heated portion of the structure. This valve has a built in vacuum breaker that meets ASSE 1052.

The Roof Mounting Bracket enables the hydrant to be mounted to any structural member with rigid support, instead of to the skin of the building like competitive products.

This bracket requires only a single penetration point of 1 3/4", and can be mounted to concrete, wood, steel, I-beams, truss, perlin or other structures with standard construction materials (Unistrut, all-thread, etc.).

Features

- Mounts to any roof structural member (truss, I-beam, concrete roof, etc.)
- Single hole penetration of 1 3/4"
- Single person installation with standard tools
- ASSE 1052 approved vacuum breaker and backflow preventer
- Commercial sill faucet on post for easy access
- Valve has integral vacuum breaker and back flow preventer
- Convertible to vandal proof loose key
- Designed to be installed with standard construction materials (Unistrut, all-thread, etc.)
- Repair can be easily accomplished at roof level
- 3/4" garden hose threads standard
- Heavy duty brass construction with a satin nickel finish
- Heavy duty galvanized pipe provides stability and is easily mounted to the roof mounting bracket
- Adjustable bracket to accommodate roof angles up to 4/12

Ordering

P-RH3

- Length
- H1- Flush Mount Roof Hydrant
  - H2- Post Mount Roof Hydrant
  - H3- Mild Climate Roof Hydrant
  - MB- Roof Hydrant Mounting Bracket







4515 East 139th Street  
Grandview, MO 64030  
(800) 362-9055  
Fax (800) 362-1463  
www.PRIER.com

Replacement Parts & Stems

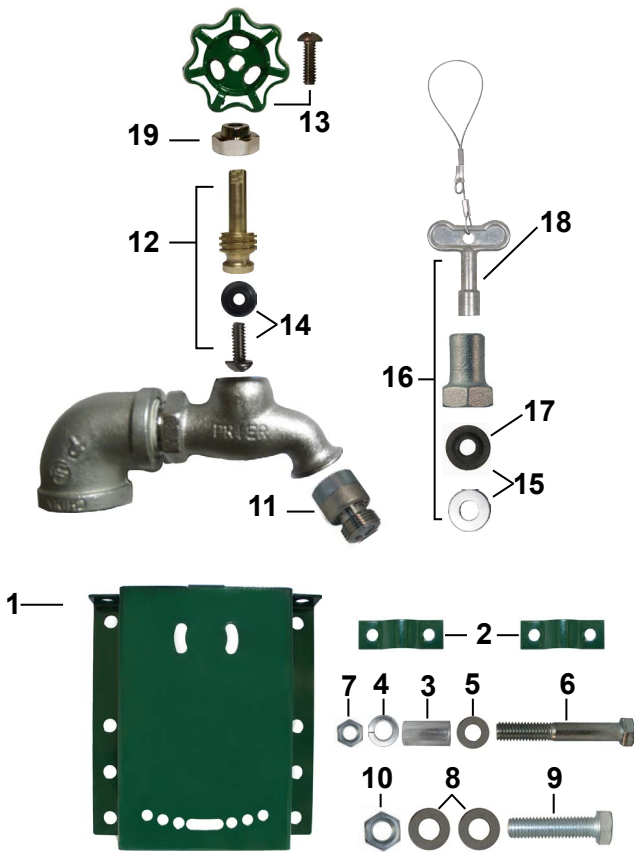

ID	Part No.	Description
1	314-0021	Mounting Bracket
2	314-0022	Pipe Bracket
3	314-0023	Stand Off
4	314-0025	3/8" Lock Washer
5	324-1006	3/8" Flat Washer
6	314-0024	3/8" Shoulder Bolt
7	314-0027	3/8" Nut
8	314-0029	1/2" Flat Washer
9	314-0028	1/2" Bolt
10	314-0030	1/2" Hex Nut
11	P-004CP	Vacuum Breaker Assembly
12	231-0001	Stem Assembly
13	C-134KT-805	Oval Handle and Screw Kit
14	C-135KT-802	Seat Washer Kit, 1/4" L Beveled
15	C-134KT-803	Stem Packing Kit
16	C-134KT-804	Loose Key Conversion Kit
17	390-1001	Stem Packing Only
18	C-108KT-808	Loose Key on Lanyard
19	310-1012	Valve Stem Cap

Rough-In Dimensions

Side Hydrant View

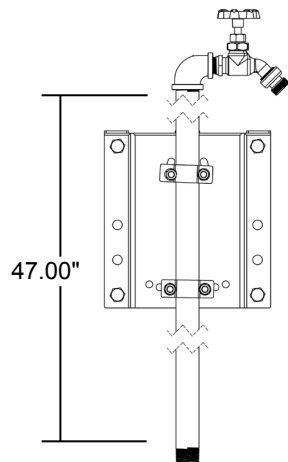

Bottom Bracket View

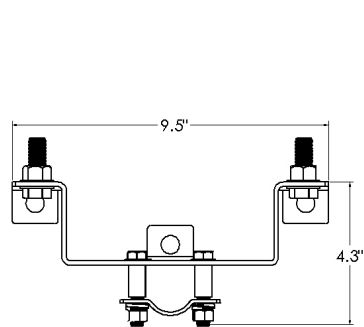

Front Bracket View

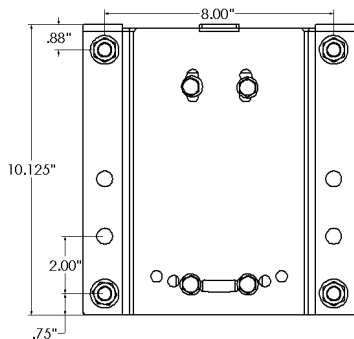

Furnish and install Model P-RH3 Commercial Post Mount Roof Hydrant manufactured by PRIER Products, Inc. Hydrant shall be installed through a 1 3/4" single penetration in the roof and mounted to the interior structure with the Universal Roof Hydrant Mounting Bracket (P-RMB) provided. This bracket must be manufactured of heavy gauge powder coated steel and must allow for adjustment to meet roof angles up to 4/12. The mounting bracket shall be mounted to concrete, a roofing truss, steel I-beam or interior wall with standard construction materials (all-thread, Unistrut or other). The hydrant shall have an integral vacuum breaker/backflow preventer and be approved under the ASSE 1052 standard. The hydrant shall have a 3/4" inlet and be made of brass with a satin nickel chromium finish. The roof penetration is to be sealed by the roofing contractor in accordance with the roofing codes and conditions in their municipality.



4515 East 139th Street  
Grandview, MO 64030  
(800) 362-9055  
Fax (800) 362-1463  
www.PRIER.com

Application

## P-RMB Universal Mounting Bracket

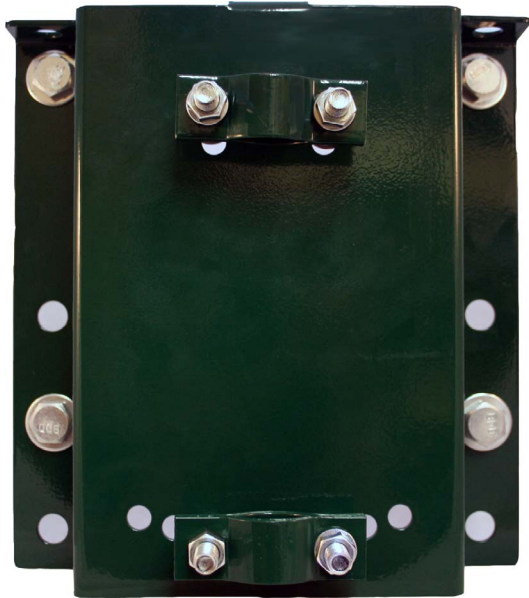

- Mounts to any Roof Structure
- Single Hole Penetration
- Works with any 3/4" Post Hydrant
- Powder Coated Steel Design



PRIER's P-RMB Universal Roof Hydrant Mounting Bracket provides a means to attach any 3/4" post hydrant to a roof structure, thus providing a simple water source on the roof of a building. PRIER's Mounting Bracket is compatible with PRIER's P-RH1, P-RH2 and P-RH3 Commercial Roof Hydrants.

The Roof Mounting Bracket enables the hydrant to be mounted to any structural member with rigid support, instead of to the skin of the building like competitive products.

This bracket requires only a single penetration point of 1 3/4", and can be mounted to concrete, wood, steel, I-beams, truss, perlin or other structural members with standard construction materials (unistrut, all-thread, or other).

Features

- Mounts to any roof structural member (truss, I-beam, concrete roof, etc.)
- Compatible with PRIER's P-RH1, P-RH2 and P-RH3 roof hydrants
- Single hole penetration of 1 3/4"
- Single person installation with standard tools
- Seals with standard roofing materials
- Works with any 3/4" post hydrant
- Designed to be installed with standard construction materials (Unistrut, all-thread, etc.)
- Powder coated steel design
- Adjustable to accommodate roof angles up to 4/12
- Bracket and hydrant can be installed independently

Ordering

## P-RMB

Length  
H1- Flush Mount Roof Hydrant  
H2- Post Mount Roof Hydrant  
H3- Mild Climate Roof Hydrant  
MB- Roof Hydrant Mounting Bracket





4515 East 139th Street  
Grandview, MO 64030  
(800) 362-9055  
Fax (800) 362-1463  
www.PRIER.com

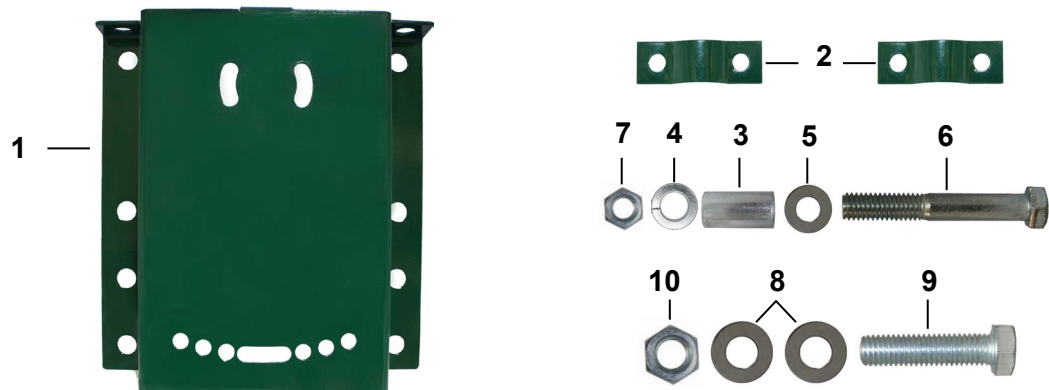

ID	Part No.	Description
1	314-0021	Mounting Bracket
2	314-0022	Pipe Bracket
3	314-0023	Stand Off
4	314-0025	3/8" Lock Washer
5	324-1006	3/8" Flat Washer
6	314-0024	3/8" Shoulder Bolt
7	314-0027	3/8" Nut
8	314-0029	1/2" Flat Washer
9	314-0028	1/2" Bolt
10	314-0030	1/2" Hex Nut

Bottom Bracket View

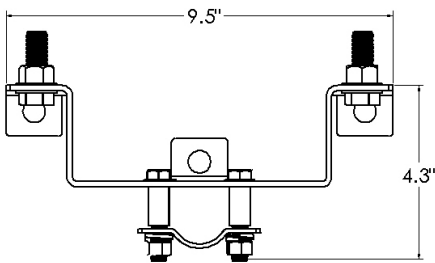

Front Bracket View

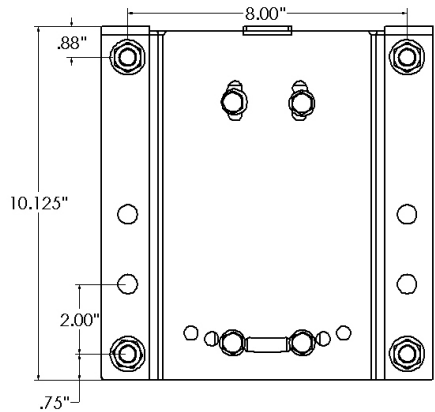

Furnish and install Model P-RMB Universal Roof Hydrant Mounting Bracket manufactured by PRIER Products. Bracket must be manufactured of heavy gauge powder coated steel. This bracket is to be installed inside the structure and must have a single penetration through the roof. This bracket must allow for adjustment to meet roof angles up to 4/12. It also must connect to I-beams, steel, truss, wood or concrete with standard construction materials. The roof penetration is to be sealed by the roofing contractor in accordance with roofing codes and conditions in their municipality.

**Page 40** P-650 Heavy Commercial Ground Hydrant  
**Page 42** P-260 Freezeless Ground Hydrant  
**Page 44** C-250 Heavy Pattern Freezeless Ground Hydrant  
**Page 46** C-240 Freezeless Economy Ground Hydrant  
**Page 48** YH Freezeless Ground Hydrant

# GROUND HYDRANTS





4515 East 139th Street  
Grandview, MO 64030  
(800) 362-9055  
Fax (800) 362-1463  
www.PRIER.com



4515 East 139th Street  
Grandview, MO 64030  
(800) 362-9055  
Fax (800) 362-1463  
www.PRIER.com

# P-650 Heavy Commercial Ground Hydrant

With Integral P-004 Vacuum Breaker  
and Dual Backflow Preventor

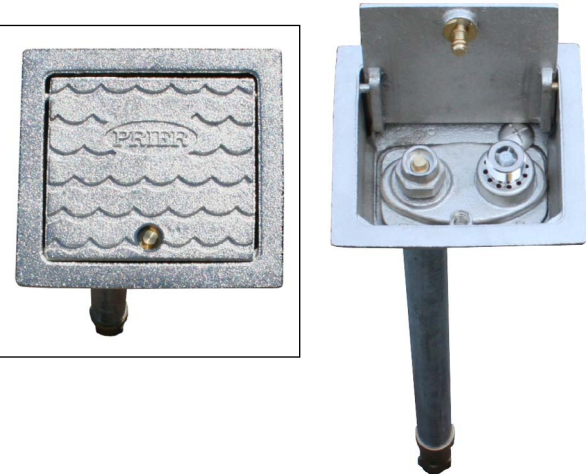

- Commercial/Industrial
- Freezeless
- Anti-Siphon
- Backflow Check Valve
- Self-Draining



PRIER P-650 Heavy Commercial Ground Hydrant provides a year round source of water to areas subject to freezing temperatures. The hydrant is installed flush to surface, eliminating interference with machinery or pedestrian traffic.

The hydrant valve is connected to the supply piping below the freeze line, and is self draining, eliminating the possibility of freezing. An operating key is provided to prevent unauthorized usage of the hydrant.

*\*shown with optional hydrant box*

- Heavy pattern standard hydrant for use with or without brass or satin nickel box
- ASSE 1052 approved backflow preventor and vacuum breaker
- Heavy duty galvanized piping, with options for all brass construction
- Simple, solderless design with threaded and sealed joints for years of reliable operation
- Repair can be easily accomplished at ground level
- No special installation or service tools are required
- Includes operating key

Ground Hydrant Only

P-650N02

Hose Thread Outlet  
0- 3/4" Garden Hose  
1- 1" Hose

Inlet  
N- 3/4" FPT

Length

- 1- 1' Bury Depth
- 2- 2' Bury Depth
- 3- 3' Bury Depth
- 4- 4' Bury Depth
- 5- 5' Bury Depth
- 6- 6' Bury Depth



Optional Hydrant Box

P-650BX1



Box Finish  
1- Satin Nickel Plated  
2- Rough Brass



*\*Note: Optional box is rated at light duty.*

*\*Note: For installations with hydrant box, both freezeless hydrant and box need to be ordered.*

## Replacement Parts

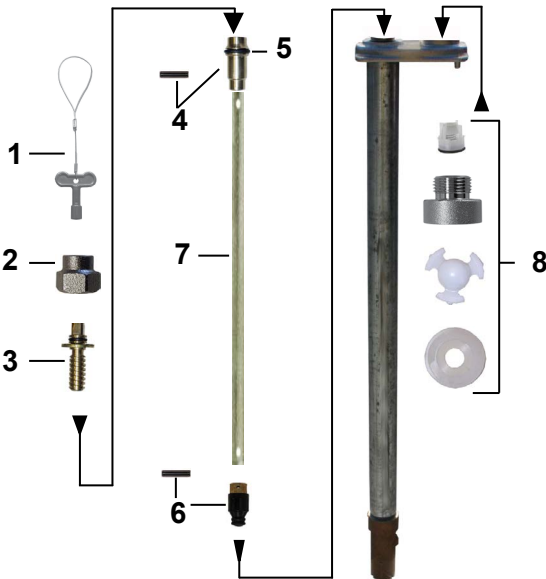

ID	Part No.	Description
1	C-108KT-808	Loose Key on Lanyard
2	300-6003	Valve Stem Cap
3	C-634KT-809	Worm Drive Assembly
4	C-634KT-808	Worm Sleeve Assembly
5	336-0001	O-Ring for Worm Sleeve
6	P-260KT-802	Stopper Assembly
7	Call PRIER	Stem Shaft
8	C-634KT-806	Vacuum Breaker Assembly
4-7	231-0801	Stem Assembly for 1' P-650, 13 1/8" OAL
4-7	231-0802	Stem Assembly for 2' P-650, 25 1/8" OAL
4-7	231-0803	Stem Assembly for 3' P-650, 37 1/8" OAL
4-7	231-0804	Stem Assembly for 4' P-650, 49 1/8" OAL
4-7	231-0805	Stem Assembly for 5' P-650, 61 1/8" OAL
4-7	231-0806	Stem Assembly for 6' P-650, 73 1/8" OAL
4-7	231-0807	Stem Assembly for 7' P-650, 85 1/8" OAL

## Rough-In Dimensions

Side Hydrant View with Box

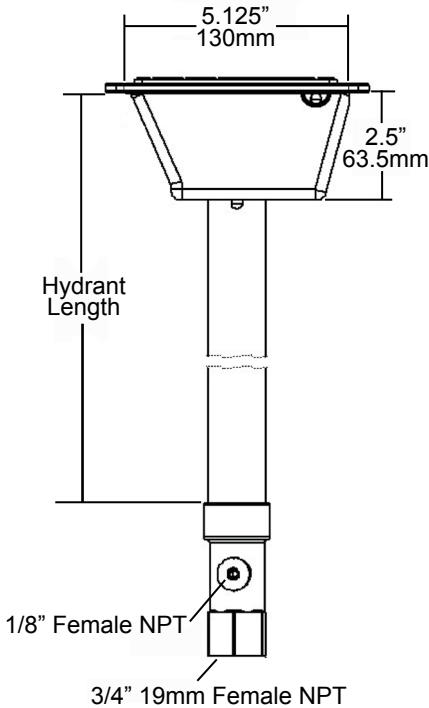

Top Box View

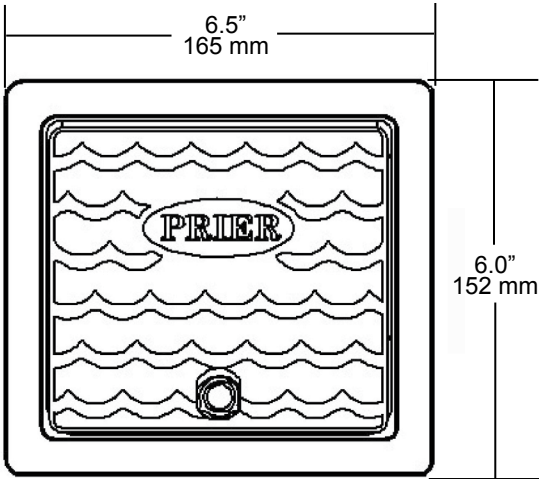

## Specs

Furnish and install PRIER's P-650 Heavy Commercial key operated ground hydrant manufactured by PRIER Products, Inc. Hydrant shall be approved to ASSE 1052 and UPC standards and shall be installed with a water box. Hydrant box shall be manufactured of solid cast brass with a rough brass or satin nickel (choose one) finish. Access to the water box shall be provided by the same operating key as the hydrant. The hydrant must be installed flush to surface to allow machinery and pedestrian traffic without damage to hydrant. Hydrant shaft shall be heavy duty piping with threaded and sealed connections. Hydrant shall have 3/4" or 1" (choose one) hose connection with freezeless water flow and self-draining functions with solid operating rod. Hydrant insertion depth to be \* feet. \*1' to 7' in 1' increments.

Application

Features

Ordering



4515 East 139th Street  
Grandview, MO 64030  
(800) 362-9055  
Fax (800) 362-1463  
www.PRIER.com



4515 East 139th Street  
Grandview, MO 64030  
(800) 362-9055  
Fax (800) 362-1463  
www.PRIER.com

Application

## P-260 Freezeless Ground Hydrant



close-up view



- **Freezeless**
- **Anti-Siphon**
- **Self-Draining**
- **Variable Flow**
- **Lockable**
- **Triple Seal Stopper**

PRIER's P-260 Freezeless Ground Hydrant provides a year round source of water to areas subject to freezing temperatures. The P-260 comes with a built in backflow preventer and flow control lock.

Additionally, the P-260 is well known for its ease of use and maintenance. The brass stem cap design allows the stem to be removed and a stopper replaced without removing the cast iron head from the hydrant, significantly simplifying the maintenance of this type of product.

Features

- Maintained at ground level without removing heavy duty cast iron head and lever handle
- Flow control lock for water flow adjustment
- Available in 8 standard lengths, longer lengths available by request
- 3/4" FPT inlet connection
- Built in backflow preventer, self-lubricating EPDM seals, and optional ASSE 1052 vacuum breaker
- Stainless steel upper rod for long wear life
- Multi-pass seat for high flow rates
- Heavy duty galvanized steel pipe body and operating stem
- Optional brass pipe and operating rod for harsh water environments
- Solid brass garden hose adapter and triple seal stopper for long wear life
- Bucket hook on spout
- Made in the USA

Ordering

### P-260-3

#### Bury Depth

- |                  |                  |
|------------------|------------------|
| 1- 1' Bury Depth | 5- 5' Bury Depth |
| 2- 2' Bury Depth | 6- 6' Bury Depth |
| 3- 3' Bury Depth | 7- 7' Bury Depth |
| 4- 4' Bury Depth | 8- 8' Bury Depth |



Part No.	Size	Overall Length	Weight Ea.
P-260-1	1' Bury	44"	13 lbs
P-260-2	2' Bury	56"	15 lbs
P-260-3	3' Bury	68"	17 lbs
P-260-4	4' Bury	80"	19 lbs
P-260-5	5' Bury	92"	21 lbs
P-260-6	6' Bury	104"	23 lbs

Replacement Parts

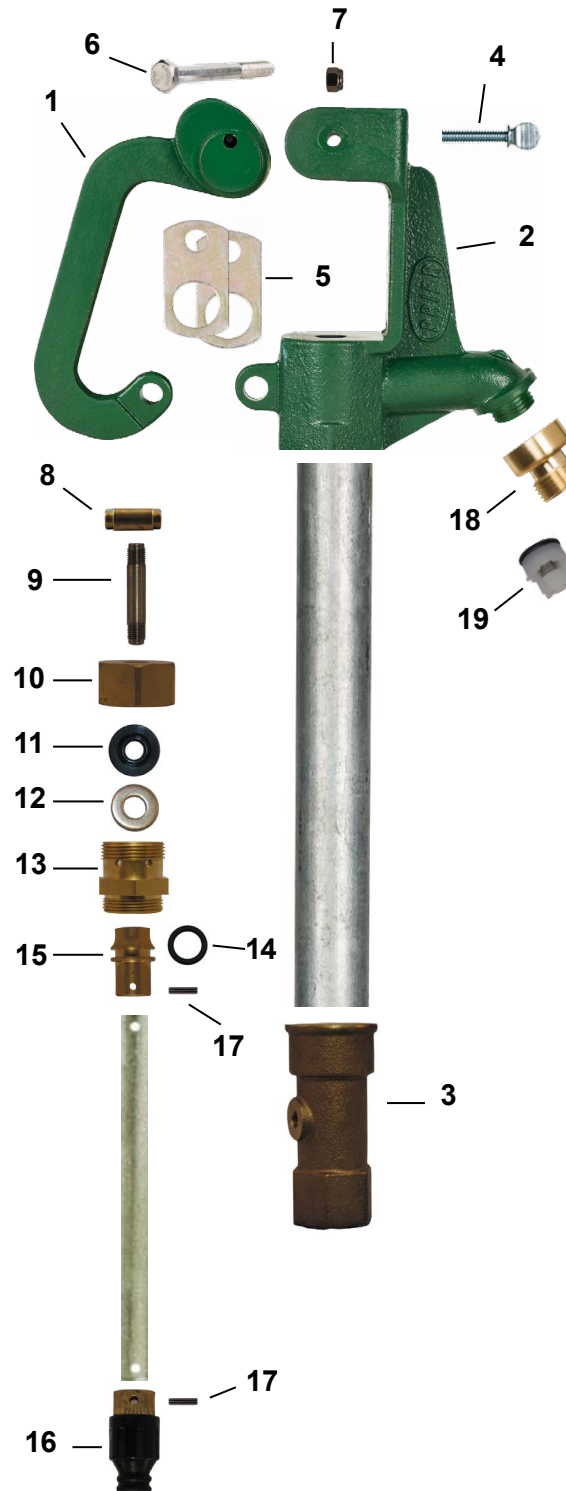

ID	Part No	Description
1	301-7003	Handle (Cast Iron)
2	301-7001	Hydrant Head (Cast Iron)
3	300-7001	Seat (Cast Brass)
4	315-0001	Thumb Screw (Zinc Plated Steel)
5	304-7001	Draw Straps, Quantity 2 Required (Zinc Plated Steel)
6	314-0011	Handle Bolt (Stainless Steel)
7	314-0009	Hex Nut (Stainless Steel with Nylon)
8	314-7001	Adjustable Connector Nut (Zinc)
9	314-7002	Upper Rod (Stainless Steel)
10	310-7005	Valve Stem Cap, Hand Tighten Only (Brass)
11	336-0008	Packing (EPDM)
12	324-1003	Washer (Stainless Steel)
13	310-7003	Seal Adapter (Brass)
14	336-0001	O-Ring (EPDM)
15	310-7001	Seal Sleeve (Brass)
16	399-7001	Stopper (EPDM over Brass)
17	324-0004	Spring Pin (Stainless Steel)
18	310-7006	Hose Piece, 3/4" Hose Thread (Brass)
19	399-0001	Check Valve (Plastic, Rubber and Stainless Steel)
	P-260KT-802	Stopper Repair Kit Contains: 14, 16, 17
	P-260KT-807	Overhaul Kit, Contains: 5 (2ea), 8, 10, 11, 12, 14, 16, 17 (2ea)





4515 East 139th Street  
Grandview, MO 64030  
(800) 362-9055  
Fax (800) 362-1463  
www.PRIER.com



4515 East 139th Street  
Grandview, MO 64030  
(800) 362-9055  
Fax (800) 362-1463  
www.PRIER.com

Application

## C-250 Freezeless Ground Hydrant



close-up view



- **Freezeless**
- **Lockable**
- **Variable Flow**
- **Time Tested**

PRIER's C-250 Freezeless Ground Hydrant provides a year round source of water to areas subject to freezing temperatures. The hydrant valve is connected to the supply piping below the frost line, and since it drains automatically, it is not subject to freezing.

The PRIER C-250 is a time tested design with a cam type operation lever control that provides full variable flow. It is available from stock in bury depths from 1' to 6', longer sizes are available upon request.

Features

- Solid, extra thick walled head casting, reduced breakage
- 3/4" FPT inlet connection
- Solid brass hose adapter
- Cam type operating lever control provides full variable flow
- High quality steel drawstraps that eliminate side pull of operating rod
- Pivot connector has double nut connection, no set screws to rust in place
- Galvanized outer pipe has no exposed threads, providing simple, in field repair
- Stainless steel operating rod provides the longest operating life
- Simple repair can be done at ground level

Ordering

### C-250-3

**Bury Depth**

- 1- 1' Bury Depth    4- 4' Bury Depth  
2- 2' Bury Depth    5- 5' Bury Depth  
3- 3' Bury Depth    6- 6' Bury Depth

Part No.	Size	Overall Length	Weight Ea.
C-250-1	1' Bury	46"	13 lbs
C-250-2	2' Bury	58"	15 lbs
C-250-3	3' Bury	70"	17 lbs
C-250-4	4' Bury	82"	19 lbs
C-250-5	5' Bury	94"	21 lbs
C-250-6	6' Bury	106"	23 lbs

Replacement Parts

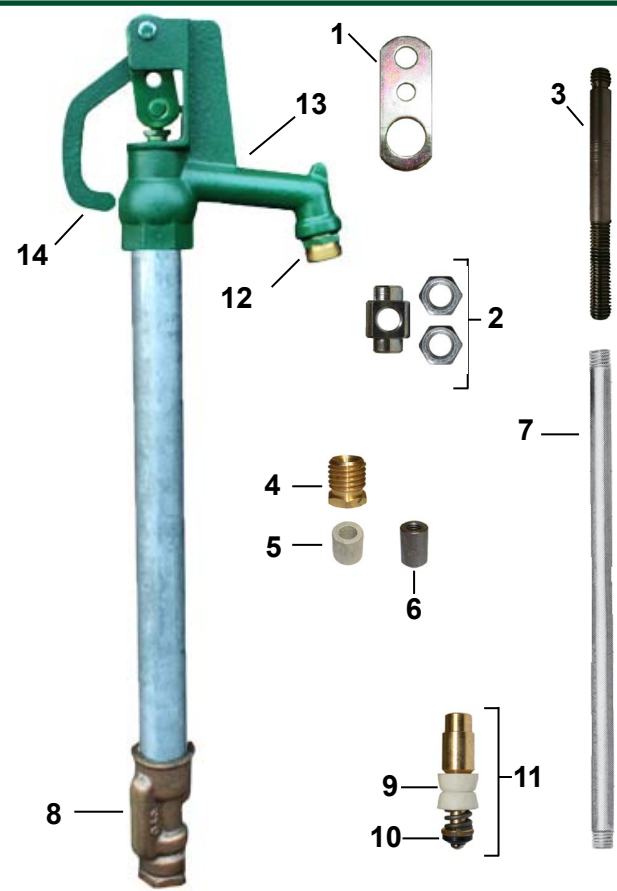

ID	Part No.	Description
1	324-1004	Draw Straps, Quantity 2 Required
2	232-0001	Pivot Connector and Nuts
3	314-0002	Rod (Stainless Steel)
4	310-0010	Packing Nut
5	346-0001	Valve Stem Packing
6	310-0014	Rod Connector
7	314-0003	7/16" Extension Rod
8	310-0011	Valve Body for C-250
9	340-0002	Cup Leathers, Quantity 2 Required
10	936-0001	3/8" L Beveled Bibb Washer
11	C-250-021	Plunger for C-250
12	310-0027	Hose Thread Adapter for C-240, C-250
13	301-0004	Head for C-250 (Cast Iron)
14	301-0001	Handle for C-250 (Cast Iron)
	C-250-801	Overhaul Kit, Contains 1, 2, 4, 5, 11



4515 East 139th Street  
Grandview, MO 64030  
(800) 362-9055  
Fax (800) 362-1463  
www.PRIER.com



4515 East 139th Street  
Grandview, MO 64030  
(800) 362-9055  
Fax (800) 362-1463  
www.PRIER.com

Application

## C-240 Freezeless Ground Hydrant

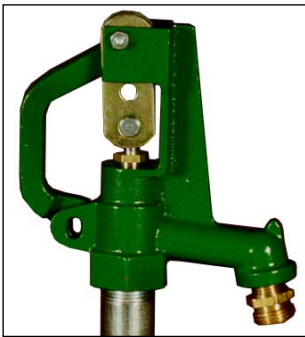

close-up view



- **Freezeless**
- **Lockable**
- **Variable Flow**
- **Time Tested**

PRIER's C-240 Freezeless Ground Hydrant provides a year round source of water to areas subject to freezing temperatures. The hydrant valve is connected to the supply piping below the frost line, and since it drains automatically, it is not subject to freezing.

The PRIER C-240 is a time tested design, with many of the quality features of PRIER's C-250 premium quality freezeless ground hydrant. It is available from stock in bury depths from 1' to 6', longer sizes are available upon request.

Features

- 3/4" FPT inlet connection
- Solid brass hose adapter
- Cam type operating lever control provides full variable flow
- High quality steel drawstraps that eliminate side pull of operating rod
- Pivot connector has double nut connection, no set screws to rust in place
- Galvanized outer pipe has no exposed threads, providing simple, in field repair
- Stainless steel operating rod provides the longest operating life
- Dual bypass high flow valve body
- One piece plunger design
- Simple repair can be done at ground level

Ordering

### C-240-3

→ **Bury Depth**  
1- 1' Bury Depth    4- 4' Bury Depth  
2- 2' Bury Depth    5- 5' Bury Depth  
3- 3' Bury Depth    6- 6' Bury Depth

Part No.	Size	Overall Length	Weight Ea.
C-240-1	1' Bury	45"	11 lbs
C-240-2	2' Bury	57"	13 lbs
C-240-3	3' Bury	69"	15 lbs
C-240-4	4' Bury	81"	17 lbs
C-240-5	5' Bury	93"	19 lbs
C-240-6	6' Bury	105"	21 lbs

Replacement Parts

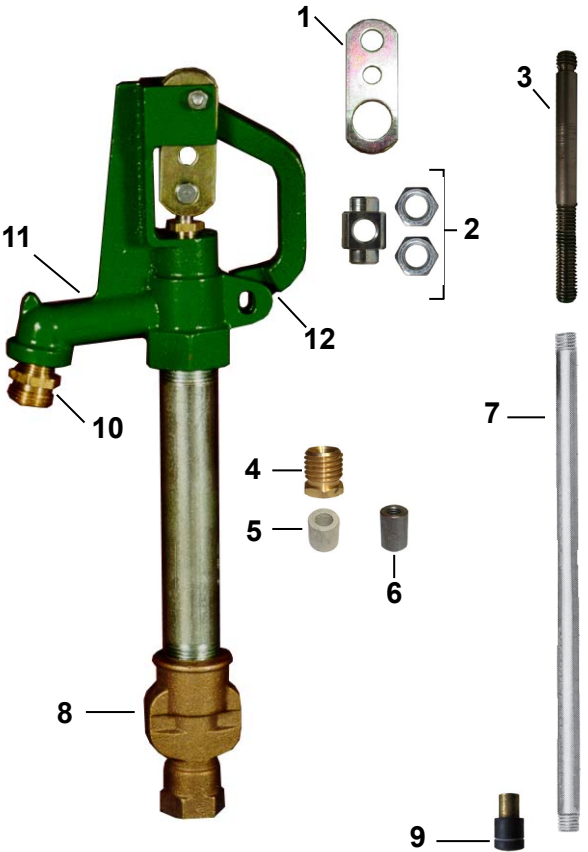

ID	Part No.	Description
1	324-1004	Draw Straps, Quantity 2 Required
2	232-0001	Pivot Connector and Nuts
3	314-0002	Rod (Stainless Steel)
4	310-0010	Packing Nut
5	346-0001	Valve Stem Packing
6	310-0014	Rod Connector
7	314-0003	7/16" Extension Rod
8	300-0027	Valve Body for C-240
9	C-240-021	Plunger for C-240
10	310-0027	Hose Thread Adapter for C-240, C-250
11	301-0003	Head for C-240 (Cast Iron)
12	301-0002	Handle for C-240 (Cast Iron)
	C-240-801	Overhaul Kit, Contains: 1, 2, 4, 5, 9





4515 East 139th Street  
Grandview, MO 64030  
(800) 362-9055  
Fax (800) 362-1463  
www.PRIER.com



4515 East 139th Street  
Grandview, MO 64030  
(800) 362-9055  
Fax (800) 362-1463  
www.PRIER.com

Application

# YH Freezeless Ground Hydrant

## Mansfield Style “Formerly Red” YH Series



close-up view



- **Freezeless**
- **Lockable**
- **Variable Flow**
- **Lead Free**

PRIER’s YH Series Economy Freezeless Ground Hydrant provides a year round source of water to areas subject to freezing temperatures. The hydrant valve is connected to the supply piping below the frost line, and since it drains automatically, it is not subject to freezing.

The YH Series Ground Hydrant contains a multiple bypass high flow valve body and a one piece plunger design. It is available from stock in bury depths from 1’ to 6’ and it meets the 2014 Safe Drinking Water Act.

Features

- 3/4” FPT inlet connection
- Heavy duty cast iron head and handle
- Solid brass hose adapter
- Galvanized outer pipe has no exposed threads, providing simple, in field repair
- Multiple bypass high flow valve body
- One piece plunger design
- Simple repair can be done at ground level
- YH model meets the 2014 Safe Drinking Water Act

Ordering

YH-3

### Bury Depth

- 1- 1’ Bury Depth    4- 4’ Bury Depth  
2- 2’ Bury Depth    5- 5’ Bury Depth  
3- 3’ Bury Depth    6- 6’ Bury Depth

Part No.	Size	Overall Length	Weight Ea.
YH-1	1’ Bury	39”	12 lbs
YH-2	2’ Bury	51”	15 lbs
YH-3	3’ Bury	63”	17 lbs
YH-4	4’ Bury	75”	20 lbs
YH-5	5’ Bury	87”	22 lbs
YH-6	6’ Bury	99”	24 lbs

Replacement Parts

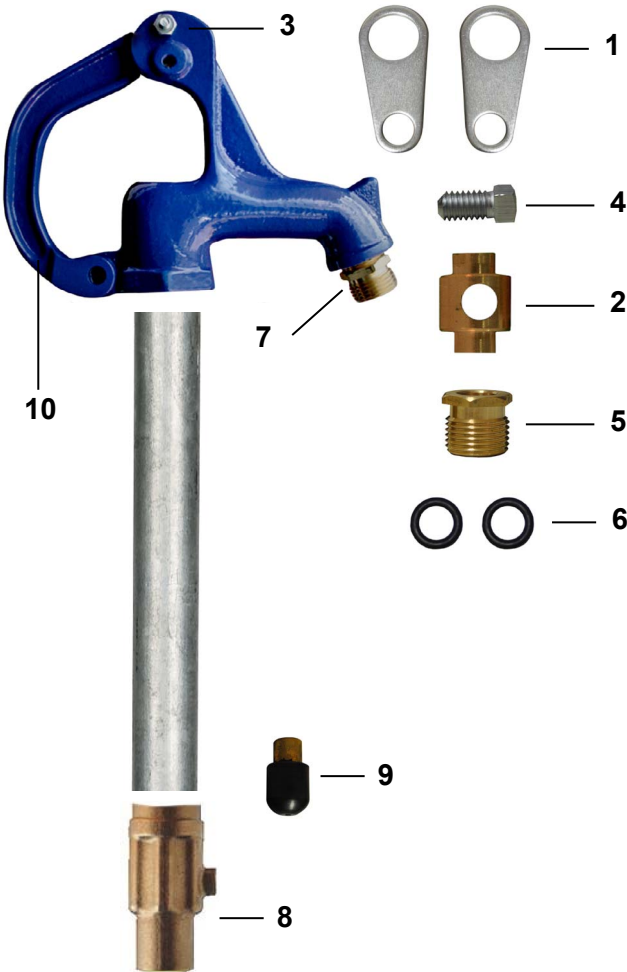

ID	Part No.	Description
1	324-3002	Draw Straps, Quantity 2 Required
2	310-3028	Pivot Connector
3	324-3003	Fulcrum Bolt and Nut
4	324-3004	Square Head Set Screw
5	310-3029	Packing Nut
6	336-3004	O-Ring Seal
7	310-3030	Hose Thread Adapter
8	300-0024	Valve Body
9	399-3004	Plunger
10	301-3001	Operating Handle
	630-9002	Repair Kit, Contains: 1, 2, 3, 4, 5, 6, 9

Page 51

C-135 Heavy Pattern Angle Sill Faucets

Page 52

C-138 Heavy Pattern Hose Bibbs

Page 53

C-155 Anti-Siphon Angle Sill Faucets

Page 55

C-158 Anti-Siphon Hose Bibbs

Page 56

P-002 Vacuum Breakers

ANGLE SILL

FAUCETS



4515 East 139th Street  
Grandview, MO 64030  
(800) 362-9055  
Fax (800) 362-1463  
www.PRIER.com

Application

Heavy Pattern Angle Sill Faucets

C-135/C-235, C-137/C-237 Styles



- Heavy Pattern
- Solid Cast Brass
- Handle or Loose Key Option
- Satin Nickel or Polished Chrome Plated

PRIER Heavy Pattern Angle Sill Faucets are designed for areas that require water service, but are not subject to freezing temperatures. Typical installations include basements, garages and for outdoor installations in mild climates. The heavy pattern design with solid brass stem assures years of reliable service with minimal maintenance.

Features

- Heavy pattern cast brass construction
- Solid cast brass mounting flange with enclosed screw holes
- Available either satin nickel plated or polished chrome finish
- Solid brass operating stem
- Cast aluminum handle assembly with stainless steel mounting screw
- AFG teflon with graphite packing
- Female iron pipe inlet connections, sweat connection on C-137
- 3/4" garden hose connection outlet
- Solid brass stem with ACME threads and 1/4" L bibb washer

Ordering

C-135NP.50

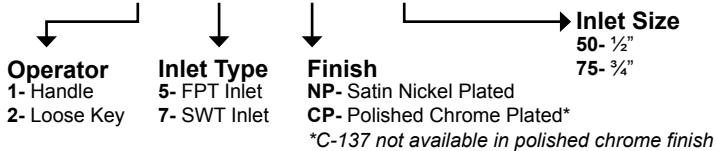

Replacement Parts

ID	Part No.	Description
1	231-0001	Stem Assembly, Rod (Brass)
2	300-1008	Valve Stem Cap (Nickel Plated)
2	300-1013	Valve Stem Cap (Polished Chrome)
3	C-134KT-805	Oval Handle and Screw Kit (Aluminum)
3	C-135KT-805	Oval Handle and Screw Kit (Polished Chrome)
4	C-135KT-802	Seat Washer Kit, 1/4" Beveled
5	C-134KT-803	Stem Packing Kit
6	390-1001	Packing Only
7	C-108KT-808	Loose Key on Lanyard
8	310-1015	Extended Valve Stem Cap (Nickel Plated)
8	310-1019	Extended Valve Stem Cap (Polished Chrome)
	C-134KT-804	Loose Key Conversion Kit, Contains: 5, 7, 8





4515 East 139th Street  
Grandview, MO 64030  
(800) 362-9055  
Fax (800) 362-1463  
www.PRIER.com

# Heavy Pattern Hose Bibbs



- Heavy Pattern
- Solid Cast Brass
- Satin Nickel Chromium Finish
- Stuffing Box Design Available

The PRIER C-138 Heavy Pattern Hose Bibbs are for installation in non-freezing areas such as basements, garages and for outdoor installations in mild climates. The heavy pattern design with solid brass stem assures years of reliable service with minimal maintenance. Stuffing box design is available for additional protection.

- Heavy pattern cast brass construction
- Satin nickel chromium finish
- Solid brass operating stem
- Inlet available 1/2" MPT x 1/2" female sweat or 3/4" MPT x 1/2" female sweat
- 3/4" garden hose connection outlet
- C-238 shipped with operating key

## C-138NP.50

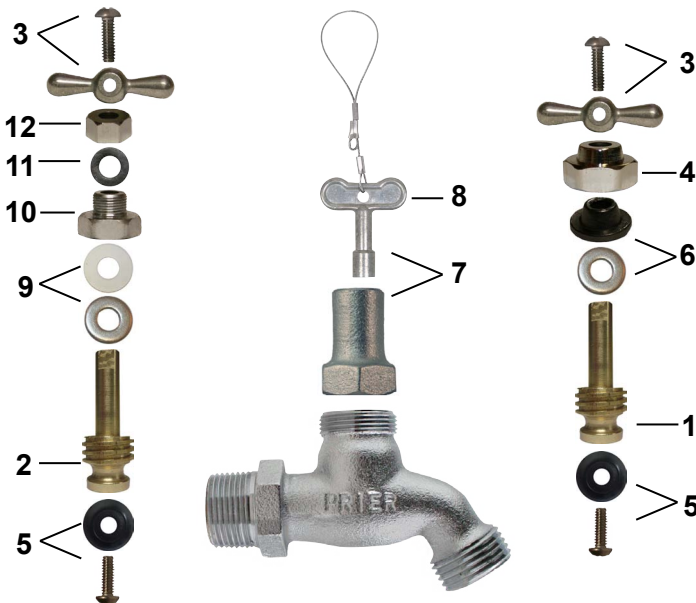

ID	Part No.	Description
1, 5	231-0001	Stem Assembly (C-138)
2, 5	231-0002	Stem Assembly (C-138ST)
3	C-138KT-801	T-Handle and Screw Kit
4	310-1012	Packing Nut (C-138)
5	C-135KT-802	Seat Washer Replacement Kit
6	C-134KT-803	Packing Kit (C-138)
6, 7, 8	C-134KT-804	Loose Key Conversion Kit
8	C-108KT-808	Loose Key on Lanyard
9	390-0001	Packing Only
10	310-0005	Packing Nut (C-138ST)
11	393-0001	Stuffing Box Packing (C-138ST)
12	310-0006	Stuffing Box (C-138ST)



4515 East 139th Street  
Grandview, MO 64030  
(800) 362-9055  
Fax (800) 362-1463  
www.PRIER.com

# Anti-Siphon Angle Sill Faucets

With Integral P-002 Vacuum Breaker



- Commercial
- Anti-Siphon
- Backflow Check Valve
- Optional Hydrant Box



PRIER's anti-siphon angle sill faucets are designed for areas that require water service with an anti-siphon back-flow check valve connection, but are not subject to freezing temperatures. Typical installations include outdoor connections in mild climates or any indoor installation for residential, commercial, institutional and industrial applications. The heavy pattern design with solid brass stem assures years of reliable service with minimal maintenance. The faucets also have a powder coated non-ferrous metal handle or operating key on loose key vandlaproof sill faucets. An optional valve box is available in either satin nickel or brass finish.

- Heavy pattern cast brass construction with solid cast brass mounting flange with enclosed screw holes
- Optional heavy patterned casted brass valve box in satin nickel or brass finish
- Satin nickel plated or polished chrome body
- Powder coated non-ferrous metal handle or operating key on loose key vandalproof sill faucets
- Stainless steel seat washer screw and handle screw
- Full circle ACME threads on stem assembly with standard 1/4" L size seat washer
- Lock shield cap
- AFG teflon with graphite packing
- P-002 vacuum breaker backflow check valve approved under ASSE 1011

Angle Sill Faucet Only

## C-155NP.50

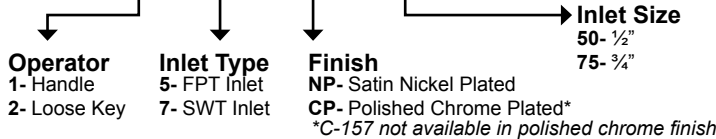

Optional Hydrant Box

## C-155BX1

- Box Finish
- 1- Satin Nickel Plated
  - 2- Rough Brass

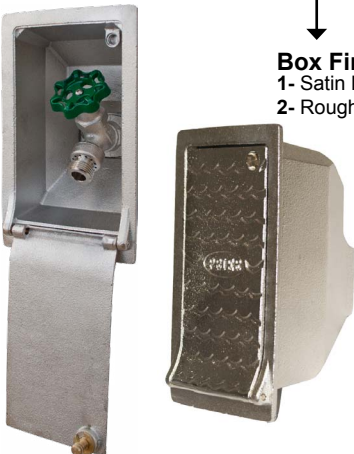



4515 East 139th Street  
Grandview, MO 64030  
(800) 362-9055  
Fax (800) 362-1463  
www.PRIER.com

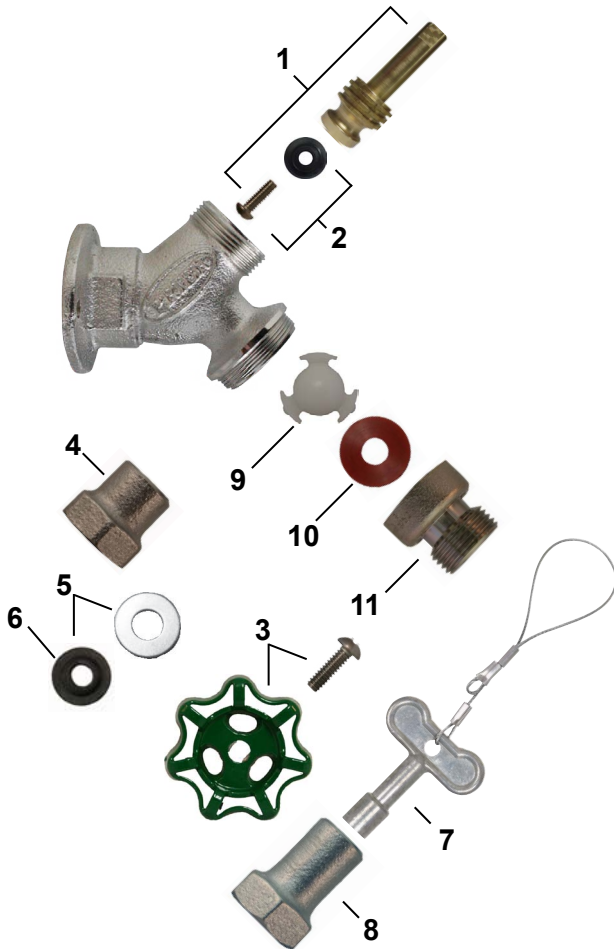

ID	Part No.	Description
1	231-0001	Stem Assembly (Brass) Rod
2	C-135KT-802	1/4" Beveled Seat Washer Kit
3	C-134KT-805	Handle and Screw Kit (Aluminum Lacquered Green)
	C-135KT-805	Handle and Screw Kit (Polished Chrome Plated Aluminum)
4	300-1008	Valve Stem Cap (Nickel Plated)
	300-1013	Valve Stem Cap (Polished Chrome Plated)
5	C-134KT-803	Stem Packing Kit
6	390-1001	Packing Only
7	C-108KT-808	Loose Key on Lanyard
8	310-1015	Extended Valve Stem Cap (Nickel Plated)
	310-1019	Extended Valve Stem Cap (Polished Chrome Plated)
9	337-0002	Check Spider (Acetal)
10	336-0006	Stepped Washer (Silicone)
11	310-0018	Vacuum Breaker Hose Piece
	C-434KT-906	Vacuum Breaker Assembly, Contains: 9, 10, 11
	C-134KT-804	Loose Key Conversion Kit, Contains: 5, 7, 8



4515 East 139th Street  
Grandview, MO 64030  
(800) 362-9055  
Fax (800) 362-1463  
www.PRIER.com

Anti-Siphon Hose Bibbs

With Integral P-002 Vacuum Breaker



- Commercial
- Anti-Siphon
- Backflow Check Valve
- Solid Cast Brass



PRIER Anti-Siphon Hose Bibbs are designed for areas that require water service with an anti-siphon backflow check valve connection, but are not subject to freezing temperatures. Typical installations include outdoor connections in mild climates or any indoor installation for residential, commercial, institutional and industrial applications.

- Heavy pattern cast brass construction
- Satin nickel chromium finish
- Vandalproof lock shield cap on C-258 model
- Diecast aluminum t-handle or operating key on loose key hose bibbs
- Stainless steel seat washer screw and handle screw
- Full circle ACME threads on stem assembly with standard 1/4" L size seat washer
- AFG teflon with graphite packing
- P-002 vacuum breaker backflow check valve approved under ASSE 1011 and CSA B64.2

C-158NP.50

Operator  
1- Handle  
2- Loose Key

Finish  
NP- Satin Nickel Plated  
ST- Nickel Chrome Plated, Stuffing Box Packing

Inlet Size  
50- 1/2"  
75- 3/4"

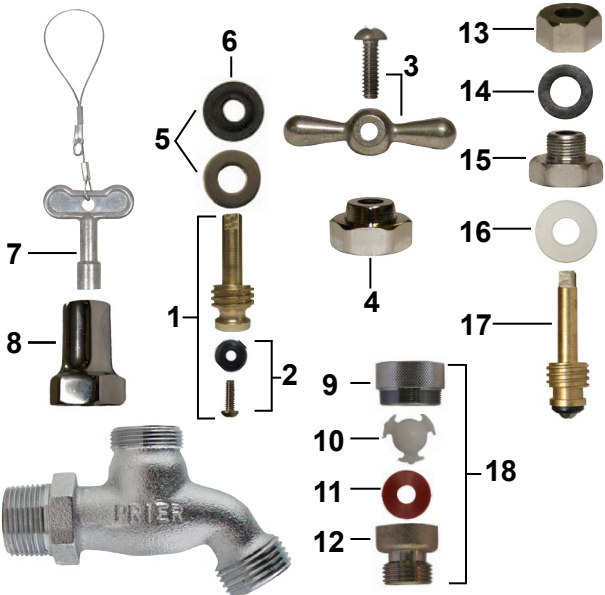

ID	Part No.	Description
1	231-0001	Stem Assembly, Rod (Brass)
2	C-134KT-802	Seat Washer Kit, 1/4" Beveled
3	C-138KT-801	T-Handle and Screw Kit
4	310-1012	Valve Stem Cap
5	C-134KT-803	Stem Packing Kit
6	390-1001	Packing Only
7	C-108KT-808	Loose Key on Lanyard
8	310-1019	Extended Valve Stem Cap (Polished Chrome)
9	310-0023	P-002 Adapter
10	337-0002	Check Spider (Acetal)
11	336-0006	Stepped Washer (Silicone)
12	310-0018	Vacuum Breaker Hose Piece
13	310-0006	Stuffing Box (C-158ST)
14	393-0001	Stuffing Box Packing (C-158ST)
15	310-0005	Packing Nut (C-158ST)
16	390-0001	Packing Spacer (C-158ST)
17	231-0002	Stem Assembly (C-158ST)
18	P-002CP	Hose End Vacuum Breaker
	C-434KT-906	Vacuum Breaker Assembly, Contains, 10, 11, 12
	C-134KT-804	Loose Key Conversion Kit, Contains: 5, 7, 8





4515 East 139th Street  
Grandview, MO 64030  
(800) 362-9055  
Fax (800) 362-1463  
www.PRIER.com

**Page 58** 20 Series Heavy Pattern Globe Valves  
**Page 59** 34 Series Heavy Pattern Brass Sillcocks  
**Page 60** 44 Series Heavy Pattern Brass Hose Bibbs  
**Page 61** 526 Series Heavy Pattern Boiler Drains

## P-002 Vacuum Breaker



- Anti-Siphon
- Backflow Check Valve
- Breakaway Set Screw



Part No.	Description	Carton Qty	Carton Wt
P-002CP	ASSE 1011 Anti-Siphon VB and Backflow Check Valve (Chrome)	36	10 lbs
P-002NP	ASSE 1011 Anti-Siphon VB and Backflow Check Valve (Nickel)	36	10 lbs

## P-003 Vacuum Breaker

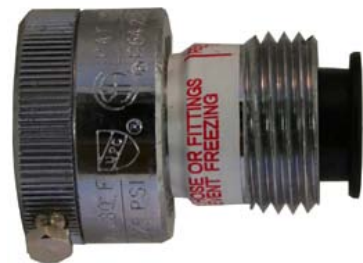

- Self-Draining
- Anti-Siphon
- Backflow Check Valve
- Breakaway Set Screw



Part No.	Description	Carton Qty	Carton Wt
P-003CP	ASSE 1011 Self Draining, Anti-Siphon VB and Backflow Check Valve (Chrome)	36	12 lbs

## P-004 Double Check Vacuum Breaker



- Anti-Siphon
- Double Check
- Dual Backflow Check Valves
- Breakaway Set Screw



Part No.	Description	Carton Qty	Carton Wt
P-004CP	ASSE 1052 VB & Backflow Check Valve-Double Check (Chrome)	36	10 lbs
P-004NP	ASSE 1052 VB and Backflow Check Valve-Double Check (Nickel)	36	10 lbs

**PLUMBING**  
**BRASS**



4515 East 139th Street  
Grandview, MO 64030  
(800) 362-9055  
Fax (800) 362-1463  
www.PRIER.com



4515 East 139th Street  
Grandview, MO 64030  
(800) 362-9055  
Fax (800) 362-1463  
www.PRIER.com

# Heavy Pattern Globe Valves

## Lead Free Mansfield Style 20 and 22 Series



- Lead free
- Heavy pattern casted red brass construction
- Solid brass operating stem
- Large unobstructed waterways for greater flow rates
- Cast metal handle assembly with brass mounting screw
- Red, blue or green operating handle options
- Packing nut design for years of reliable life
- AFG teflon with graphite packing
- Female and SWT iron pipe inlet connections
- Solid brass fast-travel stem with ACME threads
- Stop and waste option available
- Each valve individually air-tested

## Replacement Parts

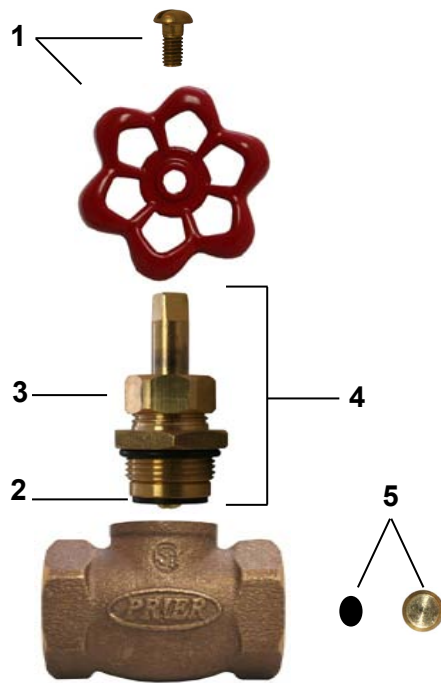

20.40-B

Waste Option  
0- No Waste Option  
2- Stop & Waste Design

Inlet  
40- 1/2" FIP  
41- 1/2" SWT  
60- 3/4" FIP  
61- 3/4" SWT

Handle Option  
None- Red  
B- Blue  
G- PRIER Green

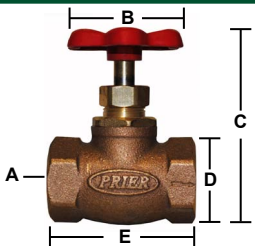

Part No.	A	B	C (Closed)	C (Open)	D	E	ID	Part No.	Description
20.40	1/2" FIP	1.9"	2.6"	3"	1.3"	2.2"	1	630-0045	Handle and Screw Kit
20.41	1/2" SWT	1.9"	2.6"	2.9"	0.8"	2.2"	2	630-0047	Bibb Washer and Screw Kit
20.60	3/4" FIP	1.9"	2.9"	3.2"	1.4"	2.3"	3	339-3003	Packing Only
20.61	3/4" SWT	1.9"	2.7"	3"	1"	2.6"	4	231-3101	Stem Assembly Complete
22.40	1/2" FIP	1.9"	2.7"	3"	1.3"	2.2"	5	22.00-KT1	Cap and Seal for Stop and Waste
22.41	1/2" SWT	1.9"	2.5"	2.9"	0.8"	2.2"		630-0043	Service Kit for Stop Valves, Contains: 1, 2, 3
22.60	3/4" FIP	1.9"	2.9"	3.2"	1.4"	2.3"			
22.61	3/4" SWT	1.9"	2.8"	3"	1"	2.6"			

# Heavy Pattern Brass Sillcocks

## Mansfield Style 34 Series



- Heavy pattern casted red brass construction
- Solid brass operating stem
- Large unobstructed waterways for greater flow rates
- Cast metal handle assembly with brass mounting screw
- Red, blue or green operating handle options
- Packing nut design for years of reliable life
- AFG teflon with graphite packing
- Available with integral vacuum breaker
- Female and SWT iron pipe inlet connections
- 3/4" garden hose connection outlet
- Solid brass fast-travel stem with ACME threads
- Each valve individually air-tested

## Replacement Parts

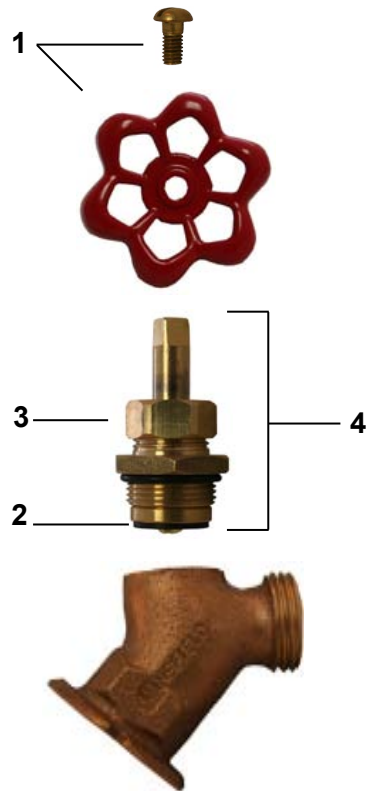

34.40VB-B

Inlet  
40- 1/2" FIP  
60- 3/4" FIP  
67- 1/2" Copper Inside  
or 3/4" Type M Copper  
Outside

VB- Integral Vacuum Breaker

Handle Option  
None- Red  
B- Blue  
G- PRIER Green

ID	Part No.	Description
1	630-0045	Handle and Screw Kit
2	630-0047	Bibb Washer and Screw Kit
3	339-3003	Packing Only
4	231-3101	Stem Assembly Complete
	630-0043	Service Kit for Brass Sillcocks, Contains: 1, 2, 3

Application

Features

Ordering

Rough-In Dimensions

Application

Features

Ordering





4515 East 139th Street  
Grandview, MO 64030  
(800) 362-9055  
Fax (800) 362-1463  
www.PRIER.com

Heavy Pattern Brass Hose Bibbs

Mansfield Style 44 Series



- Heavy pattern casted red brass construction
- Solid brass operating stem
- Large unobstructed waterways for greater flow rates
- Cast metal handle assembly with brass mounting screw
- Red, blue or green operating handle options
- Packing nut design for years of reliable life
- AFG teflon with graphite packing
- Female and SWT iron pipe inlet connections
- 3/4" garden hose connection outlet
- Solid brass fast-travel stem with ACME threads
- Each valve individually air-tested

Replacement Parts

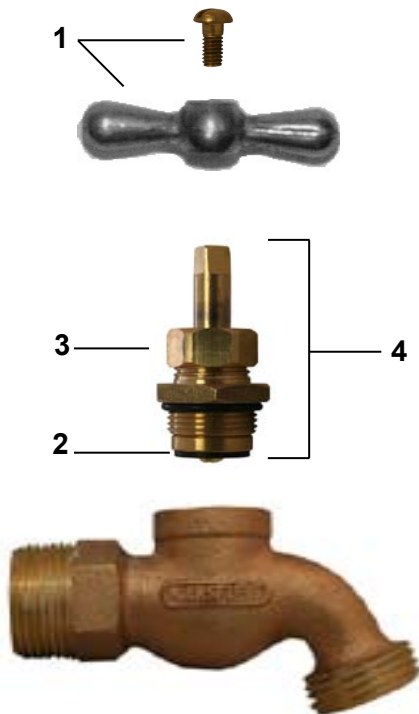

44.42-B

Inlet  
42- 1/2" MIP x 1/2" SWT  
62- 3/4" MIP

Handle Option  
None- Red  
B- Blue  
G- PRIER Green

ID	Part No.	Description
1	630-0046	Handle and Screw Kit
2	630-0047	Bibb Washer and Screw Kit
3	339-3003	Packing Only
4	231-3101	Stem Assembly Complete
	630-0043	Service Kit for Hose Bibbs, Contains: 1, 2, 3



4515 East 139th Street  
Grandview, MO 64030  
(800) 362-9055  
Fax (800) 362-1463  
www.PRIER.com

Heavy Pattern Boiler Drains

Mansfield Style 526 Series



- Heavy pattern casted red brass construction
- Solid brass operating stem
- Large unobstructed waterways for greater flow rates
- Cast metal handle assembly with brass mounting screw
- Red, blue or green operating handle options
- Packing nut design for years of reliable life
- AFG teflon with graphite packing
- Female and SWT iron pipe inlet connections
- 3/4" garden hose connection outlet
- Solid brass fast-travel stem with ACME threads
- Each valve individually air-tested

Replacement Parts

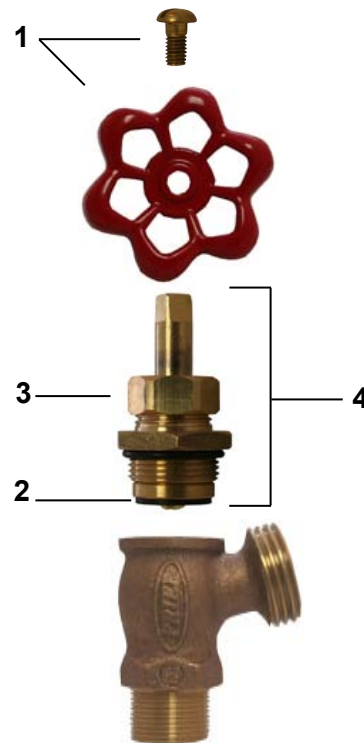

526.40-B

Inlet  
40- 1/2" FIP  
42- 1/2" MIP x 1/2" SWT  
43- 1/2" Compression  
62- 3/4" MIP

Handle Option  
None- Red  
B- Blue  
G- PRIER Green

ID	Part No.	Description
1	630-0045	Handle and Screw Kit
2	630-0047	Bibb Washer and Screw Kit
3	339-3003	Packing Only
4	231-3101	Stem Assembly Complete
	630-0043	Service Kit for Boiler Drains, Contains: 1, 2, 3

Page 63

A-110 Cast Iron Shower Drain

Page 64

B-102 Cast Iron Shower Drain With Trap

Page 65

B-110 Cast Iron Shower Drain

Page 66

C-121 Cast Brass Closet Floor Flange

Page 67

C-200 Cast Brass Cleanout Plug

Page 68

C-212 Brass Sinkwaste

Page 69

C-330 Floor and Wall Covers

Page 70

C-342 Cast Brass Backwater Valve

Page 70

C-162 4-Way Loose Key Wrench

Page 70

C-10 Series Wheel Handle

Page 71

P-310 Cast Brass Shower Drain

Page 72

P-312 Angle Style Brass Shower Drain

Page 73

P-325 Floor Drain Covers



4515 East 139th Street  
Grandview, MO 64030  
(800) 362-9055  
Fax (800) 362-1463  
www.PRIER.com

Application

A-110 Series Cast Iron Shower Drain

With P-315 Brass Strainer



- Cast Iron Body
- 4 1/2" Cast Brass Strainer
- Threaded Cast Iron Clamping Ring
- Available with 2" FPT or 2" Inside Caulk Inlet

Ordering

A-110CL-012

Inlet  
CL- 2" Caulk Type  
FE- 2" Female Pipe Thread

Strainer  
012- Chrome Plated Brass  
013- Polished Brass

Rough-In Dimensions

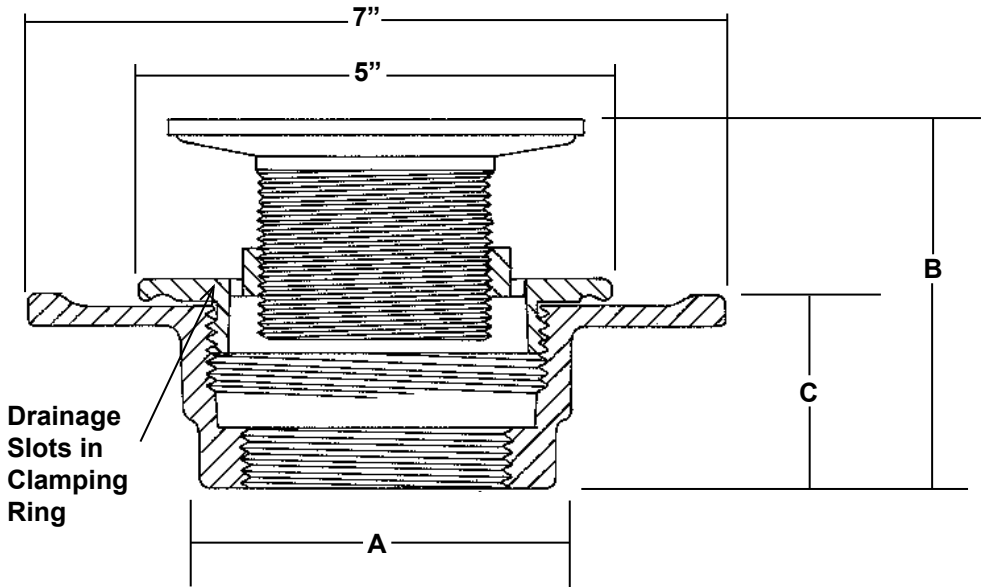

	2" FPT Inlet	2" Caulk Inlet
"A" Length	2 7/8"	3 5/8"
"B" Maximum Length	4 5/16"	4 1/2"
"B" Minimum Length	3"	3 3/16"
"C" Length	2"	2 3/16"





4515 East 139th Street  
Grandview, MO 64030  
(800) 362-9055  
Fax (800) 362-1463  
www.PRIER.com

## B-102 Series Cast Iron Shower Drain With Trap

With P-315 Brass Strainer



- Cast Iron Body With Trap
- 4 1/2" Cast Brass Strainer
- 2" FPT Inlet
- Bolt-Down Cast Iron Clamping Ring

B-102-012

Strainer  
012- Chrome Plated Brass  
013- Polished Brass

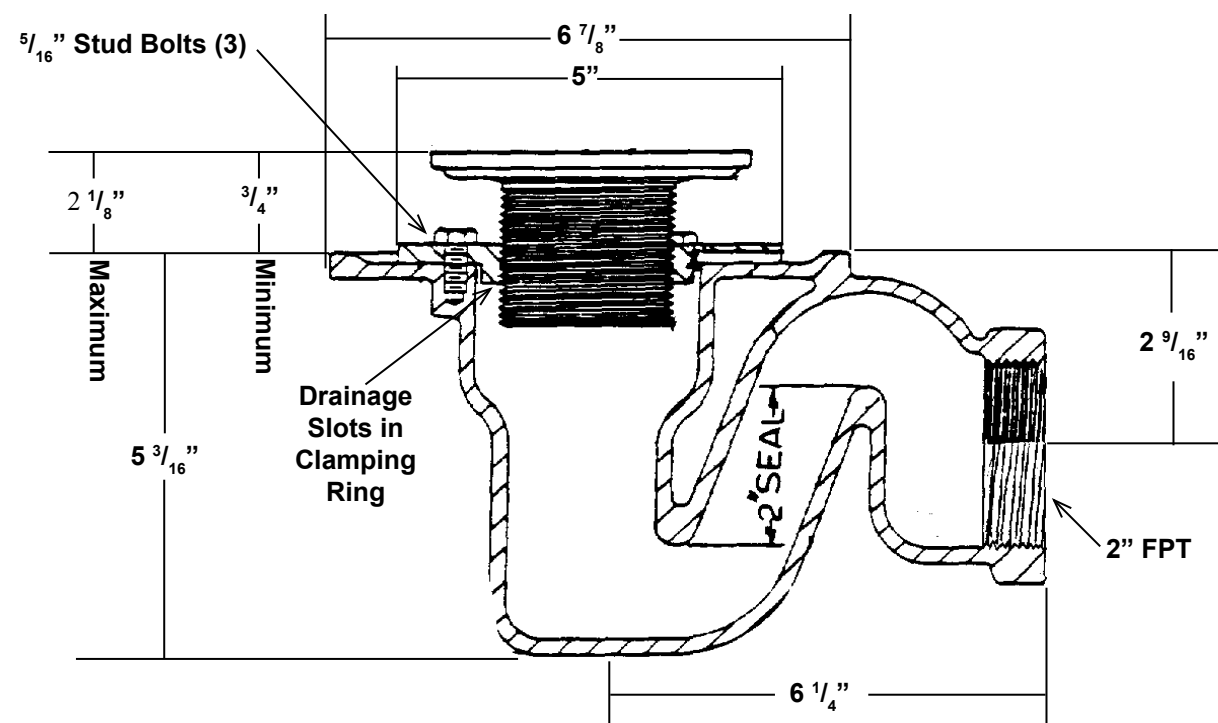

Application

Ordering

Rough-In Dimensions



4515 East 139th Street  
Grandview, MO 64030  
(800) 362-9055  
Fax (800) 362-1463  
www.PRIER.com

## B-110 Series Cast Iron Shower Drain

With P-315 Brass Strainer



- Cast Iron Body
- 4 1/4" Cast Brass Strainer
- Threaded Cast Iron Clamping Ring
- Bolt-Down Cast Iron Clamping Ring

B-110CL-012

Inlet  
CL- 2" Caulk Type  
FE- 2" Female Pipe Thread  
PL- 2" Plain End-No Hub

Strainer  
012- Chrome Plated Brass  
013- Polished Brass

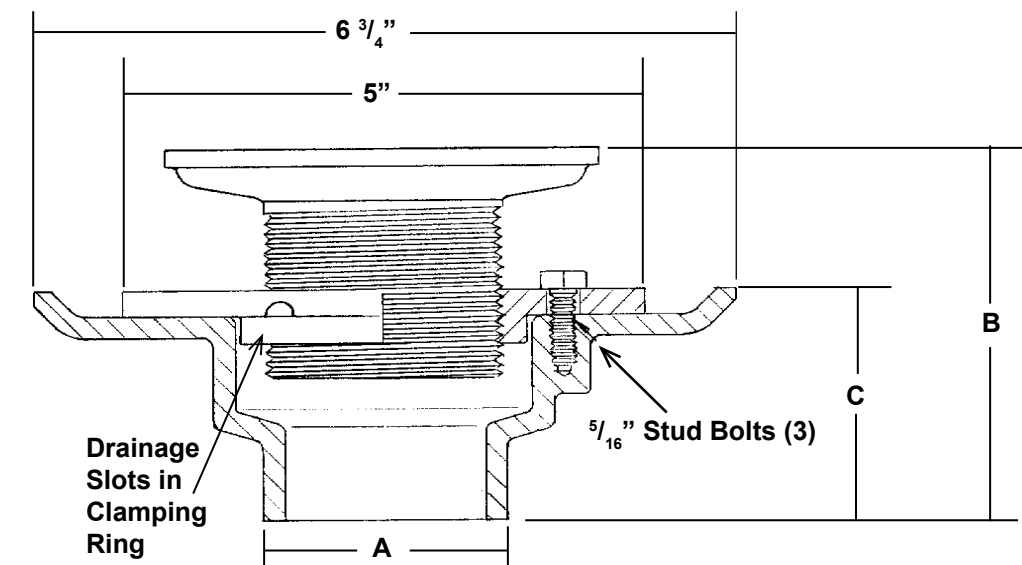

	2" FPT Inlet	2" Caulk Inlet	2" No Hub
"A" Length	3 1/4"	3 1/4"	2 5/16"
"B" Maximum Length	4 5/16"	4 1/2"	5 3/16"
"B" Minimum Length	3"	3 3/16"	4 1/16"
"C" Length	2"	2 3/16"	2 9/16"

Application

Ordering

Rough-In Dimensions



4515 East 139th Street  
Grandview, MO 64030  
(800) 362-9055  
Fax (800) 362-1463  
www.PRIER.com

C-121 Series Cast Brass Closet Floor Flange

C-121 #1

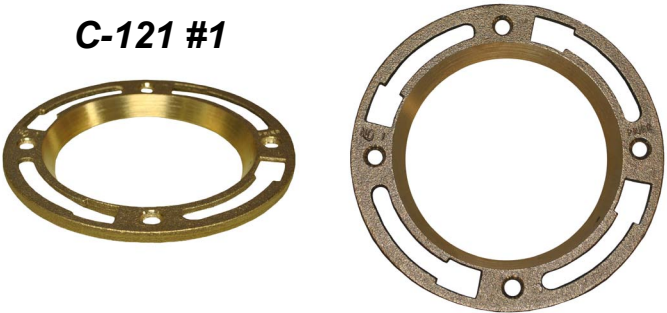

- Heavy Pattern Cast Brass
- 4" Pipe Size
- 9/16" Collar
- Wiping Surface Machined
- Recessed Groove for Bolt Heads
- Four 5/16" Bolt Slots
- Meets ASME/ANSI B16-23

Part No.	Description	Carton Qty	Carton Wt
C-121-01	Cast Brass Closet Flange; #1	24	24 lbs

C-121 #4



- Heavy Pattern Cast Brass
- Replacement type for 4" Pipe
- Extra Deep 1 1/8" Collar
- Wiping Surface Machined
- Recessed Groove for Bolt Heads
- Four 5/16" Bolt Slots
- Meets ASME/ANSI B16-23

Part No.	Description	Carton Qty	Carton Wt
C-121-04	Cast Brass Closet Flange; #4	24	32 lbs

C-121 #6

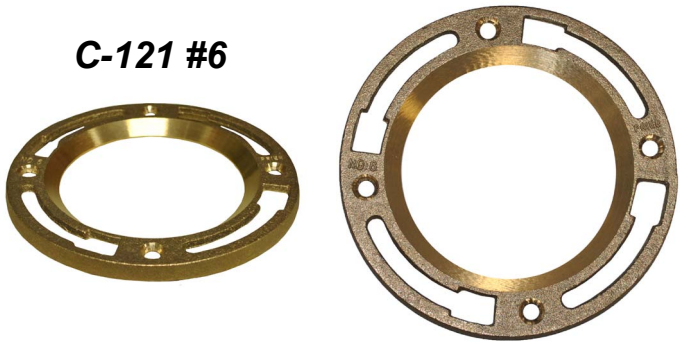

- Heavy Pattern Cast Brass
- Flat type for 4" Pipe
- 3/8" Deep Collar
- Wiping Surface Machined
- Recessed Groove for Bolt Heads
- Four 5/16" Bolt Slots
- Meets ASME/ANSI B16-23

Part No.	Description	Carton Qty	Carton Wt
C-121-06	Cast Brass Closet Flange; #6	24	26 lbs



4515 East 139th Street  
Grandview, MO 64030  
(800) 362-9055  
Fax (800) 362-1463  
www.PRIER.com

C-200/C-201 Series Cast Brass Cleanout Plug



- Cast Brass
- Precision Machined
- Available with 1/4"-20 Tapping

Part No.	Description	Carton Qty	Carton Wt
C-200-112	1 1/2" brass cleanout plug, countersunk	24	6 lbs
C-200-2	2" brass cleanout plug, countersunk	24	7 lbs
C-200-212	2 1/2" brass cleanout plug, countersunk	24	9 lbs
C-200-3	3" brass cleanout plug, countersunk	24	10 lbs
C-200-312	3 1/2" brass cleanout plug, countersunk	24	12 lbs
C-200-4	4" brass cleanout plug, countersunk	24	15 lbs
C-200-5	5" brass cleanout plug, countersunk	24	26 lbs
C-200-6	6" brass cleanout plug, countersunk	24	35 lbs
C-201-1	1" brass cleanout plug, raised head	24	5 lbs
C-201-114	1 1/4" brass cleanout plug, raised head	24	5 lbs
C-201-112	1 1/2" brass cleanout plug, raised head	24	6 lbs
C-201-2	2" brass cleanout plug, raised head	24	7 lbs
C-201-212	2 1/2" brass cleanout plug, raised head	24	8 lbs
C-201-3	3" brass cleanout plug, raised head	24	11 lbs
C-201-312	3 1/2" brass cleanout plug, raised head	24	13 lbs
C-201-4	4" brass cleanout plug, raised head	24	16 lbs
C-201-5	5" brass cleanout plug, raised head	24	28 lbs
C-201-6	6" brass cleanout plug, raised head	24	37 lbs
C-200DR-112	1 1/2" brass plug, countersunk, drilled and tapped	24	6 lbs
C-200DR-2	2" brass plug, countersunk, drilled and tapped	24	7 lbs
C-200DR-212	2 1/2" brass plug, countersunk, drilled and tapped	24	9 lbs
C-200DR-3	3" brass plug, countersunk, drilled and tapped	24	10 lbs
C-200DR-312	3 1/2" brass plug, countersunk, drilled and tapped	24	12 lbs
C-200DR-4	4" brass plug, countersunk, drilled and tapped	24	15 lbs
C-200DR-5	5" brass plug, countersunk, drilled and tapped	24	26 lbs
C-200DR-6	6" brass plug, countersunk, drilled and tapped	24	35 lbs
C-201DR-1	1" brass plug, raised head, drilled and tapped	24	5 lbs
C-201DR-114	1 1/4" brass plug, raised head, drilled and tapped	24	5 lbs
C-201DR-112	1 1/2" brass plug, raised head, drilled and tapped	24	6 lbs
C-201DR-2	2" brass plug, raised head, drilled and tapped	24	7 lbs
C-201DR-212	2 1/2" brass plug, raised head, drilled and tapped	24	8 lbs
C-201DR-3	3" brass plug, raised head, drilled and tapped	24	11 lbs
C-201DR-312	3 1/2" brass plug, raised head, drilled and tapped	24	13 lbs
C-201DR-4	4" brass plug, raised head, drilled and tapped	24	16 lbs
C-201DR-5	5" brass plug, raised head, drilled and tapped	24	28 lbs
C-201DR-6	6" brass plug, raised head, drilled and tapped	24	35 lbs





4515 East 139th Street  
Grandview, MO 64030  
(800) 362-9055  
Fax (800) 362-1463  
www.PRIER.com

### C-212 1" Brass Sinkwaste



- Heavy Pattern Cast Brass
- Brass Plug
- Available Chrome Plated or Brass
- Includes Tailpiece, Washers and Nuts
- Brass or Nickel Pull Ring

Part No.	Description	Carton Qty	Carton Wt
C-212BR	1" Brass Sinkwaste with Tailpiece, Brass Finish	24	20 lbs
C-212CP	1" Brass Sinkwaste with Tailpiece, Chrome Plated	24	20 lbs
C-212BR-011	1" Brass Sinkwaste Body & Locknut Only, Brass Finish	24	14 lbs
C-212CP-011	1" Brass Sinkwaste Body & Locknut Only, Chrome Plated	24	14 lbs
C-212ST	10" Standpipe for C-212	EA	
400-0015	Locknut, Brass for C-212	EA	
400-0016	Coupling Nut, Brass for C-212	EA	

### C-210 1 1/2" Brass Sinkwaste

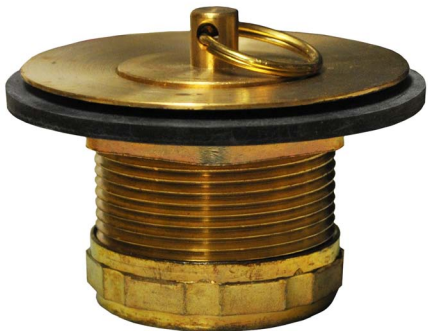

- Heavy Pattern Cast Brass
- Brass Plug
- Available Chrome Plated or Brass
- Includes Washers and Nut
- Brass or Nickel Pull Ring

Part No.	Description	Carton Qty	Carton Wt
C-210BR	1 1/2" Sinkwaste Unit, Brass Finish	24	22 lbs
C-210CP	1 1/2" Sinkwaste Unit, Chrome Plated	24	22 lbs
405-0002	1 1/2" Locknut for C-210	EA	



4515 East 139th Street  
Grandview, MO 64030  
(800) 362-9055  
Fax (800) 362-1463  
www.PRIER.com

### C-330 Series Floor and Wall Covers



- Heavy Duty Stainless Steel
- Floor Covers:  
14 Gauge (.080 thick)
- Wall Covers:  
22 Gauge (.030 thick)
- Polished Mirror Finish on  
Floor and Wall Covers

Application

Ordering

Part No.	Description	Carton Qty	Carton Wt
C-330FL03	3" Stainless Steel Floor Cover	24	4 lbs
C-330FL04	4" Stainless Steel Floor Cover	24	6 lbs
C-330FL05	5" Stainless Steel Floor Cover	24	9 lbs
C-330FL06	6" Stainless Steel Floor Cover	24	12 lbs
C-330FL08	8" Stainless Steel Floor Cover	24	22 lbs
C-330FL10	10" Stainless Steel Floor Cover	24	40 lbs
C-330WL03	3" Stainless Steel Wall Cover	24	3 lbs
C-330WL04	4" Stainless Steel Wall Cover	24	4 lbs
C-330WL05	5" Stainless Steel Wall Cover	24	6 lbs
C-330WL06	6" Stainless Steel Wall Cover	24	8 lbs
C-330WL08	8" Stainless Steel Wall Cover	24	10 lbs
C-330WL10	10" Stainless Steel Wall Cover	24	16 lbs
914-2500-02.25	1/4"-20 x 2 1/4" Bolt-Stainless Steel	24	1 lb
914-2500-04	1/4"-20 x 4" Bolt-Stainless Steel	24	2 lbs
914-2500-06	1/4"-20 x 6" Bolt-Stainless Steel	24	3 lbs

#### Extension Cover Kits

Part No.	Wall Cover Size	C-Sunk Plug Size	Bolt Length	Carton Qty	Carton Wt
C-330KT-3	3"	1 1/2"	2 1/4"	12	5 lbs
C-330KT-4	4"	2"	2 1/4"	12	6 lbs
C-330KT-6	6"	3"	2 1/4"	12	8 lbs
C-330KT-8	8"	4"	2 1/4"	12	14 lbs



4515 East 139th Street  
Grandview, MO 64030  
(800) 362-9055  
Fax (800) 362-1463  
www.PRIER.com

# C-342 Series Cast Brass Backwater Valve



- Precision Machined Cast Brass
- Backwater Valve Unit Complete with Float Ball and Sealing O-Ring or Spud Washer Gasket
- For Insertion in Existing or Newly Installed Drains

Part No.	Description	Carton Qty	Carton Wt
C-342OR	2" Brass Backwater Valve complete with O-Ring Seal	24	15 lbs
C-342SP	2" Brass Backwater Valve complete with Spud Washer Seal	24	15 lbs
430-0001	Plastic Float Ball for 2" C-342	EA	

# C-162 Series 4-Way Loose Key Wrench

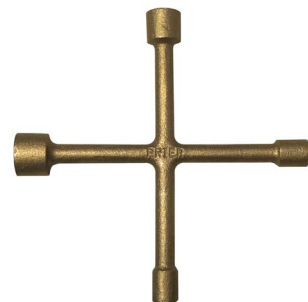

- Heavy Pattern Cast Brass
- Designed for PRIER Oval Style Stems and Standard Square Stems

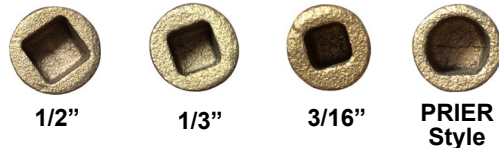

Part No.	Description	Carton Qty	Carton Wt
C-162	4-Way Loose Key Wrench for 3/16", 1/3", 1/2" or oval connections	72	40 lbs

# C-10 Series Wheel Handle



- 3/8" Square Key Rod
- 3 3/4" Diameter
- Shipped with Set Screw

Part No.	Description	Carton Qty	Carton Wt
C-10	Large Diameter Wheel Handle	72	14 lbs



4515 East 139th Street  
Grandview, MO 64030  
(800) 362-9055  
Fax (800) 362-1463  
www.PRIER.com

# P-310/P-311 Series Cast Brass Shower Drain

## Type Q Shower Stall Drain



- Cast Brass Body
- For Installation Into Preformed Shower Stalls
- 2" FPT or 2" Inside Caulk
- Compression Gasket Tightened with Inner Nut on P-311
- Stainless Steel or Polished Brass Strainer

## P-310CL-SS

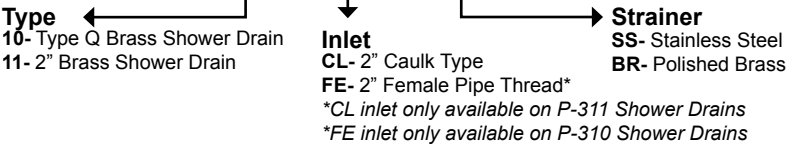

Part No.	Description	Carton Qty	Carton Wt
P-310FE-SS	Type Q Brass Shower Drain; 2" FPT, Stainless Steel Strainer	24	30 lbs
P-310FE-BR	Type Q Brass Shower Drain; 2" FPT, Polished Brass Strainer	24	30 lbs
P-311CL-SS	2" Brass Shower Drain; 2" Caulk with Adapter, Compression Nut and Key, Stainless Steel Strainer	24	32 lbs
P-311CL-BR	2" Brass Shower Drain; 2" Caulk with Adapter, Compression Nut and Key, Polished Brass Strainer	24	32 lbs
420-0001	Polished Brass Snap-in Strainer Only for P-310, P-311, P-312 Drains	EA	
424-0002	Stainless Steel Snap-in Strainer Only for P-310, P-311, P-312 Drains	EA	





4515 East 139th Street  
Grandview, MO 64030  
(800) 362-9055  
Fax (800) 362-1463  
www.PRIER.com

## P-312 Series Angle Style Brass Shower Drain

### Low Profile Type Q Angle Style



- Cast Brass Body
- For installation into preformed shower stalls
- Designed for installation requiring low clearance and side outlet
- Stainless Steel or Polished Brass Strainer

PRIER P-312 Angle Style Shower Drain is designed for use in preformed shower bases. Its low profile and side outlet make this 2" drain ideal for many flexible installation applications. The cast brass body ensures years of reliable service. The P-312 is available with either a stainless steel or polished brass circular design snap-in strainer.

Part No.	Description	Carton Qty	Carton Wt
P-312SW-SS	Type Q Elbow Shower Drain, Stainless Steel Strainer, 2" SWT Connection	24	60 lbs
P-312SW-BR	Type Q Elbow Shower Drain, Polished Brass Strainer, 2" SWT Connection	24	60 lbs
P-312H-SS	Type Q Elbow Shower Drain, Tall Stainless Steel Strainer, 2" SWT Connection	8	25.5 lbs
P-312H-BR	Type Q Elbow Shower Drain, Tall Polished Brass Strainer, 2" SWT Connection	8	25.5 lbs

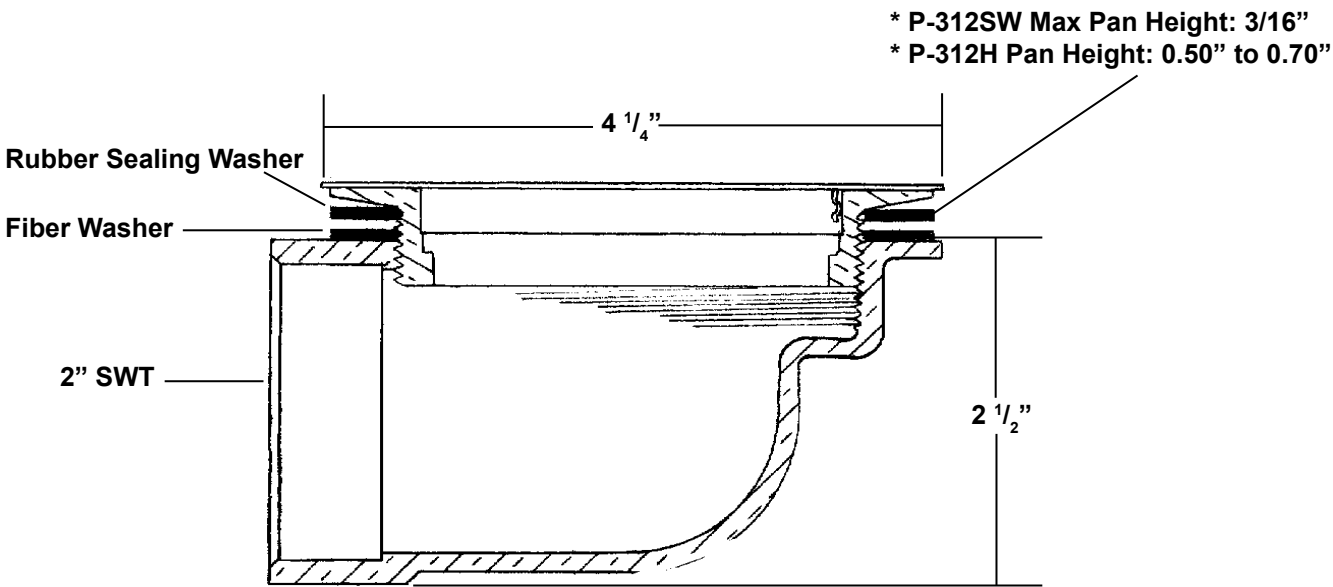

4515 East 139th Street  
Grandview, MO 64030  
(800) 362-9055  
Fax (800) 362-1463  
www.PRIER.com

## P-325 Series Floor Drain Covers



- Heavy Pattern Cast Iron
- Medium Duty
- Green Enamel Painted
- Screwholes Available Upon Request
- Custom sizes from 4 1/2" to 12" available

Part No.	Description	Thickness	Carton Qty	Carton Wt
P-325-05	5" Cast Iron Replacement Drain Cover	1/4"	12	14 lbs
P-325-06	6" Cast Iron Replacement Drain Cover	1/4"	12	18 lbs
P-325-614	6 1/4" Cast Iron Replacement Drain Cover	1/4"	12	19 lbs
P-325-612	6 1/2" Cast Iron Replacement Drain Cover	1/4"	12	20 lbs
P-325-658	6 5/8" Cast Iron Replacement Drain Cover	1/4"	12	22 lbs
P-325-634	6 3/4" Cast Iron Replacement Drain Cover	1/4"	12	25 lbs
P-325-07	7" Cast Iron Replacement Drain Cover	1/4"	12	26 lbs
P-325-714	7 1/4" Cast Iron Replacement Drain Cover	1/4"	12	27 lbs
P-325-712	7 1/2" Cast Iron Replacement Drain Cover	1/4"	12	28 lbs
P-325-734	7 3/4" Cast Iron Replacement Drain Cover	1/4"	12	29 lbs
P-325-08	8" Cast Iron Replacement Drain Cover	1/4"	12	32 lbs
P-325-814	8 1/4" Cast Iron Replacement Drain Cover	1/4"	12	36 lbs
P-325-812	8 1/2" Cast Iron Replacement Drain Cover	1/4"	12	48 lbs
P-325-834	8 3/4" Cast Iron Replacement Drain Cover	1/4"	12	46 lbs
P-325-09	9" Cast Iron Replacement Drain Cover	5/16"	6	26 lbs
P-325-914	9 1/4" Cast Iron Replacement Drain Cover	5/16"	6	28 lbs
P-325-912	9 1/2" Cast Iron Replacement Drain Cover	5/16"	6	29 lbs
P-325-934	9 3/4" Cast Iron Replacement Drain Cover	5/16"	6	30 lbs
P-325-10	10" Cast Iron Replacement Drain Cover	5/16"	6	32 lbs
P-325-12	12" Cast Iron Replacement Drain Cover	5/16"	6	44 lbs

Page 75

09 Ballcock

Page 76

190 Straight Pattern Urinal Flush Valve

Page 77

370 Liquid Level Control Valve

Page 78

451 Pressure Relief Valve

Page 78

184 Self-Closing Multi-Purpose Valve

Page 79

C-64 Brass Log Lighter Valve

Page 80

C-67 Brass Log Lighter Ball Valve

Page 81

C-69 Cast Iron Burner Bar

Page 82

C-70 Hearthglow Log Lighter Kits



4515 East 139th Street  
Grandview, MO 64030  
(800) 362-9055  
Fax (800) 362-1463  
www.PRIER.com

Application

Ordering Replacement Parts

### 09 Series Brass Ballcock



PRIER's 09 Ballcock combines the features of an economy brass ballcock with quality to pass the tests of time. It features heavy red brass castings, seamless copper riser, longlife nylon valve seat, a smooth flat seating plunger and cup seal to prevent leaking. The compound lever action assures positive opening and closing at all pressures. The 09 Ballcock has no whine, whistling squealing or rattling. It is precision machined to operate dependably and positively. The 09 is the basis for copied products worldwide.

- Dependable and quiet
- Low cost, high quality ballcock
- Longlife nylon valve seat
- Operates equally well at high or low pressures
- Heavy red brass casting
- Cup seal prevents leaking
- Seamless copper riser pipe
- Overall length: 11 1/2"

Part No.	Description	Carton Qty	Carton Wt
09	09 Ballcock, Boxed	20	23 lbs
09-P	09 Ballcock, Blister View	10	11 lbs

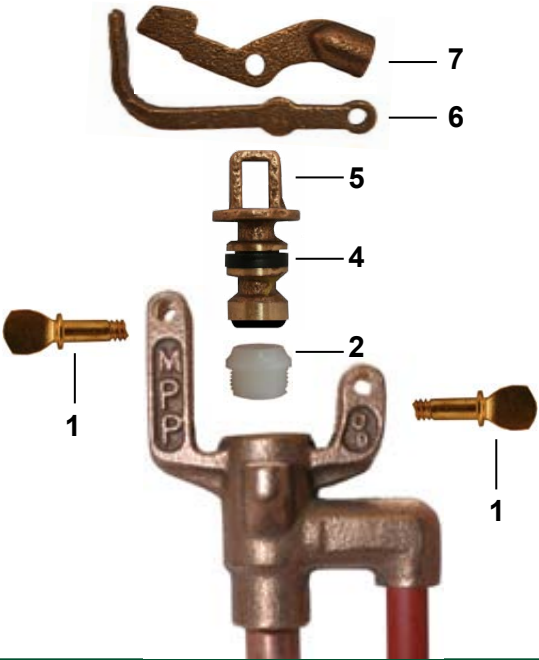

ID	Part No.	Description
1	910-3003	Thumb Screws (Brass), Quantity 2 Required
2	617-3001	Seat (Nylon)
3	636-3003	Valve Seat (Neoprene)
4	636-3002	Cup Seal (Huva)
5	123-5573	Plunger Assembly, Contains: 3, 4
6	600-3009	Lower Lever (Brass)
7	600-3010	Upper Lever (Brass)
	630-7066	Service Kit for 03/09/XQ16, Contains: 1, 2, 3, 4

Service kit 630-7066 for the 09 Ballcock also repairs the discontinued Mansfield 03 and XQ16 ballcocks.





4515 East 139th Street  
Grandview, MO 64030  
(800) 362-9055  
Fax (800) 362-1463  
www.PRIER.com

## 190 Series Straight Pattern Urinal Flush Valve



The 190 Urinal Valve is the industry's finest. It is efficient, dependable, quiet and versatile. With its automatic metering design and balanced cartridge assembly, it operates equally well at high or low pressures. The push button operation resists damage and vandalism.

The 190 features a casted brass body with triple chrome plating for long lasting finish. Each valve is water tested to assure proper operation once installed.

- Cast brass body
- Triple chrome plating
- Low cost, high quality
- Operates equally well at high or low pressures

Part No.	Description	Carton Qty	Carton Wt
190-0	1/2" FNPT Inlet x 3/8" FNPT Outlet Straight Pattern Urinal Flush Valve	10	21 lbs

### Rough-In Dimensions

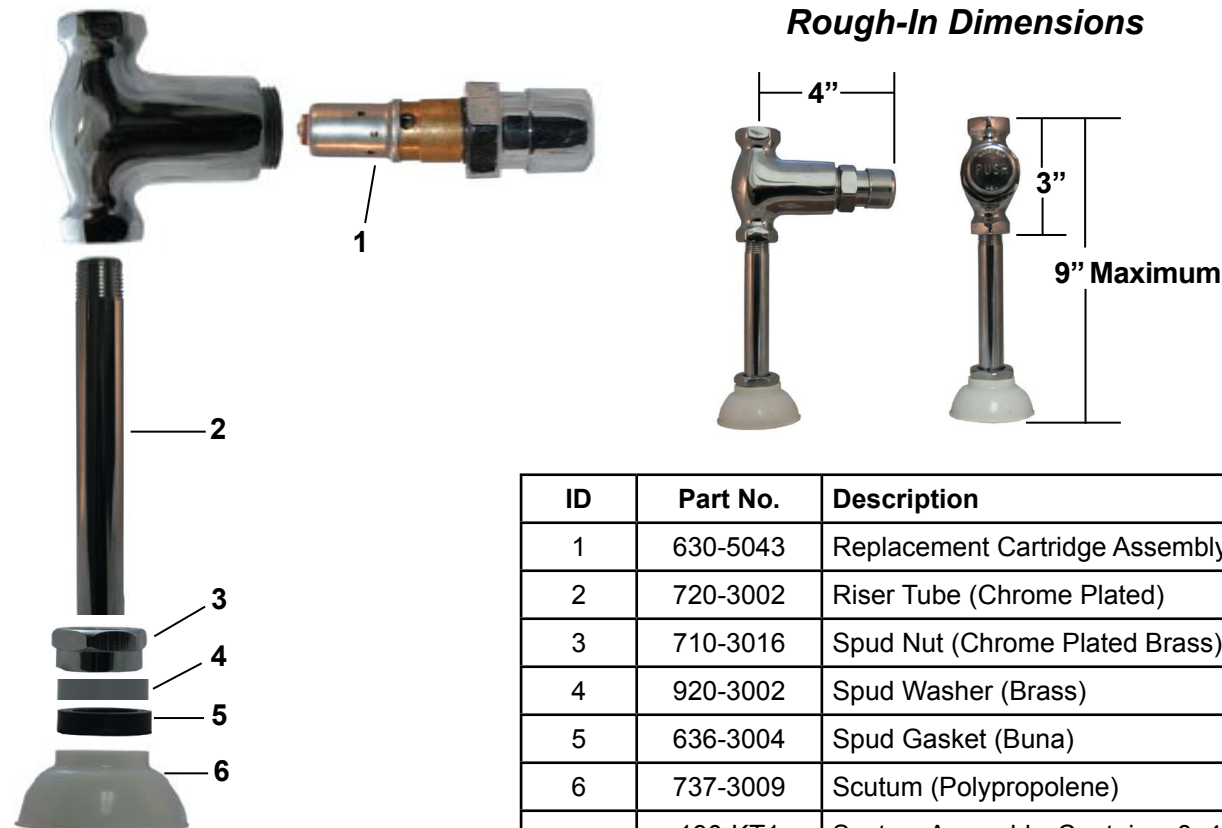

ID	Part No.	Description
1	630-5043	Replacement Cartridge Assembly
2	720-3002	Riser Tube (Chrome Plated)
3	710-3016	Spud Nut (Chrome Plated Brass)
4	920-3002	Spud Washer (Brass)
5	636-3004	Spud Gasket (Buna)
6	737-3009	Scutum (Polypropylene)
	190-KT1	Scutum Assembly, Contains: 3, 4, 5, 6



4515 East 139th Street  
Grandview, MO 64030  
(800) 362-9055  
Fax (800) 362-1463  
www.PRIER.com

## 370 Series Liquid Level Control Valve



PRIER's 370 Liquid Level Control Valve is designed for cooling towers, stock tanks, poultry troughs, oil level control or any use where liquid level control is desired. The valve is heavy patterned casted brass with a neoprene valve seat. It features positive opening or closing with no leaks or chatter. The 370 Liquid Level Control Valve is available in 1/2" or 3/4" inlets. Each valve is individually tested to assure proper functionality.

- For cooling towers, stock tanks, poultry troughs, oil level control and other uses
- Maintains liquids at the level set
- Horizontal or vertical installation
- 1/2" or 3/4" male IPS inlet x 1/2" female IPS outlet
- Includes 6" rod, chain and float ball
- Durable cast brass construction
- Heavy duty neoprene valve seat
- Positive opening and closing with no leaks or chatter

Part No.	Description	Carton Qty	Carton Wt
370-12	1/2" MIP x 1/2" FIP Liquid Level Control Valve Contains: Chain, Float and 6" Rod	10	13 lbs
370-34	3/4" MIP x 1/2" FIP Liquid Level Control Valve Contains: Chain, Float and 6" Rod	10	13 lbs

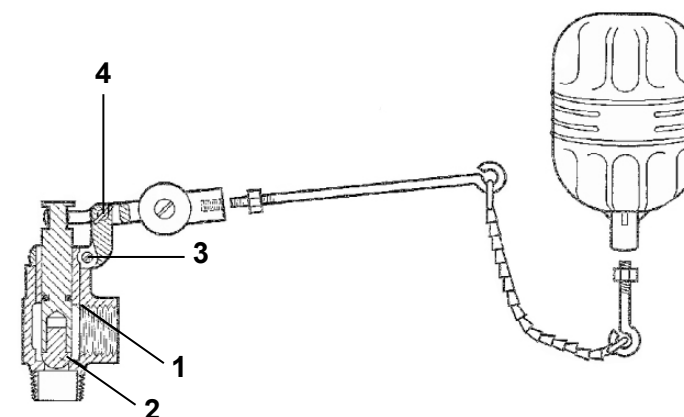

ID	Part No.	Description
1	336-6001	O-Ring
2	736-3002	Valve Seat (Neoprene)
3	910-3006	Round Head Screw (Brass)
4	910-3004	Thumb Screw (Brass)
	630-7057	Service Kit, Contains: 1, 2, 3, 4



4515 East 139th Street  
Grandview, MO 64030  
(800) 362-9055  
Fax (800) 362-1463  
www.PRIER.com

## 451 Series Pressure Relief Valve



Rough-In  
Dimensions

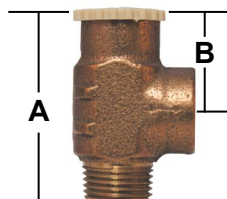

- Engineered for Pressure Relief ONLY
- Opens Automatically When Line or Tank Pressure Exceeds Valve Setting
- Heavy Casted Red Brass Body
- Stainless Steel Control Springs
- Every Valve Individually Tested

	1/2" Valve	3/4" Valve
A Length	2 1/4"	2 7/16"
B Length	1 1/8"	1 1/8"

Part No.	Description	Carton Qty	Carton Wt
451-12-75	1/2" MPT Brass Relief Valve 75 PSI	50	17 lbs
451-12-125	1/2" MPT Brass Relief Valve 125 PSI	50	17 lbs
451-12-150	1/2" MPT Brass Relief Valve 150 PSI	50	17 lbs
451-12-200	1/2" MPT Brass Relief Valve 200 PSI	50	17 lbs
451-34-75	3/4" MPT Brass Relief Valve 75 PSI	50	17 lbs
451-34-125	3/4" MPT Brass Relief Valve 125 PSI	50	17 lbs
451-34-150	3/4" MPT Brass Relief Valve 150 PSI	50	17 lbs

## 184 Series Self-Closing, Multi-Purpose Valve



Rough-In  
Dimensions

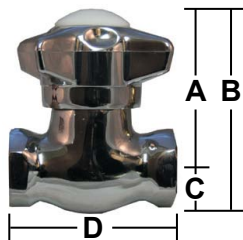

- Spring Loaded, Self-Closing Operation
- For Fixtures Requiring Manual Valves
- Heavy Casted Brass Body
- Tamper Resistant Cross Handle
- Slip-Stop Prevents Breakage
- Tested for Quality and Dependability

A Length	2 3/8"
B Length	3"
C Length	5/8"
D Length	2 7/16"

Part No.	Description	Carton Qty	Carton Wt
184-38	3/8" x 3/8" Self-Closing Multi-Purpose Valve	5	3 lbs
184-12	1/2" x 1/2" Self-Closing Multi-Purpose Valve	5	3 lbs
630-7966	Service Kit, Contains: Bonnet Packing, Stem Assembly, O-Ring and Spring	10	N/A



4515 East 139th Street  
Grandview, MO 64030  
(800) 362-9055  
Fax (800) 362-1463  
www.PRIER.com

## C-64 Series Brass Log Lighter Valve

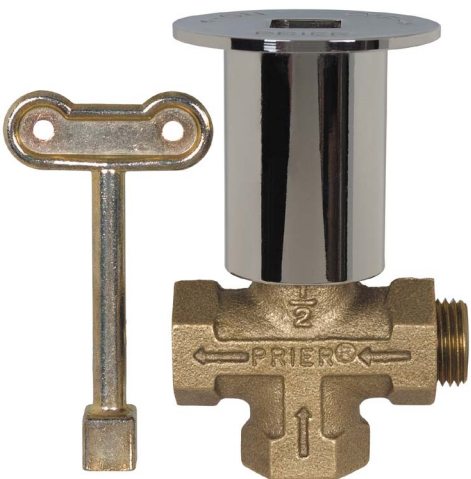

The C-64 Gas Valve is a 3-way design, allowing for installation as a straight or angle valve. This design allows one valve to be used in multiple applications.

- Heavy cast brass valve body
- 3-way design allows for multiple installation options
- Polished brass or chrome plated escutcheon
- Includes one 1/2" brass plug to block off unused opening
- Shipped with hearth key
- Available with stem extender

**Natural Gas BTU Ratings: C-64 Gas Valve: 70,840 BTUH at 7" W.C. Inlet**

Application

Ordering

Rough-In Dimensions

Part No.	Description	Carton Qty	Carton Wt
C-64CP	3 Way Log Lighter Valve; 1/2" FPT; Chrome Plated Escutcheon	24	36 lbs
C-64BR	3 Way Log Lighter Valve; 1/2" FPT; Polished Brass Escutcheon	24	36 lbs
510-0002	Escutcheon Only, Chrome Plated for C-64	12	7 lbs
510-0001	Escutcheon Only, Polished Brass for C-64	12	7 lbs
C-64-007	Die Cast Log Lighter Key for C-64 Log Lighter Valve	12	1 lb
C-64-009	10" Die Cast Log Lighter Key for C-64 Log Lighter Valve	12	2 lbs
C-64-015	14" Stem Extender for C-64 Log Lighter Valve	12	2 lbs

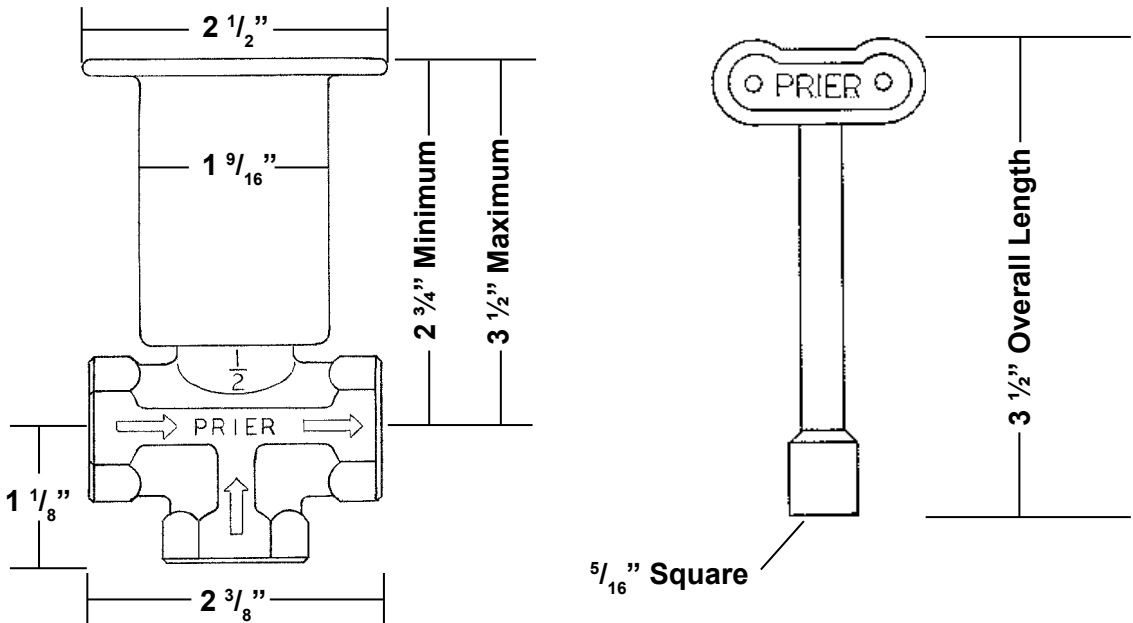





4515 East 139th Street  
Grandview, MO 64030  
(800) 362-9055  
Fax (800) 362-1463  
www.PRIER.com



4515 East 139th Street  
Grandview, MO 64030  
(800) 362-9055  
Fax (800) 362-1463  
www.PRIER.com

# C-67 Series Brass Log Lighter Ball Valve



The C-67 AGA Gas Valve is for use on any gas fireplace or appliance. Using the included operating rod, the installer can install the valve from 1" to 14" depth, allowing it to be installed "below-the-joist," eliminating fittings and installation time. The C-67 Gas Valve is also used as a shutoff for any gas burning appliance.

- AGA approved ball valve with stops
- Allows custom installation from 1" to 14" from surface
- Ideal for below-the-joist installation
- Brass or chrome plated escutcheon
- For use as log lighter valve or shutoff for gas equipment
- Shipped with two wood screws and hearth key

**Natural Gas BTU Ratings: 1/2" C-67 Gas Valve: 51,796 BTUH at 7" W.C. Inlet**

Part No.	Description	Carton Qty	Carton Wt
C-67CP.50	1/2" Extended Stem Log Lighter Valve, Chrome Plated Escutcheon	24	26 lbs
C-67BR.50	1/2" Extended Stem Log Lighter Valve, Brass Escutcheon	24	26 lbs
C-67KT-012	Chrome Escutcheon & Screw Kit for C-67 Valve	12	4 lbs
C-67KT-013	Brass Escutcheon & Screw Kit for C-67 Valve	12	4 lbs
C-67-007	Hearth Key for C-67 Log Lighter Valve	12	2 lbs

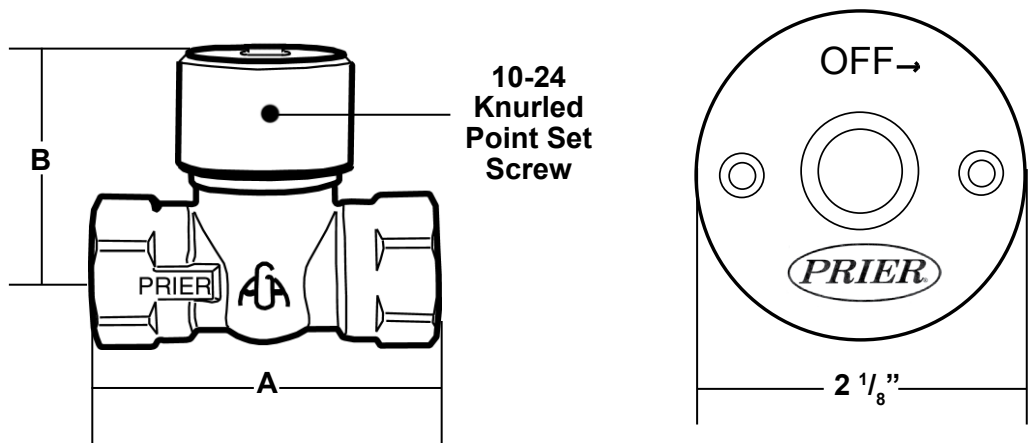

	A Length	B Length
1/2"	2 5/16"	1 5/8"
3/4"	2 9/16"	1 3/4"

# C-69 Series Cast Iron Burner Bar



The C-69 Cast Iron Burner Bar is the original burner bar with ash shields to prevent clogging of the gas ports. The tee style design has three 1/2" I.P.S. tapings for gas service from bottom or either side. The burner bar is shipped with two plugs for the unused ports

- Three 1/2" openings for flexible installation
- Ash shields prevent clogging of gas ports
- Flame diffusing design
- Ships with 2 plugs to block off unused openings
- LP Gas Adapter available

**Natural Gas BTU Ratings:  
58,225 BTUH at 7" W.C. Inlet**

Part No.	Description	Carton Qty	Carton Wt
C-69	Cast Iron Burner Bar	24	46 lbs
514-0001	LP Adapter for C-69 Burner Bar Only	EA	

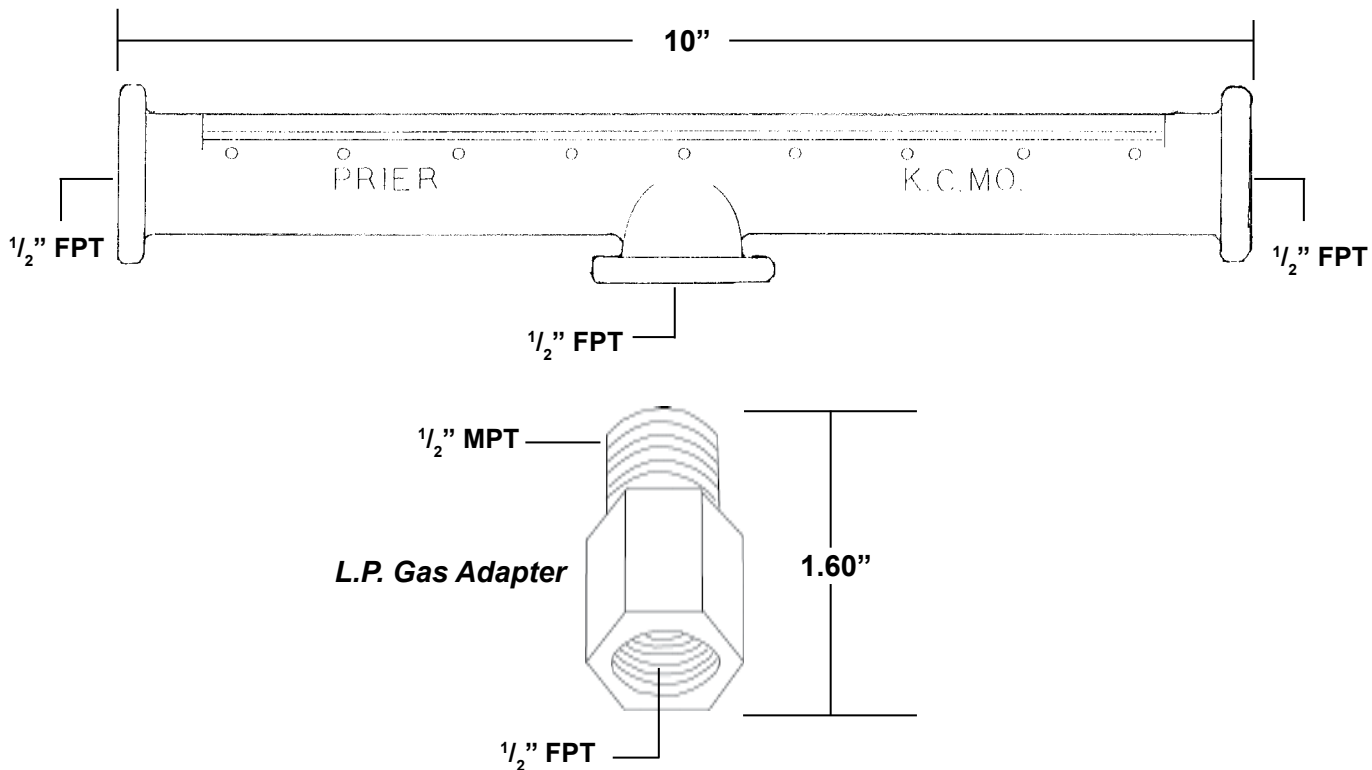

Application

Ordering

Rough-In Dimensions

Application

Ordering Rough-In Dimensions



4515 East 139th Street  
Grandview, MO 64030  
(800) 362-9055  
Fax (800) 362-1463  
www.PRIER.com

## C-70/71 Hearthglow Log Lighter Kits



**C-64 Brass Log  
Lighter Valve**



**C-67 Brass Log Lighter  
Ball Valve**



**C-69 Cast Iron Burner Bar**

PRIER's C-70/C-71 Hearthglow Log Lighter Kit is often copied, but never quite duplicated. The Hearthglow Log Lighter Kit is designed for log burning fireplaces and can be installed with multiple log lighter bars for extra wide hearths.

The C-64 Gas Valve is a 3-way design, allowing for installation as a straight or angle valve. This design allows one valve to be used in multiple applications. The C-70 Log Lighter Kit includes a brass plug for the unused opening on the valve. The C-67 Gas Valve includes a 12" operating rod that the installer cuts to the desired length. The C-67 has the flexibility of being installed from 1" to 14" below the surface. It is perfect for below-the-joist or in-wall installation.

Kit Includes:

- C-64 3-Way Gas Valve **or** C-67 Extended Stem Gas Valve (**choose one**)
- Polished Brass or Polished Chrome Escutcheon
- C-69 Log Lighter Bar with ash shields
- Hearth key
- Burner Bar entry from left, right or bottom
- Available for use with LP Gas by adding PRIER 514-0001 LP Adapter to C-69 Burner Bar

**Natural Gas BTU Ratings:**

**C-70 Kit with C-64 Gas Valve: 70,840 BTUH at 7" W.C. Inlet**

**C-71 Kit with C-67 Gas Valve: 58,225 BTUH at 7" W.C. Inlet**

Part No.	Description	Carton Qty	Carton Wt
C-70CP	Hearthglow Log Lighter Kit with C-64 3-Way Gas Valve-Chrome Escutcheon & Plug, C-69 Burner Bar with Plugs, Hearth Key	12	48 lbs
C-71CP	Hearthglow Log Lighter Kit with C-67 Extended Stem Gas Valve-Chrome Escutcheon, C-69 Burner Bar with Plugs, Hearth Key	12	42 lbs
C-70BR	Hearthglow Log Lighter Kit with C-64 3-Way Gas Valve-Polished Brass Escutcheon & Plug, C-69 Burner Bar with Plugs, Hearth Key	12	48 lbs
C-71BR	Hearthglow Log Lighter Kit with C-67 Extended Stem Gas Valve-Brass Escutcheon, C-69 Burner Bar with Plugs, Hearth Key	12	42 lbs
514-0001	LP Gas Adapter for PRIER C-69 Burner Bar	EA	1 lb



4515 E 139th Street, Grandview, MO 64030  
800-362-9055 | F: 800-362-1463 | www.PRIER.com

# QUESTIONS?

CONTACT PRIER'S FRIENDLY CUSTOMER SERVICE  
DEPARTMENT AT 800-362-9055 OR SALES@PRIER.COM.  
FOR MORE TECHNICAL INFORMATION, VISIT WWW.PRIER.COM.