

MICHIGAN CENTRAL DEVELOPMENT PROJECT

November 9, 2020

MIKYOUNG KIM DESIGN

GIFFELS WEBSTER | AQUEOUS | RESURGET
PETER BASSO ASSOCIATES | LIVING LAB | CMS
MARK ALLAN & ASSOC | ETM | ILLUMINART

Michigan Central: **Michigan Central Vision**

Michigan Central is a new mobility innovation district at the juncture of Corktown & Southwest Detroit

Michigan Central Station as a centerpiece

Mobility innovators & disruptors

Develop, test, and launch new solutions to urban transportation challenges

New and revitalized buildings

First-of-its-kind mobility testing platform



Michigan Central: Guiding Principles



Build the Future of Mobility



Optimize for Innovation



Make an Inclusive and Authentic Place



Celebrate Heritage and Legacy
ST. JAMES
ALL ARE WELCOME.



Make Decisions That Create Equity

Michigan Central: Why Open Space Matters

Fulfilling our guiding principles

First impressions are important

Connecting spaces for people

Sustainable use of space and infrastructure



mikyoung kim design



mikyoung kim
founding principal



ian downing
project executive



bryan chou
design leader



jess hamilton
project manager



yufan gao
design manager

living lab



leah groya
principal



courtney piotrowski
principal



jason macdonald
principal

Creating Human Habitats



Design Innovation



Resiliency
Sustainability



Building
Social Infrastructure

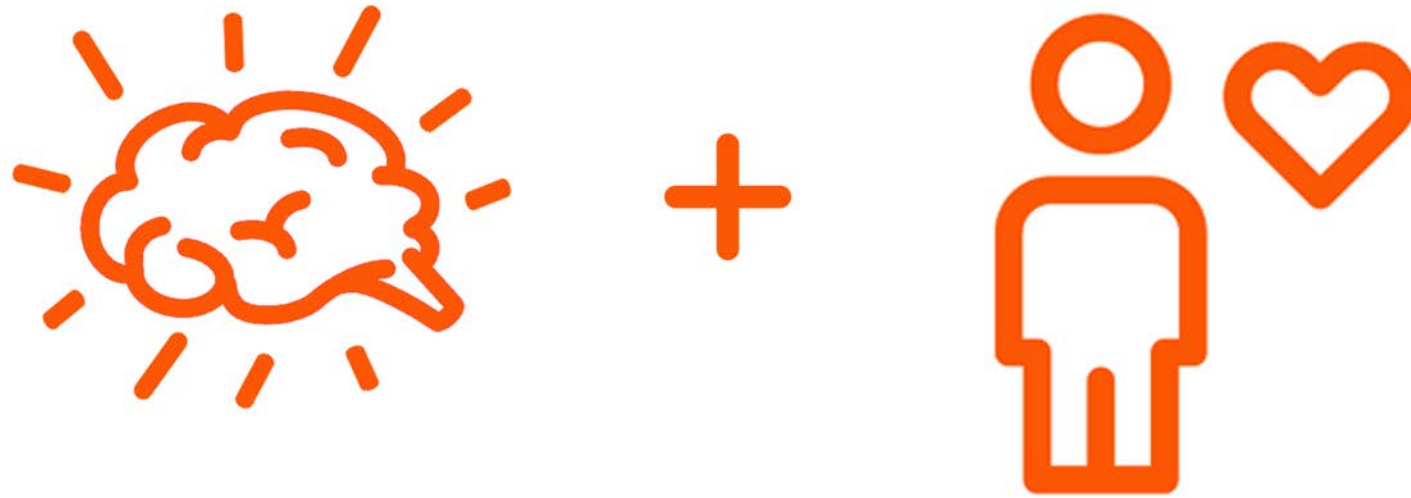

Health and Well Being

Bringing Nature Closer | Creating an Inclusive Landscape

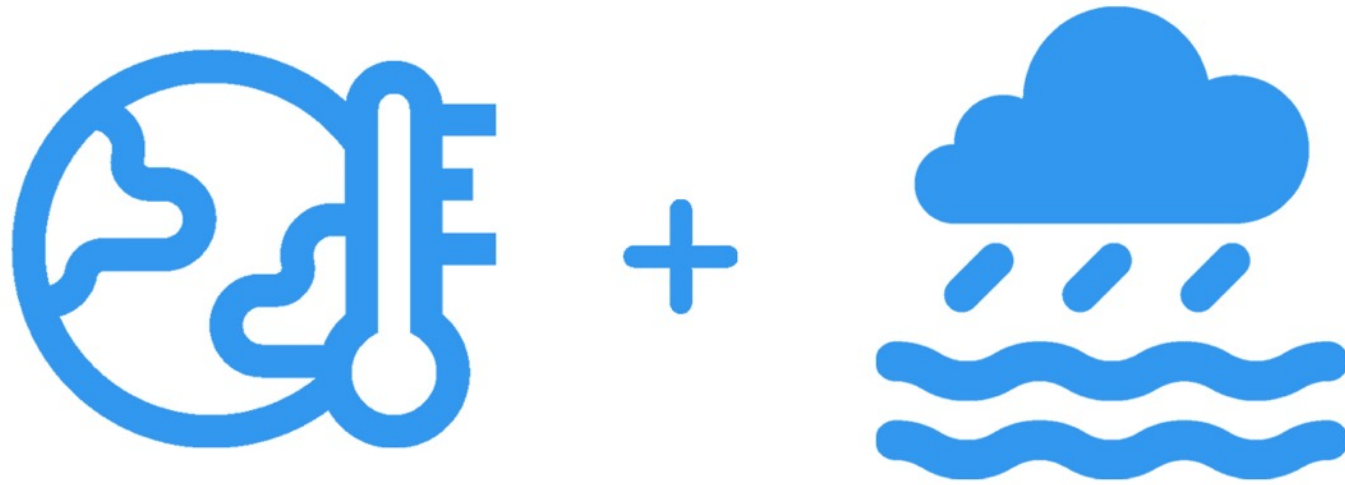

Building an Ecological Landscape

Rebuilding Biodiversity | Creating a Platform for Resiliency



a sense of wonder

discovery



diversity of programming



vibrant streets

BOSTON UNIVERSITY
JOAN & EDGAR BOOTH
THEATRE

BOOTH



celebrating connections





the unexpected

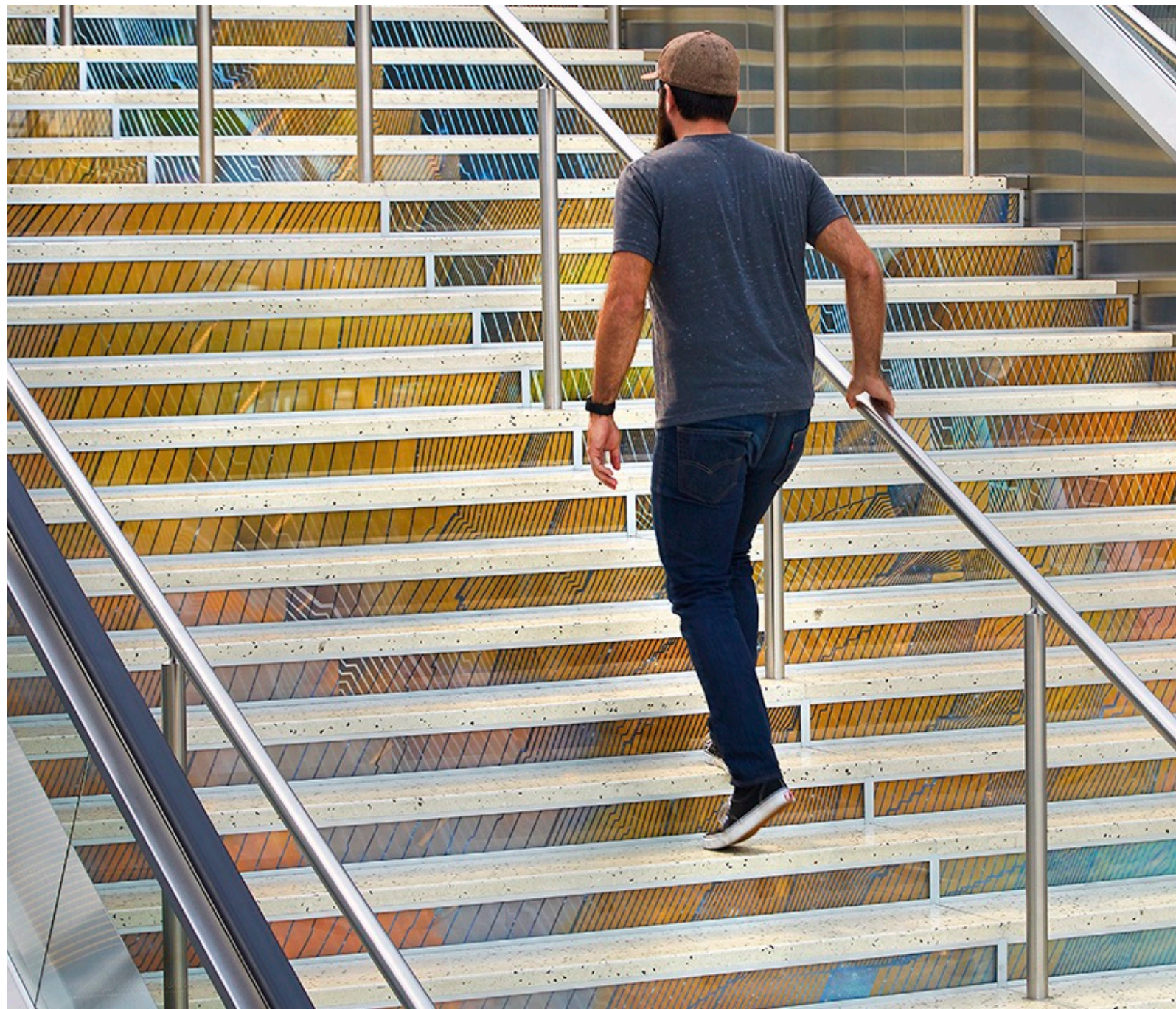

An aerial photograph of a modern outdoor plaza. The plaza is composed of large, light-colored concrete slabs arranged in a complex, interlocking geometric pattern. Interspersed among these slabs are rectangular sections of vibrant green grass. The area is surrounded by lush green trees and shrubs. Several black, modern-style street lamps are positioned throughout the plaza. In the upper left corner, there are some blue outdoor seating arrangements. A semi-transparent blue banner with white text is overlaid on the left side of the image.

plug and play



healthfulness



A photograph of a lush garden. In the foreground, a stone path with large, irregularly shaped stones leads through a garden. Two young girls, wearing matching light blue and white striped shirts and pink skirts with orange and white floral patterns, are walking away from the camera. The girl in front is crouching down, looking at the ground. In the background, two adults, a man and a woman, are standing near a wooden post-and-rail fence, looking at a tablet or book. The garden is filled with various plants, including tall grasses, shrubs, and trees. The overall scene is bright and sunny, suggesting a pleasant day in a well-maintained garden.

celebrating resiliency

restorative experiences



celebration





transforming cities

Understanding the Site

Michigan Central: Greenspace and Park Analysis



— Joe Louis Greenway
 - - - Michigan Central Mobility and Innovation District
 — Detroit Riverwalk

Michigan Central: Corktown Framework Plan

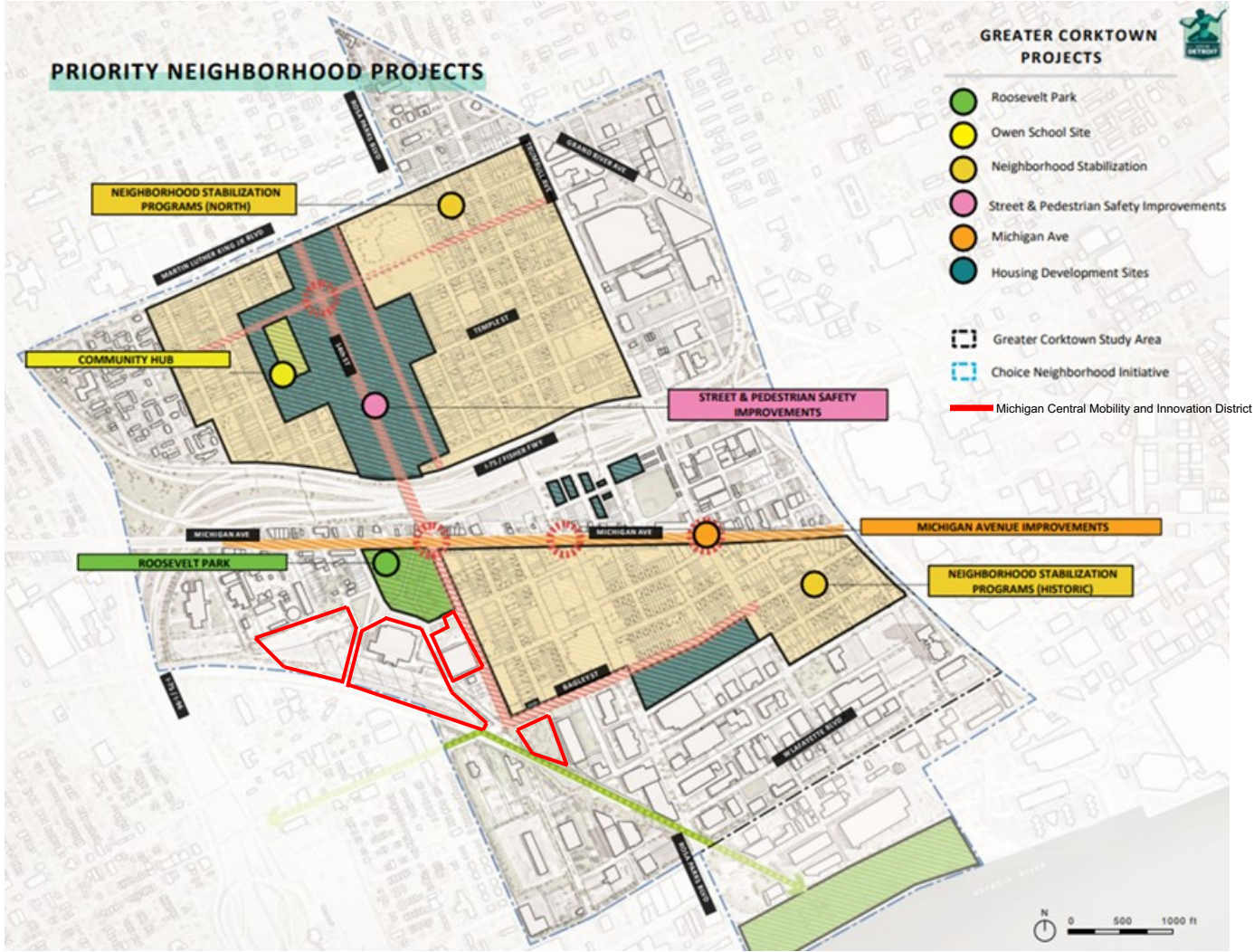

Michigan Central: Open Space

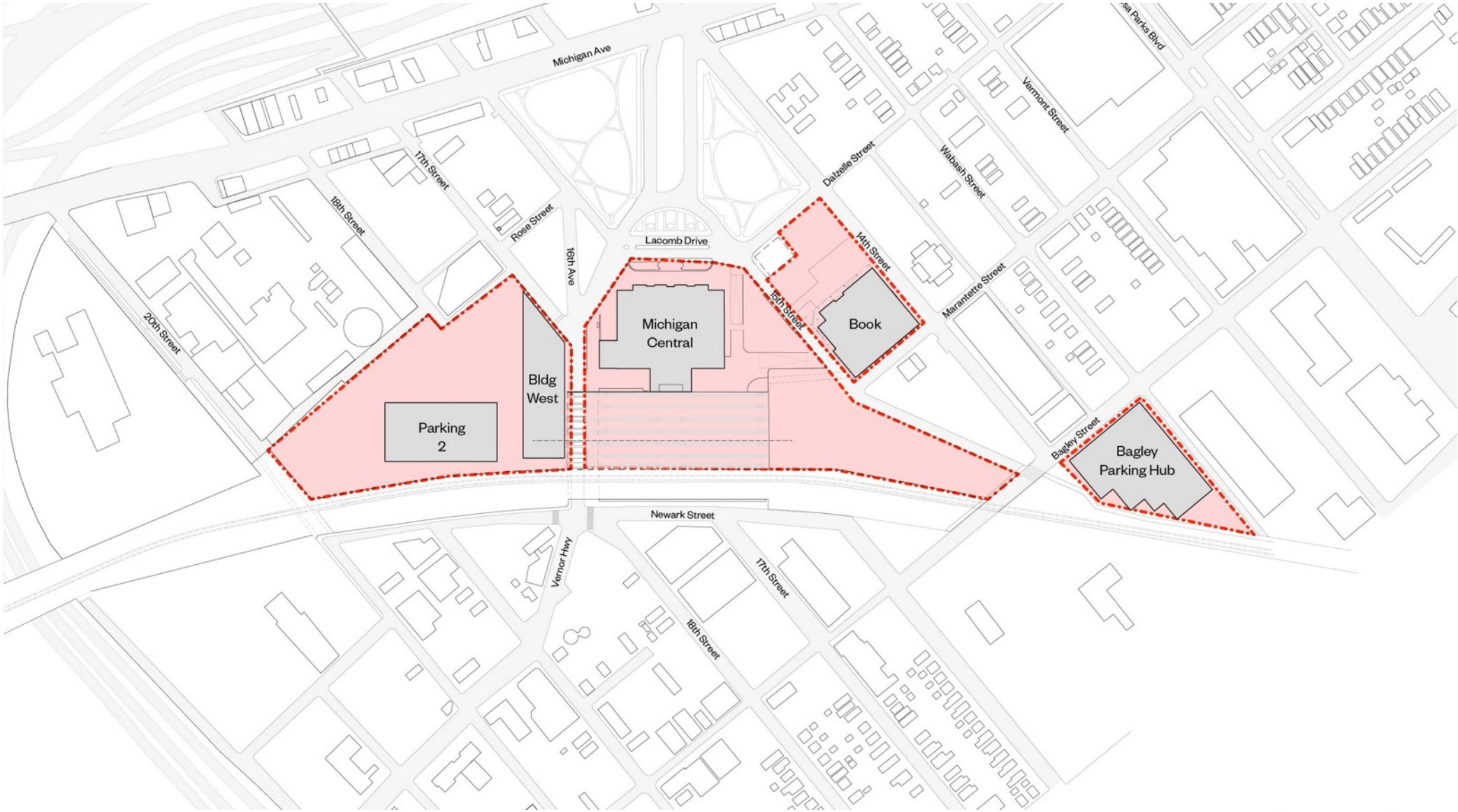

Analysis:

Scale + Programming for Station Plaza

Michigan Central : Scale Comparison

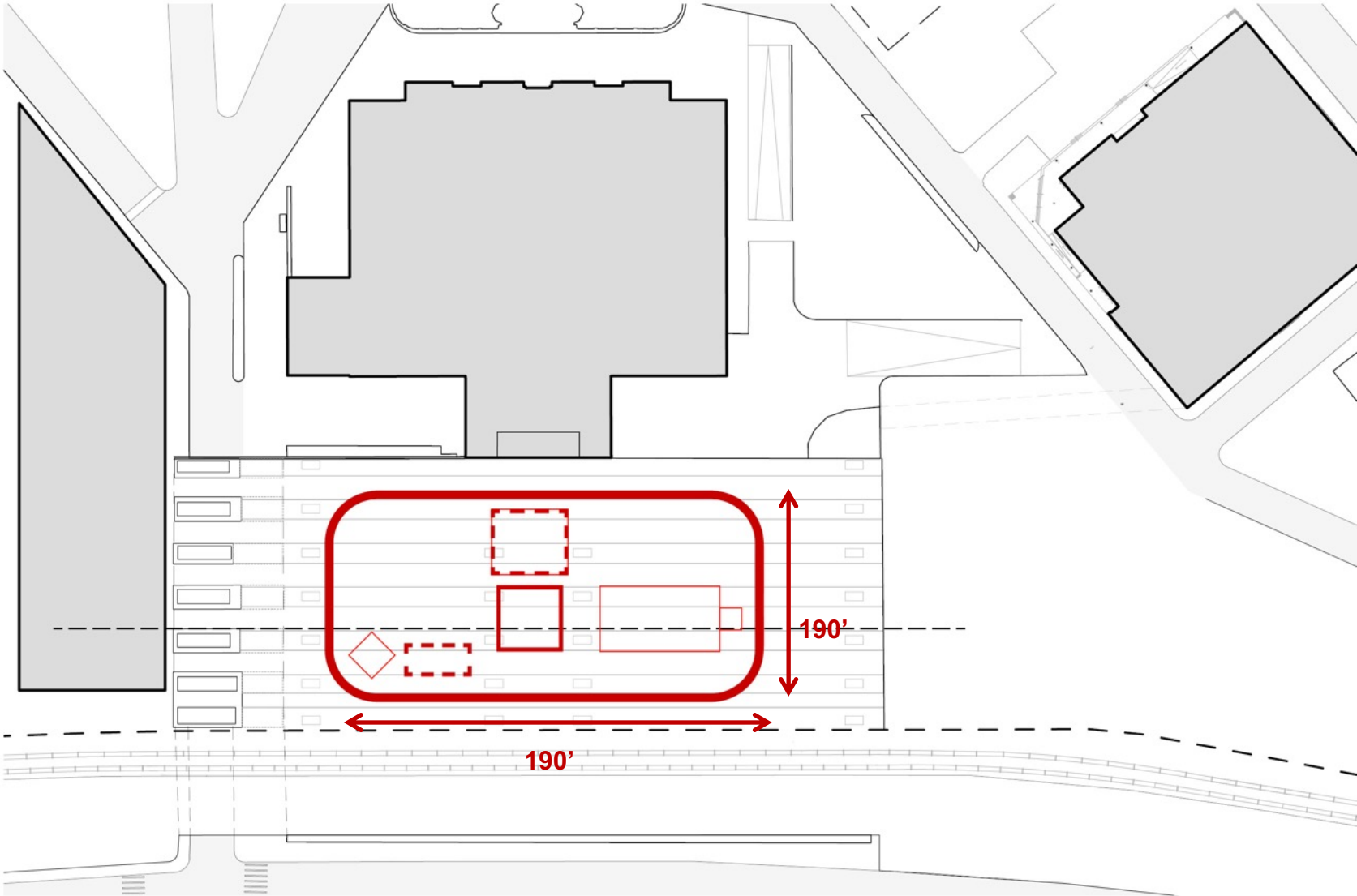

Campus Martius Park
Detroit, MI



Michigan Central: Scale Comparison

Campus Martius
Detroit, MA

- Year-round Town Square
- Skating Rink
- Tree Lighting
- Restaurant
- Public Programs
- Urban Beach
- Water Feature



Michigan Central Development: Scale Comparison

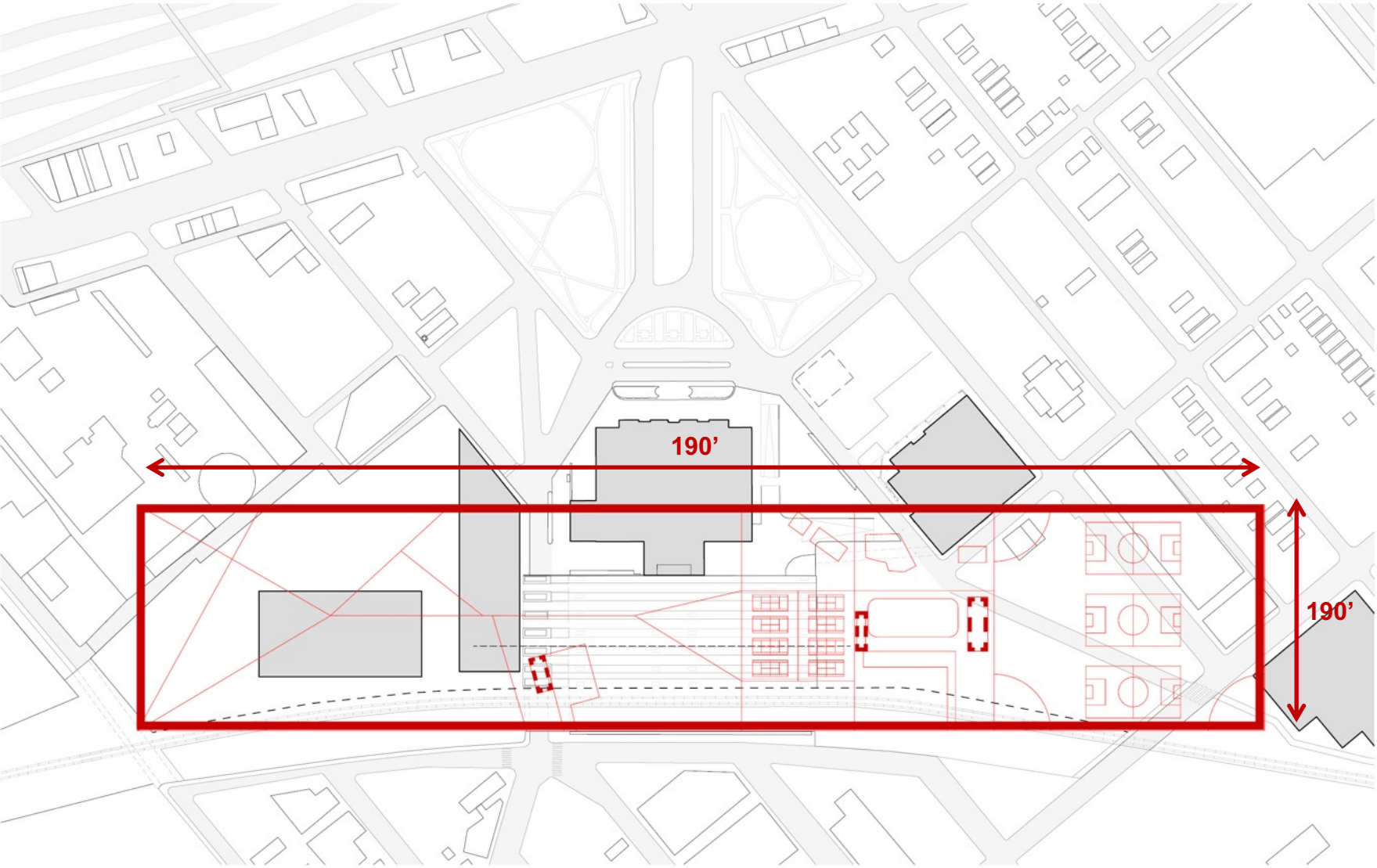

Clark Park
Detroit, MI



Michigan Central: Scale Comparison

Clark Park
Detroit, MI

Regulation Size Outdoor Ice Rink
Baseball Fields
Tennis Courts

Soccer Field
Trails
Festivals Year Round
Picnic Gathering Space



Michigan Central: Existing Area Programming

Light Shows
Sporting Events
Listen and Learns
Innovation Workshops

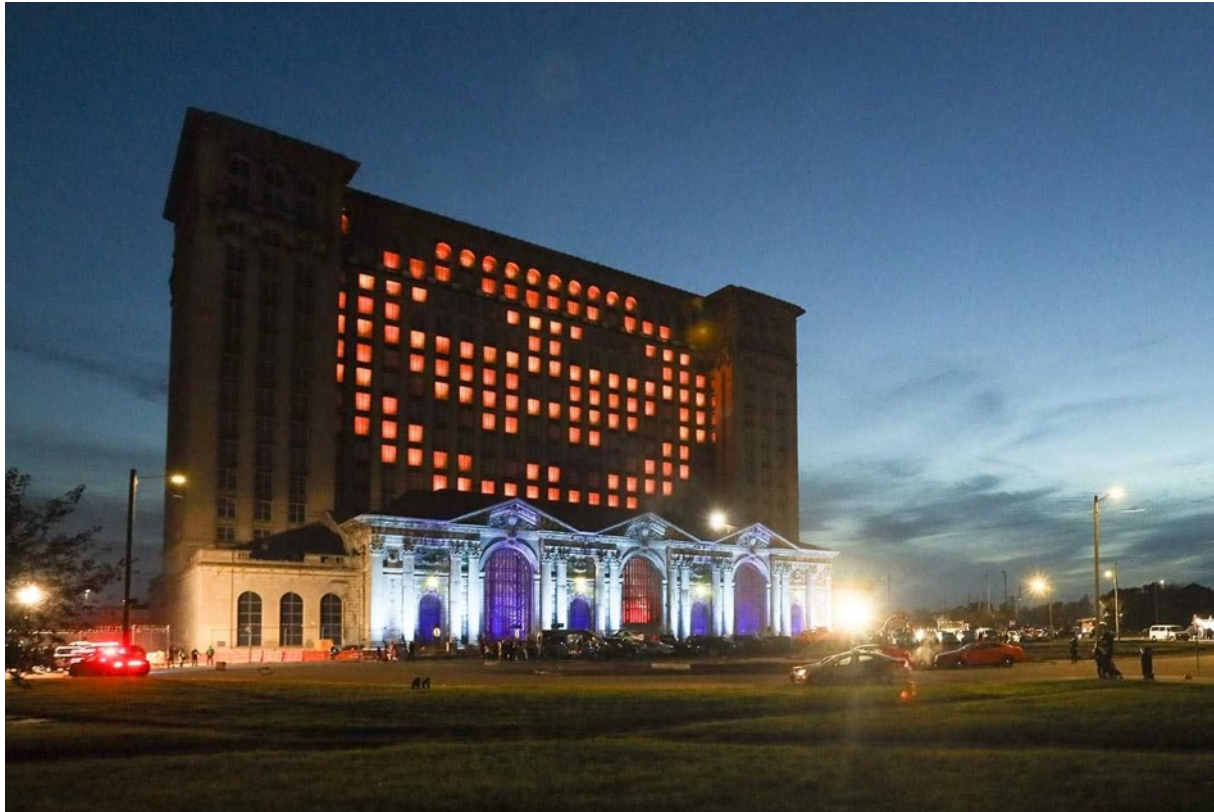

Community Engagement

Case Study McIntire Park: Site Research

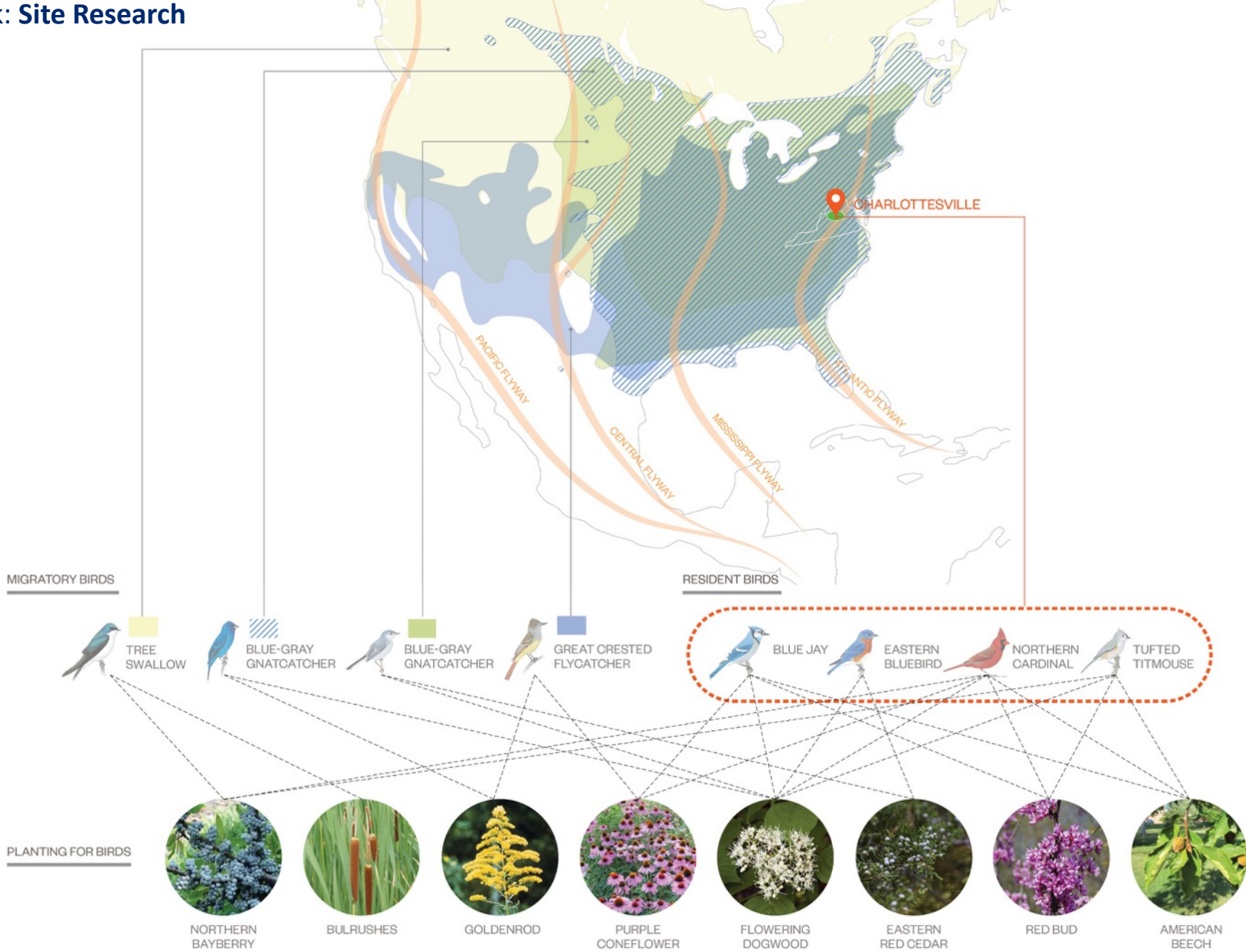

Case Study McIntire Park: **Site Visits**



Case Study McIntire Park: Community Engagement



educational FLEXIBILITY Multi-Use COLLABORATION
 LEARNING **COMMUNITY** ACCESSIBILITY PEOPLE open to all
 INTERACTION WITH NATURE identifiable WOW FACTOR
 enhance existing site opportunities SUSTAINABILITY

BIODIVERSITY SEASONALITY
 topography VIEWS/VISTAS CELEBRATION OF public garden **PIEDMONT**
ECOLOGY CONNECTIVITY
 Increasing Flora + Fauna

DIVERSITY OF EXPERIENCE Broad Reaching
WOW FACTOR DESTINATION
 FOOD beloved space contemplative vs. active
 arts CULTURAL EVENTS NATURE PLAY SEASONAL TOURS

WORKSHOPS **EDUCATION**
 student engagement INSTITUTIONAL COLLABORATION LEARNING

CENTRAL

DESIGN PRINCIPLES

HEALTH & WELLBEING



COMMUNITY ORIENTED



GARDEN PROGRAMING



SCIENCE

LIBRARY
 HERBARIUM / FUNGARIUM
 SEED COLLECTION
 ECONOMIC BOTANY
 PLANT COLLECTION DATABASE
 LABORATORIES
 MICROSCOPE SLIDE COLLECTION
 PLANT DNA REPOSITORY
 ORNAMENTAL PLANT RESEARCH
 SPIRIT COLLECTION



EDUCATION

KIDS & FAMILY
 DROP-IN ACTIVITIES,
 CHILDREN'S GARDEN CLASSES,
 SUMMER PROGRAMS, TEEN
 APPRENTICESHIP, CAMP-OUTS

TEACHERS & SCHOOLS
 SELF-GUIDED SCHOOL & CAMP
 GROUP VISITS, SCHOOL GROUP
 GUIDED WORKSHOPS, TEACHER
 PROGRAMS, ETC.

ADULT EDUCATION
 SYMPOSIUM & SEMINARS,
 WELLNESS & FITNESS, FLORAL
 DESIGN, NATURE & BIRDING,
 PHOTOGRAPHY, ETC.



SEASONAL

SEASONAL GARDEN TOURS
 MUSIC, PERFORMANCE & THEATER
 GARDEN COCKTAIL & PICNIC
 FLOWER SHOW & SALE
 ART EXHIBIT & INSTALLATION
 WATER PLAY
 BUTTERFLIES & BLOOMS
 HARVEST MARKET
 HALLOWEEN EVENTS
 HOLIDAY LIGHT DISPLAYS

AGENCIES & PARTNERS

BOTANIC GARDEN STAFF: FULL-TIME STAFF, VOLUNTEERS, INTERNS

PUBLIC AGENCIES: CITY DEPARTMENTS, GARDEN ASSOCIATIONS, UNIVERSITIES

PRIVATE AGENCIES: NON-PROFIT ORGANIZATIONS, LOCAL COMMUNITIES, SCHOOLS

mikyoung kim design

Breakout Room Brainstorm

1. Activities + Events
2. Site Elements+ Design

Activities & Events:

Breakout Activity #1

Michigan Central: Health and Well-Being

How might health and well-being be thought of in the landscape?



[BRAINSTORM]



Michigan Central: Play

How might we encourage play in an open space?



[BRAINSTORM]



Michigan Central: Innovation & Collaboration

How might a landscape inspire innovation and collaborations?

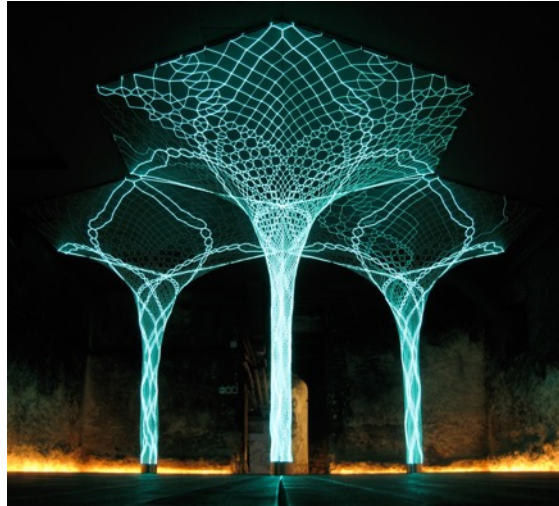

[BRAINSTORM]



Michigan Central: Celebrations & Gathering

What kinds of outdoor events & celebrations do you enjoy?

[BRAINSTORM]



Site Elements & Design:

Breakout Activity #2

Michigan Central: Human Comfort



What site elements would extend your seasons of comfort outside?

[BRAINSTORM]

Michigan Central: Engaging Nature



How do you like to engage with nature?

[BRAINSTORM]

Michigan Central: Powering the Future

What kinds of technology would be exciting to see in an open space?



[BRAINSTORM]



Michigan Central: Resiliency

How might resiliency be considered in planning for these spaces?

[BRAINSTORM]



Thank you!
Tell us more, tell your friends

<https://bit.ly/mcopenspacesurvey>