

NOTES

1. THIS PLAN REFERS TO THE TOWN OF ASHLAND ASSESSOR'S MAP #23, PARCEL #231.
2. FOR ADDITIONAL PROPERTY LINE INFORMATION REFER TO THE DEED IN BOOK 58104, PAGE 489 RECORDED AT THE MIDDLESEX REGISTRY OF DEEDS.
3. ELEVATIONS SHOWN HEREON ARE BASED ON N.A.V.D. OF 1988.
4. THE PLANIMETRIC AND TOPOGRAPHIC FEATURES SHOWN HEREON ARE THE RESULTS OF FIELD INSTRUMENT SURVEYS PERFORMED BETWEEN AUGUST 2013 AND APRIL 2015 BY THE JILLSON COMPANY.
5. THE BORDERING VEGETATED WETLAND AND TOP OF BANK FLAGS SHOWN HEREON ARE BASED ON A WETLAND DELINEATION PERFORMED IN SEPTEMBER 2013 & APRIL 2015 BY DAVID W. BURKE, WETLAND SPECIALIST. FOR ADDITIONAL INFORMATION REGARDING THE WETLAND DELINEATION AND THE WETLAND TEST PITS SHOWN HEREON REFER TO THE WETLAND DELINEATION LETTER PREPARED BY DAVID W. BURKE.
6. FOR ADDITIONAL INFORMATION REGARDING THE DEEP TEST HOLES SHOWN HEREON REFER TO THE SOIL LOGS PREPARED BY THE JILLSON COMPANY ON FILE WITH THE TOWN OF ASHLAND BOARD OF HEALTH.
7. FEMA ZONE "A" LOCATION SHOWN HEREON IS BASED ON DATA OBTAINED FROM THE STATE OF MASSACHUSETTS GIS DATABASE AND SHALL BE CONSIDERED APPROXIMATE.
8. THE TREE LOCATIONS SHOWN HEREON ARE BASED ON TOWN OF ASHLAND PLANNING BOARD PRELIMINARY PLAN REGULATIONS AND ONLY REPRESENT A PORTION OF THE TREES FOUND ONSITE.

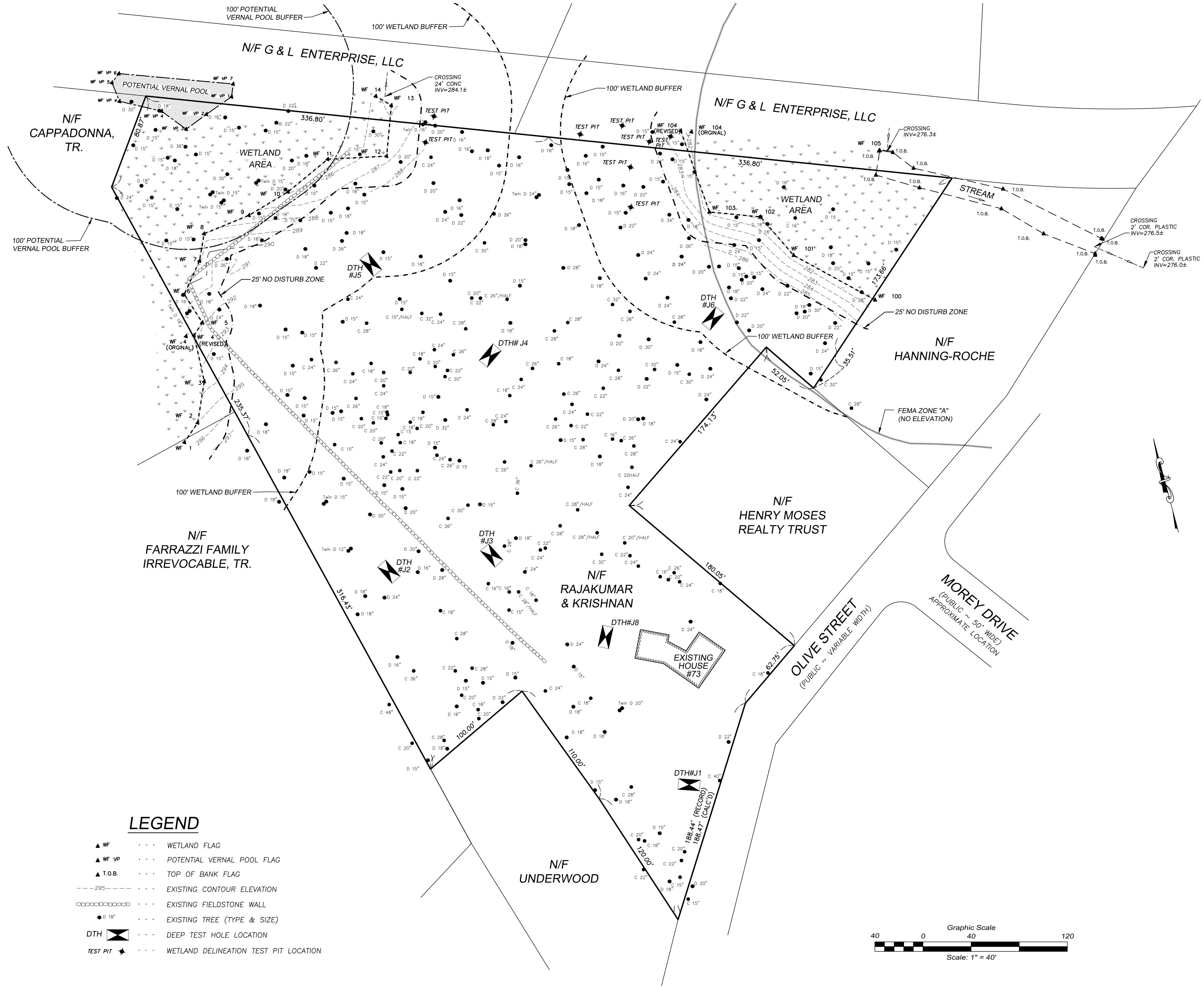

LEGEND

- ▲ WF ···· WETLAND FLAG
- ▲ WF VP ···· POTENTIAL VERNAL POOL FLAG
- ▲ T.O.B. ···· TOP OF BANK FLAG
- - - - - EXISTING CONTOUR ELEVATION
- ○ ○ ○ ○ EXISTING FIELDSTONE WALL
- D 18" ···· EXISTING TREE (TYPE & SIZE)
- DTH [Symbol] ···· DEEP TEST HOLE LOCATION
- TEST PIT [Symbol] ···· WETLAND DELINEATION TEST PIT LOCATION

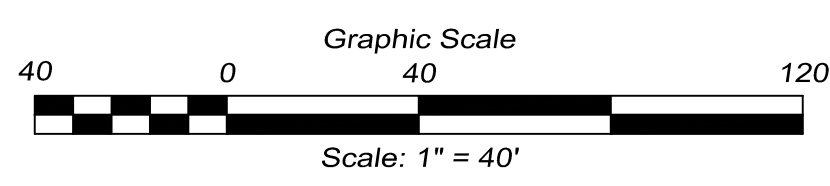

**"No. 73 OLIVE STREET
EXISTING CONDITIONS PLAN"**

OF LAND IN
ASHLAND, MASS.

OWNER/APPLICANT: SURESH RAJAKUMAR & BHUVANA KRISHNAN
12 BURNING TREE ROAD
NATICK, MA 01760

SCALE: 1"=40' DATE: 18 MARCH 2015

PREPARED BY: THE JILLSON COMPANY, INC.
P.O. BOX 2135
FRAMINGHAM, MA. 01703-2135
(508)-485-0500
www.JILLSONCOMPANY.com

REVISIONS		
REV	DATE	DESCRIPTION
1.	04/23/15	VERNAL POOL, NEW WF 4 & WF 104 LOCATIONS