

CROSLEY

CR55

Crosley 302 Wall Phone

Instruction Manual

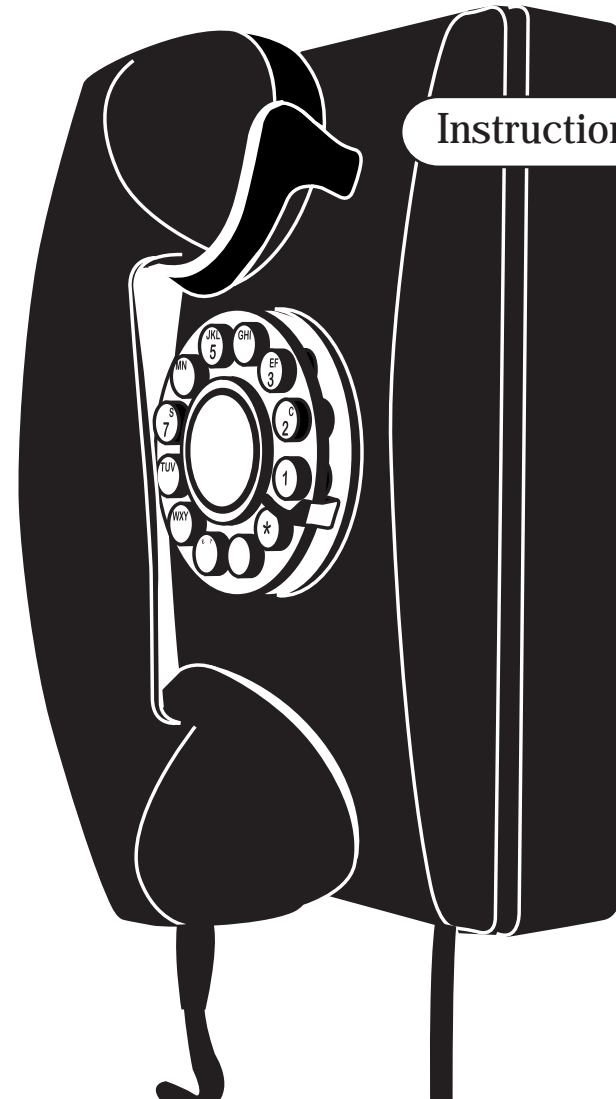

IMPORTANT SAFETY INSTRUCTIONS

When using your telephone equipment, basic safety precautions, should always be followed to reduce the risk of fire, electric shock and injury to persons, including the following:

1. Read and understand all instructions.
2. Follow all warnings and instructions marked on the product.
3. Unplug this product from the wall outlet before cleaning. Do not use liquid cleaners or aerosol cleaners. Use a damp cloth for cleaning.
4. Do not place this product on an unstable cart, stand or table. The product may fall, causing serious damage to the product.
5. Slots and openings in the cabinet and back or bottom are provided for ventilation, to protect it from overheating, these openings must not be blocked or covered. The openings should never be blocked by placing the product on the bed, sofa, rug, or other similar surface. This product should never be placed near or over a radiator or heat register. This product should not be placed in a built-in installation.
6. Never push objects of any kind into this product through cabinet slots as they may touch dangerous voltage points or short out parts that could result in a risk of fire or electric shock. Never spill liquid of any kind on the product.
7. To reduce the risk of electric shock, do not disassemble this product. Take it to a qualified serviceman when some service or repair work is required. Opening or removing covers may expose you to dangerous voltages or other risks. Incorrect re-assembly can cause electric shock when the appliance is subsequently used.
8. Unplug this product from the wall outlet and refer servicing to qualified service personnel in the following cases:
 - A. When the power supply cord or plug is damaged or frayed.
 - B. If liquid has been spilled into the product.
 - C. If the product has been exposed to rain or water.
 - D. If the product does not operate normally by following the operating instructions. Adjust only those controls, that are covered by the operating Instructions because improper adjustment of other controls may result in damage and will often require extensive work by a qualified technician to restore the product to normal operation.
 - E. If the product has been dropped or the cabinet has been damaged.
 - F. If the product exhibits a distinct change in performance.
9. Do not allow anything to rest on the power cord. Do not locate this product where the cord will be abused by persons walking on it.
10. Do not use this product near water, for example , near a bathtub, washbowl, kitchen sink, or laundry tub, in a wet basement, or near a swimming pool.
11. Avoid using a telephone (other than a cordless type) during an electric storm. There may be a remote risk of electric shock from lighting.
12. Do not use the telephone to report a gas leak in the vicinity of the leak.
13. Use only the power cord and batteries indicated in this manual. Do not dispose of batteries in a fire. They may explode. Check with local codes for possible special disposal instructions.

SAVE THESE INSTRUCTIONS

SET UP

DIAL MODE

The DIAL MODE switch is located at the back of the telephone. Slide the switch to TONE unless you have Dial-Pulse (Rotary) telephone service in your area, in which case, slide the switch to the PULSE position.

MECHANICAL BELL RINGER CONTROL

The RINGER CONTROL switch at the back of the telephone allows you to turn the ringer ON or OFF. You can still make or receive calls with the ringer in OFF position, however, you will not hear the incoming ring.

RECEIVER VOLUME

The RECEIVER VOLUME CONTROL switch, located on the bottom of the telephone, allows you to adjust the volume of the receiver earphone from LOW and HI.

INSTALLATION

To connect the telephone, connect the line cord from the back of the telephone to the wall jack.

MAKING AND ANSWERING CALLS

To get a dial tone or answer an incoming call, lift the handset.

To hang up, either replace the handset or press the HANDSET CRADLE manually.

FLASH

Pressing FLASH sends the electronic equivalent of a switchhook signal. Use FLASH with special phone company services such as call waiting.

IF THERE IS NO DIAL TONE

- 1) Make sure that all plugs are connected properly. Check the connections at the wall jack, the telephone cabinet and handset.
- 2) Try another modular jack within your home which you know to be working properly.

IF CALLS CANNOT BE DIALED OR DIALS SLOWLY

Check to make sure that the DIAL MODE switch is in the correct position for the type of service (TONE/PULSE) available in your area.

IF THE TELEPHONE DOES NOT RING

Check that RINGER CONTROL switch is not set to OFF.

If there are several telephones connected to the same line, try disconnecting some of the other telephones. Having too many telephones connected to the same line can cause low ringer volume or poor sound quality during calls.

CARE AND MAINTENANCE

Avoid rough treatment to the telephone. Do not drop the handset and always place it gently back in the cradle. Clean only with slightly dampened cloth. Do not use detergent, wax, solvent, spray, alcohol or excessive water.

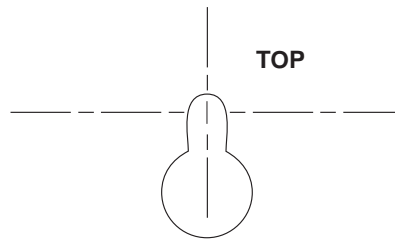

MOUNTING HOLE A

**USE THIS TEMPLATE
TO DETERMINE THE POSITION OF
TELEPHONE ON WALL,
AND WHERE TO LOCATE
SCREW HOLES.**

**REMOVE TEMPLATE FROM
WALL BEFORE INSERTING
PLASTIC ANCHORS OR SCREWS**

**USE ONLY FOR WALL
INSTALLATION OF TELEPHONE SET**

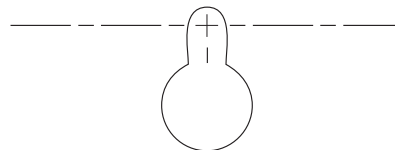

MOUNTING HOLE B

FCC Requirements

1. This equipment complies with 47CFR Part 68 and ACTA technical requirements. On the bottom of this equipment is a label that contains, among other information, the registration number and ringer equivalence number (REN) for this equipment. If requested, this information must be provided to the telephone company.
2. The USOC number of the registration jack for the equipment is RJ11C/RJ11W.
3. A FCC compliant telephone cord and modular plug is provided with this equipment. This equipment is designed to be connected to the telephone network or premises wiring using a compatible modular jack which is TIA/EIA-IS-968 compliant. See Installation Instructions details.
4. The REN is used to determine the quantity of devices which may be connected to the telephone line. Excessive RENs on the telephone line may result in the devices not ringing in response to an incoming call. In most, but not all areas, the sum of RENs should not exceed five (5.0). To be certain of the number of devices that may be connected to a line, as determined by the total RENs, contact the local telephone company.
5. If this terminal equipment causes harm to the telephone network, the telephone company will notify you in advance that temporary discontinuance of service may be required. But if advance notice isn't practical, the telephone company will notify the customer as soon as possible. Also, you will be advised of your right to file a complaint with the FCC if you believe it is necessary.
6. The telephone company may make changes in its facilities, equipment, operations or procedures that could affect the operation of the equipment. If this happens the telephone company will provide advance notice in order for you to make necessary modifications to maintain uninterrupted services.
7. The equipment cannot be used on public coin phone service provided by the telephone company. Connection to party line service is subject to state tariffs.
8. Please follow instructions for repairing if any (e.g. battery replacement section), otherwise do not alternate or repair any parts of device except specified.
9. This equipment if it uses a telephone handset is hearing aid compatible.
10. If trouble is experienced with this equipment, for repair or warranty information, please contact service center at the below. If the equipment is causing harm to the telephone network, the telephone company may request that you disconnect the equipment until the problem is resolved.

PARTS INCLUDED

Your new telephone includes the following items:

- 1 - Telephone handset
- 1 - Handset coil cord
- 1 - Telephone body
- 1 - 7 Foot line cord
- 1 - 15 Inch line cord
- 2 - Screws with wall archors
- 1 - Wall mounting template.
- 4 - Rubber spacer pads.
- 2 - Tapping screw
- 1 - Template (See above picture and instructions)

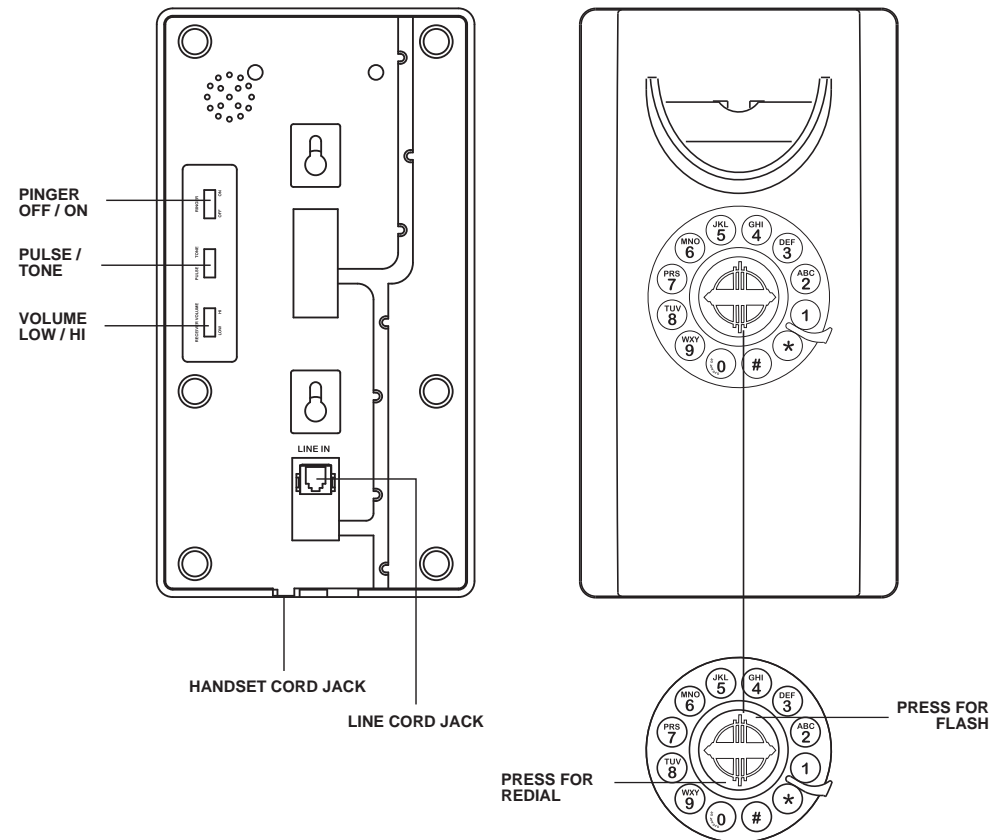

LIMITED MANUFACTURERS WARRANTY

Crosley Radio, Inc. warrants the product to be free from defects in material and workmanship under normal use for a period of one year from the original date of purchase. This warranty is not transferable. If the product is determined to be defective during the warranty period, the unit will be repaired or replaced at Crosley Radio's sole discretion. This warranty covers manufacturing defects and normal consumer use and does NOT cover damage or failure as a result of abuse, accident, alterations, misuse, neglect, abnormal wear and tear, inadequate maintenance, commercial or unreasonable use, damage caused by power surges, mishandling, accident, acts of God or attempted repair by an unauthorized service agent. Also not covered are cosmetic damages, cords and antennas.

Should this product fail to function in a satisfactory manner, it is best to first return it to the store or retailer where it was originally purchased. If additional service is still needed, the original purchaser must **FIRST** contact our offices to obtain an RA (Return Authorization) Number.

TO OBTAIN AN RA NUMBER
CALL: **1.888.CROSLEY**
(1.888.276.7539)

Send the unit prepaid to the address below in the original packaging (or reasonable substitute to prevent damage). Clearly mark your RA number on the outside packaging and include the original sales receipt (or a copy) indicating date of purchase, amount paid, and place of purchase. You must also include your full name, shipping address and daytime contact number. Please include a check or money order in the amount of \$19.95, made payable to Crosley Radio, to cover handling and return shipping charges. Returned products will not be shipped to PO Boxes. Crosley Radio will not be responsible for delays or unprocessed claims resulting from a purchaser's failure to provide any or all of the necessary information.

CROSLEY RADIO
ATTN: RETURNS DEPT
2001 PRODUCTION DRIVE
Louisville, KY 40299

For additional support: Crosley Radio Consumer Service Department
24 hours a day / 7 days a week
Telephone: 1.888.CROSLEY (1.888.276.7539)

*There are no express warranties except as listed above.
The purchaser's bill of sale is the only proof of warranty entitlement.*

This warranty gives the purchaser specified legal rights in addition to any rights which may vary from state to state.

In accordance with the "Moss-Magnuson Warranty Act" of July 10, 1975, this is termed a "limited warranty" which in no way compromises Crosley Radio's high standards of quality and workmanship.