



# Repico®

## 1. Repico® -mallit

Repico® G

Repico® S

Repico® SG



Vetoakestävä

Ei-vetoakestävä

Yhdistelmäliitin

## 2. Asennusolosuhteet

### 2.1 Tarkasta laitekilpi

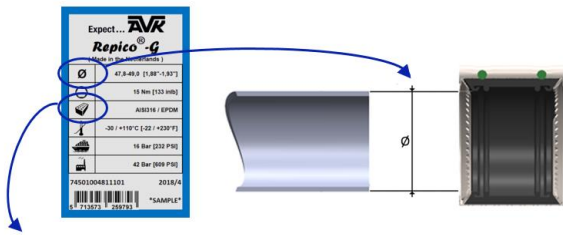

Tarkasta paineluokka!

Tiiviste	
EPDM	-30 °C ↔ +110 °C
NBR	-25 °C ↔ + 80 °C
Silikoni	-70 °C ↔ +200 °C
Viton	-30 °C ↔ +250 °C

### 2.2 Maksimirako

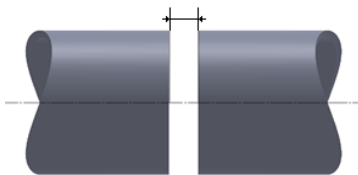

$C_{max}$	
DN15 ↔ DN65	0 ↔ 8mm
>DN80	0 ↔ 15mm

### 2.3 Kulmapoikkeama

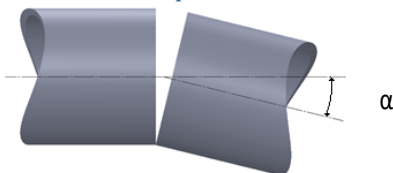

$\alpha_{max}$	
DN15 ↔ DN50	5°
DN65 ↔ DN175	4°
>DN200	2°

### 2.4 Halkaisija

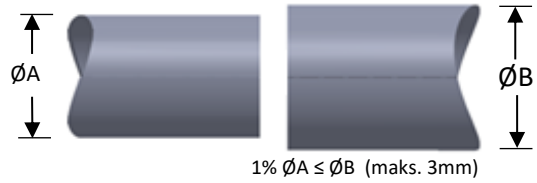

### 2.5 Kohdistus

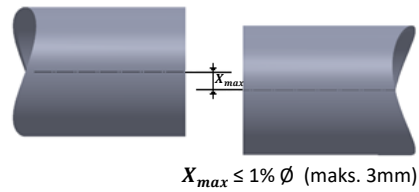

### 2.6 Soikeus

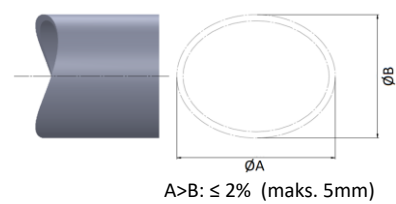

## 3. Esivalmistelut

### 3.1 Löysää pultit



### 3.2 Merkitse putki

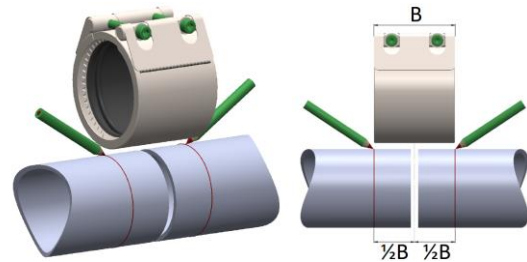

### 3.3 Puhdista putki

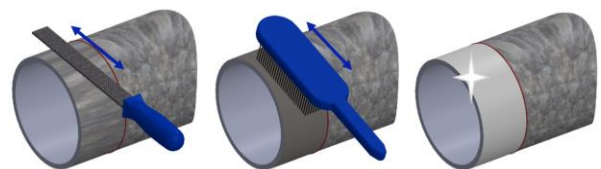

### 3.4 Tukiholkki - PE-putkeen

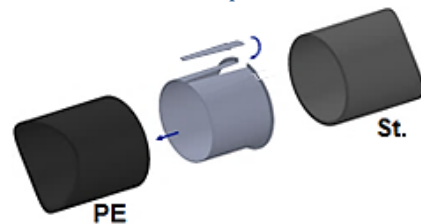



# AVK REPICO® -liitin

Asennusohjeet

Sarja 745

## 4. Kokoaminen

### 4.1 Aseta paikoilleen

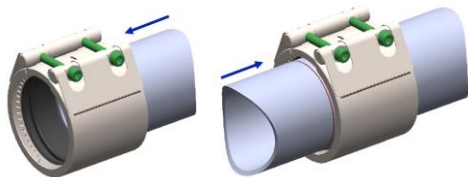

### 4.2 Kiristä osittain

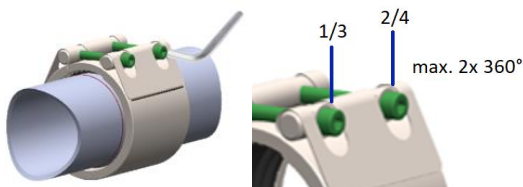

### 4.3 Älä kierrä

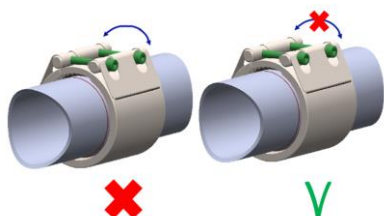

### 4.4 Kiristä momenttiin

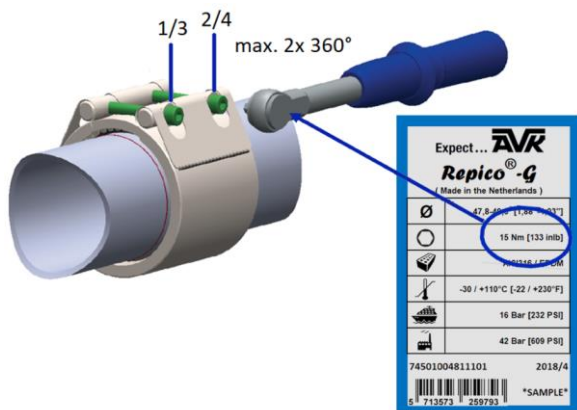

Expect... <b>AVR</b>
<b>Repico®-G</b>
(Made in the Netherlands)
Ø 47.8 [1.88" - 1.91"]
15 Nm [133 inlb]
Ø 102.0 [4.015" - 4.016"]
Ø 102.0 [4.015" - 4.016"]
-30 / +110°C [-22 / +230°F]
16 Bar [232 PSI]
42 Bar [609 PSI]
74501004811101 2018/4
5 713573 259793 *SAMPLE*

### 4.5 Varmista vuodot

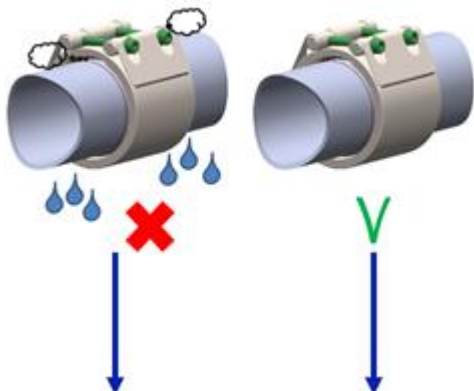

5. Purkaminen
3. Esivalmistelut
4. Kokoaminen

Done ✓

## 5. Purkaminen

### 5.1 Paine pois

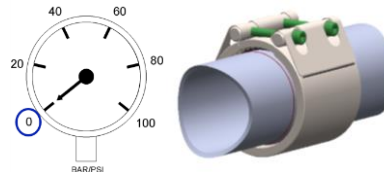

### 5.2 Varo vuotoa



### 5.3 Tue putki

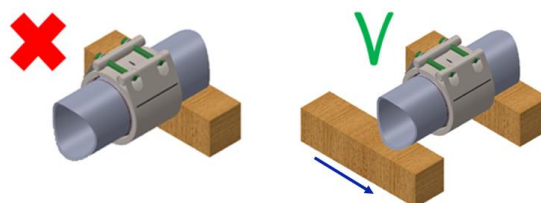

### 5.4 Löysää pultit



### 5.5 Vedä, älä käännä

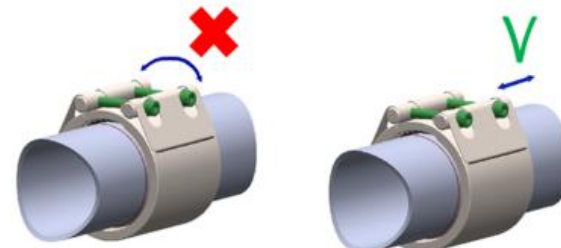

### 5.6 Poista liitin

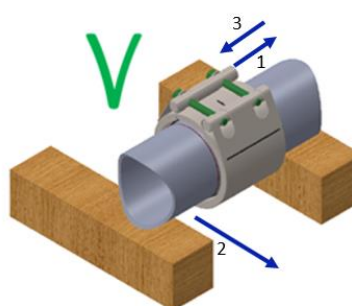

Expect... **AVR**