

# Fusion+ // user manual //

## Start-up and first settings :

First, you must remove the transparent film from outer screen guard.

The FUSION+ welding mask is then directly usable after unpacking. It is unnecessary to power up the mask, the filter darkens directly in the presence of a light source. However, we recommend to test its operation with a flash of light (lighter, flashlight ...).

To ensure a perfect fit, we recommend you to do the comfort settings on headband.

## Welding mask maintenance :

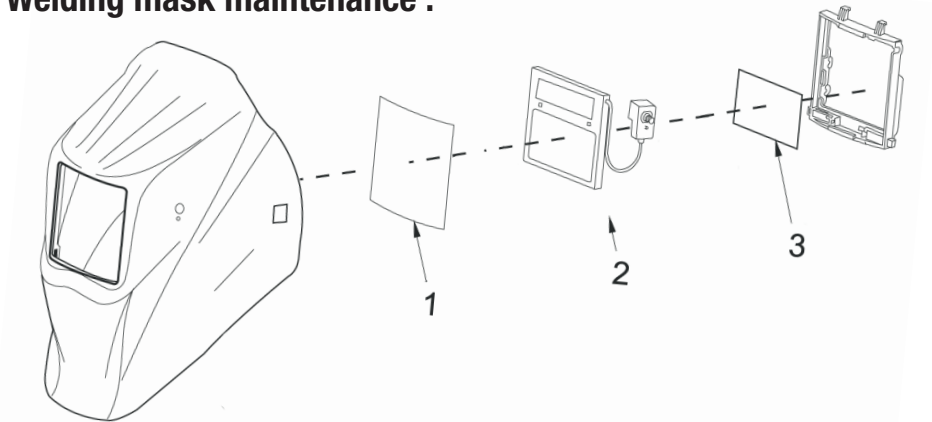

**1 ) Outer screen guard :** if this screen is dirty, damaged or scratched, Bollé Safety recommends you change it. Ideally, the screen needs to be changed weekly (1 time / week ) (ref. COVFUSPEXT).

**2 ) Auto-darkening filter B7VP :** the auto-darkening filter works with a **CR2032 battery**. The indicator «LOW BATTERY» on the filter, inside the mask, flashes a few minutes before full battery depletion. Check the proper functioning of the filter before each use and replace the battery if necessary.

**3 ) Inner screen guard :** Bollé Safety recommends regular cleaning with a microfiber cleaning cloth and/or B-Clean (cleaning solution, antibacterial, antistatic) (ref. B100 or B500). If this screen is scratched or damaged, then Bollé Safety recommends to change it monthly (1 time / month) (ref. COVFUSPINT).

**Hygienic straps :** designed to provide comfort and to absorb sweat, Bollé Safety recommends changing it every month in the interests of hygiene (ref. BESM).

**STORAGE :** the mask, if it is not used, should be stored away from light. It is best to set the filter position on «GRIND» to avoid running down the battery. After a long period of storage, it is recommended to leave the filter in the light for a few seconds to load the solar cell before using the mask.

# Frequently asked questions :

**If your filter is not darkened, it means:**

- your outer screen guard is damaged,
- the light sensors are damaged, in this case make sure they are clean, you can clean them with a B-Clean cloth.
- the sensitivity setting is too low (adjust higher)
- check the shade setting, make sure not to be on the «GRIND» position,
- the battery is low, replace it (CR2032 reference).

**The filter darkens without any arc effect:**

- the sensitivity setting is not suitable. It is too high. Decrease the sensitivity to obtain the proper setting using the «SENSITIVITY» button.



**The screen remains dark after the end of welding:**

- the delay it returns to the initial clear state is too long.  
Reduce the delay by using the button «DELAY».



**Your mask slips or falls from your head :**

- The headband is not properly adjusted, check the video shown on the front of this document to adjust the fit.

# Advice settings :

**Guide to welding shades :**

Amperage (A)	1.5	6	10	15	30	40	60	70	100	125	150	175	200	225	250	300	350	400	450	500	600
PLASMA / Plasma arc cutting									9	10	11		12			13					
Coated electrodes					8			9		10		11			12			13			14
M.A.G.							8	9		10			11			12			13		14
T.I.G on metals or metal alloys			8				9		10			11			12		13				
M.I.G on heavy metal								9		10			11		12			13		14	
M.I.G on light alloys										10			11		12		13		14		
ARC-AIR/Arc-Air gouging										10		11		12		13		14			
MICRO-PLASMA / Micro plasma welding	4		5		6		7		8		9		10		11		12				

To select the correct filter shade, firstly use the switch inside the helmet to select the corresponding shade range (choose between 5-8 or 9-13). Use the setting button on the outside of the helmet to select the precise shade. Select the «Grind» position to obtain shade 4 (filter's clear state).  
For example to select shade 9, set the switch of the filter inside the helmet to position «9-13» then select via the outer button the position 9. For shade 4, simply select the «Grind» position on the outer button.

**Recommended setting for TIG welding or continuous welding:**

- time to return to clear state : «MAX» position
- highest sensitivity: «HI» position



Delay



Sensitivity

**Recommended setting for spot welding:**

- time to return to clear state : «MIN» position
- highest sensitivity: «HI» position



Delay



Sensitivity

**Recommended setting for MIG / MAG welding:**

- time to return to clear state : «MAX» position
- highest sensitivity: «HI» position



Delay



Sensitivity

**Recommended setting for Plasma welding:**

- time to return to clear state : «MAX» position
- highest sensitivity: «HI» position



Delay



Sensitivity

Generally, it is recommended for any type of welding to adjust sensitivity on the highest level , «HI» position.

## Europe / Bollé Safety

95, rue Louis Guérin  
69100 Villeurbanne - France  
Tél. 00 33 (0)4 78 85 23 64  
Fax : 00 33 (0)4 78 85 28 56  
E-mail : [contact@bolle-safety.com](mailto:contact@bolle-safety.com)

## UK & Ireland / Bollé Safety

Unit C83 - Barwell Business Park  
Leatherhead Road - Chessington  
Surrey - KT9 2NY  
Tel. 00 44 (0)208 391 4700  
Fax: 00 44 (0)208 391 4733  
E-mail: [sales@bolle-safety.co.uk](mailto:sales@bolle-safety.co.uk)