

Axessor Apexx Keypad

Quick Start Guide

Axessor Apexx Keypad (Front View)



Numeric Keypad
(With Directional Arrows)

Back

Enter

Menu Display

Axessor Apexx Keypad
(Side/Bottom View)



USB-C Port

Battery Access Button

Axessor Apexx Keypad & Apexx Series Lock Installation

A

1 DRILL-DEBURR-TAP (Keypad holes)

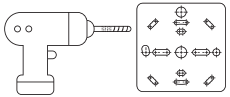

2 DRILL-DEBURR-TAP (Lock holes)

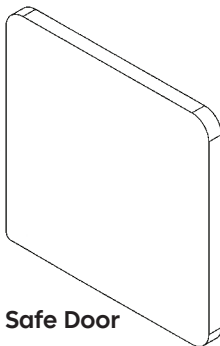
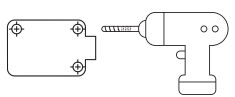

Safe Door

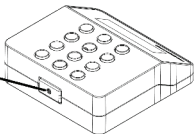
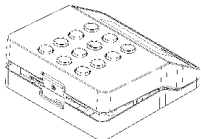
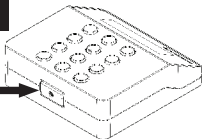
B**3 REMOVE SCREW****4 PRESS BUTTON****5 LIFT + SEPARATE**

Side View

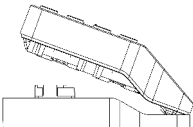

Faceplate

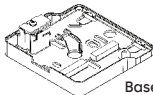

Baseplate

C**6**

x2
Metric M4-07
US Customary
Unit #8-32

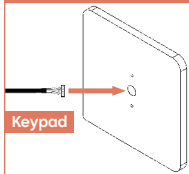
7**8****11**

Inside Faceplate

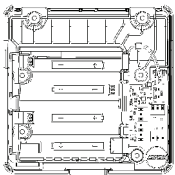

AA Batteries x4

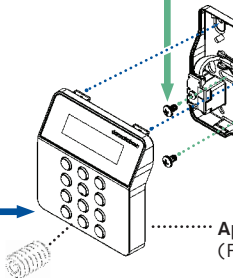

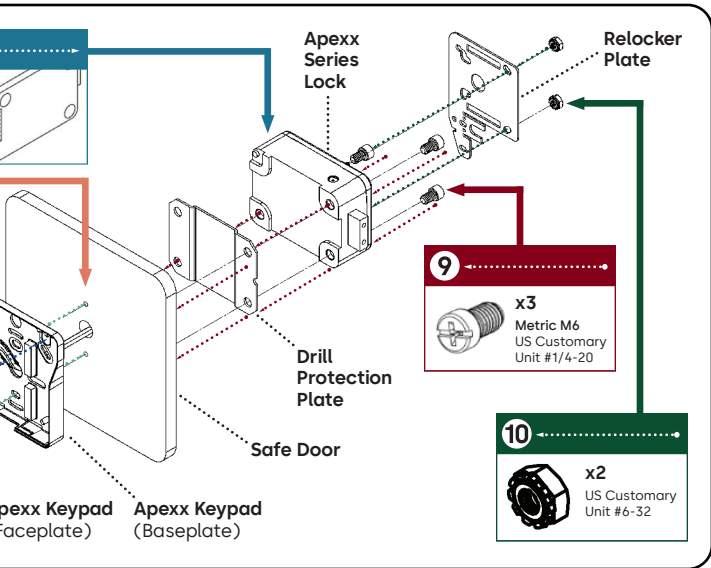

TEAR HERE



Drill-Deburr-Tap Templates

Apex Series Lock

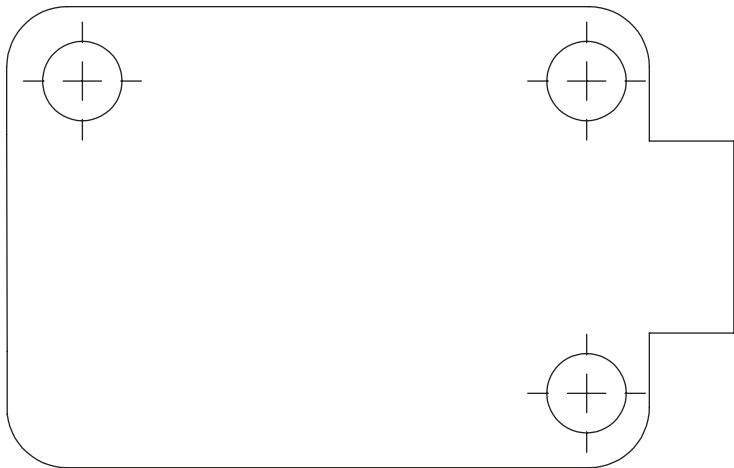

TEAR HERE



TEAR HERE



Axessor Apexx Keypad

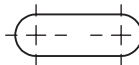
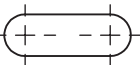

TEAR HERE





Instructions

For detailed instructions go to: www.dormakaba.com



APEXX
INSTALLATION AND
OPERATION GUIDES

Languages

For translations of this guide in easy print format:

dormakaba-safelocks.link/apexx-quickstart

(EN, DE, ES, FR, IT, PL, PT)



Any questions? We would be happy to advise you.

Contact us: sales.safelocks.us@dormakaba.com

Tech Support: SALTechSupport@dormakaba.com

dormakaba USA Inc. | 2031 Georgetown Road, Suite 125 | Lexington, KY 40511
+1 800 950 4744 | +1 888 950 4715 (tech support) | dormakaba.com

apexx.qsg.june2026
801.0123 REV B



1 Admin Setup

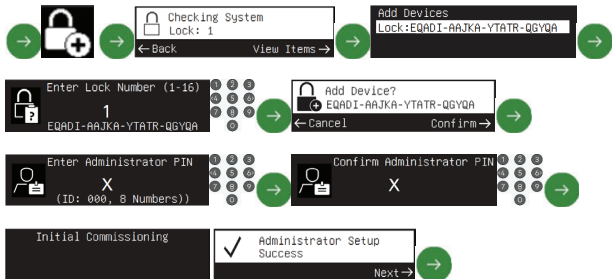

2 Set Time and Date

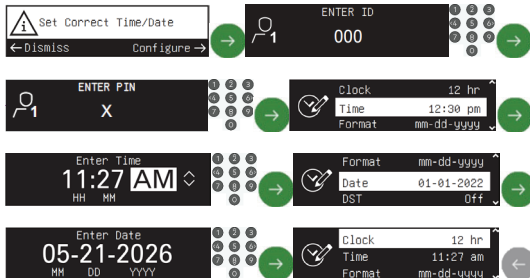

3 Set Tenant Modes: Bank, OTC, ICS



4 Change PIN



5 Set Bank Admin and PIN

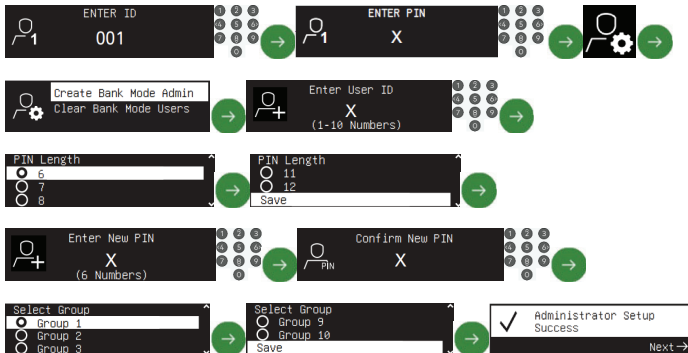

6 OTC Configure

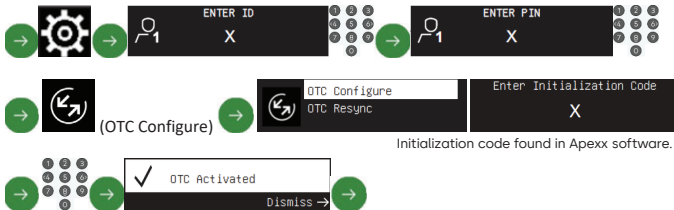

7 Open Bank

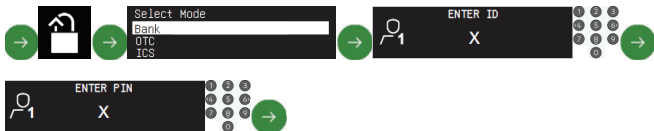

8 Open OTC

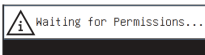

Step 8 requires Apex software.

9 Open ICS

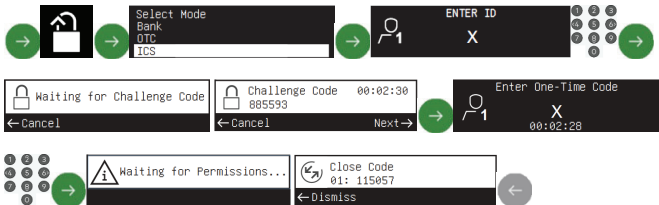

Step 9 requires Apexx software.