

Maximum reliability. Minimum fuss.



Selector Guide

---

# Kingspan KS1000 TS

**Kingspan**

Fastener Systems and Sealing Products

# Contents

Products for Specific Applications	3 - 7
Accessories	8
Technical Data	10 - 12
Technical Notes	13

## Introduction to Fixfast

Fixfast design, manufacture and supply specialist building fasteners and components for the walls and roofs of industrial, commercial and larger residential buildings. We collaborate with major building envelope system manufacturers, such as Kingspan, to provide them and their clients with engineered fastening and sealing solutions.

This selector guide has been created as an easy to use reference document, identifying the most common fasteners and components for use when installing the Kingspan KS1000 TS panel system.

Full technical data for these products along with application uses can be found on our website at [www.fixfast.com](http://www.fixfast.com) by searching for the product.

Our specification team can assist in providing NBS specifications for specific projects, whilst our customer services team can answer questions regarding the usage or ordering of Fixfast products.

If you have any queries regarding our products or services then please do contact our customer services team on 0800 304 7616 or by emailing [sales@fixfast.com](mailto:sales@fixfast.com).

## KS1000 TS primary fixing to cold rolled steel 1.2mm - 3.0mm

### Use DrillFast® DF3-HT Fasteners

8mm hex head, use Fixfast GreenDrive for stainless fasteners and Fixfast YellowDrive for carbon fasteners.

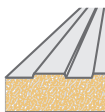

Panel Thickness	Fastener Code Stainless*	Fastener Code Carbon
40mm	DF3-SS-HT-A19-5.5 x 85	DF3-HT-A19-5.5 x 65
50mm	DF3-SS-HT-A19-5.5 x 85	DF3-HT-A19-5.5 x 85
60mm	DF3-SS-HT-A19-5.5 x 110	DF3-HT-A19-5.5 x 85
70mm	DF3-SS-HT-A19-5.5 x 110	DF3-HT-A19-5.5 x 105
80mm	DF3-SS-HT-A19-5.5 x 110	DF3-HT-A19-5.5 x 105
100mm	DF3-SS-HT-A19-5.5 x 130	DF3-HT-A19-5.5 x 130
115mm	DF3-SS-HT-A19-5.5 x 150	DF3-HT-A19-5.5 x 150
120mm	DF3-SS-HT-A19-5.5 x 150	DF3-HT-A19-5.5 x 150
137mm	DF3-SS-HT-A19-5.5 x 180	DF3-HT-A19-5.5 x 180
150mm	DF3-SS-HT-A19-5.5 x 180	DF3-HT-A19-5.5 x 180

\* A4/316 fasteners available for up to 40 year warranty

For fixing panels to timber, please contact Fixfast Customer Service team on **0800 304 7616**

## KS1000 TS primary fixing to hot rolled steel 4.0mm - 12.0mm

### Use DrillFast® DF12-HT fasteners

8mm hex head, use Fixfast GreenDrive for stainless fasteners and Fixfast YellowDrive for carbon fasteners.

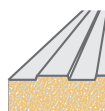

Total Panel Thickness	Fastener Code Stainless*	Fastener Code Carbon
40mm	DF12-SS-HT-A19-5.5 x 115	DF12-HT-A19-5.5 x 85
50mm	DF12-SS-HT-A19-5.5 x 115	DF12-HT-A19-5.5 x 105
60mm	DF12-SS-HT-A19-5.5 x 115	DF12-HT-A19-5.5 x 105
70mm	DF12-SS-HT-A19-5.5 x 150	DF12-HT-A19-5.5 x 125
80mm	DF12-SS-HT-A19-5.5 x 150	DF12-HT-A19-5.5 x 125
100mm	DF12-SS-HT-A19-5.5 x 150	DF12-HT-A19-5.5 x 145
115mm	DF12-SS-HT-A19-5.5 x 200	DF12-HT-A19-5.5 x 165
120mm	DF12-SS-HT-A19-5.5 x 200	DF12-HT-A19-5.5 x 165
137mm	DF12-SS-HT-A19-5.5 x 200	DF12-HT-A19-5.5 x 185
150mm	DF12-SS-HT-A19-5.5 x 200	DF12-HT-A19-5.5 x 185

\* A4/316 fasteners available for up to 40 year warranty

## KS1000 TS fixing timber tile battens to the face of the panel - option 1

Use SureFast SF-RS-SS-A4-4.8 Stainless fasteners

Use SureFast SF-RS-5.8 fasteners

Torx 25 drive, low profile head - use TX25 and bit holder.



Batten Thickness	Fastener Code - Stainless	Fastener Code - Carbon
25mm	SF - RS - SSA4 - 4.8 x 60	SF - RS - 5.8 x 55

## KS1000 TS fixing timber tile battens to the face of the panel - option 2

Use Drillfast Stainless DFTB-SS-6.0 fasteners

Torx 30 drive, countersunk head - use TX30 and bit holder.

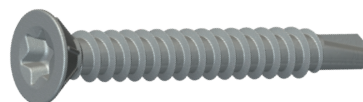
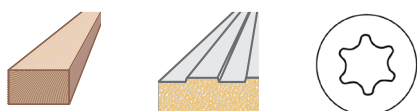

Batten Thickness	Fastener Code - Stainless
25mm	DFTB-SS-6.0 x 45

KS1000 TS secondary stitcher

Use DrillFast® stitching fasteners.

8mm hex head, use Fixfast GreenDrive for stainless steel or YellowDrive for carbon steel.

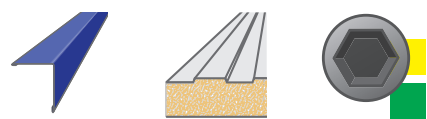

Fastener Code Stainless*	Fastener Code Carbon
DF2-SS-A15-6.3 x 25	DF2-LS-A15-6.3 x 25
* A4/316 fasteners available for up to 40 year warranty	

## Sealant for end and side laps

Use A Class butyl strip sealant



Sealant Code	Thickness x width (mm)	Roll Length
A-4 dia x 12	4 dia bead	12

## Air Sealant

Use A Class butyl strip sealant



Sealant Code	Thickness x Width (mm)	Roll Length (m)
A-8 dia x 6	8 dia bead	6

## Vapour Sealant

Use A Class butyl strip sealant



Sealant Code	Thickness x width (mm)	Roll length (m)
A-6 dia x 8	6 dia bead	8

## Fire resistant construction foam for filling ridge and hip junctions

### Use Firefoam B1



Sealant Code	Cartridge Size (ml)	Fitting
FIREFOAM-B1-GUN	750	Screwtop
FIREFOAM-B1-HAND	750	Manual

## PVC Foam Tape for all internal air sealing

### Use PVC foam air sealing tape



Sealant Code	Thickness x Width (mm)	Roll Length (m)
AST-6 x 20 x 12	6 x 20	12

### GreenDrive

One-piece drive socket for DrillFast® stainless fasteners, supports the head for easy accurate driving.

**Product Code:** GREENDRIVE



### YellowDrive

One-piece drive socket for DrillFast® carbon fasteners, supports the head for easy accurate driving.

**Product Code:** YELLOWDRIVE



### Torx drive bits

Drive bit for low profile head fasteners.  
SureFast SF-RS-5.8 and SF-RS-SSA4-4.8

**Product Code:** TX25

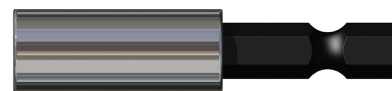

Drive bit for countersunk head fasteners.  
Drillfast DFTB-SS-6.0

**Product Code:** TX30

Many other tools and accessories are available.

Please see the current Fixfast Product Directory,  
go to **[www.fixfast.com](http://www.fixfast.com)**, or ask the Fixfast customer service team.



- **Installation tool**

Variable speed electric screwdriver

- **Installation drive**

Fixfast GreenDrive, Fixfast YellowDrive or Torx drive bits, depending on the fastener being used

- **Installation speed**

1500rpm

- **Correct Installation**

Fasteners should be driven within three degrees of perpendicular to the surface of the fastened material. Use a depth-setting nosepiece to avoid over-driving, and do not over-tighten. Variants with bonded washers should not have the rubber compressed to less than two-thirds of its uncompressed height. Care should be taken when engaging and disengaging from the fastener and to avoid damage to the protective coating.

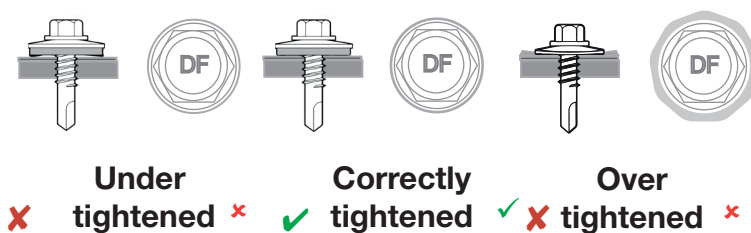

- **Handling**

Fasteners may have sharp edges, and the use of power tools can be dangerous. Use personal protective equipment. Store fasteners in dry conditions. Inspect each fastener before use and do not use damaged fasteners. Replace any fasteners which appear to have been installed incorrectly.

## Technical Data

### DF3-SS-HT-5.5 Range

Material	1.4301 stainless steel (304M), with steel case hardened welded point
Coating	Organic
Drilling Capacity	1.2mm - 3.0mm steel
Pull-out Values (axial load resistance)	
Substrate	Characteristic value
1.2mm Steel	1.30kN
2.0mm Steel	2.62kN
3.0mm Steel	4.76kN
Softwood 35mm Embedment	3.57kN

### DF3-HT-5.5 Range

Material	Steel SAE1022 case hardened
Coating	Organic
Drilling Capacity	1.2mm - 3.0mm steel
Pull-out Values (axial load resistance)	
Substrate	Characteristic value
1.2mm Steel	1.52kN
2.0mm Steel	3.01kN
3.0mm Steel	5.42kN
Softwood 35mm Embedment	3.57kN

### DF12-SS-HT-5.5 Range

Material	1.4301 Stainless steel (304M), with steel case hardened welded point
Coating	Organic
Drilling Capacity	4.0mm - 12.0mm steel
Pull-out Values (axial load resistance)	
Substrate	Characteristic value
4.0mm Steel	2.80kN
6.0mm Steel	3.09kN
8.0mm Steel	6.89kN
12.0mm Steel	6.89kN

## Technical Data

### DF12-HT-5.5 Range

Material	SAE1022 steel case hardened
Coating	Organic
Drilling Capacity	4.0mm - 12.0mm steel
Pull-out Values (axial load resistance)	
Substrate	Characteristic value
4.0mm Steel	5.44kN
6.0mm Steel	12.75kN
8.0mm Steel	13.92kN
12.0mm Steel	13.92kN

### DFTB-SS-6.0 Range

Material	1.4301stainless steel (304M), steel case hardened welded point
Coating	Organic
Drilling Capacity	0.7mm - 2.0mm steel
Pull-out Values (axial load resistance)	
Substrate	Characteristic value
1.2mm Steel	2.81kN
2.0mm Steel	4.78kN

### SF-RS-5.8 range

Material	SAE1022 steel case hardened
Coating	Organic
Drilling Capacity	max 2 x 1.0mm S275 steel
Pull-out Values (axial load resistance)	
Substrate	Characteristic value
0.5mm Steel	0.84kN
0.7mm Steel	1.43kN
0.9mm Steel	1.93kN
1.2mm Steel	2.87kN
18.0mm Ply	2.10kN
18.0mm OSB	1.58kN
Softwood 35mm Embedment	4.06kN

## Technical Data

### SF-RS-SSA4-4.8 range

Material	A4 stainless steel, with SAE1022 steel case hardened welded point
Coating	Organic
Drilling Capacity	max 2 x 1.0mm S275 steel
Pull-out Values (axial load resistance)	
Substrate	Characteristic value
0.7mm Steel	1.08kN
0.9mm Steel	1.45kN
1.2mm Steel	2.24kN
18.0mm Ply	1.77kN
18.0mm OSB	1.37kN
Softwood 35mm Embedment	3.89kN

### DF2-SS-LS-6.3 x 25

Material	1.4301 stainless steel (304M), with steel case hardened welded point
Coating	Organic
Drilling Capacity	Max 2 x sheets 1.0mm 275 Steel
Pull-out Values (axial load resistance)	
Fastener	Characteristic value
DF2-SS-LS-6.3 x 25	0.60kN

### DF2-LS-6.3 x 25

Material	Steel SAE1022 case hardened
Coating	Organic
Drilling Capacity	Max 2 x sheets 1.0mm S275 Steel
Pull-out Values (axial load resistance)	
Substrate	Characteristic value
0.5mm Steel	0.68kN

### Fastener Data

- + All dimensions are subject to manufacturing tolerances.
- + Performance values are tested and calculated according to Eurocode procedures and appropriate safety factors should be applied in any calculations using these values.

### Fastener Selection

- + Recommended fastener lengths are calculated using standard tolerances for the fasteners and the combination of materials in the build-up.
- + If there is distortion in the supporting construction, or other non-standard application detail, longer fasteners may be necessary than those shown. Always check the actual circumstances before deciding on a particular length.

### Further Assistance

- + For any enquiry, or to discuss your requirements with someone knowledgeable, call the Fixfast customer service team on **0800 304 7616**.
- + Full literature is available for the Fixfast range, or visit **[www.fixfast.com](http://www.fixfast.com)**
- + Other performance data may be available on request. For more unusual applications, tests can be carried out in our in-house technical centre to provide the necessary data.
- + Site visits are also possible, particularly for pull-out performance into concrete, masonry or other variable substrates. Please ask for a Site Visit Request form if you think this service would be useful.
- + CAD files of fasteners are available on request for inclusion in drawings.

The information contained in this document is based on the specification of the Kingspan KS1000 TS system and Fixfast's product data. It is provided in good faith but Fixfast cannot be held liable for any errors. Performance is dependent on adherence to the conditions and instructions contained in Fixfast's Technical Data Sheets for the products shown. Performance values should be approved by a qualified engineer, and Fixfast recommend preliminary tests for any application where variation is possible in the materials or substrates involved.

This image shows a full page of blank, lined paper. It features approximately 20 evenly spaced horizontal grey lines across its entire width, typical of notebook or school paper. There are no margins, text, or other markings present.





Merlin House  
Seven Mile Lane  
Borough Green  
Sevenoaks  
Kent  
TN15 8QY

**Enquiries**  
0800 304 7616  
**International**  
+44 (0) 1732 882387  
**Fax**  
0845 450 7486  
**Email**  
info@fixfast.com



Certificate number 10905  
ISO 9001, ISO 14001  
ISO 45001