

SELECTOR GUIDE

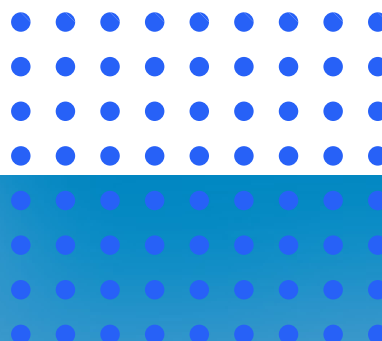

Maximum reliability. Minimum fuss.



Protex Building Envelope



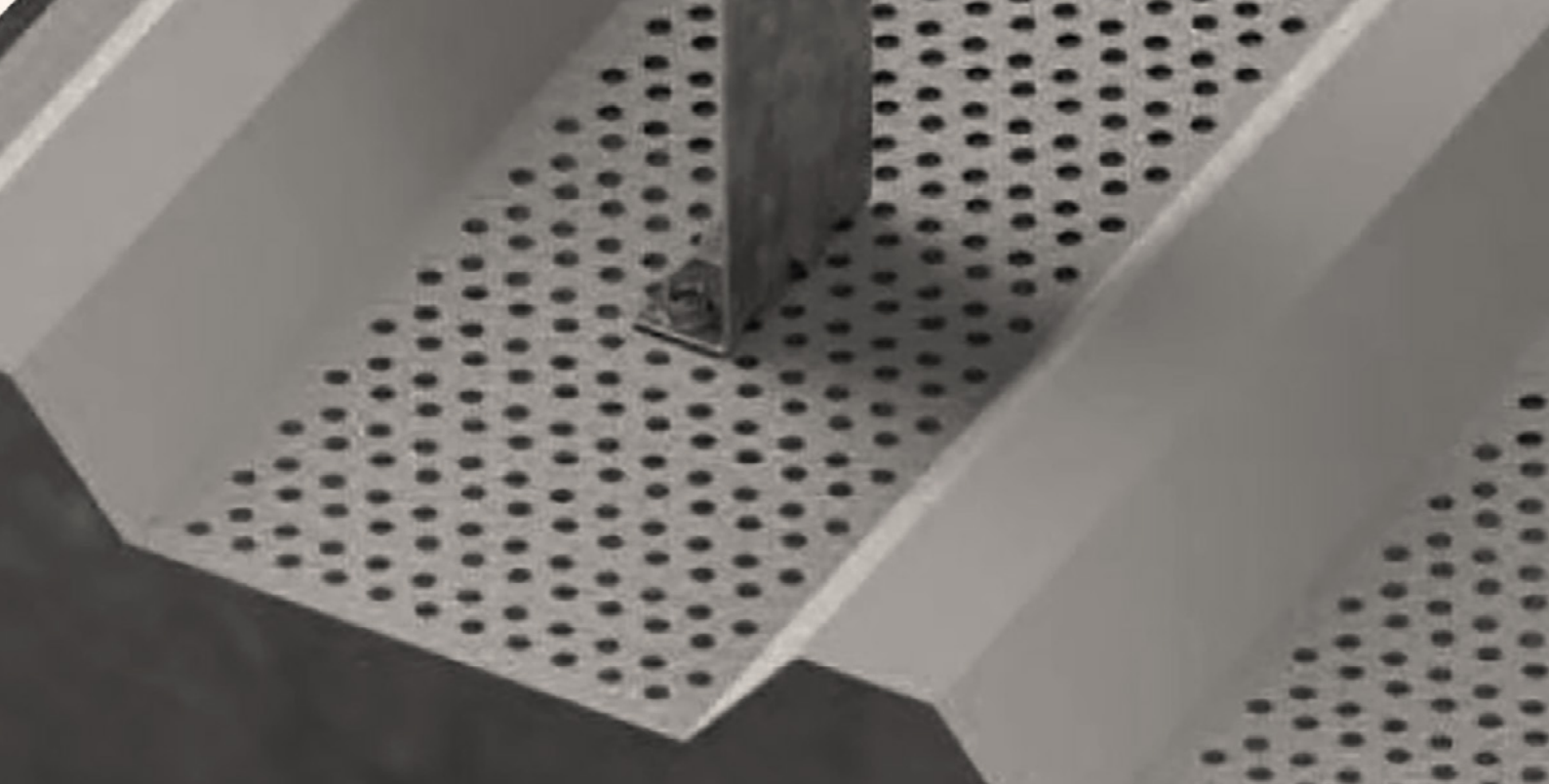

Fixfast design, manufacture and supply specialist building fasteners and components for the walls and roofs of industrial, commercial and larger residential buildings. We collaborate with major building envelope system manufacturers, such as Firth Steels, to provide them and their clients with engineered fastening and sealing solutions.

This selector guide has been created as an easy to use reference document, identifying the most common fasteners and components for use when installing the Firth Steels Protex Building Envelope system.

Full technical data for these products along with application uses can be found on our website at www.fixfast.com by searching for the product.

Our specification team can assist in providing NBS specifications for specific projects, whilst our customer services team can answer questions regarding the usage or ordering of Fixfast products.

If you have any queries regarding our products or services then please do contact our customer services team on +44 (0) 1732 882387 or by emailing sales@fixfast.com.



Full technical data for these products along with application uses can be found on our website at www.fixfast.com by searching for the product.

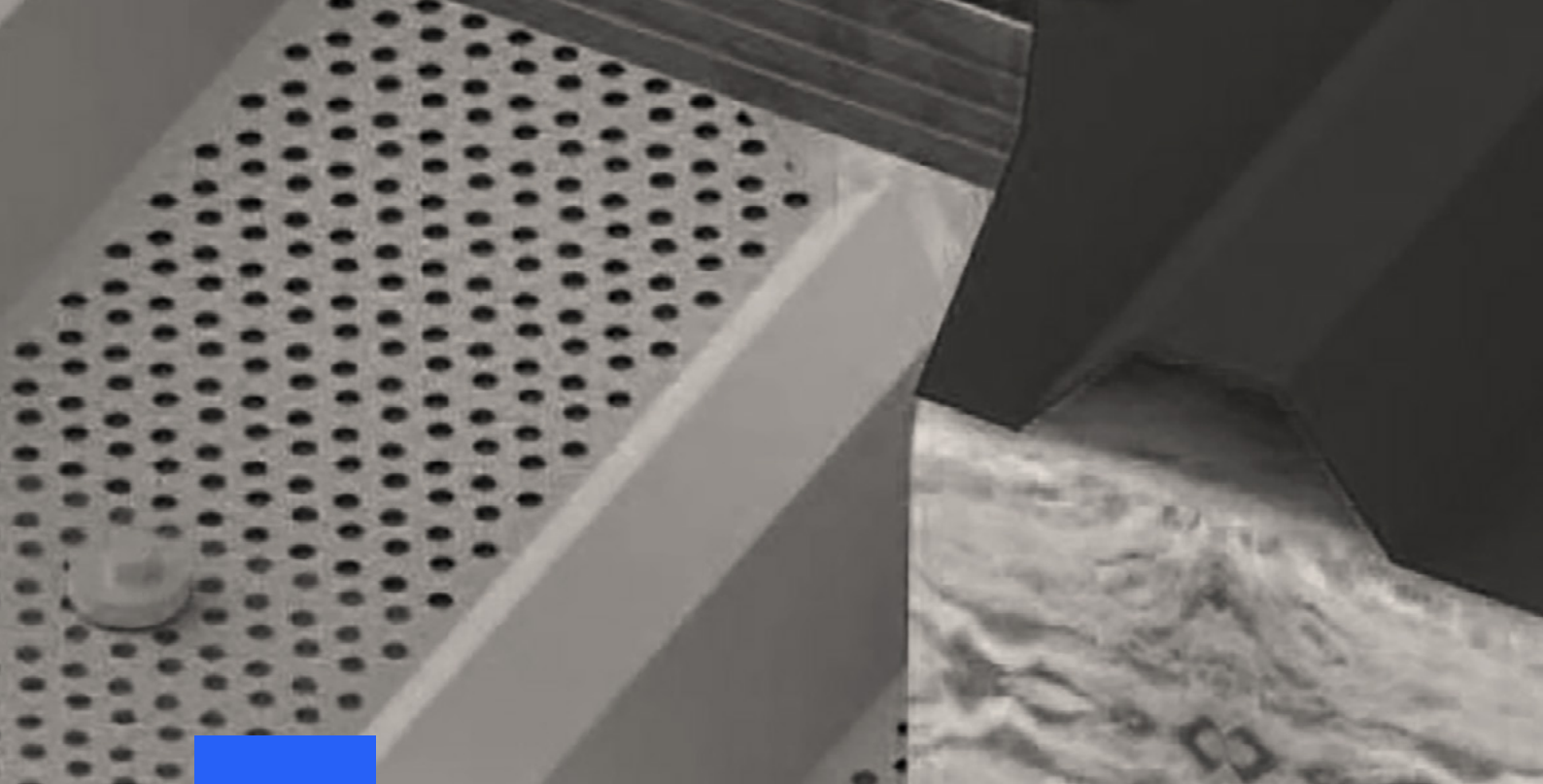

Contents

Products for specific applications	03
Accessories	11
Technical notes	12

Main outer fixing to cold rolled steel

Use MatchFast® stainless steel fasteners.

Use A15 washer for wall application and A19 washer for roof application. 11mm bi-hex head, use Fixfast MF1165 drive.



Fastener Code

MF3-SS-A19-5.5 x 35 (roof application)

MF3-SS-A15-5.5 x 35 (roof application)

Outer fixing - stitcher

Use MatchFast® stainless steel fasteners.

11mm bi-hex head, use Fixfast MF1165 drive.



Fastener Code

MF2-SS-A15-6.3 x 25

Outer fixing - rivets

Use TriGrip rivets and standard rivets.

Use powered riveting gun for installation.

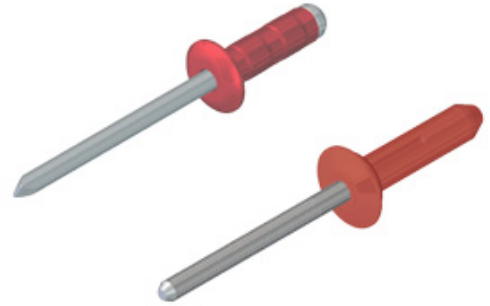

Fastener Code

RTG-AA-LAC-5.2x19

RSS-LAC-4.8x10

Main inner fixing to cold rolled steel

Use DrillFast® stainless steel fasteners.

8mm hex head, use Fixfast GreenDrive.

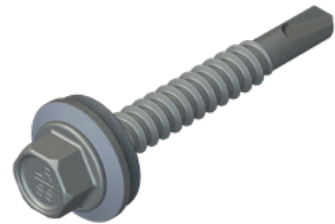

Fastener Code

DF3-SS-A15-5.5x25

Main inner fixing to hot rolled steel

Use DrillFast® stainless steel fasteners.

8mm hex head, use Fixfast GreenDrive.



Fastener Code

DF12-SS-A15-5.5 x 40

Main inner fixing to timber

Use DrillFast® stainless steel fasteners.

8mm hex head, use Fixfast GreenDrive.

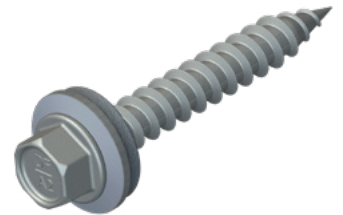
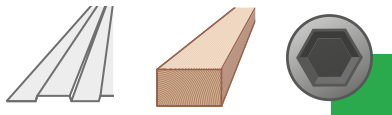

Fastener Code

DFT-SS-A15-6.0 x 50

Inner fixing - stitcher

Use DrillFast® stainless steel fasteners.

8mm hex head, use Fixfast GreenDrive.



Fastener Code

DF2-SS-LS-A15-6.3 x 25

Inner fixing - rivets

Use TriGrip rivets and standard rivets.

Use powered riveting gun for installation.



Fastener Code

RTG-AA-5.2 x 19

R-AC-4.8 x 10

Butyl strip sealant for and and side lap application on top sheet. (Also use for end lap application on liner sheet)

Use A Class butyl strip sealant



Sealant Code	Thickness x width (mm)	Roll length (m)	Box Quantity
A-5x6x9.6	9x3	9.6	30

Polyband butyl tape for side laps in a liner application

Use PB-50 butyl tape



Sealant Code	Thickness x width (mm)	Roll length (m)	Box Quantity
PB-50	1.5x50	35	6

Bedding sealant for filler blocks at ridges and hips

Use Seelex BR gun grade solvent release bedding sealant



Fastener Code

SEELEXBR

Main outer sheet fixing to cold rolled steel - Rooflight fixings

Use MatchFast® stainless steel fasteners.

11mm bi-hex head, use Fixfast MF1165 drive.



Fastener Code

MF3-SS-L29-5.5 x 35

Outer fixing - stitcher - Rooflight fixings

Use MatchFast® stainless steel fasteners.

11mm bi-hex head, use Fixfast MF1165 drive.



Fastener Code

MF2-SS-A19-6.3 x 25

Main liner sheet fixing to cold rolled steel - Rooflight fixings

Use DrillFast® stainless steel fasteners.

8mm hex head, use Fixfast GreenDrive.



Fastener Code

DF3-SS-A29-5.5 x 35

Main liner sheet fixing to hot rolled steel - Rooflight fixings

Use DrillFast® stainless steel fasteners.

8mm hex head, use Fixfast GreenDrive.

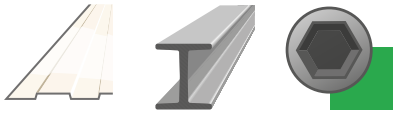

Fastener Code

DF12-SS-A29-5.5 X 40

Main liner sheet fixing to timber - Rooflight fixings

Use DrillFast® stainless steel fasteners.

8mm hex head, use Fixfast GreenDrive.

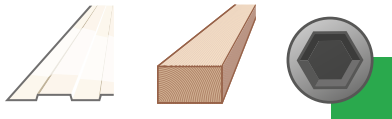

Fastener Code

DFT-SS-L29-6.0 x 50

Liner sheet fixing - stitcher - Rooflight fixings

Use DrillFast® stainless steel fasteners.

8mm hex head, use Fixfast GreenDrive.



Fastener Code

DF2-SS-A15-6.3 x 25

Technical Notes

Fastener Data

- All dimensions are subject to manufacturing tolerances.
- Performance values are characteristic failure values and appropriate safety factors should be applied in any calculations using these values.
- Build-up figures are for the specific fastener variant shown, into the maximum thickness of standard substrate. These figures may be increased by the thickness difference for thinner substrates and may not apply for different uses.

Fastener Selection

- Recommended fastener lengths are calculated using standard tolerances for the fasteners and the combination of materials in the build-up.
- If there is distortion in the supporting construction, or other non-standard application detail, longer fasteners may be necessary than those shown. Always check the actual circumstances before deciding on a particular length.

Further Assistance

- For any enquiry, or to discuss your requirements with someone knowledgeable, call the Fixfast customer service team on 0800 304 7616.
- Full literature is available for the Fixfast range, or visit www.fixfast.com.
- Other performance data may be available on request. For more unusual applications, tests can be carried out in our in-house technical centre to provide the necessary data.
- Site visits are also possible, particularly for pull-out performance into concrete, masonry or other variable substrates. Please ask for a Site Visit Request form if you think this service would be useful.
- CAD files of fasteners are available on request for inclusion in drawings.

The information contained in this document is based on the specification of the Firth Steels Protex Building system and Fixfast's product data. It is provided in good faith but Fixfast cannot be held liable for any errors. Performance is dependent on adherence to the conditions and instructions contained in Fixfast's Technical Data Sheets for the products shown. Performance values should be approved by a qualified engineer, and Fixfast recommend preliminary tests for any application where variation is possible in the materials or substrates involved.

Accessories

Green Drive

One-piece drive socket with retaining clip for 8mm hex head DrillFast stainless steel fasteners.

Product Code: MF1165



MF1165 Drive

One-piece recess drive socket - 11mm bi-hex for MatchFast fasteners, supports the head for easy accurate driving.

Product Code: MF1165





Contact Details:

T: +44 (0) 1732 882387

E: info@fixfast.com

W: fixfast.com

