

Confidence in every **Connection**™



Rainscreen Fastener Selector Guide



Fixfast design, manufacture and supply specialist building fasteners and components for the walls and roofs of industrial, commercial and larger residential buildings.

This selector guide has been created as an easy to use reference document, identifying the most common fasteners and components for use when installing Rainscreen facade systems.

Full technical data for these products along with application uses can be found on our website at www.fixfast.com by searching for the product or by emailing tech@fixfast.com.

Our specification team can assist in providing NBS specifications for specific projects, whilst our customer services team can answer questions regarding the usage or ordering of Fixfast products.

If you have any queries regarding our products or services then please do contact our customer services team on 0800 304 7616 or by emailing sales@fixfast.com.



Full technical data for these products along with application uses can be found on our website at www.fixfast.com by searching for the product.



Contents

Products for specific applications	03
Accessories	14
Installation and handling	17
Technical notes	18

Substrate Fasteners - Support structure to Concrete.

Installing Helping Hand Brackets and metal sections to Concrete.

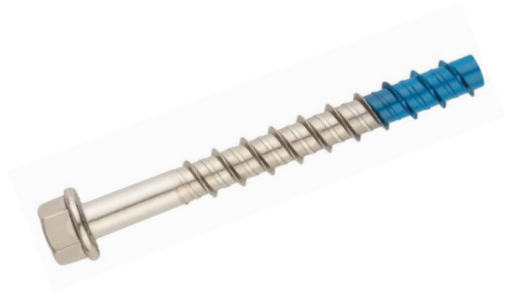

Please note a site pull out test maybe required to determine the Length and what anchor is most suitable, you can book a visit by emailing tech@fixfast.com.

Application	Product Code	Description	Drive Socket
Install Bracket to Concrete	TXE-8 x Length	A4 stainless concrete screw, for use in cracked and non-cracked concrete	13mm Integral Socket
Install Bracket to Concrete	APA4-8 x Length	A4 stainless through-bolt expansion anchor for use in cracked and non cracked concrete	9.5mm Torque Wrench
Install Nested C-Channel to Concrete	APA4-8 x Length	A4 stainless through-bolt expansion anchor for use in cracked and non cracked concrete	9.5mm Torque Wrench
Install Omega Rail to Concrete	APA4-8 x Length	A4 stainless through-bolt expansion anchor for use in cracked and non cracked concrete	9.5mm Torque Wrench
Install Z-Rrail to Concrete	APA4-8 x Length	A4 stainless through-bolt expansion anchor for use in cracked and non cracked concrete	9.5mm Torque Wrench

Substrate Fasteners - Support structure to Masonry

Installing Helping Hand Brackets and metal sections to Masonry.



Please note a site pull out test maybe required to determine the Length and what anchor is most suitable, you can book a visit by emailing tech@fixfast.com.

Application	Product Code	Description	Drive Socket
Install Bracket to Masonry or Blockwork	MFRFB-10 x Length SSKS A4	CELO 10mm multifunctional frame plug with stainless A4 hex screw	13mm Integral Socket
Install Bracket to Concrete	MFRFB-10 x Length SSKS A4	CELO 10mm multifunctional frame plug with stainless A4 hex screw	13mm Integral Socket
Install Nested C-Channel to Masonry or Blockwork	MFRFB-10 x Length SSKS A4	CELO 10mm multifunctional frame plug with stainless A4 hex screw	13mm Integral Socket
Install Omega Rail to Masonry or Blockwork	MFRFB-10 x Length SSKS A4	CELO 10mm multifunctional frame plug with stainless A4 hex screw	13mm Integral Socket

Substrate Fasteners - Support structure to Steel Framing Systems

Installing Helping Hand Brackets and metal sections to steel framing systems.

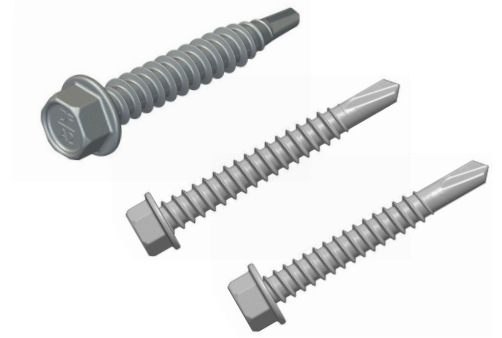
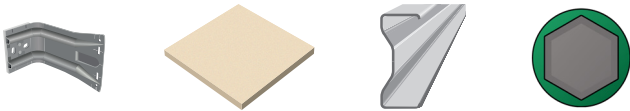

Application	Product Code	Description	Drive Socket
Install bracket to 2mm Steel framing	DF2-SS-6.0 x 35	A2/304 grade stainless steel halter fasteners for fixing to light section steel up to 2mm	GREENDRIVE
Install bracket to 3mm Steel framing	DF3-SS-6.0 x 45	A2/304 grade stainless steel halter fasteners for fixing to light section steel up to 3mm	GREENDRIVE
Install bracket to 2mm Steel framing (Marine Environment)	DF2-SSA4-6.0 x 35	A4/316 grade stainless steel halter fastener for fixing to timber or light section steel up to 2.0mm.	GREENDRIVE
Install through 12mm sheathing board into 2mm	DF2-SS-6.0 x 45	A2/304 grade stainless steel halter fasteners for fixing to light section steel up to 2mm	GREENDRIVE
Install through 12mm sheathing board into 3mm	DF3-SS-6.0 x 45	A2/304 grade stainless steel halter fasteners for fixing to light section steel up to 3mm	GREENDRIVE
Install through 12mm+ sheathing board into 3mm	DF3-SS-5.5 x Length	A2/304 grade stainless steel fastener for fixing to light metal purlins and rails up to 3mm	GREENDRIVE
Install Nested C-Channel, Omega or Z-Rail to <2mm Steel	DF2-SS-6.0 x 35	A2/304 grade stainless steel halter fasteners for fixing to light section steel up to 2mm	GREENDRIVE
Install Nested C-Channel, Omega or Z-Rail to >2mm Steel	DF3-SS-6.0 x 45	A2/304 grade stainless steel halter fasteners for fixing to light section steel up to 3mm	GREENDRIVE
Install bracket to C-Channel, Omega or Z-Rail	DF2-SS-6.0 x 35	A2/304 grade stainless steel halter fasteners for fixing to light section steel up to 2mm	GREENDRIVE

Substrate Fasteners - Support structure for timber substrates

Installing Helping Hand Brackets and metal sections to timber substrates.

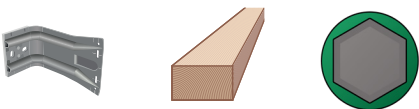

Application	Product Code	Description	Drive Socket
Install bracket to softwood timber	DFT-SS-6.0 x Length	A2/304 grade stainless steel fasteners for fixing into timber.	GREENDRIVE
Install bracket to the 100mm CLT Board	DFT-SS-6.0 x Length	A2/304 grade stainless steel fasteners for fixing into timber.	GREENDRIVE
Install Nested Omega or Z-Rail to softwood timber	DFT-SS-6.0 x Length	A2/304 grade stainless steel fasteners for fixing into timber.	GREENDRIVE

SPIDI System Fasteners - Fasteners included in the SPIDI Max subframe systems

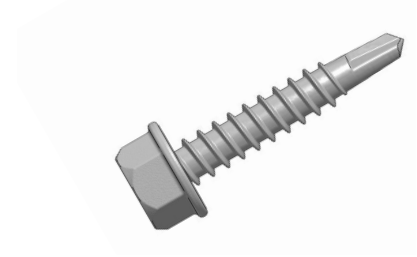

Application	Product Code	Description	Drive Socket
Bracket to Rail Fixing	DF3-SS-4.8 x 25	A2/304 grade stainless steel fastener for fixing to light metal purlins and rails.	GREENDRIVE
Hook bolt to T Rail	DF3-SS-4.8 x 25	A2/304 grade stainless steel fastener for fixing to light metal purlins and rails.	GREENDRIVE
SPIDI Versa Rail to L or T rail	DF3-SS-4.8 x 25	A2/304 grade stainless steel fastener for fixing to light metal purlins and rails.	GREENDRIVE
SPIDI Static hanger bracket to SPIDI Versa Rail	GDS3-FS-4.8 x 25	A2/304 grade stainless steel fastener for fixing to light metal purlins and rails.	GREENDRIVE
Rail to Rail fixing	DF3-SS-4.8 x 25	A2/304 grade stainless steel fastener for fixing to light metal purlins and rails.	GREENDRIVE

Sheathing Board Fixings

Installing Sheathing Board to Steel Framing Systems (SFS).

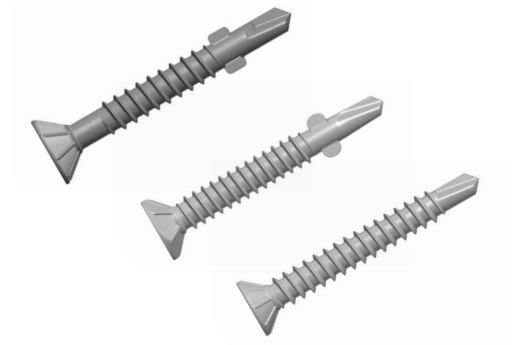
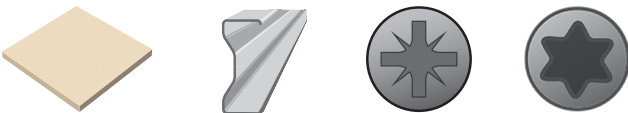

Application	Product Code	Description	Drive Socket
12mm Sheathing board to 1.5-3mm SFS (CARBON)	DF3-W-4.8 x 38	Carbon steel countersunk wingscrew fastener for fixing sheathing board to light section steel.	2PZD
12mm Sheathing board to 1.5-3mm SFS (Stainless)	DF3-SSA4-W-4.8 x 40	A4/316 grade stainless steel wingscrew for fixing sheathing board back to light section steel.	TX30
12mm Sheathing board to <2mm SFS (Stainless)	DFTB-SS-6.0 x 45	A2/304 grade stainless steel fasteners for fixing sheathing board to <2mm SFS	TX30

Typical fastener layout for 1200mm x 600mm semi-rigid mineral fibre board

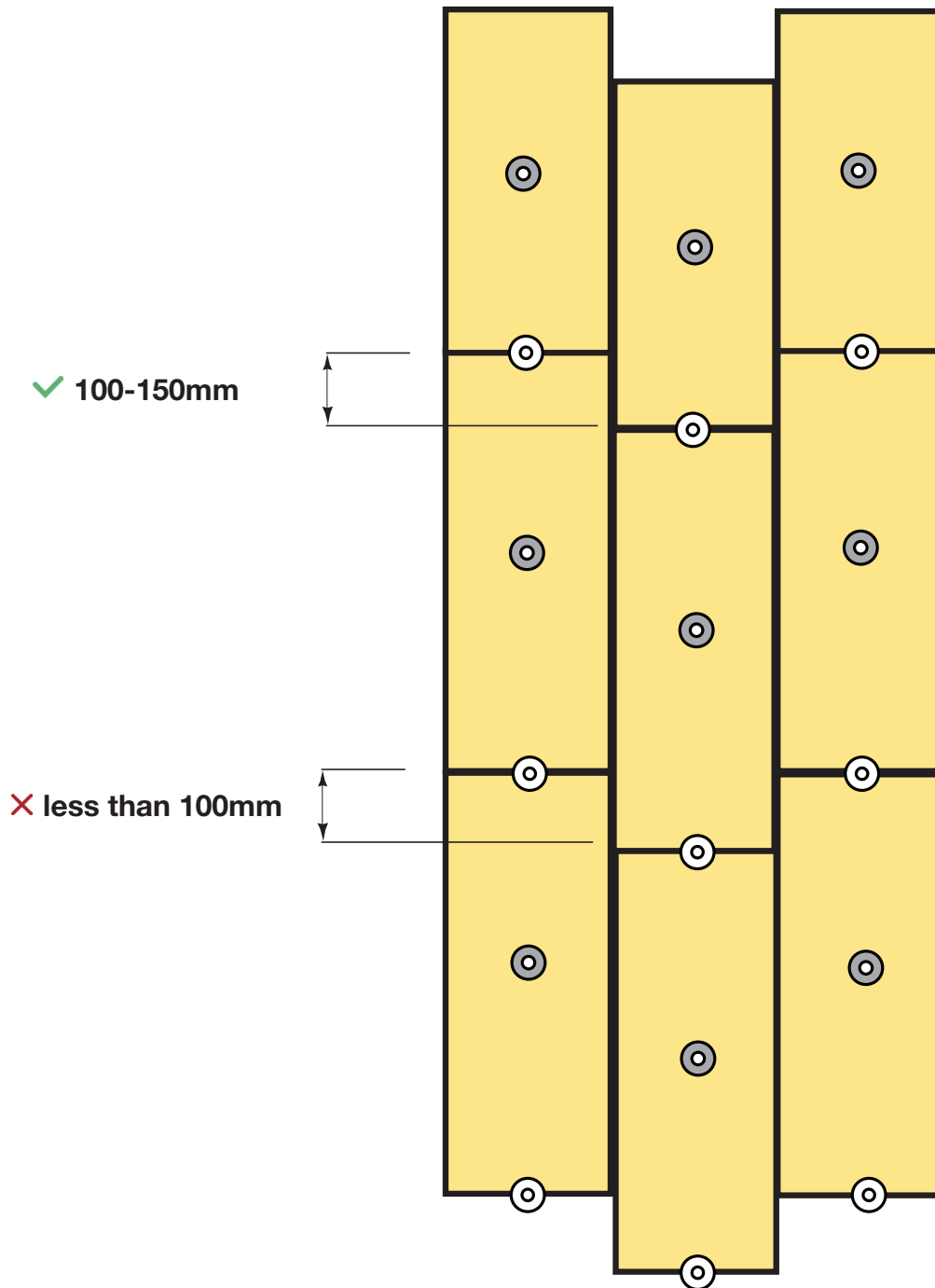

- ⊙ Metal Fixing
- ⊙ Polypropylene Fixing

NOTE: 70mm head dia. minimum.

Please check with the insulation manufacturer for specific fixing and fire safety recommendations.

Typical fastener layouts for 2400mm x 1200mm rigid PIR board

9 No. per board
(2.4m x 1.2m board - 3.13 fixings / m²)

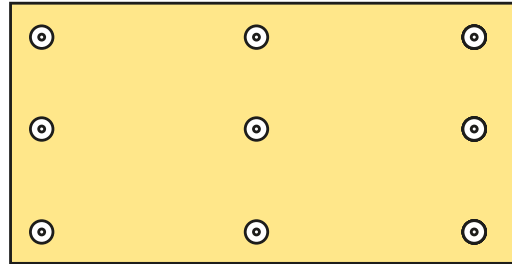

10 No. per board
(2.4m x 1.2m board - 3.47 fixings / m²)

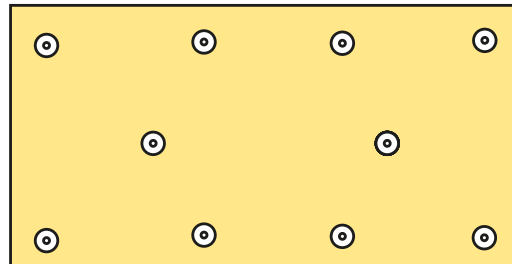

11 No. per board
(2.4m x 1.2m board - 3.82 fixings / m²)

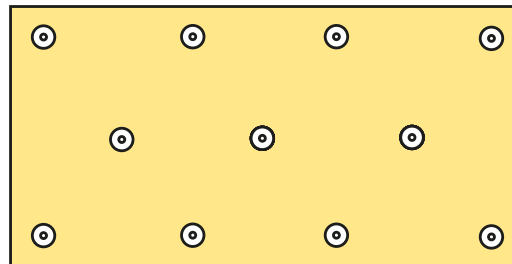

12 No. per board
(2.4m x 1.2m board - 4.17 fixings / m²)

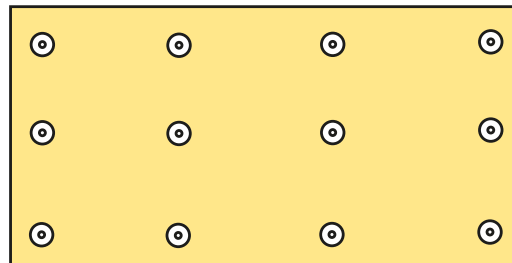

13 No. per board
(2.4m x 1.2m board - 4.51 fixings / m²)

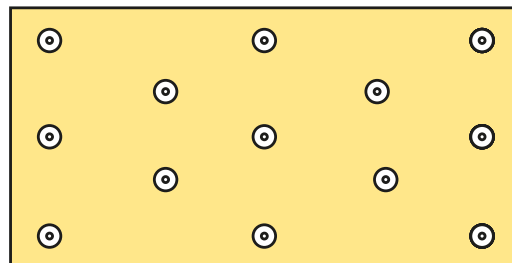

Please check with the insulation manufacturer for specific fixing and fire safety recommendations.

Fixing soft insulation to steel framing system - polypropylene head

Use DrillFast stainless steel fasteners and pressure plate

8mm hex head: use GreenDrive

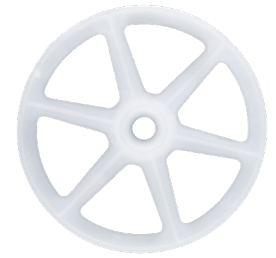

Insulation Thickness	Including 12mm sheathing board	Fastener and tube combination to steel
50mm	IW-90-8 & DF3-SS-HT-5.5 x 85	IW-90-8 & DF3-SS-HT-5.5 x 85
60mm	IW-90-8 & DF3-SS-HT-5.5 x 110	IW-90-8 & DF3-SS-HT-5.5 x 85
75mm	IW-90-8 & DF3-SS-HT-5.5 x 110	IW-90-8 & DF3-SS-HT-5.5 x 110
100mm	IW-90-8 & DF3-SS-HT-5.5 x 150	IW-90-8 & DF3-SS-HT-5.5 x 130
125mm	IW-90-8 & DF3-SS-HT-5.5 x 180	IW-90-8 & DF3-SS-HT-5.5 x 150
150mm	IW-90-8 & DF3-SS-HT-5.5 x 225	IW-90-8 & DF3-SS-HT-5.5 x 180
180mm	IW-90-8 & DF3-SS-HT-5.5 x 225	IW-90-8 & DF3-SS-HT-5.5 x 225
200mm	IW-90-8 & DF3-SS-HT-5.5 x 275	IW-90-8 & DF3-SS-HT-5.5 x 225
225mm	IW-90-8 & DF3-SS-HT-5.5 x 275	IW-90-8 & DF3-SS-HT-5.5 x 275
250mm	IW-90-8 & DF5-SSA4-HT-6.3 x 330	IW-90-8 & DF3-SS-HT-5.5 x 275
300mm	Please contact Fixfast for advice	IW-90-8 & DF5-SSA4-HT-6.3 x 330

Slab thicknesses over 230mm are only possible as a double layer

Fixing soft insulation to steel framing system - metal fixing

Use DrillFast® stainless steel fasteners and stainless steel washers

8mm hex head: use GreenDrive



Insulation Thickness	Including 12mm sheathing board	Fastener and washer combination to steel
50mm	SF-P-SS-70-D & DF3-SS-HT-5.5 x 85	SF-P-SS-70-D & DF3-SS-HT-5.5 x 85
60mm	SF-P-SS-70-D & DF3-SS-HT-5.5 x 110	SF-P-SS-70-D & DF3-SS-HT-5.5 x 85
75mm	SF-P-SS-70-D & DF3-SS-HT-5.5 x 110	SF-P-SS-70-D & DF3-SS-HT-5.5 x 110
100mm	SF-P-SS-70-D & DF3-SS-HT-5.5 x 150	SF-P-SS-70-D & DF3-SS-HT-5.5 x 130
125mm	SF-P-SS-70-D & DF3-SS-HT-5.5 x 180	SF-P-SS-70-D & DF3-SS-HT-5.5 x 150
150mm	SF-P-SS-70-D & DF3-SS-HT-5.5 x 225	SF-P-SS-70-D & DF3-SS-HT-5.5 x 180
180mm	SF-P-SS-70-D & DF3-SS-HT-5.5 x 225	SF-P-SS-70-D & DF3-SS-HT-5.5 x 225
200mm	SF-P-SS-70-D & DF3-SS-HT-5.5 x 275	SF-P-SS-70-D & DF3-SS-HT-5.5 x 225
225mm	SF-P-SS-70-D & DF3-SS-HT-5.5 x 275	SF-P-SS-70-D & DF3-SS-HT-5.5 x 275
250mm	SF-P-SS-70-D & DF5-SSA4-HT-6.3 x 330	SF-P-SS-70-D & DF3-SS-HT-5.5 x 275
300mm	SF-P-SS-70-D & DF5-SSA4-HT-6.3 x 330	SF-P-SS-70-D & DF5-SSA4-HT-6.3 x 330

Fixing soft insulation to masonry - polypropylene head

Use IAD-8 nylon anchors

Use 8mm SDS drill bits for pilot hole



Insulation Thickness	Fastener
50mm	IAD-8 x 80
60mm	IAD-8 x 100
75mm	IAD-8 x 120
100mm	IAD-8 x 140
125mm	IAD-8 x 160
150mm	IAD-8 x 180
180mm	IAD-8 x 220
200mm	IAD-8 x 240
225mm	IAD-8 x 260
250mm	IAD-8 x 280
270mm	IAD-8 x 300

Fixing soft insulation to masonry - metal

Use TIDR stainless steel anchors and TIDR-T-80 stainless steel plate washer

Use 8mm SDS drill bits for pilot hole

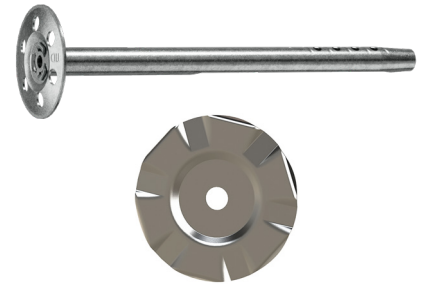

Insulation Thickness	Fastener and washer combination
50mm	TIDR-110 & TIDR-T-80
60mm	TIDR-110 & TIDR-T-80
75mm	TIDR-140 & TIDR-T-80
100mm	TIDR-140 & TIDR-T-80
125mm	TIDR-170 & TIDR-T-80
150mm	TIDR-200 & TIDR-T-80
180mm	TIDR-250 & TIDR-T-80
200mm	TIDR-250 & TIDR-T-80
225mm	TIDR-300 & TIDR-T-80
250mm	TIDR-300 & TIDR-T-80

Fixing rigid insulation to steel framing system - polypropylene head

Use DrillFast stainless steel fasteners and tube washers

8mm hex head: use GreenDrive



Insulation Thickness	Including 12mm sheathing board	Fastener and tube combination to steel
50mm	SF-T-50 x 25 & DF3-SS-HT-5.5 x 85	SF-T-50 x 25 & DF3-SS-HT-5.5 x 85
60mm	SF-T-50 x 25 & DF3-SS-HT-5.5 x 110	SF-T-50 x 25 & DF3-SS-HT-5.5 x 85
75mm	SF-T-50 x 25 & DF3-SS-HT-5.5 x 110	SF-T-50 x 25 & DF3-SS-HT-5.5 x 110
100mm	SF-T-50 x 25 & DF3-SS-HT-5.5 x 150	SF-T-50 x 25 & DF3-SS-HT-5.5 x 130
125mm	SF-T-50 x 25 & DF3-SS-HT-5.5 x 180	SF-T-50 x 25 & DF3-SS-HT-5.5 x 150
150mm	SF-T-50 x 25 & DF3-SS-HT-5.5 x 225	SF-T-50 x 25 & DF3-SS-HT-5.5 x 180
180mm	SF-T-50 x 25 & DF3-SS-HT-5.5 x 225	SF-T-50 x 25 & DF3-SS-HT-5.5 x 225
200mm	SF-T-50 x 25 & DF3-SS-HT-5.5 x 275	SF-T-50 x 25 & DF3-SS-HT-5.5 x 225
225mm	SF-T-50 x 25 & DF3-SS-HT-5.5 x 275	SF-T-50 x 25 & DF3-SS-HT-5.5 x 275
250mm	SF-T-50 x 25 & DF5-SSA4-HT-6.3 x 330	SF-T-50 x 25 & DF3-SS-HT-5.5 x 275
300mm	Please contact Fixfast for advice	SF-T-50 x 25 + DF5-SSA4-HT-6.3 x 330

Slab thicknesses over 230mm are only possible as a double layer

Fixing rigid insulation to masonry - metal

Use TIDR anchor

Use 8mm SDS drill bits for pilot hole



Insulation Thickness	Fastener and washer combination
50mm	TIDR-110
60mm	TIDR-110
75mm	TIDR-140
100mm	TIDR-140
125mm	TIDR-170
150mm	TIDR-200
180mm	TIDR-250
200mm	TIDR-250
225mm	TIDR-300
250mm	TIDR-300

Fixing rigid insulation to steel framing system - metal fixing

Use DrillFast® stainless steel fasteners and stainless steel washers

8mm hex head: use GreenDrive



Insulation Thickness	Including 12mm sheathing board	Fastener and washer combination to steel
50mm	SF-P-SSA4-40-F & DF3-SS-HT-5.5 x 85	SF-P-SSA4-40-F & DF3-SS-HT-5.5 x 85
60mm	SF-P-SSA4-40-F & DF3-SS-HT-5.5 x 110	SF-P-SSA4-40-F & DF3-SS-HT-5.5 x 85
75mm	SF-P-SSA4-40-F & DF3-SS-HT-5.5 x 110	SF-P-SSA4-40-F & DF3-SS-HT-5.5 x 110
100mm	SF-P-SSA4-40-F & DF3-SS-HT-5.5 x 150	SF-P-SSA4-40-F & DF3-SS-HT-5.5 x 130
125mm	SF-P-SSA4-40-F & DF3-SS-HT-5.5 x 180	SF-P-SSA4-40-F & DF3-SS-HT-5.5 x 150
150mm	SF-P-SSA4-40-F & DF3-SS-HT-5.5 x 225	SF-P-SSA4-40-F & DF3-SS-HT-5.5 x 180
180mm	SF-P-SSA4-40-F & DF3-SS-HT-5.5 x 225	SF-P-SSA4-40-F & DF3-SS-HT-5.5 x 225
200mm	SF-P-SSA4-40-F & DF3-SS-HT-5.5 x 275	SF-P-SSA4-40-F & DF3-SS-HT-5.5 x 225
225mm	SF-P-SSA4-40-F & DF3-SS-HT-5.5 x 275	SF-P-SSA4-40-F & DF3-SS-HT-5.5 x 275
250mm	SF-P-SSA4-40-F & DF5-SSA4-HT-6.3 x 330	SF-P-SSA4-40-F & DF3-SS-HT-5.5 x 275
300mm	Please contact Fixfast for advice	SF-P-SSA4-40-F & DF5-SSA4-HT-6.3 x 330

Fixing rigid insulation to masonry - polypropylene head

Use IAD-8 anchors

Use 8mm SDS drill bits for pilot hole



Insulation Thickness	Fastener
50mm	IAD-8 x 80
70mm	IAD-8 x 100
90mm	IAD-8 x 120
110mm	AD-8 x 140
130mm	IAD-8 x 160
150mm	IAD-8 x 180
170mm	IAD-8 x 200
190mm	IAD-8 x 220
210mm	IAD-8 x 240
230mm	IAD-8 x 260
250mm	IAD-8 x 280
270mm	IAD-8 x 300

Cavity Barrier Fasteners

Mechanically fix the cavity barrier support bracket to substrate.



Application	Product Code	Description	Drive Socket
Fix to concrete	TXE-6 x 40	A4/316 grade stainless steel screw for fixing to cracked and non-cracked concrete	10mm integral socket Pre-drill 6mm diameter
Fix to solid brickwork and blockwork	TXE-6 x 40	A4/316 grade stainless steel screw for fixing to cracked and non-cracked concrete	10mm integral socket Pre-drill 6mm diameter
Fix to 1.2 - 3.0mm steel studs	DF3-SS-5.5 x 25	DrillFast A2/304 grade stainless steel fasteners for fixing to light section steel	GREENDRIVE
Through 12mm sheathing board to 1.2 - 3.0mm steel studs	DF3-SS-5.5 x 35	DrillFast A2/304 grade stainless steel fasteners for fixing to light section steel	GREENDRIVE
Through 30mm sheathing board to 1.2 - 3.0mm steel studs	DF3-SS-5.5 x 55	DrillFast A2/304 grade stainless steel fasteners for fixing to light section steel	GREENDRIVE
Fix to 4.0 - 15.0mm steel studs	DF15-SS-5.5 x 40	DrillFast A2/304 grade stainless steel fasteners for fixing to heavy section steel	GREENDRIVE
Through 12-30mm sheathing board to 4.0 - 15.0mm steel studs	DF15-SS-5.5 x 75	DrillFast A2/304 grade stainless steel fasteners for fixing to heavy section steel	GREENDRIVE
Fix to 4.0 - 18mm steel studs	DF25-SSA4-6.3 x 75	DrillFast A4/316 grade stainless steel fasteners for fixing to ultra heavy section steel	GREENDRIVE
Fix to 12mm cement particle board	DF3-SS-5.5 x 35	DrillFast A2/304 stainless steel light steel fasteners	GREENDRIVE
Fix to 12mm calcium silicate board	DF3-SS-5.5 x 35	DrillFast A2/304 stainless steel light steel fasteners	GREENDRIVE
Fix to 0.5 - 0.7mm steel faced SIP/ Composite panel backing wall	DF2-SS-LS-A15-6.3 x 25	DrillFast A2/304 stainless steel stitchers	GREENDRIVE
Fix to OSB faced SIP panel, plywood, or CLT	DFT-SS-6.0 x 50	DrillFast A2/304 stainless steel timber fasteners	GREENDRIVE

*When fixing direct to cement particle board or calcium silicate board please refer to manufacturers guidelines

Find product data
at fixfast.com

Façade Panel Fasteners

Mechanically fix the exterior façade panel to the SPIDI Max Helping hand system.

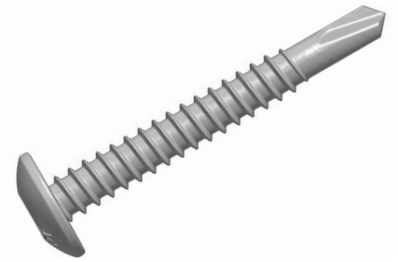

Application	Product Code	Description	Drive Socket
Aluminium Panel to 2mm Aluminum Support Rail	DF3-SSA4-P-5.5 x Length	A4/316 grade stainless steel low-profile fastener for fixing to light metal purlins and rails.	REDDRIVE
Fibre Cement Panel to 2mm Aluminum Support Rail	DF3-SSA4-P-5.5 x Length	A4/316 grade stainless steel low-profile fastener for fixing to light metal purlins and rails.	REDDRIVE
Timber Panel to 2mm Aluminum Support Rail	DF3-SSA4-P-5.5 x Length	A4/316 grade stainless steel low-profile fastener for fixing to light metal purlins and rails.	REDDRIVE
GRC Panel to 2mm Aluminum Support Rail	DF3-SSA4-P-5.5 x Length	A4/316 grade stainless steel low-profile fastener for fixing to light metal purlins and rails	REDDRIVE

Façade Panel Rivets

Rivet fix the exterior façade panel to the SPIDI Max Helping hand system.

The size and specification of the rivet will change depending on the manufacturer's details.

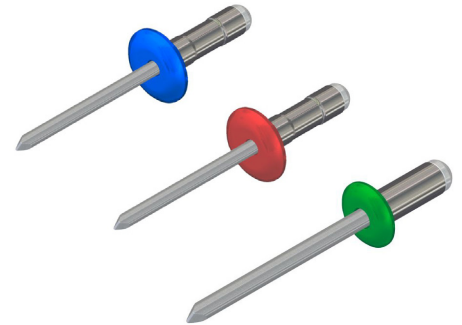

Product Code	Description
R-AS-LF-LAC-4.0 x Length	Aluminium / stainless 4.0mm diameter large flange rivet (Can supply painted or mill finish)
R-AS-LF-LAC-4.8 x Length	Aluminium / stainless 4.8mm diameter large flange rivet
R-AS-LF-LAC-5.0 x Length	Aluminium / stainless 5.0mm diameter large flange rivet
R-SSA4-LF-LAC-4.8 x Length	A4/316 grade stainless steel 4.8mm diameter large flange rivet
R-SSA4-LAC-4.8 x Length	A4/316 grade stainless steel 4.8mm diameter blind rivet
R-SS-LF-LAC-4.8 x Length	A2/304 grade stainless steel 4.8mm diameter large flange rivet
R-SS-LAC-4.8 x Length	A2/304 grade stainless steel 4.8mm diameter blind rivet

All Rivets available painted in most RAL & BS colours, or mill finish

Accessories - Rail Black Out & Anti-rattle Tape



Tape Code	Description
RBOT-40 x 25	40mm A2 fire rated self-adhesive blackout tape designed to conceal facade support rails
RBOT-60 x 25	60mm A2 fire rated self-adhesive blackout tape designed to conceal facade support rails
RBOT-120 x 25	120mm A2 fire rated self-adhesive blackout tape designed to conceal facade support rails
ART-1.2 x 60 x 25	60mm Anti-rattle / anti-squeak tape for facade rails
ART-1.2 x 120 x 25	120mm Anti-rattle / anti-squeak tape for facade rails

Accessories - Insect Mesh



Insect Mesh Code	Description
CM-BF- [Width] x 30	Black fibreglass insect ventilation mesh, available in widths: 100mm, 150mm, 200mm, 300mm, 1200mm
CM-BA- [Width] x 30	Black aluminium insect ventilation mesh, available in widths: 75mm, 100mm, 150mm, 200mm
CM-SS- [Width] x 30	Stainless steel rodent proof insect ventilation mesh, available in widths: 100mm, 150mm, 200mm

Find product data
at [fixfast.com](https://www.fixfast.com)

Accessories - Breather Membranes



Membrane Code	Description
FLAMEOUT-BREATHE-FR	FlameOut Breathe FR membrane is a breathable, non-woven fabric with superior self-extinguishing, flame-retardant properties, Class B-s1,d0
FSM-0.75 x [WIDTH] x 20	EPDM facade sealing membrane, available in widths: 100mm, up to 1000mm
CORTEX-0765-ADHESIVE	Facade sealing membrane - adhesive
FSM-FRCB-SA-0.5 x [WIDTH] x 20	Self-adhesive, Class B fire-classified EPDM-alternative membrane which is used to create water and airtight seals around openings
FSM-FRCB-0.5 x [WIDTH] x 20	Class B Fire-classified EPDM-alternative membrane which is used to create water and airtight seals around openings
CORTEX-0771FR-ADHESIVE	Class B fire rated facade sealing membrane adhesive
MPT-60 x 25	Sealing tape for repairing penetrations in breather membrane

Accessories - Packing Shims



Membrane Code	Description
APS- [THICKNESS] x 50 x 50-M12	Aluminium packing horseshoe spacer trouser shims, available in; 0.9mm, 2mm, 3mm, 5mm and 10mm thicknesses
SSPS- [THICKNESS] x 50 x 50-M12	Stainless packing horseshoe spacer trouser shims, available in 2mm, 3mm, 5mm and 10mm thicknesses

Accessories - Drives

GreenDrive

One-piece drive socket for 8mm hex-head stainless steel fasteners.

Product Code: GREENDRIVE



RedDrive

One-piece drive socket for DrillFast® low profile fasteners, supports the head for easy accurate driving.

Product Code: REDDRIVE



TX25 Drivebar

One piece DriveBar for SureFast Fasteners

Product Code: 50-TX25



Socket system

Socket for 13mm hex nut, 9.5mm drive

Product Code: 9.5-SOCKET-13

Socket for 13mm hex nut, 12.5mm drive

Product Code: 12.5-SOCKET-13

Torque wrench for 9.5mm drive

Product Code: WRENCH-9.5

Torque wrench for 12.5mm drive

Product Code: WRENCH-12.5

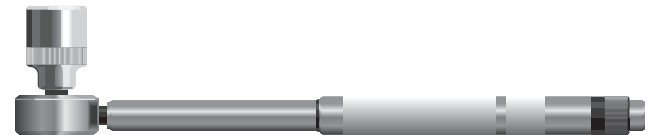

Many other tools and accessories are available.

Please see the current Fixfast Product Directory, go to www.fixfast.com, or ask the Fixfast customer service team.

Find product data
at fixfast.com

Installation and handling

+ **Installation tool**

Variable speed electric screwdriver
Impact Drivers should not be used

+ **Installation speed**

1500rpm

+ **Correct Installation**

Fasteners should be driven within three degrees of perpendicular to the surface of the fastened material. Use a depth-setting nosepiece to avoid over-driving, and do not over-tighten. Variants with bonded washers should not have the rubber compressed to less than two-thirds of its uncompressed height. Care should be taken when engaging and disengaging from the fastener and to avoid damage to the protective coating.

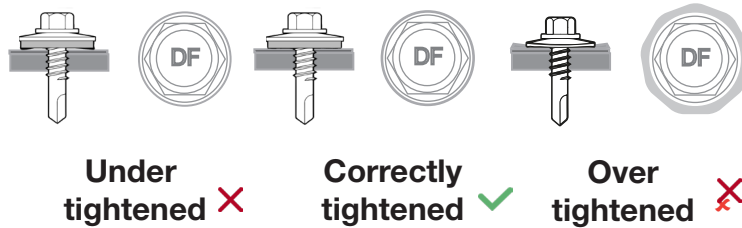

+ **Handling**

Fasteners may have sharp edges, and the use of power tools can be dangerous. Use personal protective equipment. Store fasteners in dry conditions. Inspect each fastener before use and do not use damaged fasteners. Replace any fasteners which appear to have been installed incorrectly.

Technical Notes

Fastener Data

- + All dimensions are subject to manufacturing tolerances.
- + Performance values are tested and calculated according to Eurocode procedures and appropriate safety factors should be applied in any calculations using these values.

Fastener Selection

- + Recommended fastener lengths are calculated using standard tolerances for the fasteners and the combination of materials in the build-up.
- + If there is distortion in the supporting construction, or other non-standard application detail, longer fasteners may be necessary than those shown. Always check the actual circumstances before deciding on a particular length.

Further Assistance

- + For any enquiry, or to discuss your requirements with someone knowledgeable, call the Fixfast customer service team on **0800 304 7616**
- + Full literature is available for the Fixfast range, visit **www.fixfast.com**
- + Other performance data may be available on request. For more unusual applications, tests can be carried out in our in-house technical centre to provide the necessary data.
- + CAD files of fasteners are available on request for inclusion in drawings.

The information contained in this document is based on the specification of the Rainscreen Fastener system and Fixfast's product data. It is provided in good faith but Fixfast cannot be held liable for any errors. Performance is dependent on adherence to the conditions and instructions contained in Fixfast's Technical Data Sheets for the products shown. Performance values should be approved by a qualified engineer, and Fixfast recommend preliminary tests for any application where variation is possible in the materials or substrates involved.



All our technical data can be found on our website against the individual products - including certifications, performance values, and other relevant technical data.

Find product data
at **[fixfast.com](http://www.fixfast.com)**



Contact Details:

T: +44 (0) 1732 882387

E: sales@fixfast.com

W: fixfast.com



0026

©Fixfast April 2026 | Ref: SG-S-ST-04.26/01

